

EASY  
HOME®



# USER GUIDE

## HAND HELD STEAM CLEANER



---

NOW YOU HAVE PURCHASED AN EASY HOME® PRODUCT  
YOU CAN REST ASSURED IN THE KNOWLEDGE THAT AS  
WELL AS YOUR MANUFACTURER'S WARRANTY YOU HAVE  
THE ADDED PEACE OF MIND OF DEDICATED HELPLINES  
AND WEB SUPPORT

---

### AFTER SALES SUPPORT



USA

800-223-1898



info@electra-craft.com

MODEL: 4103, 10/14, 91735

2

YEAR WARRANTY

CLEANING

# Index

---

- 03     Introduction**
- 04     Important safeguards**
- 08     Grounding instructions**
- 09     Description of the appliance**
- 10     Instructions for use**
- 11     Application of the attachments**
- 13     Filling the tank during use**
- 14     Cleaning and maintenance**
- 15     Warranty card**

# Introduction

---

Congratulations!

You have made an excellent choice with the purchase of this quality EASY HOME® product.

By doing so you now have the assurance and peace of mind which comes from purchasing a product that has been manufactured to the highest standards of performance and safety, supported by the high quality standards of ALDI.

We want you to be completely satisfied with your purchase so this EASY HOME® product is backed by a comprehensive manufacturer's 2 year warranty and an outstanding after sales service through our dedicated Helpline.

We hope you will enjoy using your purchase for many years to come.

If you require technical support or in the unlikely event that your purchase is faulty please call our Helpline for immediate assistance. Faulty product claims made within the 2 year warranty period will be repaired or replaced free of charge provided that you have satisfactory proof of purchase (keep your receipt safe!). This does not affect your statutory rights. However, be aware that the warranty will become null and void if the product is found to have been deliberately damaged, misused or disassembled.

This appliance is guaranteed from the date of purchase against all faults arising from materials or manufacture. Repair of damage or defects not covered by this warranty, or made after the warranty period has expired, will be charged at the current repair costs for repair, labor, and spare parts. In particular, warranty does not normally cover parts subject to consumption with use, like for example round brush, bent nozzle, glass wiper and cloth.

The product must be sent to the service center, in order to avoid damage during transport. Transport damages caused by inadequate packing of the product is not covered by warranty.

# Important safeguards

## SYMBOLS

The information in this manual is labeled as follows:



DANGER for children



DANGER from electricity



DANGER from other causes



WARNING: risk of burns from high temperature steam



IMPORTANT possible damage to materials

READ THESE INSTRUCTIONS BEFORE USE.

DO NOT THROW AWAY THESE INSTRUCTIONS.



### DANGER to children

- This appliance is not suitable for use by people (including children) with reduced physical, sensory or mental capabilities; by people with little or no experience or awareness of the appliance, unless carefully supervised or trained in the use of the appliance by a person responsible for their safety.
- Do not allow to be used as a toy. Close attention is necessary when used by or near children.
- When disposing of the appliance, it must be made inoperative by cutting off the power cord. Also remember to make any potentially hazardous parts of the appliance safe, as there is a risk that children may use them as toys.
- Packaging elements must not be left in reach of children as they are potentially hazardous.

# Important safeguards



## **DANGER from electricity**

- Make sure that the power voltage of the appliance corresponds to that of your main electrical power supply.
- To provide protection against risk of electric shock, connect to properly grounded outlets only.
- Do not use extension cords.
- Do not leave steamer unattended.
- Do not leave steamer when plugged in. Unplug the electrical cord when not in use and before servicing.
- Always switch off the appliance at the main switch and unplug it from the power supply before refilling it.
- Make sure that hands are dry before using or adjusting the appliance switches, before touching the plug or power connections.
- Do not handle plug or steamer with wet hands.



## **DANGER from other causes**

- Never leave the appliance exposed to the elements (rain, sunshine, etc.).
- Store your steamer indoors in a cool, dry area.
- Keep your work area well lighted.
- Use extra care when cleaning stairs.
- Never place the appliance on or near sources of heat.
- Do not put hands or feet under steamer.
- Do not pull or carry by cord. Do not use cord as a handle. Do not close a door on cord or pull cord around sharp edges or corners. Do not run steamer over cord. Keep cord away from heated surfaces.
-  Never point steam jets in the direction of people, animals or plants or towards appliances that contain electrical parts (e.g., oven interiors).
- Never direct steam jets onto the appliance itself.
- Do not immerse the steamer into water or other liquids. Always unplug the power cord from the electrical socket when filling the steamer.
- Do not use with damaged cord or plug. Inspect cord before using. If steamer is not working as it

# Important safeguards

should, has been dropped, damaged, left outdoors, or dropped into water, return it to a service center before using.

- All repairs, including the replacement of the power cord, must be carried out exclusively by a Service Center or by authorized technicians, so as to prevent any risks.
- This appliance has been designed for domestic use only and may not be used for commercial or industrial purposes.
- Household use: Do not use outdoors
- During use, the appliance contains pressurized steam: improper use can be dangerous. The appliance is designed for domestic use only, as stated in the manual. The manufacturer cannot accept any liability for damage caused through improper or incorrect use of the appliance.



## **WARNING: risk of burns from high temperature steam**

- If the steam button is pressed before the boiler has reached the optimum temperature, then water instead of steam could come out of the nozzle.
- Never touch hot surfaces while using the product. Let attachments cool before replacing them.
- Even when the appliance is not in operation, unplug it from the power supply and let it cool before inserting or removing single parts or before cleaning it.
- **IMPORTANT:** danger of burns.
- **NEVER OPEN THE CAP ON THE TANK DURING USE.**
- Before filling with water, proceed as follows; (1) Unplug from the power supply and allow to fully cool down for 5 minutes. (2) Slowly lift up cap and wait 5 seconds before refilling.



## **IMPORTANT possible damage to materials**

- Before using the product, make sure that all items, surfaces and fabrics to be cleaned are resistant to or compatible with the high temperature of the steam. Specifically, treated terracotta flooring, wooden surfaces or delicate fabrics, such as silk or velvet, should not be treated without first consulting the manufacturer's instructions and carrying out a test on a small hidden sample part.
- Never use in swimming pools containing water.
- Not for space heating purposes.

# Important safeguards

---

- Never put descaling, aromatic, alcoholic or detergent products into the steamer, as this may damage it or make it unsafe for use.
- Before switching on the appliance, make sure that there is sufficient water inside the tank. If it is necessary to refill the tank during use, proceed as described previously, and following the instructions in the paragraph "FILLING THE TANK DURING USE".
- Clean the tank at least once a month so as to eliminate any scale residues that might affect the normal operation of the appliance (see the paragraph "CLEANING AND MAINTENANCE").
- Do not put any object into openings. Do not use with any opening blocked.
- Never use the window wiper brush if the surface to be cleaned is cold; the thermal movement could cause the surface to break. In cold seasons, where the temperature is particularly low, pre-heat the glass with steam jets, all over, from a distance of about 15.7 in.
- When using for the first time or after a long pause, direct the steam jet into a container to eliminate any excess water.
- Use only as described in this manual. Use only manufacturer's recommended accessories.
- Do not unplug by pulling on cord. To unplug, grasp the plug, not the cord.
- Any changes to this product not expressly authorized by the supplier may make safety devices inoperative and will also make the user's warranty null and void.

## SAVE THESE INSTRUCTIONS

# Grounding instructions

## DANGER

Improper connection of the equipment-grounding conductor can result in a risk of electric shock. Check with a qualified electrician or service person if you are in doubt as to whether the outlet is properly grounded. Do not modify the plug provided with the appliance – if it will not fit the outlet, have a proper outlet installed by a qualified electrician.

This appliance must be grounded. If it should malfunction or breakdown, grounding provides a path of least resistance for electric current to reduce the risk of electric shock.

This appliance is equipped with a cord having an equipment grounding conductor and grounding plug. The plug must be inserted into an appropriate outlet that is properly installed and grounded in accordance with all local codes and ordinances.

This appliance is for use on a nominal 120 volt circuit and has a grounding plug that looks like the plug illustrated in Figure A. A temporary adapter which looks like the adapter illustrated in Figure B may be used to connect this plug to a two pole receptacle, as shown, if a properly grounded outlet is not available.

The temporary adapter should be used only until a properly grounded outlet, Figure A, can be installed by a qualified electrician. The green colored rigid ear, lug, or the like extending from the adapter must be connected to a permanent ground such as a properly grounded outlet box cover. Whenever the adapter is used, it must be held in place by a metal screw.

NOTE: In Canada, the use of a temporary adapter is not permitted by the Canadian Electrical Code.

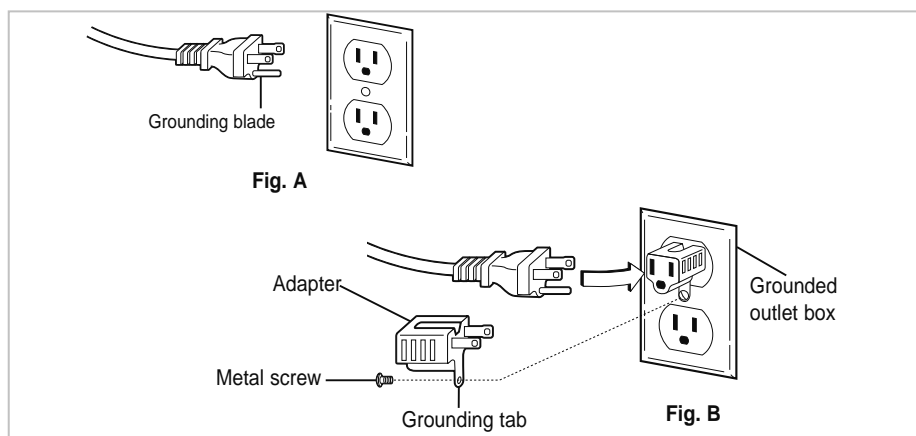



# Description of the appliance

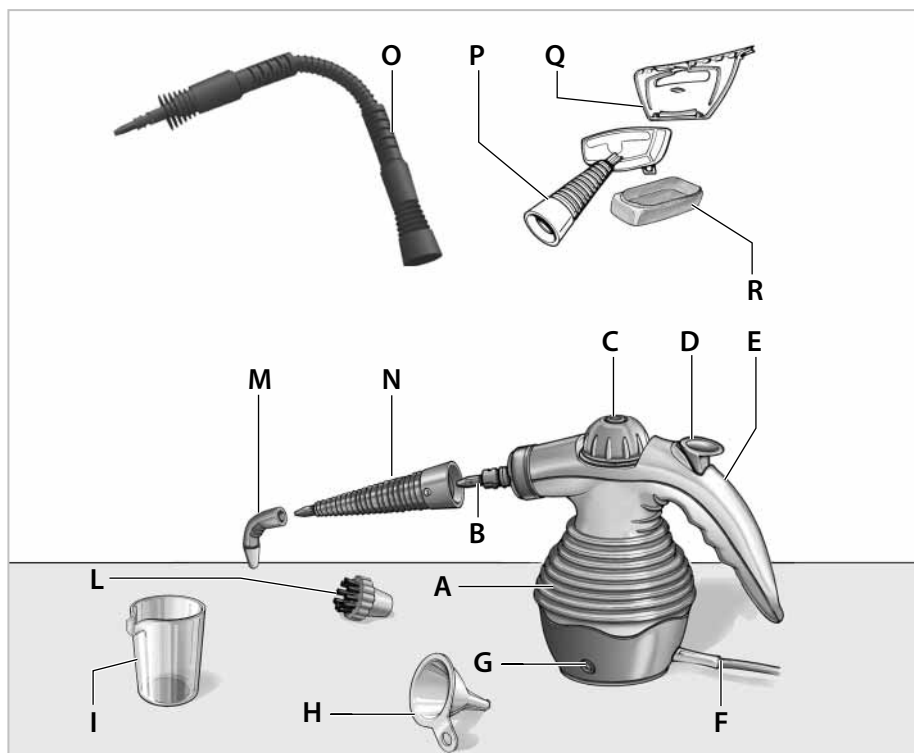

## DESCRIPTION OF THE APPLIANCE

A	Appliance body
B	Steam nozzle
C	Safety cap
D	Steam push button 
E	Handle
F	Power cord
G	Warning Light

## ATTACHMENTS

H	Funnel
I	Measuring cup
L	Round brush
M	Bent nozzle
N	Straight nozzle
O	Flexible pipe
P	Brush for fabrics
Q	Glass wiper
R	Cloth
	Instruction manual

# Instructions for use

## How to fill the tank before use

**NEVER UNSCREW THE TANK CAP UNLESS YOU ARE SURE THAT THE APPLIANCE HAS BEEN UNPLUGGED FROM THE OUTLET.**

Unscrew the safety cap (C) and overturn the tank to drain it completely.

Fill the tank with water using the special measuring cup (I) and funnel (H) provided (fig.1).

The tank has a capacity of 250 ml (roughly 8 1/2 fl. oz) and therefore the measuring cup needs to be filled twice up to the black-coloured reference notch.

Screw the safety cap (C) on again.



## How to start the appliance

Insert the plug attached to the power cord into the outlet. The warning light (G) will go on.

Steam will be ready after about 3 to 4 minutes. Press button (D) to release steam.

# Application of the attachments

## Straight nozzle:

a) fully insert the attachment until it comes to a stop up against the appliance's body. Align the mark on the nozzle with the mark on the appliance as shown in figure 2;

b) turn in a clockwise direction until the mark on the nozzle is perfectly aligned with the two lines on the appliance's body. Now the attachment is locked in the central position.

The appliance is provided with an articulated joint which allows the jet of steam to be directed as desired:

insert the straight nozzle until it covers the round gasket, align the mark on the nozzle with the mark on the appliance's body as shown in figure 2.

Turn in a clockwise direction until the mark on the nozzle is perfectly aligned with the two lines on the appliance's body (Figure 3). Now you can direct the jet of steam as desired.

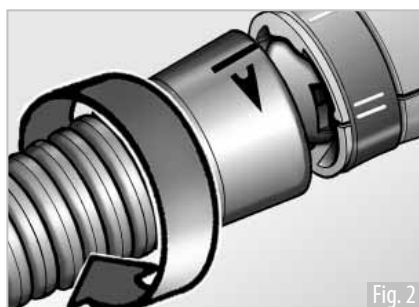

Fig. 2

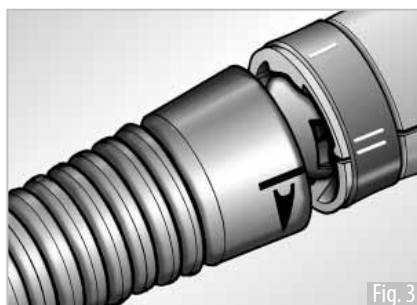
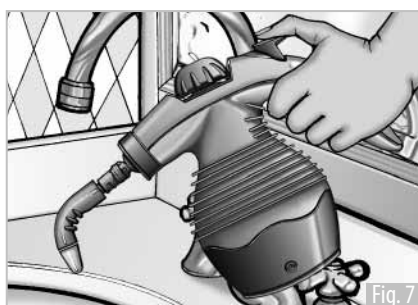
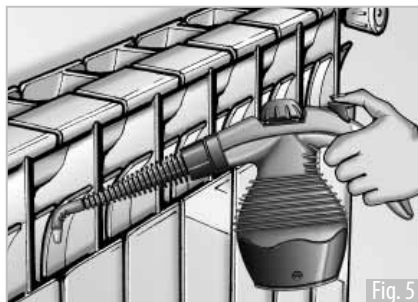
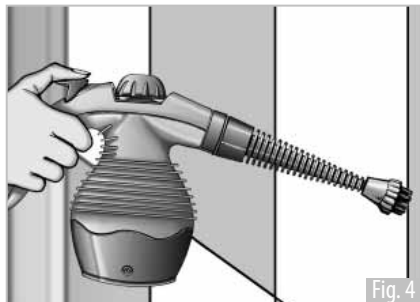

Fig. 3

# Application of the attachments

## Round brush and bent nozzle:

Both these attachments can be applied to the straight nozzle (Figure 4 and 5) and the nozzle (Figure 6 and 7). Apply them to the hexagonal end and then choose the desired angle.



# Filling the tank during use

## Flexible pipe, Brush for fabrics and glass wiper:

The flexible pipe (O) must be attached to the steam nozzle (B). Then apply the round brush (L), the bent nozzle (M) the straight nozzle (N) and then the brush for fabrics (P) to the hexagonal end on the pipe.

The brush for fabrics is provided with a cloth that can be used for the cleaning of delicate surfaces such as sofas and armchairs, and with a glass wiper to be fitted as shown in figure 8.

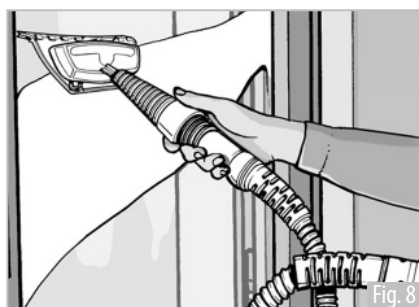

Fig. 8

## Filling the tank during use

When the water in the tank has run out and you press the button (D) no steam will come out. To refill, carry out the following operations:

- unplug the appliance;
- wait for about 10 seconds;
- carefully unscrew the safety cap (C). Before unscrewing it completely wait for the hissing noise created by residual steam to stop;
- unscrew the cap completely and slowly pour water into the tank using the funnel (H). Take care not to let any water flow out of the tank during this operation;
- retighten the safety cap;
- insert the plug into the outlet.

# Cleaning and maintenance

---

Unplug the appliance from the outlet before carrying out any operation.

Let the appliance cool down completely before putting it away or cleaning it.

To ensure appliance's best performance and long life, rinse out the boiler every month to remove any scale deposits.

Do not use vinegar or other descaling agents.

## Technical Specifications

Voltage Rating 120V 60 Hz

Power 900W

Protection Class I (this appliance must be earthed)

# HAND HELD STEAM CLEANER

Your details:

Name \_\_\_\_\_

Address \_\_\_\_\_

\_\_\_\_\_

\_\_\_\_\_



\_\_\_\_\_ E mail \_\_\_\_\_

Date of purchase\* \_\_\_\_\_

\* We recommend you keep the receipt with this warranty card

Location of purchase \_\_\_\_\_

Description of malfunction:

Return your completed warranty card to:

Electra-Craft, Inc.  
41 Woodbine Street  
Bergenfield, NJ 086121  
Phone: 201-439-1700  
Fax: 201-439-1791  
Toll free no. 800-223-1898  
M-F: 8:00 a.m. - 4:30 p.m. EST

## AFTER SALES SUPPORT



800-223-1898



info@electra-craft.com

MODEL: 4103, 10/14, 91735

**2**

YEAR WARRANTY

