

EASY
HOME®



USER GUIDE

HAND HELD STEAM CLEANER



NOW YOU HAVE PURCHASED AN EASY HOME® PRODUCT YOU CAN REST ASSURED IN THE KNOWLEDGE THAT AS WELL AS YOUR MANUFACTURER'S WARRANTY YOU HAVE THE ADDED PEACE OF MIND OF DEDICATED HELPLINES AND WEB SUPPORT

AFTER SALES SUPPORT

☎ 08452 100888
☎ 00353 (0) 579324910

💻 www.aldi.com

MODEL: 4122, 08/13, 90641

3

YEAR WARRANTY

CLEANING

Index

- 03** Introduction
- 04** Important safeguards
- 08** Description of the appliance
- 09** Instructions for use
- 10** Application of the attachments
- 12** Filling the boiler tank during use
- 13** Cleaning and maintenance
- 13** Storing the appliance and disposal

Introduction

Congratulations!

You have made an excellent choice with the purchase of this quality EASY HOME® product.

By doing so you now have the assurance and peace of mind which comes from purchasing a product that has been manufactured to the highest standards of performance and safety, supported by the high quality standards of ALDI.

We want you to be completely satisfied with your purchase so this EASY HOME® product is backed by a comprehensive manufacturer's 3 year warranty and an outstanding after sales service through our dedicated Helpline.

We hope you will enjoy using your purchase for many years to come.

If you require technical support or in the unlikely event that your purchase is faulty please telephone our Helpline for immediate assistance. Faulty product claims made within the 3 year warranty period will be repaired or replaced free of charge provided that you have satisfactory proof of purchase (keep your till receipt safe!). This does not affect your statutory rights. However, be aware that the warranty will become null and void if the product is found to have been deliberately damaged, misused or disassembled.

The instruction manual is also available from our customer assistance service, in PDF format.

Important safeguards

SYMBOLS

The information in this manual is labelled as follows:



DANGER for children



DANGER from electricity



DANGER from other causes



WARNING: risk of burns from high temperature steam



IMPORTANT possible damage to materials

READ THESE INSTRUCTIONS BEFORE USE.

KEEP THIS MANUAL AND CONSIGN IT TO THE NEW USER IF THE APPLIANCE IS SOLD ON.

This appliance conforms to the Directives 2006/95/EC and EMC 2004/108/EC.



DANGER to children

- Children over the age of 8 years are permitted to use this appliance, as are persons with reduced physical, sensory or mental capabilities, or without experience or skills, as long as they are suitably supervised or trained in the safe use of the appliance, and as a result, aware of the risks involved.

Children must not play with the appliance.

Cleaning and maintenance cannot be performed by children without adult supervision.

- When disposing of the appliance as waste, it must be made inoperative by cutting off the power cord. Also remember to make any parts of the potentially hazardous parts of the appliance safe, as there is a risk that children may use them as playthings.
- Packaging elements must not be left in reach of children as they are potentially hazardous.



Important safeguards



DANGER from electricity

- Make sure that the power voltage of the appliance corresponds to that of your mains electricity.
- Always connect the appliance to a properly earthed socket.
- In case of using extension leads, these must be suitable for the appliance power to avoid danger to the operator and for the safety of the environment in which the appliance is being used. Extension leads, if not suitable, can cause operating anomalies.
- Never leave the appliance unattended when it is connected to the power mains; unplug it after every use.
- Always switch off the appliance at the main switch and unplug it from the power mains before refilling it.
- Make sure that hands are dry before using or adjusting the appliance switches, before touching the plug or power connections.



DANGER from other causes

- Never leave the appliance exposed to the elements (rain, sunshine, etc.).
- Never place the appliance on or near to sources of heat.
- Make sure that the power cord does not come into contact with hot surfaces.
-  Never point steam jets in the direction of people, animals or plants or towards appliances that contain electrical parts (e.g., oven interiors).
- Never direct steam jets onto the appliance itself.
- Never immerse the body of the appliance, plug or power cord in water or other liquids; clean them with a damp cloth.
- Never use the appliance if the power cord or plug are damaged or if the appliance is faulty / damaged.
- All repairs, including the replacement of the power cord, must only be carried out by an Ariete Assistance Centre or by technicians authorised by Ariete, so as to prevent any risks.

Important safeguards

- This appliance has been designed for domestic use only and may not be used for commercial or industrial purposes.
- During use, the appliance contains pressurised steam: improper use can be dangerous. The appliance is designed for domestic use only, as stated in the manual. The manufacturer cannot accept any liability for damage caused through improper or incorrect use of the appliance.



WARNING: risk of burns from high temperature steam

- If the steam button is pressed before the boiler has reached the optimum temperature, then water instead of steam could come out of the nozzle.
- Never touch hot surfaces while using the product. Leave attachments to cool before replacing them.
- Even when the appliance is not in operation, unplug it from the power mains and leave it to cool before inserting or removing single parts or before cleaning it.
- **IMPORTANT: danger of scalds.**
- **NEVER OPEN THE CAP ON THE BOILER TANK DURING USE.**
- **IMPORTANT: Before unscrewing the cap on the boiler tank, proceed as follows:**
 - disconnect the power cable from plug socket;
 - bleed out the remaining pressure from the boiler tank, using the steam button on the gun and pointing the jet into a suitable container;
 - leave the appliance to cool for a few minutes;
 - slowly loosen the boiler tank cap, part of the way and wait for a few seconds;
 - unscrew the cap completely and remove it.



Important safeguards



IMPORTANT possible damage to materials

- Before using the product, make sure that all items, surfaces and fabrics to be cleaned are resistant to or compatible with the high temperature of the steam. Specifically, treated terracotta flooring, wooden surfaces or delicate fabrics, such as silk or velvet, should not be treated without first consulting the instructions from the manufacturer and carrying out a test on a small hidden sample part.
- Never use in swimming pools containing water.
- Never add scale removers, fragrances, alcohols or detergents to the boiler tank, as these could damage the appliance. We recommend filling with tap water or alternatively, with 50% demineralised water and 50% tap water in areas where the water is very hard.
- Before switching on the appliance, make sure that there is sufficient water inside the boiler tank. If it is necessary to refill the tank during use, proceed as described previously, and following the instructions in the paragraph "FILLING THE BOILER TANK DURING USE".
- Clean the boiler tank at least once a month so as to eliminate any scale residues that might affect the normal operation of the appliance (see the paragraph "CLEANING AND MAINTENANCE").
- Never use the window wiper brush if the surface to be cleaned is cold; the thermal movement could cause the surface to break, In cold seasons, where the temperature is particularly low, pre-heat the glass with steam jets, all over, from a distance of about 40 cm.
- When using for the first time or after a long pause, direct the steam jet into a container to eliminate any excess water.
- Do not threaten the safety of the appliance by using parts that are not original or which have not been approved by the manufacturer.
- Unplug the appliance by gripping the plug firmly and pulling it out of the power socket; never unplug the appliance by pulling on the power cord.
- Any changes to this product not expressly authorised by the manufacturer may make safety devices inoperative and will also render the user's warranty null and void.



Description of the appliance

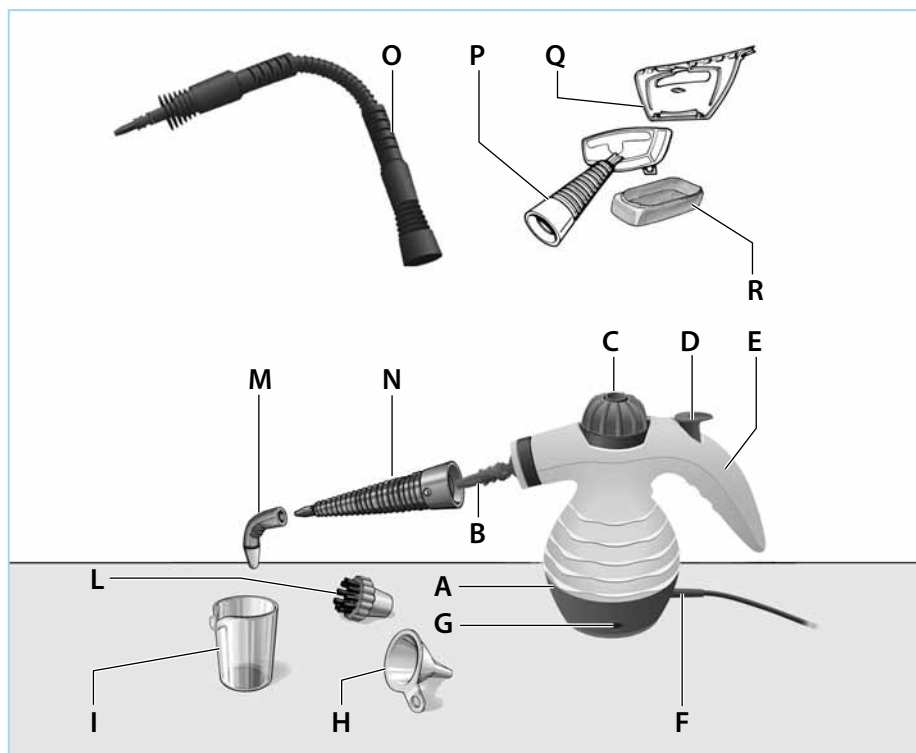

DESCRIPTION OF THE APPLIANCE

A	Appliance body
B	Articulated steam nozzle
C	Safety cap
D	Steam push button
E	Handle
F	Power cord
G	Warning Light

ATTACHMENTS

H	Funnel
I	Measuring cup
L	Round brush
M	Bent nozzle
N	Straight nozzle
O	Flexible pipe
P	Brush for fabrics
Q	Glass wiper
R	Cloth
	Instruction manual

Instructions for use

How to fill the boiler tank before use

NEVER UNSCREW THE BOILER TANK CAP UNLESS YOU ARE SURE THAT THE APPLIANCE HAS BEEN UNPLUGGED FROM THE OUTLET.

Unscrew the safety cap (C) and overturn the boiler tank to drain it completely.

Fill the boiler with water using the relevant measuring cup (I) and funnel (H) provided (fig.1).

The boiler has a capacity of 250 ml and therefore the measuring cup needs to be filled twice: the first to 175 ml and the second to 75 ml.

Screw the safety cap (C) on again.



How to start the appliance

Insert the plug attached to the power cord into the outlet. The warning light (G) will go on.

Steam will be ready after about 3 to 4 minutes. Press button (D) to release steam.

Application of the attachments

Straight nozzle:

- a) slide the accessory as far as the stop so that the nozzle reference slot and the white slot on the appliance meet up (Figure 2);
- b) turn in a clockwise direction until the mark on the nozzle is perfectly aligned with the two lines on the appliance's body. Now the attachment is blocked in the central position.

The appliance is provided with an articulated joint which allows the jet of steam to be directed as desired:

insert the straight nozzle until it covers the red round gasket. Bring the nozzle reference line to meet the white slot on the appliance (Figure 2).

Turn in a clockwise direction until the mark on the nozzle is perfectly aligned with the two lines on the appliance's body. Now you can direct the jet of steam as desired (Figure 3).

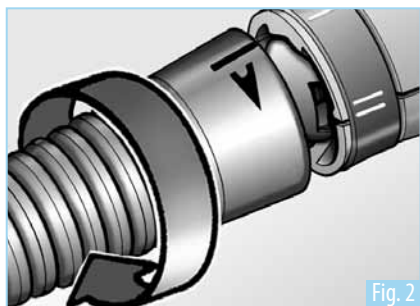

Fig. 2

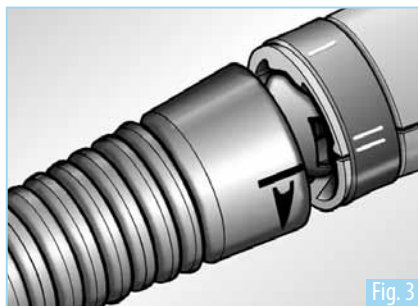

Fig. 3

Application of the attachments

Round brush and bent nozzle:

Both these attachments can be applied to the straight nozzle (Figure 4 and 5) and the articulated nozzle (Figure 6 and 7). Apply them to the hexagonal end and then choose the desired angle.

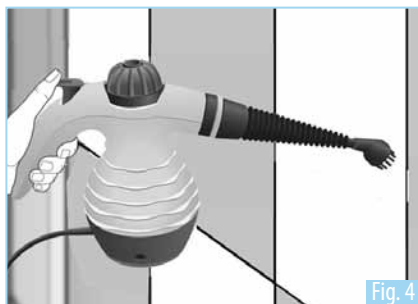

Fig. 4

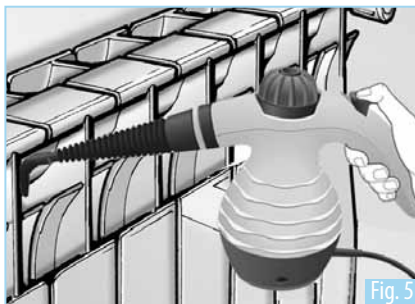

Fig. 5



Fig. 6

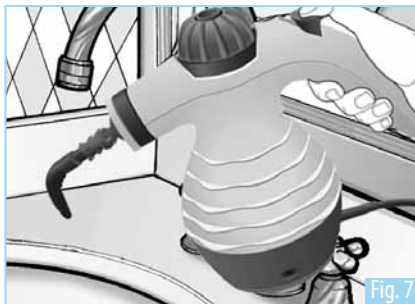

Fig. 7

Filling the boiler tank during use

Flexible pipe, brush for fabrics and glass wiper:

The flexible pipe (O) must be attached to the articulated nozzle (B). Then apply the round brush (L), the bent nozzle (M) the straight nozzle (N) and then the brush for fabrics (P) to the hexagonal end on the pipe.

The brush for fabrics is provided with a cloth that can be used for the cleaning of delicate surfaces such as sofas and armchairs, and with a glass wiper to be fitted as shown in figure 8.

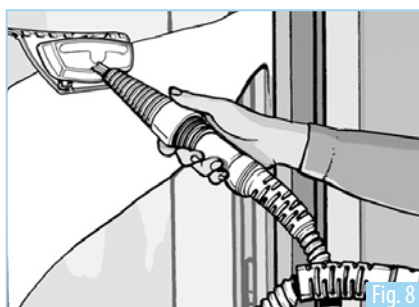

Filling the boiler tank during use

When the water in the boiler tank has run out and you press the button (D) no steam will come out. To refill, carry out the following operations:

- unplug the appliance;
- wait for about 10 seconds;
- carefully unscrew the safety cap (C). Before unscrewing it completely wait for the hissing noise created by residual steam to stop;
- unscrew the cap completely and slowly pour a measuring cup of water into the boiler using the funnel (H). Take care not to let any water flow out of the tank during this operation;
- retighten the safety cap;
- insert the plug into the outlet.

Cleaning and maintenance

Unplug the appliance from the outlet before carrying out any operation.

Let the appliance cool down completely before putting it away or cleaning it.

To ensure appliance's best performance and long life, rinse out the boiler every month to remove any scale deposits.

Do not use vinegar or other descaling agents.

Storing the appliance

Leave the appliance to cool completely before storing.

Empty the boiler tank and put away the appliance with the boiler open.

Store the appliance in a clean, dry place, out of reach of children.

Disposal

Packaging

The product is packaged using recyclable materials, which must be disposed of in the proper containers.

Electronic equipment

Do not dispose of electronic equipment in normal household waste.

Compliant with EU directive 2002/96/EC, at the end of its useful life, the appliance must be disposed of in a suitable manner. This will make it possible to re-use recyclable material, limiting the impact on the environment.

Dispose of the appliance at a collection centre for electrical waste or a recycling centre.

For more information, please contact your local disposal company or local authority.

HAND HELD STEAM CLEANER

Your details:

Name _____

Address _____



E mail _____

Date of purchase* _____

* We recommend you keep the receipt with this warranty card

Location of purchase _____

Description of malfunction:

Return your completed warranty card to:

GB
Home-tek Europe Limited
Roe Head House
Far Common Road
Mirfield
West Yorkshire
WF14 0DQ
England
HELPLINE 08452-100888

IRE
Kenny Distributors
Sragh Business Park
Tullamore Co. Offaly
Ireland
HELPLINE 00353(0)579324910

AFTER SALES SUPPORT



GB 08452 100888



00353 (0) 579324910



www.aldi.com

MODEL: 4122, 08/13, 90641

3

YEAR WARRANTY

