

boil dry protection

- If the airpot runs out of water it will boil dry. The boil dry indicator will flash and the unit will beep 3 times.  
If the user presses the “re-boil” before adding water, the boil dry indicator will light up continuously and the unit will keep 3 times again.
- Add cold water immediately.
- Allow to cool down before pressing reboil button to start boiling

**Note : if the airpot is allowed to boil dry excessively, the inner tank may change colour permanently due to high temperature.**

care & cleaning

**Before cleaning :** unplug from power and allow to cool , remove lid and empty any water

to clean the exterior

- wipe with a damp cloth and mild detergent then wipe dry with a soft cloth.
- never use any chemicals, steel wool or abrasive cleaners to clean the exterior of the appliance.

to clean the internal filter

- remove and clean with warm water and a soft brush. If necessary use some citric acid.  
**Ensure the internal filter is replaced before re-using the airpot.**

to clean the interior

- Clean regularly with a sponge or damp cloth.
- Dry with a soft cloth.
- The interior can become discoloured because of deposits of limescales and particles after prolonged use. This is not harmful to health but may be cleaned as follows :
  1. Make sure the internal filter is clean and installed
  2. Fill with water, adding 30g of citric acid.
  3. Press and hold the reboil button for 3 seconds.
  4. During cleaning the 98°C, 90°C & 80°C lights will flash alternately.
  5. When cleaning is finished all 3 lights will stay on.
  6. Press the dispense button to remove as much water as possible.
  7. Disconnect from power and allow to cool. Empty all remaining water.  
**It is recommended** that the airpot is then refilled, boiled and emptied again.
  8. Wash the interior with a sponge or damp cloth, rinse, then dry with a soft cloth.

**Note :** do not use detergent to wash the interior of the airpot as an aftertaste or frothing may occur, requiring rinsing out several times.

service and customer care

- if the cord is damaged it must, for safety reasons, be replaced by KENWOOD or and authorised KENWOOD repairer.

If you need help with:

- using your airpot or
  - servicing or repairs (in or out of guarantee)
- contact the Kenwood distributor or your authorised Kenwood repairer.  
Have your model number ready - it's on the underside of the airpot.

troubleshooting

PROBLEM	CAUSE	REMEDY
No power.	Loose power connection.	Check connection at the unit and socket.
Cannot switch to boil/reboil.	Water level is too low.	Add water.
Water cannot be dispensed or not dispensing smoothly.	No power.	Check power connection.
	Unit just finished boiling and air bubbles are trapped inside.	Open lid to release air. Close lid.
	Interior is dirty.	Clean.
Water flowing out from unit.	Stated as Full or Maximum.	Do not add water above FULL.
White residues in water.	Mineral deposits (not a defect of the unit).	Clean with Citric Acid.
Boiling sound is excessively loud.	Interior is dirty and filter blocked.	Clean with Citric Acid.

KENWOOD

AP780 series

instructions

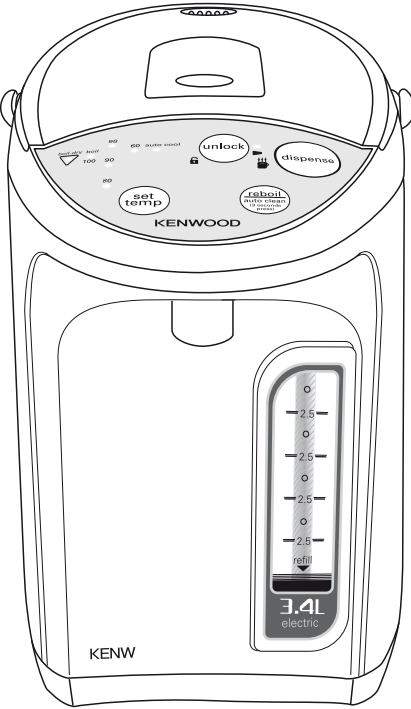

HEAD OFFICE: Kenwood Limited, 1-3 Kenwood Business Park, New Lane, Havant, Hampshire PO9 2NH

kenwoodworld.com

KENWOOD  
CREATE MORE

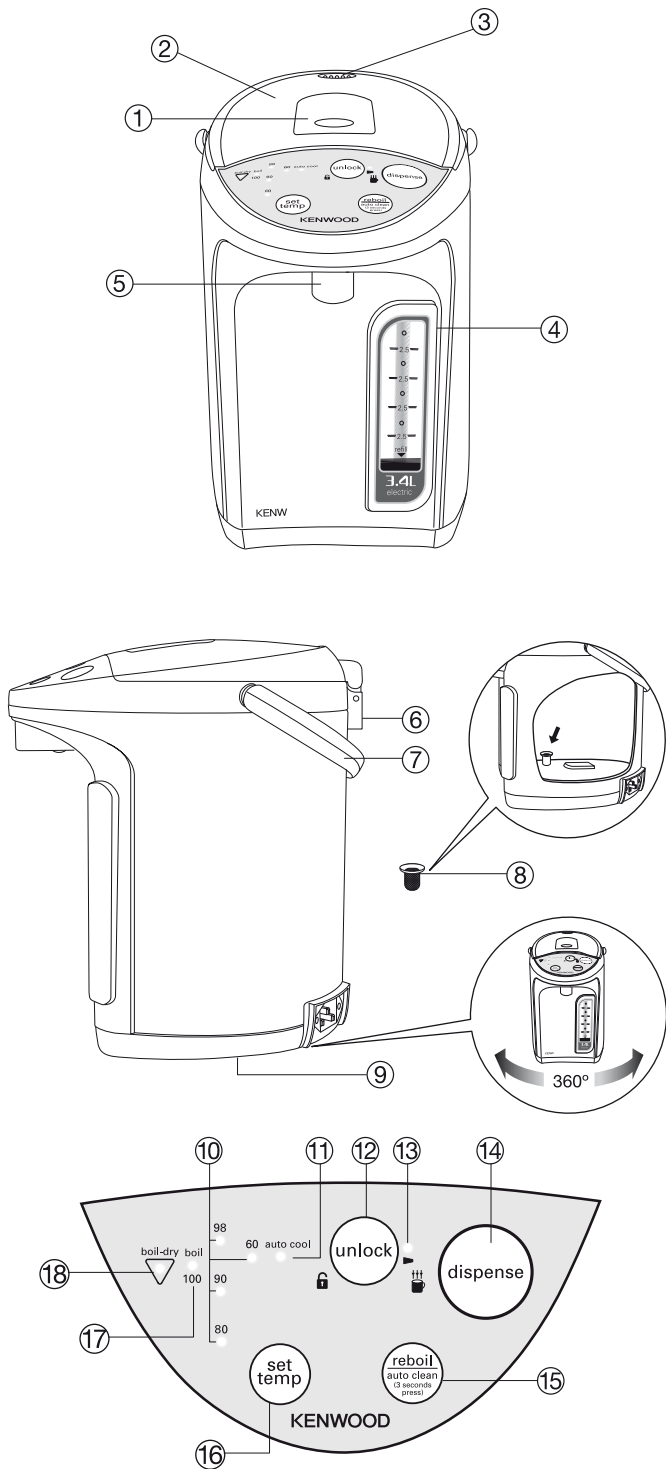

## your new Kenwood airpot

### safety

- Avoid contact with steam coming out from the airpot steam vent; or from under the lid if it is lifted; or from near the water outlet.
- **This appliance is not intended for use by persons (including children) with reduced physical, sensory or mental capabilities, or lack of experience and knowledge, unless they have been given supervision or instruction concerning use of the appliance by a person responsible for their safety.**
- Young children should be supervised to ensure that they do not play with the appliance.
- If the supply cord is damaged, it must be replaced by the manufacturer or its service agent or a similarly qualified person in order to avoid a hazard.
- **Always unplug your airpot from the power outlet when not in use.** Unplug and allow to cool before cleaning and before removing or replacing the lid.
- **Do not move the airpot if it contains hot water. Allow to cool before emptying or cleaning the airpot.**
- Always attach the power cord to the airpot first, then plug the cord into the wall outlet. Disconnect by removing the plug from the wall outlet.
- Always use the airpot on a flat, stable and heat resistant surface.
- Do not use the airpot outdoors.
- Never overfill – boiling water may splash out. Always make sure that the lid is clipped in place during use.
- **Warning :** do not open the lid while water is boiling.
- Keep small children away from the airpot and do not let the power cord hang down over the worktop edge – a child could grab it and pull the airpot down.
- Never immerse the airpot or power cord in water or other liquids.
- Keep the airpot away from hot surfaces such as cookers, hotplates or gas burners.
- Keep hands clear of the hot water coming out from the spout as splashing can occur and the water can continue to come out for a second or two after the dispense pump is turned off.
- This airpot is for boiling water only.
- This airpot is for domestic use only.
- **Note :** the reboil switch cannot be switched off manually. It will reset after boiling.

### before plugging in

- Make sure your electricity supply is the same as the one shown on the underside of your kettle.

### Important - UK only

- The wires in the cord are coloured as follows:  
Green and Yellow = Earth, Blue =Neutral, Brown = Live.  
Warning: this appliance must be earthed.
- This appliance conforms to EC directive 2004/108/EC on Electromagnetic Compatibility.

### before using for first time

- Remove all packaging and any labels.
- Clean the airpot by following “care & cleaning” section.
- **Note : check that the pump filter is correctly fitted in the base of the inner pot.**

## know your Kenwood airpot

- |                              |                              |
|------------------------------|------------------------------|
| ① latch                      | ⑩ keep warm temp. indicators |
| ② lid                        | ⑪ auto-cool indicator        |
| ③ steam outlet               | ⑫ unlock button              |
| ④ water level indicator      | ⑬ unlocked indicator         |
| ⑤ water outlet & night light | ⑭ dispense button            |
| ⑥ release catch              | ⑮ reboil/auto button         |
| ⑦ handle                     | ⑯ temp set button            |
| ⑧ internal filter            | ⑰ boil indicator             |
| ⑨ turntable (underneath)     | ⑱ boil dry indicator         |

## to use your airpot

- **Note :** whenever the airpot is unlocked, the operation light will be on; which will help in pouring particularly at night.

### General

1. Open the lid by releasing the catch.
2. Fill water to the “FULL” line on the inside. **Do not overfill.**
3. Close the lid until you hear it ‘click’ shut.
4. Attach the power cord to the airpot and then plug into the wall outlet. There will be a beep, the airpot will automatically start to heat the water and the ‘boil’ indicator light will be on. The 98°C indicator light will flash because after boiling the airpot will keep warm at 98°C unless another temperature is selected.
5. For hot water after boiling or at any time while at the set temperatures press the dispense button.
6. Before re-boiling, make sure the water level is above the “refill” mark. Press the “reboil” button. A beep will sound, and the boil indicator will be illuminated, the temperature indicator will flash and the airpot will bring the water back to boiling.
7. After boiling, the water will cool to the set temperature which the airpot is set at, there will be 9 beeps and the temperature light will be on; and then the water will be kept at that temperature.

- **Do not open the lid** during the boiling process.
- **Do not touch** the steam outlet.

### the lid

- To open the lid : lift up the top of the latch until it unclips, continue lifting to open.
- To close the lid : push it down until it clicks shut.

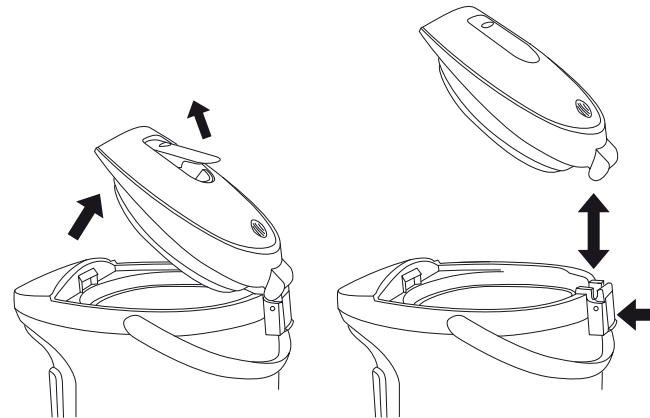

- To remove the lid : push in the release catch at the rear of the airpot; lift the latch until the lid is at 45°, the lid will now lift away from the body of the airpot.
- To replace the lid : push the release catch in; lower the lid hinge into the body of the airpot and release the catch. Now close the lid until the latch clicks shut.

### dispensing water

- Water cannot be dispensed by the electric pump if the unit is locked.
- Hold the cup under the dispensing spout.
- Before dispensing, press the unlock button. The indicator light will come on to show it is unlocked. Press the dispense button and keep pressed until the required amount of water is dispensed.
- After dispensing, the electric lock will automatically come on again after 15 seconds.
- If water does not dispense smoothly, cleaning may be needed – refer to the “care & cleaning” section.
- **Do not turn or move the airpot while dispensing water.**

### setting temperature

- Press the temp set button until the indicator light for the desired temperature flashes.
- **Note :** if the setting is changed to a higher temperature, the water will reboil and then cool to the new temperature.
- Auto cool setting. The water will cool to room temperature.
- The automatic temperature setting is 98°C. If the power is disconnected, when it is reconnected the airpot will reboil and then cool to 98°C.