

Ariete

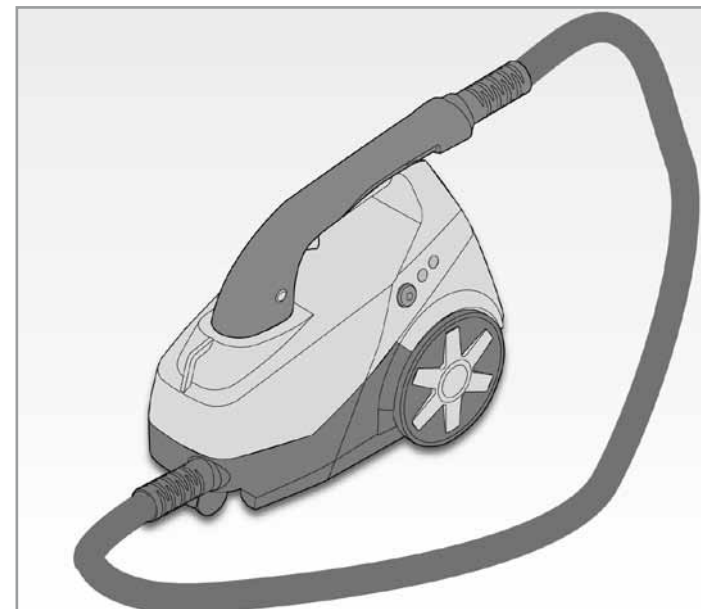

MULTI STEAMER

Ariete

Distributed by Tempo (Aust) Pty Ltd
PO Box 6056, Frenchs Forest DC 2086

After Sales Support:
1300 886 649
info@tempo.org



4203

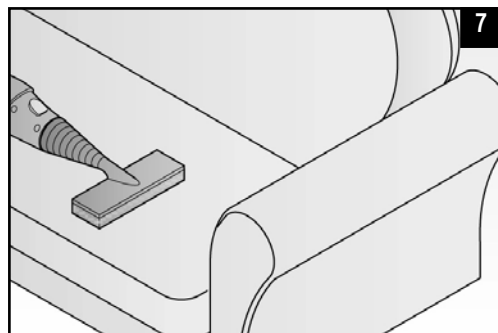
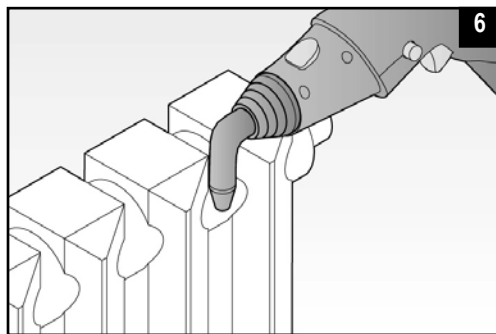
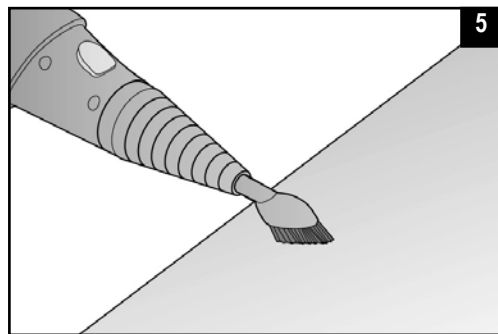
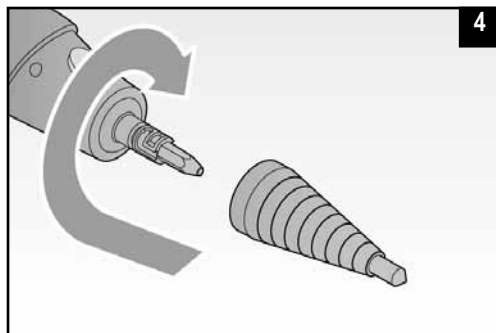
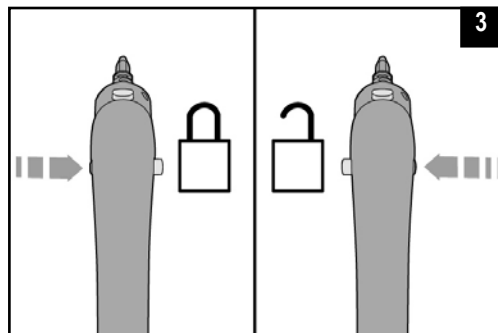
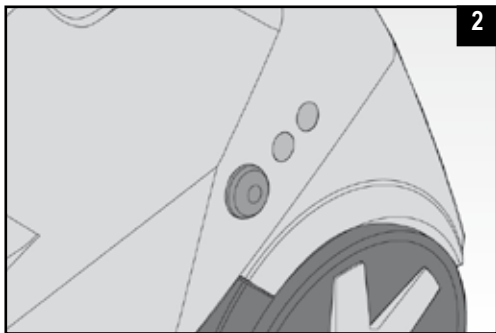
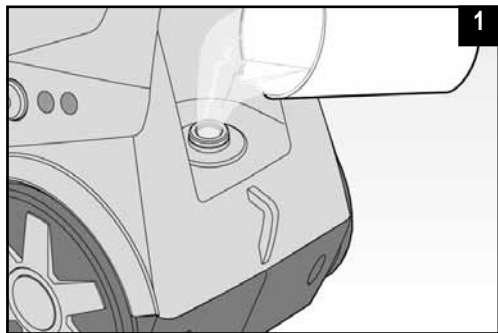

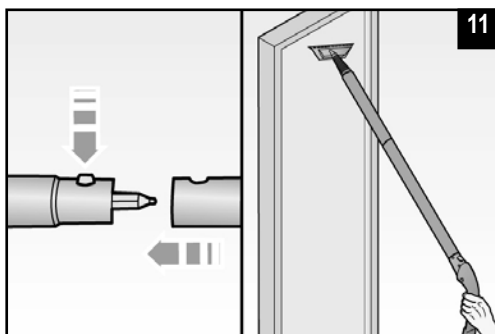

EN

SYMBOLS

The information in this manual is labelled as follows:

SYMBOL	DESCRIPTION
	DANGER for children
	DANGER from electricity
	DANGER from other causes
	WARNING danger of scalding
	IMPORTANT possible damage to materials

IMPORTANT SAFEGUARDS

READ THESE INSTRUCTIONS BEFORE USE.

DO NOT THROW AWAY THESE INSTRUCTIONS.



DANGER to children



- This appliance is not suitable for use by people – including children – with reduced physical, sensorial or mental capabilities; by people with little or no experience or awareness of the appliance, unless carefully supervised or trained in the use of the appliance by a person responsible for their safety.
- It is necessary to supervise children to make sure that they do not play with the appliance.
- When disposing of the appliance as waste, it must be made inoperative by cutting off the power cord. Also remember to make any parts of the potentially hazardous parts of the appliance safe, as there is a risk that children may use them as playthings.
- Packaging elements must not be left in reach of children as they are potentially hazardous.



DANGER from electricity



- Make sure that the power voltage of the appliance corresponds to that of your mains electricity.
- Always connect the appliance to a properly earthed socket.
- In case of using extension leads, these must be suitable for the appliance power to avoid danger to the operator and for the safety of the environment in which the appliance is being used. Extension leads, if not suitable, can cause operating anomalies.
- Never leave the appliance unattended when it is connected to the power mains; unplug it after every use.
- Always switch off the appliance at the main switch and unplug it from the power mains before refilling it.
- Make sure that hands are dry before using or adjusting the appliance switches, before touching the plug or power connections.

- **RCD:** The installation of a residual current device (safety switch) is recommended to provide additional safety protection when using electrical appliances. It is advisable that a safety switch with a rated residual operating current not exceeding 30mA be installed in the electrical circuit supplying the appliance. See your electrician for professional advice.)

DANGER from other causes

- Never leave the appliance exposed to the elements (rain, sunshine, etc.).
- Never place the appliance on or near sources of heat.
- Make sure that the power cord does not come into contact with hot surfaces.
-  Never point steam jets in the direction of people, animals or plants or towards appliances that contain electrical parts (e.g., oven interiors).
- Never direct steam jets onto the appliance itself.
- **Never immerse the body of the appliance, plug or power cord in water or other liquids; clean them with a damp cloth.**
- Never use the appliance if the power cord or plug are damaged or if the appliance is faulty / damaged.
- All repairs, including the replacement of the power cord, must only be carried out by an authorised service centre, so as to prevent any risks.
- This appliance has been designed for **domestic use only** and may not be used for commercial or industrial purposes.
- During use, the appliance contains pressurised steam: improper use can be dangerous. The appliance is designed for domestic use only, as stated in the manual. The manufacturer cannot accept any liability for damage cause through improper or incorrect use of the appliance.
- When the appliance is not in use, always lock the steam dispensing button with the special cursor.

WARNING danger of scalding

- If the steam button is pressed before the boiler has reached the optimum temperature, then water instead of steam could come out of the nozzle.

- Never touch hot surfaces while using the product. Leave attachments to cool before replacing them.
- **Even when the appliance is not in operation, unplug it from the power mains and leave it to cool before inserting or removing single parts or before cleaning it.**
-  **IMPORTANT:** danger of scalding.
- **NEVER OPEN THE CAP ON THE BOILER TANK DURING USE.**
- **IMPORTANT:** Before unscrewing the cap on the boiler tank, proceed as follows:
 - ✓ switch off the appliance at the main switch and unplug the power cord from the mains socket;
 - ✓ bleed out the remaining pressure from the boiler tank, using the steam button on the gun and pointing the jet into a suitable container;
 - ✓ leave the appliance to cool for a few minutes;
 - ✓ slowly loosen the boiler tank cap, part of the way and wait for a few seconds;
 - ✓ unscrew the cap completely and remove it.



IMPORTANT possible damage to materials



- Before using the product, make sure that all items, surfaces and fabrics to be cleaned are resistant to or compatible with the high temperature of the steam. Specifically, treated terracotta flooring, wooden surfaces or delicate fabrics, such as silk or velvet, should not be treated without first consulting the instructions from the manufacturer and carrying out a test on a small hidden sample part.
- Never use in swimming pools containing water.
- Never add scale removers, fragrances, alcohols or detergents to the boiler tank, as these could damage the appliance. We recommend filling with tap water or alternatively, with 50% demineralised water and 50% tap water in areas where the water is very hard.
- Before switching on the appliance, make sure that there is sufficient water inside the boiler tank. If it is necessary to refill the tank during use, proceed as described previously, and following the instructions in the paragraph **“FILLING THE BOILER TANK DURING USE”**.
- Clean the boiler tank at least once a month so as to eliminate any scale residues that might affect the normal operation of the appliance (see the paragraph **“CLEANING AND MAINTENANCE”**).

- Never use the window wiper brush if the surface to be cleaned is cold; the thermal movement could cause the surface to break. In cold seasons, where the temperature is particularly low, pre-heat the glass with steam jets, all over, from a distance of about 40 cm.
- When using for the first time or after a long pause, direct the steam jet into a container to eliminate any excess water.
- Do not threaten the safety of the appliance by using parts that are not original or which have not been approved by the manufacturer.
- Unplug the appliance by gripping the plug firmly and pulling it out of the power socket; never unplug the appliance by pulling on the power cord.
- Any changes to this product not expressly authorised by the manufacturer may make safety devices inoperative and will also render the user's warranty null and void.

DESCRIPTION OF THE APPLIANCE

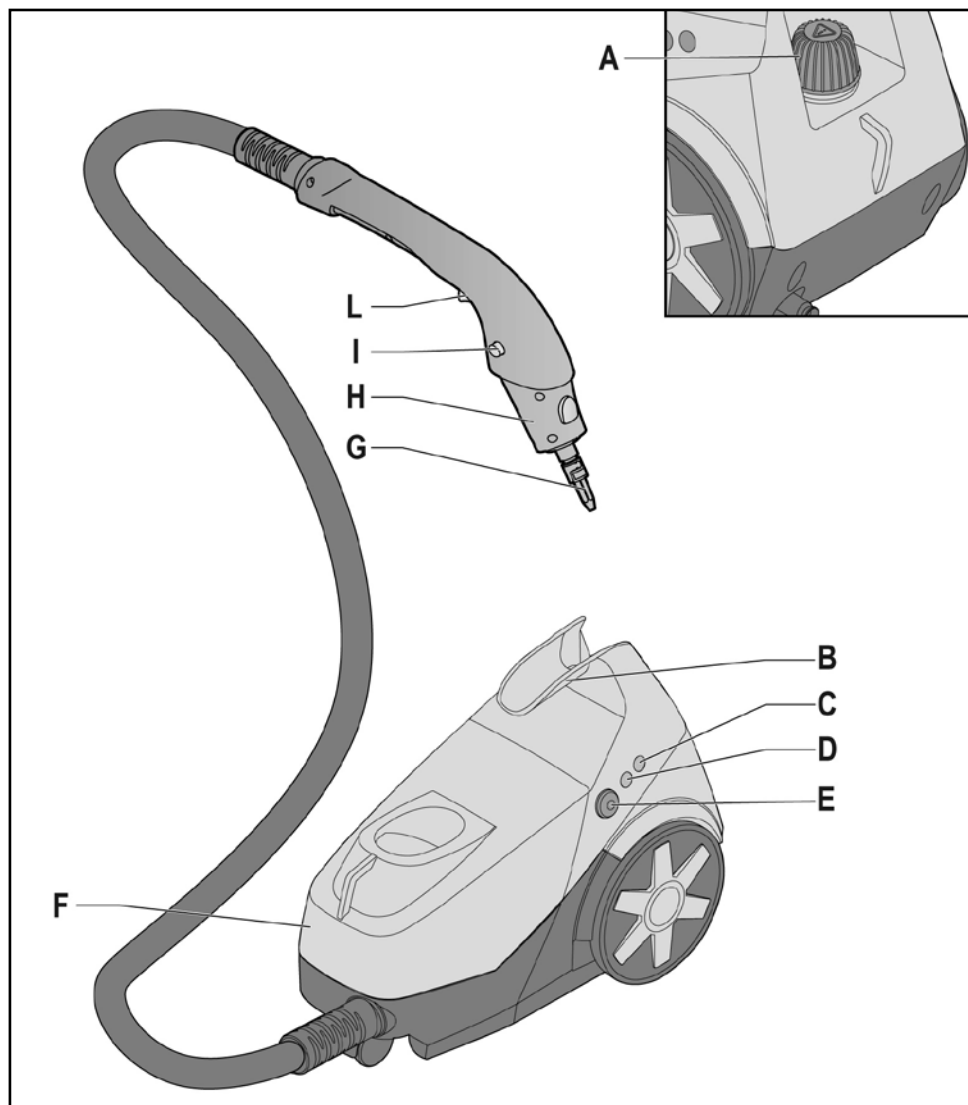

Ref.	Description	Ref.	Description
A	Boiler tank cap	F	Appliance body
B	Handle	G	Gun nozzle
C	Steam ready light	H	Gun
D	On/off light	I	Lock cursor
E	On/off switch	L	Steam dispenser button

DESCRIPTION OF ATTACHMENTS

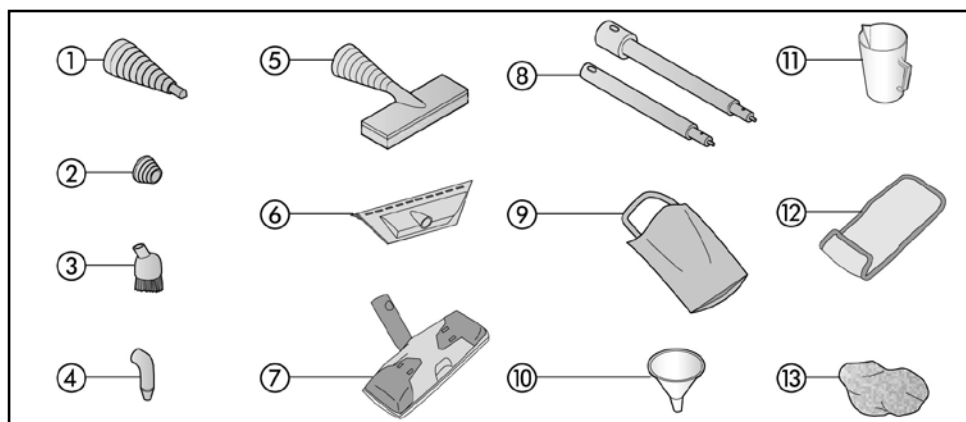

Ref.	Description	Ref.	Description
①	Extension nozzle	⑧	Extension tubes
②	Hood	⑨	Attachment bag
③	Round brush	⑩	Funnel
④	Angled nozzle	⑪	Measure
⑤	Upholstery brush	⑫	Floor cloth
⑥	Window brush	⑬	Upholstery cloth
⑦	Floor brush		

INSTRUCTIONS FOR USE

Filling the boiler tank before use

- Unscrew the boiler tank filler cap (A), and use the funnel (⑩) provided to fill the boiler tank (1).
- Screw on the boiler tank filler cap (A).
- Fit the required attachment to the gun (H) (see the “**ATTACHMENTS**” paragraph).

Switching on

- Plug the appliance power cord into the mains electricity and switch on the appliance using the On/off switch (E); the On/off light (D) will switch on, as will the steam ready light (C) (2).
- After a few minutes, the steam ready light (C) will switch off to show that the boiler tank is pressurised and the appliance can now dispense steam.

Operation

- The steam ready light (C) will switch on and off during use to show that the boiler tank is working.
- To prevent the steam from being dispensed accidentally, the lock cursor (I) must be moved from the left to the right (→); to release the steam function, move the cursor (I) from right to left (←) (3).
- To dispense steam, press the button (L) on the gun (H).
- When using for the first time, it is a good idea to spray the steam jet into a container to get rid of any water residues that might be inside the tube (any water coming out is because of the condensed steam inside the tube). This action needs to be repeated even after a few minutes of appliance inactivity. In any case, when the gun begins to dispense steam, always point the jet downwards to the ground.



IMPORTANT: When the appliance is not being used, always lock the steam dispenser button with the cursor (I).

Switching off the appliance

- To stop dispensing steam, release the dispensing button (L).
- After use, switch off the appliance, using the switch (E) and unplug it from the mains power socket. Clean the attachments and boiler tank as described in the **"CLEANING AND MAINTENANCE"** section.
- Refit the gun (H) over the special handle (B), after placing the slider (I) in the lock position.

ATTACHMENTS

Extension nozzle ①

With this attachment it is possible to thoroughly clean all those surfaces where stubborn dirt can take hold.

The nozzle can be fitted directly to the gun nozzle (G) or extension tubes ⑧: after lining up the marks on the gun nozzle (G) and attachment, turn the nozzle 90° clockwise until it locks into place (4).

Hood ②

This attachment can be fitted to the gun nozzle (G) to protect the end.

Round brush ③

This attachment fits on the extension nozzle ① and helps to dissolve the most stubborn dirt build-up, such as the type that forms on the cooktop or in the grout widths between tiles. It can be used to clean bathroom fixtures, sinks, cooker racks, showers and baths, where it removes all traces of scale (5).

Angled nozzle ④

This attachment can be fitted to the gun nozzle (G) after inserting the cap ② or extension nozzle ①. It is particularly useful for reaching and cleaning difficult areas, where dirt can build up unseen, on radiators, shutters, and bathroom fixtures, removing it simply and quickly (6).

Upholstery brush ⑤

The fabric brush can be fitted straight onto the gun nozzle (G) or to the extension tubes ⑧. When the handy cloth ⑭ is fitted, it is possible to use the brush to remove dust and for daily cleaning of sofas, armchairs, blankets, mattresses and cushions (7). The brush can also be used to freshen up fabrics, removing all creases. In any case, we recommend, when using for the first time and during normal use, to discharge the condensation from the steam into a container so as not to wet the fabrics (8).

Window brush ⑥

A window wiper brush can be fitted to the fabric brush ⑤: to assemble the two, just insert the tabs at the base of the fabric brush into the hooks at the bottom of the window wiper brush. Use the window wiper to restore the polished shine to windows, mirrors and gloss surfaces. It is also easy to use on shower cubicle glass, removing the problem of lime scale (9).

Floor brush ⑦

This accessory is used on extension tubes ⑧ and it has handy cloth grips that can hold, as well as the cloth provided ⑬, any type of machine washable cloth. To fit the cloth, place the brush in the middle, lift the clips at the ends of the brush, insert a flap of cloth and then release the clips (10).

Extension tubes ⑧

The extension tubes snap together and can be easily separated by pressing the release button. They are useful for reaching high surfaces with the window wiper ⑥, using the special extension joint, or they can be used with the floor brush ⑦ (11).

Attachment bag ⑨

The appliance comes with a bag for the attachments, which is handy for storage as well as for keeping them close at hand.

FILLING THE BOILER TANK DURING USE

If the boiler tank should become empty during use, switch off the appliance, unplug it from the mains power and proceed as follows:

- Press the steam dispensing button (L) to discharge any residual steam.
- Slowly unscrew the boiler tank filler cap (A) waiting a few seconds for the steam to finish before unscrewing it completely. Wait a few minutes before adding water to the boiler tank.
- Add more water, making sure to pour it in slowly to prevent new bursts of steam from forming.
- **We recommend waiting at least 3 minutes from the time of unplugging the appliance before adding more water to the boiler tank.**
- Firmly screw the boiler tank filler cap (A) back into place.
- Plug the appliance to the power mains.
- Press the on switch (E).

CLEANING AND MAINTENANCE

Emptying and cleaning the inside of the boiler tank



IMPORTANT: Clean the boiler tank at least once every month so as to remove any scale residues which might affect the normal operation of the appliance.

IMPORTANT: Switch off the appliance, unplug it from the mains power and leave it to cool before cleaning out the boiler tank, so as to avoid the risk of scalds.

- Bleed out any pressure remaining in the boiler tank using the steam button (L) on the gun (H), pointing the jet into a suitable container.
- Slowly unscrew the boiler tank filler cap (A) and remove it completely.
- Fill the boiler tank with tap water, shake the appliance and then turn it upside down to empty it.
- Repeat this operation a few times.



WARNING: Never add scale removers, vinegar or other perfumed substances to the tank, as these risk damaging the appliance with immediate cancellation of the warranty.

TROUBLESHOOTING...

PROBLEM	CHECK	POSSIBLE CAUSES	POSSIBLE REMEDY
No steam comes out of the nozzle	Steam ready light (C) on	Cold boiler tank	Wait for the steam ready light (C) to switch off.
	Steam ready light (C) off	No water in the boiler tank	Fill the boiler tank as described in the paragraph "FILLING THE BOILER TANK DURING USE"
	Steam ready light (C) off – Water in the boiler tank	Malfunction	Contact our Customer Support Centre
The nozzle is dispensing little steam	Steam ready light (C) on	The boiler tank is cold	Wait for the boiler tank to heat up