

# ***Ariete***

by **KENWOOD**

INSTRUCTIONS FOR USE .....2

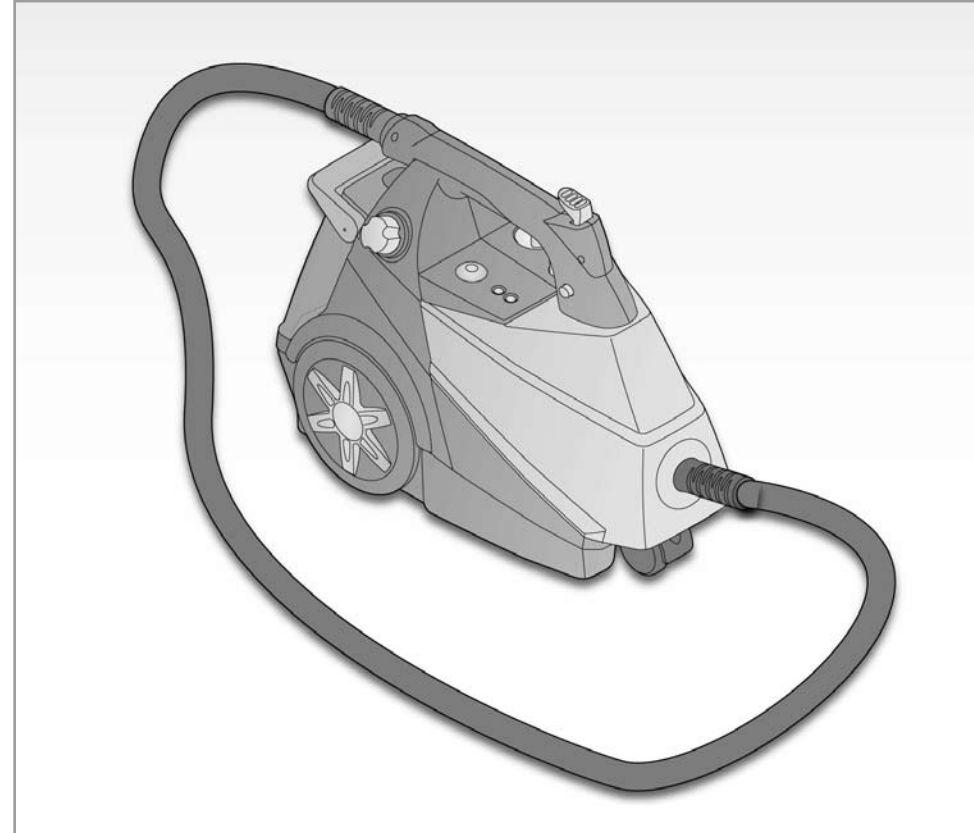

**SG<sub>30</sub>**



***Ariete***  
by **KENWOOD**

De'Longhi Australia Pty Ltd  
ABN 49 104 012 857  
Po Box 4540  
Casula Mall NSW 2170  
Australia  
Phone: 1800 126 659  
Fax: 1800 007 289  
[www.kenwood-australia.com](http://www.kenwood-australia.com)

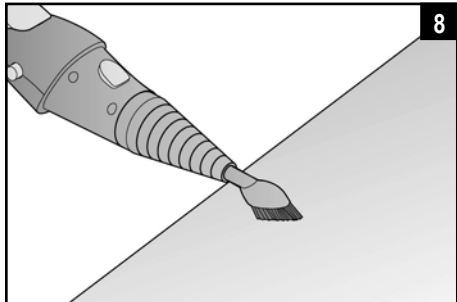
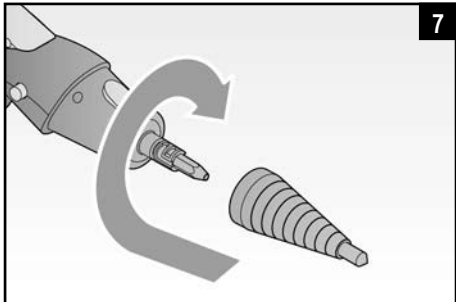
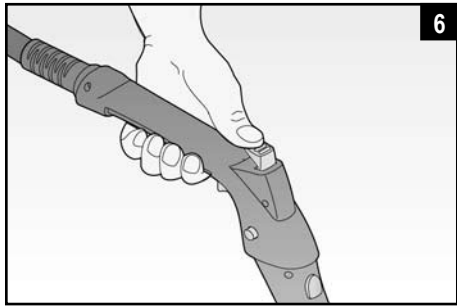
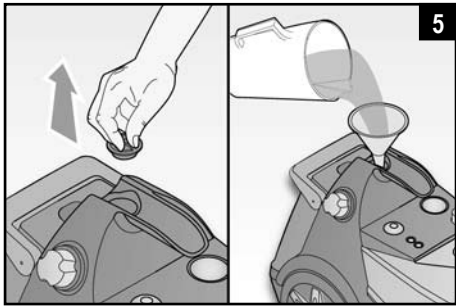
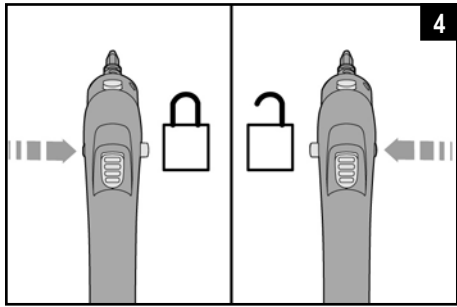
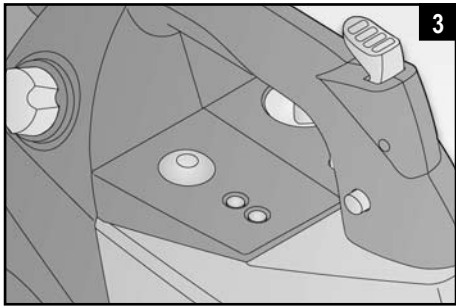
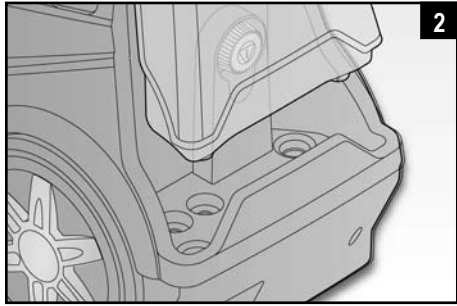
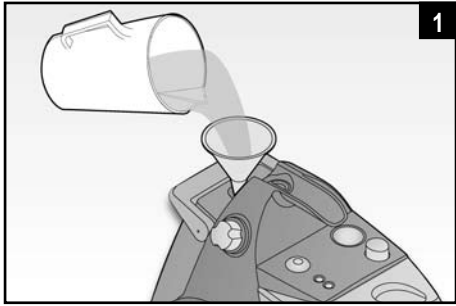
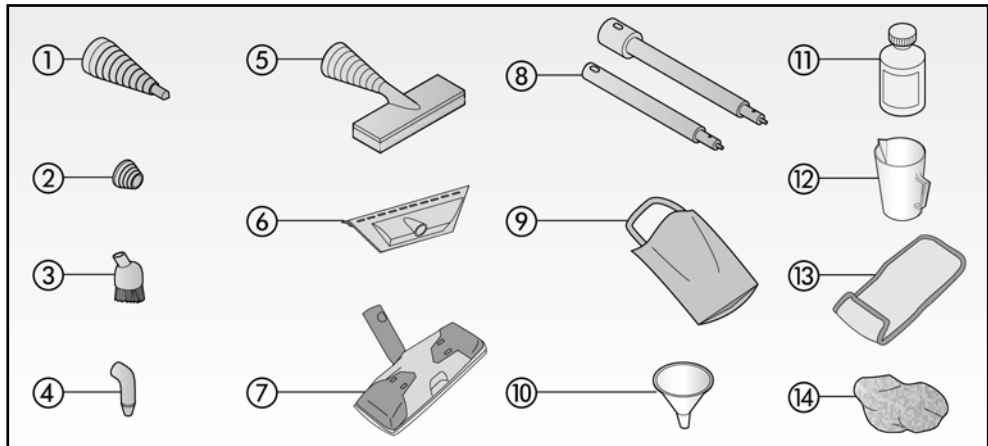
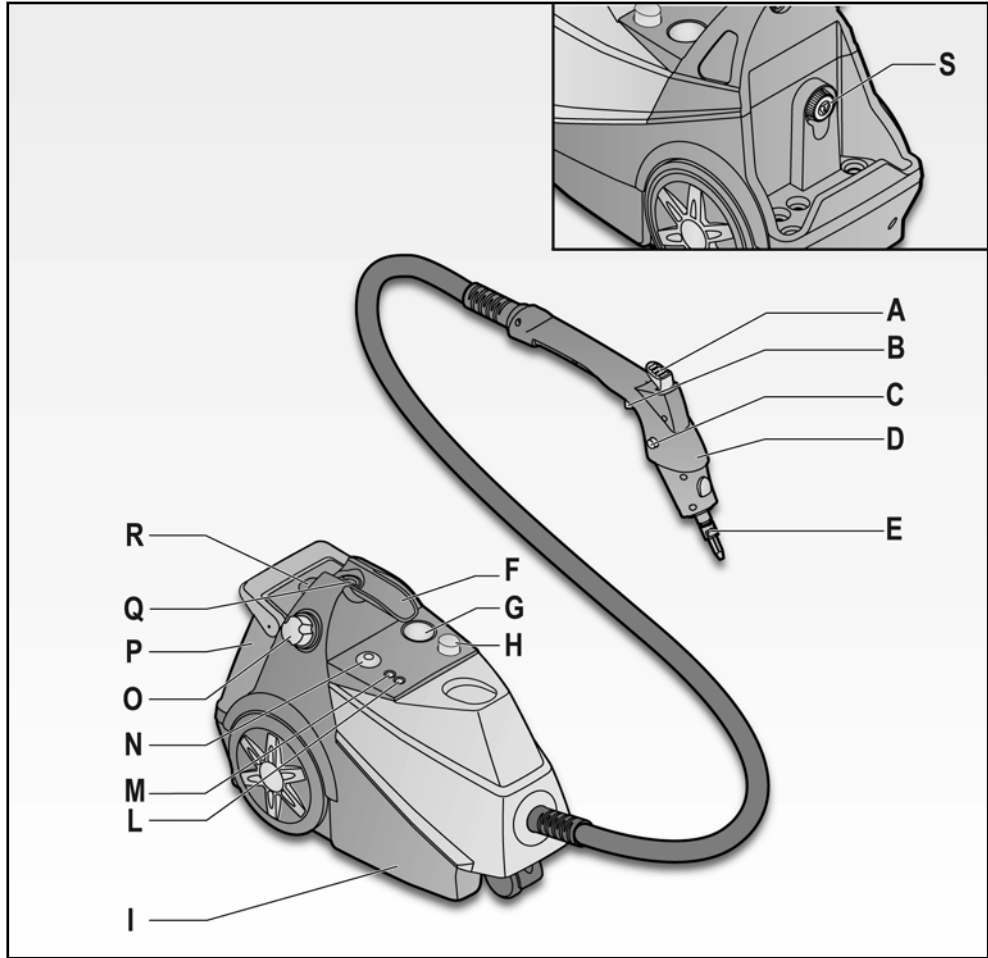

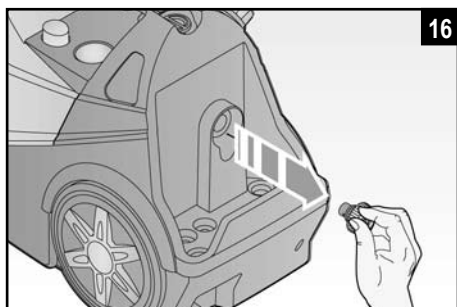
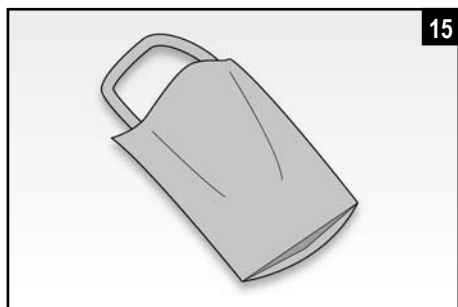
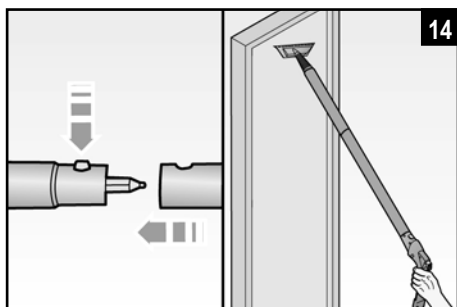
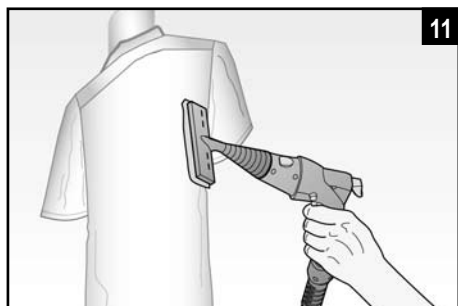
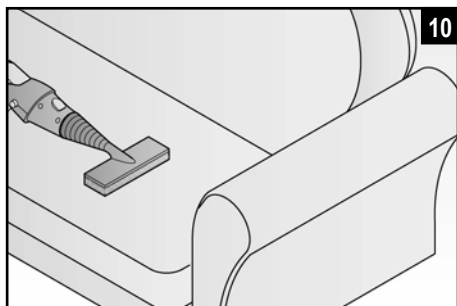
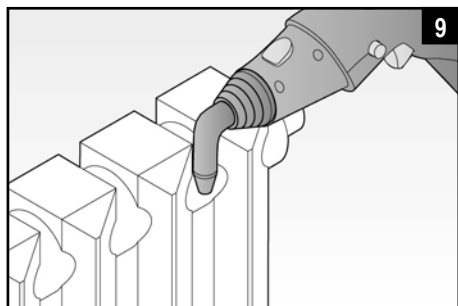

---

**CONTENTS**

---

SYMBOLS .....	3
IMPORTANT SAFEGUARDS .....	3
DESCRIPTION OF THE APPLIANCE .....	5
DESCRIPTION OF ATTACHMENTS .....	6
INSTRUCTIONS FOR USE .....	6
Filling the boiler tank before use .....	6
Switching on .....	6
Operation .....	6
Steam jet regulation .....	7
Switching off the appliance .....	7
USING WITH DETERGENT .....	7
ATTACHMENTS .....	7
FILLING THE WATER TANK DURING USE .....	8
CLEANING AND MAINTENANCE .....	8
Emptying the water tank .....	8
Emptying and cleaning the detergent reservoir .....	8
Emptying and cleaning the inside of the boiler tank .....	9
TROUBLESHOOTING .....	9

## SYMBOLS

The information in this manual is labelled as follows:



DANGER for children



DANGER from electricity



DANGER from other causes



WARNING danger of scalds



IMPORTANT possible damage to materials



Use with detergent

## IMPORTANT SAFEGUARDS

**READ THESE INSTRUCTIONS BEFORE USE.**

**DO NOT THROW AWAY THESE INSTRUCTIONS.**

This appliance conforms to the Directives 2006/95/EC and EMC 2004/108/EC.



**DANGER to children**



- This appliance is not suitable for use by people – including children – with reduced physical, sensorial or mental capabilities; by people with little or no experience or awareness of the appliance, unless carefully supervised or trained in the use of the appliance by a person responsible for their safety.
- It is necessary to supervise children to make sure that they do not play with the appliance.
- When disposing of the appliance as waste, it must be made inoperative by cutting off the power cord. Also remember to make any parts of the potentially hazardous parts of the appliance safe, as there is a risk that children may use them as playthings.
- Packaging elements must not be left in reach of children as they are potentially hazardous.
- The detergent used for this appliance must be kept well out of reach of children.
- Always follow the instructions on the detergent label before use.



**DANGER from electricity**



- Make sure that the power voltage of the appliance corresponds to that of your mains electricity.
- Always connect the appliance to a properly earthed socket.
- In case of using extension leads, these must be suitable for the appliance power to avoid danger to the operator and for the safety of the environment in which the appliance is being used. Extension leads, if not suitable, can cause operating anomalies.
- Never leave the appliance unattended when it is connected to the power mains; unplug it after every use.

- Always switch off the appliance at the main switch and unplug it from the power mains before refilling it.
- Never allow the detergent sprayed from the appliance to come into contact with power sockets and/or other electrical appliances or wires.
- Make sure that hands are dry before using or adjusting the appliance switches, before touching the plug or power connections.



## **DANGER from other causes**



- Never leave the appliance exposed to the elements (rain, sunshine, etc.).
- Never place the appliance on or near to sources of heat.
- Make sure that the power cord does not come into contact with hot surfaces.
-  Never point steam jets in the direction of people, animals or plants or towards appliances that contain electrical parts (e.g. oven interiors).
- Never direct steam jets onto the appliance itself.
- **Never immerse the body of the appliance, plug or power cord in water or other liquids; clean them with a damp cloth.**
- Never use the appliance if the power cord or plug are damaged or if the appliance is faulty / damaged.
- All repairs, including the replacement of the power cord, must only be carried out by an Kenwood Assistance Centre or by technicians authorised by Kenwood, so as to prevent any risks.
- This appliance has been designed for **domestic use only** and may not be used for commercial or industrial purposes.
- During use, the appliance contains pressurised steam : improper use can be dangerous. The appliance is designed for domestic use only, as stated in the manual. The manufacturer cannot accept any liability for damage cause through improper or incorrect use of the appliance.
- When the appliance is not in use, always lock the steam dispensing button with the special cursor.



## **WARNING danger of scalds**



- If the steam button is pressed before the boiler has reached the optimum temperature, then water instead of steam could come out of the nozzle.
- Never touch hot surfaces while using the product. Leave attachments to cool before replacing them.
- **Even when the appliance is not in operation, unplug it from the power mains and leave it to cool before inserting or removing single parts or before cleaning it.**
-  **IMPORTANT:** danger of scalds

NEVER OPEN THE SAFETY CAP DURING USE.

- IMPORTANT:**
- Before unscrewing the safety cap, proceed as follows:
    - ✓ unplug the appliance from the mains power socket;
    - ✓ slowly unscrew the safety cap and wait a few seconds before unscrewing it fully.



## **IMPORTANT possible damage to materials**



- Your Kenwood Steam Cleaner is also ideal for ceramic, marble, vinyl, linoleum and sealed hardwood floors.
- Warning: DO NOT use on sealed wood floors, or timber floors in high traffic areas where the protective coating may have worn out. DO NOT leave the mop in one spot during use or while hot for more than 15 seconds, this could cause the wood grain to rise. When using on surfaces treated with wax, the wax may be removed by the heat and steam action. It is recommended to try the appliance on a small inconspicuous area before use and refer to care instructions from the flooring manufacturer.
- Not recommended for use on CORK or CORK tiles.
- Kenwood will not accept any responsibility for damage caused to flooring if the above warnings have been ignored.
- Never use in swimming pools containing water.

- Never add scale removers, fragrances, alcohols or detergents to the boiler tank, as these could damage the appliance. We recommend filling with tap water or alternatively, with 50% demineralised water and 50% tap water in areas where the water is very hard.
- Never use the appliance if there is no water in the boiler tank as this could damage the pump.
- Before switching the appliance on or off, make sure that there is enough water inside the tank (P). If it is necessary to fill the tank during use, proceed as described previously, including the instructions in the section **"FILLING THE WATER TANK DURING USE"**.
- If using the measure and/or funnel with detergent, always clean them thoroughly before using them to fill the boiler tank.
- The detergent must only be used in small amounts and only for particularly stubborn stains; excessive amounts could damage the surfaces to be treated. Normal cleaning only requires the steam issued from the appliance. Never, under any circumstances, use cleaning agents containing the following: chlorine, solvents, ammonia or substances marked with an **"X"** . Always ventilate the area after using cleaning agents.
- Clean the boiler tank at least once a month so as to eliminate any scale residues that might affect the normal operation of the appliance (see the paragraph **"CLEANING AND MAINTENANCE"**).
- Never use the window wiper brush if the surface to be cleaned is cold; the thermal movement could cause the surface to break. In cold seasons, where the temperature is particularly low, pre-heat the glass with steam jets, all over, from a distance of about 40 cm.
- When using for the first time or after a long pause, direct the steam jet into a container to eliminate any excess water.
- Do not threaten the safety of the appliance by using parts that are not original or which have not been approved by the manufacturer.
- Unplug the appliance by gripping the plug firmly and pulling it out of the power socket; never unplug the appliance by pulling on the power cord.
- Any changes to this product not expressly authorised by the manufacturer may make safety devices inoperative and will also render the user's warranty null and void.

## DESCRIPTION OF THE APPLIANCE

Ref.	Description	Ref.	Description
A	Detergent dispenser button	L	On/off light
B	Steam dispenser button	M	Steam ready light
C	Lock cursor	N	On/off switch
D	Gun	O	Steam dispenser dial
E	Gun nozzle	P	Water tank
F	Handle	Q	Detergent filler cap
G	Pressure gauge	R	Tank cap
H	Cord rewinder button	S	Water filler cap
I	Appliance body		

## DESCRIPTION OF ATTACHMENTS

Ref.	Description	Ref.	Description
①	Extension nozzle	⑧	Extension tubes
②	Hood	⑨	Attachment bag
③	Round brush	⑩	Funnel
④	Angled nozzle	⑪	Detergent bottle
⑤	Upholstery brush	⑫	Measure
⑥	Window brush	⑬	Floor cloth
⑦	Floor brush	⑭	Upholstery cloth

## INSTRUCTIONS FOR USE

### Filling the boiler tank before use

- Remove the cap (R) from the tank (P) and fill it with water, taking care not to exceed the "MAX" level on the tank (1).
- The tank (P) can be removed by pulling it out by the handle and it can be filled with mains water, even directly from the tap.
- Then refit the tank (P), taking care that the bottom valves meet up with the pins in the seat of the appliance. Press the tank down until it is completely inserted and make sure it has been correctly fitted (2).
- Press in the cap (R).
- Fit the required tool (see the "ATTACHMENTS" paragraph) to the gun (D) and only if strictly necessary (e.g. stubborn stains), insert the detergent following the instructions in the paragraph "USING WITH DETERGENT".



**IMPORTANT:** Never use the appliance without water in the tank as this could damage the pump.



**IMPORTANT:** The tank has a safety cap (S) on the back, which can be seen once the tank has been taken out. The safety cap serves as a valve which, in the event of malfunctioning caused by excess pressure in the boiler tank, will open to allow steam to come out. In this case, the appliance will no longer be able to dispense steam.

### Switching on

- Plug the appliance into a mains socket and press the on/off switch (N); the red light (L) will switch on (3).
- After a few minutes, the green light (M) will switch on to show that the steam is ready, meaning that the tank is pressurised and that the appliance is ready to dispense steam.

### Operation

- The boiler tank is supplied automatically via a pump that switches on for a few seconds every time the appliance is filled, generating normal operation noise (vibration). Immediately after the pump has switched on, there may be a drop in steam dispensing but, after a few seconds, steam dispensing will return to normal.
- The steam ready light (M) switches on and off during use, which shows that the boiler tank is operating.
- To prevent the steam from being dispensed accidentally, the lock cursor (C) must be moved from the left to the right (A); to release the steam function, move the cursor (C) from right to left (A) (4).
- To dispense steam, press the button (B) on the gun (D).
- When using for the first time, it is a good idea to spray the steam jet into a container to get rid of any water residues that might be inside the tube (any water coming out is because of the condensed steam inside the tube). This action needs to be repeated even after a few minutes of appliance inactivity. In any case, when the gun begins to dispense steam, always point the jet downwards to the ground.



**IMPORTANT:** When the appliance is not used, always block the steam button (B) using the relevant cursor (C).



## Steam jet regulation

- Use the dial (O), to regulate the amount of steam dispensed, from a minimum to a maximum, based on cleaning needs and on the type of surface or upholstery being cleaned.
- Reduce the pressure for delicate surfaces and fabrics.

## Switching off the appliance

- Do not use the dial (O) to stop dispensing steam; release the dispenser button (B).
- The appliance has a pressure gauge (G) to show the pressure of the steam inside the boiler tank.
- At the end of use, switch off the appliance, pressing the switch (N), remove the plug and rewind the power cord by holding down the rewind button (H) on the appliance. The power cord will rewind inside the container.



**IMPORTANT: When rewinding the cord, guide it with one hand to avoid any risk of injury. Always take great care if children or pets are in the vicinity.**

- Proceed to clean the attachments, the water tank (P) and the tank, as described in the paragraph “CLEANING AND MAINTENANCE”.
- Wind the hose around the body of the appliance (I) and fit the gun (D) over the handle (F), after placing the cursor (C) in the lock position.



## USING WITH DETERGENT



The following steam appliance is fitted with an innovative, integrated detergent function to be used for stubborn dirt removal; it is an additional function and does not replace the use of steam.

- Remove the cap (Q), inside the handle (F) and, using the funnel (⊙) provided, add detergent to the appliance (5).



**IMPORTANT: Do not use tools to remove the cap (Q) as they might damage it.**



**IMPORTANT: Never add detergent to the water container (P). If using the measure and/or the funnel with detergent, always clean them carefully before using them to fill the water tank.**



**IMPORTANT: Use the detergent provided (Ⓜ) or a detergent expressly made for use with “steam cleaners”. Never, under any circumstances, use cleaning agents containing the following: chlorine, solvents, ammonia**

**or substances marked with an “X” . Always ventilate the area after using cleaning agents.**

- Close the cap (Q) tightly, pressing it all the way down.
- Press the dispenser button (A) on the gun (D); the detergent is dispensed when this button is released; the longer the button is held down, the greater the amount of detergent dispensed (6).
- The detergent does not come out immediately; it is necessary to wait for a few seconds. When using for the first time only, press the button (A) several times to feed the detergent into the dispenser circuit. In this case, prepare a special container to capture it.
- Only use small amounts of detergent and even then, only when there are particularly stubborn stains; excessive amounts of detergent can damage the surface being cleaned. The steam from the appliance is sufficient for normal cleaning.
- Use the steam dispenser button (B) and proceed to clean the surface.
- To clean the detergent reservoir:

Press the detergent dispensing button (A) until the detergent container is completely empty or remove the cap from the detergent container (Q) and tip the appliance back or onto its side.

## ATTACHMENTS

### Extension nozzle ①

With this attachment it is possible to thoroughly clean all those surfaces where stubborn dirt can take hold.

The nozzle can be fitted directly to the gun nozzle (E) or extension tubes (8); after lining up the marks on the gun nozzle (E) and attachment, turn the nozzle 90° clockwise until it locks into place (7).

### Hood ②

This attachment can be fitted to the gun nozzle (E) to protect the end.

### Round brush ③

This attachment is for fitting on the extension nozzle ① and helps to dissolve the most stubborn dirt build up, such as the

type that forms on the cook top or in the grout widths between tiles. It can be used to clean bathroom fixtures, sinks, cooker racks, showers and baths, where it removes all traces of scale (8).

#### Angled nozzle (4)

This attachment can be fitted to the gun nozzle (E) after inserting the cap (2) or extension nozzle (1). It is particularly useful for reaching and sterilising difficult areas, where dirt can build up unseen, on radiators, shutters, and bathroom fixtures, removing it simply and quickly (9).

#### Upholstery brush (5)

The fabric brush can be fitted straight onto the gun nozzle (E) or to the extension tubes (8). When the handy cloth (14) is fitted, it is possible to use the brush to remove dust and for daily cleaning of sofas, armchairs, blankets, mattresses and cushions (10). The brush can also be used to freshen up fabrics, removing all creases. In any case, we recommend, when using for the first time and during normal use, to discharge the condensation from the steam into a container so as not to wet the fabrics (11).

#### Window brush (6)

The fabric brush (5) can be fitted with a window wiper: assemble the two attachments, placing the tabs at the base of the fabric brush inside the hooks at the base of the window wiper. Use the window wiper to restore the polished shine to windows, mirrors and gloss surfaces. It is also easy to use on shower cubicle glass, removing the problem of lime scale (12).

#### Floor brush (7)

This accessory is used on extension tubes (8) and it has handy cloth grips that can hold, as well as the cloth provided (13), any type of machine washable cloth. To fit the cloth, place the brush in the middle, lift the clips at the ends of the brush, insert a flap of cloth and then release the clips (13).

#### Extension tubes (8)

The extension tubes snap together and can be easily separated by pressing the release button. They are useful for reaching high surfaces with the window wiper (6), using the special extension joint, or they can be used with the floor brush (7) (14).

#### Attachment bag (9)

The appliance comes with a bag for the attachments, which is handy for storage as well as for keeping them close at hand (15).

## FILLING THE WATER TANK DURING USE

If the tank (P) should remain without water during use, the appliance will vibrate and its noise will become more intense; in this case, switch off the appliance and unplug it from the mains power before filling the tank as described in the paragraph "INSTRUCTIONS FOR USE".



**IMPORTANT:** If the appliance is not promptly switched off, the pump might overheat and momentarily cause the appliance to block. Fill the tank (P) and wait a few moments for the appliance to start working again normally.

We recommend checking the water level inside the appliance constantly and to fill the tank (P) as described in the paragraph "INSTRUCTIONS FOR USE". In this case, it will not be necessary to switch off or unplug the appliance.

## CLEANING AND MAINTENANCE

### Emptying the water tank (P)

- In case of a long period of disuse, take out the water tank and empty it, so as to prevent the formation of scale residues, which might affect the normal operation of the appliance.

### Emptying and cleaning the detergent reservoir

Cleaning the detergent reservoir:

- Press the dispensing button (A) and dispense all of the detergent in the appliance into a suitable recipient, using water, or empty the detergent container into a recipient, being sure to rinse it out thoroughly;
- Remove the cap (Q) and fill the detergent container with water;
- Press the button (A) several times to remove all detergent residues. Repeat the operations until only water is dispensed;

then turn the appliance over to empty the detergent container and remove the remaining water.

### Emptying and cleaning the inside of the boiler tank



**IMPORTANT:** Clean the boiler tank at least once every month so as to remove any scale residues which might affect the normal operation of the appliance.



**IMPORTANT:** Switch off the appliance, unplug it from the mains power and leave it to cool before cleaning out the boiler tank, so as to avoid the risk of scalds.

- Take out the water tank (P) and unscrew the cap (S) on the back of the appliance (16).
- Slowly add tap water to the boiler tank to prevent any spurts of steam; shake the appliance and turn it upside down to empty it. Repeat the operation several times.



**WARNING:** Never add scale removers, vinegar or other perfumed substances to the tank, as these risk damaging the appliance with immediate cancellation of the warranty.

- Tighten the cap (S) and refill the water tank (P).

## TROUBLESHOOTING...

PROBLEM	CHECK	POSSIBLE CAUSES	POSSIBLE REMEDY
No steam comes out of the nozzle	Steam ready light (M) off	Cold boiler tank	Wait for the steam ready light to switch on (M)
		Lack of water in the tank (P) or badly inserted tank (P)	Refill the water tank (P) as described in the paragraph <b>"FILLING THE WATER TANK DURING USE"</b> and make sure it is in the correct position
The nozzle is dispensing little steam	Steam regulation dial (O) at minimum	Lack of pressure	Adjust steam dispensing
		Cold boiler tank	Wait for the steam ready light (M) to switch on
No detergent is being dispensed from the nozzle		First-time use	Carry out the procedures described in the paragraph <b>"INSTRUCTIONS FOR USE"</b>
		No detergent in the reservoir	Fill the reservoir
		No apparent cause	Contact the ASSISTANCE CENTRE





