

Guarantee

We grant a **three-year guarantee** from the date of purchase.

This product was manufactured using the latest production techniques and has undergone thorough quality control inspection. We guarantee that the product is in perfect condition.

We will remedy all defects in workmanship or materials within the guarantee period. In order for the guarantee to be granted, all warranty claims must be accompanied by proof of purchase from Tchibo or from an authorised Tchibo distribution partner.

If, contrary to our expectations, a defect is found, please contact our customer care service at the following e-mail address:

service@tchibo.de

Our customer consultants will be pleased to advise you on further procedure.

Damage due to improper use, failure to decalcify as well as worn parts and consumables, are not covered by the guarantee.

Please have the product number at hand in case of any queries.

This guarantee does not restrict statutory warranty rights.

Product number: EN 311 478



Steam Cleaner

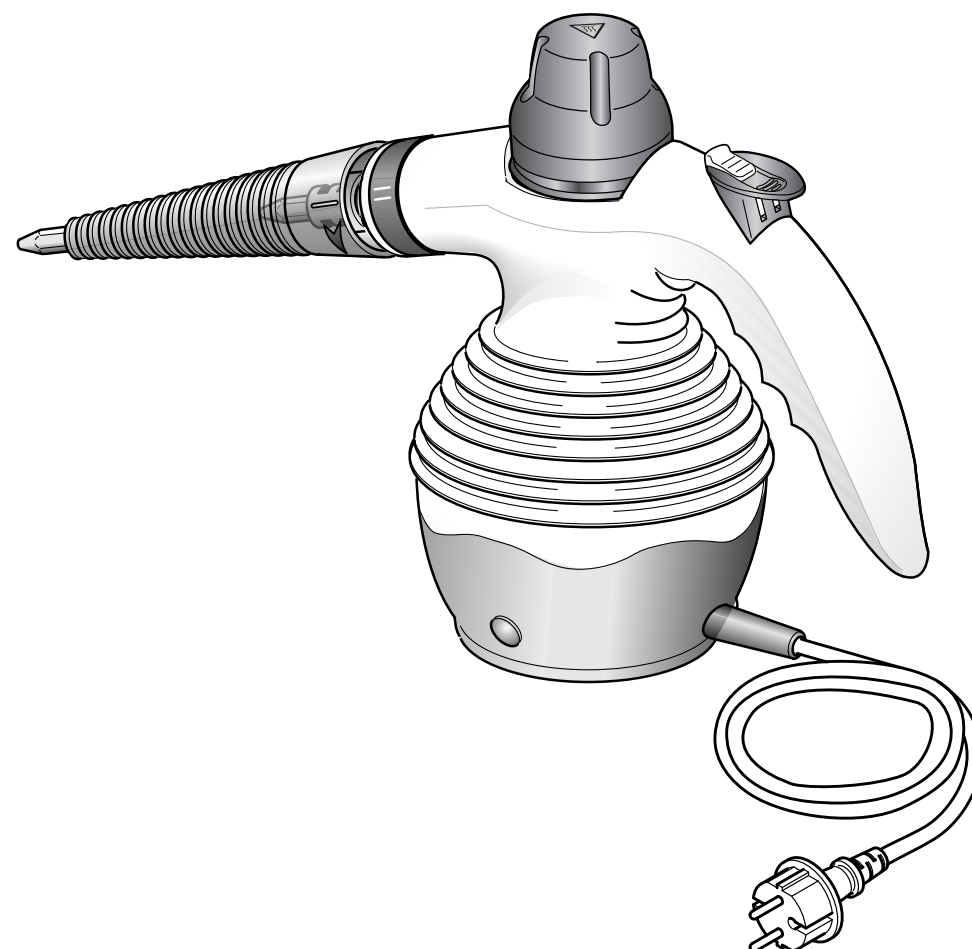

Dear Customer

Your new steam cleaner can be used in many ways.

You can, for example:

- clean seat upholstery,
- clean tiles, mirrors and windows,
- remove stains from carpets and much more...

The appliance has a compact housing, is easy to use and light to carry. With the different attachments, you can quickly and easily adapt your steam cleaner to the job at hand.

Bacteria, microbes and mites can be killed off with its hot steam that reaches a temperature of up to 95°C.

To ensure safe and correct handling, please read the complete instructions for use before putting the appliance into operation. These instructions for use also introduce some of the various application possibilities of your useful, new household appliance.

We wish you the best of success with your new steam cleaner.

Your Tchibo Team

Contents

| | | |
|---|--|--|
| 3 About these instructions | 15 | Exchanging attachments during use |
| 3 Safety warnings | 15 | After use |
| 6 At a glance (package contents) | | |
| 8 Preparing the steam cleaner (prior to use) | 16 Example applications | |
| 8 Unpacking | 16 | Cleaning panes and mirrors |
| 8 Filling the water tank before use | 16 | Cleaning tiles |
| 8 Fitting nozzles and attachments | 17 | Cleaning upholstery and car seats |
| 9 Fitting the nozzle in a fixed position | 17 | Cleaning radiators |
| 10 Fitting the nozzle to swivel | 18 Cleaning and maintaining the appliance | |
| 11 Attaching the extension hose | 18 | Rinsing out limescale residue |
| 12 Fitting the cloth onto the multi-purpose nozzle | 18 | Cleaning the appliance |
| 12 Fitting the window wiper onto the multi-purpose nozzle | 18 | Cleaning the cloth of the multi-purpose nozzle |
| 13 Use | 18 Problems / solutions | |
| 13 Taking the appliance into operation | 19 Disposal | |
| 14 Refilling the water tank during use | 19 Technical specifications | |
| | 20 Guarantee | |

Disposal

The appliance and its packaging have been manufactured from valuable materials that can be recycled. Recycling reduces the amount of refuse and helps to preserve the environment.

Dispose of the **packaging** at a recycling point that sorts materials by type. Make use of the local facilities provided for collecting paper, cardboard and lightweight packaging.



Appliances marked with this symbol must not be disposed of along with household refuse!

You are legally bound to dispose of old appliances separately from household refuse. Information about where they can be deposited free of charge is available from your local authorities.

Technical specifications

| | |
|-----------------------|--|
| Model: | 311 478 |
| Mains voltage: | 220 - 240 V ~ 50/60 Hz |
| Wattage: | 900 watts |
| Fusing: | Temperature safety switch Overheating cut-out |
| Measuring cup: | Filling quantity at top measure mark = 175 ml |
| Protection class: | I |
| Noise level: | The workplace-related noise emission of the appliance is <70 dB(A) |
| Made exclusively for: | Tchibo GmbH, Überseering 18, 22297 Hamburg, Germany |

In the course of product improvement, we reserve the right to make technical and optical modifications to the product.



Cleaning and maintaining the appliance



DANGER - risk of fatal electric shock

- Remove the mains plug from the wall socket before cleaning the appliance.

CAUTION - material damage

- Do not use vinegar or other descaling agents for descaling.
- Do not use any caustic, aggressive or abrasive products for cleaning.

Rinsing out limescale residue

Rinse the water tank once a month with water to remove limescale residue. Only this ensures durable and proper functioning of the appliance.

- ▷ Unplug the appliance and allow it to cool off completely.
- ▷ Rinse out the limescale residue with water.

Cleaning the appliance

- ▷ Unplug the appliance and allow it to cool off completely.
- ▷ Wipe it with a damp cloth if necessary.
- ▷ Clean the steam outlet nozzle with a needle if necessary.

Cleaning the cloth of the multi-purpose nozzle

The cloth can be washed in the washing machine. Please follow the care instructions on the sewn-in label.

Problems / solutions

| | |
|--|---|
| No steam comes out. | <ul style="list-style-type: none">• Is the mains plug inserted into the wall socket?• Is there water in the tank?• Is the steam outlet clogged? |
| It takes a long time for the appliance to heat up. | <ul style="list-style-type: none">• Does the appliance need descaling? |
| Water is dripping from the attachment. | <ul style="list-style-type: none">• Condensed water can collect in the steam pipe when steam cools. After switching on the appliance or when use has been interrupted for a moment, direct the nozzle into a container and press the steam button to remove the excess water. |

About these instructions

This appliance is equipped with safety features. Nevertheless, read the safety warnings carefully and only use the product as described in these instructions to avoid accidental injury or damage.

Keep these instructions for future reference.

If you pass this product on to someone else, remember to give them these instructions.

Symbols in these instructions:



This symbol warns you of the danger of injury.



This symbol warns you of the danger of injury caused by electricity.

The term **DANGER** warns of potential severe injury and danger to life.

The term **WARNING** warns of injury and severe material damage.

The term **CAUTION** warns of minor injury or damage.



This indicates additional information.

Safety warnings



Intended use

The steam cleaner is designed to clean carpets, seat upholstery, tiles, mirrors, windows and the like.

Never direct the steam at people, animals, plants or delicate objects.

The appliance is only intended for private use and is not suitable for commercial purposes.

DANGER to children and people with restricted capabilities of operating appliances

- This appliance may not be used by children. Children must not be allowed to play with the appliance.
- This appliance may be used by people with reduced physical, sensory or mental capabilities, or who lack sufficient experience and/or knowledge, provided they are supervised or have been trained in the safe use of the appliance and understand the potential dangers.

- Keep children away when you are operating the appliance and when leaving the appliance to cool down after use.
- Keep the packaging material away from children.
There is a risk of suffocation!
- If disposing of the appliance, safely cut off the mains cord to ensure that it can no longer be used. If necessary, remove all small parts from the appliance that, for example, could pose a risk to children playing with it.

DANGER due to electricity

- The steam must not be directed at electrical appliances (e.g. refrigerators, oven interiors, switches, lights, microwave ovens, etc.).
- The steam cleaner's tank is filled with water. However, you should never immerse the steam cleaner or its mains plug in water as this could result in electric shock.
- Do not touch the appliance with damp hands and do not operate it outdoors in the rain.
- Remove the mains plug from the wall socket...
... if you stop or interrupt use,
... before filling the appliance with water,
... before cleaning the appliance,
... when replacing attachments,
... if disturbances occur or the appliance is damaged, or
... during thunderstorms.
Always pull on the plug, never on the mains cord.

- The wall socket must be easily accessible so that the appliance can be unplugged quickly if necessary.
- The mains cord must not be kinked or squeezed. Keep it away from hot surfaces and sharp edges.
- Never carry or pull the appliance by its mains cord.
- Only connect the appliance to a properly installed, earthed wall socket that complies with the "Technical specifications" of the appliance.
- Do not use the steam cleaner if the appliance itself or its mains cord show any visible sign of damage or if the appliance has been dropped.
- Never leave the appliance unattended while it is connected to the mains.
- Do not disassemble the appliance. The mains cord should also not be exchanged or modified. Improper repair may result in considerable risk of injury to the user. Therefore, only have repairs to the appliance or the mains cord carried out by a specialist workshop or the customer care service.

WARNING - risk of scalds/burns and fire

- Never direct the steam at people, animals, plants or delicate objects.
- Always hold the appliance upright during operation to keep boiling water from leaking out.

Cleaning upholstery and car seats

CAUTION - material damage

- Always test fabrics, carpets and the like on an inconspicuous part of the material in order to determine whether it is suitable for steam cleaning. If necessary, consult the manufacturer of the material.

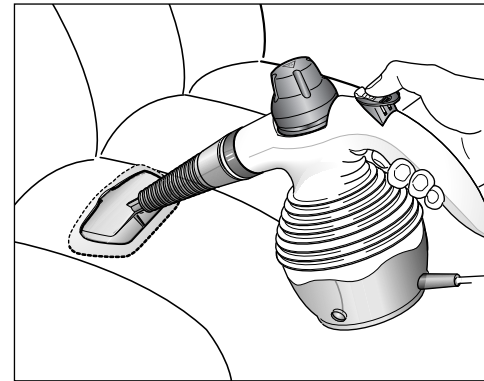

Attachments used:
Multi-purpose nozzle with cloth

Cleaning radiators

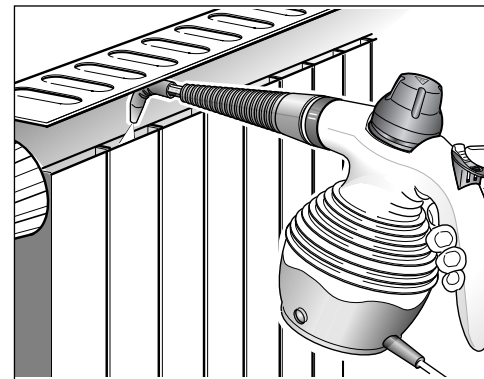

Attachments used:
Jet nozzle with curved nozzle

Example applications

i The extension hose can be used in addition to all example applications shown. Please note that the steam cools slightly due to the extended path. A continuous flow of steam can thus cause droplets to form.

Cleaning panes and mirrors

CAUTION - material damage

- Cleaning with hot steam in environments at very low temperatures could in some circumstances cause distortions due to extreme differences in temperature. Therefore always clean glass and mirrors at room temperature if possible.

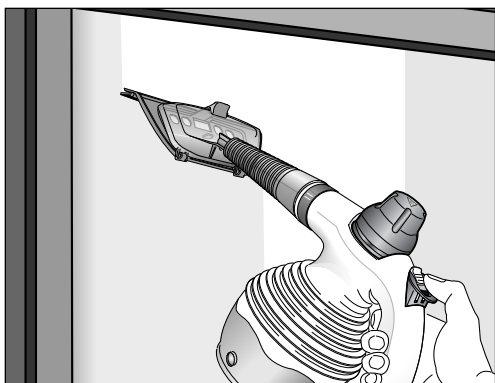

Attachments used:
Multi-purpose nozzle with window wiper

Cleaning tiles

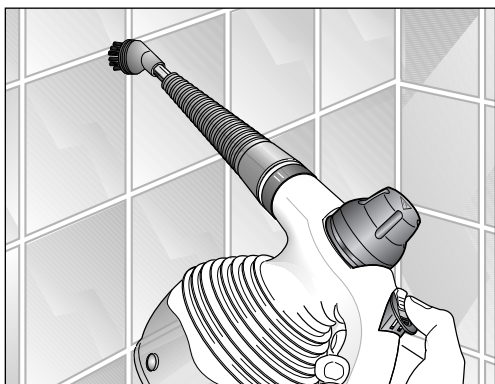

Attachments used:
Jet nozzle with round brush

- When you are not using the appliance (including if you take a short break), always secure the steam button with the safety lock so that it cannot be pressed accidentally.
- Never touch the hot surfaces of the appliance during operation.
- The appliance is still very hot after use. The safety seal can only be opened when the steam pressure in the water tank is lower than 0.35 bar. Allow it to cool off before emptying the water tank and removing the attachments.
- The safety seal must not be opened during use. For safety reasons, please follow these steps when refilling the water tank: Remove the mains plug from the wall socket. To protect against scalding, put a cloth over the safety seal before carefully releasing it; this way, escaping steam will first collect in the cloth. It is of utmost importance for you to read "Refilling the water tank during operation" in the section "Use".
- Keep the steam cleaner away from curtains and other flammable materials.
- Only store away the appliance after it has cooled off completely. Always empty the water tank before storing the appliance away.

CAUTION - material damage

- Only use tap water or distilled water to fill the tank.
Cleaning detergents, descalers, alcohol, fragrances or other liquids must not be added, as they can damage the appliance or cause it to become dangerous.
- Only use the accessories supplied.
- Always test fabrics, carpets, treated terracotta floors, wooden floors and the like on an inconspicuous part of the surface in order to determine whether it is suitable for steam cleaning. If necessary, consult the manufacturer of the material to be cleaned.
- Do not insert objects of any kind into the openings/nozzles of the appliance and, before every use, make sure they are not clogged.
- The steam cleaner must not be operated without water. As soon as the water in the tank is used up, disconnect the steam cleaner by pulling out its mains plug. Do not use the appliance with an empty tank.
- Do not expose the appliance to extreme sunlight, frost or other weather conditions (e.g. rain).
- Store the steam cleaner in a dry, cool location. Do not store the appliance in the vicinity of gas or electric cookers, heaters or ovens.

At a glance (package contents)

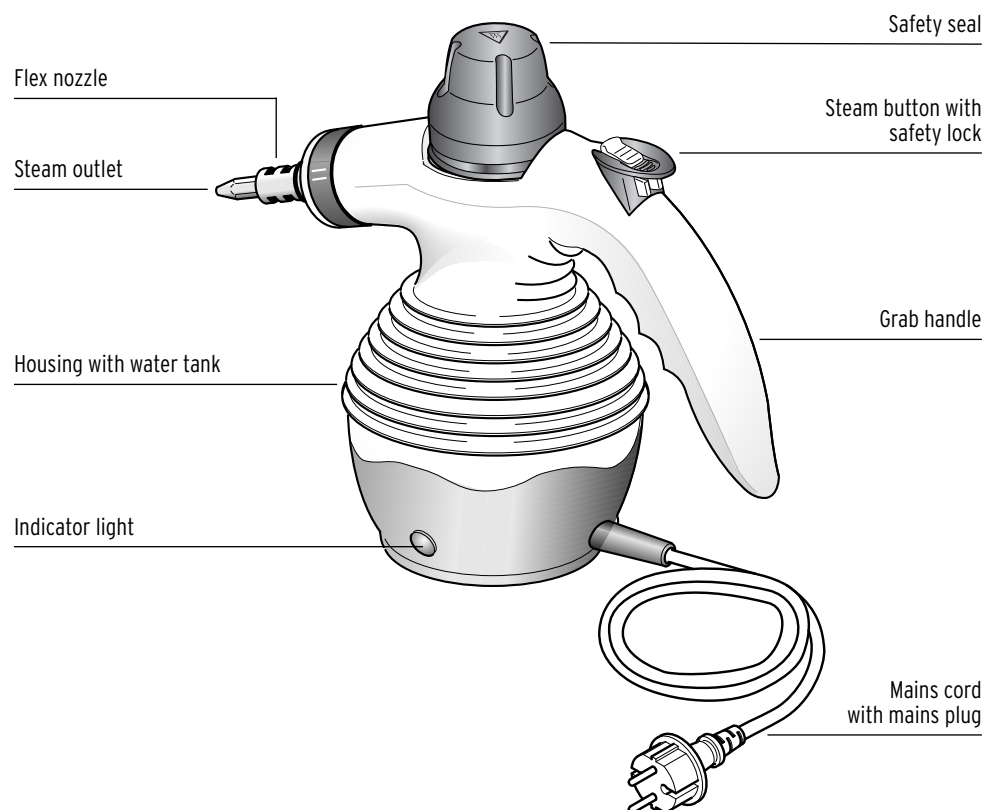

Accessories



Curved nozzle

for hard-to-reach nooks and corners,
e.g. washbasins, radiators



Round brush

e.g. for tapware, tile joints,
hub caps

Exchanging attachments during use



WARNING - risk of scalds/burns

- Steam collects at the steam outlet during use, which causes this area to get very hot. Please be cautious when exchanging the attachments.
- When you are not using the appliance (including if you take a short break), always secure the steam button with the safety lock so that it cannot be pressed accidentally.

1. Disconnect the mains plug from the wall socket.
2. Exchange the attachments as described in the section "Preparing the steam cleaner (prior to use)". To avoid burns, wear protective gloves or similar when removing attachments.
3. Put the appliance back into operation.

After use



WARNING - risk of scalds/burns

- The appliance is still very hot after use. Allow the appliance to cool off completely before storing it away.

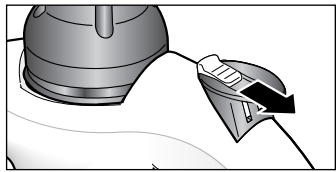
1.  Slide the safety lock on the steam button to the back.
2. Disconnect the mains plug from the wall socket.
The appliance is now switched off.
3. Please wait until the appliance has completely cooled down (approx. 2 hours).
Then carefully open the safety seal and empty the water tank.
4. Remove any attachments used.

Refilling the water tank during use



WARNING - risk of scalds/burns

- The appliance is extremely hot. Even if there is no more water in the tank, steam can still escape. It is also possible for steam to escape when unscrewing the safety seal. Therefore, proceed with caution at all times.
- When you are not using the appliance (including if you take a short break), always secure the steam button with the safety lock so that it cannot be pressed accidentally.

CAUTION - material damage

- Only use tap water or distilled water to fill the tank. Cleaning detergents, descalers, alcohol, fragrances or other liquids must not be added, as they can damage the appliance or cause it to become dangerous.

If steam no longer escapes when you press the steam button, there is no water left in the tank. For your safety, always follow the steps described below in the given order to refill the water tank:

1. Disconnect the mains plug from the wall socket.
2. If the safety seal is turning without coming off or cannot be opened, the steam pressure in the water tank is too high. Wait a few minutes until the pressure in the water tank has regulated itself.
3. To protect against scalding, put a cloth over the safety seal before releasing it; this way, escaping steam will first collect in the cloth.
4. Loosen the safety seal a little and wait until the remaining steam has fully escaped.
5. Slowly unscrew the safety seal. More steam may escape!
6. Fill the measuring cup with water no further than the top measure mark and fill the water into the tank. To avoid splashing, pour in the water slowly.
7. Screw the safety seal back on tightly.
8. Insert the mains plug back into the wall socket. The indicator light comes on. After approx. 3 to 4 minutes, the indicator light goes off. The temperature of the water is now high enough for steam to be generated. The appliance is now ready for use again.



Jet nozzle

for hard-to-reach areas, or as an extension for the curved nozzle or the round brush

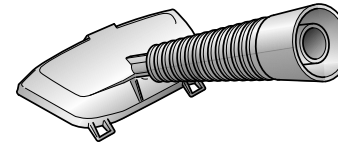

Multi-purpose nozzle

for cleaning fabrics, e.g. rugs, carpets

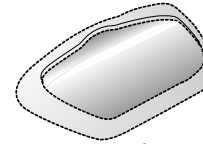

Cloth

(to use with the multi-purpose nozzle) to clean sensitive surfaces, e.g. sofas, car seat upholstery

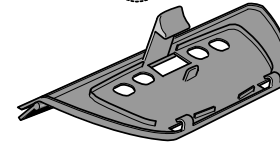

Window wiper

(to use with the multi-purpose nozzle) to clean smooth surfaces, e.g. panes, mirrors, tiles, shower screens



Extension hose

to connect between the steam cleaner and nozzle or brush; it simplifies the use of the appliance and improves the accessibility of hard-to-reach areas.

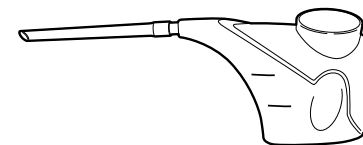

Funnel

to fill the water tank. Please thoroughly read the sections "Safety warnings" and "Refilling the water tank during operation" under "Use" before filling or refilling the water tank.

Preparing the steam cleaner (prior to use)

Unpacking



DANGER to children - danger to life due to suffocation/swallowing

- Keep the packaging material away from children. Dispose of it immediately.

1. Remove the appliance and the accessories from the packaging.
2. Ensure that all parts are present and show no signs of damage.

Filling the water tank before use

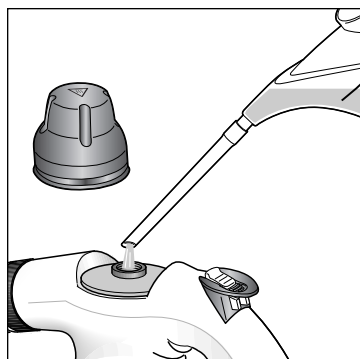

1. Unscrew the safety seal.
2. Fill the measuring cup with tap water or distilled water no further than the top measure mark and pour the water into the tank. Then fill the measuring cup again, this time to the bottom measure mark, and pour the water into the tank.
3. Tightly screw the safety seal back on.

Fitting nozzles and attachments

- ▷ Choose the appropriate accessory.

Curved nozzle, round brush



The round brush and the curved nozzle can be fitted directly onto the flex nozzle. Fit the jet nozzle or extension hose first, if necessary.



Use

Taking the appliance into operation



DANGER - risk of fatal electric shock

- The steam must not be directed at electrical appliances (e.g. refrigerators, oven interiors, switches, lights, microwave ovens, etc.).
- Remove the mains plug from the wall socket if you wish to interrupt or stop your work with the appliance.



WARNING - risk of scalds/burns

- Never direct the steam at people, animals or plants.

1. Ensure that the water tank is filled (see section "Filling the water tank before use" under "Preparing the steam cleaner (prior to use)"). Insert the mains plug into the mains socket. The indicator light turns on.
2. Wait approx. 3 to 4 minutes for the indicator light to go off. The temperature of the water is then high enough for steam to be generated. The appliance is ready for use.

3.

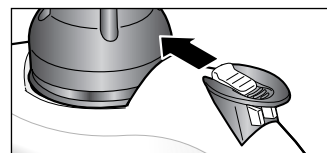

Slide the safety lock forwards.

4.

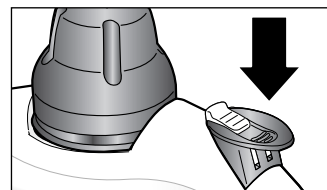

Direct the nozzle at the object to be cleaned and press the steam button.

5. Release the steam button to interrupt the supply of steam.

6.

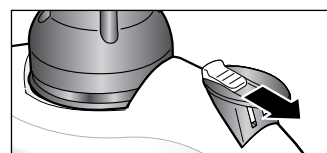

Slide the safety lock back again.

Fitting the cloth onto the multi-purpose nozzle

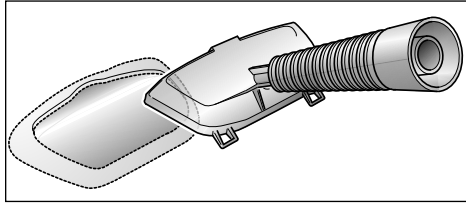

1. Pull the cloth onto the multi-purpose nozzle.
2. Fit the nozzle on the appliance as described in section "Fitting the nozzle in a fixed position".

Fitting the window wiper onto the multi-purpose nozzle

1. Remove the cloth from the multi-purpose nozzle, if necessary.

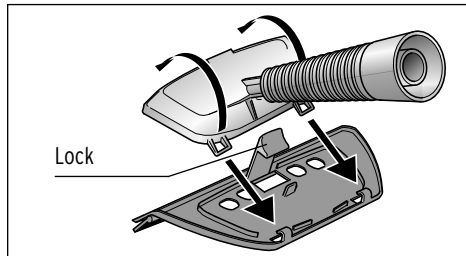

2. Fit the multi-purpose nozzle on the window wiper at an angle so that the two back mounts clasp into the hooks.
3. Push the multi-purpose nozzle forwards in the direction of the arrow until the lock of the window wiper snaps into place.

4. Fit the nozzle on the appliance as described in section "Fitting the nozzle in a fixed position".

- ▷ To release the window wiper, push back the lock and lift the multi-purpose nozzle up and off.

Jet nozzle and multi-purpose nozzle



The jet nozzle can either be swivel-mounted or fitted in a fixed position. A swivelling nozzle may be helpful in accessing hard-to-reach areas.

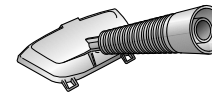

The multi-purpose nozzle is mostly fitted to the appliance in a fixed position, but it can also be swivel-mounted.

Fitting the nozzle in a fixed position

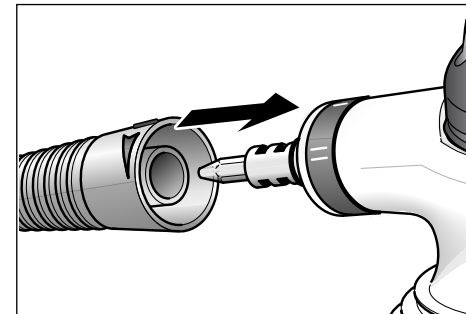

1. Fit the jet or multi-purpose nozzle onto the flex nozzle. The I mark on the nozzle points to the I mark on the appliance.
2. Push the nozzle on against the resistance as far as it will go.

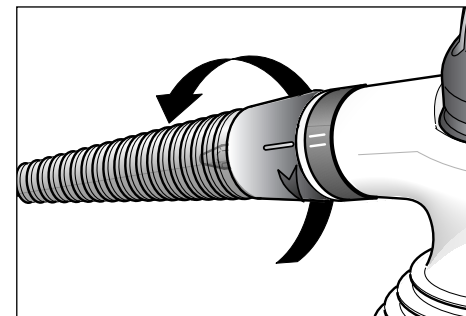

3. Turn the nozzle in the direction of the arrow. In the end position, the I mark on the nozzle points to the II mark on the appliance.

- ▷ To remove the nozzle, turn it back to the I mark and pull it off.

Fitting the nozzle to swivel

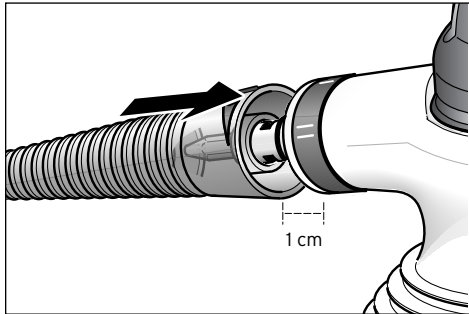

1. Fit the jet or multi-purpose nozzle approx. 1 cm onto the flex nozzle. The I mark on the nozzle points to the I mark on the appliance.



A gap of approx. 1 cm remains between the nozzle and the appliance.

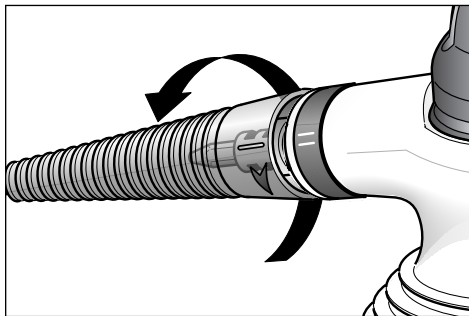

2. Turn the nozzle in the direction of the arrow. In the end position, the I mark on the nozzle points to the II mark on the appliance.

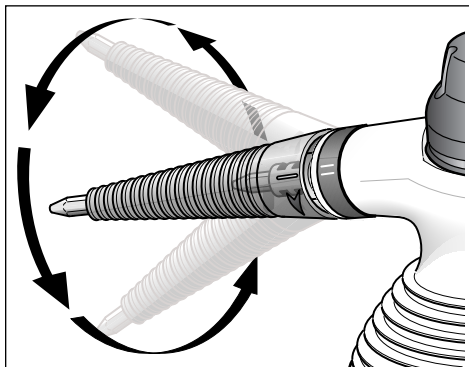

The nozzle can now be swivelled in all directions.

➤ To remove the nozzle, turn it back to the I mark and pull it off.

Attaching the extension hose

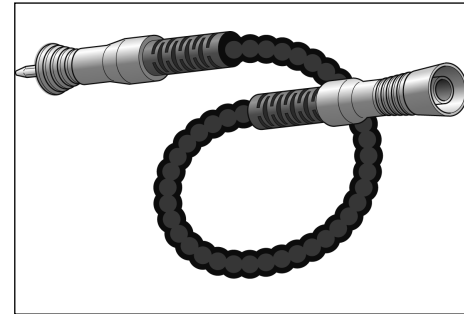

The extension hose can be fitted in a fixed position or swivel-mounted between the steam cleaner and nozzle or brush. The following instructions describe how to fit the hose in a fixed position. If you would like it to be swivel-mounted, proceed as explained in the section "Fitting the nozzle to swivel".

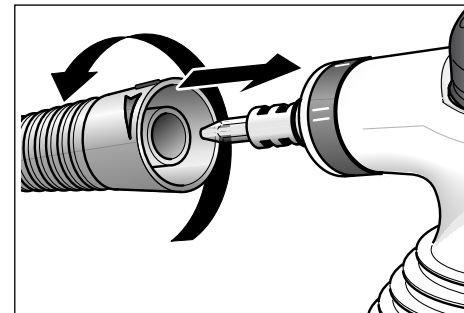

1. Fit the extension hose onto the flex nozzle. The I mark on the hose points to the I mark on the appliance.
2. Push the extension hose on as far as it will go.
3. Turn the extension hose in the direction of the arrow. In the end position, the I mark on the hose points to the II mark on the appliance.

4. Fit the jet or multi-purpose nozzle onto the other end of the extension hose, pushing it on as far as it will go.
5. Turn the jet or multi-purpose nozzle in the direction of the arrow as far as it will go.

➤ To remove the extension hose or the nozzle, turn them back to the I mark. Then pull off the extension hose or the nozzle with a sharp jerk.