



# User Manual

**Spend a little** Live a lot

EASY  
HOME

## HANDHELD WINDOW VAC CLEANER



**Product  
Info**



[www.aldi.co.uk](http://www.aldi.co.uk)

**+ VIDEO**



# QR codes take you where you want to go quickly and easily

Whether you require **product information, spare parts or accessories**, details on **warranties or aftersales services**, or if you want to watch a **product demonstration video**, our QR codes will take you there in no time at all.

## What is a QR code?

A QR code (QR = Quick Response) is a type of matrix that can be read with a smartphone camera and that contains a link to a website or contact details, for example.

**Advantage:** You do not need to manually enter a website address or contact details.

## This is how it works

To scan the QR code, all you need is a smartphone with QR code reader software and an internet connection.\* This type of software can be downloaded for free from your app store.

## Try it out now

Just scan the QR code with your smartphone and find out more about the Aldi product you have purchased.\*

## Your Aldi Service Portal

All details mentioned above can also be found in the Aldi Service Portal at [www.aldi.co.uk](http://www.aldi.co.uk).



\* Depending on your tariff plan you may be charged for the connection.



# Contents

<b>Overview .....</b>	<b>4</b>
<b>Product contents/device parts.....</b>	<b>6</b>
<b>General information.....</b>	<b>7</b>
Reading and storing the user manual .....	7
Explanation of symbols .....	7
<b>Safety .....</b>	<b>8</b>
Proper use.....	8
Safety notes .....	8
<b>First use.....</b>	<b>12</b>
Checking the window cleaner and product contents .....	12
Charging the rechargeable battery .....	12
<b>Operation.....</b>	<b>14</b>
Using the spraying attachment.....	14
Using the squeegee .....	15
<b>Cleaning .....</b>	<b>15</b>
Cleaning the spraying attachment.....	16
Cleaning the squeegee .....	16
Cleaning the window cleaner.....	16
Emptying the dirty water tank .....	17
<b>Storage .....</b>	<b>17</b>
<b>Technical data .....</b>	<b>17</b>
<b>Declaration of conformity.....</b>	<b>18</b>
<b>Disposal.....</b>	<b>18</b>
Disposing of the packaging .....	18
Disposing of old devices .....	18
<b>Warranty Card.....</b>	<b>19</b>
<b>Warranty conditions.....</b>	<b>20</b>



A

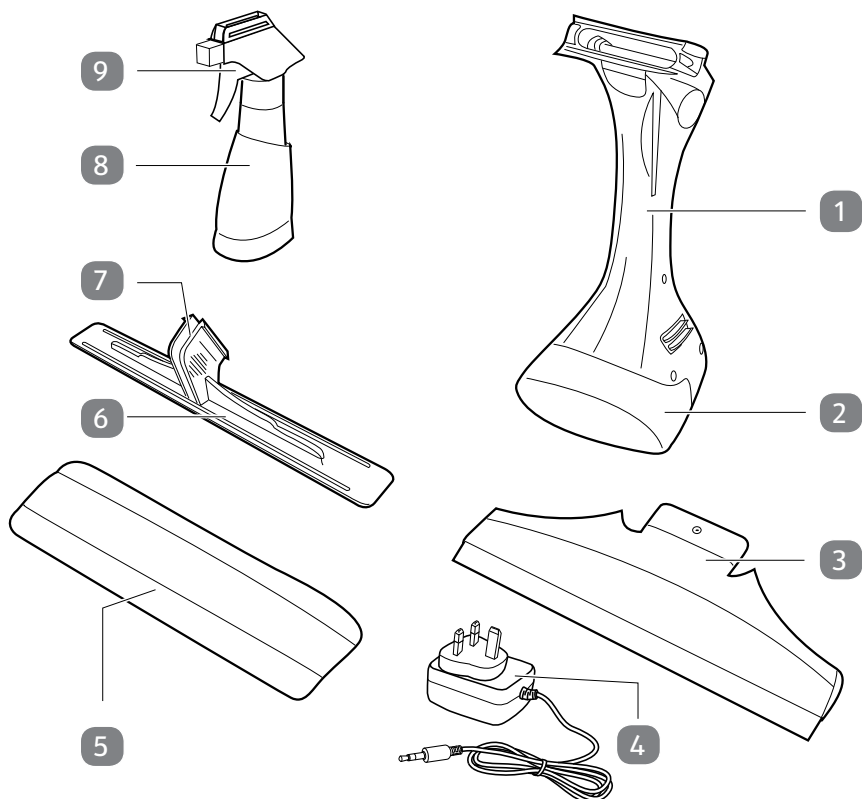

B

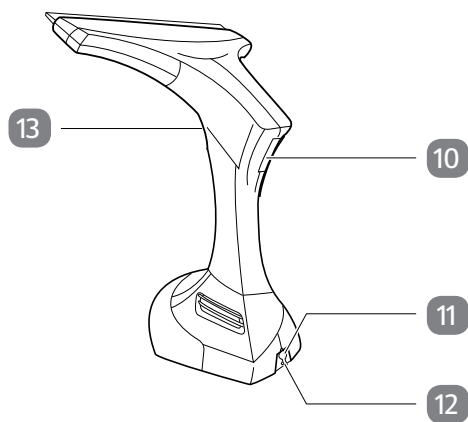







## Product contents/device parts

- 1 Housing of the window cleaner
- 2 Dirty water tank
- 3 Squeegee
- 4 Charger
- 5 Microfibre cloth
- 6 Cloth holder
- 7 Fastening clamp
- 8 Sprayer
- 9 Spray pistol
- 10 On/Off button
- 11 Charging socket
- 12 Rechargeable battery control light
- 13 Clamping button
- 14 Velcro fastener



# General information

## Reading and storing the user manual



This user manual accompanies the handheld window vac cleaner. It contains important information on start-up and handling.

For improved readability, the handheld window vac cleaner will be referred to only as the window cleaner below.

Before using the window cleaner, read the user manual carefully. This particularly applies to the safety notes. Failure to heed this user manual may result in severe injury or damage to the window cleaner.

The user manual is based on the standards and rules in force in the European Union. When abroad, you must also observe country-specific guidelines and laws.

Keep the user manual for future use. If you pass the window cleaner on to third parties, please be absolutely sure to include this user manual.

## Explanation of symbols

The following symbols and signal words are used in this user manual, on the window cleaner or on the packaging.



This signal symbol/word designates a hazard with moderate degree of risk which may lead to death or severe injury if not avoided.



This signal symbol/word designates a hazard with low risk that, if not avoided, may result in minor or moderate injury.

**NOTICE!**

This signal word warns against potential damages to property.



This symbol provides you with useful supplementary information on assembly or operation.



Declaration of conformity (see chapter "Declaration of conformity"): Products marked with this symbol meet all applicable Community regulations for the European Economic Area.



The mains adapter complies with protection class 2.







The window cleaner complies with protection class 3.



Only use the charger in indoor areas.



Short-circuit proof safety transformer

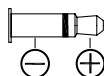

Plug polarity



36 months warranty

## Safety

### Proper use

The window cleaner is only designed for cleaning wet and smooth surfaces such as windows, mirrors and tiles. The window cleaner is not suitable for vacuuming up dust or small parts. It is only intended for private use and is not suitable for commercial use.

Only use the window cleaner as described in this user manual. Any other use is deemed improper and may result in damage to property or even personal injury. The window cleaner is not a children's toy.

The manufacturer or vendor accepts no liability for damage caused by improper or incorrect use.

### Safety notes

#### **WARNING!**

#### **Risk of electric shock!**

A faulty electrical installation or excessive mains voltage may result in an electric shock.

- Before using the window cleaner, read the user manual carefully.



- Keep the user manual for future use. If you pass the window cleaner on to third parties, please be absolutely sure to include this user manual.
- Only connect the charger of the window cleaner if the mains voltage of the socket corresponds to the nameplate specification.
- Only connect the charger of the window cleaner to an easily accessible socket so that you can quickly disconnect the window cleaner from the mains in the event of a fault.
- Never use the window cleaner if it is visibly damaged or if the charger and its cord is faulty or damaged.
- All repairs, including the replacement of the charger, must only be carried out by the customer service or by technicians who are authorised to do so. Repair by unqualified persons could result in a risk of injury to the user.
- Do not open the housing; instead, have a qualified professional perform the repairs. Contact a qualified workshop for this. Liability and warranty claims are waived in the event of repairs performed by the user, improper connection of the device or incorrect operation.
- Only parts that comply with the original device data may be used for repairs. Electrical and mechanical parts, which are essential for providing protection against sources of danger, are located in this window cleaner.
- The charger of the window cleaner must not be operated with an external timer or a separate telecontrol system.
- Never immerse the housing of the window cleaner and the charger and its cord in water or other liquids. Clean them with a damp cloth.
- Never touch the charger with damp hands.
- Never pull the charger out of the socket by the mains cord; instead, always do so by taking hold of the charger.
- Never use the mains cord as a carrying handle.



- Keep the window cleaner, charger and its cord away from open flames and hot surfaces.
- Lay the charger cord so that it does not pose a tripping hazard.
- Do not kink the mains cord and do not lay it over sharp edges.
- Only use the window cleaner in indoor areas. Never operate it in wet rooms or in the rain.
- Never store the window cleaner such that there is a risk of it falling into a tub or a basin.
- Never reach to retrieve an electrical device if it has fallen in water. In such a case, immediately disconnect the mains plug.
- Make sure that children do not insert any objects in the window cleaner.
- Do not insert any objects which conduct electricity in the charging socket, e.g. a screwdriver.
- Do not use the window cleaner if battery fluid is leaking out of the window cleaner. Contact the manufacturer, its customer service or a similarly qualified person in this case.
- Only use the enclosed charger to charge the window cleaner.

**⚠ WARNING!**

**Danger for children and persons with impaired physical, sensory or mental capacities (e.g. partially disabled persons, older persons with reduced physical and mental capacities) or lack of experience and knowledge (e.g. older children).**

- This appliance can be used by children over the age of eight and by people with reduced physical, sensory or mental capabilities, or lack of experience and knowledge, if they are supervised while using it or have been shown how to use it in a safe way and understand the hazards involved. This appliance may not be used as a plaything. Cleaning and maintenance can be performed by children only if properly supervised.



- Keep children under eight years of age away from the window cleaner and connector cable of the charger.
- Do not leave the window cleaner unattended while in operation.
- Do not allow children to play with the accessory parts of the window cleaner.
- Keep all packaging out of the reach of children do not allow children to play with the package wrapping. Children may get caught in it when playing and suffocate.
- When disposing of the appliance as waste, it must be made inoperative by cutting off the power cord. Also remember to make any of the potentially hazardous parts of the appliance safe, as there is a risk that children may use them as playthings.

## NOTICE!

### **Risk of damage!**

Improper handling of the window cleaner may result in damage to the window cleaner.

- Never place the window cleaner on or near hot surfaces (e.g. hotplates).
- Make sure that the charger and its cord do not come into contact with hot or sharp surfaces.
- Never expose the window cleaner to high temperatures (heaters etc.) or to effects of the weather (rain etc.). Never fill the window cleaner with liquid.
- Never immerse the housing of the window cleaner, the charger and its cord in water or other liquids and do not use a steam cleaner to clean it. Otherwise, you could damage the window cleaner, the charger and its cord. Clean them with a damp cloth.
- Do not in any case place the window cleaner in the dishwasher. It would be destroyed as a result.
- Only use commercially-available glass cleaners for the window cleaner. Do not use spirit or foaming cleaners.



- Stop using the window cleaner if its plastic parts exhibit cracks, are chipped or are deformed. Only replace damaged parts with corresponding original spare parts.
- Do not aim the spray jet directly at devices containing electrical components.

## First use

### Checking the window cleaner and product contents

#### NOTICE!

#### Risk of damage!

If you are not cautious when opening the packaging with a sharp knife or other pointy object, you may quickly damage the window cleaner.

- Be very careful when opening.
  1. Take the window cleaner out of the packaging.
  2. Check to make sure that the delivery is complete (see **fig. A**).
  3. Check whether the window cleaner or the individual parts are damaged. If this is the case, do not use the window cleaner. Contact the manufacturer at the service address specified on the warranty card.

### Charging the rechargeable battery

#### NOTICE!

#### Risk of damage!

Improperly charging the rechargeable battery may damage the rechargeable battery.

- Do not charge the rechargeable battery at temperatures below 5 °C or above 40 °C. Otherwise, you could damage the rechargeable battery.

Before first use, the rechargeable battery must be charged for 24 hours. The housing of the window cleaner  may become hot during the charging process.



1. Connect the charger **4** to the charging socket **11** of the window cleaner.
2. Connect the charger to a properly installed socket.

The rechargeable battery control light **12** will blink during the charging process. Once the rechargeable battery control light stops blinking, the rechargeable battery has been fully charged and the window cleaner is ready for use.

3. Remove the charger from the charging socket.

You can now use the window cleaner.

If the rechargeable battery control light starts blinking after a certain duration of use, the rechargeable battery has to be charged again. The window cleaner will automatically switch off when the rechargeable battery does not have enough power.



If the rechargeable battery life is very short after prolonged use, this is not a fault of the window cleaner. This can be resolved by

- using the window cleaner until the rechargeable battery has completely discharged and the operation is interrupted.
- recharging the window cleaner several times.

Should the rechargeable battery life nevertheless remain short, contact customer service.





# Operation

## Using the spraying attachment

### ⚠ CAUTION!

#### Risk of injury!

Improper handling of the sprayer may result in injury.

- Do not aim the spray jet at eyes.

1. Add 50 ml of commercially-available glass cleaner to the sprayer **8** and fill the sprayer up with clear tap water.
2. Insert the cloth holder **6** into the lateral pouch of the microfibre cloth **5** and attach the microfibre cloth with the Velcro fastener **14** to the cloth holder.

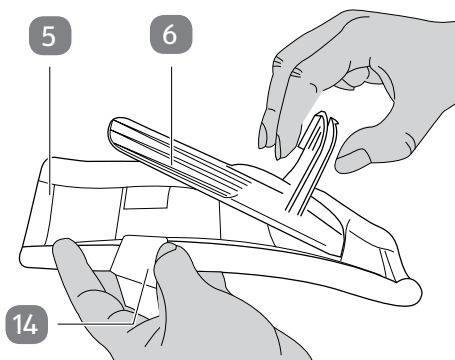

3. Push the cloth holder with the fastening clamp **7** onto the spray pistol **9** until the fastening clamp locks into place.
4. In order to clean the surface, push the trigger of the spray pistol and wipe over the surface with the microfibre cloth in semi-circular movements.

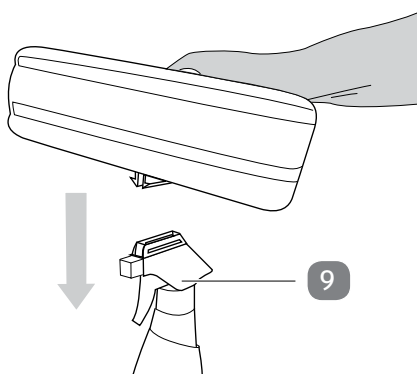



## Using the squeegee



Do not perform semi-circular or horizontal movements when vacuuming the dirty water. Otherwise, water could leak out of the dirty water tank **2**.

1. Wet the surface with water or commercially-available glass cleaner.
2. Push the squeegee **3** into the window cleaner until the squeegee locks into place.

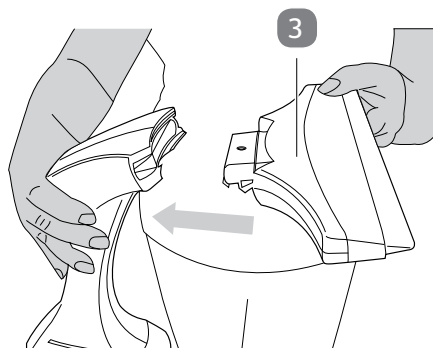

3. To switch on the window cleaner, push the On/Off button **10**.
4. Vacuum up the dirty water by gently pushing the squeegee against the surface and guiding the window cleaner slowly down from top to bottom, so that the rubber of the squeegee adheres to the surface.

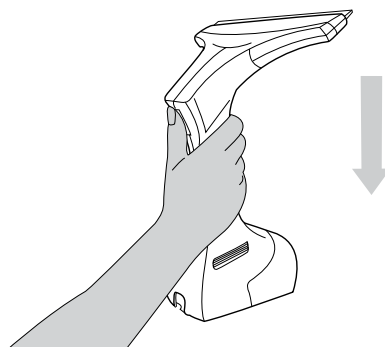

## Cleaning

### NOTICE!

#### Risk of short circuit!

Water that has penetrated the housing may cause a short circuit.

- Never immerse the window cleaner in water.
- Make sure that no water penetrates the housing.



**NOTICE!****Risk due to improper operation!**

Improper handling of the window cleaner may result in damage.

- Do not use any aggressive cleaners, brushes with metal or nylon bristles, sharp or metallic cleaning utensils such as knives, hard scrapers and the like. They could damage the surfaces.
- Do not attempt to clean the window cleaner and the accessories in the dishwasher. It would be destroyed as a result.

**Cleaning the spraying attachment**

1. To remove the cloth holder (6) from the spray pistol (9), press the fastening clamp (7) of the cloth holder together and pull the cloth holder off.
2. Remove the microfibre cloth (5) from the cloth holder.
3. Wash the microfibre cloth at 60 °C in the washing machine without adding softeners.
4. Wipe the cloth holder off with a damp cloth. Then let all parts dry completely.

**Cleaning the squeegee**

1. To remove the squeegee (3), push the clamping button (13).
2. Take the squeegee off of the window cleaner.
3. Rinse the squeegee out under running water.

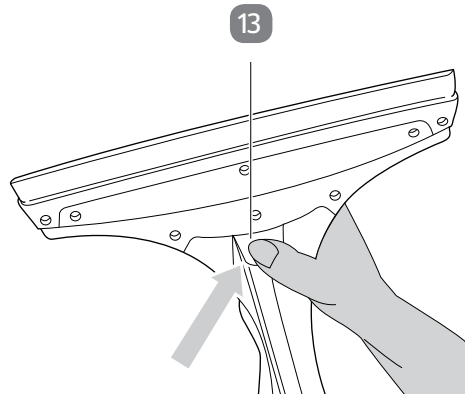
**Cleaning the window cleaner**

1. Pull the charger (4) out of the charging socket (11) before cleaning.
2. Let the window cleaner cool off completely.
3. Wipe the housing of the window cleaner (1) off with a damp cloth. Then let all parts dry completely.



## Emptying the dirty water tank

Once the dirty water tank has reached its maximum fill level, it must be emptied.

1. To switch off the window cleaner, push the On/Off button **10**.
2. Remove the dirty water tank **2**.
3. Empty the dirty water tank and rinse it out with clear tap water.
4. Put the dirty water water tank back into the window cleaner.

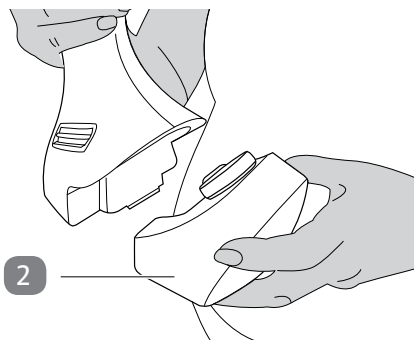

## Storage

- Store the window cleaner in a clean and dry area.

## Technical data

Model:	4125
Input voltage charger:	100–240 V~, 50/60 Hz, 0.2 A max.
Output voltage charger:	5 V, 600 mA
Rechargeable battery type:	Li-Ion 2200 mAh
Supply voltage rechargeable battery:	3.7 V
Operating time with fully charged rechargeable battery:	approx. 45 min.
Charging time when the rechargeable battery is empty:	max. 3.5–4 hours
Output:	10 W
IP code:	IPX4
Protection class window cleaner:	III ⚡
Protection class charger:	II □
Weight with squeegee:	approx. 600 g
Dimensions with squeegee (H × W × D):	32 × 25.5 × 17.5 cm
Article number:	93147



# Declaration of conformity



The EU declaration of conformity can be requested from the address specified on the warranty card (at the end of this user manual).

## Disposal

### Disposing of the packaging



Dispose of the packaging separated into single type materials. Dispose of cardboard and carton as waste paper and foils via the recyclable material collection service.

### Disposing of old devices

(Applicable in the European Union and other European states with systems for the separate collection of reusable waste materials)



#### **Old devices must not be disposed of with household waste!**

If the window cleaner can no longer be used, every user is required by law **to dispose of old devices separately from their household waste**, e.g. at a local authority recycling centre.

This ensures that old devices are recycled in a professional manner and also rules out negative consequences for the environment. For this reason, electrical devices are marked with the above symbol.



#### **Batteries and rechargeable batteries must not be disposed of with household waste!**

As a consumer, you are required by law to turn in all batteries and rechargeable batteries, regardless whether they contain harmful substances\* or not, at a local authority recycling centre or in a retail outlet so that they can be disposed of in an environmentally-friendly manner.

Bring the entire window cleaner (including the rechargeable battery) to your collection point and make sure that it is in an uncharged state!

\* labelled with: Cd = cadmium, Hg = mercury, Pb = lead



EASY  
HOME

# WARRANTY CARD

## HANDHELD WINDOW VAC CLEANER

Your details:

Name \_\_\_\_\_

Address \_\_\_\_\_

\_\_\_\_\_

\_\_\_\_\_



\_\_\_\_\_ E-mail \_\_\_\_\_

Date of purchase\* \_\_\_\_\_

\* We recommend you keep the receipt with this warranty card.

Location of purchase \_\_\_\_\_

Description of malfunction:

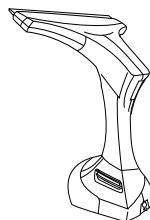

If after contacting the manufacturer you are requested to return the faulty product please return the completed warranty card together with it.

GB: Jaleno Europe Limited,  
Roe Head House, Far Common Road  
Mirfield, West Yorkshire, WF14 0DQ,  
ENGLAND

IRE: Kenilworth Electrical,  
253 Harolds Cross Road  
Dublin,  
IRELAND

**AFTER SALES SUPPORT**

GB 01924 481053



IRE 01-4968036/4963993



customerservice@jaleno.com

kenilworthelec@eircom.net

MODELL: 4125

PRODUCT CODE: 93147

01/2016

**Hotline: toll-free**

GB: Phone lines available  
Monday to Friday  
8.00 am-4.00 pm.

IRE: Phone lines available  
Monday to Friday  
9.00 am-5.00 pm.

3

YEARS  
WARRANTY



---

## Warranty conditions

Dear Customer,

The **ALDI warranty** offers you extensive benefits:

**Warranty period:** **3 years** from date of purchase.

**Costs:** Free repair/exchange.  
No transport costs.

**Hotline:** Free hotline.

<b>ADVICE:</b>	Please contact our service hotline by phone, e-mail or fax before sending in the device. This allows us to provide support in the event of possible operator errors.
----------------	--

**In order to make a claim under the warranty, please send us:**

- the faulty item together with the original purchase receipt and the completed warranty card.
- the product with all components included in the packaging.

---

**The warranty does not cover** damage caused by:

- **Accident** or **unanticipated events** (e.g. lightning, water, fire).
- **Improper use** or **transport**.
- **Disregard of the safety** and **maintenance instructions**.
- Other **improper treatment** or **modification**.

After the expiry of the warranty period, you still have the possibility to have your product repaired at your own expense. If the repair or the estimate of costs is not free of charge you will be informed accordingly in advance.

This warranty does not affect your statutory rights.

---





**Spend a little Live a lot**

Great care has gone into the manufacture of this product and it should therefore provide you with years of good service when used properly. In the event of product failure within its intended use over the course of the first 3 years after date of purchase, we will remedy the problem as quickly as possible once it has been brought to our attention. In the unlikely event of such an occurrence, or if you require any information about the product, please contact us via our helpline support services, details of which are to be found both in this manual and on the product itself.



**PRODUCED IN CHINA FOR:**

ALDI STORES LTD. PO BOX 26, ATHERSTONE  
WARWICKSHIRE, CV9 2SH.

ALDI STORES (IRELAND) LTD.  
PO BOX 726, NAAS, CO. KILDARE.  
Visit us at [www.aldi.com](http://www.aldi.com)

**AFTER SALES SUPPORT**



01924 481053



01-4968036/4963993



[customerservice@jaleno.com](mailto:customerservice@jaleno.com)

[kenilworthelec@eircom.net](mailto:kenilworthelec@eircom.net)

MODEL: 4125

PRODUCT CODE: 93147

01/2016

**3**

**YEARS  
WARRANTY**