

# BRAUN

## TributeCollection



Type 4161

Register your product  
[www.braunhousehold.com/register](http://www.braunhousehold.com/register)

CJ 3000  
Citrus juicer

English 4

**中文** 6

De'Longhi-Braun-Household GmbH  
Carl-Ulrich-Straße 4  
63263 Neu-Isenburg/Germany

5722610144/03.18  
UK/CN



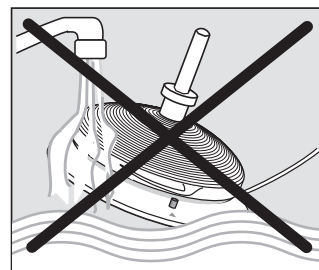
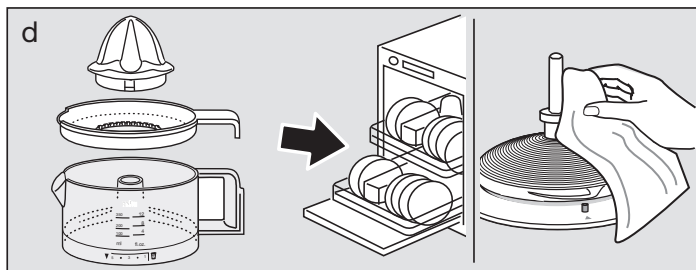
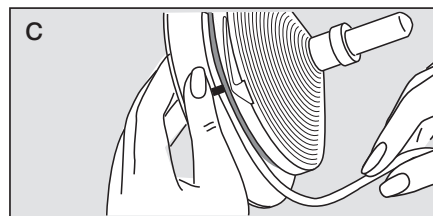
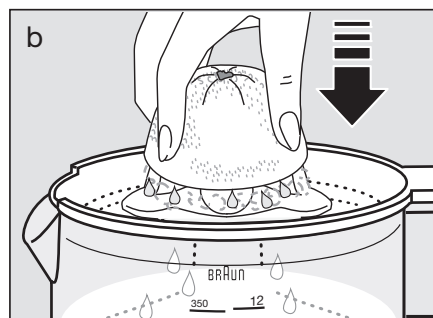
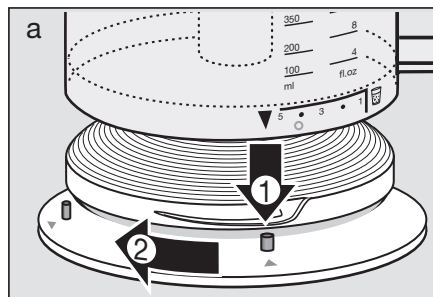
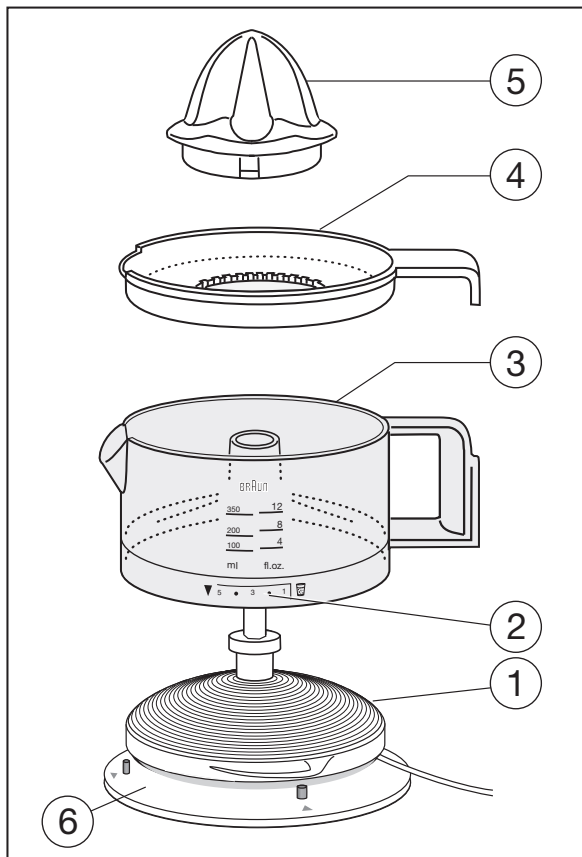

# English

Our products are engineered to meet highest standards of quality, functionality and design. We hope you thoroughly enjoy your new Braun appliance.

## Before use

**Please read instructions carefully and completely before using the appliance.**

## Caution

- This appliance can be used by children aged from 8 years and above and persons with reduced physical, sensory or mental capabilities or lack of experience and knowledge if they have been given supervision or instruction concerning use of the appliance in a safe way and understand the hazards involved.
- Children shall not play with the appliance.
- Cleaning and user maintenance shall not be made by children unless they are older than 8 years and supervised.
- Children younger than 8 years shall be kept away from the appliance and its mains cord.
- If the supply cord is damaged, it must be replaced by the manufacturer, its service agent or similarly qualified persons in order to avoid a hazard.
- Always switch off and unplug the appliance when it is left unattended and before assembling, disassembling, cleaning and storing.
- Never immerse the unit in water or other liquids.

- This appliance is designed for household use only and for processing normal household quantities.
- Please clean all parts before first use or as required, following the instructions in the Care and Cleaning section.
- Before plugging into a socket, check whether your voltage corresponds with the voltage printed on the bottom of the appliance.

## Parts and Accessories

- 1 Motor block
- 2 Pulp scale
- 3 Jug
- 4 Strainer
- 5 Cone
- 6 Cord storage

### Maximum capacity

350 ml

### Unpacking

Take the unit out of the carton. Remove all pieces of the packing. Remove any possibly extant labels on the unit (do not remove the rating plate).

## Assembling and disassembling

Press the cone (5) into the strainer (4) until the cone engages, then place the strainer on the jug (3).

To place the jug on the motor block (1), proceed as follows:

The arrow at the left end of the pulp scale (2) must be positioned over one of the arrows on the motor block (a). Then turn the jug clockwise until it is locked on the motor block. When disassembling, proceed in reverse order.

## Adjustable fruit pulp content

The amount of fruit pulp in the juice can be continuously adjusted by turning the jug (3) within the pulp scale (2)

(a):

5 = high fruit pulp content,

1 = low fruit pulp content.

## Cord store

There is a practical cord store (6) underneath the motor block (1). You only need to unwind as much cord as you need (c). To do this, remove the jug from the motor block.

## Extracting juice

After assembling the appliance (and adjusting the desired fruit pulp content), press a halved citrus fruit onto the cone (5), (b). When the fruit is pressed down, the motor will start. When removed from the cone, the motor turns off automatically. Switching the motor on and off by lifting and pressing down the fruit, can cause the cone to change directions and increase the amount of juice extracted. Before serving the juice, remove the jug from the motor block.

## Cleaning

Before cleaning, always unplug the appliance. Disassemble the appliance as described. Clean the motor block (1) with a damp cloth only. All the other parts can be cleaned in the dishwasher (d).

Both the design specifications and these user instructions are subject to change without notice.

Materials and accessories coming into contact with food conform to EEC regulation 1935/2004.



Please do not dispose of the product in the household waste at the end of its useful life. Disposal can take place at a Braun Service Centre or at appropriate collection points provided in your country.



# 中文

我们的产品具有优异的设计，完备的功能和可靠的品质，符合高水平的质量标准。希望您对新款博朗产品满意。

**使用本产品前，请仔细阅读使用说明书，并妥善保管。**

## 注意

- 该产品不适宜儿童或是在身体、精神上存在缺陷者使用，除非有专人负责照看以保证他们的安全。请勿让儿童在无人监管的情况下把玩、清洁、维护修理该产品。
- 请将本产品机器电线置于孩童触摸不到的地方。
- 若无人看管，或安装，拆卸及清洁本产品时，请务必拔掉电源插头。
- 本产品仅限于一般家庭用途。
- 将电源插头连接到插座上之前，请确认所用电压与本产品底部标示的电压值相符合。
- 请勿将电源底座(1)浸入到水中，或将其置于流动的水下。
- 如产品(包括电源线)出现任何故障，应立即停止使用，并将其送至博朗服务中心维修。任何错误或者不合格的维修都可能会导致意外事故的发生，对用户造成伤害。博朗电器满足使用的安全标准。

## 产品描述

- 1 电源底座
- 2 果肉含量刻度
- 3 果汁杯
- 4 果渣过滤器
- 5 锥形榨汁头
- 6 电线存储格

## 最大容量

350毫升

## 安装和拆卸

向下按压锥形榨汁头(5)，直至其嵌入果渣过滤器(4)，然后将果渣过滤器放在果汁杯(3)上。

将果汁杯安装到电源底座(1)上，安装流程如下：

将果肉含量刻度(2)左端的箭头对准电源底座(a)上的一个箭头安装在底座上。

然后顺时针旋转果汁杯直至其锁实在电源底座上。拆卸时，沿逆时针方向旋转。

## 可调节果肉含量

果汁中果肉含量可以通过调节果汁杯(3)上的果肉含量刻度(2)所示的范围内进行调节，如(a)所示：

5=果肉含量高

1=果肉含量低

## 电线存储格

电源底座(1)底部设有实用的电线存储格(6)。您可以根据需要,解开适当长度的电线,如(c)所示。操作时,请将果汁杯从电源底座上卸下。

## 榨汁

将产品安装完毕后(同时调节好理想的果肉含量),将对半切开的柑橘类水果压在锥形榨汁头(5)上,如(b)所示。

当水果被向下按压时,马达开始工作。

将水果从锥形榨汁头上移开时,马达自动停止工作。通过在锥形榨汁头上提起和按压水果,即可令马达停止和开始工作,亦可令锥形榨汁头改变旋转方向以增加榨汁量。

倒出果汁前,请先将果汁杯从电源底座上卸下。

## 清洁

对本产品进行清洁前,请务必拔下电源插头。

如前所述对本产品进行拆卸.仅可以使用湿布对电源底座(1)进行清洁。其他所有部件都可以使用洗碗机进行清洗,如(d)所示。

如有更改,恕不另行通知。

当本产品使用寿命结束后,请勿将其同生活垃圾一起处理。可送到博朗服务中心处置,或送到您国家提供的合适的回收点。

---

如果需要保修或维修,请与当地或就近的维修站联系。

客服热线: 400 827 1668



## 名称和产品中有害物质的含量

### Name and content of hazardous substances in products

组件 名称 Components Name	有害物质 Hazardous substances					
	铅 Lead (Pb)	汞 Mercury (Hg)	镉 Cadmium (Cd)	六价铬 Hexavalent Chromium (Cr (VI))	多溴联苯 Polybrominated biphenyls (PBB)	多溴二苯醚 Polybrominated diphenyl ethers (PBDE)
塑料外壳 和底盘 Plastic enclosure and chassis	○	○	○	○	○	○
电机、阀门 Motors, valves	○	○	○	○	○	○
电缆和电线 Cable and wiring	○	○	○	○	○	○
金属零件 Metal parts	○	○	○	○	○	○

本表格依据SJ/T 11364 的规定编制。This table is prepared in accordance with the provisions of SJ/T 11364.

○:表示该有害物质在该部件所有均质材料中的含量均在GB/T 26572规定的限量要求以下。

○: The content of such hazardous substance in all homogeneous material of such components is below the limit required by GB/T 26572.

X:表示该有害物质至少在该部件的某一均质材料中的含量超出GB/T 26572规定的限量要求。主要是由于受技术发展水平限制,暂时无法实现替代或减量化,但这部分零部件本身不直接与食物接触,正常使用条件下不会对使用者造成任何健康影响。我们的产品均通过食品安全检测,可安心使用。

X: The content of such hazardous substance in a certain homogeneous material of such components is beyond the limit required by GB/T 26572, **mainly due to the level of technical development situation, temporarily unable to achieve replacement or reduction. But this part of the component itself does not directly contact with food, it will not cause any health issue under normal conditions of use. All our products passed Food Safety Monitoring and can be used safely.**





