

IMPORTANT SAFEGUARDS

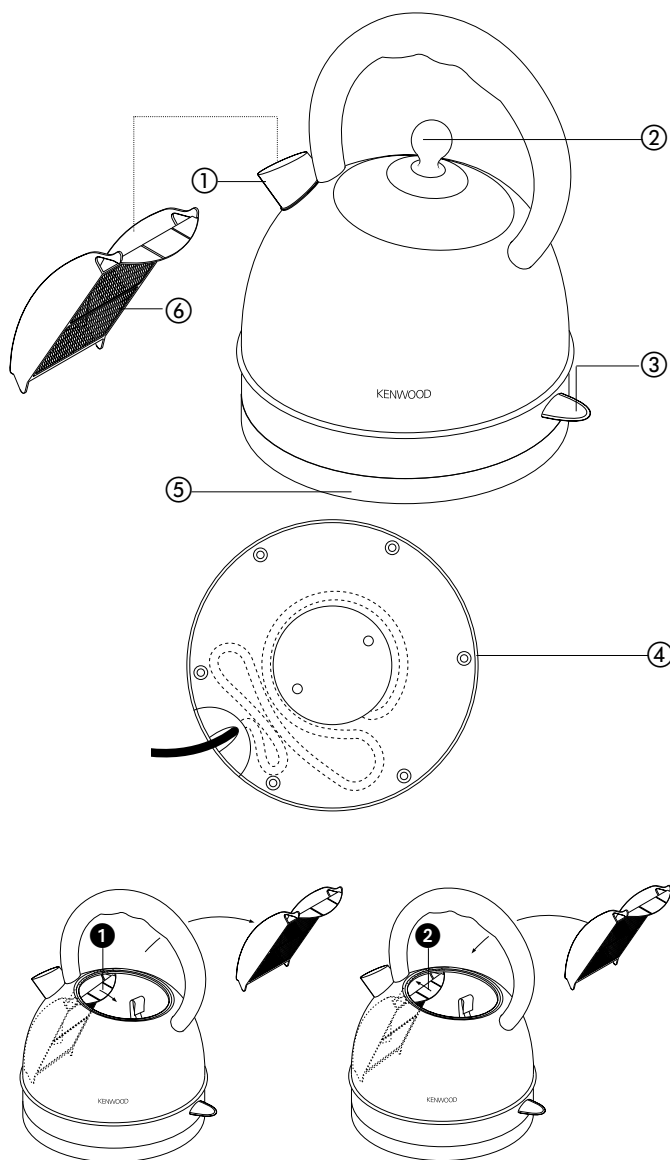

1. Read all instructions.
2. Do not touch hot surfaces. Use handles or knobs.
3. To protect against fire, electric shock and injury to persons do not immerse cord, plugs, kettle or power base in water or other liquid.
4. Close supervision is necessary when any appliance is used by or near children.
5. Unplug from outlet when not in use and before cleaning. Allow to cool before putting on or taking off parts, and before cleaning the appliance.
6. Do not operate any appliance with a damaged cord or plug or after the appliance malfunctions, or has been damaged in any manner. Return the appliance to the nearest authorised service facility for examination, repair or adjustment.
7. The use of accessory attachments not recommended by the appliance manufacturer may result in fire, electric shock or injury to persons.
8. Do not use outdoors.
9. Do not let cord hang over edge of table or counter, or touch hot surfaces.
10. Do not place on or near a hot gas or electric burner, or in a heated oven.
11. To disconnect appliance, turn any control to "off", then remove plug from wall outlet.
12. Do not use appliance for other than intended use.
13. Always ensure lid is fitted correctly before switching on and never remove lid whilst the kettle is boiling.
14. Scalding may occur if the lid is removed during the brewing cycles.

SAVE THESE INSTRUCTIONS

safety

- Avoid contact with steam coming out of the spout area when pouring and out of the lid when refilling.
- If you do not need so much cord, shorten it by pushing any excess cord inside the powerbase.
- Never overfill - boiling water may splash out.
- **Caution:** Do not operate the kettle on an inclined surface.
- Make sure the kettle is switched off before lifting or pouring.
- Remove the kettle from the base before filling or pouring.
- This kettle is for boiling water only.
- This kettle is for domestic use only.
- Failure to observe these cautions may result in damage to the kettle.

before plugging in

- Make sure your electricity supply is the same as the one shown on the underside of your kettle.

before using for the first time

- Remove all packaging and any labels.
- Fill to 'MAX', boil, then pour the water away.

know your Kenwood stainless steel kettle

- ① spout
- ② lid
- ③ on/off switch with neon
- ④ cord storage
- ⑤ 360° powerbase
- ⑥ scale filter

to use your stainless steel kettle

- 1 Open the lid to fill. The water level must be between 'Max' and 200ml (1 cup).
 - Be economical: do not boil more water than you need.
 - To improve the quality of your drinks always use fresh water.
 - Empty the kettle after each use.
 - 2 Check the lid is closed.
 - 3 Plug in and switch on. The neon will come on.
 - 4 Your kettle will boil and switch off automatically. To re-boil, wait a few seconds - the on/off switch needs time to reset.
 - Your kettle is fitted with a scale filter to hold back limescale particles.
 - If you find drops of water under your kettle, don't worry - it is just condensation.
- boil-dry protection**
- If you switch on with too little water, your kettle will cut out automatically. Switch off and let it cool down before re-filling. When it has cooled down, the switch will reset itself.

care and cleaning

Before cleaning, unplug your kettle and let it cool down.

the outside and powerbase

- Wipe with a damp cloth, then dry. Do not use abrasives - they will scratch the metal and plastic surfaces.

the inside

- Wipe with bicarbonate of soda on a damp cloth. Rinse thoroughly.
- Even though your kettle comes with a scale filter, you still need to clean the inside (and the filter) regularly.

the scale filter

- 1 Open the lid.
- 2 Remove the scale filter by ❶ pushing down on the tab to release.
- 3 **either** rinse under the tap or use a soft brush.
 - or** when descaling your kettle, drop the filter in too. Rinse thoroughly.
- 4 To re-fit the scale filter, push it in (from inside the kettle) until secure ❷.

descaling

- When limescale builds up on the heating element, buy a suitable descaler and descale your kettle. Limescale makes your kettle take longer to boil and can make the element burn out. After descaling, boil with fresh water several times and discard. Clean any descaler off the kettle - it can damage the parts.
- Some regions of the country have chalky water. This makes boiled water look cloudy and leaves a deposit on the side of the kettle. This is normal but can be removed with regular cleaning.
- Alternatively, to reduce limescale build up, use filtered water to fill your kettle.

A short power-supply cord is provided to reduce the risks resulting from being entangled in or tripping over a longer cord.

Longer detachable power-supply cords or extensions cords are available and may be used if care is exercised in their use. If a long detachable power-supply cord is used, the marked electrical rating of the detachable power-supply cord or extension cord should be at least as great as the electrical rating of the appliance and should be of the grounding 3-wire type. The longer cord should be arranged so that it will not drape over the counter top or table top where it can be pulled by children or tripped over.

repairs and servicing

Kenwood is distributed by Maverick Industries Inc.

CAUTION-There are no consumer serviceable parts inside the kettle. Do not attempt any repairs or servicing on your own. If repairs or servicing are required, contact Maverick Industries for instructions on how to pack and ship the kettle to Maverick's service center located as follows:

Maverick Customer Service
94 Mayfield Ave. Edison NJ 08837
Telephone (732) 417-9666
Hours: weekdays 8:30 AM - 4:30 PM

1 year warranty

Maverick Industries Inc. warrants this Kenwood product to be free of defects in parts, materials and workmanship for a period of 1 year, from date of purchase.

Should any repairs or servicing under this warranty be required, contact Maverick Customer Service by mail or phone for instructions on how to pack and ship the product to Maverick's National Service Center located as follow:

Maverick Customer Service
94 Mayfield Ave. Edison NJ 08837
Telephone (732) 417-9666
Hours: weekdays 8:30 AM - 4:30 PM

Do not send any parts or product to Maverick without calling and obtaining a Return Authorization Number and instructions.

This warranty is VOID if instructions for use are not followed; for accidental damage; for commercial use; for damage incurred while in transit; or if the product has been tampered with.

This warranty gives you specific legal rights and you may also have other rights which vary from state to state.

KENWOOD



SK950 series



Maverick Industries Inc
94 Mayfield Avenue, Edison, New Jersey 08837, USA 2669/1