

## Technical specifications

Model:	4164
Product number:	361 124
Mains voltage:	220 - 240 V ~ 50/60 Hz
Power:	1500 watts
Fusing:	Temperature safety switch Overheating cut-out
Measuring cup:	Filling quantity at top measure mark = max. 250 ml
Water tank volume:	max. 350 ml
Protection class:	I 
Protection type:	IPX4
Noise level:	The workplace-related noise emission of the appliance is <67 dB(A) at a distance of 30 cm
Ambient temperature:	+10 to +40°C
Manufactured by:	DeLonghi Appliances Srl Via S. Quirico, 300 50013 Campi Bisenzio (FI) Italy



## Disposal

The product and its packaging have been manufactured from valuable materials that can be recycled. Recycling reduces the amount of refuse and helps to preserve the environment.

Dispose of the **packaging** at a recycling point that sorts materials by type. Make use of the local facilities provided for collecting paper, cardboard and lightweight packaging.



**Appliances** marked with this symbol must not be disposed of along with household refuse!

You are legally bound to dispose of old appliances separately from household waste. Information about where old appliances can be disposed of free of charge is available from your local authorities.

**Product number: 361 124**

20

20

# Ariete

De'Longhi Appliances Srl.  
Divisione Commerciale Ariete  
Via San Quirico, 300  
50013 Campi Bisenzio, FI - Italy  
E-mail: [info@ariete.net](mailto:info@ariete.net)  
Internet: [www.ariete.net](http://www.ariete.net)

## Steam Mop

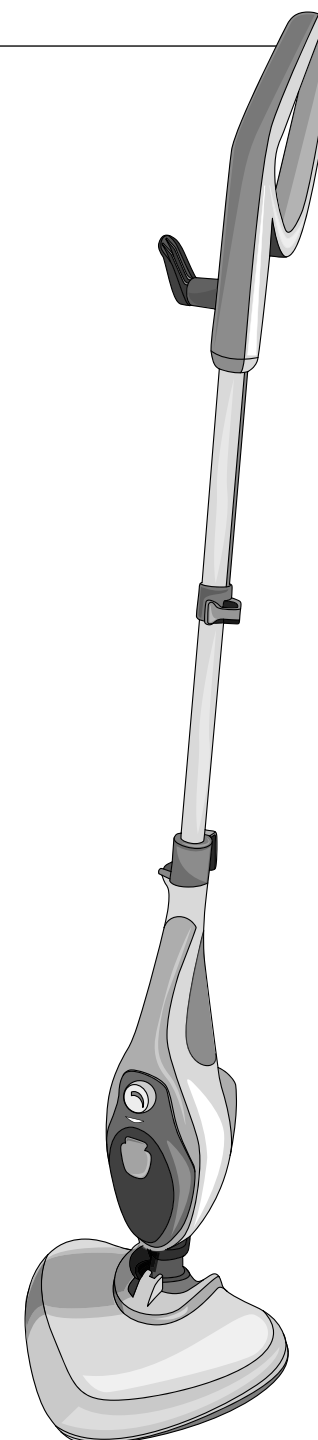

 **Instructions for use**

95945AB4X3VIII • 2018-02

**Model: 4164**

1

## Dear Customer

With your new steam mop you can powerfully and hygienically use steam to clean floors, carpets, windows, upholstery and textiles. And you can do all this in an environmentally-friendly way without cleaning agents and chemicals.

The practical water tank can hold enough water to produce steam for 15-18 minutes and can be refilled at any time.

We have included many various accessories so that you can optimally use the steam mop for all purposes.

We hope you enjoy using your new steam mop.

## Contents

<b>3 About these instructions</b>	<b>17 Cleaning and maintenance</b>
<b>4 Safety warnings</b>	17 Cleaning and maintenance after use
<b>8 At a glance (features)</b>	17 Descaling
<b>9 Prior to first use</b>	<b>19 Problems / solutions</b>
<b>11 Use</b>	<b>20 Technical specifications</b>
12 After use	<b>20 Disposal</b>
<b>13 Using accessories</b>	
13 Cleaning carpets	
13 Using smaller accessories...	
15 Cleaning textiles	
15 Cleaning glass and mirrors	

## Problems / solutions



### **WARNING** - risk of injury

• Immediately switch off and unplug the appliance in the case of malfunctions or electrical failures. Wait until the appliance has cooled down before proceeding with other measures. Do not open the appliance or try to repair it yourself. If the solutions listed here do not solve the problem, contact the customer care service or a specialist.

- |  |  |
|--|--|
| • The temperature indicator light does not light up. | • Appliance plugged in? Try plugging the appliance into a different wall socket.   |
|  | • Appliance switched on? Turn the steam dial anti-clockwise.   |
| • No steam is coming out.                            | • Steam dial set to minimum? Turn it towards maximum to increase the amount of steam.  |
|  | • The appliance is not warm enough yet. Wait a few more seconds until the appliance has reached the necessary temperature.   |
|  | • Not enough water in the tank? Fill the tank.   |
|  | • Limescale deposits in the appliances? Clean out any limescale deposits in the nozzles. Completely descale the appliance at your next convenience. In the future, use 50% tap water and 50% distilled water.  |
| • Appliance louder than before.                      | • No water in the tank? Fill the tank.   |
| • Water is leaking from the nozzles.                 | • Water condensation in the steam outlet? Turn the steam dial until no more steam comes out. If water is still coming out, place a cloth underneath the appliance and switch it off. Let the appliance cool down for approx. 5 minutes and then switch it on again. If the problem continues, consult the customer care service. |

**We recommend descaling the appliance at most every 3 months, and once a month if the water is particularly hard.**



**WARNING** - risk of injury and material damage

- Never leave the appliance unattended while it is connected to the mains.
- Descale the appliance in a well-ventilated room. Avoid directly inhaling the steam that is released while descaling.
- Direct the steam at a non-sensitive surface or a washable cloth, etc.

1. Fill the tank with a solution of 1/3 vinegar and 2/3 water, with a total volume of max. 350 ml.
2. Place the appliance on a non-sensitive surface, placing a cloth underneath it if necessary.
3. Plug the mains plug into a wall socket.
4. Switch the appliance on for 1 minute (turn the steam dial as far anticlockwise as possible).
5. Then switch the appliance off for 1 minute (turn steam dial to **O**).
6. Repeat steps 4 and 5 until you can clearly see a jet of steam being released.

7. Let the appliance operate until the solution in the tank has been completely used up. If necessary, repeat the entire process.
  8. Then switch the appliance off and unplug it at the mains socket.
  9. Rinse out the tank with fresh tap water and then empty it completely.
  10. Now fill the tank with 350 ml of fresh tap water again (or if the water is particularly hard, use a mixture of 50% tap water and 50% distilled water).
  11. Plug the mains plug in again, switch the appliance on and eject steam until the tank is empty. If necessary, repeat until the appliance releases a clean jet of steam. You can check this by wiping a clean, dry cloth over the bottom of the steam head. Switch the appliance off before doing so - risk of scalds!
- ▷ To remove limescale deposits from the accessories, soak them for a while - depending on how dirty they are - in a solution of water and vinegar. Fix the accessories on the appliance and release steam until the accessories are clean.

## About these instructions

This product is equipped with safety features. Nevertheless, read the safety warnings carefully and only use the product as described in these instructions to avoid accidental injury or damage.

Keep these instructions for future reference.

If you pass this product on to another person, remember to give them these instructions.

Symbols in these instructions:



This symbol warns you of the danger of injury.



This symbol warns you of the danger of injury caused by electricity.



This symbol warns you of the danger of injury caused by hot surfaces and scalds.



This symbol warns you of the danger of material damage.

The term **DANGER** warns of potential severe injury and danger to life.

The term **WARNING** warns of injury and severe material damage.

The term **CAUTION** warns of minor injury or damage.



This indicates additional information.

## Safety warnings

### Intended use

- The steam mop is intended for steam cleaning smooth floors such as marble, stone, tiles, parquet and hard wood - as long as these surfaces are treated and waterproof.
- With the accessories indicated here, the steam mop is also suitable for treating carpets, upholstery, textiles and windows.
- The appliance uses active steam without the addition of cleaning agents.
- The product is suitable for private use and is not suitable for commercial purposes.

### WARNING - hazards resulting from misuse

- Do not use on:
  - waxed surfaces. The steam would remove the wax.
  - untreated or absorbent floors.
  - sensitive synthetic fabrics or leather.
- On wooden floors, do not leave the appliance switched on in one place for a long time, as long exposure to steam/water could cause the wood to swell.
- Test the effect of the appliance in an inconspicuous place on the surface first. If necessary, consult the manu-

facturer of the surface to be cleaned, or ask specialists for advice.

### DANGER to children and people with restricted capabilities of operating appliances

- This appliance must not be used by children. Children must not be allowed to play with the appliance.
- This appliance may be used by people with reduced physical, sensory or mental capabilities or lack of sufficient experience and/or knowledge, provided they are supervised or have been trained in the safe use of the appliance and understand the potential dangers.
- Keep children away while using the appliance and while letting it cool down after use.
- Keep the packaging material away from children. There is a risk of suffocation!
- If disposing of the appliance, safely cut the mains cord to ensure that it can no longer be used. Remove all parts that may be dangerous for children.

### DANGER due to electricity

- The steam must not be directed at electrical appliances (e.g. the back of refrigerators, oven interiors, switches, wall sockets, lights, etc.).
- The appliance's tank is filled with water. However, you should never

## Cleaning and maintenance



### DANGER - risk of fatal electric shock

- Remove the mains plug from the wall socket before cleaning the appliance.
- The motor unit must not be immersed in water. Also protect it from drips and splashes of water.



### WARNING - risk of burns/scalding

- Let the appliance and remaining water in the tank cool down sufficiently before emptying the tank and storing the appliance away.



### CAUTION - material damage

- Do not use any caustic, aggressive or abrasive products for cleaning.
- Do not pour any cleaning or descaling agents, alcohol, fragrances or any liquids other than those listed in these instructions into the tank.

### Cleaning and maintenance after use

1. Unplug the mains plug and allow the appliance to cool down.
  2. Empty the water tank in order to avoid limescale deposits.
  3. Regularly clean the water tank with a solution of fresh tap water and 1 tbsp vinegar. Simply rinse out the tank with this solution, without switching on the appliance.
  4. Then empty the tank completely and rinse it out again with clear water.
- ▷ Wipe off the surfaces of the appliance and the accessories with a soft, slightly dampened cloth and then dry them with a dry cloth.

- ▷ The cloth pads and textile pad can be washed in the washing machine at 30°C. Also take note of the care instructions on the sewn-in label.
- ▷ Make sure the mains cord is undamaged before each use. If damaged, ask the customer service department about options for a replacement.

### Descaling

The warranty does not cover damage due to limescale. Regularly descaling your appliance will protect it and keep it working its best for a long time to come. It is necessary to descale the appliance straight away if the appliance is no longer functioning properly (only a little or no steam is released).

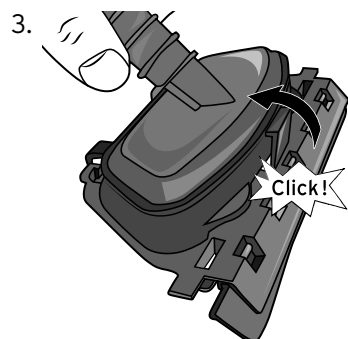

Fold the window wiper closed.

4. Remove the steam head and telescopic rod from the motor unit (see "Prior to first use", figure 2 and figure 4).

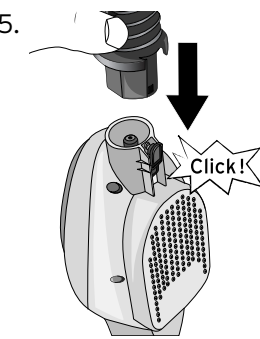
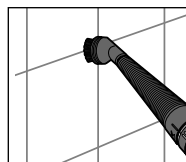
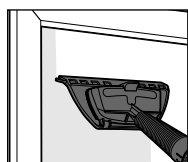

Attach the combined attachment to the bottom of the motor unit.

- To remove the window wiper, push back the lock and lift the textile attachment up and off.

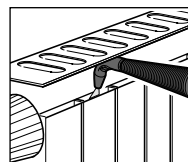
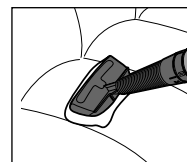

immerse the appliance itself or its mains plug in water as this could result in electric shock.

- Do not touch the appliance with damp hands and do not operate it outdoors.
- Never leave the appliance unattended while it is connected to the mains.
- Remove the mains plug from the wall socket...
  - ... if you stop or interrupt use - even for a short time,
  - ... before filling the tank with water,
  - ... before cleaning the appliance,
  - ... when replacing attachments,
  - ... if disturbances occur or the appliance is damaged,
  - ... during thunderstorms.
 When doing so, always pull on the plug, not the mains cord.
- The wall socket must be easily accessible so that the appliance can be unplugged quickly if necessary.
- The mains cord must not be kinked or squeezed. Keep it away from hot surfaces and sharp edges.
- Never carry or pull the appliance by its mains cord.
- Only connect the appliance to a professionally installed, earthed wall socket that complies with the "Technical specifications" of the appliance.
- Should it be necessary to use an extension cable, it must comply with the

"Technical specifications" of the product. Consult a specialist retailer when purchasing an extension cable.

- Do not plug any other high-power appliances (e.g. iron, electric heater) into the same socket, as this could overload the electrical circuit. Do not use a multi-outlet.
- Never use the appliance if any part of it or its mains cord is visibly damaged or if it has been dropped.
- Do not disassemble the appliance. Do not attempt to replace the mains cord yourself. Improper repairs can lead to a considerable risk of injury to the user. Therefore, only have repairs to the appliance or to the mains cord carried out by a specialist workshop or contact the customer care service.
- Only use the accessories provided. Using other accessories that are not recommended or are not supplied directly from the manufacturer may lead to a risk of fire, electric shock and/or injury of various kinds.

**WARNING - risk of scalds/burns and fire**

- Never direct the steam at people, animals, plants or delicate objects.
- Only switch the appliance on when it is in the correct operating position.
- Unplug the appliance from the wall socket when not using it (even if inter-

rupting your work for a short time). Place the appliance on a heat-resistant surface when still hot.

- Never touch the hot surfaces of the appliance while in use and for at least 5 minutes after use. Keep your hands away from the hot water and steam jet.
- Unplug the mains plug and let the appliance cool down for at least 5 minutes...
  - ... before removing the cloth pad,
  - ... before attaching, removing, or changing accessories,
  - ... before cleaning the appliance,
  - ... before leaving the appliance unsupervised.
- Only store away the appliance after it has cooled off completely. Always empty the water tank before storing the appliance away.
- Keep the appliance away from curtains and other flammable materials.
- Always unwind the mains cord completely before use as it may overheat while in operation.
- Do not direct the appliance over its own mains cord or the cords or cables of any other appliance while in use.
- Do not use the appliance in...
  - ... rooms where there is a risk of explosion, e.g. if there are fumes from oil-based paints or solvents,
  - ... enclosed spaces where there could

be fumes from waterproofing agents, explosive powders or other toxic or explosive fumes.

#### **WARNING - risk of injury**

- Take extra care when using the appliance on stairs. There is a risk of tripping and falling!
- Also be especially careful if using a ladder or something similar.
- Put the appliance away after use so that it cannot be tripped over.

#### **CAUTION - material damage**

- Only use tap water or distilled water to fill the tank. For especially hard water we recommend a 50/50% ratio of tap and distilled water. Do not use carbonated water. Cleaning detergents, descalers, alcohol, fragrances or other liquids must not be added, as they can damage the appliance or cause it to become dangerous.
- Never operate the appliance without water as this may cause the pump to burn out. Regularly check how much water is in the tank.
- Only use the supplied accessories or original accessories provided by the manufacturer.
- Always test fabrics, carpets, treated terracotta floors, wooden floors and the like on an inconspicuous part of the material in order to determine whether it is heat-resistant and suit-

#### **Cleaning textiles**



aging the textile!

The **textile attachment** with the **textile pad** is suitable for smoothing out wrinkles and creases in upholstery, tablecloths and clothing. Always use it together with the textile pad to avoid dam-

#### **Mounting the textile attachment**

1. Remove the steam head and telescopic rod from the motor unit (see "Prior to first use", figure 2 and figure 4).

2.  Pull the textile pad over the attachment.

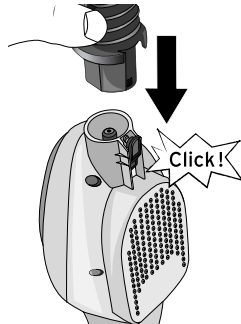
3.  Attach the textile attachment to the bottom of the motor unit.

#### **Cleaning glass and mirrors**

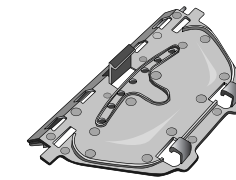

The **window wiper** it mounted on the textile attachment (without the textile pad) and is

suitable for cleaning windows, mirrors, shower panels, etc.

 Be careful when cleaning cold window panes! The thermal shock could cause the glass to break. Warm up the glass first before cleaning it, especially during colder seasons. Do so by first holding the appliance a sufficient distance (approx. 40 cm) away from the window and carefully spraying steam onto it.

#### **Mounting the window wiper**

1. Remove the textile pad from the textile attachment if necessary.

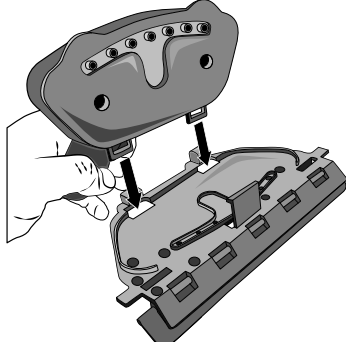
2. 

Attach the window wiper to the textile attachment.





The **angled nozzle** is especially useful in tight angles and corners, such as heaters, window shutters, toilets, etc.

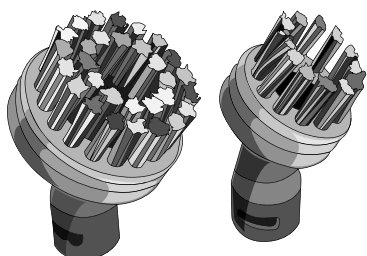

The **large and small round brushes** help remove limescale deposits or food or other residue that has dried onto surfaces such as on stovetops, metal racks in barbecues and ovens, or in sinks, showers, etc.

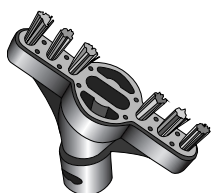

The **grout brush** is especially useful in cleaning the areas between wall and floor tiles, etc.

#### Mounting small accessories

Proceed as follows to mount smaller accessories:

1. Remove the steam head and telescopic rod from the motor unit (see "Prior to first use", figure 2 and figure 4).

2.

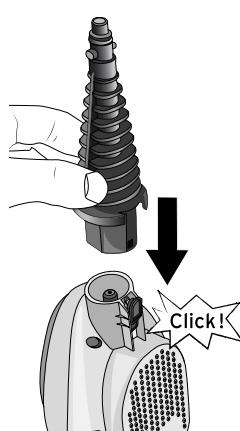

Attach the extension nozzle to the bottom of the motor unit.

3.

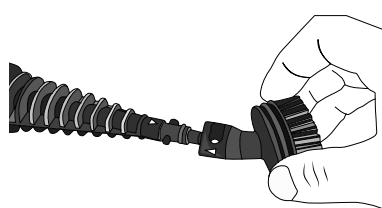

Insert the required accessory on the front of the extension nozzle. This only works in one direction! Take note of the two differently sized tips on the extension nozzle. These must be inserted in the matching groove in the accessory.

4.

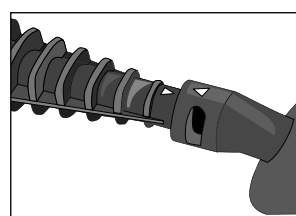

Turn the accessory until the arrow on the accessory and on the extension nozzle point to each other.

able for steam cleaning. If necessary, consult the manufacturer of the material to be cleaned.

- Never use the steam head without a cloth pad or with a damaged or worn cloth pad. Doing so could scratch or damage the surfaces you are cleaning.
- Do not use the steam head to clean glass surfaces. Instead, always use the window wiper.
- Be careful when cleaning cold window panes! The thermal shock could cause the glass to break. Warm up the glass first before cleaning it, especially during colder seasons. Do so by first holding the appliance a sufficient distance (approx. 40 cm) away from the window and carefully spraying steam onto it.
- The appliance must not be operated outdoors or in rooms with high humidity. Do not store it in rooms exposed to moisture such as cellars or garages. Protect the appliance from impacts, falls, dust, moisture, direct sunlight and extreme temperatures.
- Do not insert any objects into the openings on the appliance.
- Do not use abrasive or caustic products or hard brushes, etc. for cleaning.

## At a glance (features)

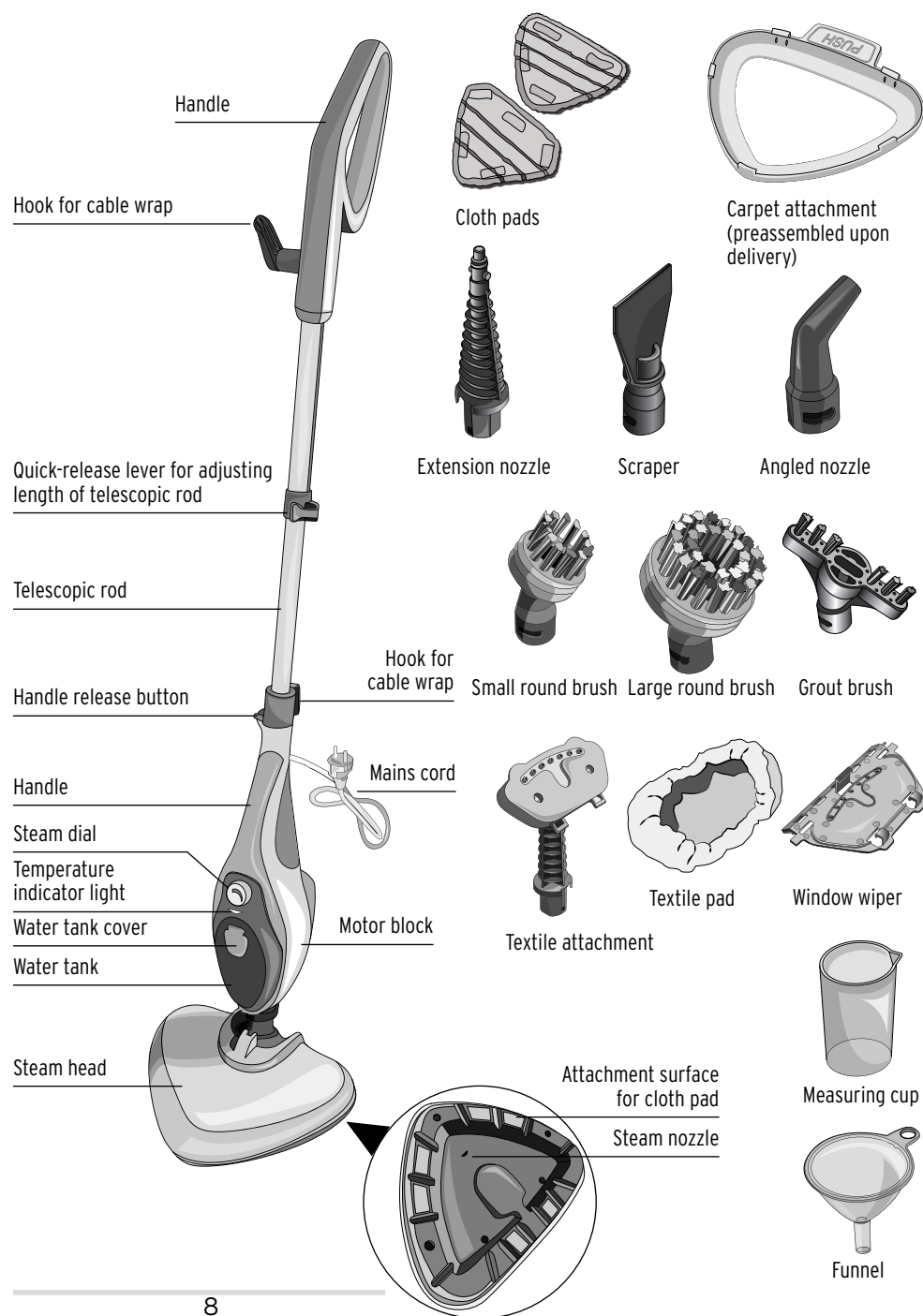

8

5.

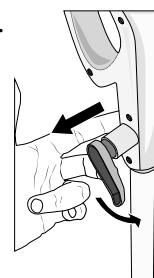

Wind up the cord: Pull out the top hook slightly and point it upwards.

6.



Wrap the cord around both hooks. Do not pull it too tight!

## Using accessories

### Cleaning carpets



The **carpet attachment** is intended for use on carpets and similar soft surfaces. Do not use on hard surfaces! Doing so could scratch the surface or damage the attachment. Always use it with the cloth pad on the steam head!

- ▷ Place the attachment on the floor with **PUSH** facing upwards. With the cloth pad attached, place the appliance with the steam head on top of the attachment and press down so that the hooks on the attachment latch onto the steam head.
- ▷ To remove, use your foot to press **PUSH** and lift the appliance upwards out of the attachment.

### Using smaller accessories...

... for particularly dirty or hard-to-reach areas.



The **extension nozzle** is suitable for cleaning dirtier areas that are not easily accessible such as in sinks, gas stoves (not electric stoves), etc.

It can also be used as a connecting piece for mounting other small accessories.



The **scraper** is suitable for scraping off more stubborn dirt.

13



parquet, wood or laminate. If necessary, use the steam dial to increase the amount of steam if the surface to be cleaned is very dirty and on non-sensitive floors (stone, tiles).

- ▷ **If the tank is empty**, you will feel the appliance vibrate and hear a loud droning sound. Immediately switch off the appliance (steam dial is in **O** position), remove the mains plug from the wall socket and refill the water tank as described in section "Prior to first use".



**WARNING** - risk of scalding

- Never change the cloth pad while the appliance is switched on. Hot steam is coming out.
- Do not turn the appliance or steam head upside down to remove the cloth pad. Hot water may flow out.

- ▷ **If you would like to wash out the cloth pad from time to time**, first switch off the appliance (steam dial in **O** position) and remove the mains plug from the wall socket. **Wait at least 5 minutes** for the appliance to cool down sufficiently before picking up the appliance and pulling off the cloth pad.

**After use**



**WARNING** - risk of burns/scalding

- Pull out the mains plug and let the appliance cool down for at least 5 minutes before removing the cloth pad or attaching, removing or switching accessories, or before cleaning the appliance or leaving it unattended.
- Only store away the appliance after it has cooled down completely.

1. Switch off the appliance (steam dial is in **O** position) and remove the mains plug from the wall socket.
2. Always empty the water tank before storing the appliance. Doing so prevents damaging limescale deposits from building in the tank.

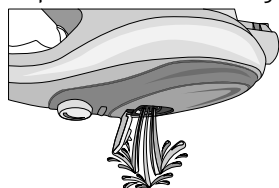

To empty the tank, carefully turn the motor unit upside

down and pour out the water.

3. Pull off the cloth pad. The cloth pad can be washed in the washing machine at 30°C. Also see the sewn-in label.

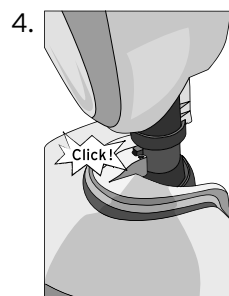

Place the appliance upright on the floor and then tilt it slightly forwards over the steam head until the joint snaps into place on the steam head.

**Prior to first use**

- ▷ Remove all the packaging material.

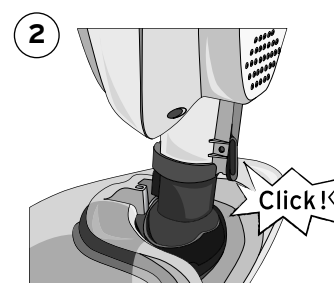
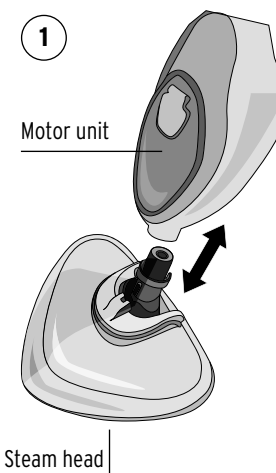

(Press lever down to remove steam head.)

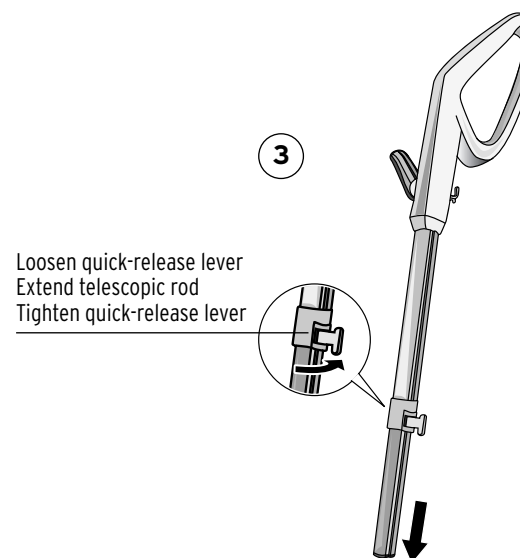

Loosen quick-release lever  
Extend telescopic rod  
Tighten quick-release lever

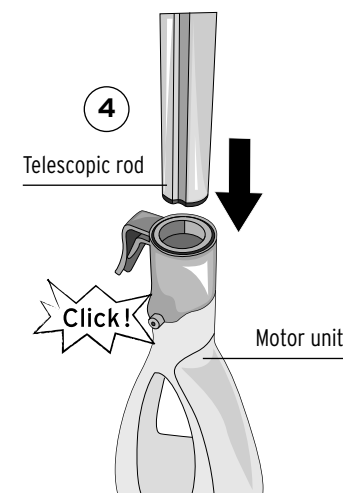

(Press button in to remove telescopic rod.)



### CAUTION - material damage

- Never fill the tank more than 350 ml! Only use tap water or distilled water to fill the tank. For especially hard water we recommend a 50/50% ratio of tap and distilled water.

5

1 full tank = 350 ml water = 1 1/2 measuring cup

Fold up the tank cover,  
fill with water,  
firmly close tank cover

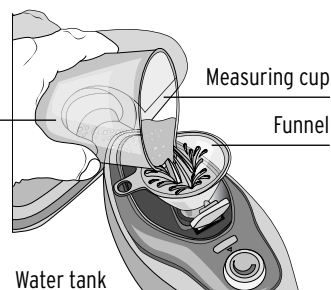

6a

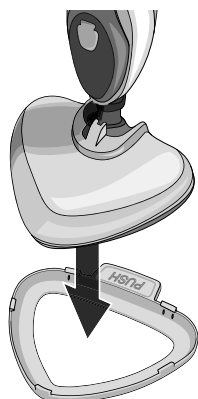

Remove carpet attachment if needed  
(see "Using accessories") ...

6b

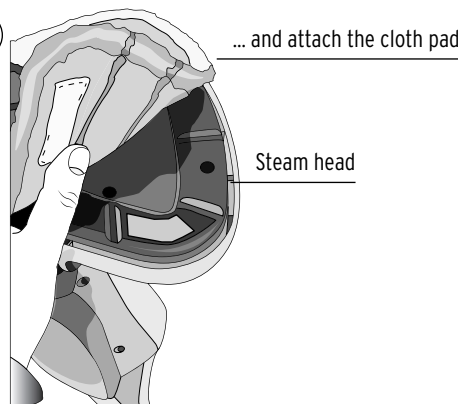

... and attach the cloth pad

7

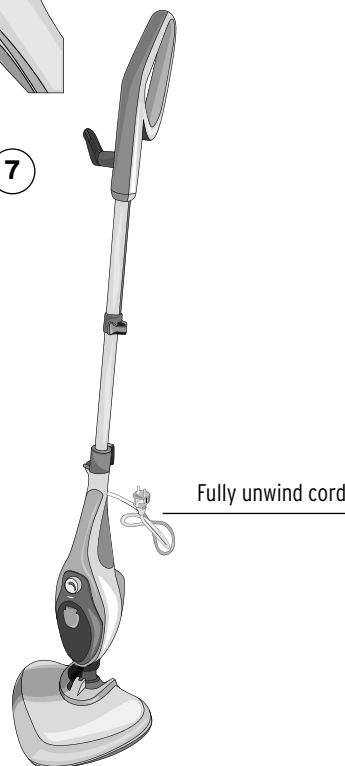

10

10

## Use



### CAUTION - material damage

- Never fill the tank more than 350 ml!
- Never operate the appliance without water as this may cause the pump to burn out. Regularly check how much water is in the tank.
- Never use the steam head without a cloth pad or with a damaged or worn cloth pad. Doing so could scratch or damage the surfaces you are cleaning.
- Only switch the appliance on when it is in the correct operating position.
- Before cleaning sensitive surfaces, always test the appliance in an inconspicuous place first to see whether the material is heat-resistant and suitable for steam cleaning.



If the steam mop is positioned in one place for a long time while switched on, a layer of white limescale may form around the edge. This can be easily removed with a little vinegar.

- ▷ Make sure that...
    - ... the water tank has enough water in it.
    - ... the mains cord is completely unwound,
    - ... a cloth pad is attached to the bottom of the steam head.
  - ▷ Vacuum the floor before using the steam mop in order to remove dirt and other particles.
1. Plug the mains plug into an earthed wall socket.

Direct the jet of steam into a bucket or similar when using the appliance for the first time or after not having used the appliance for a long time, as excess water may leak out.

2.

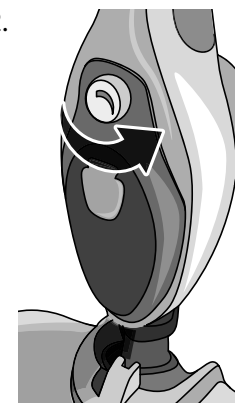

Turn the steam dial clockwise until it stops. The temperature indicator light lights up and the appliance is heating up. As soon as the water is sufficiently heated, steam

will be released - constantly (1 full tank = approx. 15-18 min.) for as long as the appliance is switched on.

3. To adjust the amount of steam, turn the steam dial between minimum and maximum. Always start at minimum. Stay at the minimum setting for floor surfaces such as

11

11