

instructions

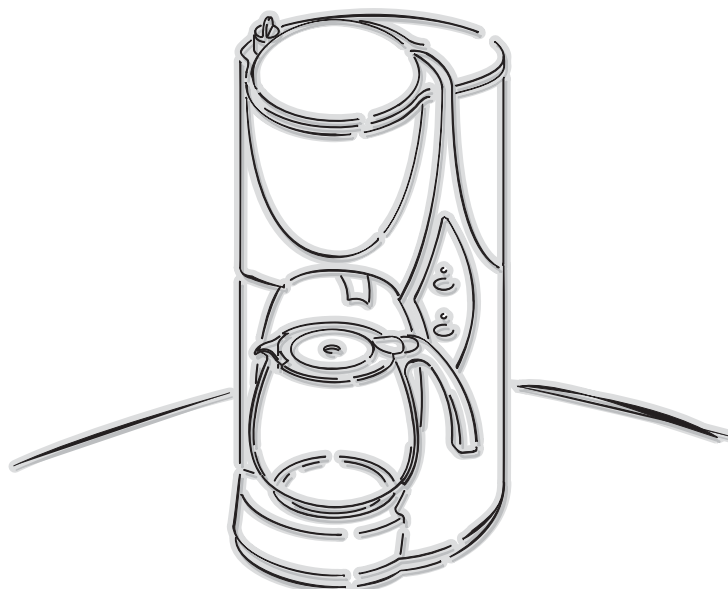

Filter Coffee Maker

ICM8/18



Living innovation

Description of appliance

The following terms are used throughout the instruction manual

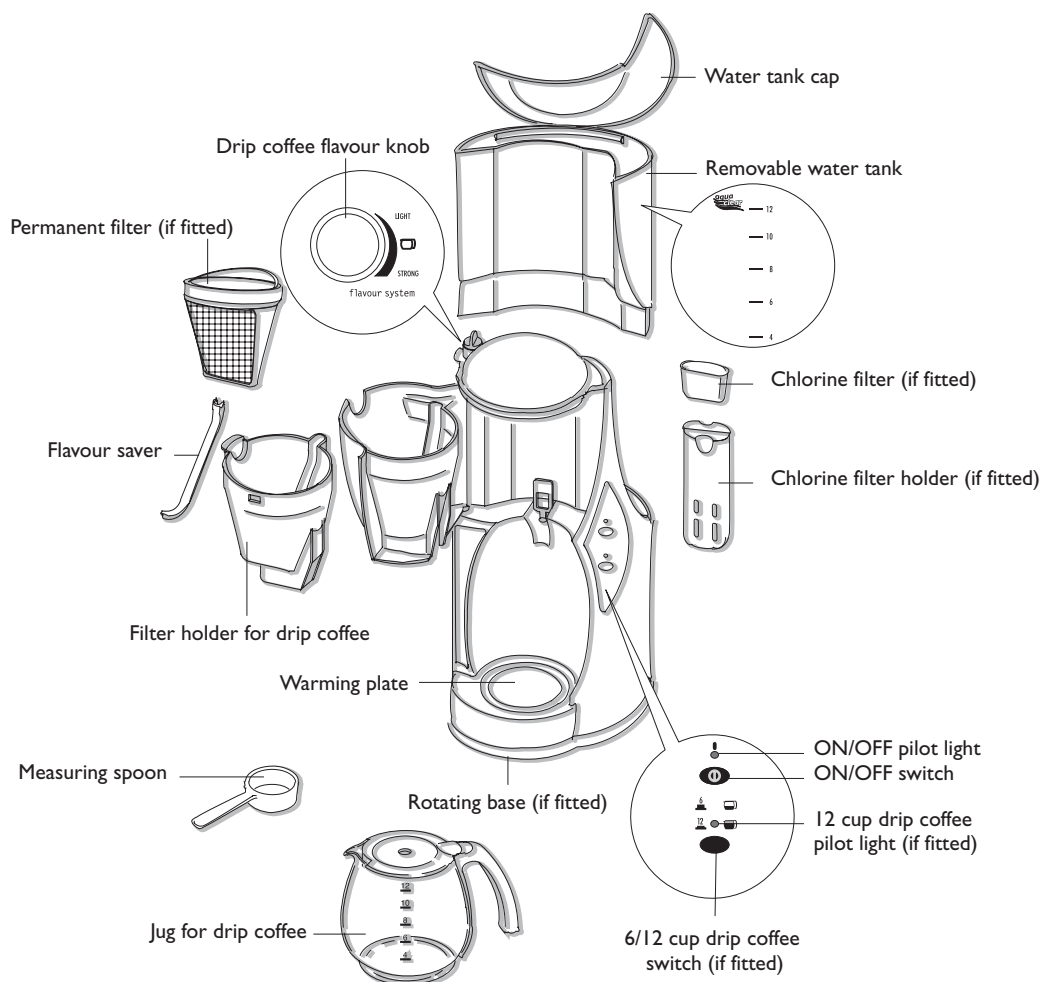

Thank you for choosing this coffee maker. To get the best results from your coffee maker it is advisable to read these instructions before using the appliance. This is the only way to ensure optimum results and maximum safety.

Using for the first time

Before using the machine for the first time, wash all the accessories in warm soapy water and rinse. For the best tasting coffee the internal circuits must be flushed through at least twice. To do this follow the instructions in the paragraph "How to prepare the filter coffee" without using ground coffee.

Installation

- Place the appliance on a working surface away from water taps and sinks.
- Check that the mains supply corresponds to the voltage on the appliance rating plate. Connect the appliance to a correctly-earthed power socket (minimum rating 10A) only. The manufacturer declines all liability for any accidents due to the incorrect earthing of the appliance.
- In the event of incompatibility between the plug on the appliance and the socket, have the plug replaced by a qualified professional.
- Never install the machine in environments where the temperature may reach 0°C or lower (the appliance may be damaged if the water freezes).
- If the power cable is longer than the distance required to reach the power socket, the extra length may be stored inside the machine by pushing the cable inside the corresponding opening.
- Please read safety warnings and electrical requirements (page 8 and 9) before operating this coffee maker.

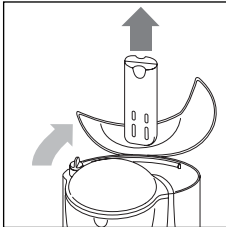

fig. 1

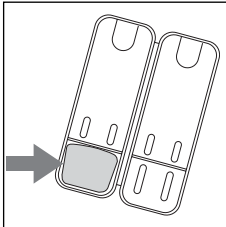

fig. 2

Chlorine filter (if fitted)

The filter eliminates the taste of chlorine from the water. To install the filter, proceed as follows :

- Remove the chlorine filter from the plastic bag and rinse it in tap water.
- Lift the water tank lid, remove the chlorine filter holder from its housing by lifting it upwards (Fig. 1).
- Open the chlorine filter holder by pressing the parts marked "PUSH", and carefully position the chlorine filter as shown in (Fig. 2).
- Close the filter holder and replace it in its housing, pushing it fully down.
- The chlorine filter must be replaced every 80 uses, and always after six months of operation.

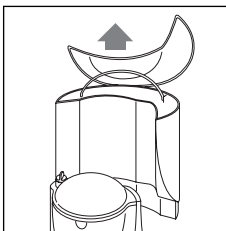

fig. 3

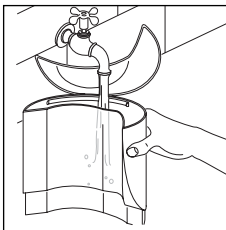

fig. 4

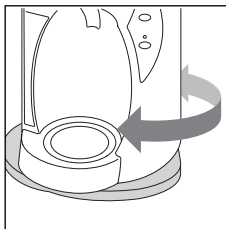

fig. 5

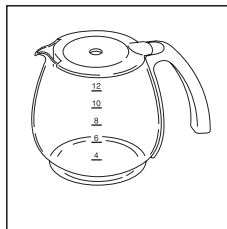

fig. 6

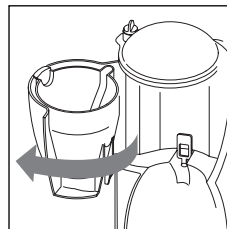

fig. 7

How to prepare the filter coffee

- Lift the water tank lid and remove the water tank (Fig. 3).
- Fill the tank with fresh, clean water up to the level corresponding to the number of cups of coffee required (Fig. 4).
NB: in models fitted with a rotating base, the coffee maker can be turned to the right or left for easier access to the water tank (Fig. 5).
- Place the tank back in the coffee maker, pressing it lightly into place. The tank may also be filled without being removed, using the coffee jug marked with the level indicators (Fig. 6).
- Open the filter holder door by pulling it to the left (Fig. 7).
- In versions with a permanent filter, place the permanent filter in the filter holder (Fig. 8). In other versions, use the size "4" paper filter.

- Place the ground coffee in the filter, using the measuring spoon supplied, and level evenly (Fig. 9). As a general rule, use a level measuring spoon of ground coffee (around 7 grams) for each cup (for example, 12 spoons to make 12 cups). The quantity of ground coffee will vary according to personal taste. Use good quality, medium ground coffee, packaged for filter coffee makers.
- Close the filter holder door and place the jug, with the lid on, on the warming plate, make sure it is placed in the centre.
- Choose the desired flavour as indicated in the paragraph "How to choose the flavour".
- Press the "ON/OFF" switch (Fig. 10). The ON pilot light above the switch will indicate that the coffee maker is in operation.
- In the models with the 6/12 cup switch " $\frac{6}{12}$ " for filter coffee, if more than six cups are required, press the 6/12 cup switch " $\frac{6}{12}$ " (Fig. 11), and the corresponding pilot light will come on. If less than six cups are required, do not press the switch. The hot water will flow more slowly through the ground coffee, with better results.
- The coffee will start to come out after a few seconds. **It is completely normal for the appliance to release a little steam while the coffee is percolating.**
- If the "ON/OFF" switch is left in the ON position after percolation, the warming plate will keep the coffee at the ideal temperature.

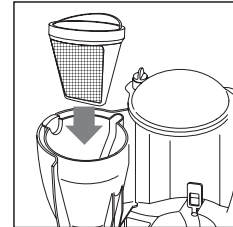

fig. 8

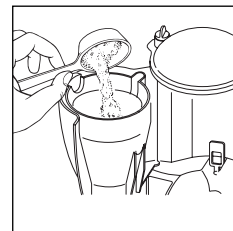

fig. 9

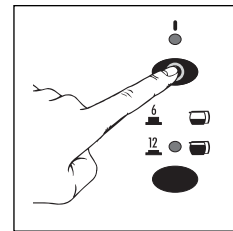

fig. 10

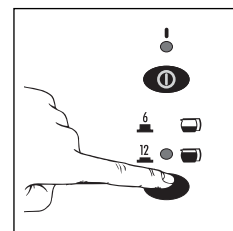

fig. 11

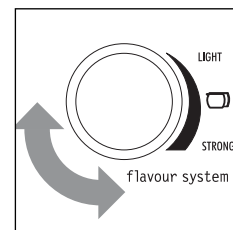

fig. 12

How to choose the flavour of the filter coffee

With the Flavour System, the flavour of the filter coffee can be chosen according to personal taste.

By turning the flavour adjustment knob (Fig. 12), the coffee maker can be set for coffee with a strong (STRONG position) or light aftertaste (LIGHT position).

The Flavour System changes the strength of the aftertaste of the coffee, while the actual taste remains the same.

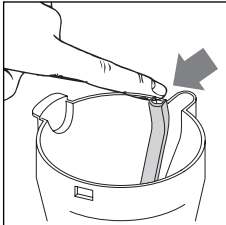

fig. 13

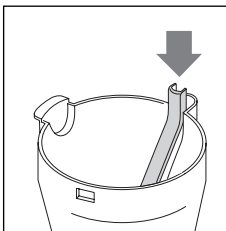

fig. 14

Cleaning and maintenance

Before performing any cleaning or maintenance operations, turn the machine off, unplug it from the power socket and allow it to cool down.

1. When cleaning the coffee maker, do not use solvents or abrasive detergents. A soft, damp cloth is sufficient.
2. Never immerse the coffee maker in water: it is an electrical appliance.

Cleaning the Flavour Saver

To clean the Flavour Saver more efficiently, it can be removed from the filter holder cone by pressing it lightly inwards (Fig. 13). To replace it, simply slide it in from above (Fig. 14).

Descaling

If the water in your local area is hard, lime scale will form over time. These deposits may affect the correct operation of the appliance.

The coffee maker must be descaled every 40 uses. The descaling process may be performed using special commercially-available scale removers for filter coffee makers. Alternatively, white wine vinegar can be used as follows:

1. Remove the chlorine filter.
2. Pour 2 cups of white wine vinegar and 3 cups of water into the tank. Place the tank in the coffee maker;
3. Place the jug on the warming plate, do not put any ground coffee in the filter holder;
4. Press the drip coffee ON/OFF switch, percolate the equivalent of one cup and then switch off the appliance;
5. Leave the vinegar to act for one hour;
6. Switch the coffee maker back on and percolate the rest of the solution;
7. To rinse the machine, operate it with water and without ground coffee at least 3 times (3 complete tanks of water).

Problem solving

Problem	Probable cause	Solution
The filter coffee takes longer to percolate	The filter coffee maker needs to be descaled	Perform the descaling procedure as described in the paragraph "Descaling"
The coffee has a vinegary taste	The coffee maker has not been rinsed sufficiently	Rinse the appliance as described in the chapter "Descaling"

Safety warnings

- This machine is designed to “make coffee”, be careful to avoid scalding from the water and steam jets or by using the machine incorrectly.
- Do not touch hot parts (areas in contact with the filter holder and the warming plate).
- After having removed the packaging, make sure that the product is complete. If in doubt, do not use the appliance and contact qualified personnel only.
- This appliance is for home use only. All other uses are considered improper and thus dangerous.
- The manufacturer cannot be held responsible for any damage caused by improper, erroneous and unreasonable use.
- Do not touch the appliance with wet or damp hands or feet.
- Never allow the appliance to be used without supervision by children or unfit persons.
- Children must be supervised at all times to ensure that they do not play with the appliance.
- In the event of failures or malfunction, switch off the appliance and do not tamper with it in any way. For repairs, contact an authorized Service Centre only and request original spare parts. Failure to observe the above points may affect the safety of the appliance.
- The power cable must not be replaced by the user as this requires the use of special tools. If the power cable is damaged or needs replacing, contact an authorized Service Centre.
- Remove the plug from the mains socket and turn off the main switch when the appliance is not in use. Do not leave the appliance switched on unnecessarily.
- Do not immerse the appliance in water.

Electrical requirements

Before using this appliance ensure that the voltage indicated on the product corresponds with the main voltage in your home, if you are in any doubt about your supply contact your local electricity company.

The flexible mains lead is supplied connected to a B.S. 1363 fused plug having a fuse of 13 amp capacity. Should this plug not fit the socket outlets in your home, it should be cut off and replaced with a suitable plug, following the procedure outlined below.

Note: Such a plug cannot be used for any other appliance and should therefore be properly disposed of and not left where children might find it and plug it into a supply socket - with the obvious consequent danger.

N.B. We recommend the use of good quality plugs and wall sockets that can be switched off when the machine is not in use.

important: the wires in the mains lead fitted to this appliance are coloured in accordance with the following code:

GREEN AND YELLOW	EARTH
BLUE	NEUTRAL
BROWN	LIVE

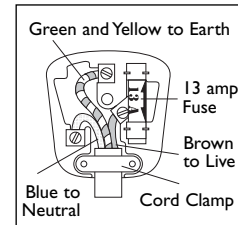

As the colours of the wires in the mains lead of this appliance may not correspond with the coloured markings identifying the terminals in your plug, proceed as follows:

The wire which is coloured green and yellow must be connected to the terminal in the plug which is marked with the letter E or by the earth symbol  or coloured green or green and yellow.

The wire which is coloured blue must be connected to the terminal which is marked with the letter N or coloured black.

The wire which is coloured brown must be connected to the terminal which is marked with the letter L or coloured red.

When wiring the plug, ensure that all strands of wire are securely retained in each terminal. Do not forget to tighten the mains lead clamp on the plug. If your electricity supply point has only two pin socket outlets, or if you are in doubt, consult a qualified electrician.

Should the mains lead ever require replacement, it is essential that this operation be carried out by a qualified electrician and should only be replaced with a flexible cord of the same size.

After replacement of a fuse in the plug, the fuse cover must be refitted. If the fuse cover is lost, the plug must not be used until a replacement cover is obtained. The colour of the correct replacement fuse cover is that of the coloured insert in the base of the fuse recess or elsewhere on the plug. Always state this colour when ordering a replacement fuse cover.

Only 13amp replacement fuses which are approved to B.S. 1362 should be fitted.

This appliance conforms to the Norms EN 55014 regarding the suppression of radio interference.

warning - this appliance must be earthed

