

# VaporMax PC800 Steam Cleaner

Thank you for purchasing a Simac steam cleaner. It is the result of expert research and development to produce a quality functional product. Rigorous quality control ensures that your product will give you good service.

This booklet has been prepared to enable you to get the most out of your steam cleaner. Please read it thoroughly to familiarise yourself with the machine and make steam cleaning an easy chore. Keep the instructions in a safe place so that you can refer to it in the future.

The booklet refers to the following steam cleaner only:

**VaporMax PC800** pressure steam cleaner

---

## SPECIAL WARNING

Do not use steam on Dralon<sup>®</sup> or synthetic velvet type materials.

On any other fabric carry out a patch test on an unseen area of reasonable size and allow to dry before doing a full clean or check with the fabric manufacturer to see if steam is safe on their product.

---

## Description

- 1 Water tank and cover
- 2 ON/OFF power button ①
- 3 Steam ready/temperature indicator light 
- 4 Tool holders
- 5 Castors
- 6 Flexible hose with hand grip

## Accessories

- 7 Carpet/floor brush
- 8 Window/tile cleaner with combined squeegee
- 9 Scouring brushes
- 10 Two extension tubes
- 11 Wash cloth
- 12 Crevice tool
- 13 De-scaler solution

# General Safeguards

1. Read this instruction book carefully before using the steam cleaner.
2. When in use the appliance uses pressurised steam: incorrect use could be dangerous. The appliance is only for domestic uses as shown in this booklet. The manufacturer will not be responsible for damage caused by incorrect use of the appliance.
3. Always unplug the appliance from the mains before refilling, changing tools or carrying out any maintenance or cleaning work on the appliance itself.
4. Before use, check that the supply voltage corresponds to the voltage shown on the rating plate on the base of the appliance.
5. Connect the appliance only to power points that have a minimum capacity of 10 amps and are earthed.
6. NEVER aim the steam jet in the direction of power points or other electrical items; this could damage them and expose you to risk of electric shock.
7. Do not unplug the appliance by pulling on the power cord. If the power cord is damaged it must be replaced by a professional repairer.
8. Avoid steam contact with the skin. The extremely high temperatures can cause serious burns. Never aim the steam jet at people or animals or use on any object that is unable to withstand high temperatures.
9. DO NOT put detergent, perfume or any other substance into the boiler. USE ONLY WATER.
10. Before steam cleaning any electrical appliances (cooker, fridge, freezer, hob, etc.) unplug them from the power supply. Before reconnecting make sure that they are completely dry as any remaining water could cause dangerous electrical discharges.
11. Before storing the appliance for long periods ensure that the tank and boiler are completely empty.
12. Do not leave the appliance unattended when switched on. Keep away from children.
13. Do not use the appliance if it appears to be defective.
14. Do not leave the appliance exposed to the elements (rain, frost, sun, etc.)
15. NEVER IMMERSE THE APPLIANCE IN WATER
16. For all repairs contact the Service Centre named in the guarantee. This will ensure that it is repaired to it's original quality using only genuine spare parts. In-guarantee repairs can only be carried out by the authorised Service Centre.
17. After disconnecting from the mains the appliance steam may continue to flow from the hose for a few seconds. Keep out of reach of children.

**KEEP THESE INSTRUCTIONS IN A SAFE PLACE FOR FUTURE USE.**

## Preparing For Use

**CAUTION: Before preparing the appliance for use or carrying out any maintenance, always disconnect from the power supply.**

All tools provided can be used on either the extension tubes or the handgrip. To fit, just push on until they click into place (fig. 1).

To remove, press the button and pull, taking care not to pinch the finger pressing the button.

Remove the cover (fig. 2) from the water tank and pour in 1 litre of water (fig. 3). The appliance works with normal tap water. If the water is very hard (over 100 mg/l) we suggest using half distilled water and half tap water. Never use distilled water alone. Never add detergent. Replace filler cover.

## Using the appliance

Plug into the mains and turn on the main switch (2). The indicator light (3) comes on and the boiler starts operating.

When the light (3) goes off the appliance is ready for use.

To start the steam push the button [A] in Fig 4 underneath the handle and steam will start to flow. It is normal for a few drops of water to come out first.

Release the button whenever you want to stop the steam.

The steam will continue to flow from the tool for about one minute until the boiler is system is empty.

During use the steam ready light will go on and off indicating that the boiler is being heated to maintain steam output.

***Important: it is normal for a little water to be given off before steam starts to flow and for the steam ready light (3) to go on and off during use. When changing tools release the trigger and the allow the steam to die down (about one minute) before changing.***

## Safety Device

The appliance is fitted with a safety device which discharges steam from the bottom in the event of a malfunction. Should this occur, turn off the appliance immediately. Unplug from the mains and leave to cool. Contact the authorised service centre.

## Descaling

To guarantee consistently high quality steam, the appliance should be descaled about every 15 tank-fulls of water depending on local hardness.

Proceed as follows:

1. Fill the tank with a solution of 125 ml of descaler and 625 ml of water (one part descaler to five parts water). Use the descaler provided only. Replacement supplies of descaler are obtainable from the service centre.
2. Position the handgrip/steam outlet inside a container or the sink to collect the water/descaler solution running out of the hose.
3. Plug into the mains and turn on the main switch (2). Plug into the mains and turn on the main switch (2). Press button (A). To run off all the descaler solution, the button can be held down using a Velcro band.
4. Run the appliance until the solution is used up.
5. Empty the tank of any remaining solution and to remove all residue from the tank and hose, operate the appliance again with a quarter of a litre of fresh water in the tank.

## GENERAL CLEANING ADVICE

Before using for the first time:

- Test the resistance of fabrics and colours on a hidden area before using
- Before cleaning floors or fabric surfaces (e.g. carpets, rugs, etc.) you are recommended to pre-clean with a vacuum cleaner
- The scouring brushes (9) are in different colours. Use the different colours for different purposes (e.g. red for the kitchen, yellow for the bathroom, etc.)

When attaching the cloth lay it on a flat surface and fold the two long edges in toward the middle. Put the floor head onto the cloth ensuring that there is a double layer of cloth underneath the bristles then clip the edges of the cloth to the floor head. This will reduce wear on the cloth.

When cleaning carpets and hard floors move the floor head over the surface at a slower pace than when using a vacuum cleaner.

**Do not use physical pressure when steam cleaning – let the power of the steam do the work.** When excess pressure is used on brush tools the bristles can be permanently mis-shaped.

## Cleaning carpets and rugs

Accessories: carpet/floor brush (7) and cloth (11) attached by the spring clips.

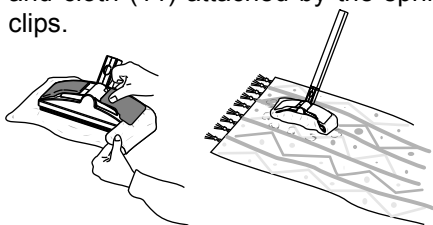

*Advice:* test for colour fastness and fibre resistance on a concealed section of reasonable size before carrying out the full clean.

It is advisable to remove surface dust first with a carpet sweeper or vacuum cleaner and again after the carpet is completely dry. This will remove dirt at the bottom of deeper carpet pile which has been loosened by the steam.

*Replacement cloths;* these can be purchased from most supermarkets or direct from the Service Department. To save money - use old towels or cotton floor cloths.

## Cleaning hard floors

Accessories: carpet/floor brush (7) and cloth (11) attached by the spring clips.

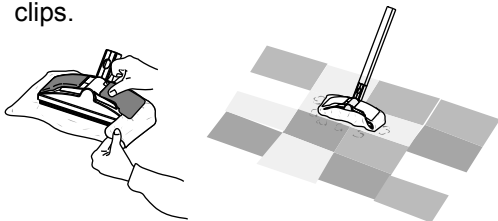

*Advice:* Not recommended for wax treated floors or wood floors which have been treated with non heat resistant varnish.

For hard floors able to withstand the high temperature of steam it is possible to use the floor brush directly on the surface without a cloth. This is

particularly useful on heavily soiled floors. Go over the area afterwards with the cloth attached to remove loosened dirt.

## Cleaning tile grout, bathrooms, shower stalls, toilets and hand basins

Accessories: crevice tool (12) with scouring brush (9) then hand held cloth to wipe up loosened dirt and dry.

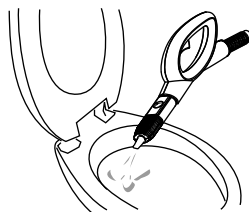
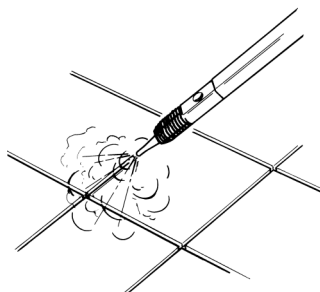
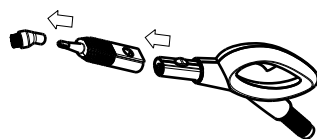

## Cleaning ovens, hobs and fridges

Accessories: crevice tool with scouring brush then hand held cloth to wipe up loosened dirt and dry.



**Advice:** always unplug the appliance to be cleaned before steam cleaning.

Before plugging in again, ensure the appliance is completely dry as any remaining water could cause electrical discharge.

## Cleaning mirrors, windows and tiles

Accessories: crevice tool with window/tile cleaner (8) with extension pipes if necessary then hand held cloth to wipe up loosened dirt and dry.

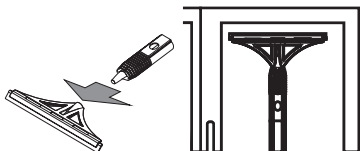

**Advice:** when cleaning cold glass bring the steam to the glass slowly so as to prevent a rapid rise in temperature and the possibility of cracking.

To clean windows and wall tiles move the tool over the surface with steam switched on using the rubber ribbed edge to clear any stubborn dirt, then release trigger to switch steam off,

and use squeegee edge to clear dirt and condensation downwards.

## OPTIONAL ACCESSORIES

### Wallpaper Stripper

The professional style wallpaper stripper makes short work of removing old wallpaper. Designed to fit directly to the hand grip or with extension pipes.

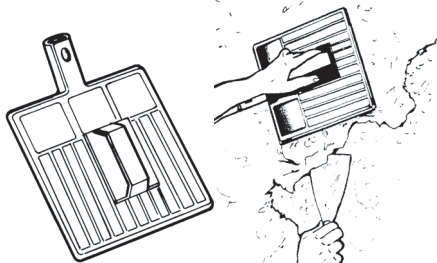

### Upholstery Tool

The triangular brush is available for cleaning upholstery and other drapes. Used with the cloth which attaches with spring clips it is ideal for most types of sofas, chairs and mattresses.

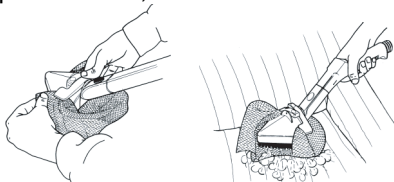

**Both of the above accessories, replacement cloths and de-scaler solution can be obtained at extra cost direct from the Service Centre**  
Ö see guarantee details.

# POWER CORD SAFETY

The power cord is fitted with a molded plug incorporating a 13A fuse. Should the fuse need to be replaced an ASTA approved BS 1362 fuse must be used of the same rating. If the fuse cover is detachable never use the appliance with the cover removed. If the plug fitted is not suitable for your socket outlet it should be cut off and destroyed. The end of the power cord should then be suitably prepared and the correct plug fitted as below.

**WARNING: A PLUG WITH BARED POWER CORD IS DANGEROUS IF PLUGGED INTO A LIVE SOCKET.**

**WARNING: This appliance must be earthed**

Important: The wires in the mains lead are coloured in accordance with the following code:

Green & Yellow	- Earth
Blue	- Neutral
Brown	- Live

As the colours of the wires in the mains lead may not correspond with the coloured markings identifying the terminals in your plug, proceed as follows: connect Green & Yellow wire to terminal marked E or coloured Green & Yellow; connect Brown wire to terminal marked N or coloured red; connect Blue wire to terminal marked N or coloured black. If a 13A plug (BS 1363) is used it must be fitted with a 13A Fuse.

## Some hints and tips.....

Use your steam cleaner to **de-frost the freezer**. It melts the ice quicker and sterilises at the same time.

Get rid of unwanted **odours on clothing** (e.g. after going to a smoky pub) by wafting steam from the crevice tool over the fabric. It brings back the freshness and gets rid of creases.

Use on mountain bikes garden tools and kid's toys to **remove mud**. On car and motor bike engines to remove grease.

If you find that the **cloths wear quickly** always have a double layer of cloth over the bristles. Place the cloth on a flat surface and fold the longest edges into the middle. Place the tool onto the cloth so that the bristles are over the double cloth layers then fold up to the clips. Did you know that you can save money by using old towels instead of the cloths supplied with the machine? They work just as well and it's a good way of using up part worn towels.

Blast out **black mould** from joints in shower enclosures and bath edges using the crevice tool. You'll be surprised what's lurking in the places that you can't see. Be sure to wipe up the mould with a cloth straight away since the steam 'cooks' it and if left to cool it sticks like glue making another cleaning task!