

Dear customer

Congratulations on your purchase and thank for your confidence in our brand.

Our products represent the fruit of rigorous testing and in-depth study.

We have prepared this user manual to enable you to get the most out of the product.

We are sure that compliance with the instructions will ensure the lengthy service life of the appliance and your lasting satisfaction.

By exploiting the power of steam, it helps reduce air pollution caused by the dispersion of chemical detergents.

This appliance exploits the power of steam to facilitate everyday cleaning in the home or for gardening, hobbies and DIY.

It has been designed to improve the hygiene of household surfaces and upholstery.

When fitted with an iron, this product constitutes an efficient ironing system capable of meeting all the family's requirements.

Consequently, it represents a valuable helping hand in everyday household tasks.

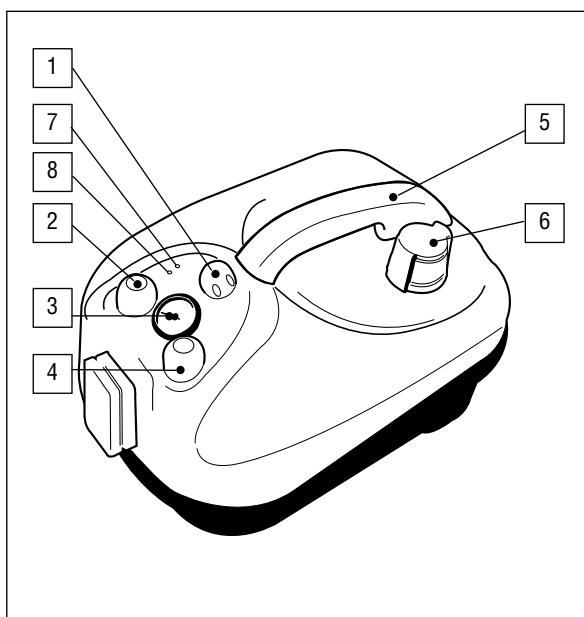

Description

1. Steam flow regulator (where this is one of the model's features)
2. Illuminated on/off switch
3. Pressure gauge
4. Steam generator switch
5. Handle
6. Filler cap
7. Steam generator light
8. Appliance operating light

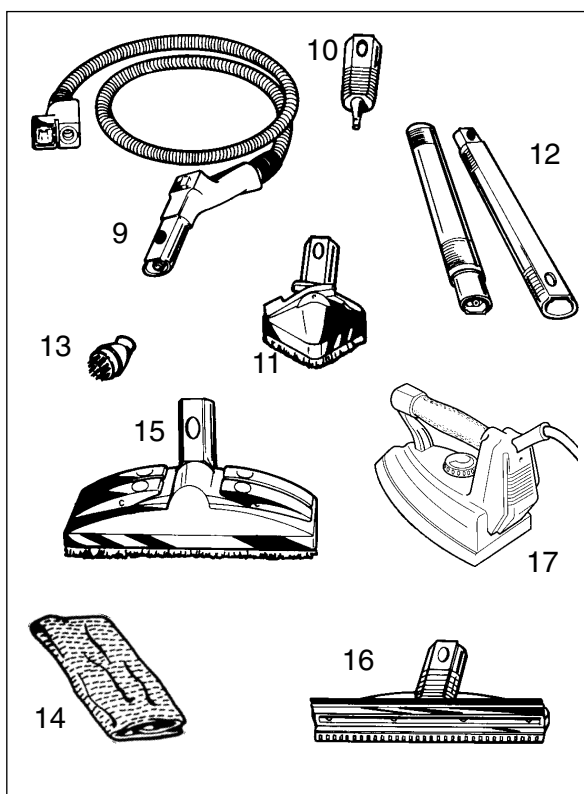

Accessories

9. Flexible hose with handgrip
10. Nozzle
11. Triangular brush
12. Two rigid extension tubes
13. Mini-brush for nozzle
14. Wash cloth for the carpet/floor brush and for the triangular brush
15. Carpet/floor brush
16. Window-cleaning squeegee (if provided)
17. Iron (if provided)

Important

- 1) Read the instructions carefully
- 2) The appliance contains pressurised steam. Incorrect or improper use could be dangerous. The appliance is designed for household use or for gardening, hobbies or DIY. All types of industrial use are excluded. The manufacturer declines all liability for damage deriving from improper use of the product.
- 3) Do not leave the iron unattended when plugged in.
- 4) Always disconnect the plug before filling the boiler tank, or before carrying out any maintenance. Always unplug before filling the boiler tank, performing maintenance or cleaning the appliance.
- 5) Before use, make sure the mains voltage corresponds to the voltage indicated on the rating plate on the bottom of the appliance.
- 6) Plug the appliance into an efficiently earthed socket with a minimum rating of 10 A.
- 7) Never direct the steam jet towards the socket or live parts: they could be damaged, with the risk of dangerous electrical discharges.
- 8) Never direct the steam jet towards the appliance.
- 9) Never unplug the appliance by pulling the power cable or appliance itself.
- 10) To avoid damaging the insulation, do not run the appliance over the power cable.

Never place the appliance in a vertical position.

- 11) DO NOT OPEN THE CAP WHILE USING THE APPLIANCE OR BEFORE ALL THE WATER HAS BEEN EXHAUSTED. THIS OCCURS WHEN STEAM IS NO LONGER DISCHARGED BY THE IRON OR TOOLS. To add water, unplug and wait about 15 minutes to avoid sudden temperature changes. Place the cloth over the cap and unscrew slowly to allow residual steam to escape slowly.
- 12) Before steam cleaning electrically-powered objects or household appliances (electric oven, refrigerator, extractor fan, etc), unplug these appliances from the mains. Before plugging in again, make sure they are perfectly dry as residual water could cause electrical discharges.
- 13) Avoid the steam coming into contact with the skin. The high temperature could cause serious burns. Never direct the steam jet towards persons or animals or towards surfaces or objects with could be damaged by high temperatures.
- 14) To move the appliance, hold it by the handgrip. As it contains a boiler, its surfaces become hot during use. Persons affected by particular pathologies causing abnormal sensitivity to heat should take special care when using this appliance.
- 15) Do not add detergent to the tank. Use water only.
- 16) If not used for long periods, you are recommended to evaporate the water completely before putting the appliance away.
- 17) **Use the iron mat provided ONLY. If it is lost or damaged, use only an ORIGINAL replacement.**
- 18) Never place the iron in a vertical position.
- 19) Keep the appliance out of reach of children or persons not capable of using it without supervision.
- 20) After ironing, allow the plate of the iron to cool before putting away.
- 21) Do not use the appliance if it appears to be faulty. Contact the dealer or authorised service centre.
- 22) If the temperature safety switch trips, the iron or device shuts down. To use again, contact specialist personnel.
- 23) Protect the appliance from atmospheric agents (rain, frost, sun, etc).
- 24) To repair or if the power cable is damaged and requires replacement, contact the dealer or authorised service centre in order to avoid compromising the efficiency of your appliance and guarantee the validity of the guarantee. For the same reasons, you are always recommended to use original spare parts.

KEEP THESE INSTRUCTIONS CAREFULLY

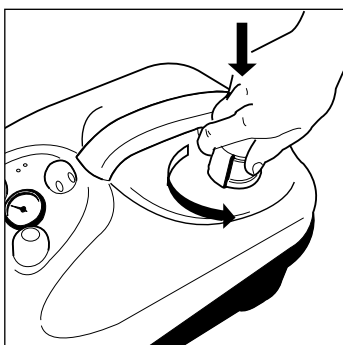

Assembling and preparing for use

Using the boiler

Before commencing any maintenance, or preparing the appliance for use, make sure that the plug is disconnected.

In order to open the boiler, press down on the safety cap and turn at the same time.

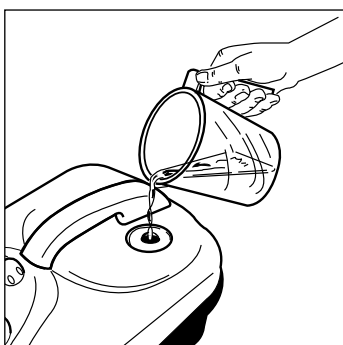

It is advisable to fill the tank with a maximum of 1,5 litres of tap water (greater quantities may result in the appliance's poor operation).

Screw on the tap, applying pressure and screwing down tight.

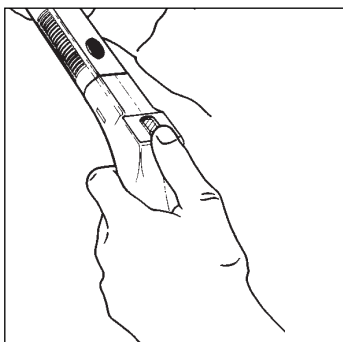

Preparing the cleaning accessories

In order to connect the flexible hose to the unit:

- * insert the flexible hose in the socket, applying slight pressure until you hear it click in
- * check whether the hose is in the socket. In order to remove it, press the button and pull it towards you.

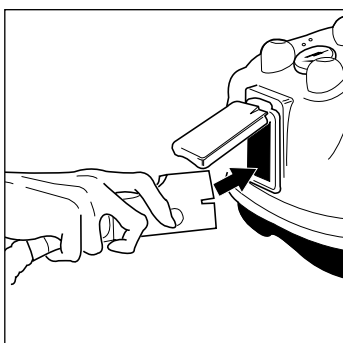

The cleaning accessories must be inserted into one or two of the rigid extension tubes, depending on the requirements. Whatever the case, the procedure is as follows:

- * hold the part, into which the accessory is to be inserted, in one hand, and press the button using the thumb of that hand;
- * with the other hand insert the accessory and slide it carefully over the button until the button emerges from the orifice on the accessory.

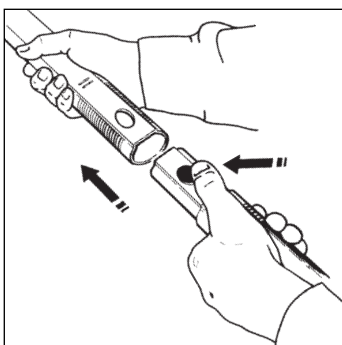

In order to disconnect the accessory, follow the reverse procedure. Remove the accessory carefully, taking care not to catch your finger which is holding the button down.

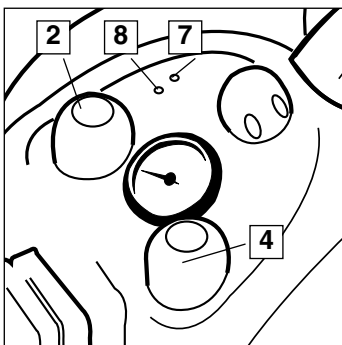

Operating the appliance

Plug the appliance in, turn on the on/off switch (2), the light comes on and the boiler starts working, activating the main steam switch (4). When the pointer on the pressure gauge enters the green zone, the appliance is ready for use and the light goes off (7).

Press the switch located on the handgrip of the flexible hose in order to shoot the steam out of the accessories.

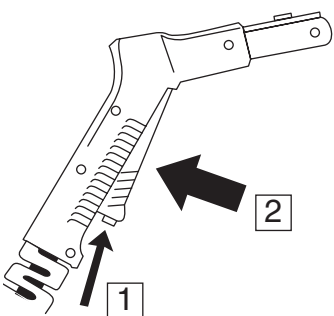

To produce steam, press the button (1) and then the lever (2). When the lever (2) on the handgrip is released, steam discharge ceases immediately.

N.B.: When used for the first time, the appliance may give out smoke and an odour for several minutes. This is caused by heating and subsequent drying of the sealers used in assembling the boiler. You are recommended to ventilate the room.

Version without gauge

Plug the appliance in, push on/off switch (2), and then activate the main steam switch (4). Wait approx. 15 minutes; when the light (7) goes off the appliance is ready for use.

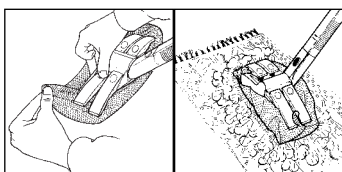
**Warning:**

- * check the resistance of fabrics or colours in places which can not be readily seen
- * it is advisable to remove dust using a vacuum cleaner before starting

Cleaning advice

Rugs and carpets

Accessories: carpet/floor brush + wash cloth held on by the snap hooks.

Steam setting: central position.

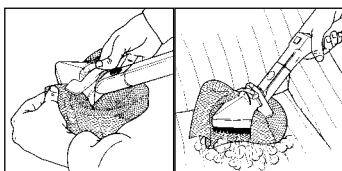
**Warning:**

- * check the resistance of fabrics or colours in places which can not be readily seen
- * it is advisable to remove dust using a vacuum cleaner before starting

Armchairs, sofas, cushions, mattresses, car interiors, blinds, vertical walls, garden furniture, gazebos, garden umbrellas and loungers.

Accessories: triangular brush + wash cloth held on by the snap hooks

Steam setting: central position

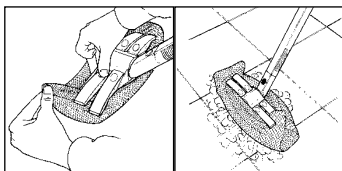
**Warning:**

- * it is not advisable to use the appliance on treated terra-cotta tiles, on waxed floors or on woodblock flooring.

Floors

Accessories: carpet/floor brush + wash cloth held on by the snap hooks

Steam setting: maximum

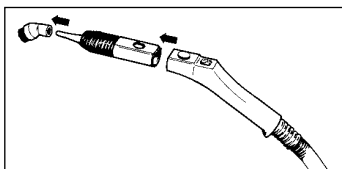

Joints between tiles, radiators, shutters, door jambs, difficult to reach points, flower pots, bicycles, mountain bikes, car engines, motorcycles, garden equipment (lawnmowers), children's games (swings)

Accessories: nozzle + mini-brush

Steam setting: maximum

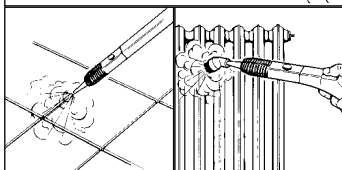

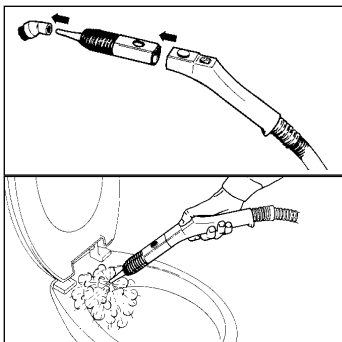

Bathroom (shower cubicle, sanitary fittings, basins, swimming pools)

Accessories: nozzle + mini-brush directly on flexible hose or on the rigid extension tube

Steam setting: maximum

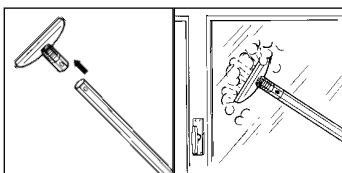

Mirrors, windows, car windows, verandas, greenhouses

Accessories: rigid extension tubes + raclette

Steam setting: minimum

Warning

** when it is cold outside, take care to avoid sudden changes in temperature which could break the glass. The glass should be heated with a slight jet of steam.*

Filling the boiler

When the steam has run out, the boiler can be filled by following the procedure below:

Only open the cap once all the water has evaporated

Let all the steam escape, using the switch on the handgrip, or the button for expelling steam from the iron.

Turn the appliance off using the on/off switch (2), or pull the plug out from the socket.

Wait for a few minutes before filling the tank again in order to avoid sudden changes in temperature.

Place the cloth over the filler cap (6) to open it. Open the cap slowly, taking care to allow any steam, which might still be inside, to escape gradually. Fill the tank again by following the procedure explained previously.

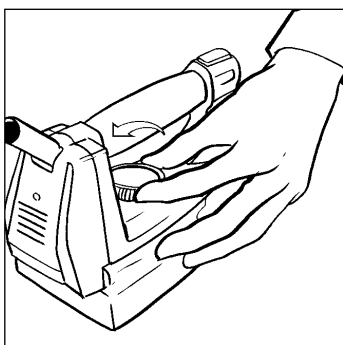

Using the iron

(if provided)

To operate the boiler, see the above instructions.

Setting up the ironing system

To connect the iron to the appliance:

Plug the iron into the socket and press until the release button clicks.

Make sure the plug is fully inserted by attempting to remove it without using the release button.

To turn on the appliance, follow the above instructions.

When the iron is started up for the first time, you are recommended to discharge the steam onto a cloth for a moment in order to eliminate possible impurities deposited in the iron. Do this by pressing the "steam required" button on top of the iron.

N.B.: When used for the first time, the appliance may give out smoke and an odour for several minutes. This is caused by heating and subsequent drying of the sealers used in assembling the boiler. You are recommended to ventilate the room.

OPERATION

Select the required temperature by rotating the thermostat knob to one of the marked sectors according to the type of fabric to be ironed. Wait until the "iron at temperature" indicator light (11) goes out before beginning to iron.

N.B.: the indicator light goes on and off during ironing according to the temperature of the iron.

To discharge steam, use the steam button on the iron. Use the steam flow regulator (1) to obtain the required quantity of steam.

N.B. When turning the iron on, you are recommended to rotate the knob into the maximum steam discharge position.

IMPORTANT: the tube connecting the iron to the boiler may become hot. The iron can also generate steam in a **vertical position**, enabling fabrics to be easily restored by steaming.

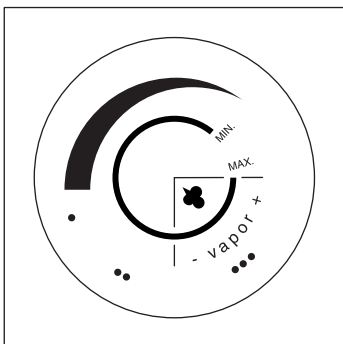

Dry ironing

Turn on the main switch (2) only and leave the steam generator switch (4) on the appliance control unit in the off position.

Wait for the indicator light on the iron to go off before starting to iron.

required quantity of steam.

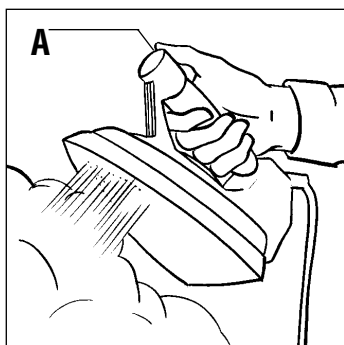

Tips for perfect ironing.

- ✓ The original appearance and softness of velvet, wool or similar materials as well as glove and bags etc. can be restored by holding the iron a few cm above the fabric whilst pressing the steam button (A).
- ✓ Carpets and rugs can be restored to new, eliminating the marks made by furniture, by allowing the steam to penetrate into the squashed pile and brushing lightly.
- ✓ Do not rest or use the iron on zips, hooks, rings etc to avoid scratching the plate.
- ✓ Keep the surface of the plate clean: to clean, wipe the cold surface with a damp cloth.
- ✓ Descaling products must not be used in the iron.
- ✓ After use, always wait until the iron is cold before putting away.
- ✓ Store the appliance in a dry place.
- ✓ After ironing, the water remaining in the boiler need not be drained.
- ✓ Silk fabrics can be dry-ironed on the wrong side.
- ✓ Divide garments according to required ironing temperature, starting with those requiring the lowest temperatures.
- ✓ Wool, cotton and linen fabrics can be steam-ironed on the wrong side, or on the right side over a fine cloth to avoid the "shiny" effect. Starched fabrics require greater moisture. Iron white and light coloured fabrics on the right side and dark colours on the wrong side. Embroidery should also be ironed on the wrong side to make it stand out.
- ✓ Linen fabrics can be steam ironed by steaming abundantly and ironing dark fabrics only on the wrong side to avoid a "shiny" effect. Iron cuffs and lapels on the right side to make them stand out.
- ✓ Every time the iron is used (including for the first time) or if you have not used the iron for several minutes: push the steam button several times. This enables the cold water to be eliminated from the steam circuit.

Perfect ironing table

Acetate - Acrylic - Nylon



DRY IRON, VERY LIGHTLY

Polyester - Rayon



DRY IRON ON REVERSE SIDE OF GARMENT
AT MINIMUM TEMPERATURE

Silk



DRY IRON ON REVERSE SIDE OF GARMENT

Wool - Fine Cotton - Fine Linen



STEAM IRON ON REVERSE SIDE OF GARMENT
PLACING A THIN CLOTH OVER THE FABRIC

Cotton - Fine Linen - Starched Articles



STEAM IRON ON FRONT OF WHITE OR LIGHT
COLOURED GARMENTS, ON REVERSE SIDE
OF DARKER ARTICLES

Linen



STEAM IRON WITH PLENTY OF STEAM ON
REVERSE SIDE OF DARK GARMENTS.