

Dear customer

Congratulations on your purchase and thank for your confidence in our brand.

Our products represent the fruit of rigorous testing and in-depth study.

We have prepared this user manual to enable you to get the most out of the product.

We are sure that compliance with the instructions will ensure the lengthy service life of the appliance and your lasting satisfaction.

By using the power of steam, you are contributing towards reducing pollution deriving from the disposal of chemical detergents.

This appliance exploits the power of steam to facilitate everyday cleaning in the home or for gardening, hobbies and DIY.

It has been designed in order to obtain the utmost hygiene on surfaces and wall paper.

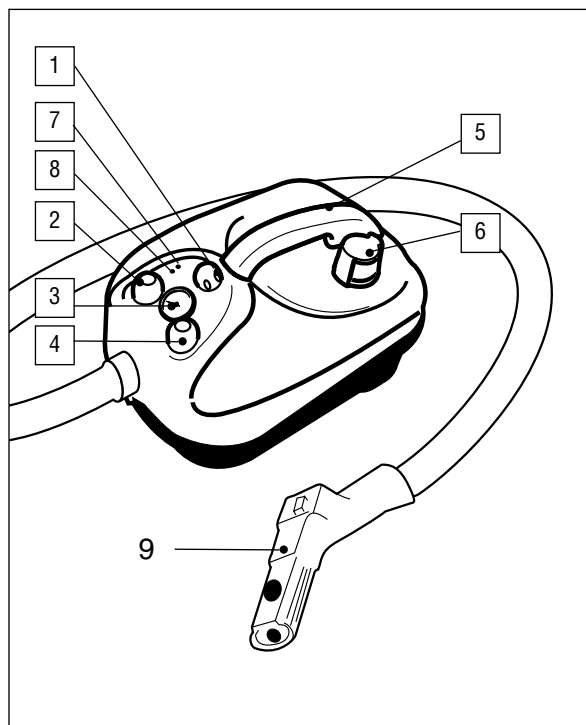

Description

1. Steam flow regulator (where this is one of the model's features)
2. Illuminated on/off switch
3. Pressure gauge (if provided)
4. Steam generator switch
5. Handle
6. Filler cap
7. Steam generator light
8. Appliance operating light
9. Flexible hose with handgrip

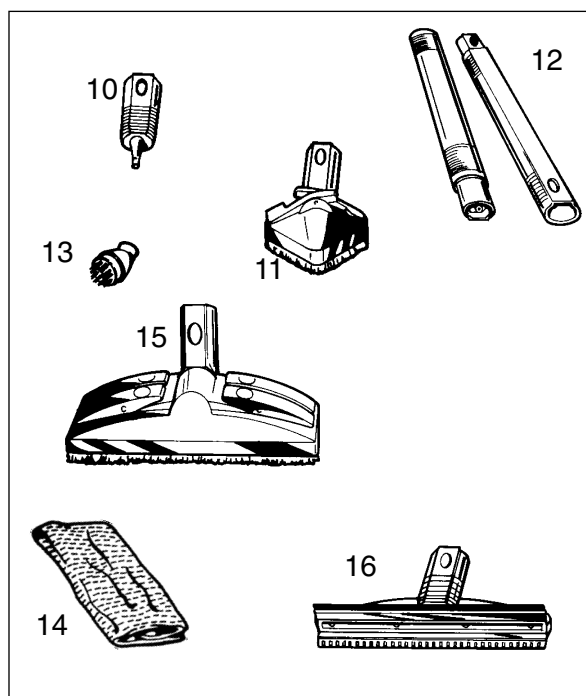

Accessories

10. Nozzle
11. Triangular brush
12. Two rigid extension tubes
13. Mini-brush for nozzle
14. Wash cloth for the carpet/floor brush and for the triangular brush
15. Carpet/floor brush
16. Window-cleaning squeegee (if provided)

Important

- 1) Read the instructions carefully
- 2) The appliance contains pressurised steam. Incorrect or improper use could be dangerous. The appliance is designed for household use or for gardening, hobbies or DIY. All types of industrial use are excluded. The manufacturer declines all liability for damage deriving from improper use of the product.
- 3) Always disconnect the plug before filling the boiler tank, or before carrying out any maintenance. Always unplug before filling the boiler tank, performing maintenance or cleaning the appliance.
- 4) Before use, make sure the mains voltage corresponds to the voltage indicated on the rating plate on the bottom of the appliance.
- 5) Plug the appliance into an efficiently earthed socket with a minimum rating of 10 A.
- 6) Never direct the steam jet towards the socket or live parts: they could be damaged, with the risk of dangerous electrical discharges.
- 7) Never direct the steam jet towards the appliance.
- 8) Never unplug the appliance by pulling the power cable or appliance itself.
- 9) To avoid damaging the insulation, do not run the appliance over the power cable.

Never place the appliance in a vertical position.

- 10) DO NOT OPEN THE CAP WHILE USING THE APPLIANCE OR BEFORE ALL THE WATER HAS BEEN EXHAUSTED. THIS OCCURS WHEN STEAM IS NO LONGER DISCHARGED BY THE IRON OR TOOLS. To add water, unplug and wait about 15 minutes to avoid sudden temperature changes. Place the cloth over the cap and unscrew slowly to allow residual steam to escape slowly.
- 11) Before steam cleaning electrically-powered objects or household appliances (electric oven, refrigerator, extractor fan, etc), unplug these appliances from the mains. Before plugging in again, make sure they are perfectly dry as residual water could cause electrical discharges.
- 12) Avoid the steam coming into contact with the skin. The high temperature could cause serious burns. Never direct the steam jet towards persons or animals or towards surfaces or objects with could be damaged by high temperatures.
- 13) To move the appliance, hold it by the handgrip. As it contains a boiler, its surfaces become hot during use. Persons affected by particular pathologies causing abnormal sensitivity to heat should take special care when using this appliance.
- 14) Do not add detergent to the tank. Use water only.
- 15) If not used for long periods, you are recommended to evaporate the water completely before putting the appliance away.
- 16) Keep the appliance out of reach of children or persons not capable of using it without supervision.
- 17) After ironing, allow the plate of the iron to cool before putting away.
- 18) Do not use the appliance if it appears to be faulty. Contact the dealer or authorised service centre.
- 19) If the temperature safety switch trips, the iron or device shuts down. To use again, contact specialist personnel.
- 20) Protect the appliance from atmospheric agents (rain, frost, sun, etc).
- 21) To repair or if the power cable is damaged and requires replacement, contact the dealer or authorised service centre in order to avoid compromising the efficiency of your appliance and guarantee the validity of the guarantee. For the same reasons, you are always recommended to use original spare parts.

KEEP THESE INSTRUCTIONS CAREFULLY

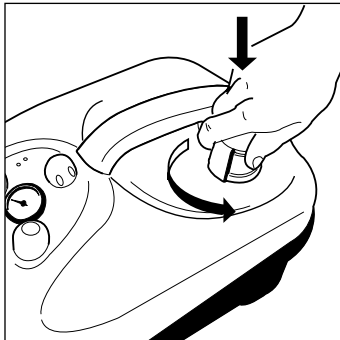

Assembling and preparing for use

Using the boiler

Before commencing any maintenance, or preparing the appliance for use, make sure that the plug is disconnected.

In order to open the boiler, press down on the safety cap and turn at the same time.

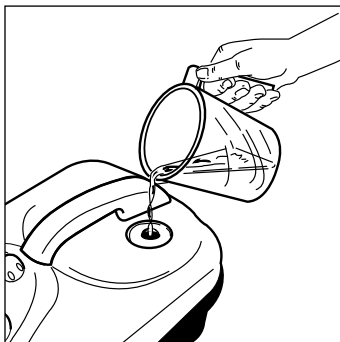

It is advisable to fill the tank with a maximum of 1,5 litres of tap water (greater quantities may result in the appliance's poor operation).

Screw on the tap, applying pressure and screwing down tight.

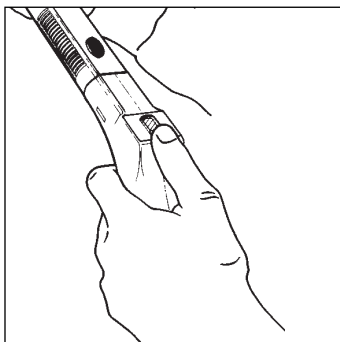

Preparing the cleaning accessories

The cleaning accessories must be inserted into one or two of the rigid extension tubes, depending on the requirements. Whatever the case, the procedure is as follows:

- * hold the part, into which the accessory is to be inserted, in one hand, and press the button using the thumb of that hand;
- * with the other hand insert the accessory and slide it carefully over the button until the button emerges from the orifice on the accessory.

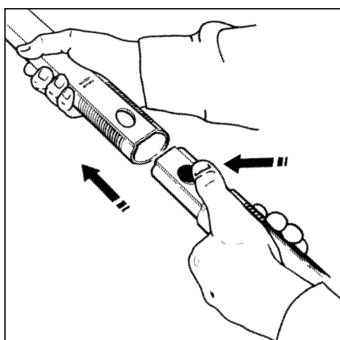

In order to disconnect the accessory, follow the reverse procedure. Remove the accessory carefully, taking care not to catch your finger which is holding the button down.

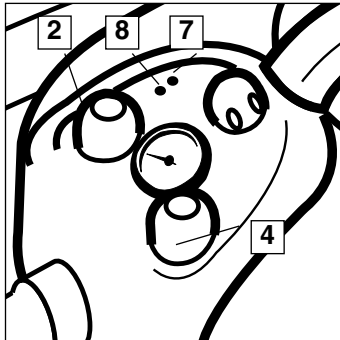

Operating the appliance

Plug the appliance in, turn on the on/off switch (2), the light comes on and the boiler starts working, activating the main steam switch (4). In models with pressure gauge, when the pointer on the pressure gauge enters the green zone, the appliance is ready for use and the light goes off (7).

To produce steam, press the button (A) and then the lever (B). When the lever (B) on the handgrip is released, steam discharge ceases immediately.

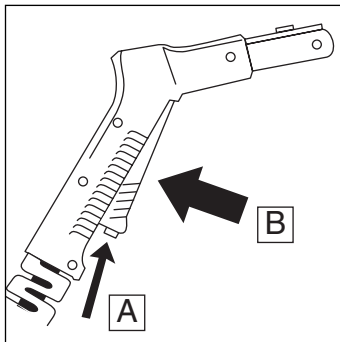

N.B.: When used for the first time, the appliance may give out smoke and an odour for several minutes. This is caused by heating and subsequent drying of the sealers used in assembling the boiler. You are recommended to ventilate the room.

Version without gauge

Plug the appliance in, push on/off switch (2), and then activate the main steam switch (4). Wait approx. 15 minutes; when the light (7) goes off the appliance is ready for use.

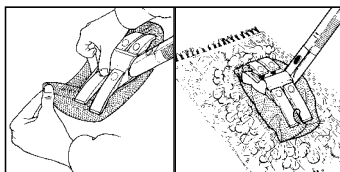

Tips:

- test the resistance of fabrics and colours on a hidden area before using
- You are recommended to remove dust beforehand using a carpet beater or vacuum cleaner

Cleaning advice

Rugs and carpets

Accessories: carpet/floor brush + wash cloth held on by the snap hooks.

Steam setting (only for models with stem flow regulator): central position.

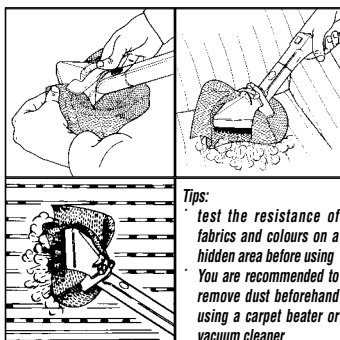

Armchairs, sofas, cushions, mattresses, car interiors, blinds, vertical walls, garden furniture, gazebos, garden umbrellas and loungers.

Accessories: triangular brush + wash cloth held on by the snap hooks

Steam setting (only for models with stem flow regulator): central position

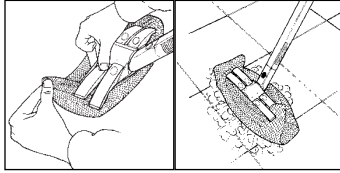

Tips:

Not recommended for treated cotton floors, wax polished floors and parquet.

Floors

Accessories: carpet/floor brush + wash cloth held on by the snap hooks

Steam setting (only for models with stem flow regulator): maximum

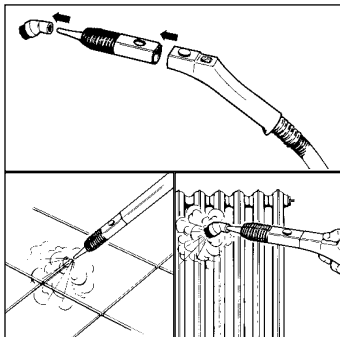

Joints between tiles, radiators, shutters, door jams, difficult to reach points, flower pots, bicycles, mountain bikes, car engines, motorcycles, garden equipment (lawnmowers), children's games (swings)

Accessories: nozzle + mini-brush

Steam setting (only for models with stem flow regulator): maximum

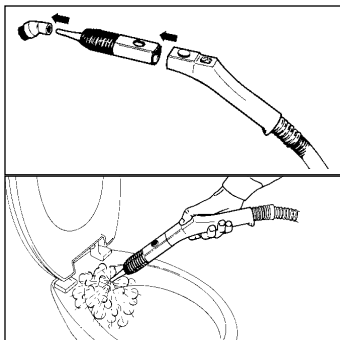

Bathroom (shower cubicle, sanitary fittings, basins, swimming pools)

Accessories: nozzle + mini-brush directly on flexible hose or on the rigid extension tube

Steam setting (only for models with stem flow regulator): maximum

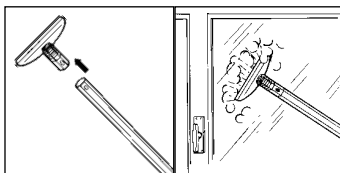

Tips:

in low temperatures, you are recommended to warm the windows first with a weak jet of steam to avoid the risk of breakage due to sudden temperature changes.

Mirrors, windows, car windows, verandas, greenhouses

Accessories: rigid extension tubes + raclette

Steam setting (only for models with stem flow regulator): minimum

Filling the boiler

When the steam has run out, the boiler can be filled by following the procedure below:

Only open the cap once all the water has evaporated

Let all the steam escape, using the switch on the handgrip, or the button for expelling steam from the iron.

Turn the appliance off using the on/off switch (2), or pull the plug out from the socket.

Wait for a few minutes before filling the tank again in order to avoid sudden changes in temperature.

Place the cloth over the filler cap (6) to open it. Open the cap slowly, taking care to allow any steam, which might still be inside, to escape gradually. Fill the tank again by following the procedure explained previously.

ELECTRICAL CONNECTION (UK ONLY)

- A) If your appliance comes fitted with a plug, it will incorporate a 13 Amp fuse. If it does not fit your socket, the plug should be cut off from the mains lead, and an appropriate plug fitted, as below.

WARNING: Very carefully dispose of the cut off plug after removing the fuse: do not insert in a 13 Amp socket elsewhere in the house as this could cause a shock hazard.

With alternative plugs not incorporating a fuse, the circuit must be protected by a 15 Amp fuse.

WARNING - THIS APPLIANCE MUST BE EARTHED

IMPORTANT

The wires in the mains lead are coloured in accordance with the following code:

| | |
|-------------------|---------|
| Green and yellow: | Earth |
| Blue: | Neutral |
| Brown: | Live |



If the plug is a moulded-on type, the fuse cover must be re-fitted when changing the fuse using a 13 Amp Asta approved fuse to BS 1362. In the event of losing the fuse cover, the plug must NOT be used until a replacement fuse cover can be obtained from your nearest electrical dealer. The colour of the correct replacement fuse cover is that as marked on the base of the plug.

- B) If your appliance is not fitted with a plug, please follow the instructions provided below:

As the colours of the wires in the mains lead may not correspond with the coloured markings identifying the terminals in your plug, proceed as follows:

The green and yellow wire must be connected to the terminal in the plug marked with the letter E or the earth symbol  or coloured green or green and yellow.

The blue wire must be connected to the terminal marked with the letter N or coloured black.

The brown wire must be connected to the terminal marked with the letter L or coloured red.