

IMPORTANT

- 1) Read the instructions carefully.
- 2) Before starting the appliance, make sure the filters are in position.
- 3) Check the filters regularly and if necessary brush or replace.
- 4) If you wash the filters, make sure they are completely dry before replacing them.
- 5) Keep the suction port away from eyes, ears, nose etc when the appliance is in operation.
- 6) Do not vacuum up red hot objects (cinders, cigarette ends, etc).
- 7) Always unplug the appliance from the mains socket when not in use or before cleaning or maintenance.
- 8) Do not use the appliance if it appears to be faulty.
- 9) To avoid damaging the insulation, do not run the appliance over the power cable.
- 10) Never unplug the appliance by pulling the power cable or the appliance itself.
- 11) The appliance is not intended for use by persons (including children) with reduced physical, sensory or mental capabilities, or lack of experience and knowledge, unless they have been given supervision or instruction concerning use of the appliance by a person responsible for their safety. Children should be supervised to ensure that they do not play with the appliance.
- 12) Use the appliance for domestic use only as described in the instructions.
- 13) For all repairs and for replacement of the power cable if damaged contact your dealer or an authorised service centre to maintain the efficiency of your appliance and the validity of the guarantee.

The manufacturer reserves the right to modify appliances and tools without warning. Original spare parts and tools should always be used to maintain the efficiency of your appliance. Failure to do so invalidates the guarantee.

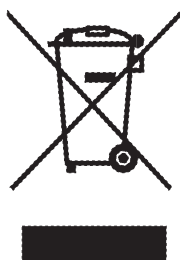

Important information for correct disposal of the product in accordance with EC Directive 2002/96/EC.

At the end of its working life, the product must not be disposed of as urban waste.

It must be taken to a special local authority differentiated waste collection centre or to a dealer providing this service.

Disposing of a household appliance separately avoids possible negative consequences for the environment and health deriving from inappropriate disposal and enables the constituent materials to be recovered to obtain significant savings in energy and resources. As a reminder of the need to dispose of household appliances separately, the product is marked with a crossed-out wheeled dustbin.

DESCRIPTION

- | | |
|---|--|
| <ul style="list-style-type: none"> A. ON/OFF switch B. Power regulator C. Clip to open Eco Heart filter housing D. Air outlet filter grill E. Grill slide F. Filter full indicator G. Cable winder | <ul style="list-style-type: none"> H. Suction port I. "Eco Heart" Bagless filter L. Carpet/floor brush M. Multipurpose nozzle for upholstered furniture N. Crevice tool |
|---|--|

PREPARATIONS FOR USE

ASSEMBLY OF THE APPLIANCE



After removing the appliance from the packaging, attach the Eco Heart filter housing to the motor assembly (fig. 1) and close with the clip (fig. 2).

DESCRIPTION OF THE ACCESSORIES

For the perfect connection of the accessories to the body of the appliance, press them in fully:

Carpet/floor brush

Vacuums up dust efficiently from both hard floors (marble, tiles) and carpets or rugs.

When the pedal (fig. 3) is pushed towards the "hard floors" position (), the bristles protrude to clean hard floors more efficiently. This position is recommended for in-depth cleaning of floors and for floors with pronounced joints. When the pedal is pushed towards the "carpets" symbol (), the bristles retract and the brush is ready to clean fabric surfaces and delicate floors such as parquet, marble, etc. To reach under radiators or shallow furniture, flatten the brush by lowering it and rotating it clockwise or anti-clockwise (Fig. 4).

Multipurpose nozzle for upholstered furniture (Fig.5)

Ideal for cleaning sofas, armchairs, upholstery, car interiors, blankets, mattresses, curtains, etc.

Crevice tool (Fig. 5)

Ideal for cleaning corners, edges, etc.

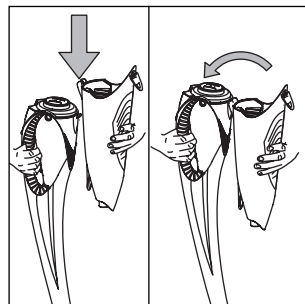

fig. 1

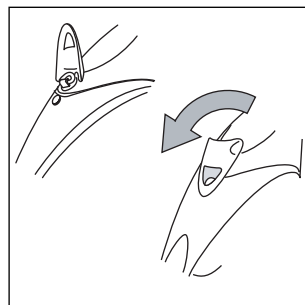

fig. 2

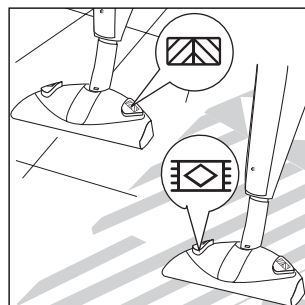

fig. 3

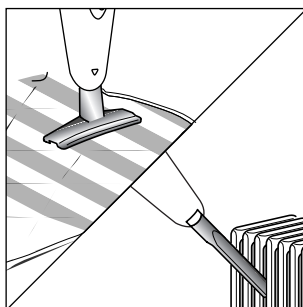

fig. 5

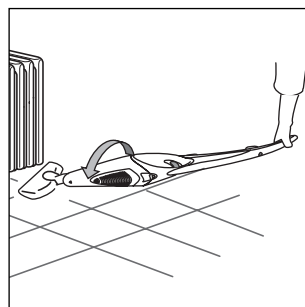

fig. 4

TURNING THE APPLIANCE ON

Set the appliance up according to your cleaning requirements, then plug into a suitable mains socket. Press the ON/OFF switch **A**.

MODELS WITH POWER REGULATOR (B)

Adjust the power by turning the regulator

Before turning the appliance on, you are recommended to turn the regulator to minimum.

The electronic regulator enables suction power to be varied according to the type of surface to be treated.

- **Maximum power:** use for carpets, rugs, corners, edges and heavy dirt (gravel, breadcrumbs, etc).
- **Medium power:** saves electricity, reduces noise and is more than enough to remove dust from hard floors and upholstery.
- **Minimum power:** essential when vacuuming delicate and light objects such as lightweight upholstery to avoid the fabric being sucked up and hampering efficient cleaning.

PARKING POSITION

During cleaning, the appliance can be left briefly in a vertical position.

Simply remove the bristles (pressing the pedal to pos , straighten up the brush and push the vacuum cleaner forwards so as to insert the guide X in the slot Y (see figure 7).

Then, to start operation again, pull the vacuum cleaner towards you by the handle until releasing the joint on the brush.

The “parking” position can also be used to store the appliance once the cleaning has been completed: in this case, the appliance should be rested against a wall.

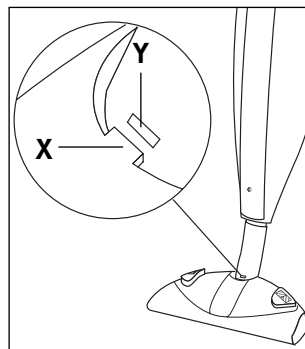

fig. 7

CLEANING AND MAINTENANCE

Before carrying out maintenance of any sort, always make sure the appliance is unplugged from the mains.

Filter full indicator (F)

The filter full indicator lights up when the vacuum duct is blocked or the Eco Heart filter is full.

The appliance has a special Eco Heart filter designed to exploit the space to the full.

The quantity of dust collected is the same as with a paper bag and the performance of the appliance is always constant and efficient.

Empty the Eco Heart filter

Release the clip **C** (Fig. 8), open the Eco Heart filter housing and separate it from the motor assembly (fig. 9).

Remove the "Eco Heart" filter using the special grip (fig. 10). The dirt and dust are contained in the filter.

Rotate the tabs (fig. 11) and release the door of the filter. Empty the filter (fig. 12).

Close the filter again and replace it.

Close the Eco Heart filter housing and fasten with the clip **C**.

Motor filter maintenance

To keep suction power at maximum efficiency, the motor cool and the air given out completely clean and dust free, always keep the motor filter clean. To remove the motor filter, open the appliance, following the instructions for emptying the Eco Heart filter then remove the motor filter (fig. 13).

Simply wash regularly with water and normal detergent then when dry, replace.

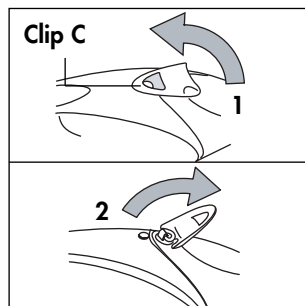

Fig. 8

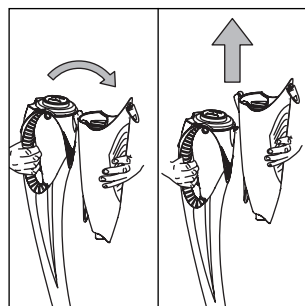

Fig. 9

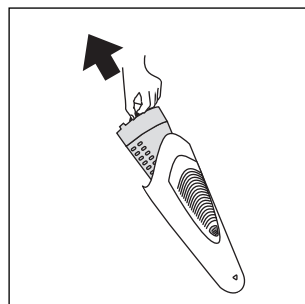

fig. 10

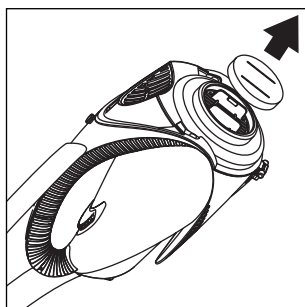

Fig. 13

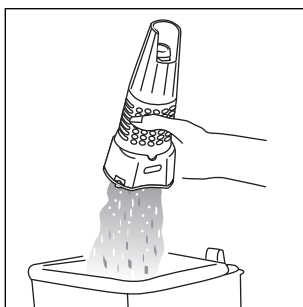

Fig. 12

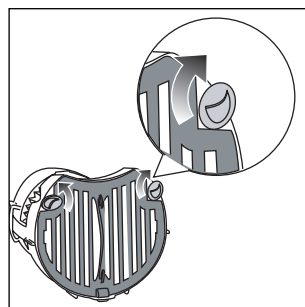

fig. 11

Replacing the activated carbon filters (depending on the model)

Remove the grill **D** by pressing the slide **E** upwards (Fig. 14), remove the grill, rotate it, lift the tab on the filter frame and push it in the direction of the arrow (Fig. 15). The filter should be changed frequently (approx. every 2-3 months) to avoid the recirculation of bacteria in the environment.

To reassemble the filter and the grill:

- 1) Position the filter with the darker side facing the plastic grill and then reposition the frame. (Fig. 16).
- 2) Press the base of the frame at the bottom of the grill (Fig. 17).
- 3) Press the tab at the top of the frame (Fig. 18).
- 4) Replace the grill, first positioning the top part; then rest the bottom part and press the slide downwards until hearing the click (Fig. 19).

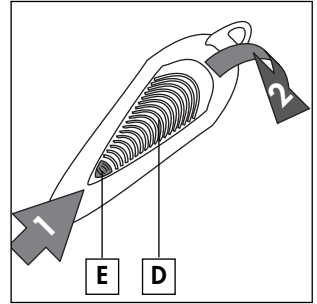

Fig. 14

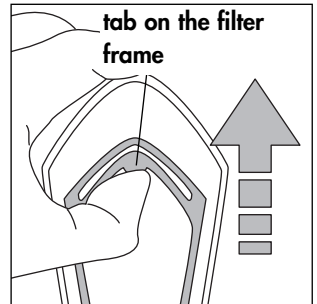

Fig. 15

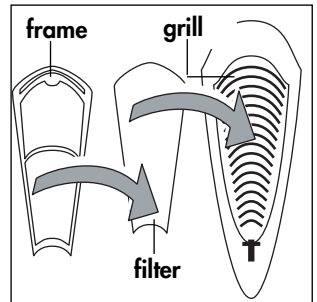

Fig. 16

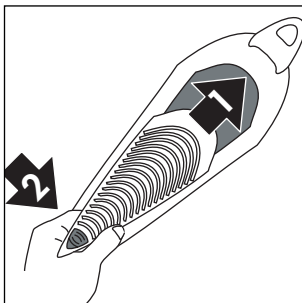

Fig. 19

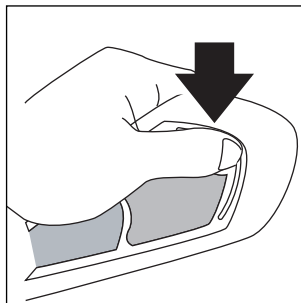

Fig. 18

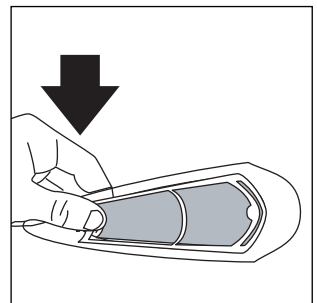

Fig. 17

Cleaning the "Eco Heart" system

You are recommended to thoroughly clean the "Eco Heart" filter system regularly as follows:

- Remove the "Eco Heart" filter and empty as described on the previous page.
- Remove the back filter (fig. 20).
- Pull the top part to separate the "ECO HEART" filter elements (fig. 21) and then remove the washable HEPA* filter.

Clean the filters by shaking. It is also good practice to wash them occasionally in running water and neutral soap. Do not use steel or hard bristle brushes as these could damage the filter material.

Before re-assembling the "Eco Heart" system, dry both filters thoroughly.

To correctly reposition the components of the "Eco Heart" system, line up the De'Longhi logo with the perforated part of the bottom element (fig. 22).

- * The HEPA (High Efficiency Particulate Arresting) filter removes impurities down to a size of 0.1 microns, filtering all types of particle and even bacteria.

The life of a HEPA filter depends on the working conditions of the appliance. You should therefore check the state of the filter regularly and if necessary replace. The filter should, however, last about one year.

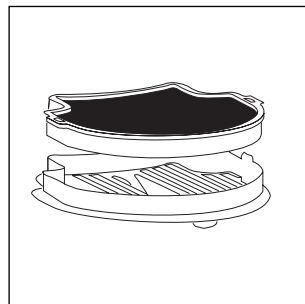

Fig. 20

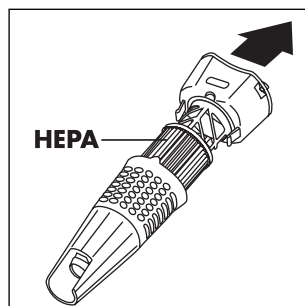

Fig. 21

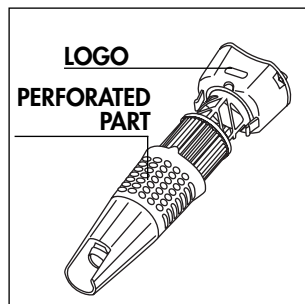

Fig. 22