

WARNINGS

- 1) Read the instructions carefully.
- 2) Before starting the appliance, make sure the filters are in position.
- 3) Check the filters regularly and if necessary brush or replace.
- 4) If you wash the filters, make sure they are completely dry before replacing them.
- 5) Keep the suction outlet away from eyes, ears, nose etc when the appliance is in operation.
- 6) Do not vacuum up red hot objects (cinders, cigarette ends, etc).
- 7) Always unplug the appliance from the mains socket when not in use or before cleaning or maintenance.
- 8) Do not use the appliance if it appears to be faulty.
- 9) To avoid damaging the insulation, do not run the appliance over the power cable.

- 10) Never unplug the appliance by pulling the power cable or the appliance itself.
- 11) Keep the appliance out of reach of children or unfit persons.
- 12) Use the appliance for domestic use only as described in the instructions.
- 13) For repairs, contact your dealer or an authorized service centre only

The manufacturer reserves the right to modify appliances and tools without warning. Original spare parts and tools should always be used to maintain the efficiency of your appliance. Failure to do so invalidates the guarantee.

DESCRIPTION

- A. Handgrip
- B. Hose with handgrip
- C. Built-in handle
- D. Power regulator (if present)
- E. Clip for opening dust bag compartment
- F. Air outlet filter grill
- G. Dust container full indicator
- H. ON/OFF switch
- I. Cable winder
- L. "Eco Heart" Bagless Filter
- M. Suction port
- N. Carpet/floor brush
- O. Multipurpose nozzle for upholstered furniture
- P. Crevice tool

PREPARATIONS FOR USE

FITTING THE HANDLE

After unpacking the appliance, fit the hose with handgrip as shown in fig.1.

Make sure the tab on the hose coupling clicks into place in the circular housing in the aluminium extension tube (fig.2).



The handle can be pulled out to use the appliance as a portable vacuum cleaner (fig.5 and 6). Just press on the circular housing on the tube (fig. 2) and pull upwards.

DESCRIPTION OF THE TOOLS

To make sure the tools are correctly attached to the cleaner, press in firmly:

Carpet/floor brush (M)

Efficiently removes dust from floors (marble or tiled), rugs or carpets.

When the pedal (fig. 3) is pushed towards the "hard floors" position (), the bristles protrude to clean hard floors more efficiently. This position is recommended for in-depth cleaning of floors and for floors with pronounced joints. When the pedal is pushed towards the "carpets" symbol (), the bristles retract and the brush is ready to clean fabric surfaces and delicate floors such as parquet, marble, etc.

To reach under radiators or shallow furniture, flatten the brush by lowering it and rotating it clockwise or anticlockwise (Fig. 4).

Multipurpose nozzle for upholstered furniture (fig. 5)

Ideal for cleaning sofas, armchairs, upholstery, car interiors, blankets, mattresses, curtains, etc.

Crevice tool (fig. 6)

For cleaning corners, edges, etc.

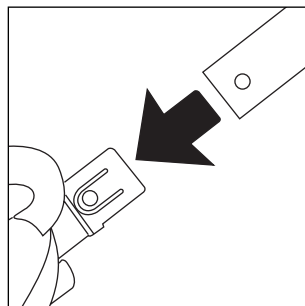

fig. 1

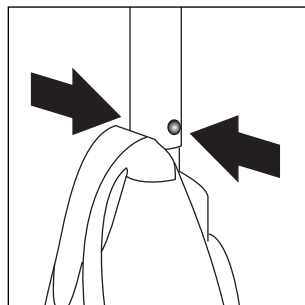

fig. 2

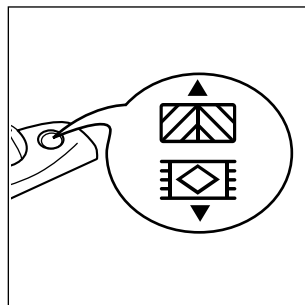

fig. 3

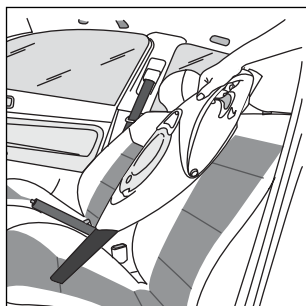

fig. 6

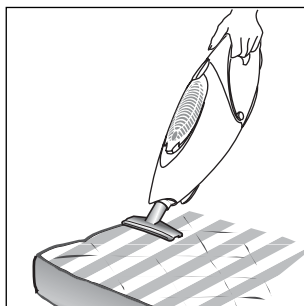

fig. 5

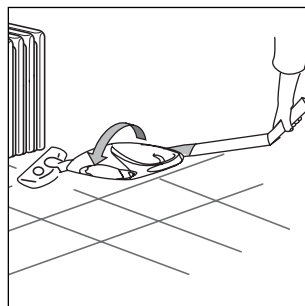

fig. 4

TURNING THE APPLIANCE ON

Set the appliance up according to your cleaning requirements, then plug into a suitable mains socket. Press the ON/OFF switch (H).

MODELS WITH POWER REGULATOR (D) (IF PRESENT)

In models with power regulation (D), adjust the power by turning the regulator. Before turning the appliance on, you are recommended to turn the regulator to minimum.

The electronic regulator enables suction power to be varied according to the type of surface to be treated.

- **Maximum power:** use for carpets, rugs, corners, edges and heavy dirt (gravel, breadcrumbs, etc).
- **Medium power:** saves electricity, reduces noise and is more than enough to remove dust from hard floors and upholstery.
- **Minimum power:** essential when vacuuming delicate and light objects such as lightweight upholstery to avoid the fabric being sucked up and hampering efficient cleaning.

"PARKING" POSITION

While cleaning, the appliance can be left briefly in the vertical. Simply extract the bristles (by pressing the pedal towards the  position), place the brush in an upright position and push the cleaner forwards until the guide X fits into the slot Y (see figure 7). To resume work, pull the cleaner by the handgrip towards itself until the brush joint is released.

The "parking" position can also be used to put the appliance away after cleaning. You should, however, always rest it against a wall.

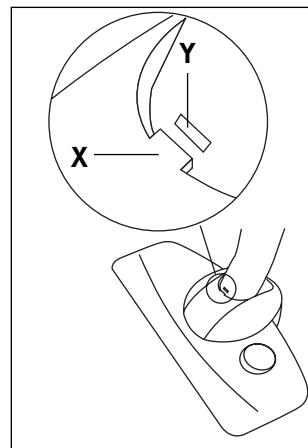

fig. 7

CLEANING AND MAINTENANCE

Before carrying out maintenance of any sort, always make sure the appliance is unplugged from the mains.

Container full indicator (G)

The container full indicator is activated when the vacuum hose is blocked or the dust container is over full.

The appliance is fitted with a special "Eco Heart" container.

Thanks to its special shape, the "Eco Heart" container exploits the available space to the full.

The quantity of dust collected is the same as with a paper bag and the performance of the appliance is always constant and efficient.

Empty the "Eco Heart" dust container

Release the clip **E** (Fig. 8), open the dust compartment and separate it from the motor assembly (fig. 9).

Remove the "Eco Heart" filter using the special grip (fig. 10). The dirt and dust are contained in the filter.

Rotate the tabs (fig. 11) and release the door of the filter. Empty the container (fig. 12).

Close the container again and replace it.

Close the dust bag compartment and fasten with the clip **E**.

Motor filter maintenance

To keep suction power at maximum efficiency, the motor cool and the air given out completely clean and dust free, always keep the motor filter clean. To remove the filter, open the appliance, following the instructions for replacing the dust bag, then remove the filter (fig. 13). Simply wash regularly with water and normal detergent then when dry, replace.

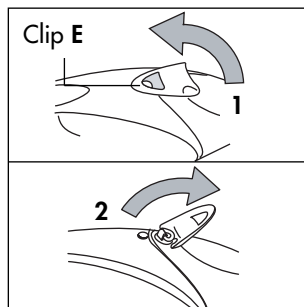

Fig. 8

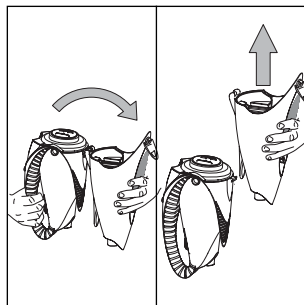

Fig. 9

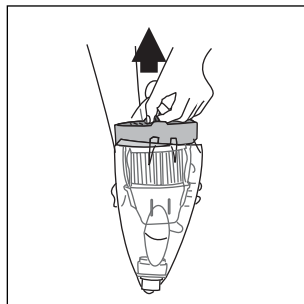

fig. 10

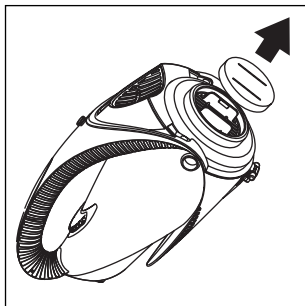

Fig. 13

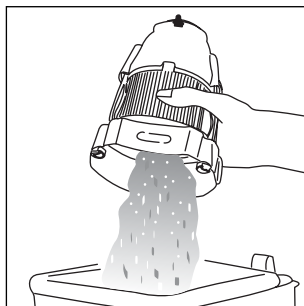

Fig. 12

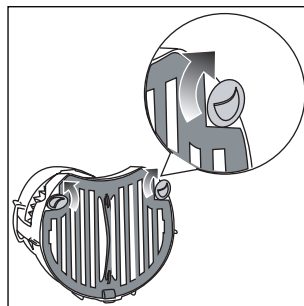

Fig. 11

Replacing the microfilter

Release clip **E**.

Release grill **F** using the tab (Fig. 14), then remove the grill and extract the filter.

Replace the filter with a new one, attaching it to the teeth provided. Replace the grill by pressing it down firmly on all sides (fig. 15). The microfilter should be changed often (about every 2-3 months) to avoid bacteria circulating in the environment.

Cleaning the "Eco Heart" system

You are recommended to thoroughly clean the "Eco Heart" dust collection system regularly as follows:

- Remove the "Eco Heart" dust container and empty as described on the previous page.
- Remove the back filter (fig. 16).
- Press lightly on the two tabs and lift the top part (fig.17).
- Remove the washable HEPA filter* (fig. 18).

Clean the filters by shaking. It is also good practice to wash them occasionally in running water and neutral soap. Do not use steel or hard bristle brushes as these could damage the filter material. Before re-assembling the "Eco Heart" system, dry both filters thoroughly.

To correctly reposition the components of the "Eco Heart" system, line up the De'Longhi logo with the projection on the HEPA filter (fig. 19).

* The HEPA (High Efficiency Particulate Arresting) filter removes impurities down to a size of 0.1 microns, filtering all types of particle and even bacteria.

The life of a HEPA filter depends on the working conditions of the appliance. You should therefore check the state of the filter regularly and if necessary replace. The filter should, however, last about one year.

A line drawing of the microfilter assembly. A hand is shown using a tab to lift a grill labeled 'F'. A clip labeled 'E' is shown being released from the side of the assembly. Arrows 1 and 2 indicate the direction of movement for the grill and clip respectively.

Fig. 14

A line drawing showing a hand pressing the grill back onto the filter assembly. The grill is shown in a slightly raised position, and the hand is applying pressure to it.

Fig. 15

A line drawing of the back filter, which is a rectangular, pleated filter. It is shown being lifted out of a dust container.

Fig. 16

A line drawing of the HEPA filter being inserted into the dust container. Arrows indicate the direction of insertion.

Fig. 19

A line drawing of the HEPA filter being removed from the dust container. An arrow indicates the direction of removal.

Fig. 18

A line drawing of the top part of the dust container being lifted. Arrows indicate the direction of lifting.

Fig. 17

13