

Dear customer

Congratulations! You have just bought a De'Longhi Tabata, the latest generation upright vacuum cleaner, versatile, easy to handle and powerful.

Our products are the result of exhaustive technical tests backed by consolidated experience in the production of home cleaning appliances.

We have produced this manual to enable you to get the best from your appliance and appreciate its quality to the full.

If you follow our tips, we are sure the appliance will give you complete satisfaction and long and faithful service.

This appliance will make your everyday household cleaning easier.

IMPORTANT

- 1) Read the instructions carefully
- 2) Before starting the appliance, make sure the filters are in position.
- 3) Check the filters regularly and if necessary brush or replace.
- 4) If you wash the filters, make sure they are completely dry before replacing them.
- 5) Keep the suction port away from eyes, ears, nose etc when the appliance is in operation.
- 6) Do not vacuum up red hot objects (cinders, cigarette ends, etc).
- 7) Always unplug the appliance from the mains socket when not in use or before cleaning or maintenance.
- 8) Do not use the appliance if it appears to be faulty.
- 9) To avoid damaging the insulation, do not run the appliance over the power cable.
- 10) Never unplug the appliance by pulling the power cable or the appliance itself.
- 11) Keep the appliance out of reach of children or unfit persons.
- 12) Use the appliance for domestic use only as described in the instructions.
- 13) For repairs, contact your dealer or an authorized service centre only

The manufacturer reserves the right to modify appliances and tools without warning. Original spare parts and tools should always be used to maintain the efficiency of your appliance. Failure to do so invalidates the guarantee.

DESCRIPTION

- **"Nautilus System"**
 - A. Jointed handgrip with cap
 - B. Handgrip release slide
 - C. Fork rotation device
 - D. Fork
- E. Built-in handle
- F. Power regulator
- G. Clip for opening dust container
- H. Air outlet filter grill
- I. Dust container full indicator
- L. ON/OFF switch
- M. Cable winder
- N. Suction port
- O. "Eco Heart" Bagless Filter
- P. Two position carpet/floor brush or "Explora" brush (depending on model)
- Q. Multipurpose nozzle for upholstered furniture
- R. Crevice tool

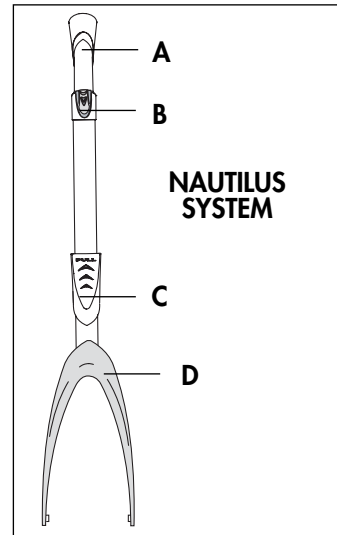

INTRODUCTION

Versatile, powerful and compact, Tabata goes wherever you want, but above all, becomes whatever you want whenever you want.

Thanks to the innovative **"Nautilus System"** rotating fork, you can transform it in a flash:

1

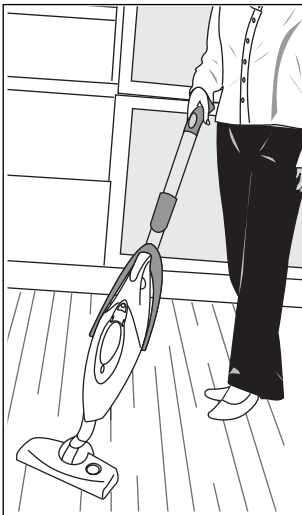

Traditional upright vacuum cleaner for floors or carpets

2



Vacuum cleaner to **remove difficult to reach dirt** (under or on top of furniture, etc).

3

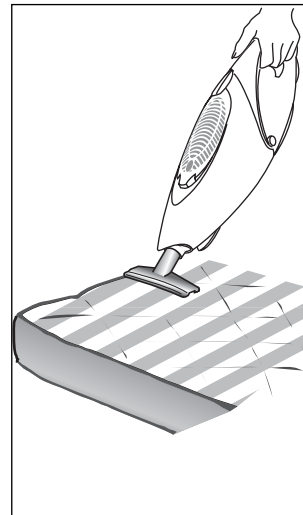

Portable vacuum cleaner to clean sofas, car interiors, mattresses, etc.

PREPARATIONS FOR USE

Unpack the appliance, fit the suction hose into the hole in the fork of the "Nautilus System" (fig. 1), push it in as far as it will go then rotate clockwise until it locks in place. **To ensure the hose is correctly inserted, make sure the word "PULL" on the rotating device on the hose is turned towards the built-in handle (E).**

Now the "Nautilus System" is in the correct position to use the appliance as a traditional upright vacuum cleaner.

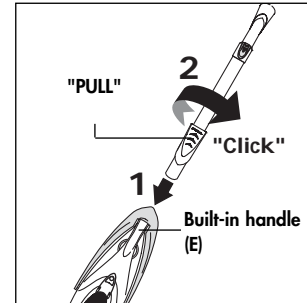

Fig. 1

USING AS A TRADITIONAL UPRIGHT VACUUM CLEANER

Cleaning floors and carpets

Make sure the "Nautilus System" is turned towards the built-in handle E. Fit the carpet/floor brush O (depending on model), pushing it into the suction port N as far as it will go (fig. 2). To remove, just pull until it comes out.

The two-position carpet/floor brush efficiently removes dust from floors (marble or tiled), rugs or carpets.

When the pedal (fig. 3) is pushed towards the "hard floors" position (⊞), the bristles protrude to clean hard floors more efficiently. This position is recommended for in-depth cleaning of floors and for floors with pronounced joints. When the pedal is pushed towards the "carpets" symbol (⊞), the bristles retract and the brush is ready to clean fabric surfaces and delicate floors such as parquet, marble, etc.

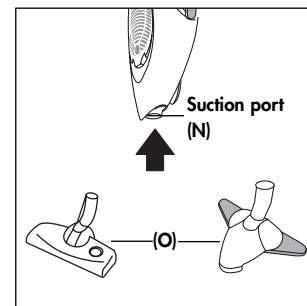

Fig. 2

With the "Explora" brush (certain models only), the cleaner vacuums up dust from hard floors, carpets or rugs efficiently.

The jointed wings make it ideal for vacuuming near furniture or in corners (Fig. 3).

To reach under radiators or shallow furniture, flatten the brush by lowering it and rotating it clockwise or anticlockwise (Fig. 4).

To reach under beds or deeper furniture, you should set the cleaner up for cleaning inaccessible places as described in the paragraph "Using as a vacuum cleaner to clean inaccessible places".

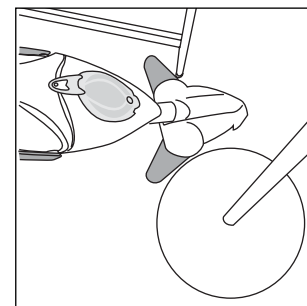

Fig. 3

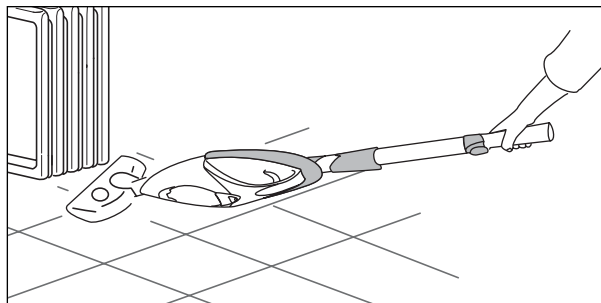

Fig. 4

USING AS A VACUUM CLEANER TO CLEAN INACCESSIBLE PLACES

Cleaning under furniture

To reach inaccessible places, set the appliance up as follows. Move the handgrip release slide **B** downwards and at the same time rotate the handgrip through 180° until it lines up with the hose (fig. 5). Release the slide **B**.

Remove the carpet/floor brush **O** (depending on model). Holding the appliance by the built-in handle, release the fork **D** by sliding the fork rotation device **C** upwards in the direction indicated by the arrow. Rotate the fork through 180° from the part opposite the appliance, then release the device **C**, accompanying the hose until it fits correctly into the suction port **N** (fig. 6).

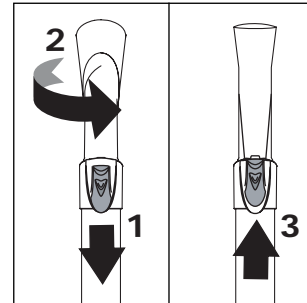

Fig. 5

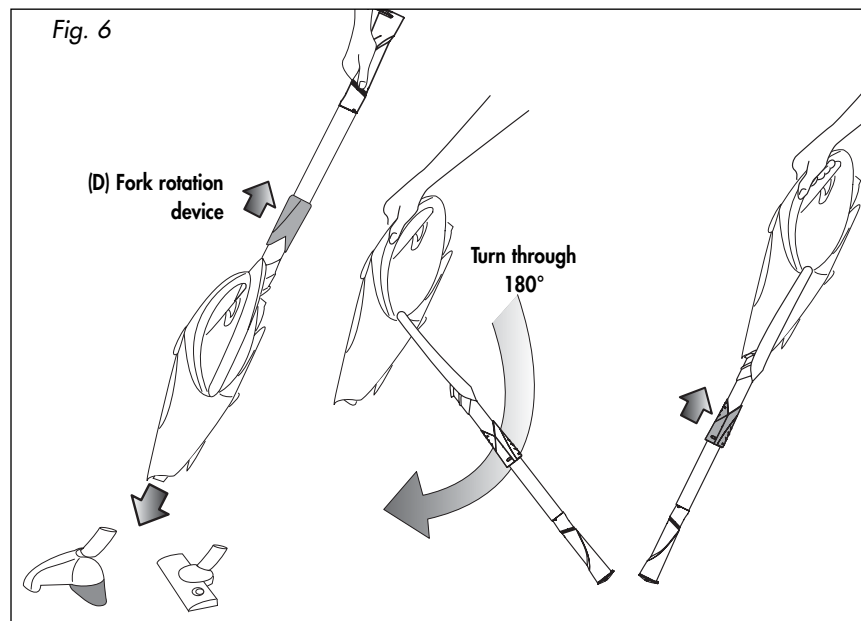

Fig. 6

Remove the rubber cap covering the end of the handgrip **A** and fit the carpet/floor brush **O** supplied with your appliance. With the fork turned towards the suction port **N**, the hose and handgrip thus act as an extension tube, enabling you to reach inaccessible places (fig. 7).

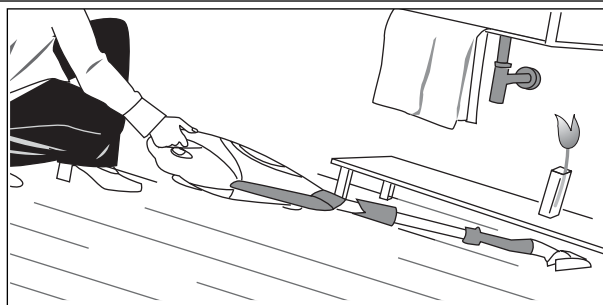

Fig. 7

Cleaning under furniture

With the fork **D** in the position described, rotate the jointed hand-grip (A) through 180° until it is at an angle to the hose.

If you use the carpet/floor brush **O** (depending on model) to clean the top of high furniture, rotate the appliance with the built-in handle **E** turned downwards (fig. 8). If necessary, hold the appliance with both hands to balance the weight.

USING AS A PORTABLE VACUUM CLEANER

To use your appliance as a portable vacuum cleaner, remove the "Nautilus System".

You must then:

- release the fork **D** by sliding the fork rotation device upwards in the direction indicated by the arrow (fig. 9);
- release the two fixing points (fig. 10).

Fit the required tool to the suction port (**N**):

- **Multipurpose nozzle for upholstered furniture:** ideal for cleaning sofas, armchairs, upholstery, car interiors, blankets, mattresses, curtains, etc.
- **Crevice tool:** for cleaning corners, edges, etc.

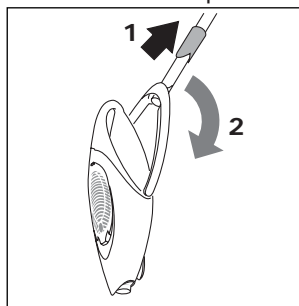

Fig. 9

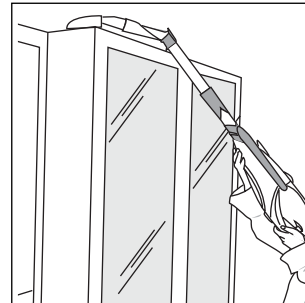

Fig. 8

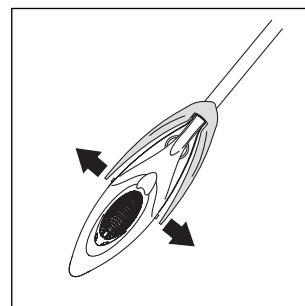

Fig. 10

HOW TO FIT THE "NAUTILUS SYSTEM"

With the "Nautilus System" and the appliance positioned as shown in fig. 11, insert the two fixing points one after the other, then turn the fork towards the built-in handle.

To make sure the fork is correctly inserted, make sure the word "PULL" on the rotating device on the hose is turned towards the built-in handle (E).

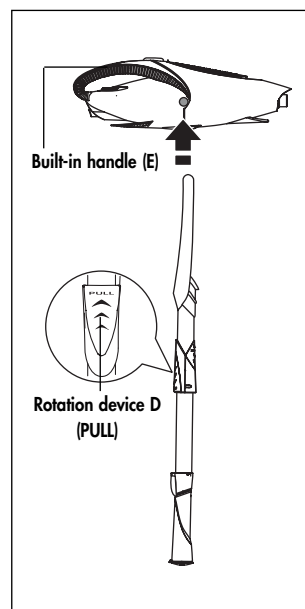

Fig. 11

TURNING THE APPLIANCE ON

Set the appliance up according to your cleaning requirements, then plug into a suitable mains socket. Press the ON/OFF switch **L**.

MODELS WITH POWER REGULATOR (F)

In models with power regulation, adjust the power by turning the regulator **F**. Before turning the appliance on, you are recommended to turn the regulator to minimum.

The electronic regulator enables suction power to be varied according to the type of surface to be treated.

- **Maximum power:** use for carpets, rugs, corners, edges and heavy dirt (gravel, breadcrumbs, etc).
- **Medium power:** saves electricity, reduces noise and is more than enough to remove dust from hard floors and upholstery.
- **Minimum power:** essential when vacuuming delicate and light objects such as lightweight upholstery to avoid the fabric being sucked up and hampering efficient cleaning.

PARKING POSITION

Appliances with two position carpet/floor brush

During pauses in cleaning, the appliance can be left for short periods of time in the vertical "parking" position, following the instructions below.

Place the brush pedal in the "hard floors" position (bristles out) and push the cleaner forwards until the guide **X** fits into the slot **Y** (see figure 12). To resume work, hold the brush firmly on the floor with your foot and pull the cleaner upwards until the guide **X** is released (fig. 13).

Appliances with Explora brush

During cleaning, the appliance can be left briefly in a vertical position. Press the cleaner downwards until the projections on the "Explora" brush joint fit into the guides (Fig. 14).

To resume work, hold the brush firmly on the ground with your foot, then pull the cleaner upwards by the handgrip until the Explora brush joint is released. (Fig. 15).

Never block the Explora brush on the ground by pressing with your foot on the jointed wings.

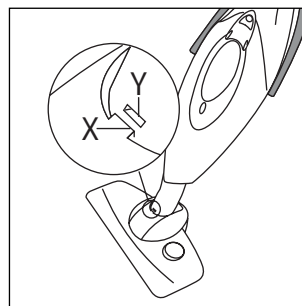

Fig. 12

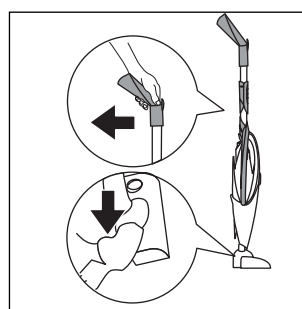

Fig. 13

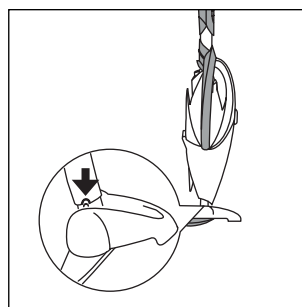

Fig. 14

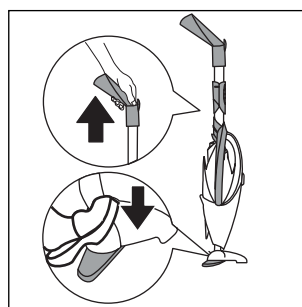

Fig. 15

CLEANING AND MAINTENANCE

Before carrying out maintenance of any sort, always make sure the appliance is unplugged from the mains.

Container full indicator (I)

The container full indicator is activated when the vacuum hose is blocked or the dust container is over full.

The appliance is fitted with a special "Eco Heart" container.

Thanks to its special shape, the "Eco Heart" container exploits the available space to the full.

The quantity of dust collected is the same as with a paper bag and the performance of the appliance is always constant and efficient.

Empty the "Eco Heart" dust container

Release the clip **G** (Fig. 16), open the dust compartment and separate it from the motor assembly (fig. 17).

Remove the "Eco Heart" filter using the special grip (fig. 18). The dirt and dust are contained in the filter.

Rotate the tabs (fig. 19) and release the door of the filter. Empty the container (fig. 20).

Close the container again and replace it.

Close the dust bag compartment and fasten with the clip **G**.

Motor filter maintenance

To keep suction power at maximum efficiency, the motor cool and the air given out completely clean and dust free, always keep the motor filter clean. To remove the filter, open the appliance following the instructions for emptying the dust container, then remove the filter (Fig. 21). Simply wash regularly with water and normal detergent then when dry, replace.

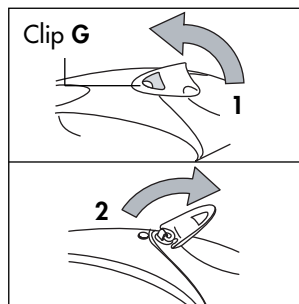

Fig. 16

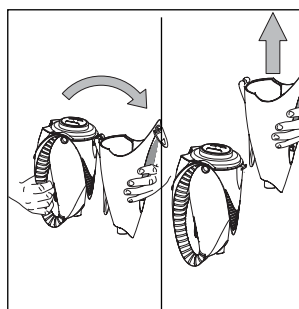

Fig. 17

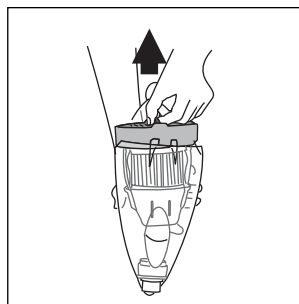

Fig. 18

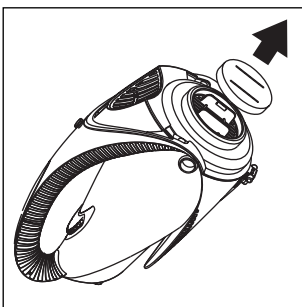

Fig. 21

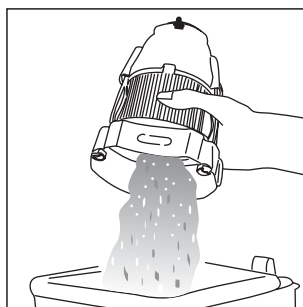

Fig. 20

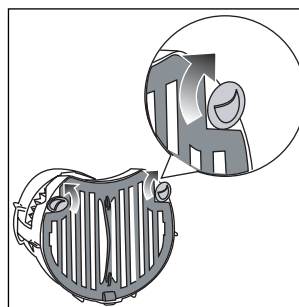

Fig. 19

Replacing the microfilter

Release clip **G**.

Release grill **H** using the tab (Fig. 22), then remove the grill and extract the filter.

Replace the filter with a new one, attaching it to the teeth provided. Replace the grill by pressing it down firmly on all sides (fig. 23). The microfilter should be changed often (about every 2-3 months) to avoid bacteria circulating in the environment.

Cleaning the "Eco Heart" system

You are recommended to thoroughly clean the "Eco Heart" dust collection system regularly as follows:

- Remove the "Eco Heart" dust container and empty as described on the previous page.
- Remove the back filter (fig. 24).
- Press lightly on the two tabs and lift the top part (fig.25).
- Remove the washable HEPA filter* (fig. 26).

Clean the filters by shaking. It is also good practice to wash them occasionally in running water and neutral soap. Do not use steel or hard bristle brushes as these could damage the filter material.

Before re-assembling the "Eco Heart" system, dry both filters thoroughly.

To correctly reposition the components of the "Eco Heart" system, line up the De'Longhi logo with the projection on the HEPA filter (fig. 27).

* The HEPA (High Efficiency Particulate Arresting) filter removes impurities down to a size of 0.1 microns, filtering all types of particle and even bacteria.

The life of a HEPA filter depends on the working conditions of the appliance. You should therefore check the state of the filter regularly and if necessary replace. The filter should, however, last about one year.

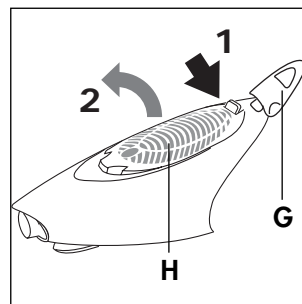

Fig. 22

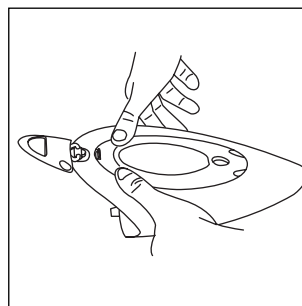

Fig. 23

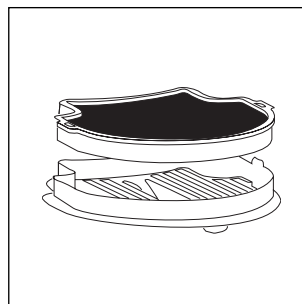

Fig. 24

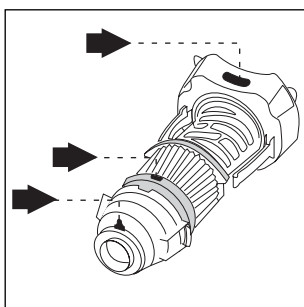

Fig. 27

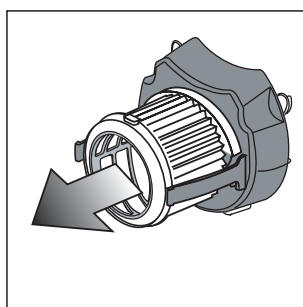

Fig. 26

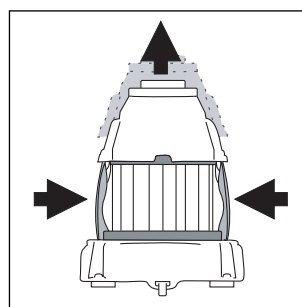

Fig. 25