

Congratulations and thank you for choosing our company.

All our products are the result of meticulous design and technical testing.

We have produced this manual to enable you to get the best from your appliance and appreciate its quality to the full.

If you follow our tips, we are sure the appliance will give you complete satisfaction and long and faithful service.

By exploiting the power of steam, it helps reduce air pollution caused by the dispersion of chemical detergents.

This appliance exploits the power of steam to facilitate everyday cleaning in the home or for gardening, hobbies or DIY.

It has been designed to improve the hygiene of household surfaces and upholstery.

DESCRIPTION

- A** Filter
- B** Steam generator cap
- C** Condensate tank + filter
- D** Suction port
- E** Tank release slide
- F** ON/OFF light
- G** Steam ready light
- H** No water light
- I** ON/OFF switch
- J** Rear grille
- J1** Back filter

STANDARD TOOLS*

- K** Flexible hose with handgrip
- L** Extension tubes
- M** Brush
- N** Triangular nozzle
- O** Squeegee
- P** Multi-purpose nozzle with brush
- Q** Connector with lance
- R** Brushes
- S** T"-shaped nozzle

* The standard tools vary according to model.

IMPORTANT SAFEGUARDS

- 1) **Read the instructions carefully**
- 2) The appliance contains pressurised steam. Incorrect or improper use could be dangerous. The appliance is designed for household use or for gardening, hobbies or DIY. All types of industrial use are excluded. The manufacturer declines all liability for damage deriving from improper use of the product.
- 3) Do not leave the appliance unattended while plugged into the mains socket.
- 4) Always unplug the appliance from the mains socket before starting to fill the steam generator tank or before cleaning or maintenance.
- 5) Before use, check that the mains voltage corresponds to the voltage indicated on the rating plate on the bottom of the appliance.
- 6) Plug the appliance into an efficiently earthed socket with a minimum rating of 10 A.
- 7) Never direct the steam jet towards power sockets or appliances containing electrical components such as those inside ovens. They could be damaged.
- 8) Never direct the steam jet towards the appliance.
- 9) Never unplug the appliance by pulling the power cable or appliance itself.
- 10) To avoid damaging the insulation, do not run the appliance over the power cable. **Never place the appliance in a vertical position.**
- 11) Do not open the cap while the appliance is in use and before all the water has been used up (steam is no longer discharged by the tools). To add water, unplug from the mains and wait about 15 minutes to avoid sudden temperature changes. Place a cloth over the cap and unscrew slowly to allow residual steam to escape gradually.
- 12) Avoid the steam coming into contact with the skin. The high temperature could cause serious burns. Never direct the steam jet towards persons or animals or towards surfaces or objects which could be damaged by high temperatures.
- 13) To move the appliance, hold by the handgrip. As it incorporates a steam generator, surfaces become hot during use. Persons affected by particular pathologies causing abnormal sensitivity to heat should take special care when using this appliance.
- 14) Do not add detergent to the tank. Use water only.
- 15) If not used for long periods, you are recommended to allow all water to evaporate before putting the appliance away.
- 16) The appliance is not intended for use by persons (including children) with reduced physical, sensory or mental capabilities, or lack of experience and knowledge, unless they have been given supervision or instruction concerning use of the appliance by a person responsible for their safety. Children should be supervised to ensure that they do not play with the appliance.
- 17) Do not use the appliance if it appears to be faulty. Contact your local dealer or an authorised service centre.
- 18) If the overheat switch trips, the appliance shuts down. To reuse, contact specialised personnel.
- 19) Protect the appliance from the elements (rain, frost, sun, etc).
- 20) For repairs contact an authorised service centre in order to avoid compromising the efficiency of your appliance and to maintain the validity of the guarantee. For the same reasons, you are always recommended to use original spare parts. If the power cable is damaged, it must be replaced by the manufacturer or an authorised technical service centre in order to avoid all risk.

This appliance conforms to EEC directives 73/23 and 93/68 (and subsequent amendments) on Low Voltage and 89/336 (and subsequent amendments) on Electromagnetic Compatibility.

KEEP THESE INSTRUCTIONS CAREFULLY

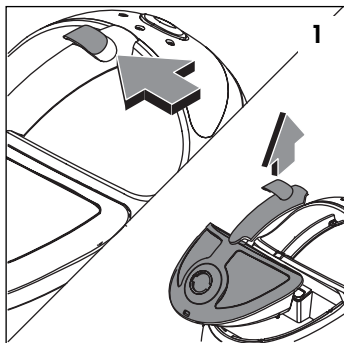

ASSEMBLY AND PREPARATION FOR USE

Before carrying out maintenance on the appliance or preparing it for cleaning, make sure it is unplugged from the mains socket.

Remove the condensate tank by sliding the slide on the handle (fig. 1).

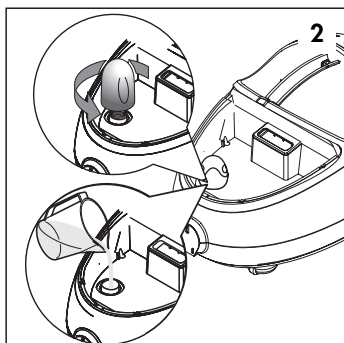

To open the steam generator, unscrew the cap (fig. 2).

Fill the tank with a maximum of about 1.5 litres of tap water (without adding detergent).

Screw up the cap until completely closed.

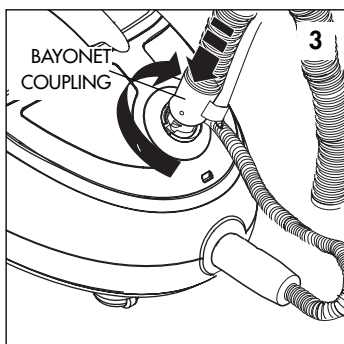

PREPARING THE CLEANING TOOLS

Connect the hose (fig. 3).

Insert the bayonet coupling into the socket on the cover, press down and rotate clockwise as far as it will go.

Insert the extension tube onto the hose handgrip, making sure the handgrip coupling is perfectly connected to the extension tube coupling by pushing firmly together. **Lock in place by rotating the locking ring (1) (fig. 4).**

To make sure it is fitted correctly, attempt to remove the extension tube.

To insert the second extension tube or brush, proceed as described above.

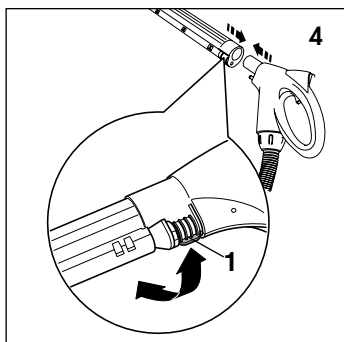

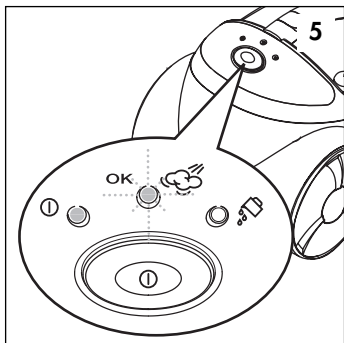

OPERATING THE APPLIANCE

Plug the power cable into the mains socket.

Press the ON/OFF button.

The power light comes on.

When the steam ready light comes on, the appliance is ready for use (fig. 5).

This takes about 15 minutes.

During operation, the steam ready light comes on and goes off. This is part of normal operation.

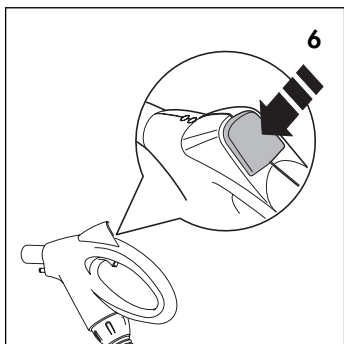

N.B: When used for the first time, the appliance may give out smoke and an odour for several minutes. This is caused by heating and subsequent drying of the sealers used in assembling the steam generator. You are recommended to ventilate the room.

To deliver steam, hold the button on the bottom of the hose handgrip down. Release it to stop delivery. Activate suction by pressing the ON/OFF button (fig 6). The appliance will then wash and vacuum at the same time. In the case of persistent marks, you are recommended to steam first, then vacuum. (See paragraph "Extraction washing technique").

When the water in the steam generator is about to run out, the "no water" indicator light comes on (fig. 7).

To fill again, proceed as follows:

Press the ON/OFF button to turn the appliance off.

Unplug from the mains socket.

Remove the condensate tank by sliding the slide on the handgrip (fig. 1).

Wait 10-15 minutes for the appliance to cool down.

Slowly unscrew the cap, using a cloth to allow residual steam to escape.

Refill as described above.

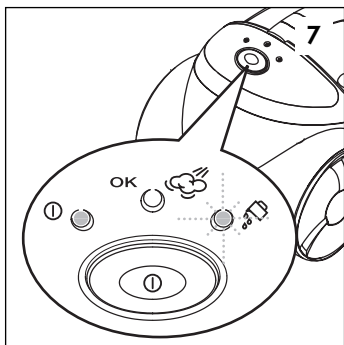

Important! Never unscrew the cap with the steam generator under pressure and never operate the appliance without water.

Whenever you top up with water, remove the condensate tank by sliding the slide on the handgrip, then release and remove the tank lid (fig. 8).

Empty the condensate water, rinse the internal filters (fig. 9), replace them in their housings then close the tank again by pressing on the front until it clips into place.

Replace the tank by resting it on the appliance and closing the slide again.

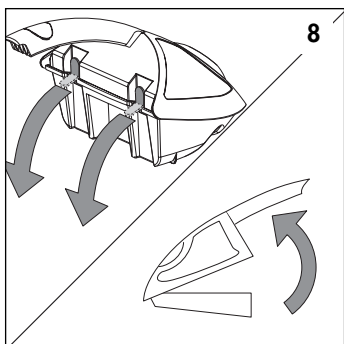

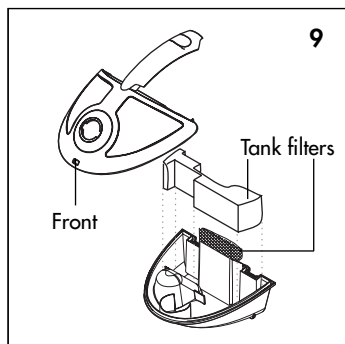

CLEANING TIPS

Extraction washing technique

For extraction washing, proceed as follows:

Aim the steam jet at the surface to be treated using the steam button and at the same time activate suction using the ON/OFF button on the hose handgrip.

Pass a number of times over the surface to be treated vacuuming only.

The treated surfaces will be almost completely dry and the dirt will be removed.

Steam cleaning without extraction

To use the appliance as a steam cleaner only, proceed as above, but without activating the vacuum system, in other words, without pressing the vacuum button. It is not necessary to press the suction button on the hose handgrip.

EXTRACTION AND STEAM CLEANING TOOLS (the exact tools supplied vary according to model)

Multipurpose brush (fig. 10)

To use the steam extraction washing brush on hard floors turn the pedal until the bristles are protruding.

This obtains a combined steam+brush action for more efficient cleaning.

Then to vacuum up the dirt, press the pedal to raise the brushes and repass with suction only.

After cleaning, drops of water may fall from the brush. This is caused by condensate forming in the tubes.

Tips: not recommended for treated terracotta floors, waxed floors and parquet.

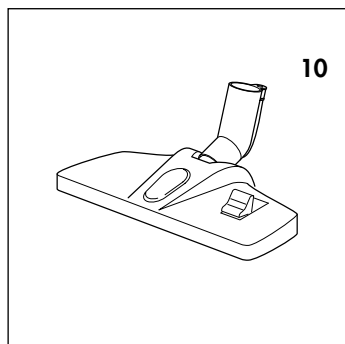

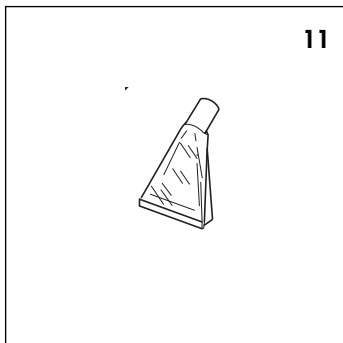

Triangular nozzle (fig. 11)

Insert the extension tube either directly onto the handgrip, making sure the coupling is perfectly connected to the handgrip coupling, or to the extension tube, pushing firmly together and then **locking by rotating the locking ring**.

Use the triangular nozzle to wash and wet vacuum upholstery, sofas, furniture and hanging fabrics.

To avoid damaging colours and delicate fabrics, you should first test on a concealed part of the carpet or upholstery to be cleaned.

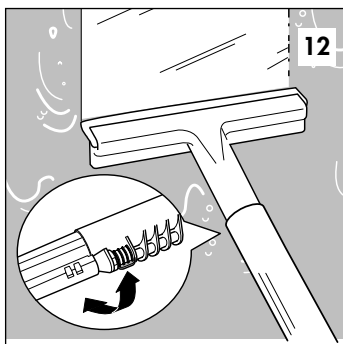

Squeegee tool (fig. 12)

The squeegee tool is extremely useful for cleaning glazed surfaces.

Insert the extension tube either directly onto the handgrip, making sure the coupling is perfectly connected to the handgrip coupling or to the extension tube, pushing firmly together and then locking by rotating the locking ring.

Aim the jet at the surface to be washed.

To dry, tilt the tool so that the squeegee adheres perfectly to the surface to be dried.

Tip: in low temperatures, you are recommended to warm the windows first with a weak jet of steam to avoid the risk of breakage due to sudden temperature changes.

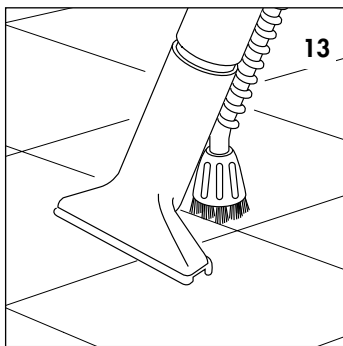

Nozzle with steam insert and brush (fig. 13).

Insert the extension tube either directly onto the handgrip, making sure the coupling is perfectly connected to the handgrip coupling or to the extension tube, pushing firmly together and then locking by rotating the locking ring.

Combined with steam, the brush facilitates removal of the dirt from joints between tiles, radiators, bathroom fittings and all difficult to reach points.

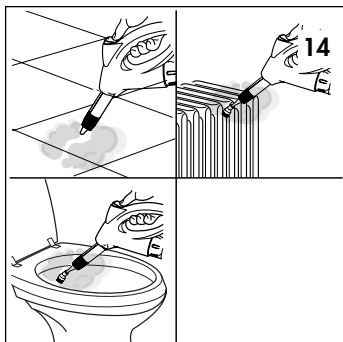

Coupling for steam tools (14)

Enables the steam cleaning lance and brushes to be fitted directly to the hose handgrip or extension tube.

Lance and brushes

After fitting the crevice tool, attach one of the brushes provided.

A number of brushes are provided, enabling you to always use the same brush for the same cleaning task (eg. one for the bathroom, one for the kitchen, etc).

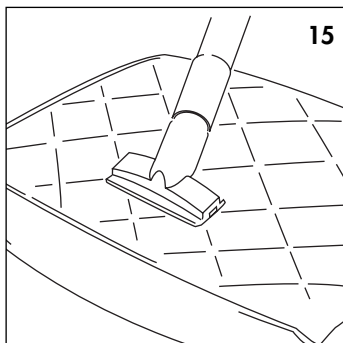

Multi-function nozzle (15)

Used for cleaning sofas, upholstery, car interiors, drapes, etc.

CLEANING AND MAINTENANCE

IMPORTANT: Before cleaning or maintenance, always unplug from the mains socket.

After using the appliance, to improve hygiene you should rinse the tools.

You should empty the condensate collection tank each time you use the appliance and clean the filter in the tank.

If not used for long periods, you are recommended to empty the steam generator before putting the appliance away.

After emptying and rinsing the tank, remove the filter (B), wash under running water and leave to dry.

To improve the working life of the filter, keep it dry.

Every now and then, remove the rear grille (M) of the appliance, remove the filter M1, wash under running water and dry.

Replace the filter and then the rear grille on the appliance, taking care to ensure the guide shown in fig. 16 is positioned at the bottom.

The rear grille can act as a cable tidy (see figure 17).

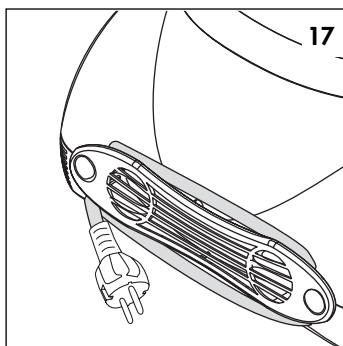
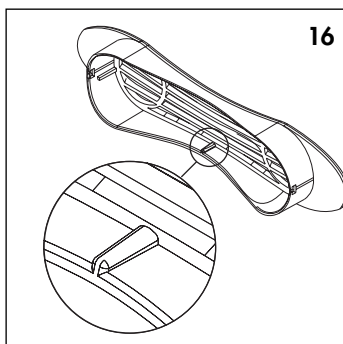

Important information for correct disposal of the product in accordance with EC Directive 2002/96/EC.



At the end of its working life, the product must not be disposed of as urban waste.

It must be taken to a special local authority differentiated waste collection centre or to a dealer providing this service.

Disposing of a household appliance separately avoids possible negative consequences for the environment and health deriving from inappropriate disposal and enables the constituent materials to be recovered to obtain significant savings in energy and resources. As a reminder of the need to dispose of household appliances separately, the product is marked with a crossed-out wheeled dustbin.