



Read  
Operating  
Instructions  
Carefully

Save this  
booklet

Dear Customer,

*all our products are the result of meticulous technical testing supported by a consolidated experience in the design and manufacture of household cleaning appliances.*

*We have prepared this manual to help you make the most of your deep-cleaner and to fully appreciate its superb quality.*

*Please read it carefully before you use your appliance.*

*We are certain that, if you follow our suggestions, this appliance will give you maximum satisfaction and many years of service.*

## Contents

1. Important information	p. 21
2. Preparing for use	p. 22
3. Dry Vacuum	p. 22
3.1 Vacuuming accessories	p. 23
3.2 Electronic version	p. 24
3.3 Paper filter maintenance	p. 25
4. Wet vacuum	p. 25
4.1 Tools and accessories	p. 26
4.2 Emptying the tank	p. 27
5. Extraction cleaning	p. 27
5.1 Extraction-tools accessories	p. 29
5.2 Cold water cleaning	p. 29
5.3 Hot water cleaning	p. 30
5.4 Rinsing operations	p. 31
5.5 Steam cleaning	p. 31
5.6 Extraction cleaning techniques	p. 32
5.7 Cleaning windows	p. 32
6. Care and maintenance	p. 33
6.1 Descaling	p. 34
7. Warranty	p. 35



### IMPORTANT INFORMATION FOR CORRECT DISPOSAL OF THE PRODUCT IN ACCORDANCE WITH EC DIRECTIVE 2002/96/EC.

At the end of its working life, the product must not be disposed of as urban waste. It must be taken to a special local authority differentiated waste collection centre or to a dealer providing this service.

Disposing of a household appliance separately avoids possible negative consequences for the environment and health deriving from inappropriate disposal and enables the constituent materials to be recovered to obtain significant savings in energy and resources. As a reminder of the need to dispose of household appliances separately, the product is marked with a crossed-out wheeled dustbin.

## Components description

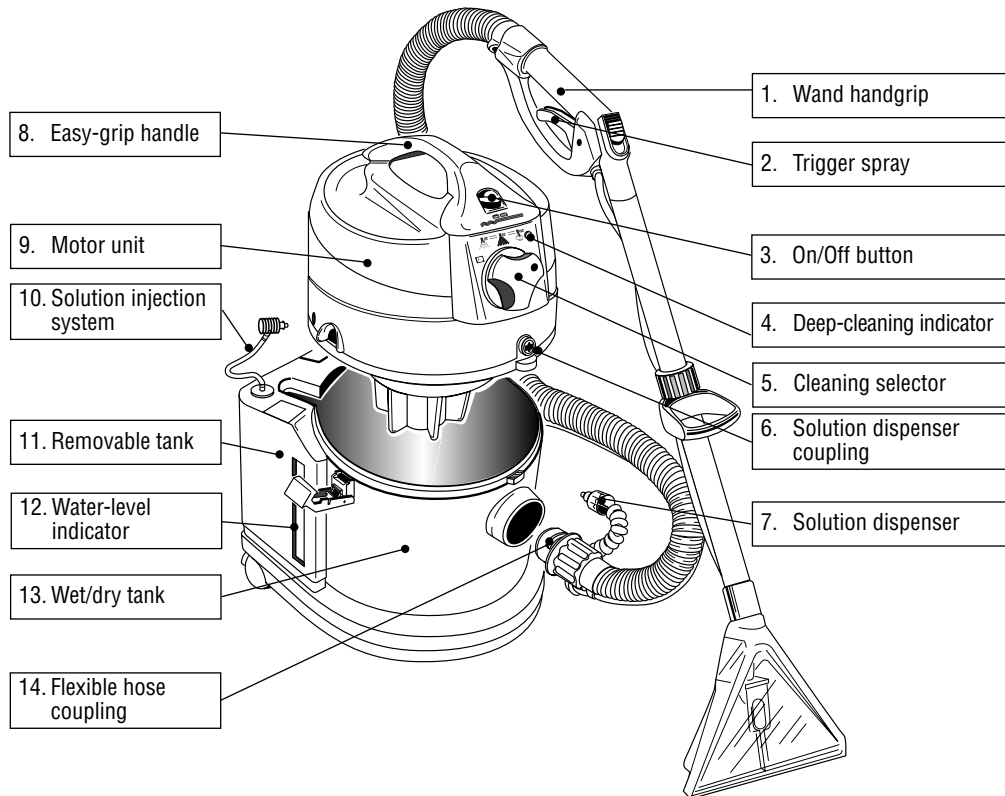

## Tools and accessories

- 15. Flexible suction hose
- 16. Large clear plastic nozzle
- 17. Hard floor brush
- 18. Small clear plastic nozzle (optional)
- 19. Carpet/rug brush
- 20. Window cleaning attachment (optional)
- 21. Shampoo bottle (where provided)
- 22. Two extension tubes
- 23. Multi-purpose nozzle (where provided)
- 24. Round brush attachment (where provided)
- 25. Crevice tool (where provided)
- 26. Wet vacuum filter
- 27. Paper filter (where provided)
- 28. Cloth filter (where provided)
- 29. Dustbag (where provided)
- 30. Extension tube handgrip (where provided)

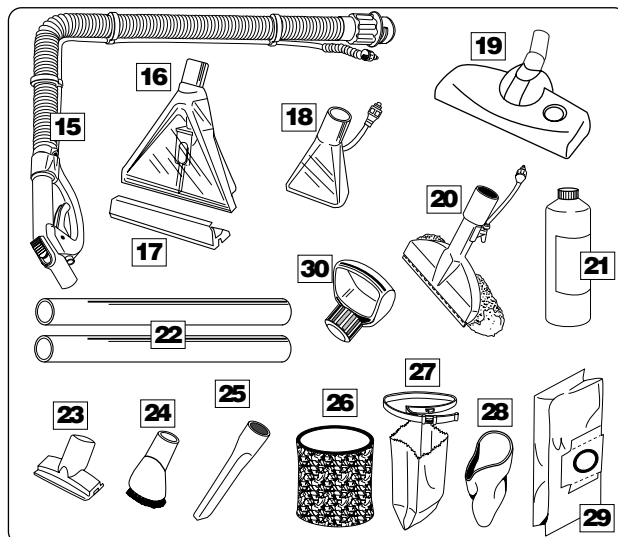

## 1. Important information

- 1) **Read the instruction booklet carefully before using the appliance.**
- 2) The appliance contains pressurised steam. Incorrect or improper use could be dangerous. The appliance is designed for household use or for gardening, hobbies or DIY. All types of industrial use are excluded. The manufacturer declines all liability for damage deriving from improper use of the product.
- 3) **Always disconnect the appliance from mains outlet when not in use or before any maintenance or care operation.**
- 4) Before using, check that the mains voltage corresponds to the voltage indicated in the specifications label under the handle.
- 5) Connect your cleaner only to power outlets with a minimum of 10 amps V, and make sure the outlet is earthed.
- 6) **Do not leave your cleaner unattended while it is running. Keep it away from the reach of children and persons unfit to use it.**
- 7) **Avoid the steam coming into contact with the skin. The high temperature could cause serious burns. Never direct the steam jet towards persons or animals or towards surfaces or objects with could be damaged by high temperatures.**
- 8) Do not aim the water or steam jet at people or animals and do not use on surfaces or objects with a low resistance to heat.
- 9) Never direct the steam jet towards the appliance. Before steam cleaning electrically-powered objects or household appliances (electric oven, refrigerator, extractor fan, etc), unplug these appliances from the mains. Before plugging in again, make sure they are perfectly dry as residual water could cause electrical discharges.
- 10) Avoid skin contact with steam. High temperature may cause serious burns.
- 11) Do not touch the plug or cord with wet hands.
- 12) Do not clean the appliance with trichloroethylene or other solvents. Use soapy water only.
- 13) Do not add detergent to the water tank (steam function). Use water only.
- 14) Do not run the appliance over the power cord as this may damage the insulating sheath.
- 15) Do not tug on the power cord to disconnect the appliance from mains outlet.
- 16) Do not shut the power cord in doors or rub against sharp corners. Keep away from hot surfaces.
- 17) Do not use the appliance to pick up matches, hot ash, or burning cigarette ends.
- 18) Do not use to pick up flammable liquids.
- 19) Avoid vacuuming up hard or sharp objects that might damage the dustbag or the appliance itself. Do not use to pick up nails, pins, screws, coins, or other metal objects.
- 20) Always check that filters are in place before switching on your appliance.
- 21) After use, disconnect the flexible hose and the solution dispenser before storing the appliance. Empty the solution dispenser by working the dispenser trigger.
- 22) Periodically check the exhaust filters, and replace if necessary.
- 23) After washing the wet vacuum filter, make sure it is perfectly dry before re-positioning it.
- 24) **Be especially careful when using the appliance on stairs.**
- 25) To prevent fire or shock hazard do not expose the appliance to rain or moisture. Keep out of direct sunlight.
- 26) Do not attempt to use the appliance if it appears to be faulty. Do not use with a damaged power cord or plug. If the machine has been accidentally dropped, left outside, immersed in water or otherwise wet, take it to an authorized Technical Service Centre.
- 26) To repair or if the power cable is damaged and requires replacement, contact an authorised service centre in order to avoid compromising the efficiency of your appliance and guarantee the validity of the guarantee. For the same reasons, you are always recommended to use original spare parts.

### **SAVE THESE INSTRUCTIONS**

The manufacturer reserves the right to change the specifications of the appliance and/or accessories without prior notice. This appliance complies with EEC Directive 73/23 and 93/68 CEE and 89/336 CEE on electromagnetic compatibility.

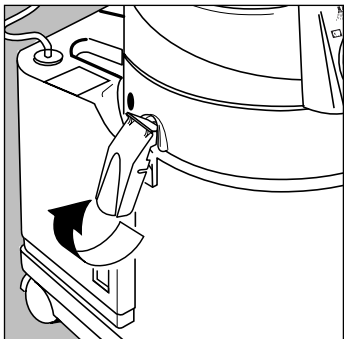

## 2. Preparing for use

Remove the motor unit by releasing the catches.

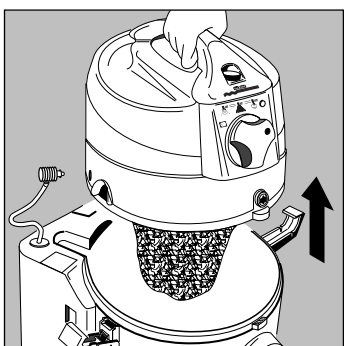

Lift off motor unit by the easy-grip handle. Remove tools out of the tank and fit the tools for the task required onto your cleaner.

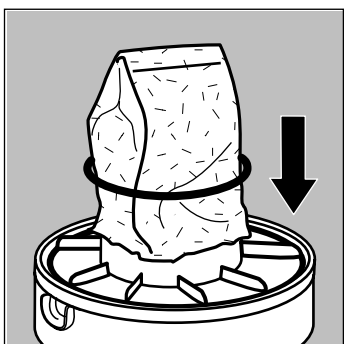

## 3. Dry vacuum

*This appliance is first and foremost a powerful and versatile vacuum cleaner.*

Make sure that the motor-protection paper bag (27) and the cloth filter (28) (where provided), are fitted over the motor housing.

Secure the paper filter with the specila elastic ring (where provided) or an ordinary elastic band.

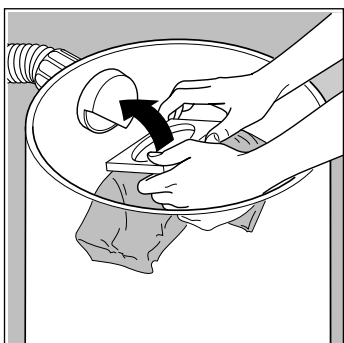

The large dustbag (29) (where provided) must be placed inside the tank by fitting the cardboard collar onto the inlet port.

**CAUTION: Do not pick up liquids when paper or cloth filters are in place.**

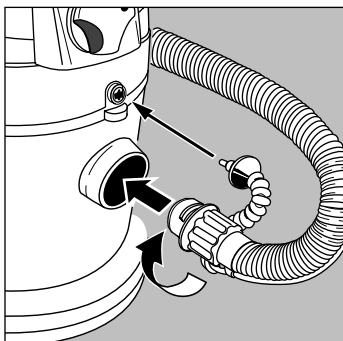

Connect the flexible hose to the inlet port of your cleaner by rotating the hose coupling clockwise until it is securely attached.

Connect the solution dispenser (7) (although not strictly necessary for dry vacuuming) so that it does not get in the way while vacuuming.

Attach one end of the extension tube(s) to the handgrip and the desired tool to the other end.

### 3.1 Dry vacuum accessories

#### Carpet/floor power nozzle (where provided)

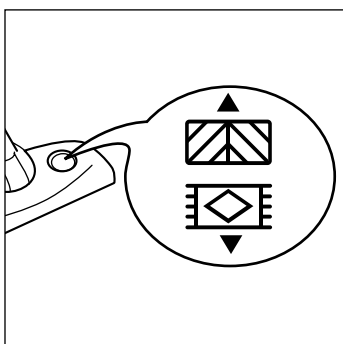

Efficiently removes dust from floors (marble or tiled), rugs or carpets.

When the pedal is pushed towards the "hard floors" symbol (▲), the bristles protrude to clean hard floors more efficiently. This position is recommended for in-depth cleaning of floors and for floors with pronounced joints. When the pedal is pushed towards the "carpets" symbol (◈), the bristles retract and the brush is ready to clean fabric surfaces and delicate floors such as parquet, marble, etc.

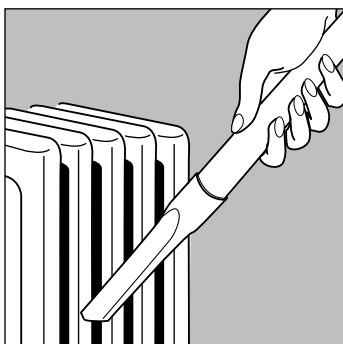

#### Crevice tool (where provided)

You can use this tool to pick up crumbs, dust, and other fine debris. Ideal for cleaning those hard-to-reach places like radiators, car interiors, awkward corners, and all nooks and crannies.

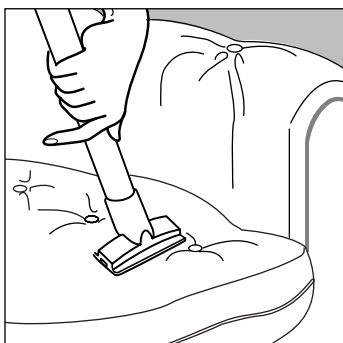

#### Multi-purpose nozzle (where provided)

For cleaning upholstery, sofas, car interiors, drapes, curtains, etc.

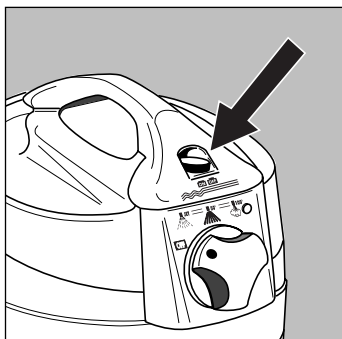

Fit the required tool to the flexible hose, plug in the power cord and switch your cleaner on by depressing the ON/OFF suction button (3) ONLY.

To stop vacuuming, press the same button again.

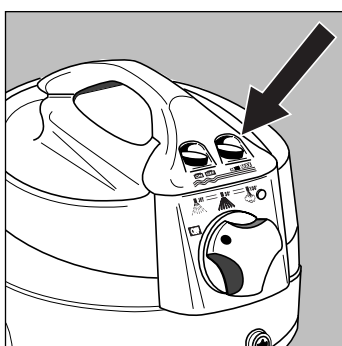

### 3.2 Electronic version

If your cleaner is equipped with electronic suction control to adjust suction power to the type of fabric to be cleaned or the dirt to be removed, set the selector to minimum before switching on the appliance.

**Maximum power:** recommended for heavy dirt (pebbles, soil, etc.) on hard flooring, textile floors and deep-pile carpets, in corners, along edges, etc.

**Medium power:** saves energy and reduces the noise of the appliance. It is more than enough to remove dust from hard flooring and upholstery.

**Minimum power:** indispensable for vacuuming over light, delicate objects such as light fabric coverings to avoid sucking up the fabric and making cleaning difficult.

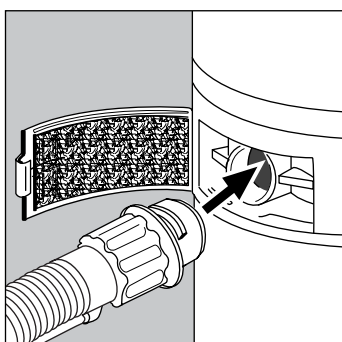

### Blower

With a simple operation, the exhaust port may be used to turn your cleaner into a powerful blower, particularly useful for whisking away leaves and soil from terraces or decks, or cleaning hard-to-reach corners.

To open the exhaust port hatch on the motor unit, simply pull the small protruding lever outward and connect the end of the hose to the exhaust port. Switch on your cleaner by depressing the ON/OFF button (3) ONLY.

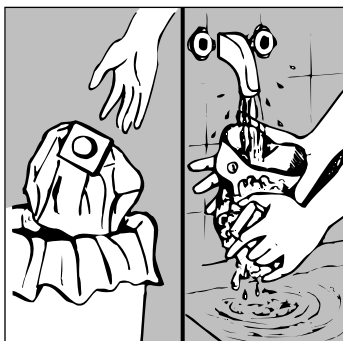

### 3.3 Paper and cloth filter care and maintenance

When using your appliance as a dry vacuum cleaner, replace paper filter (27) (where provided) regularly . Simply wash the cloth filter (25) (where provided) periodically in warm soapy water.

**Always make sure the cloth filter is completely dry before reusing it.**

When vacuuming up particularly fine dust, for example ash, talcum powder, rubble dust, etc., the paper or cloth filter may seem clean, but may actually become clogged, which will result in a lowered performance. In such cases, it is preferable to replace the paper filter and wash the cloth filter.



## 4. Wet Vacuum

*This function will help you to cope with those little emergencies when you have to mop up liquids and spillages from any surface quickly and efficiently, like, for example , unclogging a drain or dealing with minor floods from washing machines, dishwashers, , basement floors, etc.*

*Do not immerse the appliance in liquids, only the nozzle end.*

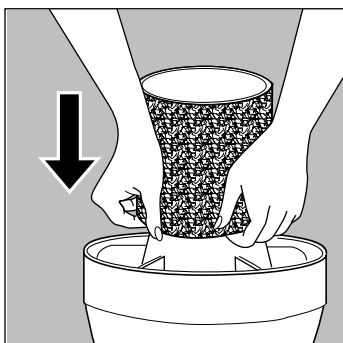

Remove the motor unit by releasing the catches (as described in "Preparing for Use"). Lift off motor unit and fit the polyurethane foam filter for wet pick up (26) over motor housing.

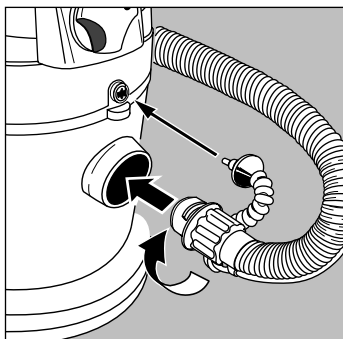

Reattach the motor unit to the tank, connect the flexible hose to the inlet port by rotating the hose coupling clockwise until securely fastened. Connect the solution dispenser (7) to the motor unit by pressing it in deeply .

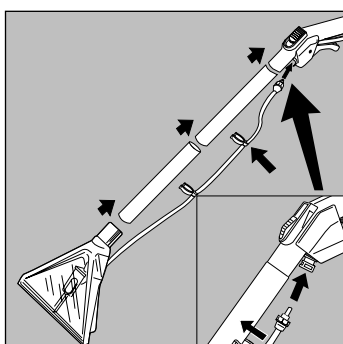

## 4.1 Wet Vacuum tools and accessories

### Large clear plastic nozzle (16)

Useful for picking up liquids from floors, carpets and rugs. Attach to the extension tube and connect the solution dispenser (already connected to the nozzle) to the handgrip. Secure to extension tube by means of its clips .

### Brush attachment for hard floors

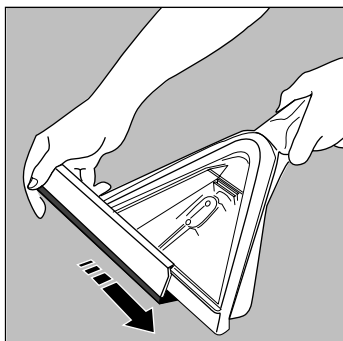

When using the large clear plastic nozzle on hard floors, fit brush attachment (17) by carefully sliding it over the runners on the nozzle to avoid it coming loose during use.

### Crevice tool (25)

Recommended for wet pick-up from hard-to reach places or to unclog drains.

### Small clear plastic nozzle (18)

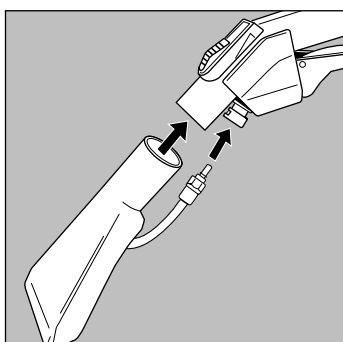

Ideal for spot cleaning or spills on upholstery, sofas, furniture, etc.

Attach nozzle directly to handgrip. Connect solution dispenser to handgrip by pushing it in securely.

Switch on by depressing the ON/OFF suction button only.



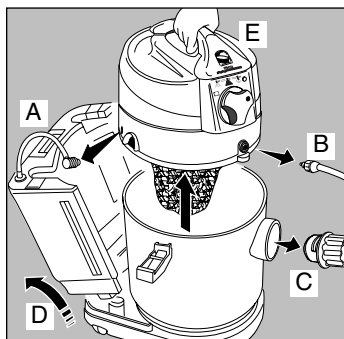

**CAUTION:** When the dirty-water tank is full, a special safety device will shut off suction automatically. At this point switch off the motor, disconnect the machine and empty the dirty-water tank.

## 4.2 Emptying the tank

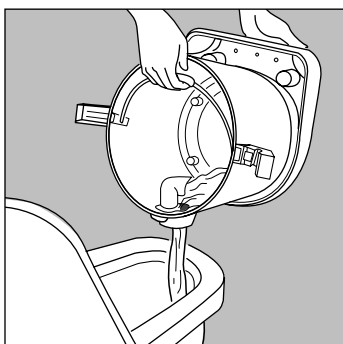

To empty the tank, disconnect in this order: the solution injection system (a), the solution dispenser (b), the suction hose coupling (c), the external removable tank (d), and the motor unit (e).

Empty the dirty-water tank with the help of the inner handle (if fitted).



## IMPORTANT NOTICE

If the textile surface to be cleaned has previously been treated with a shampoo different from the product supplied with this appliance, excessive foam may form inside the dirty water tank. If the foam should begin to overflow, switch off your cleaner and empty the dirty-water tank. Always use the original no-foam shampoo.

## 5. Extraction cleaning

*Extraction cleaning involves spraying a detergent solution (water + shampoo) followed by a vacuuming action, the so-called extraction, to remove the solution and grime and stains along with it, effectively wiping away dirt and deep-cleaning all surfaces.*

**CAUTION:** Make sure that all the fabrics and surfaces to be cleaned are sturdy enough for extraction cleaning and colour-fast. If in doubt, spot-test in an inconspicuous area and wait until completely dry before checking the results. The manufacturer shall not be liable for damage to rugs, carpets, chairs, upholstery, etc., resulting from the use of detergents other than those provided with the appliance (for example, liquid dish detergent, hair shampoo, soaps in general).

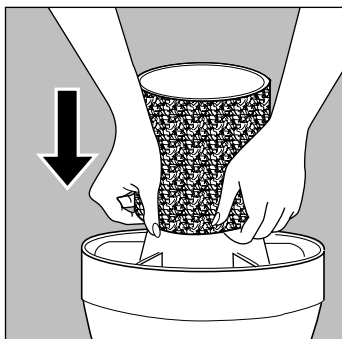

Remove the motor unit by releasing the catches (as described in "Preparing for Use"). Make sure the motor housing is fitted with the polyurethane foam filter for wet vacuum (26) and not with paper filters (27) (29) or cloth filter (28).

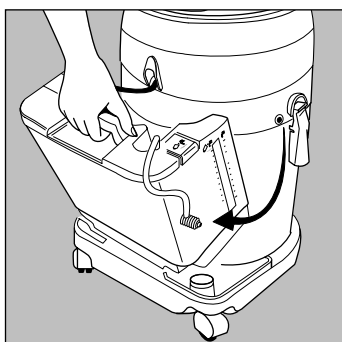

### Filling the removable cleaning solution tank

Disconnect the solution injection system and remove the solution tank lifting it out by its handle.

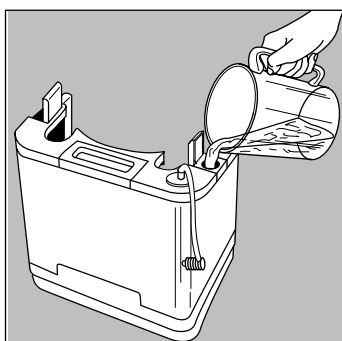

Fill the tank from the port marked with the tap symbol with plain water to the **Max** level for steam cleaning or rinsing operations.

For cold-water cleaning, proceed as follows: fill with water until the right-hand-side water level ball in the water level indicator reaches notch no.9, then add shampoo to fill. The ball should now reach the **MAX** notch.

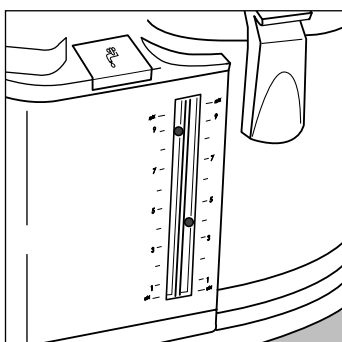

**CAUTION:** The proportions indicated are valid only as long as the original shampoo is used. The manufacturer shall not be liable for damage to fabrics or the machine itself resulting from the use of different detergents. Always follow the instructions and dosage indicated on the bottle and use the correct no-foam detergent.

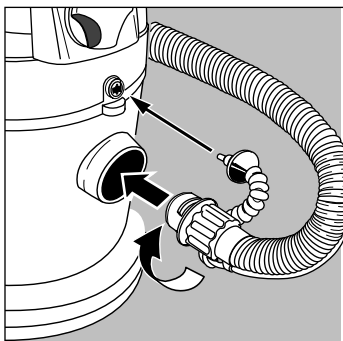

Close the port hatches, reattach the removable tank, and connect the solution injection system (10) by firmly pressing in place.

Reposition the motor unit, connect the flexible hose to the inlet port by rotating the hose coupling clockwise until securely fastened. Connect the solution dispenser (7) to the motor unit by pressing it in deeply .

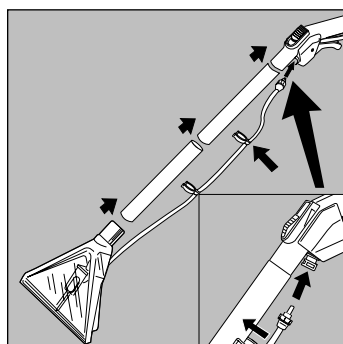

## 5.1 Extraction tools and accessories

### Large triangular clear plastic nozzle (16)

Useful for cleaning floors, carpets and rugs. Attach to extension tubes and connect the solution dispenser to the handgrip by pushing it in and rotating clockwise. When cleaning hard floors, use brush attachment (17) as described in section 4.1.

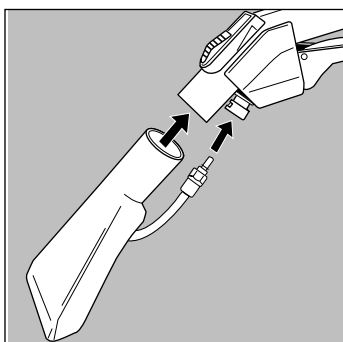

### Small triangular clear plastic nozzle

Ideal for extraction cleaning on upholstery, sofas, vertical fabric coverings, car interiors, etc. Attach nozzle directly to handgrip. Connect solution dispenser to handgrip by pushing it in securely. Once the nozzle is in place, plug your cleaner into mains outlet and adjust the selector to the required type of cleaning.

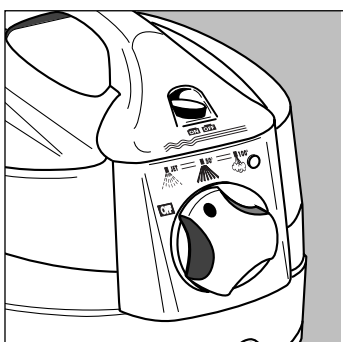

## 5.2 Cold-water cleaning

Cold-water cleaning is particularly recommended for delicate unwaxed hard floors like fired-clay tiles, parquet floors and all textile flooring (rugs, carpeting).

Fit your cleaner with the tool required for the desired type of cleaning. Rotate selector (5) to the **JET** symbol to obtain spray action for the water and shampoo solution.

Proceed with cleaning s described at section 5.6

## 5.3 Hot-water cleaning

*Hot-water cleaning is recommended for heavily soiled unwaxed hard floors like ceramic tiles, linoleum or vinyl floors, and tiles in general.*

*Recommended also for mirrors and windows - use with the window squeegee.*

**CAUTION:** When cleaning window with hot water or steam in cold weather , pre-heat glass panes with a weak jet of hot water or steam and then continue at a higher temperature setting to avoid breakage due to sudden changes in temperature .

Fit the cleaner with the nozzle best suited to the task required. Rotate selector to the **50C** setting. After one minute your cleaner will be ready to deliver a powerful jet of hot water, the most efficient way of dealing with tough dirt.

**USEFUL HINTS:** In case of particularly ground-in dirt, proceed as follows:

- begin by dry-vacuuming in accordance with the instructions contained in the “Dry vacuum” section;
- set up the machine for extraction cleaning and proceed to treat the dirty surface as follows:
  - rotate selector to hot-water position and use the spray trigger on the handgrip to spray cleaning solution on the surface to be treated;
  - wait one or two minutes for pre-treatment to soak in;
  - depress the extractor button and go over the pre-treated area using dry vacuum only (*do not use extractor lever*);
  - rinse carefully following the instructions in the next section.

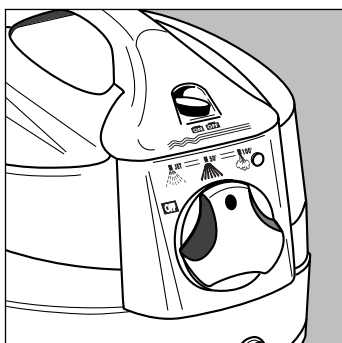

## 5.4 Rinsing operations

After cleaning with the detergent solution, you may wish to proceed with rinsing operations. Rinsing will ensure that all traces of detergent are removed from the treated surface, especially recommended for materials where detergent residues are hard to get to, like , for example , fabric and textiles in general.

For rinsing, use the same tools as for extraction cleaning.

Also the procedure is the same as for extraction cleaning.

## 5.5 Steam cleaning

*Recommended for the maximum hygiene of non-delicate unwaxed hard floors (ceramic tiles, linoleum or vinyl floors, tiles in general) and to clean glass surfaces.*

**N.B.: To avoid wasting energy, keep the steam generator on only during steam cleaning.**

Rotate selector (5) to the position with the **100C** symbol. After about two minutes steam will start to be delivered to the nozzle. Proceed with cleaning following the instructions for extraction cleaning contained in section 5.6.

To shut off steam output, rotate the selector to the OFF position.

**N.B.: The water delivered by the pump action before full steam power reaches the nozzle is perfectly normal and does not indicate any malfunctioning in the machine.**

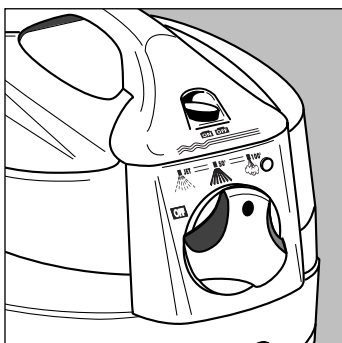

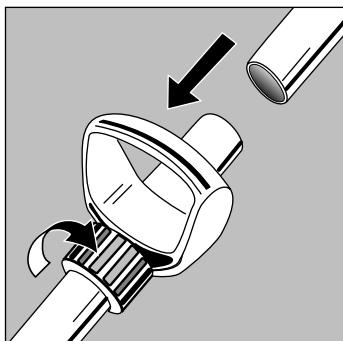

Attach one end of the extension tubes to the handgrip and the tool for the task required to the other end. If provided, the extra handgrip (30) at the tube junction will make cleaning operations easier.

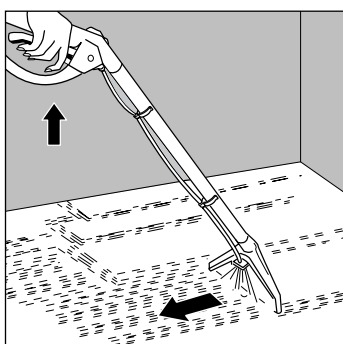

## 5.6 Extraction cleaning technique

Extraction cleaning with cold or hot water, or steam, is performed as follows:

- spray the detergent solution or the steam jet onto the surface to be treated by pressing spray trigger (2) while simultaneously vacuuming from front to back depressing the vacuum button;
- go over the same area several times, vacuuming only, without pressing the spray trigger.

The treated surface will then be free of dirt and almost completely dry.



## 5.7 Cleaning windows

*The window wiper attachment (where provided) is an extremely practical tool for cleaning glass surfaces. If your appliance is not provided with this accessory, you can ask your dealer for one as an optional extra.*

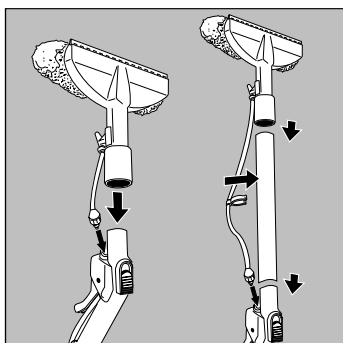

Fit the attachment either directly onto the handgrip or, if it makes work easier, use the rigid extension tubes as well.

In this case, fit the longer solution dispenser to the extension tubes and secure it with the clips.

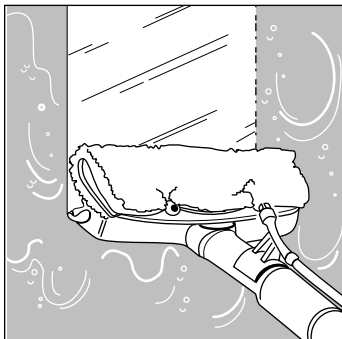

Glass can be cleaned with hot or cold water, or with steam. In all cases use the following method: spray water or steam jet on the surface to be cleaned and go over the area with the sponge side of the tool, then wipe the glass dry by turning the wiper over and using the side with the rubber scraper while vacuuming at the same time.

**Caution:** at low temperatures it is advisable to heat the glass with a weak jet of steam to avoid breakage due to the sudden change in temperature.



## 6. Care and maintenance of the appliance

**Caution:** Always disconnect the appliance from mains outlet before performing any cleaning or maintenance operation.

After the appliance has been used for extraction cleaning or wet vacuuming, the tools and accessories on the machine should be rinsed to ensure maximum hygiene before storing. Clean nozzle, tubes and hose by vacuuming up a few litres of clean water.

Always empty out the dirty-water tank after use (see section 4.2).

After emptying and rinsing the dirty-water tank, remove the wet-vacuum foam filter (26), wash it under running water and let it dry completely before re-positioning. Owing to their particular composition, wet-vacuum foam filters must be kept dry to prolong their life and prevent deterioration.

Periodically replace the exhaust filter inside the hatch on the motor unit.

To open the hatch, simply pull the small protruding lever outwards.

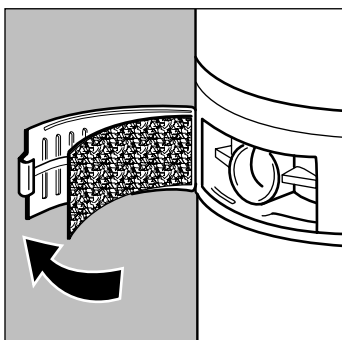

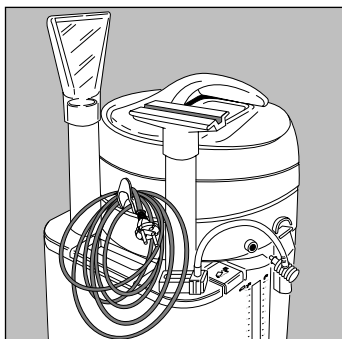

Periodically check that the float inside the motor housing is free to move in its holder.

Before storage, wind the cord and on the hook at the back of the motor unit (checking that it is not damaged or nicked).

### **Cleaning the dispenser nozzle on the clear plastic attachments**

In case the dispenser nozzle on the triangular attachments should become obstructed, remove blockage by pulling out the nozzle with a clockwise motion. Clean nozzle under running water and re-position in its housing.

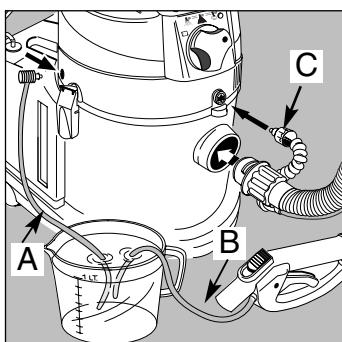
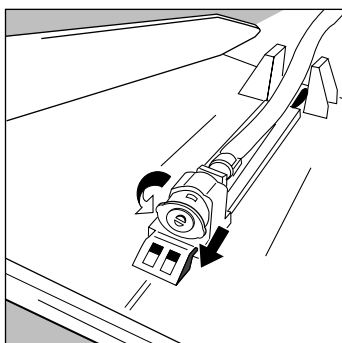

## **6.1 Descaling the steam generator**

The steam generator should be descaled after 8/10 times it has been used for steam cleaning, to prevent scale build-up which may result in a lowered performance.

Fill a vessel with a litre of water and 125ml of descaling solution (citric acid).

Connect solution injection tube (A) to its coupling on the motor unit and injection tube (B) to its coupling on the



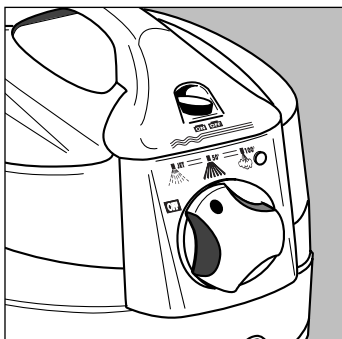

hose handgrip, and solution dispenser (C) to its own housing.

Rotate cleaning selector from OFF to cold-water cleaning and let the machine run for about 30 minutes , keeping the spray trigger depressed by means of the band provided. Follow with rinsing with water only for 10 more minutes.

**N.B.:** perform descaling when the appliance is cold.

## 7. Warranty

In the event your appliance should require servicing ( or for the purchase of accessories like filters, attachments, shampoo, etc.) contact your dealer or an authorized Service Centre..

Use only original spare parts and accessories so as to maintain the appliance in good working order and NOT invalidate the warranty.

The manufacturer reserves the right to change the specifications of the appliance and/or accessories without prior notice.

### ELECTRICAL CONNECTION (UK ONLY)

- A) If your appliance comes fitted with a plug, it will incorporate a 13 Amp fuse. If it does not fit your socket, the plug should be cut off from the mains lead, and an appropriate plug fitted, as below.

**WARNING:** Very carefully dispose of the cut off plug after removing the fuse: do not insert in a 13 Amp socket elsewhere in the house as this could cause a shock hazard.

With alternative plugs not incorporating a fuse, the circuit must be protected by a 15 Amp fuse.

If the plug is a moulded-on type, the fuse cover must be

re-fitted when changing the fuse using a 13 Amp Asta approved fuse to BS 1362. In the event of losing the fuse cover, the plug must NOT be used until a replacement fuse cover can be obtained from your nearest electrical dealer. The colour of the correct replacement fuse cover is that as marked on the base of the plug.

- B) If your appliance is not fitted with a plug, please follow the instructions provided below:

#### **WARNING - THIS APPLIANCE MUST BE EARTHED IMPORTANT**

The wires in the mains lead are coloured in accordance with the following code:

Green and yellow:	Earth
Blue:	Neutral
Brown:	Live



As the colours of the wires in the mains lead may not correspond with the coloured markings identifying the terminals in your plug, proceed as follows:

The green and yellow wire must be connected to the terminal in the plug marked with the letter E or the earth symbol  or coloured green or green and yellow.

The blue wire must be connected to the terminal marked with the letter N or coloured black.

The brown wire must be connected to the terminal marked with the letter L or coloured red.