

ENGLISH

Dear Customer,

Each one of our products is the result of consolidated experience in the design and production of appliances for household cleaning, and has been subject to meticulous technical testing.

We have prepared this manual to help you make the most of your deep-cleaner and to fully appreciate its superb quality.

We therefore recommend that you read it carefully before using the appliance.

We are certain that if you follow our suggestions, this appliance will give you absolute satisfaction and many years of service.

CONTENTS

1. Preparing for use	p. 5
2. Dry vacuuming	p. 5
2.1 Dry vacuuming accessories	p. 6
2.2 Paper filter maintenance	p. 7
3. Wet vacuuming	p. 8
3.1 Wet vacuuming accessories	p. 8
3.2 Emptying the wet/dry tank	p. 9
4. Extraction cleaning	p. 10
4.1 Filling the extraction cleaning tank	p. 11
4.2 Extraction cleaning accessories	p. 11
4.3 Extraction cleaning technique	p. 12
5. Care and maintenance	p. 13
6. Guarantee	p. 14

Components description

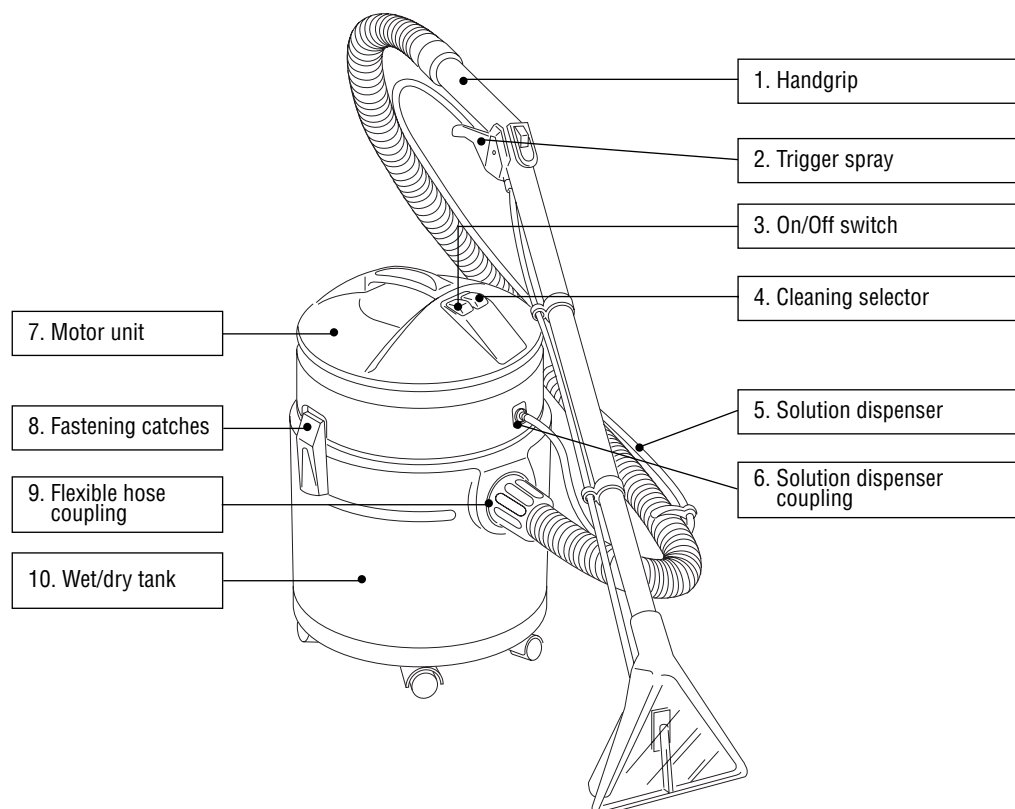

Accessories

- 11. Flexible hose
- 12. Large triangular attachment
- 13. Hard floor brush attachment
- 14. Carpet/floor brush
- 15. Shampoo bottle
- 16. Two extension tubes
- 17. Multi-purpose nozzle
- 18. Crevice tool
- 19. Liquid pick-up filter
- 20. Paper filter
- 21. Dustbag

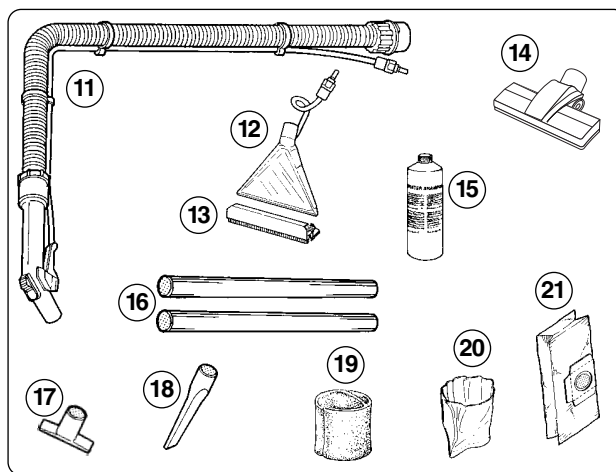

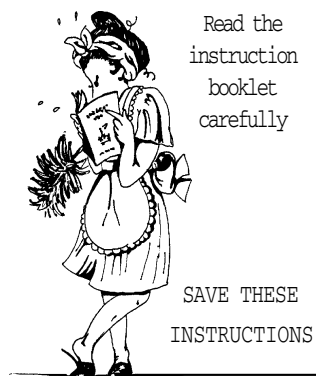

Important safety instructions

- Before using, check that the mains voltage corresponds to the voltage specified on the rating plate.
- The appliance should be plugged into well-earthed sockets rated at 10 amps or more. In the case of appliances with double insulation (see symbol  on specifications label), earthing is not necessary.
- **Always disconnect the appliance from mains when not in use and before carrying out maintenance or cleaning of the appliance itself.**
- Do not clean the appliance with trichloroethylene or other solvents. Use water with ordinary liquid detergents only.
- Do not unplug by pulling on the power cord or the appliance itself.
- Do not leave the appliance unattended while running. Keep it well away from children and persons unfit to use it.
- Do not run the appliance over the electric cord as this may damage the insulation.
- Do not touch the plug with wet hands.
- Do not use the appliance to pick up flammable or corrosive liquids
- Do not use the appliance to pick up matches, hot ash or burning cigarette ends.
- Do not attempt to use the appliance if it appears to be faulty. Do not use with a damaged power cord or plug.
- Do not shut the cord in doors or allow it to rub against sharp corners. Keep away from hot surfaces.
- Do not expose the appliance to rain or moisture. Keep out of direct sunlight.
- Avoid vacuuming up hard or sharp objects that might damage the dustbag and the appliance itself. Do not use the appliance to vacuum up nails, pins, screws or other metal objects.
- Before starting the appliance, make sure that the correct filters are properly positioned.
- This appliance is intended for domestic use only, and must be used in accordance with the operating instructions contained in this booklet and only with the tools and accessories provided.
- The manufacturer shall not be liable for damage resulting from the improper use of the appliance.
- For all repairs, contact an authorised Technical Service Centre only.

The manufacturer reserves the right to change the specifications of the appliance and/or accessories provided prior notice.

The use of original spare parts and accessories is recommended to maintain the appliance in good working order and NOT invalidate the guarantee.

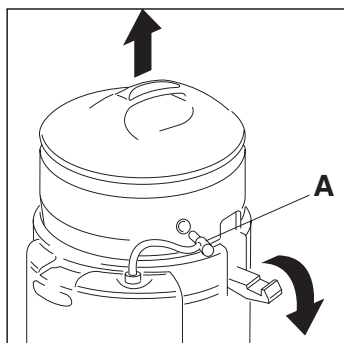

1. Preparing for use

Remove the motor unit by releasing the catches. Your appliance is equipped with an external tank. Remove the solution injection system (A) by pulling it out.

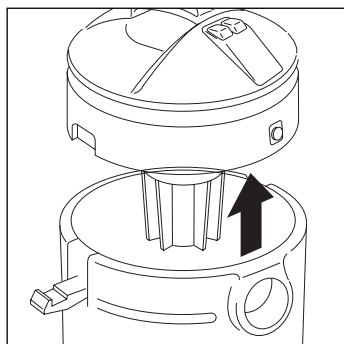

Lift off the motor unit using the handle. Remove tools out of the tank and fit the most appropriate attachment for the work to be done.

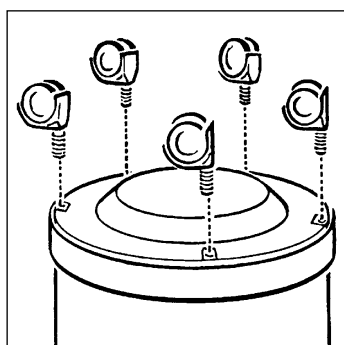

Turn the appliance over and fit the wheels provided, pushing them into the special holes in the base of the tank.

2. Dry vacuuming

This appliance is first and foremost a powerful and versatile vacuum cleaner.

Check that the paper (22) is fitted over the motor-protection housing.

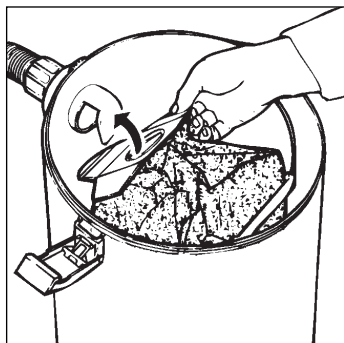

The large dustbag must be positioned inside the tank. Slide the cardboard collar around the suction inlet port.

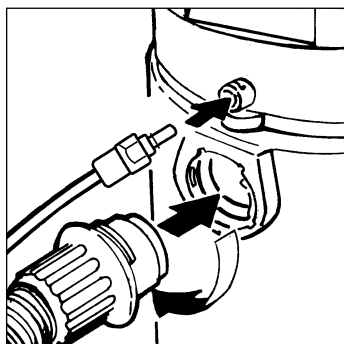

Connect the flexible hose to the suction inlet port, rotating the hose coupling clockwise until securely attached.

Connect the solution dispenser (5) (even though not necessary for dry vacuuming) so that it does not get in the way during vacuuming. Attach one end of the extension tubes (16) to the handgrip and the other to the appropriate accessory.

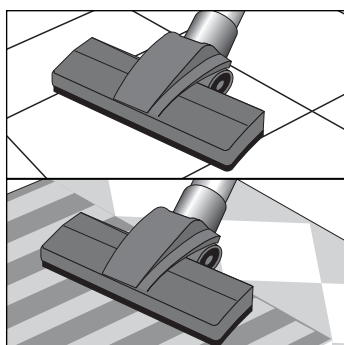

2.1 Dry vacuuming accessories

Carpet/floor brush (14)

Effectively vacuums up dust from both hard floors and carpets or rugs.

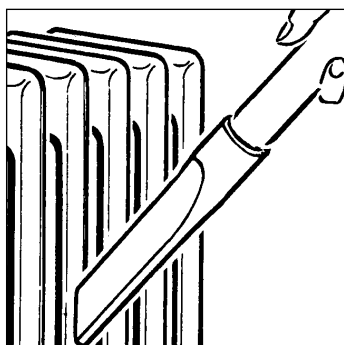

Crevice tool (18)

For picking up crumbs, dust and other fine debris. Ideal for cleaning all those difficult-to-reach places like radiators, car interiors etc.



Multi-purpose nozzle (17)

For cleaning sofas, upholstery, car interiors, drapes, curtains etc.

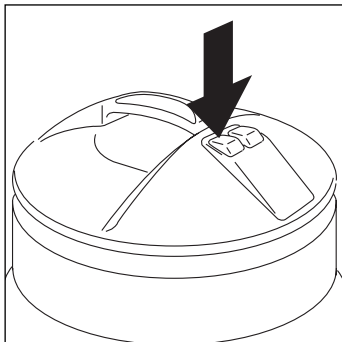

Fit the required accessory to the flexible hose, plug in the power cord and switch the appliance on by pushing the ON/OFF suction switch (3) ONLY.

To stop vacuuming, press the same switch again.

NEVER press the wash switch (4) when using the appliance for dry or wet vacuuming.

2.2 Paper filter maintenance

When using the appliance as a dry vacuum cleaner, replace the motor protection filter (20) regularly.

When vacuuming up particularly fine dust, for example cement, talcum powder, or rubble dust, the paper filter may appear to be clean, while actually clogged, which will result in a lowered performance. In such cases, it is preferable to replace the paper filter.

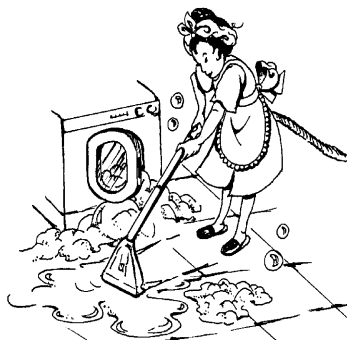

3. Wet vacuuming

This function is useful when coping with those little emergencies when you have to mop up liquids and spills from any surface quickly and efficiently, like, for example, such as unblocking a sink or drain or dealing with minor floods from washing machines, dishwashers, basement floors, etc. Do not immerse the appliance in liquids, only the nozzle end.

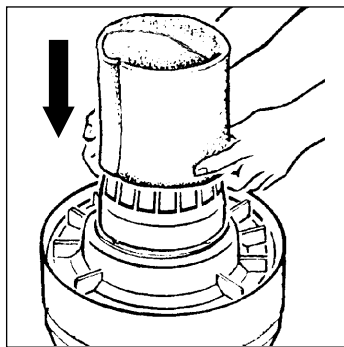

Remove the motor unit by releasing the catches (as described in "Preparing for Use"), lift it up and fit the polyurethane liquid pick-up filter (19) to the motor protection housing.

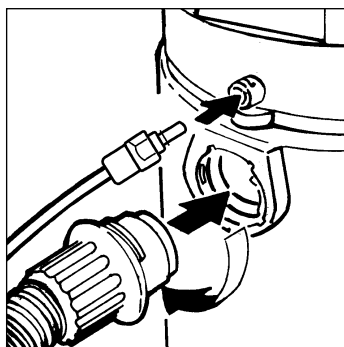

Reattach the motor unit to the tank, connect the flexible hose to the suction inlet port, rotating the hose coupling clockwise until securely fastened.

Connect the solution dispenser (5) to the motor unit by pushing it in and rotating clockwise.

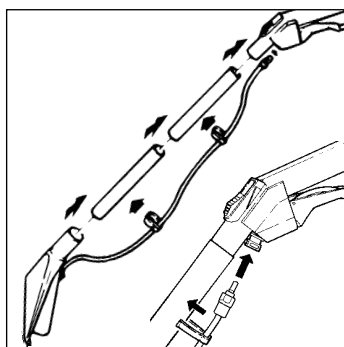

3.1 Wet vacuuming accessories

triangular attachment (12)

Useful for vacuuming up liquids from both hard and carpeted floors. Fit the triangular attachment to the extension tubes and the solution dispenser (already connected to the nozzle) to the hand grip. Secure the solution dispenser to the extension tubes by means of its clips.

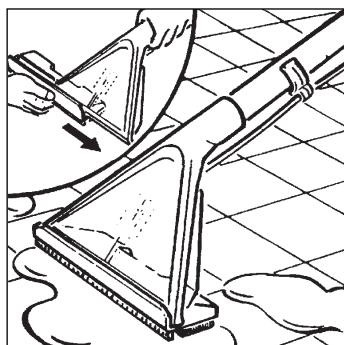

Brush attachment for hard floors

When using the clear plastic accessory on hard floors, fit brush attachment (13) by carefully sliding it over the runners on the accessory to avoid it coming loose during use.

Crevice tool (18)

Recommended for vacuuming liquids from hard-to-reach places or to unclog drains.

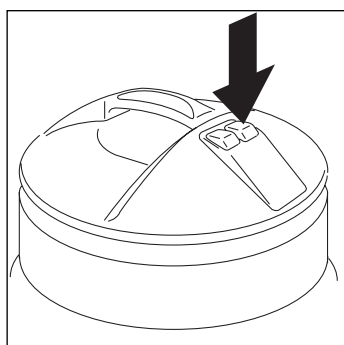

When the appropriate accessories have been fitted to the flexible hose, plug in the appliance and switch on by pressing the ON/OFF switch ONLY. To stop vacuuming, press the same switch again.

NEVER press the wash switch (4) when using the appliance for dry or wet vacuuming.

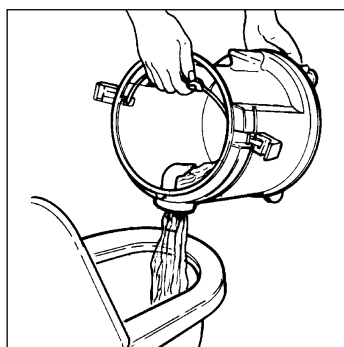

CAUTION: The liquid collection drum can hold approximately 8 litres of water; above this level, a special safety device will shut suction off automatically and the number of motor revolutions will increase. At this point switch off the motor, disconnect the appliance and empty the wet/dry tank.

3.2 Emptying the wet/dry tank

To empty the tank, release catches on the motor unit. Empty it with the help of the internal handle.



IMPORTANT NOTICE

If the fabric surface to be cleaned has previously been treated with a shampoo different from the one provided, an excessive amount of foam may form inside the wet/dry tank. If the foam should begin to overflow, switch off the appliance and empty the tank. Always use the original no-foam shampoo.

4. Extraction cleaning

The extraction cleaning technique involves spraying a detergent solution (water + shampoo) followed by a vacuuming action, the so-called extraction, to remove the solution and grime and stains along with it, effectively wiping away dirt and deep-cleaning all surfaces.

CAUTION: Make sure that all the fabrics and surfaces to be cleaned are sturdy enough for extraction cleaning and colour-fast. If in doubt, spot-test in an inconspicuous area and wait until completely dry before checking the results. The manufacturer disclaims all liability for damage to rugs, carpets, chairs, upholstery, etc., resulting from the use of detergents other than those provided with the appliance.

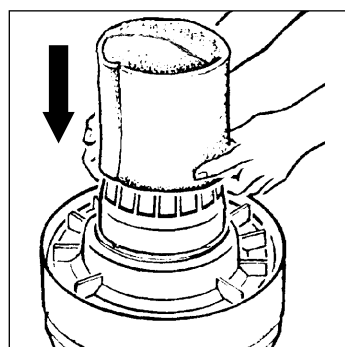

Remove the motor unit by releasing the catches (as described in "Preparing for Use"), and check to make sure the polyurethane liquid pick-up filter (19) is fitted on the motor protection housing and paper (20) (21) filters are NOT in place.

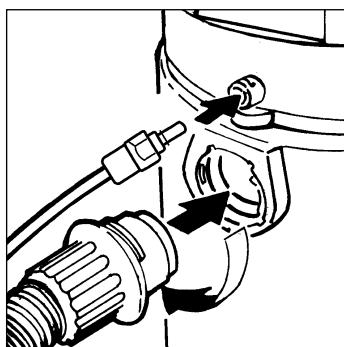

Reattach the motor unit to the tank, connect the flexible hose to the suction inlet port, rotating the hose coupling clockwise until securely fastened.

Connect the solution dispenser (5) to the motor unit by pushing it in firmly until it clicks in place.

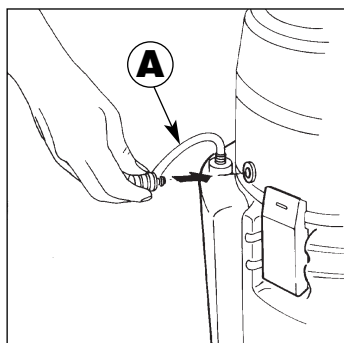

4.1 Filling the tank for extraction cleaning

To disconnect the solution injection system (A) from the motor unit, just pull it out.

Release catch, remove the solution tank and fill it with a solution of shampoo and water according to the proportions shown on the shampoo bottle.

The tank holds approximately 3 litres.

Reposition the cleaning solution tank and reconnect the solution injection system (A) to the motor unit.

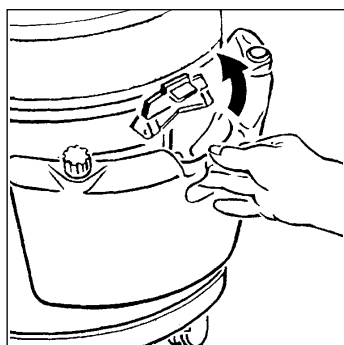

4.2 Extraction cleaning tools and accessories

Triangular attachment (12)

Recommended for vacuuming liquids from both hard and carpeted floors.

When the required accessories have been fitted to the machine, plug in the appliance and switch on by pressing both switches: the wash switch (4) and the suction switch (3).

NOTICE: noise level. After setting up your machine, you may notice an increase of the noise level for a few seconds. This is not due to a defect in the machine but to the water starting to circulate for the first time. Should the noise continue for more than 15 seconds, check that the suction inlet tube is correctly connected to the motor unit. When the water in the tank runs out, the noise level will increase once again. At this point, switch off the machine and proceed to refill the tank as described in the instruction booklet.

Advice for using appliances with separate switches

With separate switches it is possible to depress the wash switch (4) only and use the spray trigger to spray the cleaning solution onto the surface to be treated.

Wait one or two minutes to allow the solution to soak in.

Press the ON/OFF switch (3) and go over the treated surface again using the suction function only without using the spray trigger (2).

CAUTION: never press the wash switch (4) when there is no cleaning solution in the tank. If used incorrectly, a safety device will automatically shut off the pump to protect it from damage. In this case, wait about 30 minutes before using the appliance again.

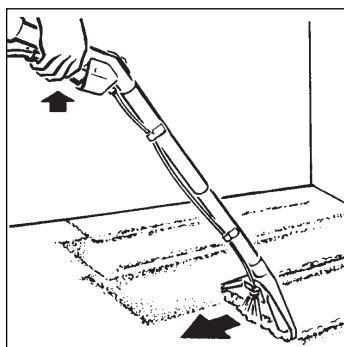

4.3 Extraction cleaning technique

Extraction cleaning is performed as follows:

- spray the cleaning solution onto the surface to be treated by pressing the spray trigger(2) while simultaneously vacuuming from front to back.
- go over the same area several times, vacuuming only, without pressing the spray trigger (2).

The treated surface will then be free of dirt and almost completely dry.



5. Cleaning and maintenance of the appliance

CAUTION: Before carrying out any cleaning or maintenance operation, make sure the appliance is unplugged from the mains.

After the appliance has been used for extraction cleaning or wet vacuuming, the tools and accessories should be rinsed to ensure maximum hygiene before storing the machine. Clean nozzle, tubes, hose, and attachments by vacuuming up a few litres of clean water.

Always empty out the dirty-water tank after use (see section 3.2, p. 9).

After emptying and rinsing the wet/dry tank, remove the liquid pick-up filter (19). Wash it under running water and let it dry before repositioning. Owing to their particular composition, liquid pick-up filters must be kept dry to prevent them from deteriorating.

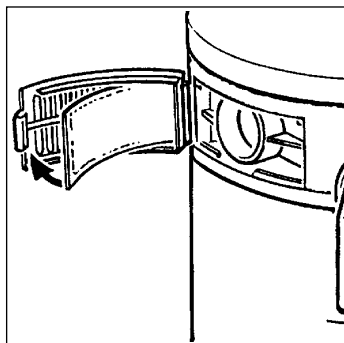

Periodically replace the filter inside the exhaust port hatch on the motor unit.

To open the hatch, pull the small protruding lever outwards.

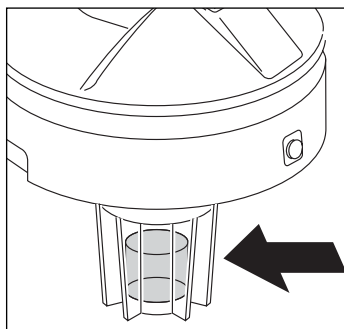

Periodically check that the float inside the motor protection housing is free to move in its holder.

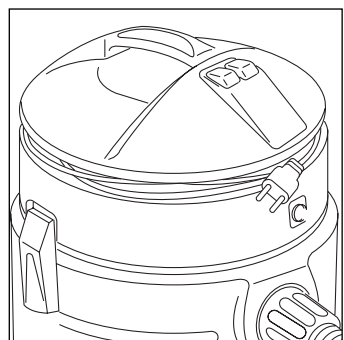

Before storing, place the accessories in the tank, and wind the cord (checking that it is not damaged or worn) around its slot at the top of the appliance.

Useful tip: If the appliance is not going to be used for some time, rinse the system using water only (with no cleaning solution) to prevent the pump from becoming blocked by accumulated detergent. Fill the tank with water only, operate the pump and hold down the spray trigger for a few minutes.

6. Guarantee

In the event the appliance should require technical servicing (or for the purchase of accessories: filters, attachments etc.) contact your dealer or an authorised Service Centre only.

Use original spare parts and accessories only so as to maintain the appliance in good working order and NOT invalidate the guarantee.