

Warnings

- This appliance is designed for home air conditioning and must not be used for other purposes.
- It is dangerous to modify or alter the characteristics of the appliance in any way.
- The appliance must be installed in conformity with legislation in force in the country concerned.
- If the appliance requires repair, contact a Service Centre authorised by the manufacturer only.
- Repairs carried out by unauthorised personnel may be dangerous.
- If the power cable is damaged, it must be replaced by a qualified professional authorised by the manufacturer only.
- This air conditioning unit must be used by adults only. Never allow children to play with the appliance.
- This appliance is designed for home air conditioning and must not be used for other purposes.
- Do not allow children to play with the appliance.
- The appliance must be connected to an efficient earth system.
- Have your electrical circuit checked by a qualified electrician.
- Do not use extension cables.
- Before cleaning or maintenance operations, always unplug the appliance from the mains socket.
- Do not move the appliance by pulling the power cable.
- Do not install the appliance in rooms containing gas, oil or sulphur. Do not install near sources of heat. .
- Do not rest heavy or hot objects on top of the appliance.
- Clean the anti-microbial filters at least once a week.
- Avoid using heating appliances near the air conditioning unit.
- Always transport the appliance upright or resting on one side.
- Use the appliance as described in this instruction manual only.
- As with any electrical appliance, while the instructions aim to cover as many eventualities as possible, caution and common sense should be used when operating and installing this air conditioning unit.
- At the end of its working life, take the appliance to a special collection centre.
- The materials used for packaging can be recycled.
- You are therefore recommended to dispose of them in special differentiated waste collection containers.
- When putting the appliance away, do not cover with plastic bags.
- The refrigerant gas R410a conforms to EC regulations on the environment.
- Avoid perforating the refrigerant circuit of the appliance.
- Keep the appliance at least 50 cm away from flammable substances (alcohol etc) or pressurised containers (e.g. aerosol cans).

DESCRIPTION

- | | |
|---------------------------------------|---|
| 1 air outlet grille | 11 air exhaust hose |
| 2 control panel | 12 window outlet |
| 3 castors | 13 suckers |
| 4 handles | 14 castor locks |
| 5 evaporator air intake grille | 15 remote control unit (certain models only) |
| 6 air exhaust hose housing | 16 adjustable window bar (certain models only) |
| 7 condenser air intake grille | |
| 8 drain hose cover | |
| 9 power cable | |
| 10 flange cap | |

What is the Pinguino

During the summer, you feel comfortable at a temperature of between 24 and 27° C with a relative humidity of about 50%.

During the summer, you feel comfortable at a temperature of between 24 and 27° C with a relative humidity of about 50%.

Compared with installed models, portable air conditioning units have the advantage that they can be moved from one room to another in the home or be transported from one building to another.

Hot air from the room is passed through a coil cooled by refrigerant gas. Excess heat and moisture are removed before the air is re-emitted into the room.

In single unit models (Pinguino), a small part of this air is used to cool the refrigerant gas and then, when hot and damp, is discharged outside.

In models with case, the circuit is cooled using air from outside.

All Pinguino models can also be used in fan-only mode.

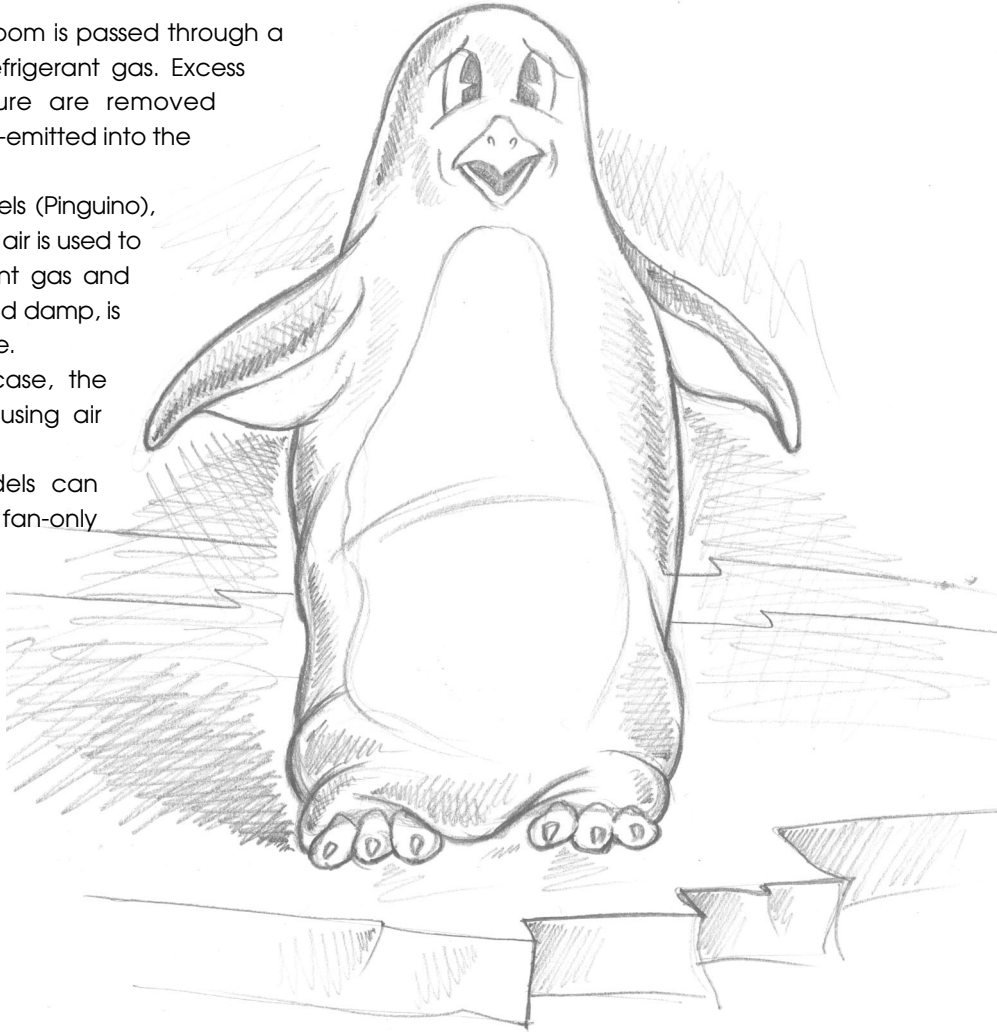

Preparing for use

ELECTRICAL CONNECTIONS

Before plugging the appliance into the mains socket, check that:

- the mains power supply corresponds to the value indicated on the rating plate on the back of the appliance;
- the mains socket and electrical circuit are adequate for the appliance;
- the mains socket matches the plug. If this is not the case, have the plug replaced;
- the mains socket is adequately earthed.

Failure to follow these important safety instructions absolves the manufacturer of all liability.

The power cable must be replaced by a qualified professional only.

The instructions below will enable you to prepare your air conditioning unit for operation as efficiently as possible.

The instructions below will enable you to prepare your air conditioning unit for operation as efficiently as possible.

AIR-CONDITIONING WITHOUT INSTALLATION

Just a few simple steps and your comfort is ensured with Pinguino:

- Fit the air exhaust hose [11] in the housing [6] at the back of the appliance. Insert it as shown in figure A.

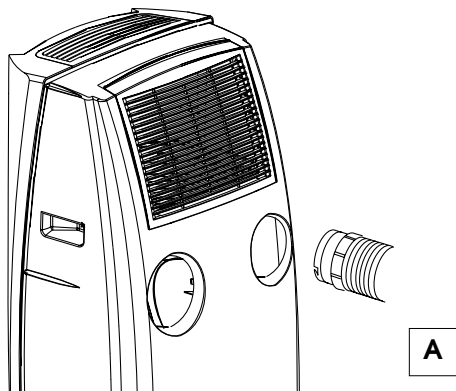

- Fit the window outlet [12] Fit the window outlet [11].
- Place the air conditioning unit near a window or French window.
- Make sure the air exhaust hose is unobstructed.
- Open the window or French window slightly and position the outlet [12] as shown in figure B.

Keep air hoses as short and free of curves as possible to avoid constrictions.

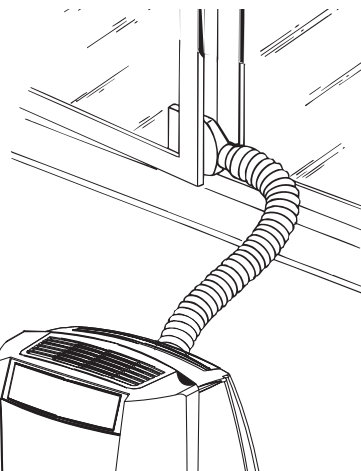

- If you have a double window, use the suckers [13] provided to hold the two parts of the window together (fig. C).

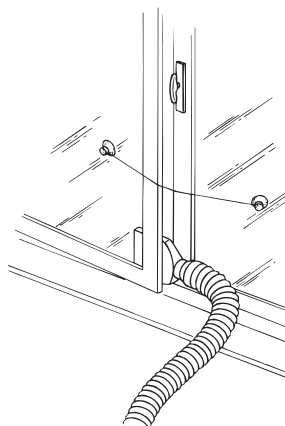

Preparing for use

Using the adjustable bar (certain models only)

- Some models are provided with an adjustable bar which can be useful if your home is fitted with roller blinds.

To fit the bar, proceed as follows:

- fit the window outlet **12** in the housing in the bar (fig. D).

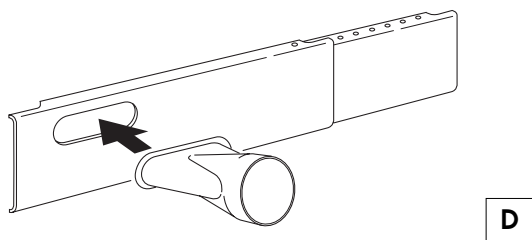

- position the bar on the window sill
- extend the bar for the full length of the window and fit it into the roller blind guides.

If you wish, you can block the bar in place using the pin supplied (fig. E), then lower the blind onto the bar.

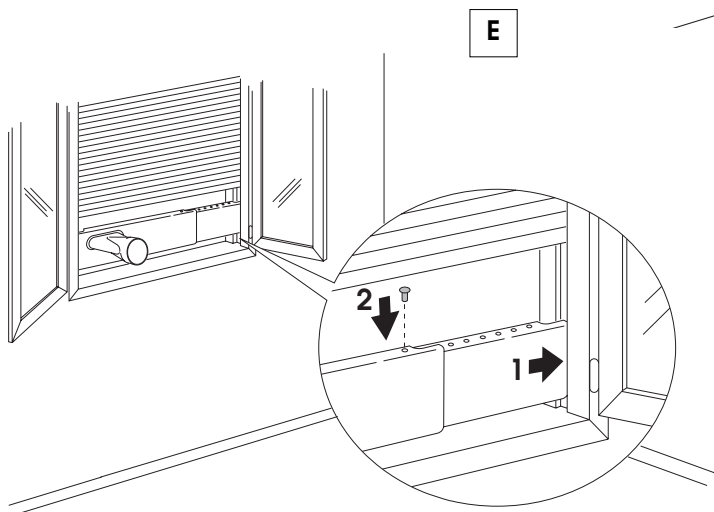

- fit the air exhaust hose **11** to the window outlet **12** and insert the other end of the hose into the back of the air conditioner (figure F).

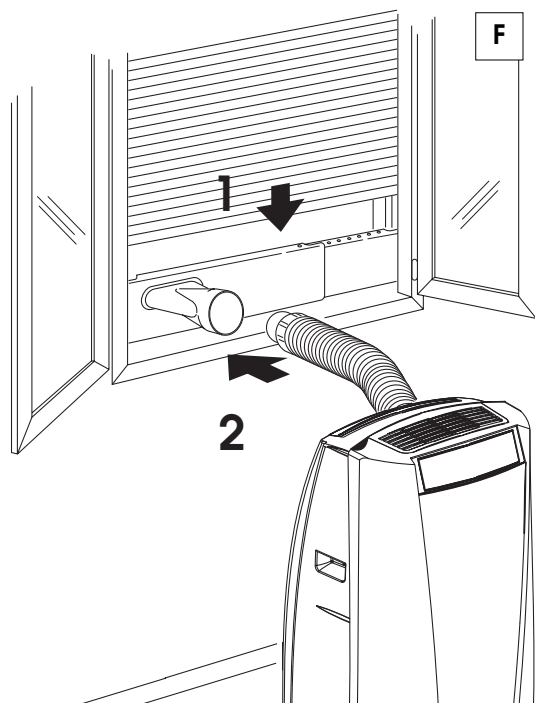

Preparing for use

AIR-CONDITIONING WITH INSTALLATION

If required, the Pinguino can also be installed semi-permanently (Fig. G).

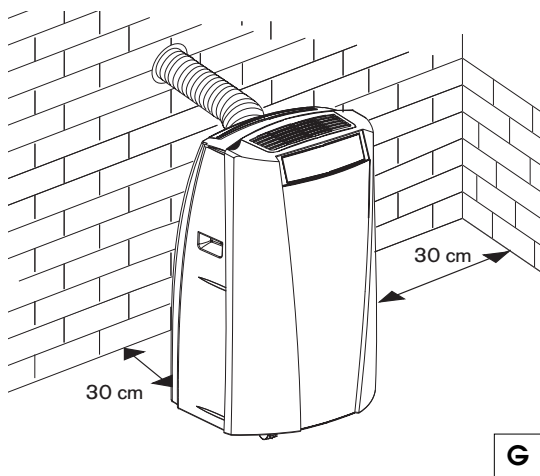

Proceed as follows:

- Drill a hole in an outside wall or through a window pane. Respect the dimensions of the hole and heights shown in figures H and I.

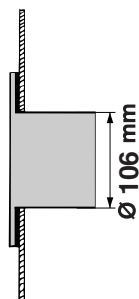

in the window pane



in the wooden kick-board of a French window

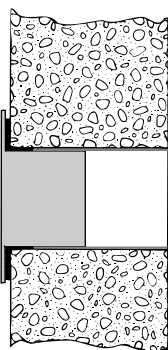

in the wall: you are recommended to insulate the section of wall using suitable insulation.

- Fit the flange accessory [10] provided in the hole.
- Fit the hose [11] in the housing at the back of the appliance (fig. A page 22).
- Fit the end of the hose [11] to the flange [10] as shown in fig. I.

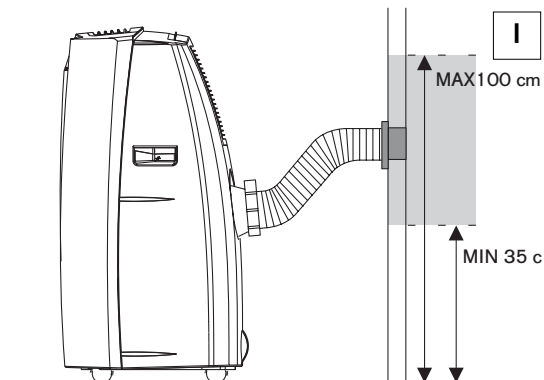

When the hose [11] is not fitted, the hole can be closed with the flange cap [10].

NOTE:

When installing the air conditioning unit semi-permanently, you should leave a door slightly open (as little as 1 cm) to guarantee correct ventilation.

Keep the air hoses as short and free of curves as possible to avoid constrictions.

Control panel

Control panel

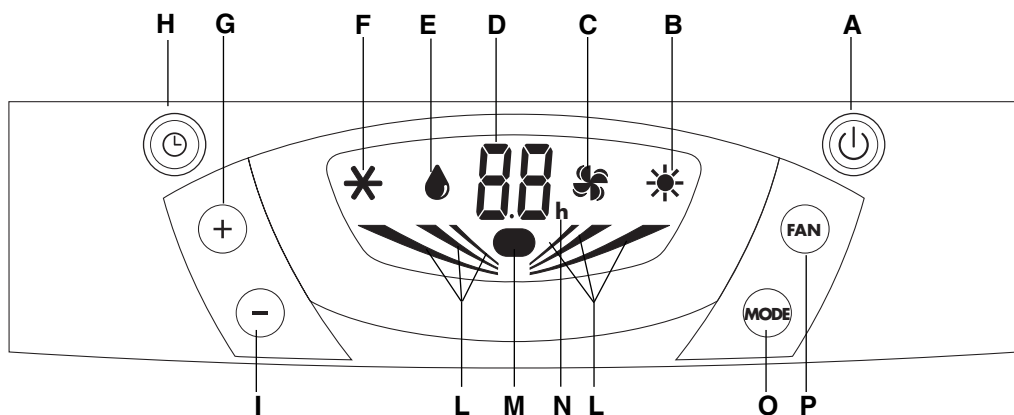

DESCRIPTION OF THE CONTROL PANEL

- A** ON/STAND-BY button
- B** Heating mode light (certain models only)
- C** Fan mode light
- D** **Display** Displays the temperature values set and the programmed operating time
- E** Dehumidifying mode light
- F** Air conditioning light
- G** Increase temperature/programmed operating time button
- H** Timer button
- I** Reduce temperature/programmed operating time button
- L** Fan speed lights
- M** Remote control receiver
- N** Time indicator
- O** **MODE** selection button
Air conditioning, dehumidifying, fan, heating (certain models only)
- P** Fan speed selection button

Operation

TURNING THE APPLIANCE ON

Plug the appliance into the mains.

Two lines appear on the display indicating that the appliance is in stand-by.

Press the **ON/STAND-BY** button (**A**) (when turned on, the air conditioner starts operating in the same mode as when it was turned off). Press the **MODE** button (**O**) until the indicator light corresponding to the required mode lights up:

Light (**F**) : air-conditioning mode

Light (**E**) : dehumidifying mode

Light (**C**) : fan mode

Light (**B**) : heating mode (certain models only)



AIR-CONDITIONING MODE “”

Ideal for hot muggy weather when you need to cool and dehumidify the room.

To set this function correctly, press the **"MODE"** button until the “” light comes on, then press the + (**G**) or - (**I**) buttons until the required temperature is displayed.



Then select the fan speed by pressing the **FAN** button (**P**) until the indicator light corresponding to the required fan speed lights up:



(**HIGH**) the air conditioner operates at maximum to reach the required temperature as rapidly as possible.



(**MED**) reduces noise levels but still maintains a good level of comfort.



(**LOW**) for silent operation

AUTO: the appliance automatically selects the most suitable fan speed in relation to the temperature set on the digital display (the graphics on the display move).

The most suitable temperature for the room during the summer varies from 24 to 27°C. You are recommended, however, not to set a temperature much below the outdoor temperature.

DEHUMIDIFYING MODE

Ideal for reducing the humidity in a room without lowering or raising the temperature (spring or autumn, damp rooms, rainy spells, etc).

In dehumidifying mode, the appliance selects fan speed automatically.



Fan mode

FUNZIONE VENTILAZIONE

Adjust fan speed by pressing the **FAN** button (**P**).
The fan speed selected will be displayed (HIGH, MED, LOW).
In this mode, **AUTO** cannot be selected.



HEATING MODE (CERTAIN MODELS ONLY)

To set operation of the appliance correctly, press the "+" (**G**) or "-" (**I**) buttons until the desired temperature is displayed.
In heating mode, the fan speed is selected automatically by the appliance.



SETTING THE TIMER

The timer can be used to delay appliance start up or shut down.
This avoids wasting electricity by optimising operating periods

How to programme delayed start up

- Plug the appliance into a mains socket and press the **ON/STAND-BY** button (**A**), then select the required operating mode and other settings (temperature, fan speed, etc).
- Press the **ON/STAND-BY** button (**A**) again. The appliance switches to stand-by mode.
- Press the **TIMER** button (**H**): the last timer setting or the preset value 6.0 h flashes on the display.
6.0 h.
- Use the + (**G**) or - (**I**) buttons to set the number of hours delay before the appliance comes on. During the first ten hours, you can select half hour intervals.
For times greater than ten hours, one hour intervals can be selected.
If the "+" (**G**) or "-" (**I**) buttons are pressed for more than 2 seconds, the time runs rapidly up to a maximum of 24 hours.
Press the timer button again within a few seconds to confirm the setting.
If the setting is not confirmed within a few seconds, the display resets to stand-by.
With the timer activated, the countdown before the programmed start up time is displayed.
To cancel the timer programme, press the timer button (**H**).

How to programme delayed shutdown

- Delayed shutdown can be set with the appliance in any operating mode - air conditioning/dehumidifying/fan/heating (certain models only).
- Press the **Timer** button (**H**) the last timer setting or the preset value **6.0 h** flashes on the display.
- Use the + (**G**) or - (**I**) button to set the number of hours delay before the appliance goes off. During the first ten hours, you can select half hour intervals.
For times greater than ten hours, one hour intervals can be selected.
If the "+" (**G**) or "-" (**I**) buttons are pressed for more than 2 seconds, the time runs rapidly up to a maximum of 24 hours.
Press the timer button again within a few seconds to confirm the setting.
At the set time, the air conditioner shuts down and remains in stand-by.
To cancel the timer programme, press the timer button (**H**).

Self-diagnosis

SELF-DIAGNOSIS

The appliance has a self diagnosis system to identify a number of malfunctions.

IF ... IS DISPLAYED	...WHAT SHOULD YOU DO?
<i>Lt</i> LOW TEMPERATURE (FROST PREVENTION)	When the appliance is operating in air conditioning or dehumidifying mode, this device prevents the formation of ice. The appliance starts up again automatically when the defrosting process is completed.
<i>PF</i> PROBE FAILURE (SENSOR DAMAGED)	If this is displayed, contact your service centre.
<i>Ft</i> FULL TANK	Empty the internal safety tank, through the drain hoses. see page 33 "end of season operations"

Using the remote control unit

USING THE REMOTE CONTROL (certain models only)

CORRECT USE OF THE REMOTE CONTROL

- Point the remote control at the receiver (**M**) on the air-conditioner.
- Maximum distance: around 7 metres (without any obstacles between the remote control and the receiver).
- The remote control should be handled with **extreme care**. Do not drop it, expose it to direct sunlight, or leave it near sources of heat.

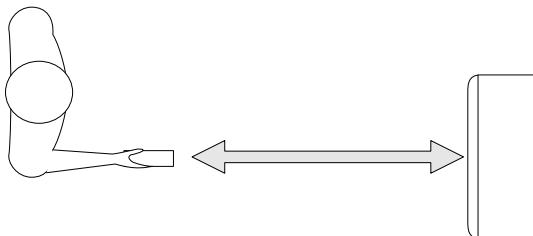

DESCRIPTION OF THE REMOTE CONTROL

- 17) "FAN" button
- 18) "ON/OFF" button
- 19) "MODE" button
- 20) "TIMER" button
- 21) Display

Inserting or replacing the batteries

- Remove the cover on the rear of the remote control;
- Remove the flat batteries if present.
- Insert two new R03 "AAA" 1.5V batteries, inserting them correctly (see the instructions inside the battery compartment);
- Replace the cover.

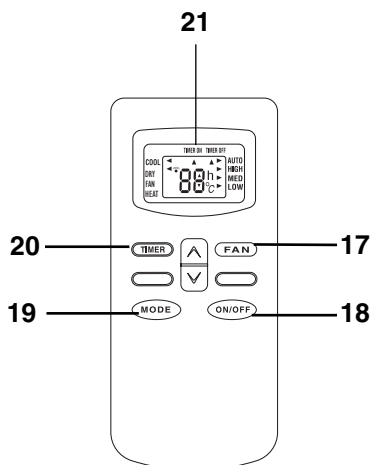

If the remote control unit is replaced or discarded, the batteries must be removed and disposed of in accordance with current legislation as they are harmful to the environment.

(Do not use a combination of rechargeable and disposable batteries)

TURNING THE APPLIANCE ON

Plug the appliance into the mains.

Press the **ON/OFF** button (**18**) (when turned on, the air conditioner starts operating in the same mode as when it was turned off).

Press the **MODE** (**19**) button to select the required mode

AIR-CONDITIONING (COOL)

DEHUMIDIFYING (DRY)

FAN ONLY (FAN)

HEATING (HEAT) (certain models only)

An arrow on the display indicates the selected mode.

Using the remote control unit

AIR-CONDITIONING MODE (COOL)

Ideal for hot humid weather when you need to cool and dehumidify the room.

In air-conditioning mode, use the buttons to select the desired temperature  .

The display shows the set temperature.

To change the fan speed, use the **FAN** button (17) on the remote control, choosing from the available speeds:

AUTO: the appliance automatically selects the most suitable fan speed in relation to the temperature set on the digital display.

HIGH: the air conditioning unit operates at maximum to reach the required temperature as rapidly as possible

MED: reduces noise levels but still maintains a good level of comfort

LOW: for silent operation

Two arrows on the display indicate respectively "COOL" and the fan speed.

The most suitable temperature for the room during the summer varies from 24 to 27°C. You are recommended, however, not to set a temperature much below the outdoor temperature.

DEHUMIDIFYING MODE

Ideal to reduce room humidity while avoiding temperature variations (spring and autumn, damp rooms, rainy periods, etc).

In dehumidifying mode, the appliance selects fan speed automatically.

Two arrows on the remote control display indicate "**DRY**" and "**AUTO**" respectively.

FAN MODE ONLY (FAN)

In fan mode, fan speed can be set by pressing the **FAN** button (17).

La velocità di ventilazione cambia a rotazione fra quelle disponibili (LOW/MED/HIGH).

Due frecce nel display indicano la funzione "**FAN**" e la velocità impostata.

In questa modalità non è possibile selezionare la velocità **AUTO**.

HEATING MODE (CERTAIN MODELS ONLY)

To set operation of the appliance correctly, press the  buttons until the desired temperature is displayed. In heating mode, the fan speed is selected automatically by the appliance.

SETTING THE TIMER



The timer can be used to delay appliance start up or shutdown. This avoids wasting electricity by optimising operating periods.

How to programme delayed shutdown

- With the air-conditioning unit on, press the **TIMER** button (20). The time is displayed and the "h" symbol flashes, with a flashing arrow indicating "**TIMER OFF**".
- Set the time when you want the appliance to go off using the  buttons (from 30 minutes to 24 hours). During the first ten hours, you can select half hour intervals. For times greater than ten hours, one hour intervals can be selected.
- Press the **TIMER** button again to confirm the selection. A beep sounds and the time set is also displayed on the control panel, confirming setting of the timer. A countdown of the time left is displayed on both the air conditioner and remote control displays. At the end of the set time the appliance switches off automatically.
- To cancel the timer programme, press the **TIMER** button again. The appliance emits a beep and both displays reset to display the settings prior to activation of the timer.

Using the remote control unit

Programming delayed start-up

- With the air-conditioning unit stand-by, press the TIMER button. The display shows a flashing arrow indicating "TIMER ON". Now make all the desired settings for when the appliance will switch on (operating mode, fan speed and temperature).
Confirm the settings by pressing the TIMER button. The time is displayed and the "h" symbol flashes. Set the time when you want the appliance to switch off using the   buttons (from 30 minutes to 24 hours).
During the first ten hours, you can select half hour intervals.
For times greater than ten hours, one hour intervals can be selected.
- Press the TIMER button again to confirm the start-up time.
A beep sounds and the time set is also displayed on the control panel, confirming setting of the timer.
A countdown of the time left is displayed on both displays.
- At the end of the set time the appliance switches on automatically, with the settings made previously.
- To cancel the timer programme, press the TIMER button again.
The appliance emits a beep and both displays reset to stand-by.

Tips

To get the best from your air conditioning unit, follow these recommendations:

- close the windows and doors in the room to be air conditioned.

The only exception is when the appliance is installed through a hole in the wall.

In this case, you are recommended to leave a slight draught through a door or window to guarantee correct ventilation.

- Never use the appliance in very damp rooms (laundries for example).
- Never use the appliance outdoors.

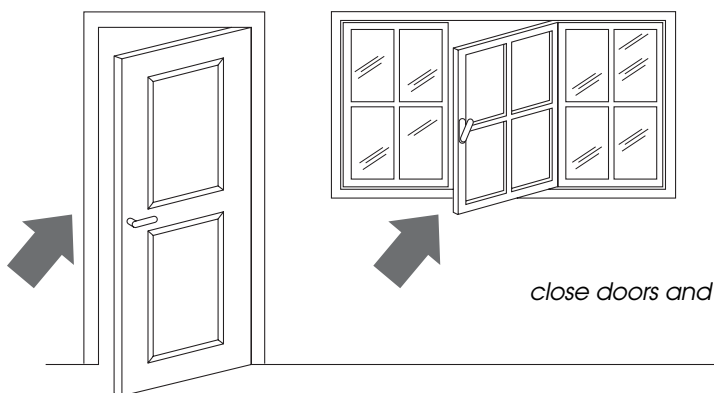

close doors and windows

- Protect the room from direct exposure to the sun by partially closing curtains and/or blinds to make the appliance much more economical to run;
- Never rest objects of any kind on the air conditioning unit;
- Never obstruct the air intake **5** or outlet **1** grilles;
- Make sure there are no heat sources in the room.

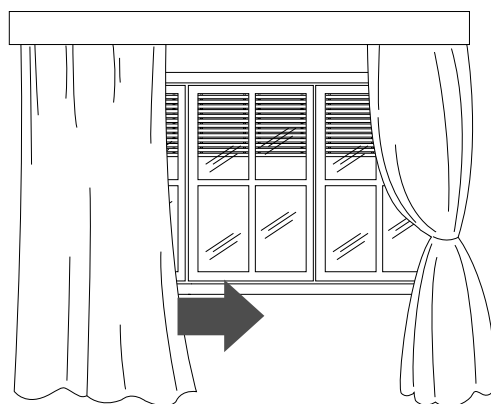

close blinds or curtains

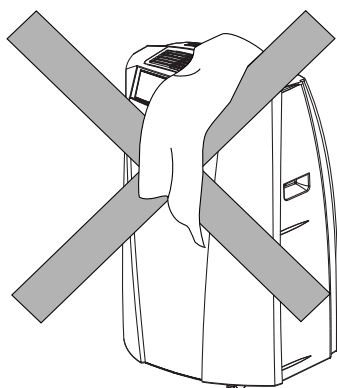

do not cover the appliance

- Make sure the air conditioning unit is on a level floor. If necessary, place the two castor locks **14** under the front wheels **3**.

Cleaning

Before cleaning or maintenance, turn the appliance off by pressing the ON/STAND-BY button (A) or button (18) on the remote control (certain models only). Always unplug the appliance from the mains socket.

CLEANING THE CABINET

You should clean the appliance with a slightly damp cloth then dry with a dry cloth. For safety reasons, never wash the air conditioning unit with water.

Precautions

Never use petrol, alcohol or solvents to clean the appliance. Never spray insecticide liquids or similar.

CLEANING THE AIR FILTERS

To keep your air conditioner working efficiently, you should clean the dust filter every week of operation. The filter is housed in the intake grille. To clean the filters, proceed as follows:

1. Remove the intake grille by rotating outwards (Fig. L).

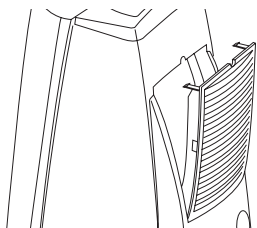

L

2. Remove the dust filter by detaching it from the grille (Fig. M).

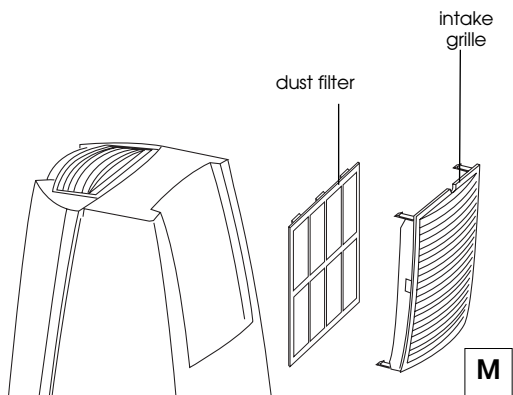

Use a vacuum cleaner to remove the dust collected on the filter.

If it is very dirty, immerse in warm water and rinse a number of times.

The water should never be hotter than 40°C. After washing, leave the filter to dry.

To replace, put the filters back in the intake grille then attach the intake grille to the appliance.

START OF SEASON CHECKS

Make sure the power cable and plug are undamaged and the earth system is efficient. Follow the installation instructions precisely.

END OF SEASON OPERATIONS

To empty the internal circuit completely of water, open the cover **8** on the rear of the appliance.

Pull out the 2 drain hoses, take off the caps and let all the residual water flow out (figure N).

When all the water has been drained, place the caps back on the hoses and put the hoses back inside.

Clean the filters and dry thoroughly before putting them back.

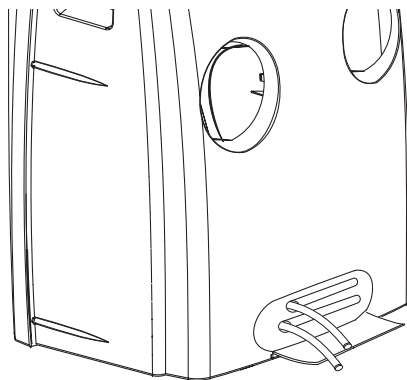

N

Troubleshooting

PROBLEM	CAUSE	REMEDY
The air conditioning unit does not start	<ul style="list-style-type: none"> no electricity it is not plugged into the mains the safety device has tripped 	<ul style="list-style-type: none"> wait plug into the mains contact your service centre
The air conditioning unit works for a short time only	<ul style="list-style-type: none"> the air exhaust hose has a constriction the air exhaust hose is blocked there are bends in the air exhaust hose 	<ul style="list-style-type: none"> position the exhaust hose correctly check there are no obstacles obstructing air discharge eliminate the bends
The air conditioning unit works, but does not cool the room	<ul style="list-style-type: none"> window open there are heat sources in the room (burner, lamp, etc) the exhaust hose is detached air filters clogged the air conditioning unit is not powerful enough for the conditions or size of the room 	<ul style="list-style-type: none"> close the window eliminate the heat source connect the exhaust hose clean or replace the filters
Particular odour in the room	<ul style="list-style-type: none"> air filter clogged 	<ul style="list-style-type: none"> clean or replace the filter
The air conditioning unit does not operate for about three minutes after turning it on	<ul style="list-style-type: none"> the safety device has tripped 	<ul style="list-style-type: none"> wait for three minutes
appears on the display <i>LE / PF / FE</i>	<ul style="list-style-type: none"> See "self-diagnosis" section 	

Guarantee/technical specification

GUARANTEE AND TECHNICAL ASSISTANCE

The conditions of the guarantee and technical assistance are given on the certificate supplied with your appliance.

LIMIT CONDITIONS	
Room temperature for air conditioning	21 ÷ 35°C
Room temperature for heating (certain models only)	25°C max.

TECHNICAL CHARACTERISTICS:

Power supply voltage see rating plate

Max. power input during air conditioning "

Absorbed power heating (certain models only): "

Refrigerant "

Cooling capacity "

Appliance dimensions:

- width 505 mm
- height 825 mm
- depth 440 mm
- weight 34 kg

Transport, filling, cleaning, recovery and disposal of refrigerant should be performed by a technical service centre appointed by the manufacturer only.

The appliance should be disposed of by a specialist centre appointed by the manufacturer only.

IMPORTANT INFORMATION FOR CORRECT DISPOSAL OF THE PRODUCT IN ACCORDANCE WITH EC DIRECTIVE 2002/96/EC.

At the end of its working life, the product must not be disposed of as urban waste. It must be taken to a special local authority differentiated waste collection centre or to a dealer providing this service.

Disposing of a household appliance separately avoids possible negative consequences for the environment and health deriving from inappropriate disposal and enables the constituent materials to be recovered to obtain significant savings in energy and resources. As a reminder of the need to dispose of household appliances separately, the product is marked with a crossed-out wheeled dustbin.

