

**Read this instruction booklet carefully before installing and using the machine. In this way, you will obtain the best possible results and maximum operating safety.**

## SAFETY WARNINGS

Read the following instructions carefully!

- Before use, check that the power supply corresponds to the voltage shown on the serial number plate. Connect the appliance only to properly-earthed power outlet (minimum 10A).
- In case of incompatibility between the plug and your socket, have the socket replaced by a qualified electrician.
- The electrical safety of this appliance is only guaranteed when it is properly earthed according to current electrical safety regulations. The manufacturer declines all responsibility for any damage resulting from inadequate earthing of the appliance. If in doubt, consult a qualified electrician.
- Do not use the appliance without water.
- This appliance is designed to make coffee: be careful to avoid scalding when using the water and steam jets.
- Do not touch hot parts (steam nozzle, water, area around the filter-holder and filter).
- Do not remove the filter-holder when the appliance is producing steam or hot water.
- Do not leave water in the machine when the room temperature is 0°C or below.
- After unpacking, check the appliance for damage. If in doubt, do not use the appliance; contact a qualified technician.
- Packaging materials (plastic bags, polystyrene foam, etc.) are a potential source of danger, and must be kept out of reach of children.
- This appliance is designed for domestic use only. Any other use of the appliance is considered improper and therefore dangerous.
- The manufacturer declines all responsibility for any damage resulting from improper, incorrect or careless use of the appliance.
- Do not touch the appliance with wet or damp hands or feet.
- Do not use the appliance in bathrooms.
- The appliance is not intended for use by persons (including children) with reduced physical, sensory or mental capabilities, or lack of experience and knowledge, unless they have been given supervision or instruction concerning use of the appliance by a person responsible for their safety. Children should be

supervised to ensure that they do not play with the appliance.

- Do not immerse the appliance in water.
- Before carrying out any cleaning or maintenance operations, always disconnect the appliance from the mains power supply by removing the plug.
- In case of failure or malfunction, switch off the appliance and do not attempt to effect repairs. Contact an authorized Service Centre and insist on original spare parts. Failure to observe the above points may affect the safety of the appliance.
- Installation must be carried out according to manufacturer's instructions.
- If the supply cord is damaged, it must be replaced by the manufacturer, its service agent or similarly qualified persons in order to avoid a hazard.
- Remove the plug from the mains socket when the appliance is not in use. Do not leave the appliance switched on unnecessarily. Turn off the power switch when the appliance is not in use.

This appliance conforms to EEC Directive 87/308 regarding the suppression of radio disturbance.

Materials and accessories coming into contact with food conform to EC regulation 1935/2004.

## DESCRIPTION OF THE APPLIANCE

- A** Control panel
- B** Steam control knob
- C** Water tank (removable on some models)
- D** Movable lid
- E** Power cable
- F** Steam and hot water spout
- G** Cappuccino nozzle (if included)
- H** Drip tray
- I** Boiler outlet
- L** Pressing pad (if included)
- M** Measure / pressing pad
- N** Filter cup
- O** Filter-holding lever
- P** Filter for coffee powder with creamer
- Q** "OK" indicator light
- R** "ON/OFF" switch with indicator light
- S** Steam switch
- T** Coffee and water dispensing switch

## USING THE COFFEE-MAKER FOR THE FIRST TIME

Remove the packaging and take out the bag containing the accessories. When the appliance is new, the following accessories must be washed with lukewarm water and detergent then rinsed thoroughly: filter cup, measure, two filters. The internal circuit of the coffee-maker must then be pre-washed as follows:

### Filling the tank

Raise the lid and pour fresh water into the tank (fig. 1). On the models with removable tank for easier filling, the tank can be extracted by pulling upwards (fig. 2). Make sure that the pipes are immersed when the tank is put back into place.

### Pre-washing

- a) Plug in at the power socket, remembering the safety instructions.
- b) Press the ON/OFF button (R) and coffee-dispensing button (T). The ON/OFF indicator light will come on (fig. 3). The pump will start to "load water". Wait until water starts to come out of the boiler outlet, then turn off the coffee-dispensing switch. After about 2 minutes, the "OK" light will come on (fig. 4). This means that the water (in the boiler) is at the correct temperature.
- c) Press the dispensing switch again for 10-15 seconds, allowing water to fall from the boiler outlet (fig. 5), then turn off the switch.
- d) To thoroughly pre-wash the circuit, perform the above operation at least five or six times.

At this point the machine is ready for normal use.

### Fitting the filter cup

To fit the filter cup onto the machine, place the cup under the boiler outlet (fig. 6) then press upwards and turn to the right **as far as it will go**.

## MAKING ESPRESSO COFFEE

- Always use fresh water and keep the tank clean.
- Before dispensing the coffee, always wait for the OK light to come on: this indicates that the water in the boiler has reached the ideal temperature for coffee-making.
- The coffee cups, filter cup and the filters should be heated before making the coffee.

The accessories can be heated with hot tap water or in the following way:

- Turn on the machine by pressing the ON/OFF switch (R).
- Place the filter for coffee powder with creamer in the filter holder, making sure the tab is correctly inserted in the corresponding slot, as shown in Fig. 7, and hook the filter holder onto the machine, to allow it to heat up.
- Wait for the OK light to come on, press the coffee dispensing switch (T) and let the hot water heat the accessories.
- Turn off the dispensing switch, remove and drain the filter cup, filter and coffee cups.

**You are advised to also perform this operation (hot water dispensing with no coffee in filter) if you want to make coffee after dispensing steam. In this case, performance of an "idle cycle" brings the machine to the ideal temperature for making perfect coffee.**

For best results, you are advised to use well-roasted and suitably ground top quality coffee.

### Method

- Turn on the machine by pressing the ON/OFF switch and wait for the OK light to come on.
- A few drops of water may fall from the boiler outlet: this is quite normal and is not a fault.
- Insert the filter (fig. 7).
- To prepare just one cup of coffee, fill the filter with 1 even measuring spoon of ground coffee, around 7 grams. To prepare two cups of coffee, on the other hand, use the filter with the creamer and fill it with two scant measuring spoons of ground coffee (around 6+6 grams). Fill the filter in small doses to avoid spilling the coffee, distributing it evenly and pressing lightly.
- On machines with pressing pad, this operation can be performed using the pressing pad next to the boiler outlet (fig. 8) in order to ensure more uniform pressing and therefore better-quality coffee. Remove any excess coffee from the rim of the filter.
- Fit the filter cup as described above.
- Place the pre-heated cup or cups on the drip tray, under the filter cup spouts. When the light comes on, press the dispensing switch and only release when the desired amount of coffee has been dispensed (about 20-30 sec.) (fig. 9).

- To release the filter cup, wait for a few seconds then turn the handle from right to left.
- To remove the used coffee, hold the filter in place by means of the special lever built into the handle, turn the filter cup upside down and empty the coffee or tablet by knocking the cup against a firm surface (fig. 10).
- If the machine is not to be used for a long time, turn it off and empty the water tank.  
A pre-wash should be performed, as described above, before using it the next time.

## MAKING A GOOD CAPPUCCINO

- Use a metal container, preferably tall with a small diameter.  
Only fill it 1/3 of the way up with milk to prevent it from boiling over.
- Turn the machine on by pressing the ON/OFF switch.
- Press the steam switch. After about 3 minutes the "OK" light will come on, indicating that the machine is at the ideal temperature for steam production (fig. 11).
- Important! At this stage, a few drops of water may be emitted from the boiler outlet: this is completely normal, but be careful not to scald yourself.
- Immerse the steam spout in the bottom of the milk (fig. 12) and turn the steam knob anti-clockwise. The amount of steam delivered by the spout can be adjusted by turning the knob.
- Lower the container so that the spout skims the surface of the milk and then give short bursts of steam at intervals, barely immersing the spout (fig. 12).
- If your coffee machine is equipped with a cappuccino nozzle, immerse the nozzle into the milk down to the mark on the nozzle (fig. 13).

**The first steam dispensed is mixed with water, so to get drier steam, wait for a few seconds with the steam adjustment knob open.**

- Always unscrew and rinse the cappuccino nozzle immediately after use in order to prevent the milk from hardening on the pipes. From time

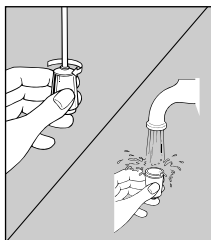

to time, use a pin to clean the holes in the cappuccino nozzle.

## DISPENSING STEAM

(to make tea, stock, etc.)

The steam function is useful for heating liquids.

- Switch the machine on by pressing the ON/OFF switch.
- Press the steam switch. After about few minutes the "OK" light will come on, indicating that the machine is at the ideal temperature for steam production.
- Immerse the steam spout in the bottom of the milk and turn the steam knob anti-clockwise the amount of steam delivered by the spout can be adjusted by turning the knob.

When the liquid is hot, completely close the steam knob and turn off the steam switch.

## DISPENSING HOT WATER

(to make tea, stock, etc.)

- Turn on the machine by pressing the ON/OFF switch and wait for the "OK" light to come on.
- Place a glass or cup under the steam spout.
- Press the dispensing switch while opening the steam lever.
- Hot water will be dispensed from the spout. When enough water has been delivered, close the lever and turn off the dispensing switch and "ON-OFF" switch.

## CLEANING AND MAINTENANCE OF THE FILTER

About every 300 coffees or when the coffee drips out of the filter holder or not at all, clean the ground coffee filter holder as follows:

- Remove the filter from the filter holder.
- Remove the filter cap (fig. 14) by unscrewing in the direction indicated by the arrow on the cap.
- Remove the frother from the container by pushing it from the cap end.
- Remove the gasket.
- Rinse all components and clean the metal filter thoroughly in hot water using a brush (fig. 15).

Make sure the holes in the metal filter are not blocked. If necessary, clean with a pin (see fig. 16).

- Replace the filter and gasket on the plastic disk as shown in fig. 17.

Make sure to insert the pin on the plastic disk into the hole in the gasket indicated by the arrow in fig. 17.

- Replace the resulting assembly in the steel filter container (fig. 18), making sure the pin is inserted into the hole in the support (see arrow in fig. 18).
- Finally, screw on the cap (fig. 19).

Failure to clean as described above invalidates the guarantee.

### CLEANING THE BOILER OUTLET

About every 300 coffees, the espresso boiler outlet must be cleaned as follows:

- Make sure the appliance is not hot and that it is unplugged from the mains.
- Using a screwdriver, unscrew the screw fixing the espresso boiler outlet filter.
- Clean the outlet filter thoroughly in hot water using a brush. Make sure the holes are not blocked. If necessary, clean with a pin.

Failure to clean as described above invalidates the guarantee.

### OTHER CLEANING OPERATIONS

1. Do not use solvents or abrasive cleaning products to clean the appliance. A soft, damp cloth is sufficient.
2. Remove the drip tray, empty and wash frequently.
3. Clean the water tank regularly.

**IMPORTANT:** during cleaning, never immerse the coffee machine in water. It is an electrical appliance.

### DESCALING

You are recommended to descale the coffee machine about every 200 coffees.

You should use a commercially available product specifically for descaling espresso coffee machines.

If such a product is not available, proceed as follows.

- Fill the tank with one litre of water.
- Dissolve 2 spoonfuls (about 30 grams) of citric acid (obtainable from chemist's or drug stores).
- Make sure the filter holder is not attached and position a recipient under the boiler outlet.
- Operate the machine as though making coffee until the tank has been emptied, then rinse.
- Repeat the operation with water only for 2-3 tanks.

Repair of damage to the coffee machine caused by scale is not covered by the guarantee unless descaling is performed regularly as described above.

### ELECTRICAL CONNECTION (UK ONLY)

- A) If your appliance comes fitted with a plug, it will incorporate a 13 Amp fuse. If it does not fit your socket, the plug should be cut off from the mains lead, and an appropriate plug fitted, as below.

**WARNING:** Very carefully dispose of the cut off plug after removing the fuse: do not insert in a 13 Amp socket elsewhere in the house as this could cause a shock hazard.

With alternative plugs not incorporating a fuse, the circuit must be protected by a 15 Amp fuse.

**WARNING - THIS APPLIANCE MUST BE EARTHED**  
**IMPORTANT**

The wires in the mains lead are coloured in accordance with the following code:

Green and yellow:	Earth
Blue:	Neutral
Brown:	Live



If the plug is a moulded-on type, the fuse cover must be re-fitted when changing the fuse using a 13 Amp Asta approved fuse to BS 1362. In the event of losing the fuse cover, the plug must NOT be used until a replacement fuse cover can be obtained from your nearest electrical dealer. The colour of the correct replacement fuse cover is that as marked on the base of the plug.

- B) If your appliance is not fitted with a plug, please follow the instructions provided below:

As the colours of the wires in the mains lead may not correspond with the coloured markings identifying the terminals in your plug, proceed as follows:

The green and yellow wire must be connected to the terminal in the plug marked with the letter E or the earth symbol  or coloured green or green and yellow.

The blue wire must be connected to the terminal marked with the letter N or coloured black.

The brown wire must be connected to the terminal marked with the letter L or coloured red.