

# instructions

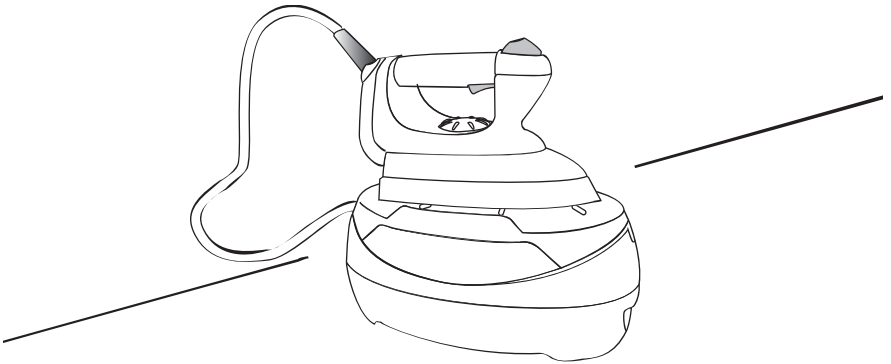

## **Steam Iron**

**Please keep your instructions for future reference**

Description

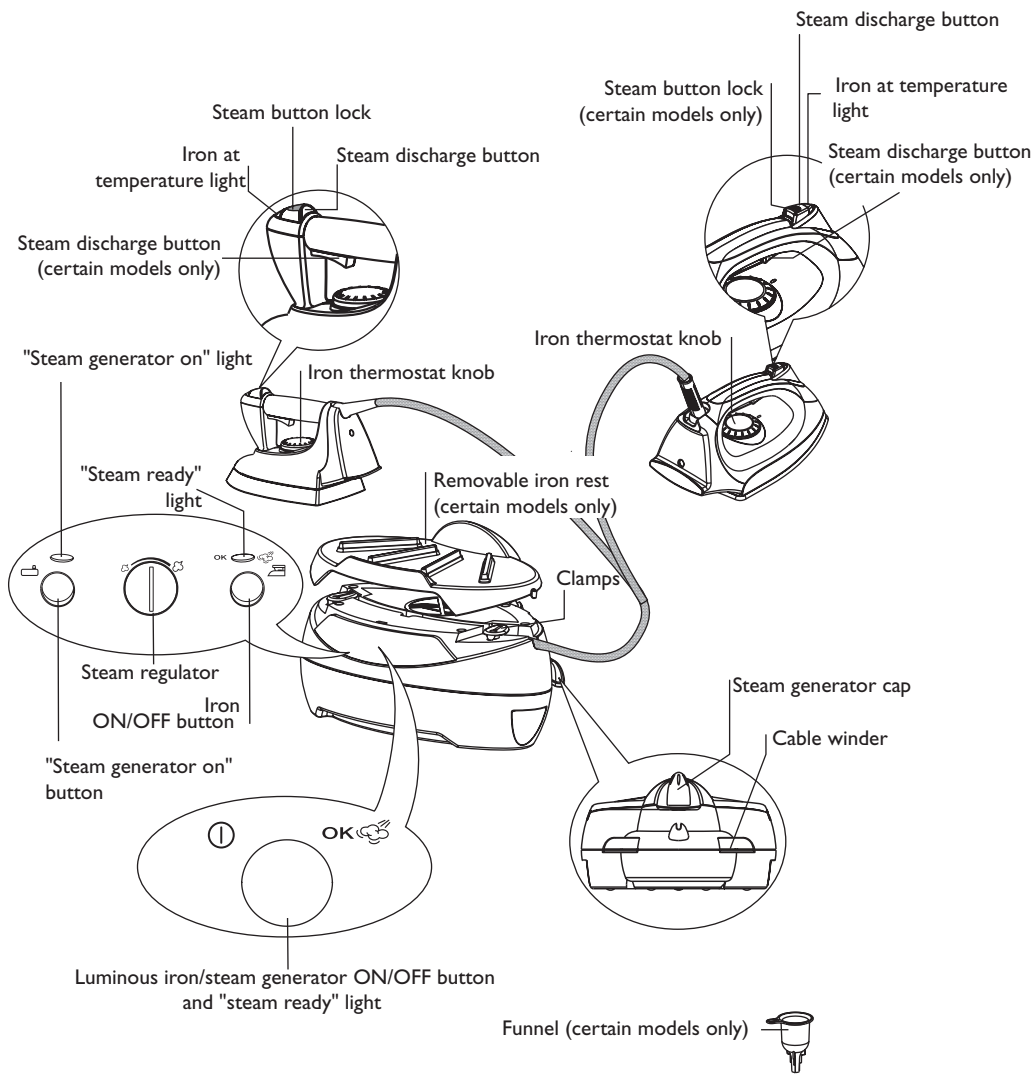

**Thank you for choosing this steam iron. To get the very best out of your new appliance it is advisable to read these instructions before using it. This will ensure that you gain optimum results and use the appliance safely.**

## About your appliance

The ironing system uses normal tap water. If the water in your area is very hard, please mix half tap water with half distilled water.

Do not use chemicals or detergents such as fragrances or scale removers in the tank as this could damage the tank.

The ironing system should be placed for use on a flat, stable, surface that is heat resistant.

We suggest that as the ironing system takes several minutes to heat up, fill it up and switch it on (following the instructions below), and then gather your ironing while you wait for it to heat up.

During use, the iron can be rested in a "vertical" position (fig. 1). However, make sure the surface is even and stable to avoid the iron falling over.

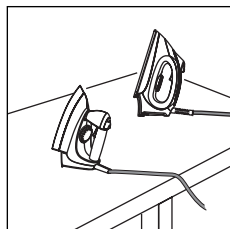

fig. 1

## Setting up the appliance for ironing

**Before carrying out this operation, always make sure the appliance is cold and unplugged from the mains.**

In models with removable iron rest, the position of the steam/cable tube can be changed to adapt the appliance to all working positions:

- lift up the removable iron rest;
- rotate the tube clamps (fig. 2);
- remove the tube and locate it on the other side;
- rotate the clamps with a coin to block the tube in place;

**If the steam cable tube clamps are not properly closed, the iron rest will not rest on the steam generator correctly.**

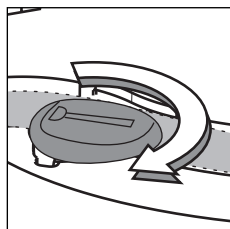

fig. 2

The removable iron rest can be placed on the ironing board:

**never rest the iron on the appliance without the iron rest in place.**





## Filling the water tank and connecting to the mains

Before steam ironing, make sure the fabric is suitable for this kind of ironing. The machine works with **normal tap water**. In case of very hard water (hardness above 27°F) we suggest using 50% distilled water diluted with tap water. Never use chemical substances or detergents (eg perfumed water, essences, descaling solutions, etc).

Make sure the power cable is unplugged from the mains socket. Unscrew the steam generator cap and fill the tank with water using the funnel (if provided). In versions fitted with a cap lock device, the cap cannot be unscrewed while the steam generator is still under pressure. Screw up the cap fully and plug the iron into the mains socket.

**Important: never unscrew the cap with the boiler under pressure.**

## Using your ironing system

**Steam generator with separate switches:** press the switch  to turn on power to the steam generator. The "steam ready" light  and (if present) the "steam generator on" light come on. Press the switch  to turn on power to the iron. The "iron at temperature" light on the iron comes on. Certain models are fitted with a steam regulation knob enabling the quantity of steam to be increased or decreased. NB: When you turn the iron on, you are recommended to turn the steam regulation knob to the maximum steam position.

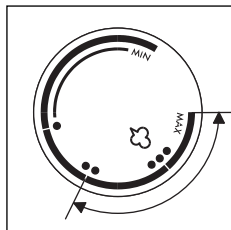

fig. 3

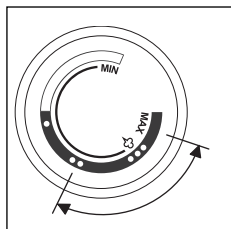

fig. 4

**Steam generator with single switch:** press the ON/OFF switch to turn power to the steam generator and iron on. The "steam ready" light incorporated in the switch and the "iron at temperature" light (4) on the iron come on.

### Operation (all models):

**NB:** When used for the first time, the appliance may give off smoke and an odour for several minutes. This is caused by heating and subsequent drying of the sealers used in assembling the steam generator and iron. The room should be ventilated.

Position the thermostat regulation knob in the area indicated in figure 3 or 4 (depending on model) according to the type of fabric to be ironed (see table on page 6). Before ironing, wait until the "iron at temperature" light goes off and the "steam ready" light comes on.

**NB:** both lights will go on and off during ironing, according to the temperature reached by the steam generator and iron.

**This is part of normal operation and is not a cause for concern.**

This steam button lock allows a continuous output of steam to be obtained by keeping the steam button pressed down mechanically, avoiding the need to do so manually.

To use, simply press the button and slide the lock backwards.

To release the button, slide the lock forwards.

**IMPORTANT:** the tube connecting the iron to the steam generator may become hot.

### Models with "professional" type iron

To obtain steam, press the steam button located on the iron.

NB: If your iron has both the button and trigger, you can choose to use either the top button or the bottom trigger as you prefer.

In certain models with professional iron, a slide allows a **continuous output of steam** to be obtained by keeping the steam button pressed down mechanically, avoiding the need to do so manually.

To use, simply press the button and slide the lock backwards.

To release the button, slide the lock forwards.

### Models with "domestic" type iron

To obtain steam, press the steam button located on the iron.

If your iron has both the button and trigger, you can choose to use either the top button or the bottom trigger as you prefer.

In certain models, a slide allows a continuous output of steam to be obtained by keeping the steam button pressed down mechanically, avoiding the need to do so manually.

To use, simply press the button and slide the lock backwards.

To release the button, slide the lock forwards.

### Vertical ironing (fig. 5)

The ironing system can be used for ironing and freshening garments on hangers, and curtains. Unless the fabric is cotton or linen we suggest holding the iron a few centimetres away from the material.

### Topping up the tank with water

When the water in the steam generator has run out, no more steam is given off. To refill, proceed as follows:

#### Steam generator with separate switches:

Turn the steam generator off using the switch .

Vent any steam left using the button on the handle of the iron.

Turn the iron off using the switch .

#### Steam generator with single switch:

Vent any steam left using the button on the handle of the iron. Turn the appliance off using the switch.

### Dry ironing

Plug the appliance into the mains.

#### Steam generator with separate switches:

Press the switch  to turn power to the iron on. The relative light comes on.

Position the thermostat regulation knob, according to the type of fabric to be ironed (see table on page 6).

**NB: When the iron has reached the selected temperature, the light on the iron goes out.**

#### Steam generator with single switch:

Press the switch to turn power to the iron on. The "iron at temperature" light and the light incorporated in the switch come on.

Position the thermostat regulation knob, according to the type of fabric to be ironed (see table on page 6).

When dry ironing, do not use the steam control (2).

### Putting your ironing system away

It is normal for there to be water left in the tank when you finish ironing. This does not affect operation of the iron. **NEVER turn the appliance upside down to empty the tank.**

After finishing ironing, you should put the ironing system away with the door tightly closed to avoid dust and foreign bodies falling into the tank and possibly jeopardising operation of the pump. To put the appliance away tidily, make sure it is completely cold, wrap the power cable around the cable tidy, then wrap the double cable.

### AFTER IRONING

Wait for the appliance to cool down then position the iron rest on the appliance.

Wrap the cable around the cable winder.

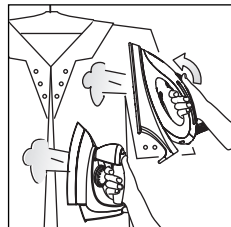





fig. 5

**Table - Thermostat dial settings**

			
Acetate, acrylic, nylon, polyester, rayon	Silk	Wool, cotton, fine linen	Cotton, linen, starched clothes

### Safety Warnings

- This appliance is designed to iron. Use with extreme care to avoid burns from the steam and avoid any improper use.
- When in use, do not touch any of the appliance's hot surfaces.
- After unpacking, make sure that the appliance is complete and undamaged. In case of doubt, do not use the appliance and seek the advice of a qualified service professional.
- Packaging materials (plastic bags, foam polystyrene, etc.) should not be left within the reach of children as this could be a potential source of danger.
- This appliance is designed for domestic use only. Any other use is to be considered improper and invalidates the guarantee and could be dangerous.
- The manufacturer takes no responsibility for damage derived from improper use.
- Never touch the appliance with wet or damp hands.
- Never allow children or unfit persons to use or play with the appliance.
- Never leave the appliance unattended.
- In case of breakdown or malfunctioning, turn the appliance off immediately and do not touch. For repairs, please contact a Service Centre authorised by the manufacturer and request the use of original replacement parts only. This is to ensure the safe use of the appliance.
- Noises could occur when the steam generator is heating up or cooling down, due to normal expansion and contraction of the stainless steel with which it is made.
- The power cable must never be replaced by the user. If the cable should become damaged, or needs to be replaced, please contact a Service Centre authorised by the manufacturer.
- When the appliance is not in use, turn off and disconnect the plug from the socket.
- The use of an extension lead is not recommended, however if it is necessary then follow carefully the extension lead's instructions, and most importantly ensure that the extension lead is correctly rated in accordance with the appliance being used and NEVER overloaded.
- As with any electrical appliance, whilst the instructions aim to cover as many eventualities as possible, caution and common sense should be applied when operating your appliance, particularly in the vicinity of young children.

## Electrical requirements

**Before using this appliance ensure that the voltage indicated on the product corresponds with the main voltage in your home, if you are in any doubt about your supply contact your local electricity company.**

The flexible mains lead is supplied connected to a B.S. 1363 fused plug having a fuse of 13 amp capacity. Should this plug not fit the socket outlets in your home, it should be cut off and replaced with a suitable plug, following the procedure outlined below.

**Note:** Such a plug cannot be used for any other appliance and should therefore be properly disposed of and not left where children might find it and plug it into a supply socket - with the obvious consequent danger.

**N.B.** We recommend the use of good quality plugs and wall sockets that can be switched off when the machine is not in use.

important: the wires in the mains lead fitted to this appliance are coloured in accordance with the following code:

GREEN AND YELLOW	EARTH
BLUE	NEUTRAL
BROWN	LIVE

As the colours of the wires in the mains lead of this appliance may not correspond with the coloured markings identifying the terminals in your plug, proceed as follows:

The wire which is coloured green and yellow must be connected to the terminal in the plug which is marked with the letter E or by the earth symbol  $\perp$  or coloured green or green and yellow.

The wire which is coloured blue must be connected to the terminal which is marked with the letter N or coloured black.

The wire which is coloured brown must be connected to the terminal which is marked with the letter L or coloured red.

When wiring the plug, ensure that all strands of wire are securely retained in each terminal. Do not forget to tighten the mains lead clamp on the plug. If your electricity supply point has only two pin socket outlets, or if you are in doubt, consult a qualified electrician.

Should the mains lead ever require replacement, it is essential that this operation be carried out by a qualified electrician and should only be replaced with a flexible cord of the same size.

After replacement of a fuse in the plug, the fuse cover must be refitted. If the fuse cover is lost, the plug must not be used until a replacement cover is obtained. The colour of the correct replacement fuse cover is that of the coloured insert in the base of the fuse recess or elsewhere on the plug. Always state this colour when ordering a replacement fuse cover.

Only 13amp replacement fuses which are asta approved to B.S. 1362 should be fitted.

This appliance conforms to the Norms EN 55014 regarding the suppression of radio interference.

**Warning - this appliance must be earthed**

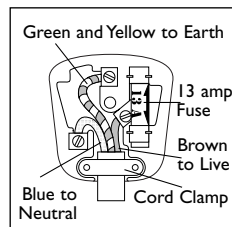

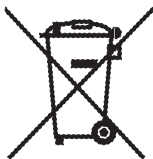

**Important information for correct disposal of the product in accordance with EC Directive 2002/96/EC.**

At the end of its working life, the product must not be disposed of as urban waste.

It must be taken to a special local authority differentiated waste collection centre or to a dealer providing this service.

Disposing of a household appliance separately avoids possible negative consequences for the environment and health deriving from inappropriate disposal and enables the constituent materials to be recovered to obtain significant savings in energy and resources. As a reminder of the need to dispose of household appliances separately, the product is marked with a crossed-out wheeled dustbin.