

IMPORTANT

Carefully read this handbook before using the appliance in order to obtain the best results and for maximum safety in use. Save these instructions for future reference.

WARNINGS**Carefully read the following instructions.**

- Before using the appliance, check that the mains supply voltage corresponds to the one indicated on the appliance label. Only connect the appliance to a power supply and to sockets with a minimum current rating of 10 A and provided with an earth connection.
- If the socket and mains lead plug are incompatible, the socket should be changed by qualified personnel only.
- The safety of this appliance is guaranteed only if it is correctly connected to a proper and effective earth connection as provided by the regulations in force on electrical safety. The manufacturer cannot be considered responsible for damages caused by the absence of an earth connection on the power supply line. If in doubt, consult an expert.
- Do not leave the iron unsupervised when plugged into the power socket.
- Never leave the appliance filled with water in a room where it will be subject to a temperature below or equal to 0°C.
- After removing the packing, make sure that the appliance is not damaged. If in doubt, do not use the appliance and consult an expert.
- The packing elements (plastic bags, polystyrene foam, etc.) should be kept out of the reach of children as they are a safety hazard.
- Adapters, multi-pin sockets and/or extensions should not be used. If their use is necessary, only adapters, multi-pin sockets and extensions that comply with current safety regulations should be used, taking care not to exceed the power limit indicated on the adapter.
- This appliance is intended for household use only. Any other use is considered inappropriate and consequently dangerous.
- Noises could occur when the steam generator is heating up or cooling down, due to normal expansion and contraction of the stainless steel with which it is made.
- The manufacturer shall not be liable for damages caused by inappropriate, incorrect or irresponsible use or for damages resulting from repairs carried out by non-qualified personnel.
- In the event of damage to the plug, to the hydraulic and electric system, only qualified personnel should replace the component parts with original spare parts.
- For any repairs and for the replacement of the power cable, if damaged, contact your reseller or an authorised service centre, so as to ensure the effectiveness of your appliance and the validity of the guarantee.
- DO NOT OPEN THE CAP WHEN USING THE APPLIANCE OR UNTIL THE APPLIANCE HAS RUN OUT OF WATER. The latter occurs when no more steam is released from the iron. To add water, unplug the appliance, and wait around 15 minutes to avoid rapid changes in temperature. Place a cloth on the cap and gradually unscrew it, allowing any residual steam to be released slowly.

- ONLY use the iron pad supplied; in the event of damage, only use the ORIGINAL spare part.
- If your model is provided of top cover, before lifting the appliance, be sure that the top cover is securely positioned.

The use of all electrical appliances implies the observance of some fundamental rules.

IN PARTICULAR:

- Never touch the appliance with wet or damp hands or feet. Never place the appliance in water.
- Never use the appliance in bathrooms.
- Never pull the mains lead or the appliance with wet or damp hands or feet.
- The appliance is not intended for use by young children or infirm persons without supervision.
- Young children should be supervised to ensure that they do not play with the appliance.
- Never leave the appliance plugged in as it could be a safety hazard.
- Before cleaning or servicing, disconnect the appliance by removing the plug from the socket.
- If the appliance should become faulty and/or not work properly, Switch it off and do not attempt to repair it. For all repairs contact only a Customer Service Centre appointed by the manufacturer and ask for original spare parts. Non-compliance with this warning can compromise the safety of the appliance.
- When the appliance is to be discarded, after unplugging it, the mains lead should be cut to make the appliance unusable.
- The mains lead of this appliance should not be changed by the user. If it is damaged or needs replacing, contact a Customer Service Centre appointed by the manufacturer.
- Never fill the appliance under running water.
- Absolutely avoid contact between the hot base and cables.
- If the safety thermistor is activated, the appliance switches off automatically. To use the appliance again, it must be serviced by qualified personnel.
- Do not direct the steam jet toward people as this could be dangerous.
- Do not use the iron on clothes that are still very wet.
- Do not store the iron if the base is hot.
- Do not use mixtures of stain removers or similar products.
- Unplug the appliance when it is not being used. Do not leave it plugged in if it not to be used.
- During use, the steam generator should not be moved.
- If the ironing system is dropped causing visible damage to the appliance (steam generator or iron), do not use. Take to an authorised service centre.
- Never remove the water tank cap when the appliance is connected to the mains supply.
- The steam generator should be placed on a flat surface that is particularly resistant to high temperatures.
- The appliance must be used on a stable ironing board

This appliance complies with the directive 89/336/EEC on radio interference suppression.

DESCRIPTION

- 1) Steam button lock (certain models only)
- 2) Steam discharge button
- 2A) Steam discharge trigger (certain models only)
- 2B) Steam discharge wheel with top and bottom activation and end lock for continuous delivery (certain models only).
- 3) Iron thermostat knob
- 4) "Iron on temperature" indicator light
- 5) Water tank cap
- 6) Removable iron pad
- 7) Funnel (if provided)
- 8) Steam control knob (if provided)
- 9) "Steam ready" indicator light
- 10) Pressure gauge (if provided)
- 11) "Low water" indicator light (if provided)
- 12) ON-OFF steam generator switch
- 13) ON-OFF iron switch
- 14) Top cover (if provided)

USEFUL HINTS

- Velvet, wollen fabrics, etc. as well as gloves, bags and so on will recover their original look and softness. Just pass the iron at a short distance with the steam on.
- Carpets will become like new again by removing the mark left by furniture placed on them; make the steam penetrate into the carpet where the nap has been pressed and brush it softly.
- Neither use or lean the iron on zips, hooks, rings, etc. to avoid scratching the plate.
- The surface of the plate must be kept clean: to clean it, just wipe the cold surface with a damp cloth. The iron mustn't be treated with decalcifying detergents.
- After using it, always wait till the iron is cold before putting it away.
- Put the iron in a dry place.
- When you have finished ironing it is not necessary to empty the water left in the water tank.
- Sort out clothes according to the recommended ironing temperature and begin to iron the ones that require the lowest temperature.
- Silk textiles can be dry-pressed on the reverse.
- Wollen, cotton and fine linen can be steam-ironed on the reverse or on the right side by putting a thin cloth to avoid "shine". Stached textiles need more steam. Iron whites and light colours on the right side; iron dark colours on the reverse as well as embroidery to make it stand out.

- Linen textiles can be steam-ironed by abundantly steaming the material and by ironing dark colours on the reverse to avoid "shine". Iron lapels on the right side to make them stand out.
- Each time you start operating the steam generator (and the first time you use it) or if you haven't used steam for some minutes: press the steam control button several times and away from the ironing board. This will remove the cold water from the steam circuit.
- During use, the iron can be rested in a "vertical" position (fig. 1). However, make sure the surface is even to avoid the iron falling over.
- The removable iron pad can be put where you prefer: be careful not to put the iron directly on the boiler's body..

INSTRUCTIONS FOR USE

Before steam ironing, make sure the fabric is suitable for this kind of ironing. The machine works with tap water. In case of very hard water (hardness above 27°F) we suggest using half distilled water and half tap water. Do not use chemicals or detergents (e.g. perfumed water, fragrances, scale removers, etc.).

For the models provided with top cover (14), remove it as shown in Fig. 3.

Filling the steam generator water tank and connecting to the power mains

Make sure the appliance is unplugged. Remove the water tank cap (5) and fill the tank with water using the special funnel (7) (if provided). Some models are provided with a safety cap which can't be unscrewed if there's still steam in the steam generator. Screw back the cap securely (5) and plug the switch in.

Attention: never unscrew the cap (5) with the steam generator under pressure.

Functioning

Press switch (12) to power the steam generator; the "Steam ready" (9) pilot lamp comes on.

Press the ON-OFF switch (13) to turn on the iron; the "Iron on temperature" (4) pilot lamp indicator light comes on.

Important: When in use for the first time, the iron may give off some smell and a particular odour due to the heating and subsequent drying out of the sealants used to assemble the steam generator and the iron.

This will stop in a few minutes. It is advisable to ventilate the room.

Position the iron thermostat knob (3) in the area indicated in Figure 1 or 2 (in some models), in accordance with the type of textile to be ironed (fig. 3). Wait till the "steam ready" light (9) and the "iron on temperature" light (4) go out before starting to iron.

N.B.: both indicator lights will go on and off during the ironing, according to the temperature reached by the steam generator and the iron. This is part of the normal functioning of the iron and you needn't worry about it.

Steam discharge in models with professional iron

To obtain steam, press the steam button (2) located on the iron.

NB: If your iron has both the button (2) and trigger (2A), you can choose to use either the top button or the bottom trigger as you prefer.

In certain models with professional iron, a slide (1) allows a **continuous output of steam** to be obtained by keeping the steam button pressed down mechanically, avoiding the need to do so manually. To use, simply press the button (2) and slide the lock backwards.

To release the button, slide the lock forwards.

Steam discharge in models with domestic iron

To obtain steam discharge, rotate the wheel (2B) forwards. The wheel can be rotated from the bottom of the handgrip (fig. 4).

To obtain **continuous steam** rotate the wheel forwards until it locks into place.

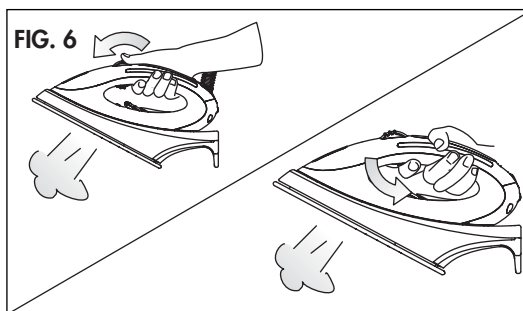

The steam regulator (8) allows the regulation of steam. The quantity of steam can be reduced or increased.

IMPORTANT: When switching on the iron, keep knob in the maximum steam output position.

WARNING: the iron-steam generator connecting hose may become hot.

Refilling the water tank

In some model, when the steam generator water tank runs out of water, the indicator light (11) goes on. To refill follow these instructions.

Turn the steam generator off using the switch (12). Let the remaining steam off by pushing the button (2) or (2A). placed on the iron handle. Turn the iron off using the switch (13). Unplug the appliance. Allow the appliance to cool down for a few minutes. Slowly unscrew the cap and refill as indicated in the "Filling the water tank" paragraph.

The manometer (if provided)

The manometer (10) allows you to keep the pressure in the steam generator under control.

The manometer has a graduated scale with two zones of different colour:

- a blue zone, from left to the centre, within which the gauge needle is positioned during normal operation, oscillating according to the pressure in the steam generator.
- a red zone, from the centre to the right. The gauge needle steadily positioned in this area, means an anomalous functioning of the iron. In this case switch the iron off and contact an authorized customer service centre.

DRY IRONING

Plug the appliance into the mains.

Press button (13) to turn power to the iron on. The light (4) comes on. Position the thermostat regulation knob (3), according to the type of fabric to be ironed (fig. 3). For dry ironing, do not use the steam control (2).

N.B.: when the iron has reached the selected temperature, the light (4) goes out.

STORING THE APPLIANCE

When storing the appliance, clip on top cover (14) (if provided) ensuring that it is correctly located in its housing (fig.4).

When using the appliance, lift it by handle to be found on the top of the cover.

Subject to changes