

instructions

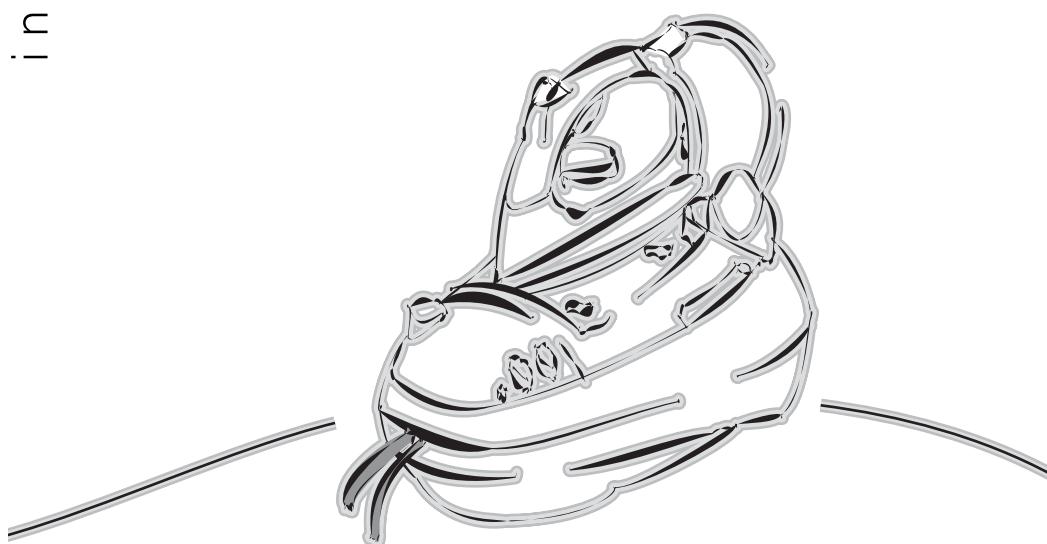

**Ironing system  
VVX170**

**Please keep your instructions for future reference**



*Living innovation*

## Ironing system description

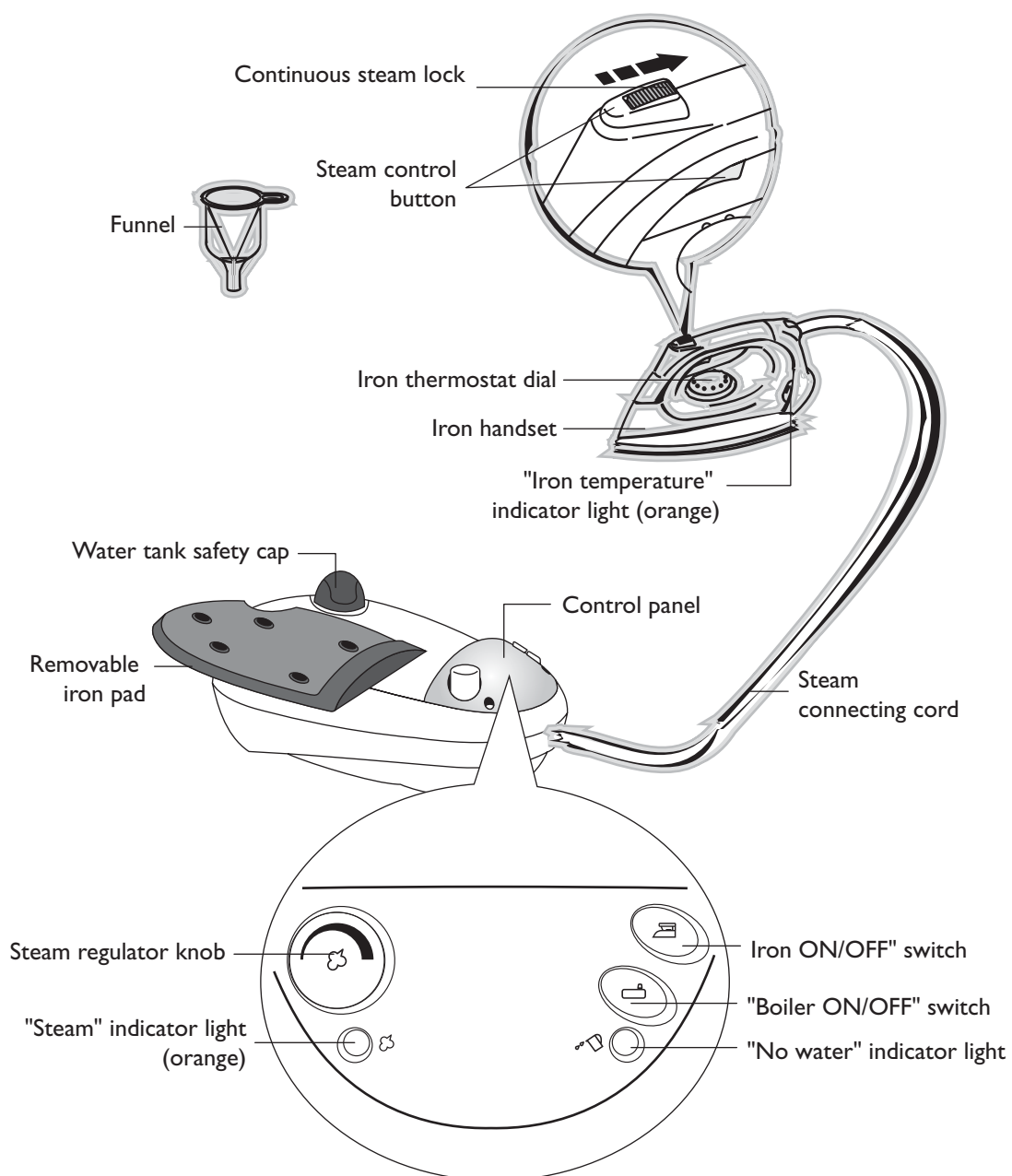

**Thank you for choosing this ironing system. To get the very best out of your new ironing system it is advisable to read these instructions before using it. This will ensure that you gain optimum results and use the appliance safely.**

### About your ironing system

The system uses normal tap water. If the water in your area is very hard, please mix half tap water with half distilled water.

Do not use chemicals or detergents such as fragrances or scale removers in the tank as this could damage the tank.

The ironing system should be placed for use on a flat, stable, surface that is heat resistant.

We suggest that as the ironing system takes several minutes to heat up, fill it up and switch it on (following the instructions below), and then gather your ironing while you wait for it to heat up.

The removable iron pad can be put where you prefer: be careful not to put the iron directly on the boiler's body.

### Filling and preparing for use

- With the ironing system unplugged, remove the water tank safety cap, by pushing down and turning anti-clockwise.
- Fill the tank with 1 litre of water, using the funnel supplied, taking care not to overfill.
- Screw the cap back on and then plug into the mains.

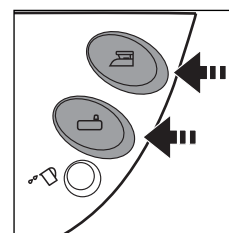

fig. 1

### Using your ironing system

- Press switches and to power the steam generator and the iron (fig. 1) ; the "Steam ready" pilot lamp and the iron temperature light (orange) on the iron handset will also come on (fig. 2).
- Turn the thermostat dial on the iron handset to the steam area indicated in Fig 3. (Remember to test fabrics first if you are unsure of the temperature to iron them at ). The thermostat dial should be altered in accordance of what type of fabric you are ironing (see table on page 5 for guidance).
- The system is ready for use when; the orange steam light on the base and iron temperature light on the iron handset go out.
- To obtain steam press either the steam control button on the top of the handle or on the underside of the handle, choose which ever is most comfortable for you. The steam stops as soon as you release the button

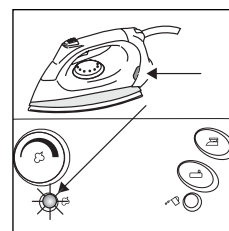

fig. 2

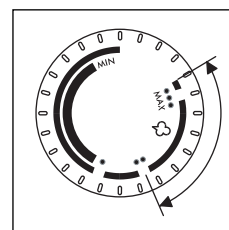

fig. 3

### IMPORTANT;

1. Never attempt to open the water tank cap when it is under pressure.
2. When used for the first time the iron may give off a 'new' smell. This is perfectly normal and will not last long.
3. The steam and iron temperature indicator lights will go on and off intermittently during use, according to the temperature of the iron and the boiler.
4. The steam connecting cord will become warm during use.

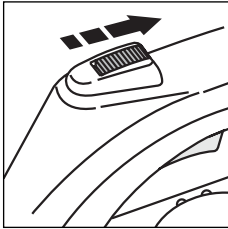



fig. 4

### Steam Button Lock

For continuous steam (without having to keep the steam button pressed down) you can slide the steam lock into position. The lock is found on the steam button on the top of the iron handle. To lock in place, simply press the button down and slide the lock backwards (Fig 4). To release, push the slide forwards to its original position.

### Refilling the Tank

If there is no steam left, and you still have more ironing to do, the tank can be refilled as follows;

1. Turn the steam generator off using the switch .
2. Let the remaining steam off by pushing the steam button on the iron handle.
3. Turn the iron off using the switch .
4. Unplug the appliance.
5. Wait for the appliance to cool down, this will take several minutes. Slowly unscrew the cap and refill as per the instructions on page 3.

### Vertical ironing

The ironing system can be used for ironing and freshening garments on hangers, and curtains. Unless the fabric is cotton or linen we suggest holding the iron a few centimetres away from the material.

**Dry ironing**

Press button  to turn power to the iron on; the iron temperature light (orange) on the iron handset will come on (fig. 5). Position the thermostat dial, according to the type of material you are ironing, and you are ready to iron.

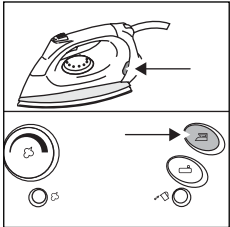

fig. 5



**Putting your ironing system away**

Once you have finished using your ironing system, unplug it and let it cool down. If you put it away immediately after use, be very careful as it will be hot, and ensure that the surface where you are storing it is heat resistant

**Tip**

An open mesh type ironing board is recommended for best results, as this lets the steam through.

**Table - Thermostat dial settings**

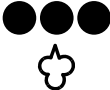
			
Acetate, acrylic, nylon, polyester, rayon	Silk	Wool, cotton, fine linen	Cotton, linen, starched clothes

### **Safety Warnings**

- This appliance is designed to iron. Use with extreme care to avoid burns from the steam and avoid any improper use.
- When in use, do not touch any of the appliance's hot surfaces.
- After unpacking, make sure that the appliance is complete and undamaged. In case of doubt, do not use the appliance and seek the advice of a qualified service professional.
- Packaging materials (plastic bags, foam polystyrene, etc.) should not be left within the reach of children as this could be a potential source of danger.
- This appliance is designed for domestic use only. Any other use is to be considered improper and invalidates the guarantee and could be dangerous.
- The manufacturer takes no responsibility for damage derived from improper use.
- Never touch the appliance with wet or damp hands.
- Never allow children or unfit persons to use or play with the appliance.
- Never leave appliance unattended.
- In case of breakdown or malfunctioning, turn the appliance off immediately and do not touch. For repairs, please contact a Service Centre authorised by the manufacturer and request the use of original replacement parts only. This is to ensure the safe use of the appliance.
- Noises could occur when the steam generator is heating up or cooling down, due to normal expansion and contraction of the stainless steel with which it is made.
- The power cable must never be replaced by the user. If the cable should become damaged, or needs to be replaced, please contact a Service Centre authorized by the manufacturer.
- When the appliance is not in use, turn off and disconnect the plug from the socket.
- The use of an extension lead is not recommended, however if it is necessary then follow carefully the extension lead's instructions, and most importantly ensure that the extension lead is correctly rated in accordance with the appliance being used and NEVER overloaded.
- As with any electrical appliance, whilst the instructions aim to cover as many eventualities as possible, caution and common sense should be applied when operating your appliance, particularly in the vicinity of young children.

## Electrical requirements

**Before using this appliance ensure that the voltage indicated on the product corresponds with the main voltage in your home, if you are in any doubt about your supply contact your local electricity company.**

The flexible mains lead is supplied connected to a B.S. 1363 fused plug having a fuse of 13 amp capacity. Should this plug not fit the socket outlets in your home, it should be cut off and replaced with a suitable plug, following the procedure outlined below.

**Note:** Such a plug cannot be used for any other appliance and should therefore be properly disposed of and not left where children might find it and plug it into a supply socket - with the obvious consequent danger.

**N.B.** We recommend the use of good quality plugs and wall sockets that can be switched off when the machine is not in use.

important: the wires in the mains lead fitted to this appliance are coloured in accordance with the following code:

GREEN AND YELLOW	EARTH
BLUE	NEUTRAL
BROWN	LIVE

As the colours of the wires in the mains lead of this appliance may not correspond with the coloured markings identifying the terminals in your plug, proceed as follows:

The wire which is coloured green and yellow must be connected to the terminal in the plug which is marked with the letter E or by the earth symbol  or coloured green or green and yellow.

The wire which is coloured blue must be connected to the terminal which is marked with the letter N or coloured black.

The wire which is coloured brown must be connected to the terminal which is marked with the letter L or coloured red.

When wiring the plug, ensure that all strands of wire are securely retained in each terminal. Do not forget to tighten the mains lead clamp on the plug. If your electricity supply point has only two pin socket outlets, or if you are in doubt, consult a qualified electrician.

Should the mains lead ever require replacement, it is essential that this operation be carried out by a qualified electrician and should only be replaced with a flexible cord of the same size.

After replacement of a fuse in the plug, the fuse cover must be refitted.

If the fuse cover is lost, the plug must not be used until a replacement cover is obtained. The colour of the correct replacement fuse cover is that of the coloured insert in the base of the fuse recess or elsewhere on the plug. Always state this colour when ordering a replacement fuse cover.

Only 13amp replacement fuses which are approved to B.S. 1362 should be fitted.

This appliance conforms to the Norms EN 55014 regarding the suppression of radio interference.

**Warning - this appliance must be earthed**

