

Dear customer,

Congratulations and thank you for choosing our company.

All our products are the result of meticulous design and technical testing.

We have produced this manual to enable you to get the best from your appliance and appreciate its quality to the full.

If you follow our tips, we are sure the appliance will give you complete satisfaction and long and faithful service.

By exploiting the power of steam, it helps reduce air pollution caused by the dispersion of chemical detergents.

This appliance exploits the power of steam to facilitate everyday cleaning in the home or for gardening, hobbies and DIY.

It has been designed to improve the hygiene of household surfaces and upholstery.

Important information for correct disposal of the product in accordance with EC Directive 2002/96/EC.

At the end of its working life, the product must not be disposed of as urban waste.

It must be taken to a special local authority differentiated waste collection centre or to a dealer providing this service.

Disposing of a household appliance separately avoids possible negative consequences for the environment and health deriving from inappropriate disposal and enables the constituent materials to be recovered to obtain significant savings in energy and resources. As a reminder of the need to dispose of household appliances separately, the product is marked with a crossed-out wheeled dustbin.

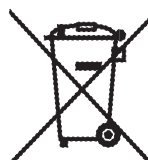

DESCRIPTION

- A** Pressure gauge (if fitted)
- B** Filter
- C** Hose socket with cover
- D** Boiler cap
- E** Condensate tank + filter
- F** Suction port
- G** Tank release slide
- H** Steam regulator
- I** "Steam ready" indicator light
- J** "ON/OFF" indicator light
- K** No water indicator light
- L** ON/OFF switch
- M** Tool compartment
- N** Rear grill
- N1** Rear filter

STANDARD TOOLS*

- O** Hose with handgrip
- P** Extension tubes

Tools for steam extraction washing

- Q** Multi-purpose brush
- Q1**.Bristle insert
- Q2**.Wet vacuuming insert
- Q3**.Carpet/rug insert
- R** Multi-purpose nozzle
- R1** Squeegee insert
- R2** Bristle insert
- S** Small triangular nozzle
- T** Squeegee
- U** Multi-purpose nozzle with brush (+ spare brush)

Tools for steam cleaning

- V** Coupling for steam tools
- W** Steam lance
- X** Bristles in-line and round brush

* The tools supplied vary according to the specific model.
The appliance can also be used as an ironing system
and is provided with a socket compatible with the professional iron kit.

WARNINGS

1) Read the instructions carefully

- 2) The appliance contains pressurised steam. Incorrect or improper use could be dangerous.
The appliance is designed for household use or for gardening, hobbies or DIY. All types of industrial use are excluded. The manufacturer declines all liability for damage deriving from improper use of the product.
 - 3) Before changing tools, cleaning the appliance or maintenance, always unplug from the mains.
 - 4) Before use, make sure the mains voltage corresponds to the voltage indicated on the rating plate on the bottom of the appliance.
 - 5) Plug the appliance into an efficiently earthed socket with a minimum rating of 10 A.
 - 6) Never direct the steam jet towards appliances containing electrical components such as the inside of ovens. They could be damaged, with the risk of dangerous electrical shock.
 - 7) Never direct the steam jet towards the appliance.
 - 8) Never unplug the appliance by pulling the power cable or appliance itself.
 - 9) To avoid damaging the insulation, do not run the appliance over the power cable.
Never place the appliance in a vertical position.
 - 10) Do not open the cap while using the appliance or before all the water has been used up. This occurs when steam is no longer discharged by the iron or tools.
To add water, unplug and wait about 15 minutes to avoid sudden temperature changes. Place a cloth over the cap and unscrew slowly to allow residual steam to escape gently.
 - 11) Avoid the steam coming into contact with the skin. The high temperature could cause serious burns. Never direct the steam jet towards persons or animals or towards surfaces or objects which could be damaged by high temperatures.
 - 12) To move the appliance, hold it by the handgrip. As it contains a boiler, surfaces become hot during use. Persons affected by particular pathologies causing abnormal sensitivity to heat should take special care when using this appliance.
 - 13) Do not add detergent to the tank. Use water only.
 - 14) If not used for long periods, you are recommended to evaporate the water completely before putting the appliance away.
 - 15) The appliance is not intended for use by persons (including children) with reduced physical, sensory or mental capabilities, or lack of experience and knowledge, unless they have been given supervision or instruction concerning use of the appliance by a person responsible for their safety. Children should be supervised to ensure that they do not play with the appliance.
 - 16) Do not use the appliance if it appears to be faulty. Contact your local dealer or an authorised service centre.
 - 17) If the temperature safety switch trips, the appliance shuts down.
To use again, contact specialist personnel.
 - 18) Protect the appliance from atmospheric agents (rain, frost, sun, etc).
 - 19) For repairs or if the power cable is damaged and requires replacement, contact an authorised service centre in order to avoid compromising the efficiency of your appliance and to guarantee the validity of the guarantee. For the same reasons, you are always recommended to use original spare parts.
- This appliance conforms to EEC directives 73/23 and 93/68 (and subsequent amendments) on low voltage and 89/336 (and subsequent amendments) on electromagnetic compatibility.

KEEP THESE INSTRUCTIONS CAREFULLY

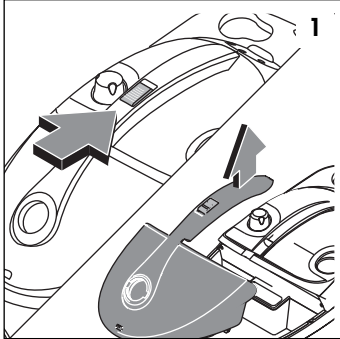

ASSEMBLY AND PREPARATIONS FOR USE

Before maintenance or preparing the appliance for use, make sure it is unplugged from the mains.

Remove the condensate tank using the slide on the handle (fig. 1).

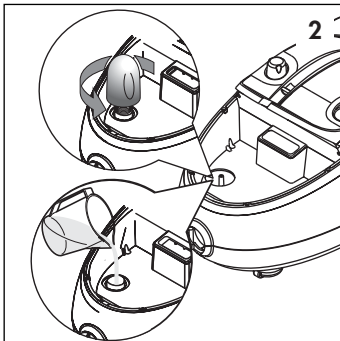

To open the boiler, unscrew the cap (fig. 2).

Fill the tank with a maximum of about 1.5 litres of tap water (without adding detergent).

Screw the cap up completely.

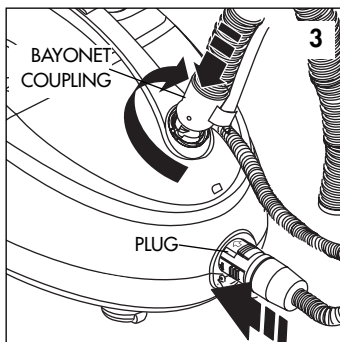

PREPARING THE CLEANING TOOLS

Fit the hose onto the appliance (fig. 3).

Insert the bayonet coupling into the socket on the cover, press down and rotate clockwise as far as it will go.

Open the safety hatch and insert the plug into the socket on the bottom of the appliance, making sure the arrow points upwards. Push down until it locks into place.

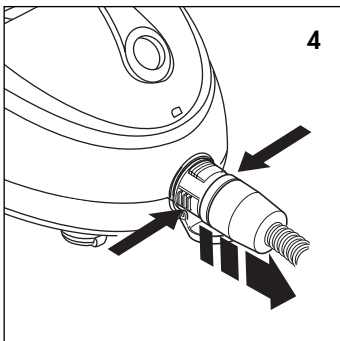

To remove, press the locking fins at the side and pull (fig. 4).

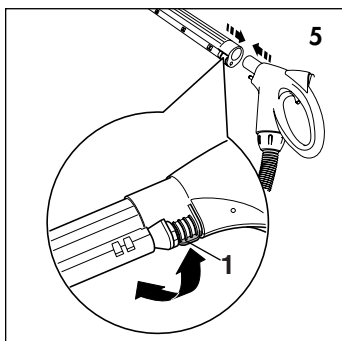

Fit the extension tube onto the hose handgrip, making sure the handgrip coupling is perfectly connected to the extension tube coupling by pushing firmly together. **Lock in place by rotating the locking ring (1)** (fig. 5).

To make sure it is fitted correctly, try removing the extension tube.

To insert the second extension tube or brush, proceed as described above.

USING THE APPLIANCE

Plug into the mains socket.

Press the "ON/OFF" button.

At this point, the power on indicator light comes on. When the "steam ready" indicator light also comes on, the appliance is ready for use (fig. 6) and, in models where present, the pressure gauge needle is in the green zone (about 3-4 bars) (fig. 7). This requires about 15 minutes.

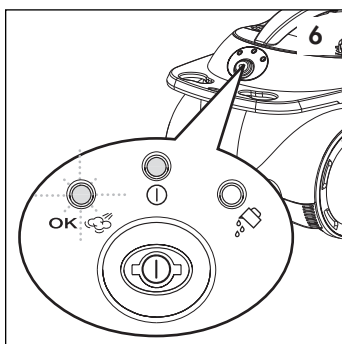

During operation, the steam ready indicator light goes on and off. This is part of normal operation.

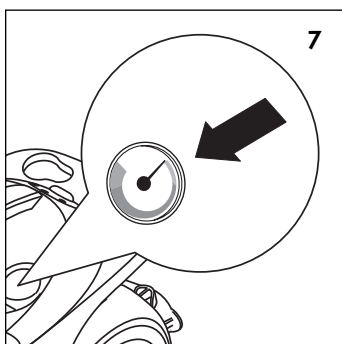

NB: When used for the first time, the appliance may give out smoke and an odour for several minutes. This is caused by heating and subsequent drying of the sealers used in assembling the boiler. You are recommended to ventilate the room.

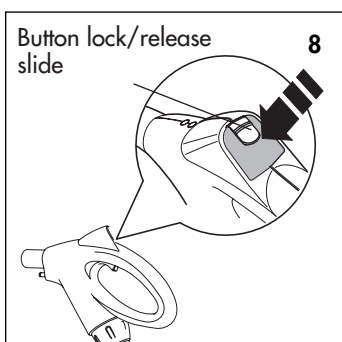

To discharge steam, hold the button on the bottom of the hose handgrip down. Release it to stop discharge. Activate suction by pressing the ON/OFF button (fig. 8). The appliance will then wash and vacuum at the same time.

To turn off suction, push the slide towards the inside.

In the case of persistent marks, you are recommended to steam first, then use suction. (See paragraph "extraction washing technique").

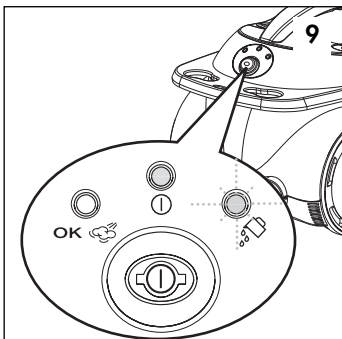

When the water in the boiler is about to run out, the "no water" indicator light comes on (fig. 9). Top up as follows:

Turn the appliance off by pressing the ON/OFF button.
Unplug from the mains socket.
Remove the condensate tank using the handgrip slide (fig. 1).
Wait 10-15 minutes until the appliance cools down.
Open the cap slowly using a cloth to allow residual steam to escape.
Refill as described above.

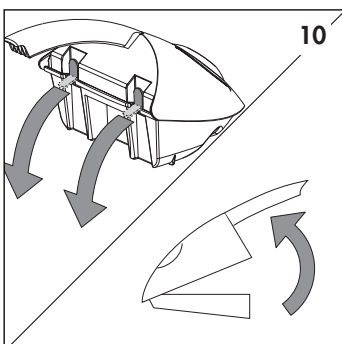

Important! Never unscrew the cap with the boiler under pressure and never operate the appliance without water.

Whenever you top up with water, remove the condensate tank using the slide on the handgrip, then remove the cover by unhooking from the tank (fig. 10).

Empty the condensate water, rinse the internal filters (fig. 11) and replace in the filter housing, then close the tank by pressing at the front until it hooks into place.
Replace the tank by placing it on the appliance and closing the slide.

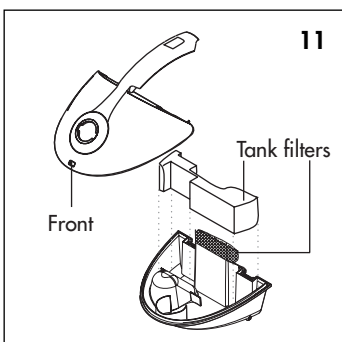

STEAM REGULATION KNOB (fig. 12)

Regulates the quantity of steam discharged.
When turning on, you are recommended to rotate the knob to the maximum steam discharge position.

PRESSURE GAUGE (certain models only)

Regulates boiler pressure.
Depending on the model, the pressure gauge scale is graduated from 0-6 bars or in coloured sectors.

- Normal working pressure is about 3-4 bars (green sector).
- If pressure is constantly above 5 bars or near the 0 (red sector), you should contact an authorised service centre.

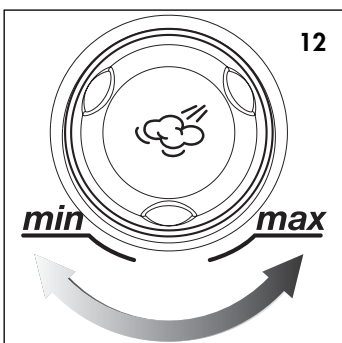

TIPS FOR CLEANING

Extraction washing technique

For extraction washing, proceed as follows:

Aim the steam jet at the surface to be treated using the steam discharge button and at the same time activate suction using the ON/OFF button on the hose handgrip.

Pass a number of times over the surface to be treated using suction only. The treated surfaces will be almost completely dry and the dirt will be removed.

Steam cleaning without suction

To use the appliance as a steam cleaner only, proceed as above, but without activating the suction system. Do **not** press the suction button on the hose handgrip

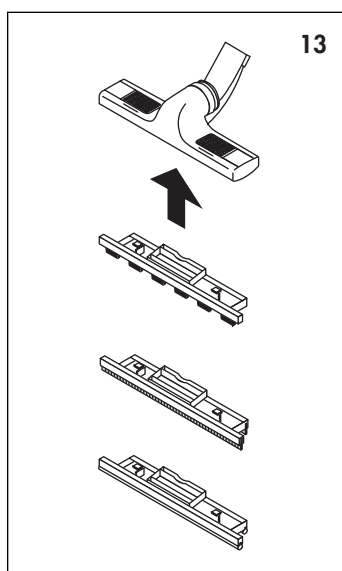

TOOLS FOR STEAM CLEANING AND VACUUMING

(The tools supplied vary according to the specific model)

Multipurpose brush (fig. 13)

This multipurpose brush can be used on any kind of wide surface simply by changing the insert.

To do this:

1. push outwards the lateral tabs on the frame;
2. insert the desired insert;
3. push inwards the tabs to lock in the insert.

Bristle insert: ideal for steam cleaning on hard floors.

Wet vacuuming insert: ideal for steam extraction cleaning on smooth floors.

Carpet/rug insert: ideal for cleaning carpet and rugs.

After cleaning, drops of water may fall from the brush. This is caused by condensation forming in the tubes.

Recommendation: use on treated cotton floors, wax polished floors and parquet is not recommended.

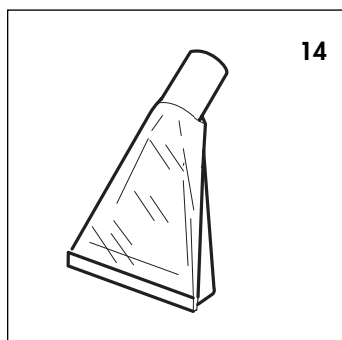

Small triangular nozzle (fig. 15)

Fit the extension tube either directly onto the handgrip (making sure the coupling is perfectly connected to the handgrip coupling) or to the extension tube, pushing firmly together and **then locking by rotating the locking ring.**

The small triangular nozzle can be used to wash and wet vacuum upholstery, sofas, furniture and vertical textiles.

To avoid damaging colours and delicate fabrics, you should first test on a concealed part of the carpet or upholstery to be cleaned.

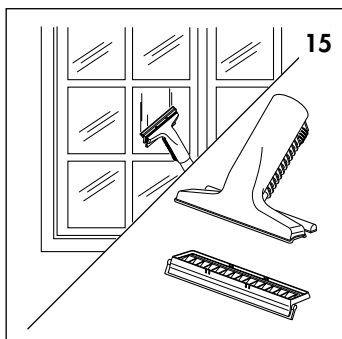

Multi-purpose nozzle

This nozzle can be used with either the squeegee or bristle inserts. After fitting the required insert, attach the multi-purpose nozzle to the extension tube or directly to the handgrip and lock in place with the locking ring.

Squeegee insert (fig. 15)

Ideal for cleaning small windows (lattice, etc).

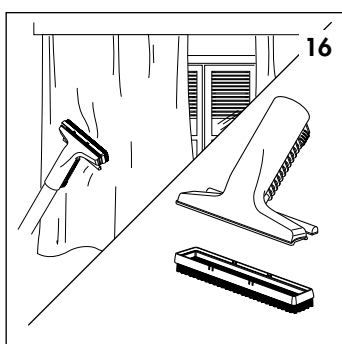

Bristle insert (fig. 16)

Ideal for refreshing fabrics (curtains, clothes, upholstery etc).

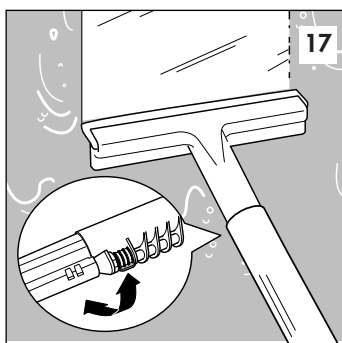

Squeegee tool (fig. 17)

The squeegee tool is extremely useful for cleaning glazed surfaces.

Insert the extension tube either directly onto the handgrip (making sure the coupling is perfectly connected to the handgrip coupling) or to the extension tube, pushing firmly together and then locking by rotating the locking ring.

Aim the jet at the surface to be washed. To dry, slope the tool in such a way that the squeegee adheres perfectly to the surface to be dried.

Recommendation: in low temperatures, you are recommended to warm the windows first with a weak jet of steam to avoid the risk of breakage due to sudden temperature changes.

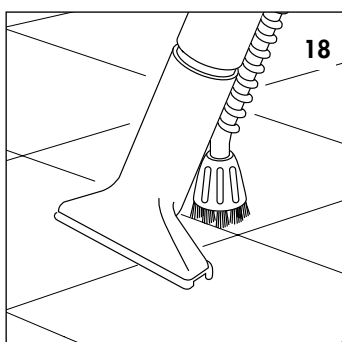

Nozzle with steam insert and brush (fig. 18).

Insert the extension tube either directly onto the handgrip (making sure the coupling is perfectly connected to the handgrip coupling) or to the extension tube, pushing firmly together and then locking it by rotating the locking ring.

Combined with steam, the brush facilitates removal of the dirt from joints between tiles, radiators, bathroom fittings and all difficult to reach points.

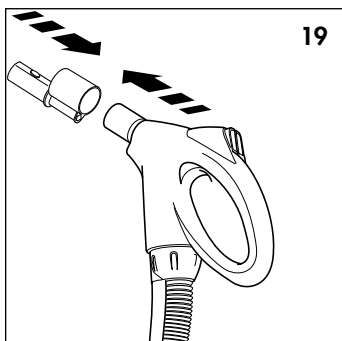

TOOLS FOR STEAM CLEANING

(the tools supplied vary according to the specific model)

Coupling for steam tools (fig. 19)

Enables a greater range of specific steam cleaning tools to be fitted directly to the hose handgrip or extension tube.

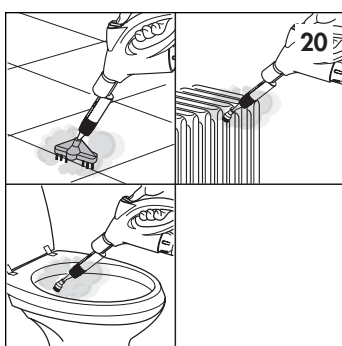

Lance + brushes (round or in-line) (fig. 20)

After fitting the lance tool, attach one of the brushes provided.

The "round" brush is recommended for cleaning radiators, ovens, etc.

The "bristles in-line" brush is particularly suitable for cleaning joints between tiles.

Important: After fitting the required tool, follow the instructions in the manual to operate the appliance.

REFILLING THE BOILER

The tank cannot be refilled until steam production has ceased. Proceed as follows:

- **Never open the cap until the water is completely finished.**
- **With the appliance on, discharge all steam using the switch on the handgrip or the steam discharge button on the iron.**
- Turn the appliance off using the ON/OFF switch and unplug from the mains socket.
- Wait a few minutes before refilling the tank to avoid sudden temperature changes.
- Place a cloth over the tank cap when opening. Open the cap slowly and carefully to allow residual steam to escape. Refill the tank as described above.

TURNING THE APPLIANCE OFF

The appliance can be turned off when the boiler is still under pressure.

You are, however, recommended to release residual pressure using the lever on the handgrip until the steam is finished.

Turn the appliance off via the main switch and unplug from the mains.

Wait at least 15 minutes after turning off the appliance before opening the cap.

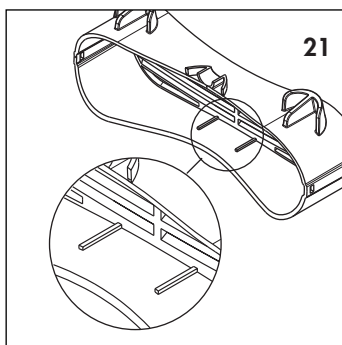

CLEANING AND MAINTENANCE

Important: Before cleaning or maintenance, always unplug from the mains socket.

After using the appliance, to improve hygiene you should rinse the tools.

After each use, you are recommended to empty the condensate tank and clean the filter in the tank.

If not used for long periods, you are recommended to empty the boiler before putting the appliance away.

After emptying and rinsing the tank, remove the filter (B), wash with running water and leave to dry.

To improve the working life of the filter, keep it dry.

Every now and then, remove the rear grill N from the appliance, take out the filter N1, wash under running water and leave to dry.

When dry, replace and reattach the grill to the back of the appliance, making sure the guides shown in fig. 21 face downwards.

The extension tubes can be stored in the tool compartment M.