

AIR CONDITIONER

INSTRUCTION MANUAL

SAVE THESE INSTRUCTIONS

CLIMATISEUR

MODE D'EMPLOI

CONSERVEZ CE MODE D'EMPLOI

CLIMATIZADOR

INSTRUCCIONES DE USO

CONSERVE ESTAS INSTRUCCIONES

LEA CUIDADOSAMENTE ESTE

INSTRUCTIVO ANTES DE USAR SU APARATO

PAC T140HPEC

Register this product online and receive a free trial issue of Cook's Illustrated.

Visit www.delonghiregistration.com.

Visit www.delonghiusa.com for a list of service centers near you. (U.S. Only)

Enregistrez ce produit en ligne et recevez un numéro gratuit de Cook's Illustrated.

Visitez www.delonghiregistration.com.

Visitez www.delonghiusa.com pour y voir une liste des centres de réparation proches de chez vous. (É.-U. uniquement)

Registre este producto en línea y reciba un ejemplar gratis de Cook's Illustrated.

Visite www.delonghiregistration.com.

Visite www.delonghiusa.com para ver la lista de centros de servicios cercanos a usted. (Solamente en los Estados Unidos)

Electronic characteristics/Caractéristiques
électroniques/Características electricas

115V~60HZ 1500W



IMPORTANT SAFEGUARDS

- Use this appliance only as described in this instruction manual. As with any electrical appliance, the instructions aim to cover as many situations as possible. Caution and common sense should be used when operating and installing this air conditioner.
- This appliance has been manufactured to cool and dehumidify domestic environments and must not be used for other purposes.
- It is dangerous to alter or modify the unit's characteristics in any way.
- The appliance must be installed in accordance with the relevant national legislation.
- Should repairs be necessary, contact the nearest authorized Repair Service Center. Unauthorized servicing can be dangerous.
- The appliance is not intended for use by persons (including children) with reduced physical, sensory or mental capabilities, or lack of experience and knowledge, unless they have been given supervision or instruction concerning use of the appliance by a person responsible for their safety. Children should be supervised to ensure that they do not play with the appliance.
- If the power cable is damaged, it must be replaced by the manufacturer or an authorized technical service center in order to avoid risk.
- Always ensure the appliance is plugged into a grounded 3-prong outlet. If you have any doubts check with a qualified electrician.
- Do not use extension cables.
- Before cleaning or maintenance operations, always unplug the unit from the outlet.
- Do not pull on or place strain on the power cord when moving the appliance.
- The appliance should not be installed where the atmosphere may contain combustible gases, oil or sulphur, or near heat sources.
- Do not rest hot or heavy objects on the appliance.
- Clean the filters at least once a week.
- Avoid using heaters near the unit.
- The unit should be transported in a vertical position. If this is not possible secure the unit at an angle, do not lie it horizontally.
- Before transporting the unit, drain the unit. After transportation, wait at least 6 hours before switching the unit on.
- The packaging materials can be recycled. You are therefore recommended to place them in the special containers for differentiated waste collection.
- This appliance is fitted with a special safety device. When the compressor switches off, this device prevents it from switching on again for at least 3 minutes.

WARNING: Changes or modifications not expressly approved by the party responsible for compliance could void the user's authority to operate the equipment.

SPECIFIC WARNINGS FOR APPLIANCES WITH R410A REFRIGERANT GAS:

R410A refrigerant gas conforms to EC regulations on the environment.

Avoid perforating the refrigerant circuit of the appliance.

ENVIRONMENTAL INFORMATION:

This unit contains fluorinated greenhouse gases covered by the Kyoto Protocol.

Maintenance and disposal must be carried out by qualified personnel only (R410A, GWP=1975).

SAVE THESE INSTRUCTIONS

THIS PRODUCT IS FOR HOUSEHOLD ONLY

ELECTRICAL CONNECTIONS

Before plugging the appliance into the outlet, check that:

- the power supply corresponds to the value indicated on the rating plate on the back of the appliance;
- the outlet and electrical circuit are adequate for the appliance;
- the outlet matches the plug. If this is not the case, have the plug replaced;
- the outlet is a properly grounded 3 hole outlet.

Failure to follow these important safety instructions absolves the manufacturer of all liability.

WHAT IS THE PINGUINO

During the summer, you feel comfortable at a temperature of between 75 - 80°F (24 - 27°C) with a relative humidity of about 50%.

An air conditioner removes excess moisture and heat from the room where it is located.

Compared with wall mounted models, portable air conditioners have the advantage that they can be moved from one room to another in the home or be transported from one building to another.

Hot air from the room is passed through a coil cooled by refrigerant gas. Excess heat and moisture are removed before the air is re-emitted into the room.

With portable air conditioners, a small part of this air is used to cool the refrigerant gas and then, when hot and damp, is discharged outside.

In the spring and autumn, the appliance can also be used to heat.

The efficient heat pump system provides a high heating capacity with low energy consumption.

All Pinguino models can also be used in fan-only mode.

PREPARING FOR USE

The instructions below will enable you to prepare your air conditioner for operation as efficiently as possible.

Before use, make sure the air intake and outlet grilles are unobstructed.

Air-conditioning without installation

Just a few simple steps and your comfort is ensured with your appliance:

- Fit the air exhaust hose (F) in the housing at the back of the appliance (fig. 1).
- In order to improve the performance of the appliance in air conditioning and boost (supercool) modes, you can also fit the intake hose accessory (M) in its housing in the back of the appliance as shown in figure 1A. **This step is optional.**

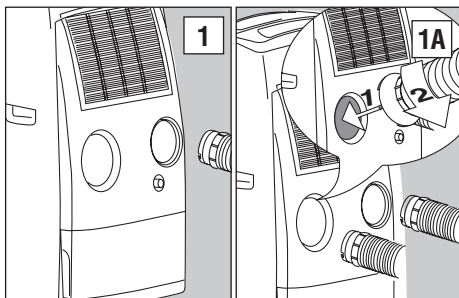

- Fit the window outlet (N) to the end of the hose (L/M).
- Place the air conditioner near a window or French window.
- Adjust the length of the hose to reach the window.
- Make sure the air exhaust hose is unobstructed.

Sash window

For optimum results:

- If you have a sash window, place the bracket (U) or (V) according to your needs, on the window sill, extend the bracket fully within the window frame, fix the bracket by using the locking pin then lower the window onto the bracket. Insert the window outlet (N) of the exhaust hose (L) into the slot, then connect the hose to the air conditioner (fig. 2 and 2A). Thanks to the locking pins, it's possible to use the window bracket also for sliding windows.

DESCRIPTION

- A** Air outlet grille
- B** Control panel
- C** Castors
- D** Handles
- E** Air intake grille with filters
- F** Air exhaust hose housing
- G** Intake grille
- H** Continuous condensate drain connection
- I** Condensate tank
- J** Power cable
- K** 2 flange caps
- L** Air exhaust hose
- M** Air inlet to intake hose
- N** 2 window outlets
- O** Suckers
- P** Castor locks
- Q** Continuous drain hose with coupling
- R** Remote control
- S** 3M® air purifying filter
- T** Silver ion filter
- U** Single hole window bracket with pin
- V** Double holes window bracket with pins
- W** Bug net
- X** Remote control support + adhesive strip
- Y** Dust cover
- Z** Remote control receiver

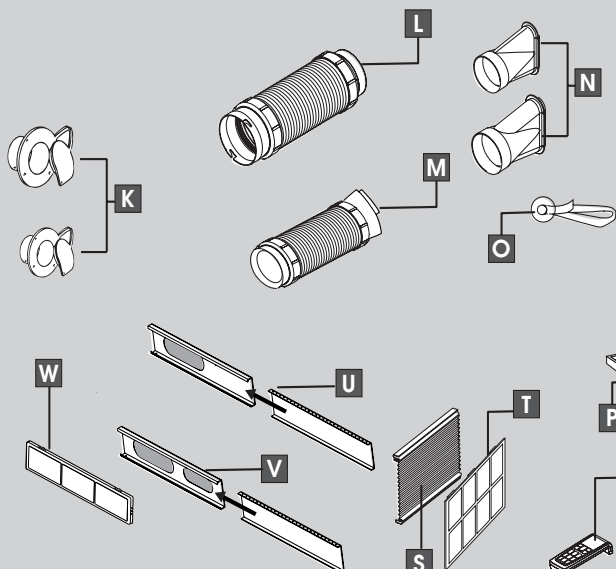
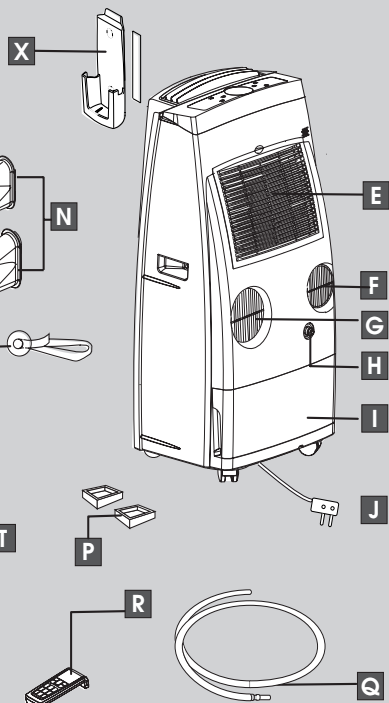
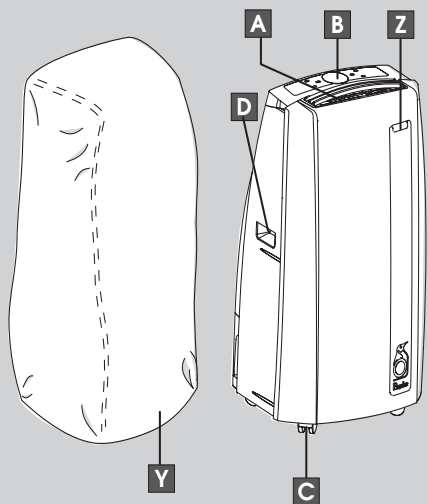

Position the hole of the bracket so to allow a correct installation of the exhaust hose.

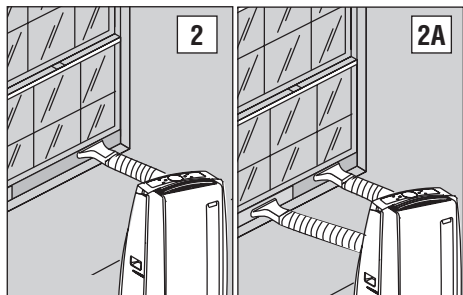

If the windows are large, use the 2 window bar (U and V) to cover your window opening, extending them to the required length, then blocking it with the locking pins supplied. Make sure you do not cover the hole or holes for the window outlet.

Bug Screen

To stop bugs from coming in, a screen can be mounted on the window bracket as shown in fig. 3.

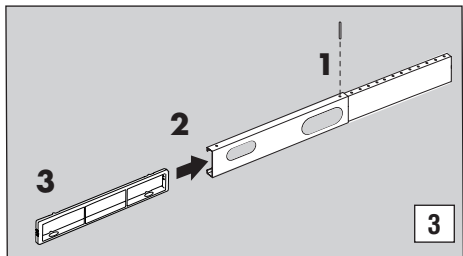

i Keep the air hose as short and free of curves as possible to avoid bottlenecks.

Double window

Open the double window slightly and position the window outlet (N). Use the suction pad (O) to hold the two parts of the window together (fig. 4).

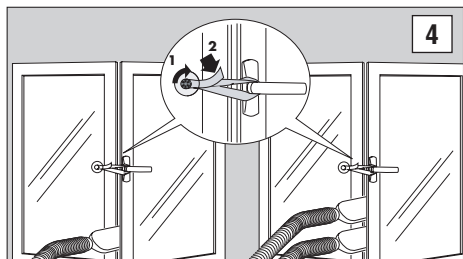

Air-conditioning with installation

If required, your appliance can be installed semi-permanently (Fig. 5 and 5A).

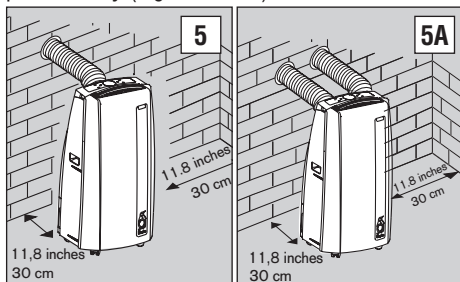

Proceed as follows:

- Drill a hole in an outside wall or through a window pane. Fit the flange accessory provided in the hole following the indications in figs. 6, 7 and 8.

Respect the dimensions and height of the hole given in figures 6, 7 and 8.

4.17 inches - 106 mm inlet hole dimension

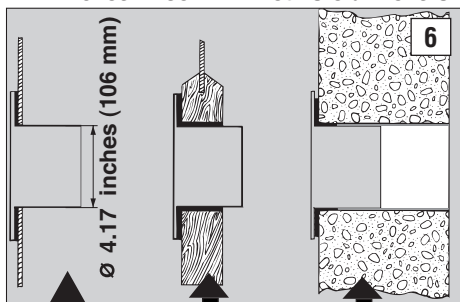

in the window pane
in the wooden kickboard of a French window
in the wall: you are recommended to insulate the section of wall using suitable insulation

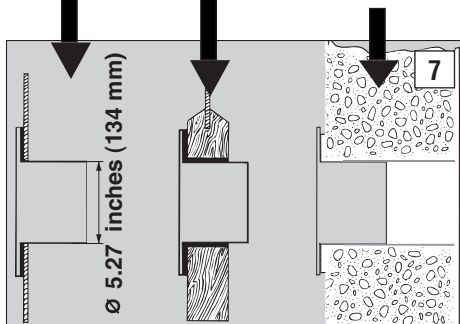

5.27 inches - 134 mm outlet hole dimension

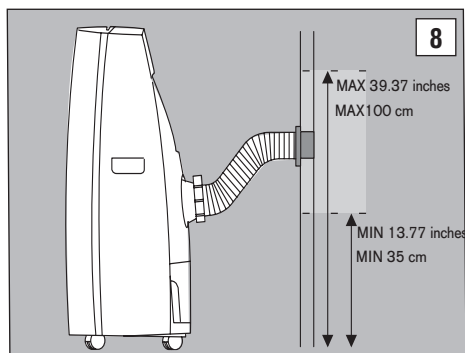

- Fit the air exhaust hose (L) in the housing at the back of the appliance (fig. 1).
- Fit the end of the hose to the flange (K).
When the hose is not fitted, the hole can be closed with the flange cap.

i Keep the air hose as short and free of curves as possible to avoid bottle necks.

i When installing the air conditioner semi-permanently, you should leave a door slightly open, as little as 0.5 inch (1 cm), to guarantee correct ventilation.

CONTROL PANEL

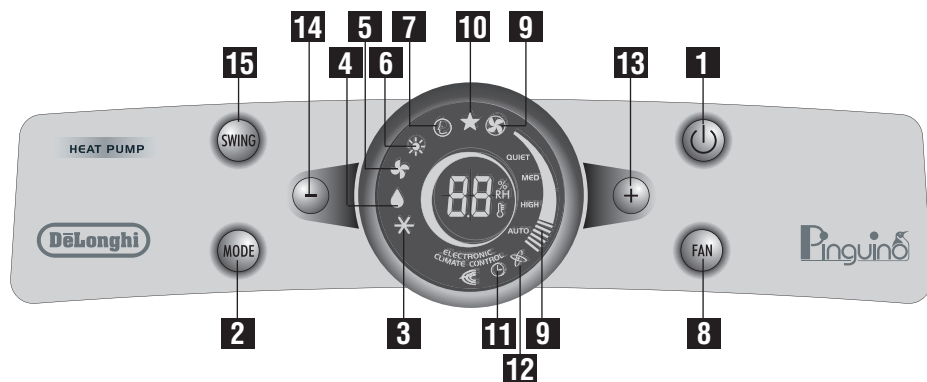

DESCRIPTION

- | | |
|-------------------------------------------------------------------------------------------------------------------------------------------------------------------------------------------------------------------------------------------------------------------------------------------------|---------------------------------------------------------------------------------------------------------------------------------------------------------------------------------------------------------------------------------------------------------------------------------------------------|
| <p>1 ON/Standby button (on/off)</p> <p>2 MODE button (selects the modes): Air conditioning, dehumidifying, air purifying/fan, heating, Smart</p> <p>3 Air conditioning symbol</p> <p>4 Dehumidifying symbol</p> <p>5 Air purifying/fan symbol</p> <p>6 Heating symbol</p> <p>7 Smart symbol</p> | <p>8 Fan speed button: Quiet - Med - High - Auto.</p> <p>9 Speed indicator</p> <p>10 SLEEP symbol</p> <p>11 "Timer" symbol</p> <p>12 "Ionizer" symbol (certain models only)</p> <p>13 Increase button (+)</p> <p>14 Decrease button (-)</p> <p>15 SWING button (movement of the grille flaps)</p> |
|-------------------------------------------------------------------------------------------------------------------------------------------------------------------------------------------------------------------------------------------------------------------------------------------------|---------------------------------------------------------------------------------------------------------------------------------------------------------------------------------------------------------------------------------------------------------------------------------------------------|

OPERATING FROM THE CONTROL PANEL

The control panel enables you to manage all the main functions of the appliance, but to fully exploit its potential, you must use the remote control.

Turning the appliance ON

- Plug into the outlet. Two lines appear on the display indicating that the appliance is in standby (fig. 9).
- Press the button  until the appliance comes on. The last function active when it was turned off will appear. When turned on for the first time, the appliance will be in “air conditioning” mode.

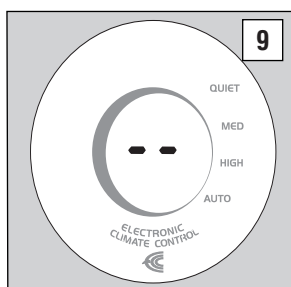

- Never turn the air conditioner off by unplugging from the outlet. Always press the button  then wait for a few minutes before unplugging. This allows the appliance to perform a cycle of checks to verify operation.



Air-conditioning Mode (FIG. 10)

Ideal for hot muggy weather when you need to cool and dehumidify the room.

To set this mode correctly:

- Press the **MODE** button a number of times until the air-conditioning symbol (3) appears.
- Select the target temperature by pressing the + or - button until the corresponding value is

displayed.

- Select the required fan speed by pressing the **FAN** button.

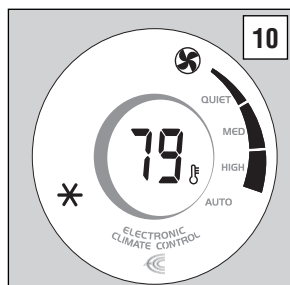

Four speeds are available:



Quiet speed: for quiet operation;
Medium speed: reduces noise levels but still maintains a good level of comfort;
High speed: to achieve the target temperature as rapidly as possible;
Auto speed: the appliance automatically selects the most suitable fan speed in relation to the temperature set on the digital display.

The most suitable temperature for the room during the summer varies from 75 to 81°F (24 to 27°C). You are recommended, however, not to set a temperature much below the outdoor temperature.



DEHUMIDIFYING MODE (FIG. 11)

Ideal to reduce room humidity (spring and autumn, damp rooms, rainy periods, etc).

Place the appliance in the room without fitting the air exhaust hose and inlet hose (L,M).

To set this mode correctly:

- Press the **MODE** button a number of times until the dehumidifying symbol (4) appears, then press the + or - button until the required humidity level is displayed. At the same time, the Auto fan light comes on as the appliance automatically selects the most appropriate speed. Water is removed from the air and collected in the tank at the back of the air conditioner. When the tank is full, the appliance shuts down and **FE** (full tank) appears on the display. The tank must be ex-

tracted and emptied (fig. 12). When the tank has been emptied and replaced, the appliance starts up again.

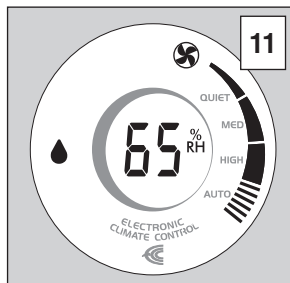

PUMP OPTION

The patented pump system will pump collected moisture upward out a window or into a drain, this eliminates the need to empty the tank during dehumidification. Simply connect the drain tube as shown in fig. 13.fig. 13.

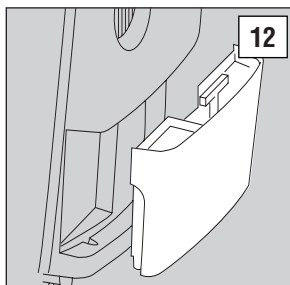

Note: In order for the continuous pump system to operate correctly, ensure the tube is properly connected to the unit. To release, press the coupling flange.

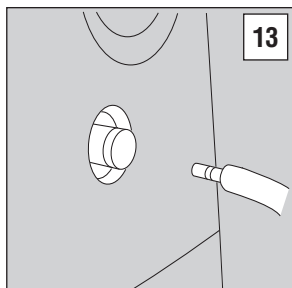

AIR PURIFYING/FAN MODE (FIG. 14)

When using the appliance in this mode, the air exhaust hose does not need to be attached.

To set this mode correctly:

- Press the **MODE** button a number of times until the fan symbol (5) appears.
- Select the required fan speed by pressing the **FAN** button.

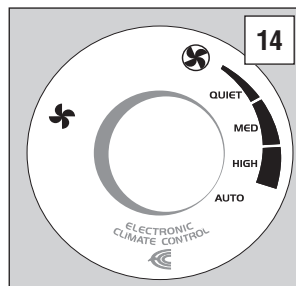

Three speeds are available:



Quiet speed: for quiet operation.

High speed: for maximum fan power;

Medium speed: reduces noise levels but still maintains a good level of comfort;

High speed: for maximum fan power;

In this mode, AUTO speed cannot be selected.



HEATING MODE (FIG. 15)

When going from heating to cooling mode, the unit will need 3-5 minutes before producing warm or cool air. To set this function correctly:

- Press the **MODE** button a number of times until the heating symbol (6) appears.
- Select the required temperature by pressing the + or - button until the corresponding value is displayed.
- In heating mode, the fan speed is selected automatically by the appliance.

Water is removed from the air and collected in the tank at the back of the air conditioner.

When the tank is full, the appliance shuts down and "FL" (full tank) appears on the display. The tank must be extracted and emptied (fig. 12).

When the tank has been emptied, the appliance

starts up again. The continuous drain hose accessory enables the condensate produced to be eliminated without requiring the tank to be emptied periodically.

To use the continuous drain function, fit the hose with the rapid coupling as shown in fig. 13.

With particular weather conditions it is possible that some wet built up in the air exhaust hose (L).

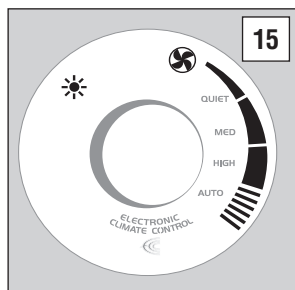

- ✓ When operating in very cold rooms, the appliance defrosts automatically, momentarily interrupting normal operation. "LT" appears on the display. During this operation, it is normal for the noise made by the appliance to change.
- ✓ In this mode, the fan may operate for short periods, even though the set temperature has already been reached.



SMART MODE (FIG. 16)

To select this mode, press the MODE button a number of times until the SMART symbol (7) appears. In this mode, the appliance decides automatically whether to operate in air conditioning, fan or heating mode, the most suitable temperature for optimum well-being and the fan speed.

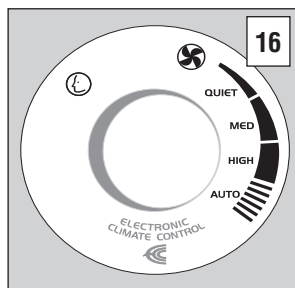

SWING BUTTON

Moves the grill flaps to distribute air uniformly throughout the room, or to focus air in a certain direction.

- When the **SWING** button is pressed once, the flaps begin moving alternately forwards and backwards. Press the **SWING** button again to stop the flaps in their current position. Pressing the button again will restart the flaps moving forwards and backwards.
- When the appliance is turned off, the flaps will close irrespective of their position.

REMOTE CONTROL DESCRIPTION

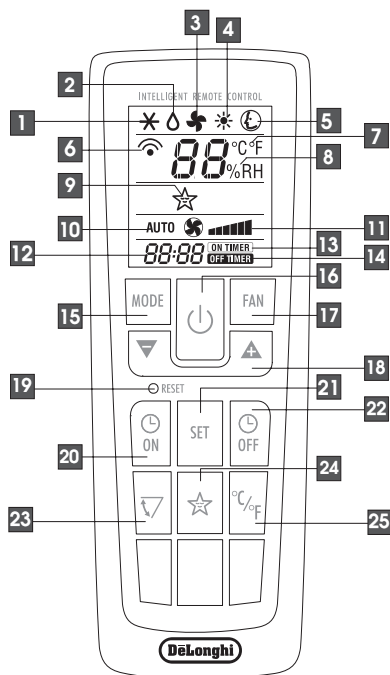

- 1 Air conditioning symbol
- 2 Dehumidifying symbol
- 3 Fan symbol
- 4 Heating symbol
- 5 SMART symbol
- 6 Signal transmission
- 7 Selected temperature scale indicator
- 8 Relative humidity indicator
- 9 SLEEP symbol
- 10 AUTO fan speed indicator
- 11 Fan speed indicator
- 12 Clock
- 13 Timer ON symbol
- 14 Timer OFF symbol
- 15 MODE button (selects the modes)
- 16 ON/Standby button
- 17 FAN button
- 18 Increase (+) and decrease (-) button
- 19 Reset button (resets the factory default settings)
- 20 Timer ON button
- 21 SET button
- 22 Timer OFF button
- 23 SWING button
- 24 SLEEP button
- 25 °C or °F selection button

USING THE REMOTE CONTROL

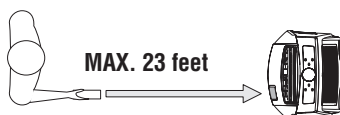

- Point the remote control at the receiver on the appliance. The remote control must be no more than 23 feet away from the appliance (without obstacles between the remote control and the receiver).
- The remote control must be handled with **extreme care**. Do not drop it or expose it to direct sunlight or sources of heat.

INSERTING OR REPLACING THE BATTERIES

- Remove the cover on the rear of the remote control (fig.17);
- Insert two R03 "AAA" 1.5V batteries in the correct position (see instructions inside the battery compartment);
- Replace the cover.

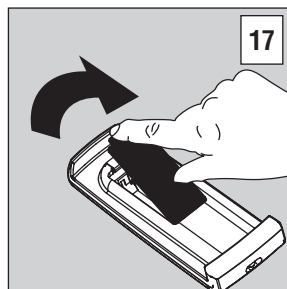

If the remote control unit is replaced or discarded, the batteries must be removed and disposed of in accordance with current legislation as they are harmful to the environment. Do not mix old and new batteries.

Do not mix alkaline, standard (carbon-zinc) or rechargeable (nickel-cadmium) batteries. Do not dispose of batteries in fire. Batteries may explode or leak. If the remote control is not be used for a certain length of time, remove the batteries.

Note: This equipment has been tested and found to comply with the limits for a Class B digital device, pursuant to part 15 of the FCC Rules. These

limits are designed to provide reasonable protection against harmful interference in a residential installation.

- This equipment generates, uses and can radiate radio frequency energy and, if not installed and used in accordance with the instructions, may cause harmful interference to radio communications. However, there is no guarantee that interference will not occur in a particular installation. If this equipment does cause harmful interference to radio or television reception, which can be determined by turning the equipment off and on, the user is encouraged to try to correct the interference by one or more of the following measures:

- Reorient or relocate the receiving antenna.
- Increase the separation between the equipment and receiver.
- Connect the equipment into an outlet on a circuit different from that to which the receiver is connected.
- Consult the dealer or an experienced radio/TV technician for help.

Changes or modifications not expressly approved by the party responsible for compliance could void the user's authority to operate the equipment.

- This device complies with Part 15 of the FCC Rules. Operation is subject to the following two conditions: (1) this device may not cause harmful interference, and (2) this device must accept any interference received, including interference that may cause undesired operation.

SETTING THE TIME

After having inserted the batteries, the clock on the display flashes until the time is set.

Proceed as follows:

- Press the + or - button until the correct time is reached. Hold the button down to run rapidly through first the minutes, then the tens of minutes and then the hours.
- Once the correct time has been reached, press the **SET** button to confirm.

If you need to change the time later, press the **SET** button, then set as described above. To cancel the settings programmed on the remote control and restore the original settings, press the **RESET** button lightly with the point of a pencil or pen.

USING THE REMOTE CONTROL (FIG. 18)

The **ON/Standby**, **MODE**, **FAN**, + and - buttons correspond to the equivalent buttons on the control panel.

ON/STANDBY button: Turns the appliance on and off.

MODE button: Selects modes AIR CONDITIONING, DEHUMIDIFYING, AIR PURIFYING, FAN, HEATING, SMART

FAN button: selects fan speed (High, Medium, Quiet, Auto)

+ and - button: increase and decrease. To use these buttons see the section "Operating from the control panel".

The following section describes the additional functions corresponding to the controls on the bottom part of the remote control.

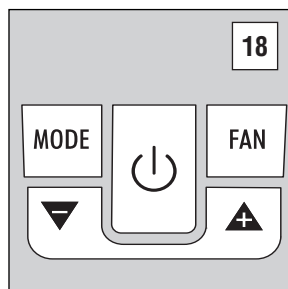

SELECTING THE TEMPERATURE SCALE (FIG. 19)

Press the $^{\circ}\text{C}/^{\circ}\text{F}$ button to switch the temperature display from degrees Celsius to degrees Fahrenheit and vice versa.

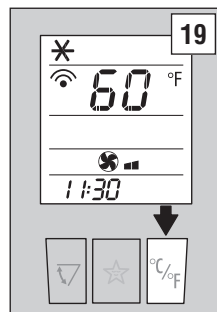



SLEEP FUNCTION (FIG. 20)

This function is useful for the night as it gradually reduces operation of the appliance.

To set this function correctly:

- Select the operating mode (air conditioning, dehumidifying, heating or smart as described above.)
- Press the  button. The appliance operates in the previously selected mode.

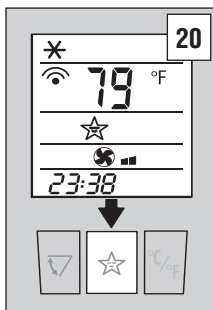

The SLEEP function maintains the room at optimum temperature without excessive fluctuations in either temperature or humidity and with near silent operation. Room temperature and humidity vary gradually to ensure the most comfortable conditions.

During air conditioning, the temperature increases by 2°F (1°C) every 60 minutes and a further degree after 2 hours. In dehumidifying mode, the dehumidifying power of the appliance is partially reduced every hour twice. In heating mode, the temperature drops by 2°F (1°C) every hour, three times. In all modes the unit will shutdown after 8 hours.



SWING FUNCTION (FIG. 21)

Moves the grill flaps to distribute air uniformly throughout the room, or to focus air in a certain direction.

When the **SWING** button is pressed and the flaps have begun moving alternately forwards and backwards, pressing the button again will lock the flaps in their current position. Pressing the button again will restart the flaps moving forwards and backwards. When the appliance is turned off, the flaps will close irrespective of their position.

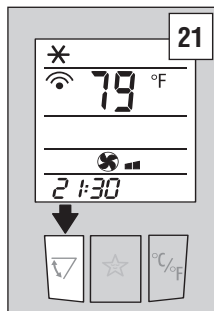

PROGRAMMING THE TIMER



The timer can be programmed to start up and shut down to fit in with your needs.

Programming start up

With the unit on, make all the desired settings for when the appliance will switch on (operating mode, fan speed and temperature), then turn the appliance off.

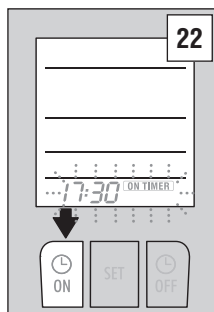
- Press the  ON button. The start-up time and message “ON TIMER” flash on the remote control display (fig. 22).

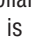

- Press the  or  buttons to set the time you want the appliance to start up.
- When that time is reached, press the **SET** button to confirm (fig. 23). The message “ON TIMER” appears on the remote control display and the symbol  is displayed on the appliance to indicate that the timer is active. At the end of the set time the appliance switches on automatically

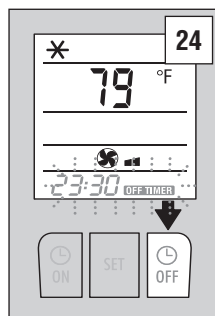
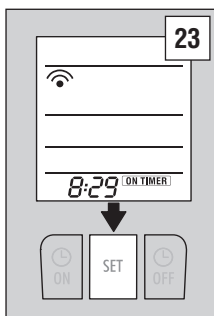

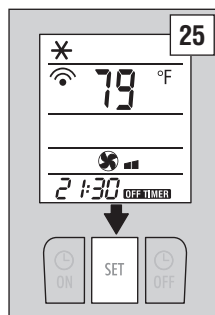

Programming shutdown

- Press the ☹ OFF button. The shutdown time and the message “OFF TIMER” flash on the remote control display (fig. 24).
- Press the ▼ or ▲ buttons to set the time you want the appliance to shut down.
- When that time is reached, press the SET button to confirm (fig. 25). The message “OFF TIMER” appears on the remote control display and the symbol ☹ is displayed on the appliance to indicate that the timer is active. At the end of the set time the appliance switches off automatically

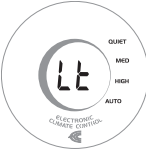

SELF-DIAGNOSIS

The appliance has a self diagnosis system to identify a number of malfunctions. Error messages are displayed on the appliance display.

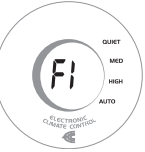
IF IS DISPLAYED... ..WHAT SHOULD I DO?	IF IS DISPLAYED... ..WHAT SHOULD I DO?
 <p>LOW TEMPERATURE (frost prevention)</p> <p>The appliance is fitted with a frost protection device to avoid excessive formation of ice. The appliance starts up again automatically when the defrosting process is completed.</p>	 <p>FULL TANK</p> <p>Empty the tank on the back of the appliance and replace it correctly. OR The continuous drain hose is not connected correctly or is obstructed and the air conditioner is draining into the tank. Note: in dehumidifying mode, it is normal for this message to appear.</p>
 <p>PROBE FAILURE (sensor damaged)</p> <p>If this is displayed, contact your local authorized service center</p>	 <p>FAILURE 1 (pump failure)</p> <p>If this is displayed, contact your local authorized service center</p>

TIPS FOR OPTIMAL PERFORMANCE

To get the best from your air conditioner, follow these recommendations:

- close the windows and doors in the room to be air conditioned (fig. 26). When installing the air conditioner semi-permanently, you should leave a door slightly open (as little as 1/2") to guarantee correct ventilation.

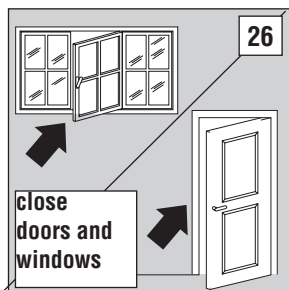

- Protect the room from direct exposure to the sun by partially closing curtains and/or blinds to make the appliance much more economical to run (fig. 27);

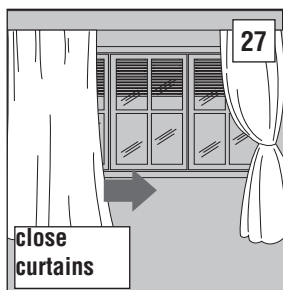

- never rest objects of any kind on the air conditioner;
- do not obstruct the air intake and outlet (fig. 28). Leave the grilles free;



- make sure there are no heat sources in the room.
- never use the appliance in very damp rooms (laundries for example).
- never use the appliance outdoors.
- make sure the air conditioner is standing on a level surface. if necessary, place the castor locks under the front wheels.

AIR PURIFYING FILTERS

The appliance is fitted with a silver ion dust filter which retains the impurities in the air drawn in from the room and a 3M® electrostatic filter which retains the finest dust particles (fig. 29).

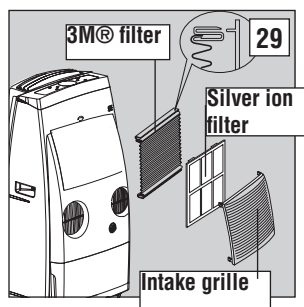

SILVER ION FILTER

The silver ion filter not only retains dust particles, but also has an efficient antibacterial action. It also greatly reduces concentrations of irritants such as pollen and spores.

The filter is treated with small particles of silver (on the scale of millionths of a millimetre) which are able to block the multiplication of and destroy any bacteria or spores they come into contact with.

3M® ELECTROSTATIC FILTER

The 3M® electrostatic filter retains the finest dust particles, thus enhancing the filtering capacity of the appliance.

To use the 3M® electrostatic filter:

- A) Remove the intake grille
- B) Remove the filter from the packaging
- C) Use the two plastic edges of the 3M® filter to hook it to the special attachments on the dust filter already inside the intake grille.
- D) Replace the grille on the appliance.

CLEANING

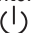
Before cleaning or maintenance, turn the appliance off by pressing the  button on the control panel or remote control, wait for a few minutes then unplug from the outlet.

CLEANING THE CABINET

You should clean the appliance with a slightly damp cloth then dry with a dry cloth.

- Never wash the air conditioner with water. It could be dangerous.
- Never use petrol, alcohol or solvents to clean the appliance.
- Never spray insecticide liquids or similar.

CLEANING THE AIR FILTERS

To keep your air conditioner working efficiently, you should:

1. Clean the silver ion filter every week of operation.
2. Replace the 3M® air purifying filter at the end of each season or when exhausted (see the instructions near the filter housing on the appliance). The filters are housed in the intake grille.

To clean the filters, proceed as follows:

1. Remove the intake grille by rotating outwards (fig. 30).
2. Remove the 3M® air purifying filter (white).
3. Remove the silver ion filter by detaching it from the grille.

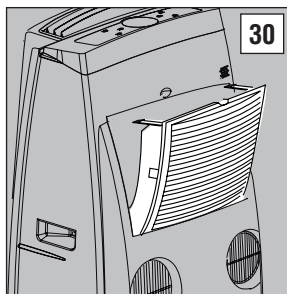

Use a vacuum cleaner to remove dust accumulations from the silver ion filter.

If it is very dirty, immerse in warm water and rinse a number of times.

The water should never be hotter than 105°F (40°C).

After washing, leave the filter to dry.

To replace, put the filters back in the intake grille then attach the intake grille to the appliance.

- **Never try and wash or clean the 3M® filter as this could reduce its filtering capacity. When the filter is exhausted, replace it.**

START OF SEASON CHECKS

Make sure the power cable and plug are undamaged and the electrical system is efficient.

Follow the installation instructions precisely.

END OF SEASON OPERATIONS

Place the appliance in STAND-BY.

To empty the internal circuit completely of water, press the MODE and FAN buttons simultaneously for a number of seconds without removing the tank.

The water in the internal circuit will drain into the tank or through the continuous drain hose if connected.

Make sure the other end of the hose is near a suitable drain.

When completely drained, disconnect the continuous drain hose.

Clean the filters and dry thoroughly before putting them back.

TROUBLESHOOTING

PROBLEM	CAUSE	SOLUTION
The air conditioner does not come on	<ul style="list-style-type: none"> no electricity it is not plugged into the outlet the internal safety device has tripped the safety device of the plug has tripped. 	<ul style="list-style-type: none"> restore electricity plug into the outlet wait 30 minutes, if the problem persists contact your service center reset the safety plug
The air conditioner works for a short time only	<ul style="list-style-type: none"> there are bends or kinks in the air exhaust hose something is preventing the air from being discharged 	<ul style="list-style-type: none"> position the air hose correctly, keeping it as short and free of curves as possible to avoid bottlenecks check and remove any obstacles obstructing air discharge
The air conditioner works, but does not cool the room	<ul style="list-style-type: none"> windows, doors and/or curtains open there are heat sources in the room (oven, hairdryer, etc) the air exhaust hose is detached from the appliance silver ion and 3M® filter clogged the technical specification of the appliance is not adequate for the room in which it is located. 	<ul style="list-style-type: none"> close doors, windows and curtains, bearing in mind the "TIPS FOR CORRECT USE" given above eliminate the heat sources fit the air exhaust hose in the housing at the back of the appliance (fig. 1) clean the filters as described above
During operation, there is an unpleasant smell in the room	<ul style="list-style-type: none"> silver ion and 3M® filter clogged. 	<ul style="list-style-type: none"> clean the filters as described above
The air conditioner does not operate for about three minutes after restarting it	<ul style="list-style-type: none"> the internal compressor safety device prevents the appliance from being restarted until three minutes have elapsed since it was last turned off. 	<ul style="list-style-type: none"> wait. This delay is part of normal operation.
The following message appears on the display: <i>LT/FT/PF/FI</i>	<ul style="list-style-type: none"> The appliance has a self diagnosis system to identify a number of malfunctions. 	<ul style="list-style-type: none"> See the SELF-DIAGNOSIS chapter.

TECHNICAL SPECIFICATIONS

Outlet voltage	see rating plate
Maximum absorbed power in air conditioning	“
Maximum absorbed power in heating	“
Refrigerant	“
Cooling capacity	“
Heating power	“

LIMIT CONDITIONS

Temperature of room in air conditioning	70-95°F (21-35°C)
Temperature of room in heating	50-81°F (10÷27°C)

Transport, filling, cleaning, recovery and disposal of refrigerant should be performed by a technical service centre appointed by the manufacturer only.
The applianceshouldbedisposedofbyaspecialist centre appointed by the manufacturer only.

NEVER TRANSPORT OR TURN THE APPLIANCE UPSIDE DOWN OR ON ITS SIDE. IF THIS OCCURS, WAIT 6 HOURS BEFORE TURNING THE APPLIANCE ON, 24 HOURS IS RECOMMENDED. After the unit has been on its side, oil needs to return to the compressor to ensure proper function. Without allowing the unit this time (6-24 hours) The unit may function for only a short time, and then the compressor will break down from lack of oil.

This appliance is equipped with a 3 prong grounded plug. The plug must be connected into an outlet that is properly installed and grounded in the accordance with all local codes and ordinances. Do not modify the plug provided with the appliance. If it will not fit the outlet, have a proper outlet installed by a qualified electrician or relocate the unit to a proper outlet. If the household electrical supply does not meet the above specifications, or if you are not sure your home has an effective electrical ground, have a qualified electrician or your local electrical utility company check it and correct any problems.

SAFETY PLUG

The appliance is fitted with a safety plug to protect the power cable. If power is cut off, unplug from the outlet and make sure the power cable is undamaged. If the cable is damaged, call the service center immediately. If power cuts off frequently and the power cable is undamaged, contact a qualified electrician.

OPERATION OF THE SAFETY PLUG

If the safety device incorporated in the plug trips and cuts off the power supply, check that the power cable and plug are not damaged. If the power cable is undamaged, to restore operation press the “RESET” button. To verify correct operation of the plug, press the “TEST” button periodically and make sure the appliance disconnects. If this is not the case, contact the service center. To restore operation, press the “RESET” button.

This warranty applies to all home appliances with De'Longhi or Kenwood brand names.

FOR CONTIGUOUS UNITED STATES ONLY

Limited Warranty

We warrant each De'Longhi appliance to be free from defects in material and workmanship. From the purchase date, our obligation under this warranty is to provide two (2) year free parts and labor on the entire appliance, with an additional four (4) years free on any part of the sealed system consisting of the compressor, evaporator, condenser and factory connected refrigerant tubing. Labor and all other parts during the additional four (4) year warranty are to be paid by the owner. All appliances in need of repair are to be shipped to an authorized De'Longhi service center at the owner's expense, and De'Longhi will then incur the return shipping costs. After the first six (6) years of ownership, all expenses (all parts, labor and shipping) are to be paid by the owner of the unit. This warranty shall apply only if the appliance is used in accordance with the factory directions that accompany it, and on an Alternating Current (AC) circuit. This warranty is in lieu of all other warranties and representations, expressed or implied, and all other obligations or liabilities on our part. We do not authorize any other person or company to assume for us any liability in connection with the sale or use of our appliance. This warranty shall not apply to any appliance that has been repaired or altered outside our factory nor shall it apply to any appliance that has been subjected to misuse, negligence or accidents.

If repairs become necessary, see contact information below:

U.S. Residents:

Please contact our toll free hotline at 1-800-322-3848 or log onto our website at www.delonghi.com.

For all accessories, spare parts or replacement parts, please contact our parts division at 1-800-865-6330.

Residents of Canada:

Please contact our toll free hotline at 1-888-335-6644 or log onto our website at www.delonghi.com.

Other countries:

Please visit: www.delonghi.com.