

Warnings

- This appliance is designed for home air conditioning and must not be used for other purposes.
- It is dangerous to modify or alter the characteristics of the appliance in any way.
- The appliance must be installed in conformity with national legislation regulating electrical equipment and installations.
- If the appliance requires repair, contact a Service Centre authorised by the manufacturer only. Repairs carried out by unauthorised personnel may be dangerous.
- If the power cable is damaged, it must be replaced by a qualified professional authorised by the manufacturer only.
- This appliance must be used exclusively by adults.
- The appliance is not intended for use by persons (including children) with reduced physical, sensory or mental capabilities, or lack of experience and knowledge, unless they have been given supervision or instruction concerning use of the appliance by a person responsible for their safety. Children should be supervised to ensure that they do not play with the appliance.
- The appliance must be connected to an efficient earth system. Have your electrical circuit checked by a qualified electrician.
- Do not use extension cables.
- Before cleaning or maintenance, always unplug the appliance from the mains socket.
- Do not move the appliance by pulling the power cable.
- Do not install the appliance in rooms containing gas, oil or sulphur. Do not install near sources of heat.
- Do not rest heavy or hot objects on top of the appliance.
- Clean the air filter at least once a week.
- Avoid using heating appliances near the air conditioner.
- Always transport the appliance upright or resting on one side.
- Use the appliance as described in this instruction manual only. As with all electrical equipment, whilst the instructions aim to cover as many eventualities as possible, caution and common sense should be applied when operating and installing this appliance.
- At the end of its working life, consign the appliance to a specialist collection centre.
- The materials used for packaging can be recycled. You are therefore recommended to dispose of them in special differentiated waste collection containers.
- When putting the appliance away, do not cover with plastic bags.
- Keep the appliance at least 50 cm away from flammable substances (alcohol etc) or pressurised containers (e.g. aerosol cans).

DESCRIPTION

- | | |
|--------------------------------|---|
| 1 control panel | 10 flange with cap |
| 2 air outlet grille | 11 suckers |
| 3 castors | 12 air exhaust hose |
| 4 handles | 13 window outlet |
| 5 filter | 14 castor locks |
| 6 evaporator air intake grille | 15 window bracket |
| 7 air exhaust hose housing | 16 window bracket extension (only on some models) |
| 8 condensate drain connection | 17 remote control unit (certain models only) |
| 9 power cable | |

What is Pinguino?

During the summer, you feel comfortable at a temperature of between 24 and 27° C with a relative humidity of about 50%.

An air conditioner removes excess moisture and heat from the room where it is located.

Compared with installed models, portable air conditioners have the advantage that they can be moved from one room to another in the home or be transported from one building to another.

Hot air from the room is passed through a heat exchanger cooled by refrigerant gas. Excess heat and moisture are removed from the air which is then re-emitted into the room cooler and dryer.

In single unit models, a small part of this air is used to cool the refrigerant gas and then, when hot and damp, is discharged outside.

In models with outdoor unit, the circuit is cooled using air from outside.

All Pinguino models can also be used in fan-only mode.

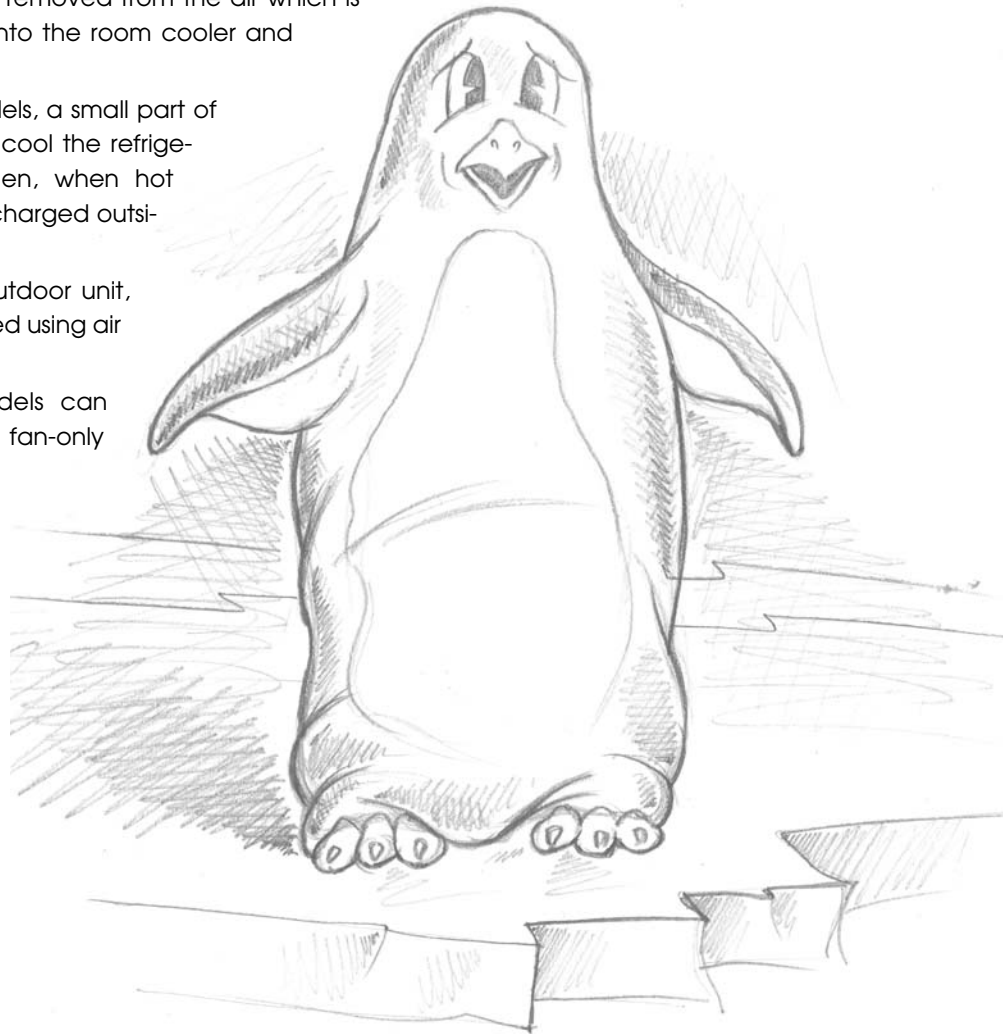

Preparing for use

ELECTRICAL CONNECTIONS

Before plugging the appliance into the mains socket, check that:

- the mains power supply corresponds to the value indicated on the rating plate on the back of the appliance;
- the power socket and electrical circuit are adequate for the appliance.
- the mains socket matches the plug. If this is not the case, have the plug replaced;
- the mains socket is adequately earthed. Failure to follow these important safety instructions absolves the manufacturer of all liability.

The power cable must be replaced by a qualified professional only.

The instructions below will enable you to prepare your air conditioner for operation as efficiently as possible.

Before use, make sure the air intake and outlet grilles are unobstructed.

AIR-CONDITIONING WITHOUT INSTALLATION

Just a few simple steps and your comfort is ensured with Pinguino:

- Fit the air exhaust hose **12** in the housing **7** at the back of the appliance. Insert as shown in figure **A**.

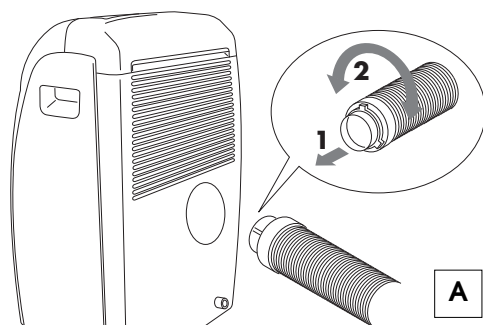

- Fit the window outlet **13** to the end of the hose **12**.
- Place the air conditioner near a window or French window.
- Make sure the air exhaust hose is unobstructed.
- Open the window or French window slightly and position the outlet **13** as shown in figure **B**.

Keep the air hoses as short and free of curves as possible to avoid bottlenecks.

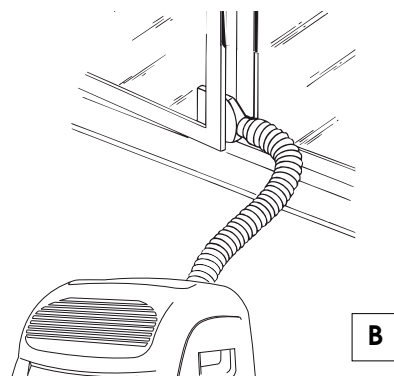

- If you have a double window, use the suckers **11** provided to hold the two parts of the window together (fig. **C**).

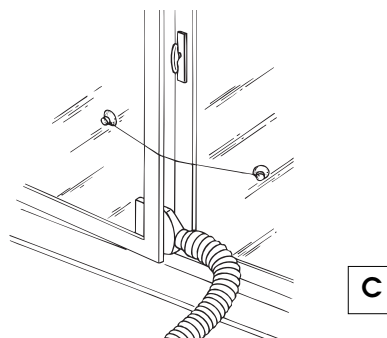

You can also use the "**adjustable bar**" accessory.

- Position the bar on the window sill and adjust until it fits in the guides of the blind (the length can be blocked with the plastic pin provided), then lower the blind
- Fit the air hose to the end of the window outlet.
- Place the air conditioner near a window or French window and connect the end of the hose as shown in figure **D**.

Preparing for use

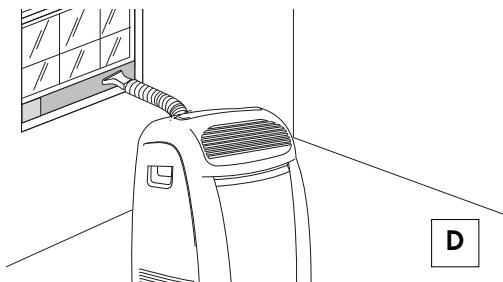

- If the windows are large, use the window bracket extension (16) (if provided) to cover your window aperture, extending it to the required length, then blocking it with the locking pins supplied (see figure E). Make sure you do not cover the hole for the window outlet.

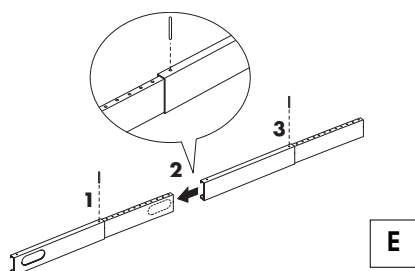

AIR-CONDITIONING WITH INSTALLATION

If required, the Pinguino can also be installed semi-permanently (Fig. F).

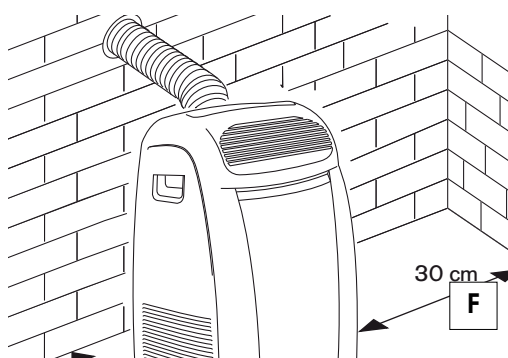

Proceed as follows:

- Drill a hole in an outside wall or through a window pane. Respect the height and dimensions of the hole as given in figures G and H.

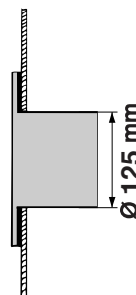

in the window pane



in the wooden kick-board of a French window

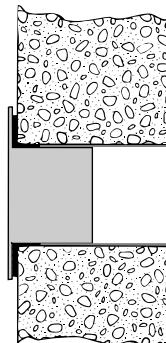

in the wall: you are recommended to insulate the section of wall using suitable insulation.

G

Keep the air hoses as short and free of curves as possible to avoid bottlenecks.

- Fit the flange accessory provided 10 in the hole
- Fit the end of the hose 12 to the flange 10 as shown in fig. F.

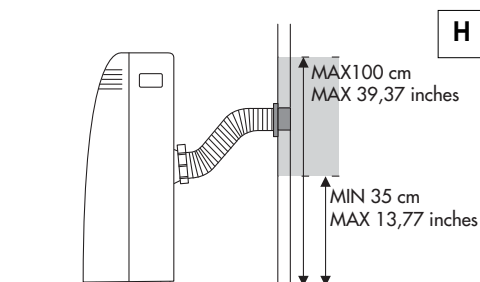

H

When the hose 12 is not fitted, the hole can be closed with the flange cap 10.

NOTE:

When installing the air conditioner semi-permanently, you should leave a door slightly open (as little as 1 cm) to guarantee correct ventilation.

Control panel

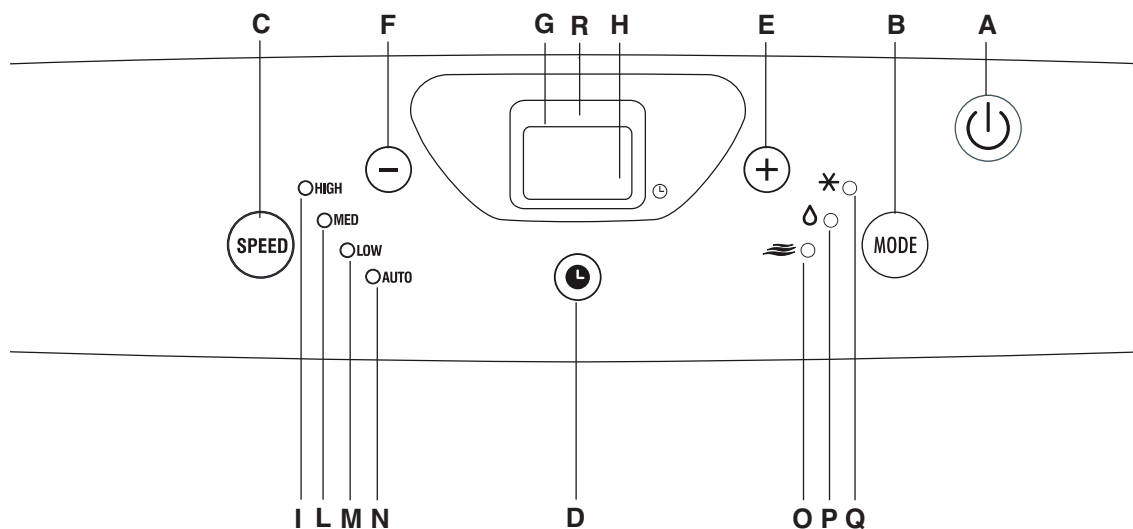

DESCRIPTION OF THE CONTROL PANEL

- A** ON/STAND-BY button
- B** **MODE selection** button
Air conditioning, dehumidifying, fan
- C** **FAN speed** selection button
- D** **Timer** button
- E** **Programmed operation increase temperature/time** button
- F** **Programmed operation decrease temperature/time** button
- G** **Display** showing the temperature values set and the programmed operating time
- H** **Timer in operation** light
- I/L/M/N** **Fan speed** and **AUTO mode** lights
- O** **Fan mode** light
- P** **Dehumidifying mode** light
- Q** **Air-conditioning mode** light
- R** **Remote control** receiver

Operating from the control panel

TURNING THE APPLIANCE ON

Plug into the mains socket.

Two lines appear on the display indicating that the appliance is in stand-by.

Press the **ON/STAND-BY** button (A). When turned on, the air conditioner starts operating in the same mode as when it was turned off.

Press the **MODE** button (B) until the light corresponding to the required mode lights up:

Light (Q) ✕ : air-conditioning mode

Light (P) ∇ : dehumidifying mode

Light (O) ≡ : fan mode



AIR-CONDITIONING MODE

Ideal for hot muggy weather when you need to cool and dehumidify the room.

To set operation of the appliance correctly, press the + (E) or - (F) buttons until the desired temperature is displayed.

Then select the fan speed by pressing the FAN button (C) until the light corresponding to the required fan speed lights up:

HIGH: the air conditioner operates at maximum to reach the required temperature as rapidly as possible

MED: reduces noise levels but still maintains a good level of comfort

LOW: for silent operation

AUTO: the appliance automatically selects the most suitable fan speed in relation to the temperature set on the digital display.



The most suitable temperature for the room during the summer varies from 24 to 27°C. You are recommended, however, not to set a temperature much below the outdoor temperature.

Operating from the control panel

DEHUMIDIFYING MODE

Ideal for reducing humidity in spring and autumn, during rainy spells or in damp rooms, etc.

In dehumidifying mode, the appliance must have the same configuration as for the air conditioning mode, with the air exhaust hose fitted to the appliance to allow air to be discharged externally.

For instructions on preparing for use, see the section "Air conditioning without installation" (page 21). When the dehumidifying mode is selected, the light (P) comes on and " dh " appears on the display.

At the same time, the **AUTO** fan light (N) comes on. In this mode, other speeds cannot be selected.



FAN MODE

Adjust fan speed by pressing the **FAN** button (C) as described for the air-conditioning mode.

In this mode, **AUTO** cannot be selected.

The fan speed selected will be displayed.

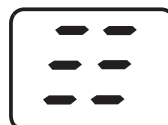

SETTING THE TIMER

The timer can be used to delay appliance start up or shutdown. This avoids wasting electricity by optimising operating periods.

How to programme delayed start up

- Plug the appliance into a mains socket and press the **ON/STAND-BY** button (A), then select the required operating mode and other settings (temperature, fan speed, etc).
- Press the **ON/STAND-BY** button (A) again: The appliance switches to stand-by mode (the two central segments are displayed).
- Press the **TIMER** button (D). The last timer setting or the preset value 5.0 flashes on the display.
- Use the + (E) or - (F) buttons to set the number of hours delay before the appliance comes on. During the first ten hours, you can select half hour intervals. For times greater than ten hours, one hour intervals can be selected. If the + (E) or - (F) buttons are pressed for more than 2 seconds, the time runs rapidly up to a maximum of 24 hours. Press the timer button again within a few seconds to confirm the setting. If the setting is not confirmed within a few seconds, the display resets to stand-by. With the timer activated, the countdown before the programmed start up time is displayed and the light (H) flashes.

To cancel the timer programme, press the timer button (D) again.

How to programme delayed shutdown

- Delayed shutdown can be programmed in any operating mode (air conditioning/dehumidifying/fan).
- Press the **TIMER** button (D). The last timer setting or the preset value 5.0 flashes on the display.
- Use the + (E) or - (F) button to set the number of hours delay before the appliance goes off. During the first ten hours, you can select half hour intervals. For times greater than ten hours, one hour intervals can be selected.
If the + (E) or - (F) buttons are pressed for more than 2 seconds, the time runs rapidly up to a maximum of 24 hours.

Press the timer button again within a few seconds to confirm the setting.

When the timer is set, the light (H) flashes.

At the set time, the air conditioner shuts down and remains in stand-by.

To cancel the timer programme, press the timer button (D) again.

Self-diagnosis

SELF-DIAGNOSIS

The appliance has a self diagnosis system to identify a number of malfunctions.

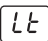
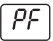
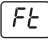
IF ... IS DISPLAYED	...WHAT SHOULD YOU DO?
 LOW TEMPERATURE (frost prevention)	When the appliance is operating in dehumidifying mode, this device prevents the formation of ice. The appliance starts up again automatically when the defrosting process is completed.
 PROBE FAILURE (sensor damaged)	If this is displayed, contact your local authorised service centre.
 FULL TANK	Empty the internal tank, see page 31 "End of season operations"

Using the remote control unit (Certain models only)

CORRECT USE OF THE REMOTE CONTROL

- Point the remote control at the receiver (R) on the air conditioner.
- Maximum distance: around 7 metres (without any obstacles between the remote control and the receiver).
- The remote control should be handled with **extreme care**. Do not drop it, expose it to direct sunlight, or sources of heat.

DESCRIPTION OF THE REMOTE CONTROL

- 18) FAN button
- 19) ON/OFF button
- 20) MODE button
- 21) TIMER button
- 22) Display

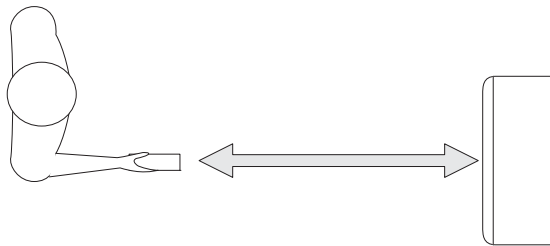

Inserting or replacing the batteries

- Remove the cover on the rear of the remote control;
- Remove the flat batteries if present.
- Insert two R03 AAA 1.5V batteries, making sure they are in the correct position (see the instructions inside the battery compartment);
- Replace the cover.

If the remote control unit is replaced or discarded, the batteries must be removed and disposed of in accordance with current legislation as they are harmful to the environment.

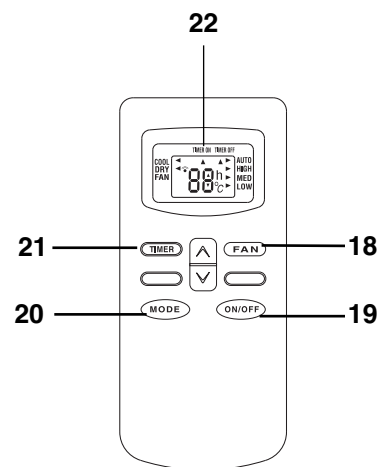

Using the remote control unit

TURNING THE APPLIANCE ON

Plug into the mains socket.

Press the **ON/OFF** button **19** (when turned on, the air conditioner starts operating in the same mode as when it was turned off).

Press the **MODE 20** button to select the required mode

AIR-CONDITIONING (COOL)

DEHUMIDIFYING (DRY)

FAN ONLY (FAN)

An arrow on the display indicates the selected mode.

AIR-CONDITIONING MODE (COOL)

Ideal for hot humid weather when you need to cool and dehumidify the room.

In air-conditioning mode, use the  buttons to select the desired temperature.

The display shows the set temperature.

To change the fan speed, use the **FAN** button **18** on the remote control, choosing from the available speeds:

AUTO: the appliance automatically selects the most suitable fan speed in relation to the temperature set on the digital display.

HIGH: the air conditioner operates at maximum to reach the required temperature as rapidly as possible

MED: reduces noise levels but still maintains a good level of comfort

LOW: for silent operation

Two arrows on the display indicate respectively COOL and the fan speed.

The most suitable temperature for the room during the summer varies from 24 to 27°C. You are recommended, however, not to set a temperature much below the outdoor temperature.

DEHUMIDIFYING MODE (DRY)

Ideal to reduce room humidity while avoiding temperature variations (spring and autumn, damp rooms, rainy periods, etc).

In dehumidifying mode, the appliance selects fan speed automatically.

Two arrows on the remote control display indicate DRY and AUTO respectively.

FAN MODE ONLY (FAN)

In fan mode, fan speed can be set by pressing the **FAN** button **18**.

The fan speed changes between the speeds available (LOW/MED/HIGH).

Two arrows on the display indicate FAN mode and the speed set.

In this mode, AUTO speed cannot be selected.

SETTING THE TIMER

The timer can be used to delay appliance start up or shutdown. This avoids wasting electricity by optimising operating periods.

How to programme delayed shutdown

- With the air-conditioning unit on, press the **TIMER** button **21**. The time is displayed and the "h" symbol flashes, with a flashing arrow indicating TIMER OFF.
- Set the time when you want the appliance to go off using the  buttons (from 30 minutes to 24 hours). During the first ten hours, you can select half hour intervals. For times greater than ten hours, one hour intervals can be selected.
- Press the **TIMER** button again to confirm the selection. The appliance emits a beep and the light **(H)** flashes on the control panel, confirming successful activation of the timer. A count-down of the time left is displayed on the remote control display and the light **(H)** flashes on the air conditioner display.
- At the end of the set time the appliance switches off automatically.

Using the remote control unit

- To cancel the timer programme, press the **TIMER** button again. The appliance emits a beep and both displays reset to display the settings prior to activation of the timer.

How to programme delayed start up

- With the air conditioner off, press the **TIMER** button. An arrow indicating **TIMER ON** flashes on the display. Now make all the desired settings for when the appliance will switch on (operating mode, fan speed and temperature). Confirm the settings by pressing the **TIMER** button. The time is displayed and the "h" symbol flashes.
Set the time when you want the appliance to switch off using the buttons  (from 30 minutes to 24 hours).
During the first ten hours, you can select half hour intervals. For times greater than ten hours, one hour intervals can be selected.
- Press the **TIMER** button again to confirm the start-up time. **A beep sounds and the time set is also displayed** on the control panel, confirming setting of the timer. The light (H) flashes on the air conditioner display. A countdown of the time left is displayed on both displays.
- At the end of the set time the appliance switches on automatically, with the settings made previously.
- To cancel the timer programme, press the **TIMER** button again. The appliance emits a beep and both displays reset to stand-by.

Tips

To get the best from your air conditioner, follow these recommendations:

- close the windows and doors in the room to be air conditioned. The only exception is when the appliance is installed through a hole in the wall. In this case, you are recommended to leave a slight draught through a door or window to guarantee correct ventilation.
- Never use the appliance in very damp rooms (laundries for example).
- Never use the appliance outdoors.

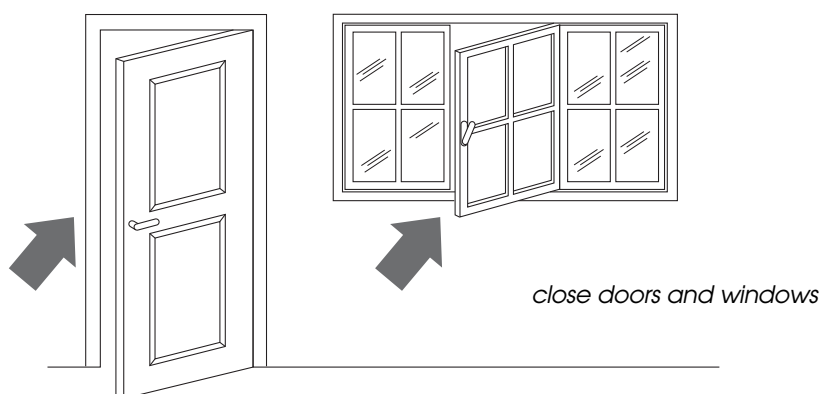

- Protect the room from direct exposure to the sun by partially closing curtains and/or blinds to make the appliance much more economical to run;
- Never rest objects of any kind on the air conditioner;
- Never obstruct the air intake **6** or outlet **2**;
- Make sure there are no heat sources in the room.

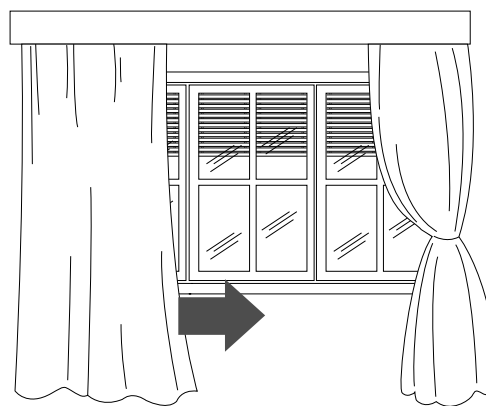
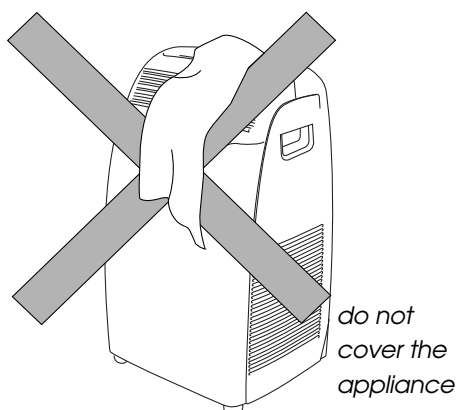

close blinds or curtains

- Make sure the air conditioner is standing on a level surface. If necessary, place the two castor locks **14** under the front wheels **3**.

Cleaning

Before cleaning or maintenance, turn the appliance off by pressing the ON/STAND-BY button (A) or in models with remote control unit, by pressing the ON/OFF button, then always unplug the appliance from the mains socket.

CLEANING THE CABINET

You should clean the appliance with a slightly damp cloth then dry with a dry cloth. For safety reasons, never wash the air conditioner with water.

Precautions

Never use petrol, alcohol or solvents to clean the appliance. Never spray insecticide liquids or similar.

CLEANING THE AIR PURIFYING FILTERS

To keep your air conditioner working efficiently, you should clean the dust filter every week of operation.

The filter is housed in the intake grille.

To clean the filters, proceed as follows

1. Remove the dust filter by extracting it upwards (figures I and L).

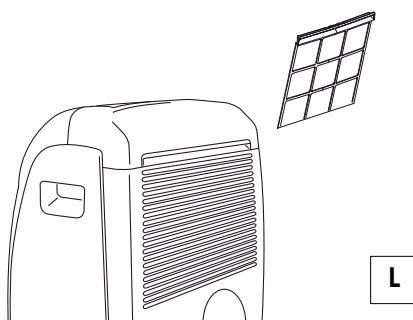
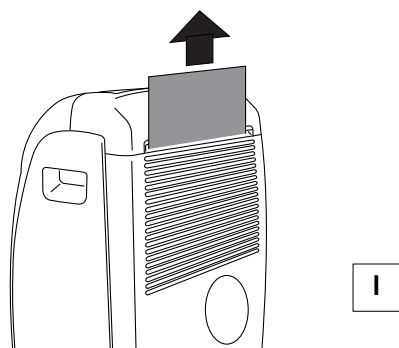

2. Use a vacuum cleaner to remove dust accumulations from the filter. If it is very dirty, immerse in warm water and rinse a number of times. The water should never be hotter than 40°C. After washing, leave the filter to dry, then put back in place.

START OF SEASON CHECKS

Make sure the power cable and plug are undamaged and the earth system is efficient.

END OF SEASON OPERATIONS

To empty the internal circuit completely of water, remove the cap (figure M)

Run off all water left into a basin. When all the water has been drained, put the cap back in place.

Clean the filter and dry thoroughly before putting back.

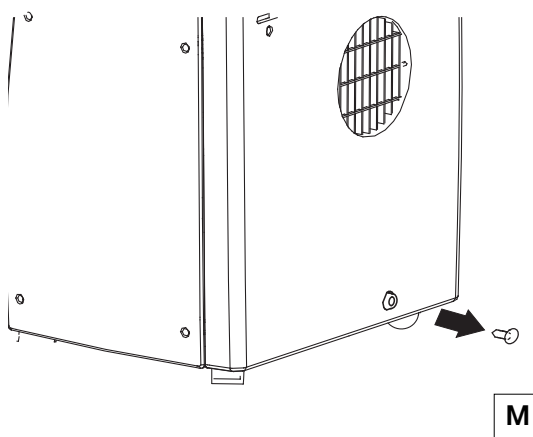

Troubleshooting

PROBLEM	CAUSE	REMEDY
The air conditioner does not come on	<ul style="list-style-type: none"> there is no current it is not plugged into the mains The safety device has tripped 	<ul style="list-style-type: none"> wait plug into the mains Contact your service centre
The air conditioner works for a short time only	<ul style="list-style-type: none"> the air exhaust hose has a constriction the air exhaust hose is blocked there are bends in the air exhaust hose 	<ul style="list-style-type: none"> position the exhaust hose correctly check there are no obstacles obstructing air discharge eliminate the bends
The air conditioner works, but does not cool the room	<ul style="list-style-type: none"> window open there are heat sources in the room (burner, lamp, etc) the exhaust hose is detached air filter clogged the air conditioner is not powerful enough for the conditions or size of the room 	<ul style="list-style-type: none"> close the window eliminate the heat source connect the exhaust hose clean or replace the filter
Particular odour in the room	<ul style="list-style-type: none"> the filter is clogged 	<ul style="list-style-type: none"> clean or replace the filter
The air conditioner does not operate for about 3 minutes after turning it on	<ul style="list-style-type: none"> The safety device has tripped 	<ul style="list-style-type: none"> wait for three minutes
LL / PF / FL appears on the display	<ul style="list-style-type: none"> See self-diagnosis section 	

ELECTRICAL CONNECTION (UK ONLY)

- A) If your appliance comes fitted with a plug, it will incorporate a 13 Amp fuse. If it does not fit your socket, the plug should be cut off from the mains lead, and an appropriate plug fitted, as below.
WARNING: Very carefully dispose of the cut off plug after removing the fuse: do not insert in a 13 Amp socket elsewhere in the house as this could cause a shock hazard.
 With alternative plugs not incorporating a fuse, the circuit must be protected by a 15 Amp fuse.

WARNING - THIS APPLIANCE MUST BE EARTHED **IMPORTANT**

The wires in the mains lead are coloured in accordance with the following code:

Green and yellow:	Earth
Blue:	Neutral
Brown:	Live



- If the plug is a moulded-on type, the fuse cover must be re-fitted when changing the fuse using a 13 Amp Asta approved fuse to BS 1362. In the event of losing the fuse cover, the plug must NOT be used until a replacement fuse cover can be obtained from your nearest electrical dealer. The colour of the correct replacement fuse cover is that as marked on the base of the plug.
- B) If your appliance is not fitted with a plug, please follow the instructions provided below:

As the colours of the wires in the mains lead may not correspond with the coloured markings identifying the terminals in your plug, proceed as follows:

The green and yellow wire must be connected to the terminal in the plug marked with the letter E or the earth symbol  or coloured green or green and yellow.
 The blue wire must be connected to the terminal marked with the letter N or coloured black.
 The brown wire must be connected to the terminal marked with the letter L or coloured red.

Guarantee/technical specification

GUARANTEE AND TECHNICAL ASSISTANCE

The conditions of the guarantee and technical assistance are given on the certificate supplied with your appliance.

TECHNICAL CHARACTERISTICS

Power supply voltage	see rating plate
Max. power input during air conditioning	"
Refrigerant	"
Cooling capacity	"

LIMIT CONDITIONS

Room temperature for air conditioning	21 ÷ 35°C
---------------------------------------	-----------

Dimensions of appliance:

• width	463 mm
• height	773 mm
• depth	372 mm
• weight	30 kg

Transport, filling, cleaning, recovery and disposal of refrigerant should be performed by a technical service centre appointed by the manufacturer only.

The appliance should be disposed of by a specialist centre appointed by the manufacturer only.