

IMPORTANT SAFEGUARDS

- Use this appliance only as described in this instruction manual. As with all electrical equipment, whilst the instructions aim to cover as many eventualities as possible, caution and common sense should be applied when operating and installing this appliance.
- This appliance is designed for home air conditioning and must not be used for other purposes.
- It is dangerous to modify or alter the characteristics of the appliance in any way.
- The appliance must be installed in conformity with national legislation regulating electrical equipment and installations.
- If the appliance requires repair, contact a Service Centre authorised by the manufacturer only. Repairs carried out by unauthorised personnel may be dangerous.
- This appliance must be used exclusively by adults.
- Never allow the appliance to be used by people (including children) with psychological, physical or sensory impairments or with insufficient experience and knowledge, unless closely supervised and instructed by someone responsible for their safety. Young children should be supervised to ensure that they do not play with the appliance.
- The appliance must be connected to an efficient earth system. Have your electrical circuit checked by a qualified electrician.
- Do not use extension cables.
- Before cleaning or maintenance, always unplug the appliance from the mains socket.
- Never unplug the appliance by pulling on the power cable.
- Do not install the appliance in rooms containing gas, oil or sulphur. Do not install near sources of heat.
- Keep the appliance at least 50 cm away from flammable substances (alcohol etc) or pressurised containers (eg aerosol cans).
- Do not rest heavy or hot objects on top of the appliance.
- Clean the air filter at least once a week.
- Avoid using heating appliances near the air conditioner.
- Always transport the appliance upright or resting on one side. Before moving the appliance, empty the internal circuit completely of water. After moving the appliance, wait at least 1 hour before starting it.
- When putting the appliance away, do not cover with plastic bags.
- The materials used for packaging can be recycled. You are therefore recommended to dispose of them in special differentiated waste collection containers.
- At the end of its working life, consign the appliance to a specialist collection centre.
- If the power cable is damaged, it must be replaced by the manufacturer or an authorised technical service centre in order to avoid all risk.
- R410A refrigerant gas conforms to EC regulations on the environment. Avoid perforating the refrigerant circuit of the appliance.
- **ENVIRONMENTAL INFORMATION:** This unit contains fluorinated greenhouse gases covered by the Kyoto Protocol. Maintenance and disposal must be carried out by qualified personnel only (R410A, GWP=1975).

Important information for correct disposal of the product in accordance with EC Directive 2002/96/EC.



At the end of its working life, the product must not be disposed of as urban waste. It must be taken to a special local authority differentiated waste collection centre or to a dealer providing this service. Disposing of a household appliance separately avoids possible negative consequences for the environment and health deriving from inappropriate disposal and enables the constituent materials to be recovered to obtain significant savings in energy and resources. As a reminder of the need to dispose of household appliances separately, the product is marked with a crossed-out wheeled dustbin.

ELECTRICAL CONNECTIONS

Before plugging the appliance into the mains socket, check that:

- the mains power supply corresponds to the value indicated on the rating plate on the back of the appliance;
- the power socket and electrical circuit are adequate for the appliance.
- the mains socket matches the plug. If this is not the case, have the plug replaced;
- the mains socket is adequately earthed. **Failure to follow these important safety instructions absolves the manufacturer of all liability.**

WHAT IS THE PINGUINO

During the summer, you feel comfortable at a temperature of between 24 and 27° C with a relative humidity of about 50%.

An air conditioner removes excess moisture and heat from the room where it is located. Compared with installed models, portable air conditioners have the advantage that they can be moved from one room to another in the home or be transported from one building to another.

Hot air from the room is passed through a heat exchanger cooled by refrigerant gas. Excess heat and moisture are removed before the air is re-emitted into the room.

In single unit models, a small part of this air is used to cool the refrigerant gas and then, when hot and damp, is discharged outside.

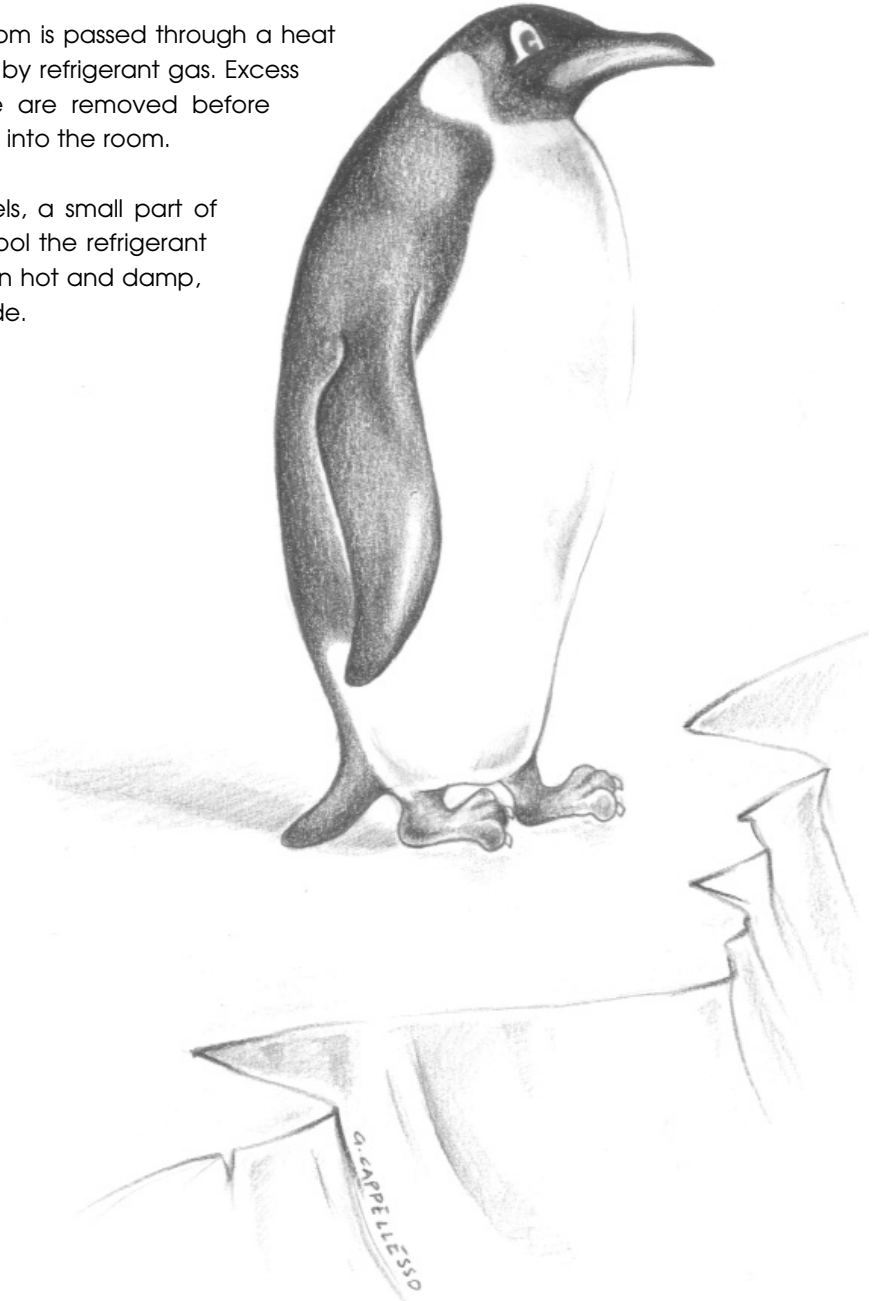

DESCRIPTION

- 1 air outlet grille
- 2 control panel
- 3 castors
- 4 handles
- 5 filter
- 6 intake grille
- 7 air exhaust hose housing
- 8 condensate drain
- 9 power cable
- 10 flange cap
- 11 air exhaust hose
- 12 window outlet
- 13 suckers
- 14 castor locks
- 15 remote control

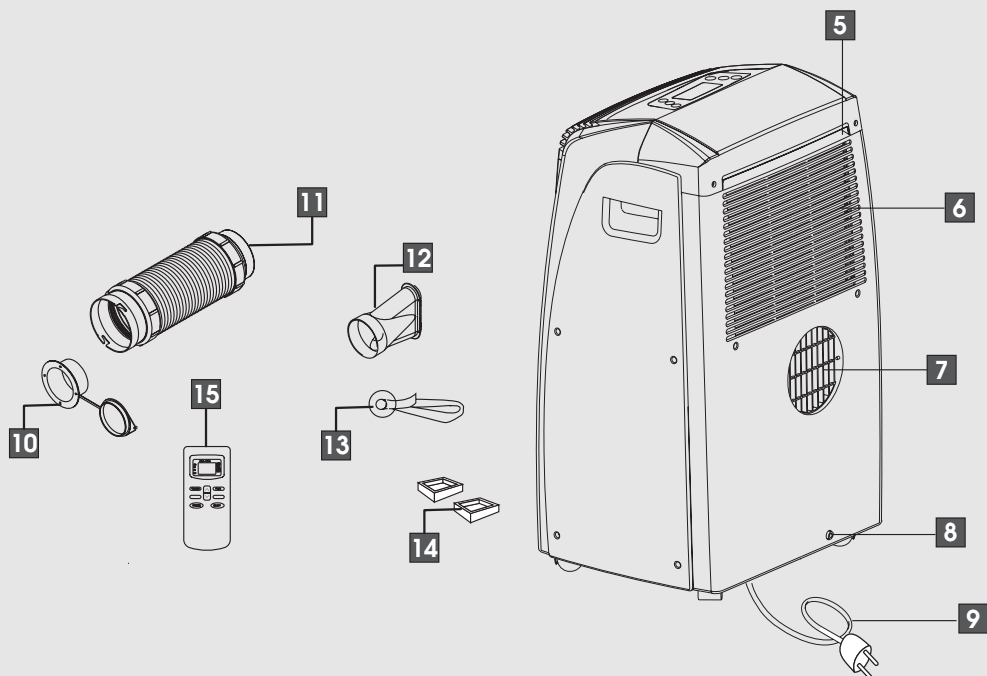
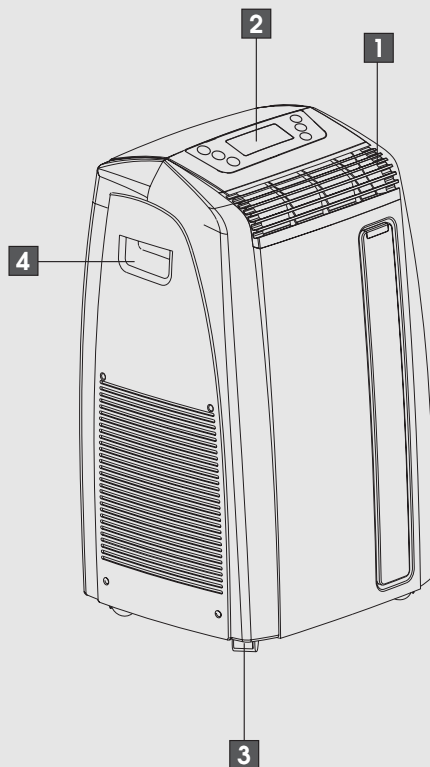

PREPARING FOR USE

The instructions below will enable you to prepare your air conditioner for operation as efficiently as possible.

Before use, make sure the air intake and outlet grilles are unobstructed.

AIR-CONDITIONING WITHOUT INSTALLATION

Just a few simple steps and your comfort is ensured with your appliance:

- Fit the air exhaust hose in the housing at the back of the appliance (fig. 1).
- Fit the window outlet to the end of the hose.
- Place the air conditioner near a window or French window.
- Adjust the length of the hose to reach the window.
- Make sure the air exhaust hose is unobstructed.
- Open the window or French window slightly and position the outlet (fig. 2).
- If you have a double window, use the sucker provided to hold the two parts of the window together (fig. 3).

Keep the air hose as short and free of curves as possible to avoid bottlenecks.

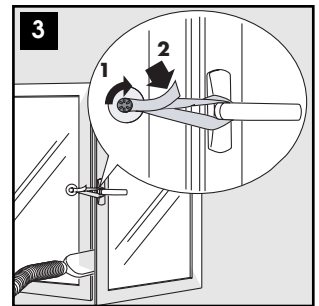
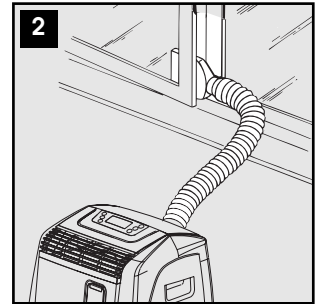
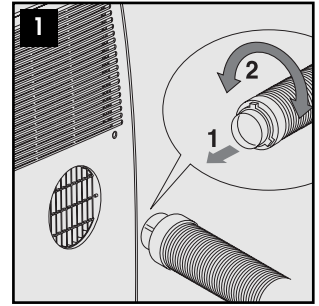

AIR-CONDITIONING WITH INSTALLATION

If required, your appliance can also be installed semi-permanently (Fig. 4).

Proceed as follows:

- Drill in an outside wall or in the window pane a 134 mm dia. hole respecting the heights shown in fig. 5.

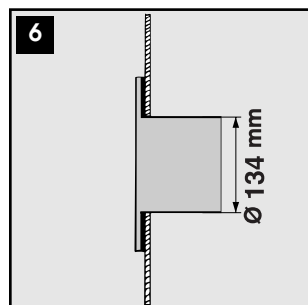
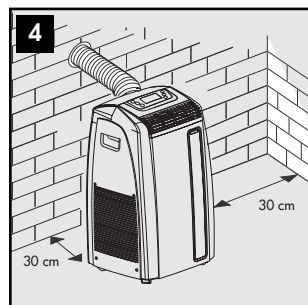
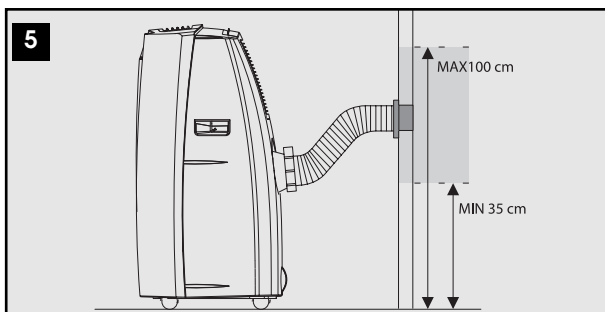

in the window pane

- Fit the flange accessory provided in the hole **following the indications in figs. 6, 7 and 8.**
- Fit the hose in the housing at the back of the appliance (fig. 1).
- Fit the end of the hose to the flange as shown in fig. 5. When the hose is not fitted, the hole can be closed with the flange cap.

Keep the air hose as short and free of curves as possible to avoid bottlenecks.

- ✓ When installing the air conditioner semi-permanently, you should leave a door slightly open (as little as 1 cm) to guarantee correct ventilation.

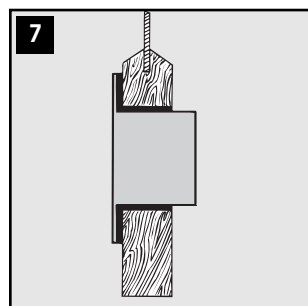

*in the wooden kickboard
of a French window*

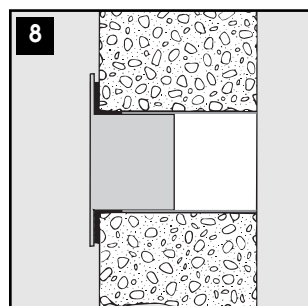

*in the wall: you are
recommended to insulate
the section of wall
using suitable insulation.*

DESCRIPTION OF CONTROL PANEL

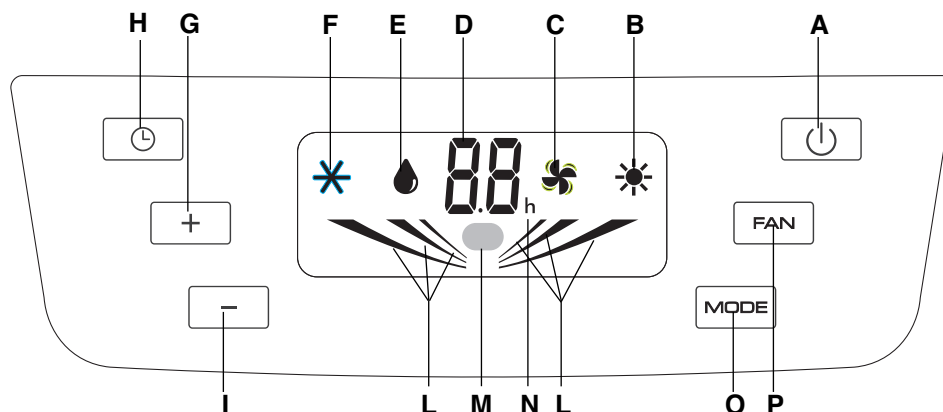

- | | |
|--|---|
| A ON/STAND-BY button | H Timer button |
| B Heating mode light (certain models only) | I Reduce temperature/programmed operating time button |
| C Fan mode light | L Fan speed lights |
| D Display Displays the temperature values set and the programmed operating time | M Remote control receiver |
| E Dehumidifying mode light | N Time indicator |
| F Air conditioning mode light | O MODE selection button |
| G Increase temperature/programmed operating time button | Air conditioning, dehumidifying, fan, heating (certain models only) |
| | P Fan speed selection button |

OPERATING FROM THE CONTROL PANEL

Plug the appliance into the mains.

Two lines appear on the display indicating that the appliance is in stand-by.

Press the **ON/STAND-BY** button (**A**) (when turned on, the air conditioner starts operating in the same mode as when it was turned off). Press the **MODE** button (**O**) until the indicator light corresponding to the required mode lights up:

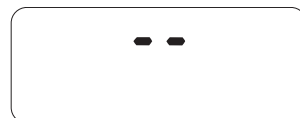

Light (**F**) : air-conditioning mode

Light (**E**) : dehumidifying mode

Light (**C**) : fan mode

AIR-CONDITIONING MODE “✱”

Ideal for hot muggy weather when you need to cool and dehumidify the room.

To set this function correctly, press the **"MODE"** button until the “✱” light comes on, then press the + (**G**) or - (**I**) buttons until the required temperature is displayed.

Then select the fan speed by pressing the **FAN** button (**P**) until the indicator light corresponding to the required fan speed lights up:

 (**HIGH**) the air conditioner operates at maximum to reach the required temperature as rapidly as possible.

 (**MED**) reduces noise levels but still maintains a good level of comfort.

 (**LOW**) for silent operation

AUTO: the appliance automatically selects the most suitable fan speed in relation to the temperature set on the digital display (the graphics on the display move).



The most suitable temperature for the room during the summer varies from 24 to 27°C. You are recommended, however, not to set a temperature much below the outdoor temperature.

DEHUMIDIFYING MODE

Ideal for reducing the humidity in a room without lowering or raising the temperature (spring or autumn, damp rooms, rainy spells, etc).

In dehumidifying mode, the appliance selects fan speed automatically.

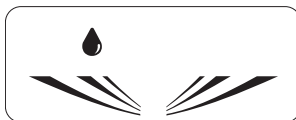

FUNZIONE VENTILAZIONE

Adjust fan speed by pressing the **FAN** button (**P**).

The fan speed selected will be displayed (HIGH, MED, LOW).

In this mode, **AUTO** cannot be selected.



SETTING THE TIMER

The timer can be used to delay appliance start up or shut down.

This avoids wasting electricity by optimising operating periods

How to programme delayed start up

- Plug the appliance into a mains socket and press the **ON/STAND-BY** button (**A**), then select the required operating mode and other settings (temperature, fan speed, etc).
- Press the **ON/STAND-BY** button (**A**) again. The appliance switches to stand-by mode.
- Press the **TIMER** button (**H**): the last timer setting or the preset value 6.0 h flashes on the display. **6.0** h.
- Use the **+** (**G**) or **-** (**I**) buttons to set the number of hours delay before the appliance comes on.

During the first ten hours, you can select half hour intervals.

For times greater than ten hours, one hour intervals can be selected. If the **+** (**G**) or **-** (**I**) buttons are pressed for more than 2 seconds, the time runs rapidly up to a maximum of 24 hours. Press the timer button again within a few seconds to confirm the setting. If the setting is not confirmed within a few seconds, the display resets to stand-by.

With the timer activated, the countdown before the programmed start up time is displayed.

To cancel the timer programme, press the timer button (**H**).

How to programme delayed shutdown

- Delayed shutdown can be set with the appliance in any operating mode - air conditioning/dehumidifying/fan.
- Press the **Timer** button (**H**) the last timer setting or the preset value **6.0** h. flashes on the display.
- Use the **+** (**G**) or **-** (**I**) button to set the number of hours delay before the appliance goes off.

During the first ten hours, you can select half hour intervals.

For times greater than ten hours, one hour intervals can be selected. If the **+** (**G**) or **-** (**I**) buttons are pressed for more than 2 seconds, the time runs rapidly up to a maximum of 24 hours. Press the timer button again within a few seconds to confirm the setting.

At the set time, the air conditioner shuts down and remains in stand-by. To cancel the timer programme, press the timer button (**H**).

SELF-DIAGNOSIS

The appliance has a self diagnosis system to identify a number of malfunctions.

IF ... IS DISPLAYED	...WHAT SHOULD YOU DO?
L_L LOW TEMPERATURE (FROST PREVENTION)	When the appliance is operating in air conditioning or dehumidifying mode, this device prevents the formation of ice. The appliance starts up again automatically when the defrosting process is completed.
PF PROBE FAILURE (SENSOR DAMAGED)	If this is displayed, contact your service centre.
F_L FULL TANK	Empty the internal safety tank, through the drain hose. see page 31 "end of season operations"

USING THE REMOTE CONTROL

CORRECT USE OF THE REMOTE CONTROL

- Point the remote control at the receiver (M) on the air-conditioner.
- Maximum distance: around 7 metres (without any obstacles between the remote control and the receiver).
- The remote control should be handled with **extreme care**. Do not drop it, expose it to direct sunlight, or leave it near sources of heat.

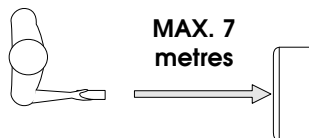

DESCRIPTION OF THE REMOTE CONTROL

- 16) "FAN" button
- 17) "ON/OFF" button
- 18) "MODE" button
- 19) "TIMER" button
- 20) Display

Inserting or replacing the batteries

- Remove the cover on the rear of the remote control;
- Remove the flat batteries if present.
- Insert two new R03 "AAA" 1.5V batteries, inserting them correctly (see the instructions inside the battery compartment);
- Replace the cover.

✓ If the remote control unit is replaced or discarded, the batteries must be removed and disposed of in accordance with current legislation as they are harmful to the environment.

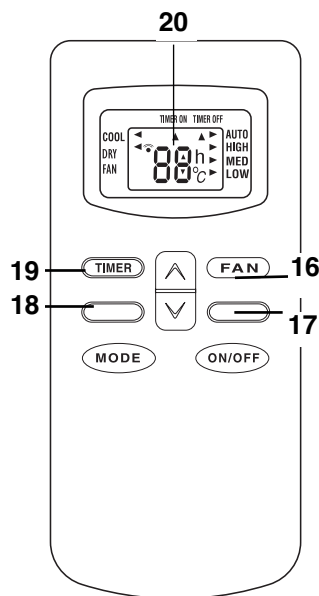

TURNING THE APPLIANCE ON

Plug the appliance into the mains.

Press the **ON/OFF** button (17) (when turned on, the air conditioner starts operating in the same mode as when it was turned off). Press the **MODE** (18) button to select the required mode

AIR-CONDITIONING (COOL)

DEHUMIDIFYING (DRY)

FAN ONLY (FAN)

An arrow on the display indicates the selected mode.

AIR-CONDITIONING MODE (COOL)

Ideal for hot humid weather when you need to cool and dehumidify the room.

In air-conditioning mode, use the buttons to select the desired temperature  .

The display shows the set temperature.

To change the fan speed, use the **FAN** button (16) on the remote control, choosing from the available speeds:

LOW: for silent operation.

MED: reduces noise levels but still maintains a good level of comfort.

HIGH: the air conditioning unit operates at maximum to reach the required temperature as rapidly as possible.

AUTO: the appliance automatically selects the most suitable fan speed in relation to the temperature set on the digital display.

Two arrows on the display indicate respectively "COOL" and the fan speed.

The most suitable temperature for the room during the summer varies from 24 to 27°C. You are recommended, however, not to set a temperature much below the outdoor temperature.

DEHUMIDIFYING MODE

Ideal to reduce room humidity while avoiding temperature variations (spring and autumn, damp rooms, rainy periods, etc).

In dehumidifying mode, the appliance selects fan speed automatically.

Two arrows on the remote control display indicate "**DRY**" and "**AUTO**" respectively.

FAN MODE ONLY (FAN)

In fan mode, fan speed can be set by pressing the **FAN** button (16).

La velocità di ventilazione cambia a rotazione fra quelle disponibili (LOW/MED/HIGH).

Due frecce nel display indicano la funzione "**FAN**" e la velocità impostata.

In questa modalità non è possibile selezionare la velocità **AUTO**.

SETTING THE TIMER

The timer can be used to delay appliance start up or shutdown. This avoids wasting electricity by optimising operating periods.

How to programme delayed shutdown

- With the air-conditioning unit on, press the **TIMER** button (19). The time is displayed and the "h" symbol flashes, with a flashing arrow indicating **"TIMER OFF"**.
- Set the time when you want the appliance to go off using the  buttons (from 30 minutes to 24 hours). During the first ten hours, you can select half hour intervals. For times greater than ten hours, one hour intervals can be selected.
- Press the **TIMER** button again to confirm the selection. A beep sounds and the time set is also displayed on the control panel, confirming setting of the timer. A countdown of the time left is displayed on both the air conditioner and remote control displays. At the end of the set time the appliance switches off automatically.
- To cancel the timer programme, press the **TIMER** button (19) again. The appliance emits a beep and both displays reset to display the settings prior to activation of the timer.

Programming delayed start-up

- With the air-conditioning unit stand-by, press the **TIMER** button (19). The display shows a flashing arrow indicating "TIMER ON". Now make all the desired settings for when the appliance will switch on (operating mode, fan speed and temperature).
Confirm the settings by pressing the **TIMER** button (19). The time is displayed and the "h" symbol flashes.
Set the time when you want the appliance to switch off using the  buttons (from 30 minutes to 24 hours).
During the first ten hours, you can select half hour intervals.
For times greater than ten hours, one hour intervals can be selected.
- Press the **TIMER** button again to confirm the start-up time.
A beep sounds and the time set is also displayed on the control panel, confirming setting of the timer.
A countdown of the time left is displayed on both displays.
- At the end of the set time the appliance switches on automatically, with the settings made previously.
- To cancel the timer programme, press the **TIMER** button (19) again.
The appliance emits a beep and both displays reset to stand-by.

TIPS FOR CORRECT USE

To get the best from your air conditioner, follow these recommendations:

- close the windows and doors in the room to be air conditioned (fig. 9). When installing the air conditioner semi-permanently, you should leave a door slightly open (as little as 1 cm) to guarantee correct ventilation;
- Protect the room from direct exposure to the sun by partially closing curtains and/or blinds to make the appliance much more economical to run (fig. 10);
- never rest objects of any kind on the air conditioner;
- do not obstruct the air intake and outlet (fig. 11). Leave the grilles free;
- make sure there are no heat sources in the room.
- never use the appliance in very damp rooms (laundries for example);
- never use the appliance outdoors;
- make sure the air conditioner is standing on a level surface. if necessary, place the castor locks under the front wheels;

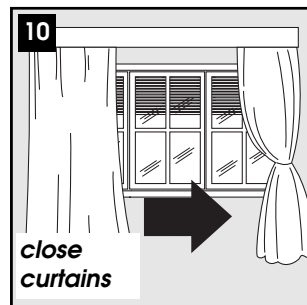
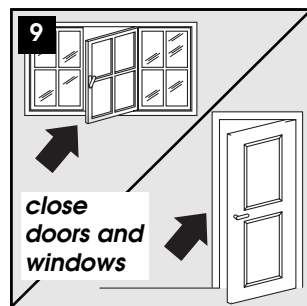

CLEANING

Before cleaning or maintenance, turn the appliance off by pressing the  button on the control panel or remote control, wait for a few minutes then unplug from the mains socket.

CLEANING THE CABINET

You should clean the appliance with a slightly damp cloth then dry with a dry cloth.

- ✓ Never wash the air conditioner with water. It could be dangerous.
- ✓ Never use petrol, alcohol or solvents to clean the appliance.
Never spray insecticide liquids or similar.

CLEANING THE AIR FILTERS

To keep your air conditioner working efficiently, you should clean the silver ion filter every week of operation.

The filter is housed in the intake grille (fig. 12).

Use a vacuum cleaner to remove dust accumulations from the filter. If it is very dirty, immerse in warm water and rinse a number of times.

The water should never be hotter than 40°C. After washing, leave the filter to dry and replace it.

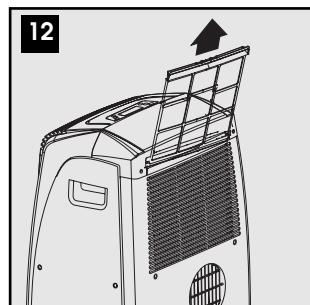

START - END OF SEASON OPERATIONS

START OF SEASON CHECKS

Make sure the power cable and plug are undamaged and the earth system is efficient.

Follow the installation instructions precisely.

END OF SEASON OPERATIONS

To empty the internal circuit completely of water, remove the cap (fig. 13).

Run off all water left into a basin. When all the water has been drained, put the cap back in place.

Clean the filter and dry thoroughly before putting back.

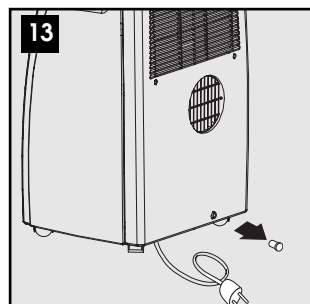

TROUBLESHOOTING

PROBLEM	CAUSE	SOLUTION
The air conditioner does not come on	<ul style="list-style-type: none"> • there is no current • it is not plugged into the mains • the internal safety device has tripped 	<ul style="list-style-type: none"> • wait • plug into the mains • Wait 30 minutes, if the problem persists, contact your service center.
The air conditioner works for a short time only	<ul style="list-style-type: none"> • there are bends or kinks in the air exhaust hose • something is preventing the air from being discharged 	<ul style="list-style-type: none"> • position the air exhaust hose correctly, keeping it as short and free of curves as possible to avoid bottlenecks • check and remove any obstacles obstructing air discharge
The air conditioner works, but does not cool the room	<ul style="list-style-type: none"> • windows, doors and/or curtains open • there are heat sources in the room (oven, hairdryer, etc) • the air exhaust hose is detached from the appliance • the technical specification of the appliance is not adequate for the room in which it is located. 	<ul style="list-style-type: none"> • close doors, windows and curtains, bearing in mind the "tips for correct use" given above • eliminate the heat sources • fit the air exhaust hose in the housing at the back of the appliance (fig. 1).
During operation, there is an unpleasant smell in the room	<ul style="list-style-type: none"> • airfilter clogged 	<ul style="list-style-type: none"> • clean the filter as described above
The air conditioner does not operate for about three minutes after restarting it	<ul style="list-style-type: none"> • the internal compressor safety device prevents the appliance from being restarted until three minutes have elapsed since it was last turned off. 	<ul style="list-style-type: none"> • wait. This delay is part of normal operation.
The following message appears on the display: LT / PF / FT	<ul style="list-style-type: none"> • The appliance has a self diagnosis system to identify a number of malfunctions. 	<ul style="list-style-type: none"> • See the SELF-DIAGNOSIS chapter.

TECHNICAL SPECIFICATIONS

Mains voltage	see rating plate
Maximum absorbed power in air conditioning	"
Refrigerant	"
Cooling capacity	"

LIMIT CONDITIONS

Temperature of room in air conditioning	18-35°C
---	---------

SIZE OF APPLIANCE

- width 463 mm
- height 775 mm
- depth 382 mm
- weight 32 kg

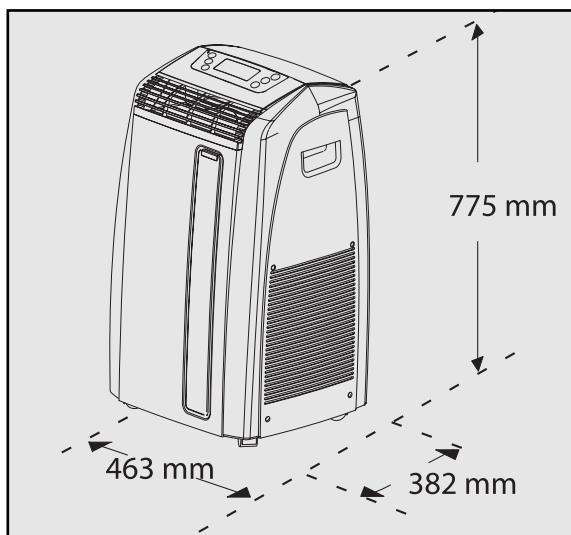

GUARANTEE

The terms of the guarantee and technical assistance are given in the documentation accompanying your appliance.