

Description of Appliance

The following terms are used throughout the instruction manual

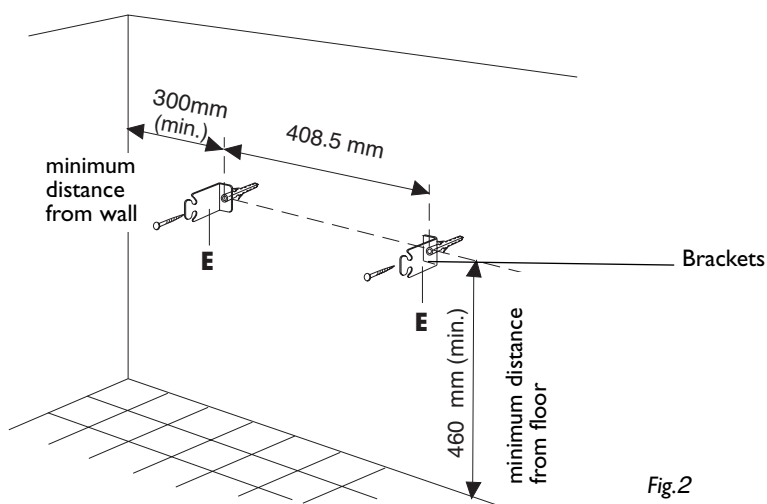
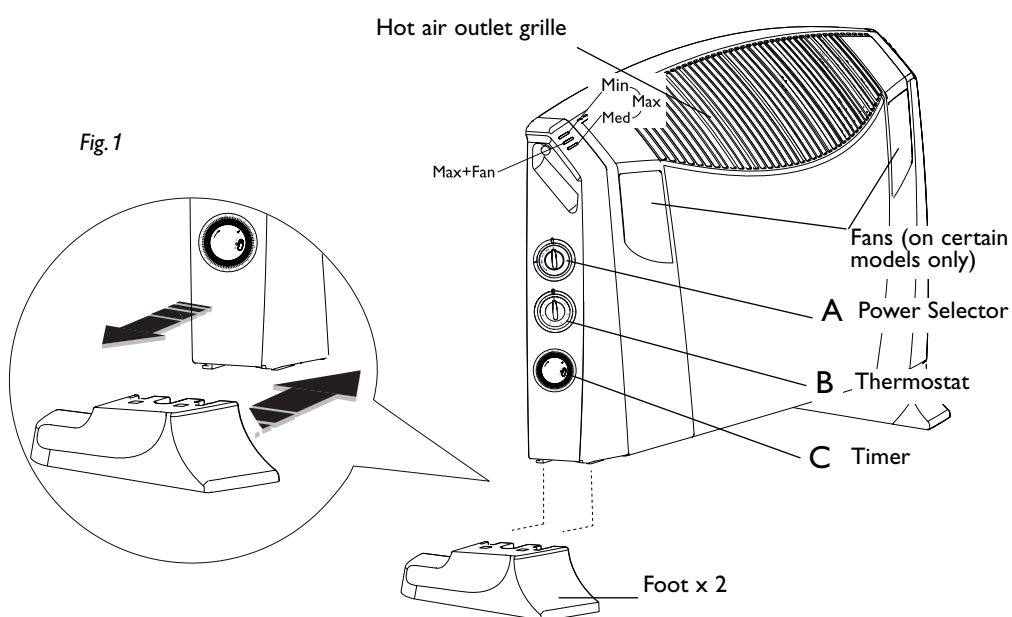

Thank you for choosing this De'Longhi convector heater. To get the best results from your new heater please read these instructions carefully before use. This should ensure optimum results and maximum safety.

SAFETY WARNINGS

- The first time you use the appliance, operate it for at least 15 minutes with the thermostat at maximum to eliminate the “new” smell. A little smoke due to the protective substances applied to the heating element before transport may be given off. This is completely normal and not a cause for concern.
- **Do not use the convector heater near bath tubs, showers, sinks or swimming pools.** The appliance must not be placed directly under a fixed socket.
- Do not rest the power cable on the appliance.
- Always use the heater in a vertical position only.
- Do not obstruct the hot air outlet grilles or the air intake grille at the top or the bottom of the appliance.
- If the power cable is damaged, it must be replaced by the manufacturer or an authorised service centre in order to eliminate all risk.
- Do not use this appliance in rooms measuring less than 4m². You should avoid positioning it in currents of air which could disturb operation of the heater.

A safety device trips and turns the appliance off in the event of overheating or if it is placed in strong currents of air. To reset, unplug the appliance from the mains socket and leave to cool down (about five minutes), remove the cause of overheating, plug back into the mains and turn on again.

A number of models are fitted with a special device which turns power off if the appliance is tipped over, sloped or knocked. If this occurs, you will hear a beep.



WARNING: In order to avoid overheating, never under any circumstances cover the appliance during operation.

CAUTION: In order to avoid a hazard due to inadvertent resetting of the thermal cutout, this appliance must not be supplied through an external switching device, such as an external timer, or connected to a circuit that is regularly switched on and off by the utility.

Important information for correct disposal of the product in accordance with EC Directive 2002/96/EC.



At the end of its working life, the product must not be disposed of as urban waste. It must be taken to a special local authority differentiated waste collection centre or to a dealer providing this service. Disposing of a household appliance separately avoids possible negative consequences for the environment and health deriving from inappropriate disposal and enables the constituent materials to be recovered to obtain significant savings in energy and resources. As a reminder of the need to dispose of household appliances separately, the product is marked with a crossed-out wheeled dustbin.

Important - UK only

- The wires in the cord are coloured as follows:
Green and Yellow = Earth
Blue = Neutral
Brown = Live.
- The appliance must be protected by a 13A approved (BS1362) fuse.
- warning: this appliance must be earthed.

Note:

- For non-rewireable plugs the fuse cover **MUST** be refitted when replacing the fuse. If the fuse cover is lost then the plug must not be used until a replacement can be obtained. The correct fuse cover is identified by colour and a replacement may be obtained from your De'Longhi Authorised Repairer (see guarantee leaflet).
- If a non-rewireable plug is cut off it must be destroyed immediately. An electric shock hazard may arise if an unwanted non-rewireable plug is inadvertently inserted into a 13A socket outlet.
- This appliance complies with European Economic Community Directive 89/336/EEC.

1. Electrical connections

- Before plugging into the mains, make sure the voltage of your mains supply corresponds to the value Volt indicated on the appliance and that the socket and power line are appropriate for the load required.
- THIS APPLIANCE COMPLIES WITH DIRECTIVE 2004/108/EEC AND ON ELECTROMAGNETIC COMPATIBILITY.

2. Attaching the feet

To fit the feet, proceed as follows: insert the foot into the guide on the side and push as far as it will go until the two teeth hook in place (fig. 1).

3. Wall mounting

IMPORTANT: before drilling the wall, make sure the area is free of electrical wires or pipes. To fix your convector heater to the wall, use the brackets “E” and “F” provided and appropriate screws and wall plugs (provided). Proceed as follows:

- Fix the brackets “E”, making sure the distances are as shown in fig. 2.
- Hang the heater on the two brackets fixed to the wall. Insert the two brackets “F” in the back of the convector base as shown in fig. 3-4.

Mark the bracket fixing points on the wall.

- Remove the heater, drill the wall and insert the wall plugs.
- Fix the heater again, inserting the brackets “F” into the base of the heater and fixing them to the holes in the wall using the screws.

Now your heater is mounted on the wall.

The appliance must not be positioned directly underneath a fixed power point. Position the appliance in such a way that the plug is easily accessible even after installation.

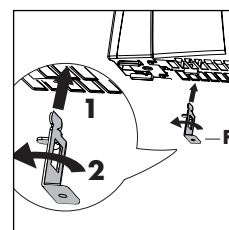

Fig.3

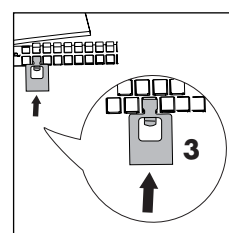

Fig.4

4. Operation and use

Turning on

Plug into the mains, turn the thermostat dial (B) to maximum and turn the appliance on by means of the power selector (A) as described below.

- Turn the selector (A) to the **Min** position to select minimum power (the Min power light comes on).
- Turn the selector (A) to the **Med** position to select medium power (the Med power light comes on).
- Turn the selector (A) to the **Max** position to select maximum power (the Max power light comes on).

In the fan version, both Min and Med lights come on.

5. Adjusting the thermostat

When the room has reached the required temperature, turn the thermostat dial (B) slowly anticlockwise until the lights go out and no further. The thermostat will automatically regulate the temperature set and keep it constant. In spring or autumn or on mild days, you can save energy by using minimum power.

6. Frost prevention mode

With the thermostat dial in the * position and one of the power levels selected, the appliance maintains room temperature at about 5°C, preventing freezing with minimal energy consumption.

7. Models with fan

Some models have two fans for faster more even heating. To use this function, turn the power selector (A) to the Max position * (the corresponding light comes on).

8. Models with 24 hour timer (C)

If you wish to operate the heater without the timer, position the slider on position I. On the contrary if you wish to operate the heater at a set time, first put the slider (D) on position ⌚ (fig. 5) then proceed as follows:

- Check the time on your clock or watch. If it is 10.00 for example, turn the numbered programmer disk until the number 10 coincides with the pointer marked on the programmer.
- Set the periods of time during which you want the appliance to operate by pushing the teeth outwards. Each tooth corresponds to a period of 15 min. At the end of this procedure, sectors corresponding to the operating periods can be seen.
- In this way, the appliance will function automatically each day at the times set. (Important: the appliance must always be plugged into the socket)
- To modify programming, return the teeth to the initial position and set the new operating periods.
- To turn the appliance off completely, turn the dial (A) to the "0" position and unplug from the mains.

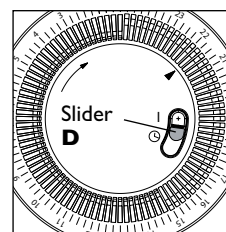

Fig. 5

9. Maintenance

Always unplug from the mains socket before cleaning.

The convector heater requires no special maintenance. It is sufficient to remove dust with a soft dry cloth. Clean when cold only. Never use abrasive powders or solvents.