

DeLonghi



Filter Coffee Maker



Living innovation

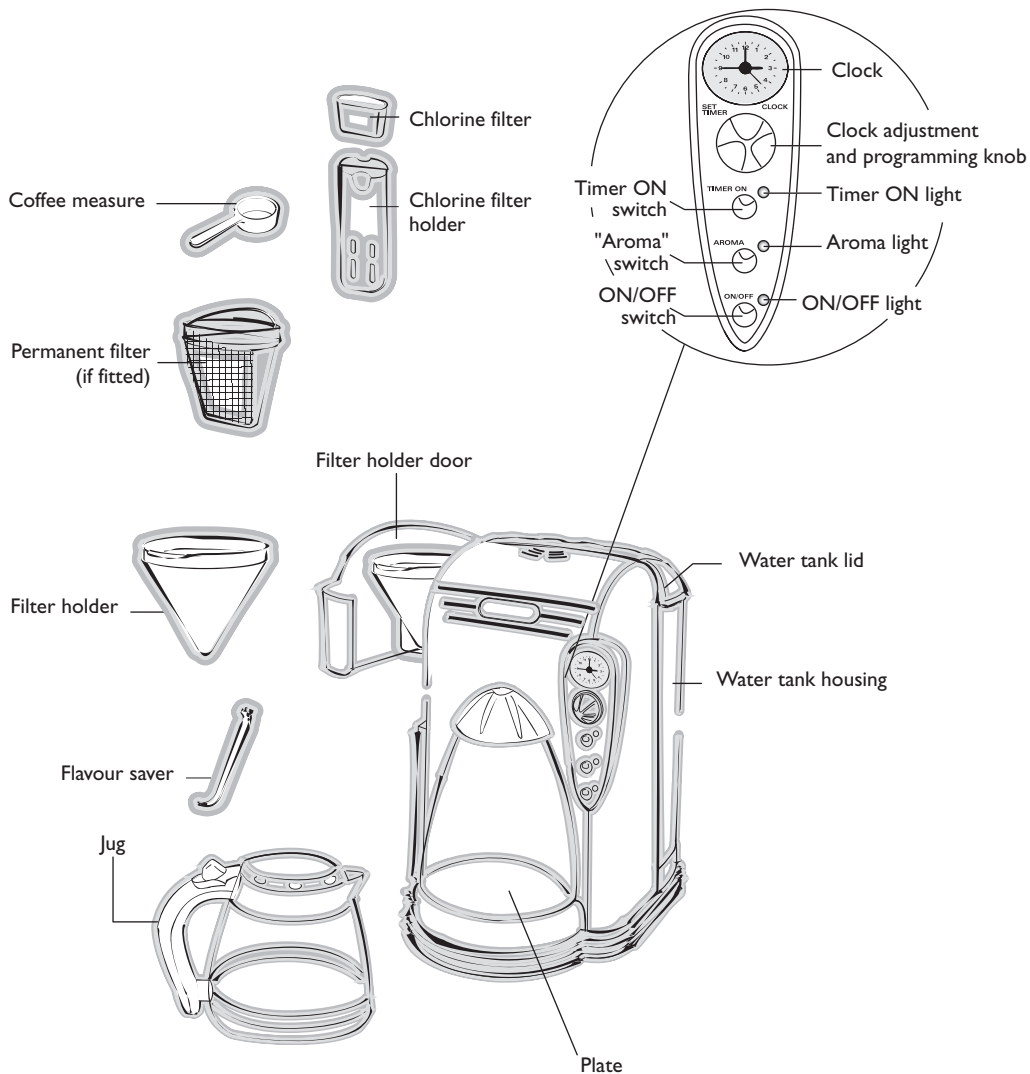

Thank you for choosing this coffee machine. To get the best result out of your new coffee machine it is advisable to read these instructions before using the appliance. This is the only way to ensure optimum results and maximum safety.

Using for the first time

Before using the machine for the first time, wash all the accessories in warm soapy water and rinse. For the best tasting coffee the internal circuits must be flushed through at least twice. To do this, follow the instructions in the paragraph "How to prepare the filter coffee" without using ground coffee.

Installation

- Place the coffee maker on a flat work surface at a safe distance from taps and sinks.
- Check that the voltage corresponds to that indicated on the appliance rating plate. The appliance must always be connected to a correctly-earthed power socket (minimum rating 10A) only. The manufacturer is not liable for damage caused by inadequate earthing of the appliance.
- In the event of incompatibility between the plug on the appliance and the socket, have the plug replaced by a qualified professional.
- Never install the machine in environments where the temperature may reach 0°C or lower (the appliance may be damaged if the water freezes).
- Please read safety warnings and electrical requirements (page 8 and 9) before operating this coffee maker.
- Adjust the exact time by pressing and at the same time turning the knob clockwise (fig. 1).

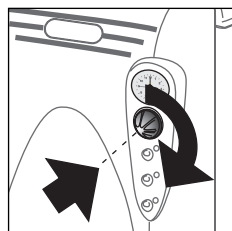

fig. 1

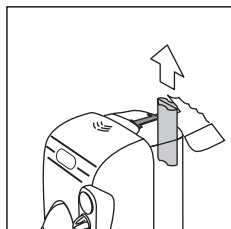

fig. 2

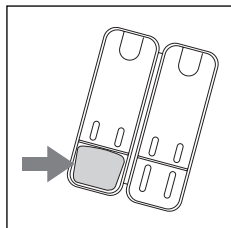

fig. 3

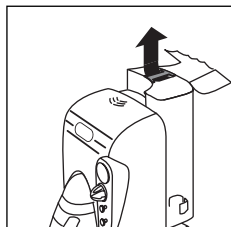

fig. 4

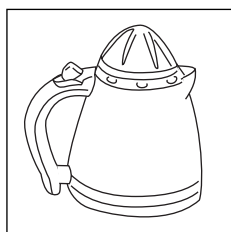

fig. 5

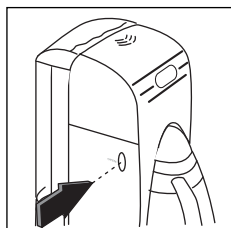

fig. 6

Chlorine filter (if fitted)

The filter eliminates the taste of chlorine from the water. To install the filter, proceed as follows :

- Remove the chlorine filter from the plastic bag and rinse it in tap water.
- Lift the water tank lid and remove the chlorine filter holder from its housing by lifting it upwards (fig. 2).
- Open the chlorine filter holder by pressing the parts marked “PUSH” and carefully place the filter in the holder as shown in fig. 3.
- Close the filter holder and replace it in its housing pushing it fully down.
- The chlorine filter must be replaced every 80 uses, and always after six months of operation.

How to prepare the filter coffee

- Lift the water tank lid and remove the tank (fig. 4)
- Fill the tank with fresh, clean water up to the level corresponding to the number of cups of coffee required. Place the tank back in the coffee maker pressing it lightly into place. The tank may also be filled without being removed, using the coffee jug marked with the level indicators (fig. 5).
- Open the filter holder by rotating towards the left (fig. 6).
- Place the permanent filter in the filter holder (fig. 7).
- Place the ground coffee in the filter, using the measuring spoon supplied, and level evenly (Fig. 8). As a general rule, use a level measuring spoon of ground coffee (around 7 grams) for each cup (for example, 8 spoons to make 8 cups). Never use more than 11 level spoons. The quantity of ground coffee used will vary according to personal taste. Use good quality, medium ground coffee, packaged for filter coffee makers.
- Close the filter holder, screw up tightly the jug lid and place the thermal jug on the plate.
- Your appliance has an AROMA button. When this is pressed, percolation of the coffee is slowed down to extract more of the aroma. This is particularly recommended when preparing from 1 to 6 cups.



fig. 7

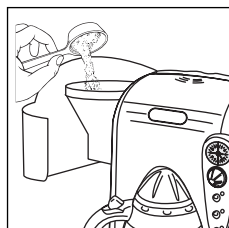

fig. 8

- Press the "ON/OFF" switch (Fig. 9). The ON pilot light next to the switch indicates that the coffee maker is in operation.
- The coffee will start to come out after a few seconds. **It is completely normal for the appliance to release a little steam while the coffee is filtering.**
- A beep indicates when the coffee is ready.
- To pour out the coffee, turn the lid anticlockwise until the (●) symbol is lined up with the spout (fig. 10).

Attention: removing the jug before all the coffee is made does not interrupt production of the coffee, but merely blocks flow into the jug. If you want to pour out a little coffee immediately, you are recommended to do so as rapidly as possible in order to avoid the coffee overflowing in the filter holder.

Models with thermal jug: to pour out the coffee, turn the lid anticlockwise until the (●) symbol is lined up with the spout (fig. 10).

Important: the timer enables you to have your coffee ready and waiting whenever you want.

- 1 Turn the knob until the red pointer indicates the time when you want the coffee to be ready (fig. 11).
- 2 Press the "Timer On" button. The corresponding light comes on (fig. 12).

Important: the appliance has an electric clock. Make sure the appliance is plugged into the mains electricity supply by watching the seconds pointer turn. The appliance has a 12 hour clock, so programming must be for less than this time.

Cleaning and maintenance

Before performing any cleaning or maintenance operations, turn the machine off, unplug it from the power socket and allow it to cool down.

1. When cleaning the coffee maker, do not use solvents or abrasive detergents. A soft, damp cloth is sufficient.
2. Never immerse the coffee maker in water: it is an electrical appliance.

Cleaning the Flavour Saver

To clean the Flavour Saver more efficiently, it can be removed from the filter holder by sliding it upwards (Fig. 14). To replace, simply slide in from above.

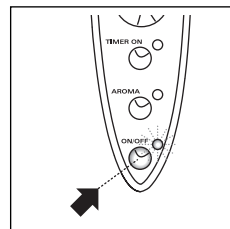

fig. 9

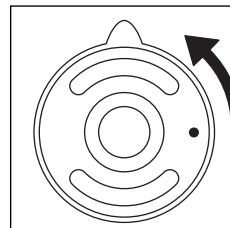

fig. 10

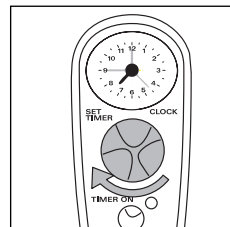

fig. 11

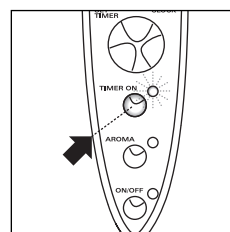

fig. 12

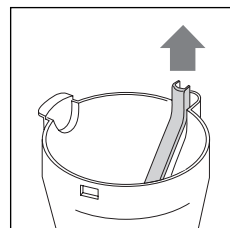

fig. 14

Descaling

If the water in your local area is hard, lime scale will form over time. These deposits may affect the correct operation of the appliance.

The coffee maker must be descaled every 40 uses. The descaling process may be performed using special commercially-available scale removers for filter coffee makers. Alternatively, white wine vinegar can be used as follows:

1. Remove the chlorine filter.
2. Pour 2 cups of white wine vinegar and 3 cups of water into the tank. Place the tank in the coffee maker;
3. Place the jug on the warming plate, do not put any ground coffee in the filter holder;
4. Press the filter coffee ON/OFF switch, filter the equivalent of one cup and then switch off the appliance;
5. Leave the vinegar to act for one hour;
6. Switch the coffee maker back on and filter the rest of the solution;
7. To rinse the machine, operate it with water and without ground coffee at least 3 times (3 complete tanks of water).

Problem solving

Problem	Possible causes	Solution
<i>The filter coffee takes a long time to filter through.</i>	<ul style="list-style-type: none">• The filter coffee maker needs to be descaled	<ul style="list-style-type: none">• Descale as described in the paragraph "Descaling"
<i>The coffee has an acid flavour</i>	<ul style="list-style-type: none">• The coffee maker has not been rinsed sufficiently	<ul style="list-style-type: none">• Rinse the appliance as described in the chapter "Descaling"

Safety Warnings

- This appliance is designed to make coffee. Take care during use to avoid burns caused by the water or steam jets or improper use of the appliance itself.
- When the appliance is in use, do not touch any of the machine's hot surfaces.
- After unpacking, make sure that the machine is complete and undamaged. In case of doubt, do not use the appliance and seek the advice of a qualified service professional.
- Packaging materials (plastic bags, foam polystyrene, etc.) should not be left within the reach of children as this could be a potential source of danger.
- This appliance is to be used for domestic use only. Any other use is to be considered improper and therefore, dangerous.
- The manufacturer takes no responsibility for damage derived from improper use.
- Never touch the appliance with wet or damp hands.
- Never immerse the appliance in water.
- Never allow the appliance to be used by children or unfit persons.
- Do not allow children to play with the appliance.
- In the event of breakdown or malfunctioning, turn the appliance off immediately and do not touch. For repairs, please contact a Service Centre authorised by the manufacturer. Failure to observe the above points may affect the safe use of the appliance.
- The power cable must never be replaced by the user. If the cable should become damaged, or needs to be replaced, please contact a Service Centre authorised by the manufacturer.
- When the appliance is not in use, turn off and disconnect the plug from the socket.
- As with any electrical appliance, whilst the instructions aim to cover as many eventualities as possible, caution and common sense should be applied when operating your appliance, particularly in the vicinity of young children.

Important information for correct disposal of the product in accordance with EC Directive 2002/96/EC.

At the end of its working life, the product must not be disposed of as urban waste.

It must be taken to a special local authority differentiated waste collection centre or to a dealer providing this service.

Disposing of a household appliance separately avoids possible negative consequences for the environment and health deriving from inappropriate disposal and enables the constituent materials to be recovered to obtain significant savings in energy and resources. As a reminder of the need to dispose of household appliances separately, the product is marked with a crossed-out wheeled dustbin.



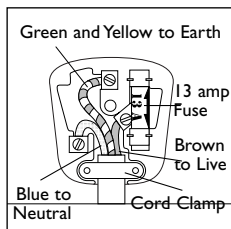

Electrical requirements

Before using this appliance ensure that the voltage indicated on the product corresponds with the main voltage in your home, if you are in any doubt about your supply contact your local electricity company.

The flexible mains lead is supplied connected to a B.S. 1363 fused plug having a fuse of 13 amp capacity. Should this plug not fit the socket outlets in your home, it should be cut off and replaced with a suitable plug, following the procedure outlined below.

Note: Such a plug cannot be used for any other appliance and should therefore be properly disposed of and not left where children might find it and plug it into a supply socket - with the obvious consequent danger.

N.B. We recommend the use of good quality plugs and wall sockets that can be switched off when the machine is not in use.

Important: the wires in the mains lead fitted to this appliance are coloured in accordance with the following code:

GREEN AND YELLOW	EARTH
BLUE	NEUTRAL
BROWN	LIVE

As the colours of the wires in the mains lead of this appliance may not correspond with the coloured markings identifying the terminals in your plug, proceed as follows:

The wire which is coloured green and yellow must be connected to the terminal in the plug which is marked with the letter E or by the earth symbol \perp or coloured green or green and yellow.

The wire which is coloured blue must be connected to the terminal which is marked with the letter N or coloured black.

The wire which is coloured brown must be connected to the terminal which is marked with the letter L or coloured red.

When wiring the plug, ensure that all strands of wire are securely retained in each terminal. Do not forget to tighten the mains lead clamp on the plug. If your electricity supply point has only two pin socket outlets, or if you are in doubt, consult a qualified electrician.

Should the mains lead ever require replacement, it is essential that this operation be carried out by a qualified electrician and should only be replaced with a flexible cord of the same size.

After replacement of a fuse in the plug, the fuse cover must be refitted. If the fuse cover is lost, the plug must not be used until a replacement cover is obtained. The colour of the correct replacement fuse cover is that of the coloured insert in the base of the fuse recess or elsewhere on the plug. Always state this colour when ordering a replacement fuse cover.

Only 13amp replacement fuses which are asta approved to B.S. 1362 should be fitted.

This appliance conforms to the Norms EN 55014 regarding the suppression of radio interference.

Warning - this appliance must be earthed

