

ELECTRIC PANEL HEATER
HHP1000S - HHP1500S - HHP2000S
HHP1000W - HHP1500W - HHP2000W

Please retain these instructions for future reference



Living innovation

Description of the appliance

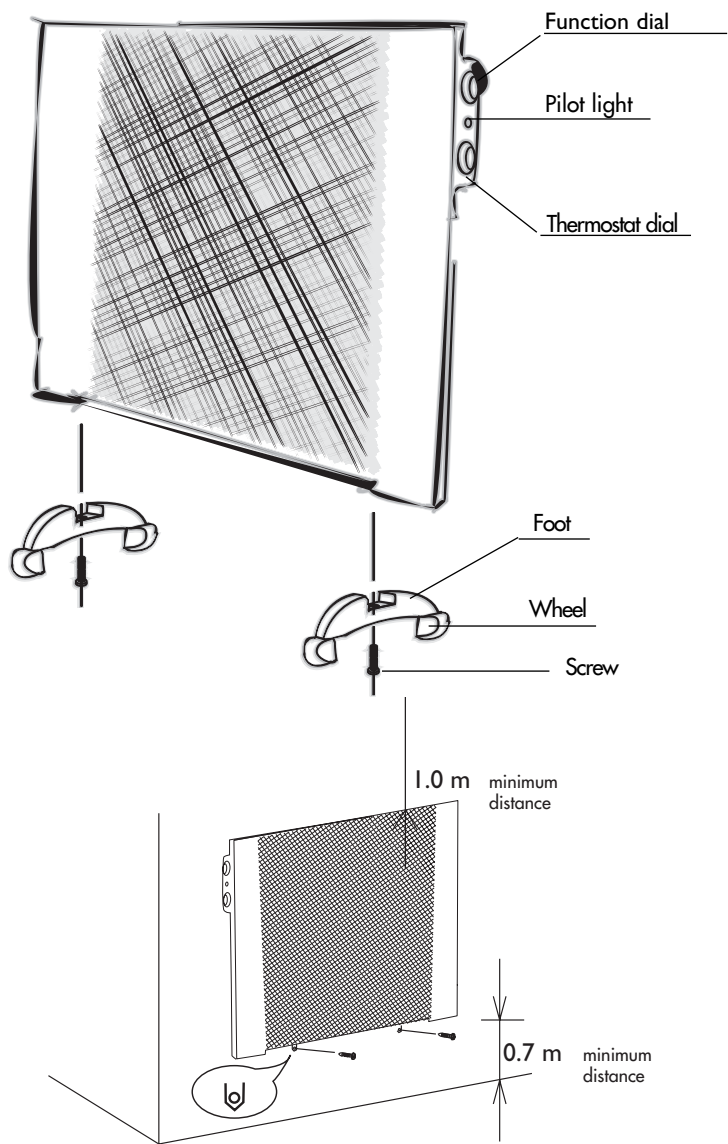

fig. 1

HOW TO USE YOUR ELECTRIC PANEL HEATER

Thank you for choosing this Dè Longhi heater. Please read this instruction booklet carefully before using this heater. By doing so, you will obtain optimum results with maximum safety.

1. Warnings

- Never use the heater to dry laundry.
- Never place the power cable on top of the heater while it is hot.
- Only use the heater in an upright position.
- If the supply cord is damaged, it must be replaced by the manufacturer, its service agent or similarly qualified persons in order to avoid a hazard.
- We recommend that you not place the heater in a draught, because strong draughts of air may adversely affect the equipment's operational efficiency.
- On using the appliance for the first time, turn it on to the maximum power setting for at least 2 hours. This is to eliminate the 'new odour' which is released by the appliance. During this time ensure that the room is well ventilated.
- the use of an extension lead is not recommended, however if it is necessary then follow carefully the extension lead's instructions, and most importantly ensure that the extension lead is correctly rated in accordance with the appliance being used and NEVER overloaded.
- As with any electrical appliance, whilst the instructions aim to cover as many eventualities as possible, caution and common sense should be applied when operating your appliance, particularly in the vicinity of young children.
- Position the appliance so that the plug and the outlet can be easily reached even after installation.
- Do not use the appliance in rooms less than 4 m² in area.
- The appliance is fitted with a tilt-switch which turns the appliance off if it should fall over. To restart the appliance, simply place it upright again.
- The appliance is not intended for use by persons (including children) with reduced physical, sensory or mental capabilities, or lack of experience and knowledge, unless they have been given supervision or instruction concerning use of the appliance by a person responsible for their safety. Children should be supervised to ensure that they do not play with the appliance.

The appliance is fitted with a **safety device** which will switch the appliance off in case of **accidental overheating**. To reset, disconnect the plug from the power socket for a few minutes, remove the cause of overheating then plug the appliance in again.



WARNING: In order to avoid overheating, never under any circumstances cover the appliances during operation, as this would lead to dangerous overheating.

CAUTION: In order to avoid a hazard due to inadvertent resetting of the thermal cutout, this appliance must not be supplied through an external switching device, such as a timer, or connected to a circuit that is regularly switched on and off by the utility.

IMPORTANT INFORMATION FOR CORRECT DISPOSAL OF THE PRODUCT IN ACCORDANCE WITH EC DIRECTIVE 2002/96/EC.



At the end of its working life, the product must not be disposed of as urban waste. It must be taken to a special local authority differentiated waste collection centre or to a dealer providing this service. Disposing of a household appliance separately avoids possible negative consequences for the environment and health deriving from inappropriate disposal and enables the constituent materials to be recovered to obtain significant savings in energy and resources. As a reminder of the need to dispose of household appliances separately, the product is marked with a crossed-out wheeled dustbin.

Electrical requirements

Before using this appliance ensure that the voltage indicated on the product corresponds with the main voltage in your home, if you are in any doubt about your supply contact your local electricity company.

The flexible mains lead is supplied connected to a B.S. 1363 fused plug having a fuse of 13 amp capacity. Should this plug not fit the socket outlets in your home, it should be cut off and replaced with a suitable plug, following the procedure outlined below.

Note: Such a plug cannot be used for any other appliance and should therefore be properly disposed of and not left where children might find it and plug it into a supply socket - with the obvious consequent danger.

N.B. We recommend the use of good quality plugs and wall sockets that can be switched off when the machine is not in use.

important: the wires in the mains lead fitted to this appliance are coloured in accordance with the following code:

GREEN AND YELLOW	EARTH
BLUE	NEUTRAL
BROWN	LIVE

As the colours of the wires in the mains lead of this appliance may not correspond with the coloured markings identifying the terminals in your plug, proceed as follows:

The wire which is coloured green and yellow must be connected to the

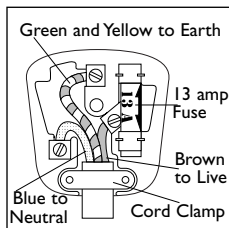

terminal in the plug which is marked with the letter E or by the earth symbol  or coloured green or green and yellow.

The wire which is coloured blue must be connected to the terminal which is marked with the letter N or coloured black.

The wire which is coloured brown must be connected to the terminal which is marked with the letter L or coloured red.

When wiring the plug, ensure that all strands of wire are securely retained in each terminal. Do not forget to tighten the mains lead clamp on the plug. If your electricity supply point has only two pin socket outlets, or if you are in doubt, consult a qualified electrician.

Should the mains lead ever require replacement, it is essential that this operation be carried out by a qualified electrician and should only be replaced with a flexible cord of the same size.

After replacement of a fuse in the plug, the fuse cover must be refitted. If the fuse cover is lost, the plug must not be used until a replacement cover is obtained. The colour of the correct replacement fuse cover is that of the coloured insert in the base of the fuse recess or elsewhere on the plug. Always state this colour when ordering a replacement fuse cover. Only 13amp replacement fuses which are CE approved to B.S. 1362 should be fitted.

This appliance conforms to the Norms EN 55014 regarding the suppression of radio interference.

2. General instructions

Carefully remove the heater from the packaging. Check that neither the heater nor the power cable has been damaged during transport. Do not operate the heater if damaged. Your heater is suitable for either freestanding or wall mounting usage. Do not assemble the feet if wall mounting.

3. Electrical connection

- Before plugging the appliance into the mains, check that your supply voltage is the same as that shown on the rating plate of the appliance and that the electric installation is suitable to the power shown on the rating plate.
- If using more than one appliance at a time, it is important to ensure that the power supply is adequate to cope with the power requirements.
- This appliance complies with EEC Directive 89/336 relating to electromagnetic compatibility.

4. Free standing operation

To fit the feet to the appliance, proceed as follows:

Unscrew the screws from the feet, then fix the foot with the relevant screws, as shown in the description of the appliance.

5. Wall-mounting installation

- If wall-mounting this appliance, the minimum distances from other objects must be followed, as shown in fig 1.

The wall mounting kit should contain:

1 support

4 x Screws (M 3.5 x 38 PA)

4 x Wall plugs (\varnothing 6 x 30)

1. Select position for siting the heater ensuring that:
 - a. **It is not located directly below a power socket outlet.**
 - b. **The cable and plug can easily reach a suitable mains power outlet**
 - c. **No electric cables or other tubes could be damaged.**
 - d. **It is not positioned near curtains or inflammable materials.**
2. Before drilling the wall, mark out a template following carefully the dimensions as shown in fig.2.
3. For solid brick block walls, use a 6 mm masonry drill and drill according to the marks you have made and then insert the wall plugs provided.
(For plasterboard we suggest locating the studding and using No 6 woodscrews directly into the wood, or special plasterboard fixings. For other wall types please seek specialist advice).
4. Fix the support by means of the the 2 screws provided. (fig.3).
5. Hang the heater on the support.
6. Mark out the 2 lower fixing points (see fig.1). Remove the appliance, drill the lower holes and insert the wall plugs. Now, you can hang the heater to the support and fix the lower part of the appliance with the 2 remaining screws (see figure1).

6. Functioning and use. - Turn the thermostat dial in a clockwise direction until it reaches the 6 setting.

- Turn the function dial to setting **I** (the pilot light will come on).
- **Switching off:** turn the function dial to the "0" setting.

7. Adjusting the thermostat

The thermostat should be maintained until the desired room temperature has been reached. Now move the thermostat back gradually until the red pilot light goes out. The thermostat can then remain at this setting, regulating the desired temperature.

8. Care and Cleaning

Before cleaning the appliance, make sure it is unplugged from the mains and wait until it is completely cool. Remove any dust with a soft, dry cloth. Never use abrasive powers or solvents. If necessary, remove concentrated areas of dirt with a vacuum cleaner. The appliance should not require any other type of maintenance.

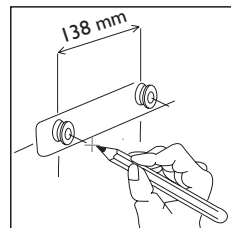

fig. 2

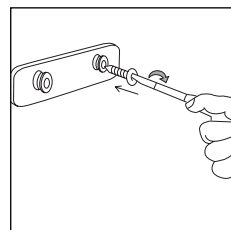

fig. 3