

KENWOOD

TYPE HBP03

instructions

Cod: 6265104400 Rev. 0 - 30/11/2020



Kenwood Ltd

New Lane
Havant
Hampshire
PO9 2NH
kenwoodworld.com



© Copyright 2020.Kenwood Limited. All rights reserved



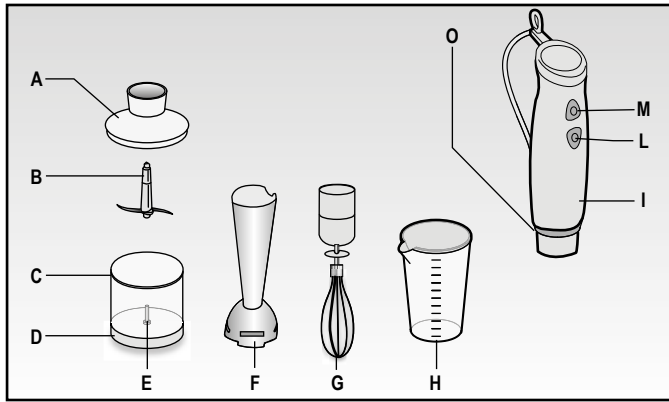

Fig. 1

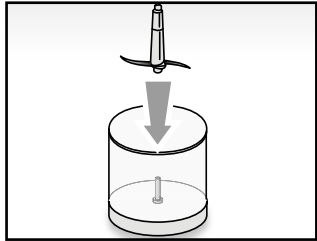

Fig. 2

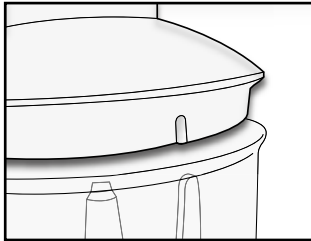

Fig. 3

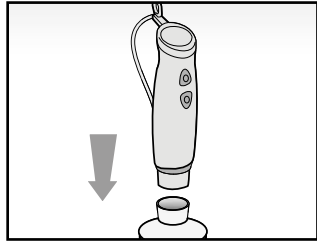

Fig. 4

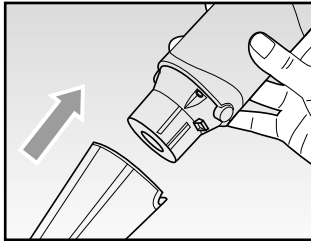

Fig. 5

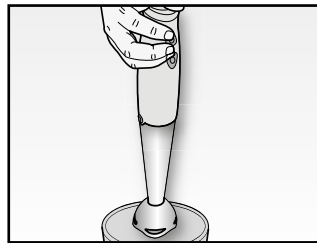



Fig. 6

safety

- Read these instructions carefully and retain for future reference.
- Remove all packaging and any labels.
- If the cord is damaged it must, for safety reasons, be replaced by KENWOOD or an authorised KENWOOD repairer.
- Make sure that the voltage on the appliance rating plate corresponds to that of the mains electricity.
- This appliance shall not be used by children. Keep the appliance and its cord out of reach of children.
- Always disconnect the appliance from the mains supply if it is left unattended and before assembling, disassembling or cleaning.
- Appliances can be used by persons with reduced physical, sensory or mental capabilities or lack of experience and/or knowledge provided they are supervised or have been trained in the safe use of the device and understand the potential dangers.
- Children shall not play with the appliance.
- Never place the appliance on or close to sources of heat.
- Never leave the appliance exposed to the elements (rain, sun, etc....).
- Make sure that the power cord does not come into contact with hot surfaces.
- Keep the power cord well away from sharp corners. Do not wind the power cord around the appliance.

- NEVER IMMERSE THE MOTOR BODY, PLUG, OR POWER CORD IN WATER OR OTHER LIQUIDS – WIPE CLEAN USING A DAMP CLOTH ONLY.
- Never use the appliance close to sinks. Never use it with wet hands.
- Always stand the appliance on a flat, steady surface during use.
- Before starting the appliance, make sure that it has been properly assembled.
- Never operate the appliance when it is empty.
- NEVER TOUCH MOVING PARTS.
- Handle blades with great care so as to avoid all risk of injury.
-  WARNING: INSERT THE CHOPPER BLADE SET (B) BEFORE THE FOOD. Wait until the blade has stopped moving before removing the lid.
- Do not use the appliance if the blades are damaged.
- Do not use the appliance to chop particularly hard foods (e.g., ice cubes or meat on the bone).
- Make sure that the power base is not switched on before fitting or removing attachments, when cleaning the appliance or when it is not in use.
- Do not insert hands or metal utensils (forks, knives, etc.) into the various attachments while operating the appliance.
- Keep long hair or loose clothing away from the appliance while the blade set is operating.
- Before removing the power base, wait for all

attachments (blades, whisks) to stop moving.

- Unplug the appliance from the mains power if it should break during operation or when it is not in use.
- To disconnect, grip the plug and pull it from the wall outlet. Never pull the cord.
- Never use the appliance if the power cord or plug are damaged, if the appliance itself is faulty or if it shows clear signs of damage caused by a fall or by other reasons; in this case, take the appliance to your nearest authorised assistance centre.
- Only use original attachments.
- This appliance has been designed for use within a time limit of 1 minute max. Switch off the appliance after 1 minute in case of liquid foods and after 30 seconds in case of solid foods. Leave the appliance for at least 30 minutes at room temperature before using it again to avoid overloading the motor.
- If the blade set does not rotate or has difficulty in doing so, to avoid causing any damage to the appliance, switch it off immediately and unplug it from the mains power. Make sure that there is nothing to block the blade in the container or that the container is not too full.
- If the power cord is damaged, it must be replaced only by the manufacturer, their technical assistance service or a qualified specialist in order to avoid risks.
- This appliance is designed for HOME USE ONLY and may not be used for commercial or industrial purposes.

- The appliance is designed to chop and blend different types of food.
- This appliance conforms to the directives 2014/35/EU and EMC 2014/30/EU, and to the regulations (EC) No. 1935/2004 of 27/10/2004 regarding material in contact with foods.
- In the event that you decide to dispose of the appliance, we advise you to make it in-operative by cutting off the power cord. We also recommend that any parts that could be dangerous be rendered harmless, especially for children, who might play with the appliance or its parts.
- Packaging must never be left within the reach of children since it is potentially dangerous.

key

- A Chopper lid
- B Chopper blade
- C Chopper container
- D Non-slip base
- E Chopper blade assembly shaft
- F Hand blender shaft
- G Wire whisk attachment
- H Graduated container with lid
- I Power base
- L Speed "Turbo" button
- M Speed I button
- O Rod removal button

instructions for use

WARNING:

Make sure that the power base (I) switched off before fitting or removing attachments, when cleaning the appliance or when it is not in use.

Using the chopper attachment

- Fit the blade set (B) to the shaft (E) in the container (C) (Fig. 2).

WARNING:

Handle blades with great care so as to avoid all risk of injury.

WARNING:

INSERT THE BLADE SET BEFORE THE FOOD.

Wait until the blade has stopped moving completely before removing the lid.

- Cut food into small pieces (1.5 x 1.5 cm) and place the pieces inside the container (C).
- Fit the lid (A) to the container (C), making sure that the slot in the bottom of the lid fits perfectly over the reference tab on the container and pressing the lid down until it locks into place (Fig. 3). Make sure that the top part of the blade (B) has correctly entered the housing in the base of the lid.

WARNING:

Before using the appliance, make sure that the blade set and lid have been properly fitted.

- Place the power base (I) on the lid (A), and press down gently until it locks into place (Fig. 4).
- Once the appliance is assembled, start it by pressing the speed I button (M). After this, and according to the type of food being processed, it will be possible to pass to the higher speed by pressing the relevant button (L). For optimum appliance operation, use the pulse function, pressing the button (M-L) for very short periods (2-3 seconds).

CAUTION:

If the appliance should fail to operate, make sure that the attachments have been fitted correctly.

- For fine and even chopping, take off the power base (I) and remove the food from the sides of the container (C) with a spatula as necessary.
- To stop appliance operation, release the relevant speed button (M-L). The appliance can be used to chop foods in very brief amounts of time.

Using the hand blender attachment

- Fit the rod (F) to the power unit (I): fit the two parts together by slotting in the rod (F) and gently pressing on the power unit (I) until the rod clicks firmly into place (Fig. 5).
- The hand blender (F) is a useful appliance for preparing sauces, soups, mayonnaise, baby food and shakes.

Using the wire whisk attachment

- Mount the wire whisk (G) onto the power unit (I): put close the two parts and insert the whisk (F) by slightly pressing it on the power unit (I) (Fig. 5).
- Place the whisk in the centre of the mix and start the appliance, mixing at the slowest speed at first and gradually increasing the speed to the required level.
- The wire whisk attachment (G) serves for mixing, whipping cream and egg whites and for soft mixes.

- Both the hand blender (F) and wire whisk (G) attachment can be used with the graduated container (H) provided or directly immersed inside saucepans containing the food to be blended, after first removing them from the heat to prevent overheating. To keep food from splashing during blending operations, we recommend using containers with high sides and switching off the appliance while it is still inside the container with the food. We also recommend using the pulse function as this not only offers better results, it also prevents the appliance motor from overheating. Do not use to blend boiling foods to avoid all risk of burns and scalds.
- After switching off, the blade on the handheld blender will continue to rotate. Wait for the blade to stop before removing the mixer from the foods, then continue with food preparation, using the appliance.
- Once the appliance is assembled, start it by pressing the speed I button (M). After this, and according to the type of food being processed, it will be possible to pass to the higher speed by pressing the relevant button (L) (Fig. 6).

WARNING:

If the appliance should fail to operate, make sure that the attachments have been fitted correctly.

WARNING:

Before removing the power base (I), wait for the blade to have stopped completely and then unplug the appliance from the power mains.

- To remove the rod (F-G) it is necessary to press the two buttons (O) together.

cleaning and maintenance

WARNING:

NEVER IMMERSE THE POWER BASE, PLUG OR POWER CORD IN WATER.

WARNING:

Make sure that the power base is not switched on before fitting or removing attachments, when cleaning the appliance or when it is not in use.

- Remove the attachments from the power base (I) by following the assembly process in reverse order.
- The power base (I) can be wiped clean with a damp cloth.
- When cleaning the attachments of the chopper lid (A), graduated container with lid (H), hand blender shaft (F) and wire whisk attachment (G), we recommend rinsing them under running water.
- The plastic parts, such as the chopper container (C) and graduated container (H) can be cleaned in the top rack of the dishwasher.
- Never clean using sharp or abrasive objects.

MAYONNAISE RECIPE

- Place the following into the container (C) provided: 15 g white wine vinegar, 4 eggs and 15 g salt;
- Start the blender at speed "I" (M);
- Slowly pour the oil into the bowl (150 g oil per egg used) and pass to speed setting "Turbo" (L) when the mix begins to thicken. If the oil remains on the surface, switch off the appliance, mix in by hand and then use the blender for 15 seconds.

service and customer care

- If you experience any problems with the operation of your appliance, before requesting assistance visit www.kenwoodworld.com.
- Please note that your product is covered by a warranty, which complies with all legal provisions concerning any existing warranty and consumer rights in the country where the product was purchased.
- If your Kenwood product malfunctions or you find any defects, please send it or bring it to an authorised KENWOOD Service Centre. To find up to date details of your nearest authorised KENWOOD Service centre visit www.kenwoodworld.com or the website specific to your Country.
- Made in China.



**IMPORTANT INFORMATION
FOR CORRECT DISPOSAL
OF THE PRODUCT IN
ACCORDANCE WITH THE
EUROPEAN DIRECTIVE ON
WASTE ELECTRICAL AND
ELECTRONIC EQUIPMENT
(WEEE)**

At the end of its working life, the product must not be disposed of as urban waste.

It must be taken to a special local authority differentiated waste collection centre or to a dealer providing this service.

Disposing of a household appliance separately avoids possible negative consequences for the environment and health deriving from inappropriate disposal and enables the constituent materials to be recovered to obtain significant savings in energy and resources. As a reminder of the need to dispose of household appliances separately, the product is marked with a crossed-out wheeled dustbin.