

Register Now 
www.delonghi.com/register

TRRS Series

OIL FILLED RADIATOR

Instructions for use

This product is only suitable for well insulated spaces or occasional use



The DeLonghi logo is displayed in a black oval with a white border. The text "DeLonghi" is in a bold, white, sans-serif font.

ELECTRICAL CONNECTION

- A) If your appliance comes fitted with a plug, it will incorporate a 13 Amp fuse. If it does not fit your socket, the plug should be cut off from the mains lead, and an appropriate plug fitted, as below. **WARNING:** Very carefully dispose of the cut off plug after removing the fuse: do not insert in a 13 Amp socket elsewhere in the house as this could cause a shock hazard. With alternative plugs not incorporating a fuse, the circuit must be protected by a 15 Amp fuse. If the plug is a moulded-on type, the fuse cover must be re-fitted when changing the fuse using a 13 Amp Asta approved fuse to BS 1362. In the event of losing the fuse cover, the plug must NOT be used until a replacement fuse cover can be obtained from your nearest electrical dealer. The colour of the correct replacement fuse cover is that as marked on the base of the plug.
- B) If your appliance is not fitted with a plug, please follow the instructions provided below:

WARNING - THIS APPLIANCE MUST BE EARTHED

IMPORTANT

The wires in the mains lead are coloured in accordance with the following code:

Green and yellow:	Earth
Blue:	Neutral
Brown:	Live



As the colours of the wires in the mains lead may not correspond with the coloured markings identifying the terminals in your plug, proceed as follows:

The green and yellow wire must be connected to the terminal in the plug marked with the letter E or the earth symbol  or coloured green or green and yellow. The blue wire must be connected to the terminal marked with the letter N or coloured black. The brown wire must be connected to the terminal marked with the letter L or coloured red.

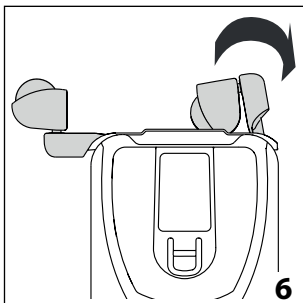
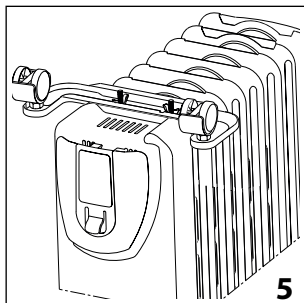
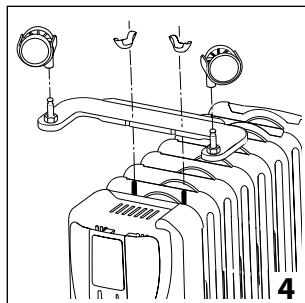
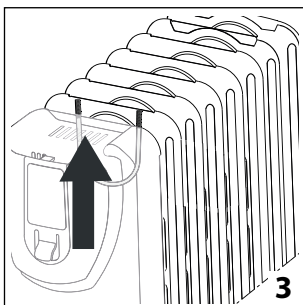
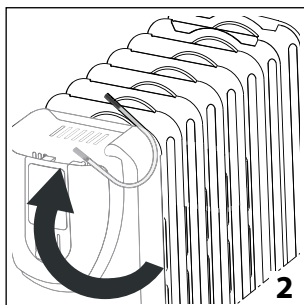
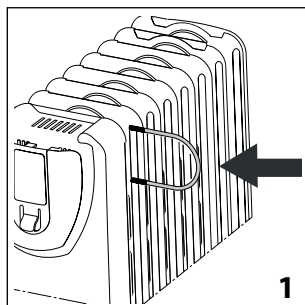
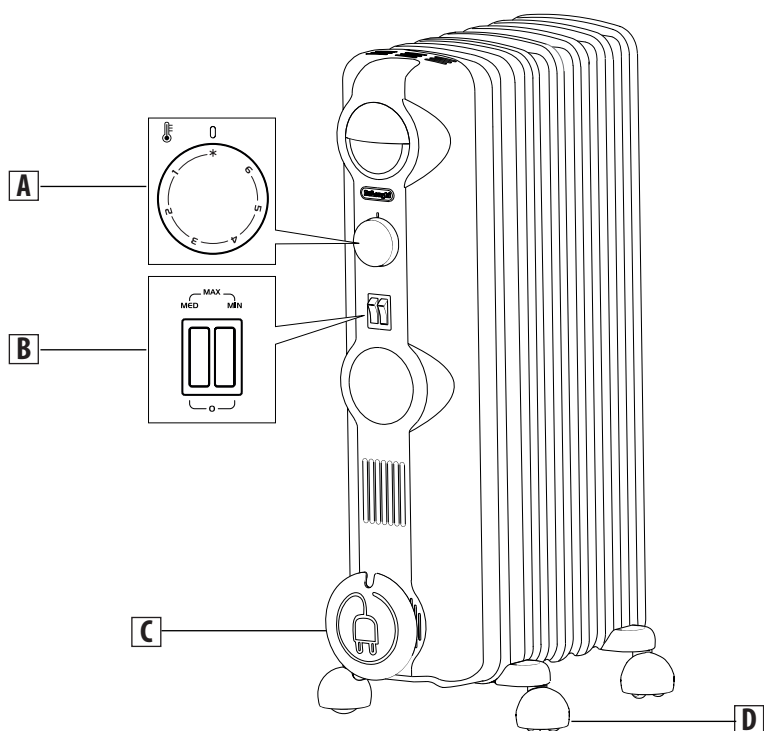

IMPORTANT WARNINGS

Read all the Instruction for Use carefully before using the appliance. Keep this Instructions for Use.



Danger!

Failure to observe the warning may result in life threatening injury by electric shock.

- Do not use the heater in the vicinity of bathtubs, wash basins, showers, sinks and swimming pools.
- Never use the heater to dry laundry.
- If the power cable has been damaged, it must be replaced by the manufacturer or the technical service centre or by a qualified person so as to avoid all risks.



Important!

Failure to observe the warning could result in injury or damage to the appliance.

- This appliance can be used by children aged from 8 years and above and persons with reduced physical, sensory or mental capabilities or lack of experience and knowledge if they have been given supervision or instruction concerning use of the appliance in a safe way and understand the hazards involved. Children shall not play with the appliance. Cleaning and user maintenance shall not be made by children without supervision.
- Children of less than 3 years should be kept away unless continuously supervised.
- Children aged from 3 years and less than 8 years shall only switch on/off the appliance provided that it has been placed or installed in its intended normal operating position and they have been given supervision or instruction concerning use of the appliance in a safe way and understand the hazards

involved. Children aged from 3 years and less than 8 years shall not plug in, regulate and clean the appliance or perform user maintenance.

CAUTION — Some parts of this product can become very hot and cause burns. Particular attention has to be given where children and vulnerable people are present.

- **WARNING:** Do not use this heater in small rooms when they are occupied by persons not capable of leaving the room on their own, unless constant supervision is provided.
- The body of this radiator is filled with a precise quantity of special oil, so that repairs requiring the opening of the oil body must only be made by the service agent. Any oil leakage must be reported to the Customer Experience, see enclosed guarantee for details.
- When scrapping the heater, follow the regulations concerning the disposal of oil.
- The appliance must not be located immediately below a fixed socket-outlet.
- **CAUTION:** in order to avoid any danger caused by an accidental resetting of the safety system, this appliance must not be powered through an external timer.
- Do not obstruct the air intake and outlet area (danger of overheating).



Danger of burns!!

Failure to observe the warning could result in burns or scalds.

- **WARNING:** In order to avoid overheating, never under any circumstances cover the appliances during operation, as this would lead to dangerous overheating.
- The use of an extension lead is not



recommended, as overheating of the extension lead may occur during the operation of the heater.

- Never place the power cable on top of the heater while it is hot.
- Do not rest anything on the appliance.
- **WARNING:** To reduce the risk of fire, keep textiles, curtains, or any other flammable material a minimum distance of 1 m from the air outlet.



Please note:

This symbol indicates recommendations and important information for the user.

- We recommend that you not place the heater in a draught, because strong draughts of air may adversely affect the equipment's operational efficiency.
- Use this heater on a horizontal and stable surface.
- Always use the appliance in an upright position.
- Do not use this heater if it has been dropped.
- Do not use if there are visible signs of damage to the heater.
- The heater must be positioned at least 50cm from furniture or other objects.
- The first time you use the appliance, operate it of at least 15 minutes at maximum to eliminate the "new" smell.
A little smoke due to the protective substances applied to the heating element before transport may be given off.
- Position the appliance so that the plug and the outlet can be easily reached.
- Do not use the appliance in rooms less than 4 m² in area.
- The appliance is fitted with a safety device which will switch off it in case of accidental overheating.

To reset, please contact Customer Experience, see enclosed guarantee.

- Before putting the appliance away, make sure it is completely cooled and unplugged from the mains socket. Do not store in dusty atmospheres.
- The appliance must not be hung.

For non-EU countries only:

This appliance is not intended for use by persons (including children) with reduced physical, sensory or mental capabilities, or lack of experience and knowledge, unless they have been given supervision or instruction concerning use of the appliance by a person responsible for their safety. Children should be supervised to ensure that they do not play with the appliance.

Disposing of the appliance



The appliance must not be disposed of with household waste, but taken to an authorised waste separation and recycling centre.

Fundamental recommendations regarding safety

Dear Customer – The plug on this appliance will get 'warm' during use, this is perfectly normal. This product is A HIGH POWER HEATING APPLIANCE designed to our usual high standards but please make sure your wall sockets are in good condition and the plug is inserted correctly to avoid any accidental overheating. We suggest that you check the plug AND THE SOCKET regularly if the heater is in prolonged use, if you are in any doubt please consult an electrician.

DESCRIPTION

(see figure on pag. 3).

- A** Thermostat
- B** Switches
- C** Cord holder
- D** Wheel

USE

Electrical connection

- Before plugging the radiator into the mains, check that the voltage of your mains electricity supply corresponds to the value V indicated on the appliance and that the

- socket and power line are appropriately dimensioned.
- CONNECT THE RADIATOR TO EFFICIENTLY EARTHED SOCKETS ONLY.
- This appliance complies with directive on electromagnetic compatibility.

Fitting the feet

Remove the feet and the castors from the polystyrene packing. Insert the threaded u-bolt as shown in figures 1, 2 and 3 and use wing nuts to fix the feet to the bottom of the radiator between the last two elements, then fit the castors to the spindles on the feet and push firmly until they click into position (fig. 4-5). Pull each castor to check that it is fitted correctly. In certain models, the castors are already mounted on the feet.

Models with "Easy wheel" sytem

Turn the radiator upside-down on a rug or a soft surface in order to prevent damaging the paint finish.
Fully unfold the castors by turning them outwards (Fig.6). Turn the radiator back to its upright position.



Important!

When in use, the radiator should always be kept vertical (wheels at the bottom, controls at the top). Any other position could be dangerous!

INSTRUCTIONS FOR USE

Switching on

Turn the thermostat dial clockwise to maximum (6).
Turn on both switches. The lights on the switches remain on until the room temperature reaches the set temperature, then, they will switch off. When the room reaches the required temperature, turn the dial anticlockwise slowly until you hear a click and the lights will switch off.
The appliance will come on and go off automatically to maintain the required temperature.

- button in position «MIN» = minimum power (indicator light on);
- button in position «MED» = intermediate power (indicator light on);
- both buttons in position «MIN» «MED» = maximum power (indicator lights on)

Using the thermostat

The thermostat operates on the basis of room temperature and not radiator temperature. Turn the thermostat dial anticlockwise towards the lower numbers to reduce the temperature; turn it clockwise towards the higher numbers to raise the temperature. To turn the appliance off completely, turn the thermostat to minimum ✱ and unplug from the mains.

Frost protection function

With the thermostat in position ✱ and the switches pressed, the appliance maintains the room at a temperature of about 5°C, preventing freezing with minimum energy consumption.

MAINTENANCE

Before carrying out any operation on the radiator, unplug from the electric mains and wait for it to cool.

The oil-filled electric radiator requires no particular maintenance. It is sufficient to remove the dust with a soft, dry cloth. Never use abrasive powders or solvents. If necessary remove concentrations of dirt using a vacuum cleaner.

TECHNICAL CHARACTERISTICS

Power supply	See rating label
Absorbed power	"

TROUBLESHOOTING

PROBLEM	CAUSE	SOLUTION
The appliance doesn't work	Be sure it is plugged in and that the electrical outlet is working.	Plug into the power outlet.
	Check for any obstruction.	Remove the obstruction and let the appliance cool down. If the appliance doesn't work please contact Customer Experience.
	The temperature may be set too low.	Set the temperature to a higher position.