

Register Now 
www.delonghi.com/register



5717710271_00_0220

KG200 - 210

COFFEE GRINDER
INSTRUCTIONS FOR USE



De'Longhi

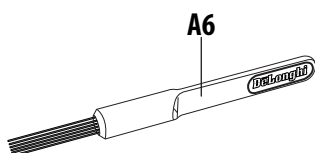
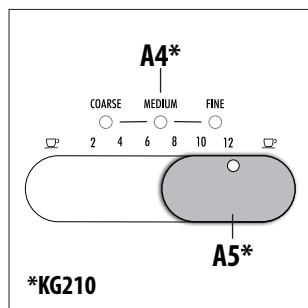
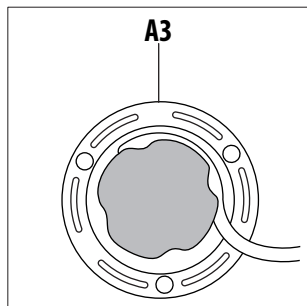
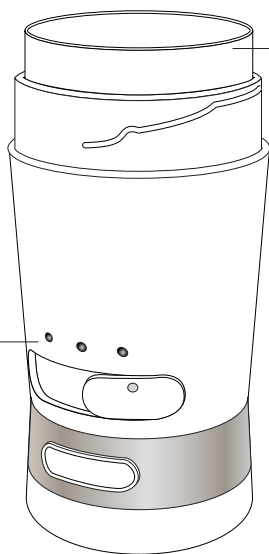
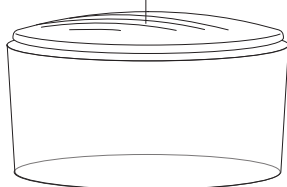
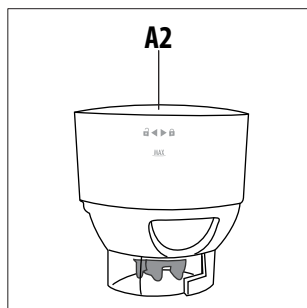
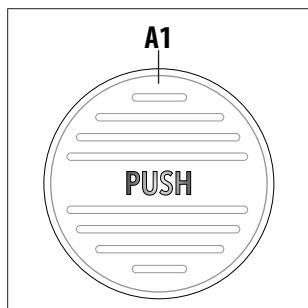

1. EN - FUNDAMENTAL SAFETY WARNINGS

- Appliances can be used by persons with reduced physical, sensory or mental capabilities or lack of experience and knowledge if they have been given supervision or instruction concerning use of the appliance in a safe way and if they understand the hazards involved.
- Children should be supervised to ensure that they do not play with the appliance.
- This appliance must be used exclusively for the purpose for which it was expressly conceived. All other use is considered improper. This appliance is not suitable for commercial use. The manufacturer is not liable for damage deriving from improper use of the appliance. Never try to chop ice or use the appliance other than as indicated in the Instruction for Use.
- Never clean by immersing the appliance in water.
- **IMPORTANT:** to prevent damage to the appliance, do not clean with alkaline detergents; use a soft cloth and, where applicable, neutral detergent.
- Do not use the appliance if the cover protecting the rotating part is damaged or ruined.
- This is an household appliance only. It is not intended to be used in: staff kitchen areas in shops, offices and other working environments; farm houses; by clients in hotels, motels and other residential type environments; bed and breakfast type environments.
- If the plug or power cord is damaged, it must be replaced by customer services only to avoid all risk.

FOR EUROPEAN MARKETS ONLY:

- Always unplug the appliance when left unattended and before assembly, taking apart or cleaning.
- This appliance shall not be used by children. Keep the appliance and its cord out of reach of children.
- Children shall not play with the appliance.

2. SAFETYWARNINGS



Danger!

Failure to observe the warning may result in life threatening injury by electric shock.

This is an electrical appliance and may cause electric shock. You should therefore follow these safety warnings:

- Before performing any cleaning operations, the machine must be turned off and disconnected from the mains power supply. Never immerse the machine in water.
- Never touch the appliance with damp hands or feet.
- Never touch the plug with damp hands.

- Make sure the socket used is freely accessible at all times, enabling the appliance to be unplugged when necessary. Unplug directly from the plug only. Never pull the cord as you could damage it.
- To disconnect the appliance completely you must unplug it from the mains socket.
- If the appliance is faulty, do not attempt to repair.
- Turn it off, unplug from the mains socket and contact Customer Services.
- Before cleaning the appliance, turn it off and unplug from the mains socket.



Important:

Failure to observe the warning could result in injury or damage to the appliance.

- Keep all packaging (plastic bags, polystyrene foam) away from children.
- Do not locate the appliance above or near electric or gas hobs or a hot oven.
- Make sure there are no foreign objects in the coffee mill.
- Avoid contact with moving parts.
- **Model with blades:** The blades are sharp. Take care when handling.

2.1 Instructions for Use

Read this Instruction for Use carefully before using the appliance. Failure to follow this Instruction for Use may result in injury or damage to the appliance.

The manufacturer is not liable for damage deriving from failure to respect this Instruction for Use.



Please note:

Keep this Instruction for Use. If the appliance is passed to other persons, they must also be provided with this Instruction for Use.

2.2 Technical characteristics

- The appliance complies with EC directives.
- Materials and accessories coming into contact with food conform to EEC regulation 1935/2004.

3. DISPOSING OF THE APPLIANCE



The appliance must not be disposed of with household waste, but taken to an authorised waste separation and recycling centre.

4. DESCRIPTION OF THE APPLIANCE

- A1. Coffee container lid (press to start the coffee mill)
- A2. Removable coffee container
- A3. Cable tidy
- A4. Grinding level indicator lights (KG210 only)
- A5. Cup number selection slider (KG210 only)
- A6. Cleaning brush

Before using the appliance, always read the safety warnings.

Important:

- Always wait at least one minute before using the coffee mill again to avoid the appliance overheating.
- To guarantee the freshness of the coffee, always clean the appliance after every use, particularly when grinding coffee after having ground other food such as sugar. Using the appliance to grind oily (e.g. peanuts) or hard (e.g. rice) seeds is not recommended.
- Bear in mind that releasing the lid, even if only for a moment, resets the appliance and the grinding begins again as if the beans were still whole.



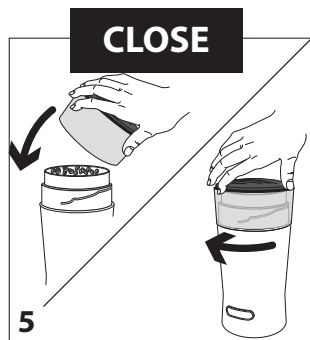
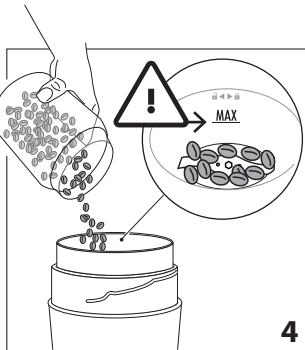
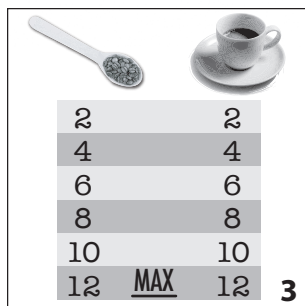
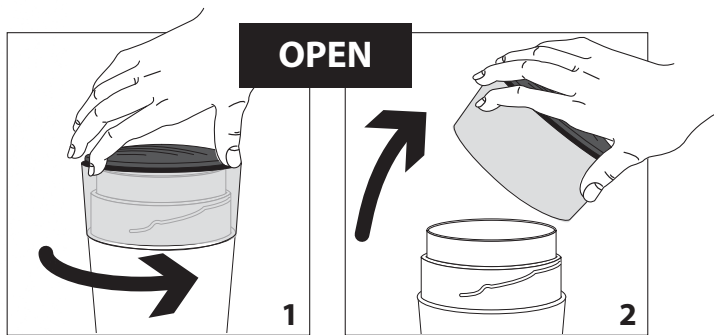
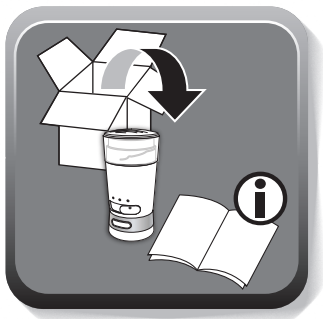

KG210

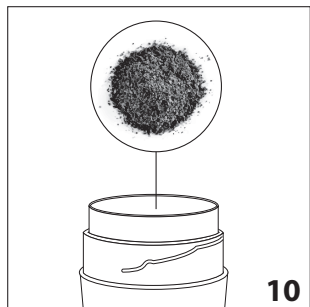
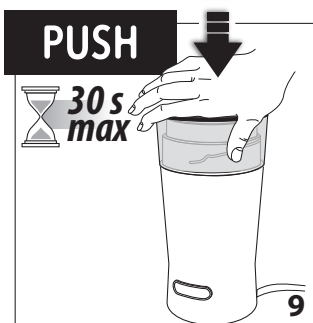
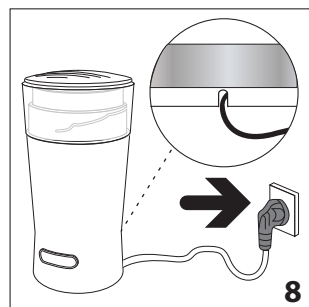
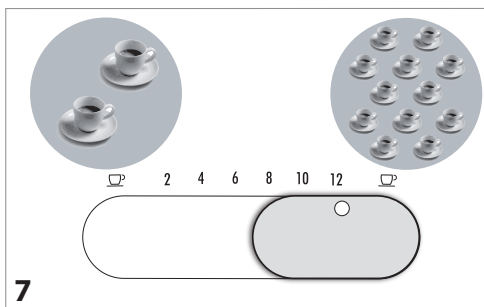
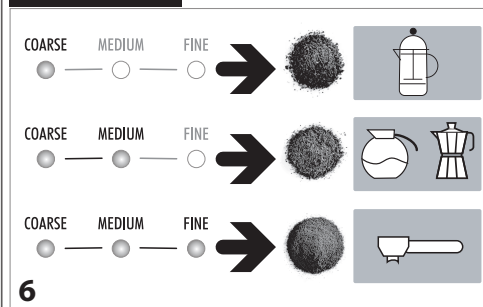

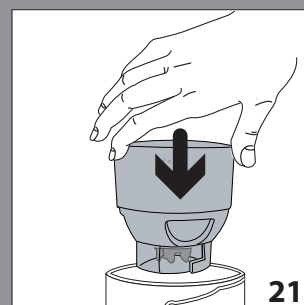
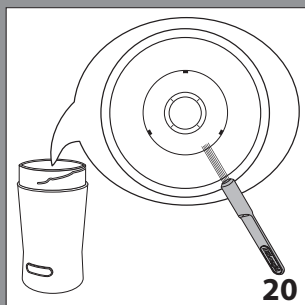
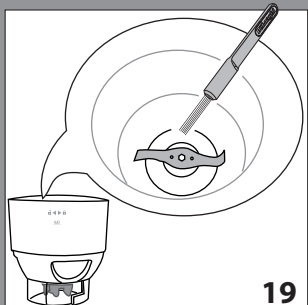
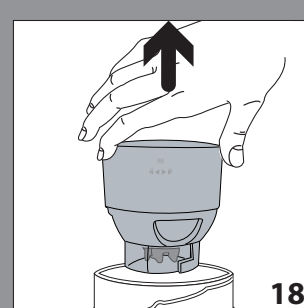
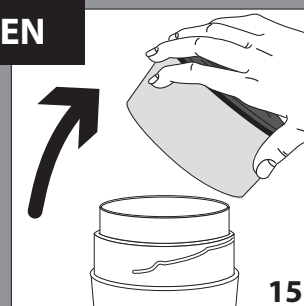
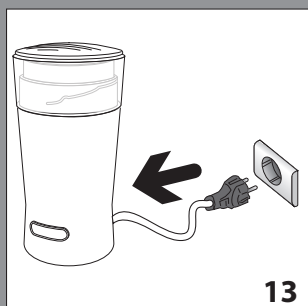
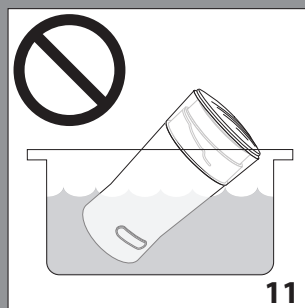

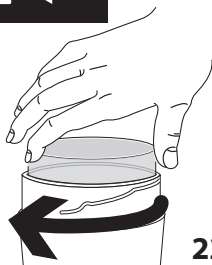

22



23

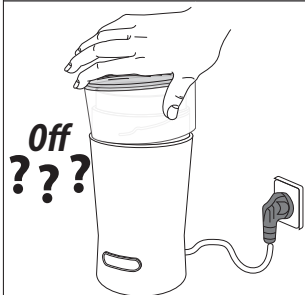

OPEN

CLOSE



fig. 1-2-5



111 mm



223 mm



1000 mm



KG210

1020 gr

KG200

920 gr