

Important safeguard

- Use this appliance only as described in this instruction manual.

As with any electrical appliance, the instructions aim to cover as many situations as possible. Caution and common sense should be used when operating and installing this air conditioner.

- This appliance has been manufactured to cool and dehumidify domestic environments and must not be used for other purposes.
- It is dangerous to alter or modify the unit's characteristics in any way.
- The appliance must be installed in accordance with the relevant national legislation.
- Should repairs be necessary, contact the nearest authorized Repair Service Center. Unauthorized servicing can be dangerous.
- The appliance is not intended for use by persons (including children) with reduced physical, sensory or mental capabilities, or lack of experience and knowledge, unless they have been given supervision or instruction concerning use of the appliance by a person responsible for their safety.
Children should be supervised to ensure that they do not play with the appliance.
- If the power cable is damaged, it must be replaced by the manufacturer or an authorized technical service centre in order to avoid all risk.
- Always ensure the appliance is plugged into a grounded 3-prong outlet. If you have any doubts check with a qualified electrician.
- Do not use extension cables.
- Before cleaning or maintenance operations, always unplug the unit from the outlet.
- Do not pull on or place strain on the power cord when moving the appliance.
- The appliance should not be installed where the atmosphere may contain combustible gases, oil or sulphur, or near heat sources.
- Do not rest hot or heavy objects on the appliance.
- Clean the filters at least once a week.
- Avoid using heaters near the unit.

- The unit should be transported in a vertical position. If this is not possible secure the unit at an angle, do not lie it horizontally.
- Before transporting the unit, drain the unit. After transportation, wait at least 6 hours before switching the unit on.
- The packaging materials can be recycled. You are therefore recommended to place them in the special containers for differentiated waste collection.
- This appliance is fitted with a special safety device. When the compressor switches off, this device prevents it from switching on again for at least 3 minutes.
- **WARNING:** Changes or modifications not expressly approved by the party responsible for compliance could void the user's authority to operate the equipment.

Specific warnings for appliances with R410A refrigerant gas

R410A refrigerant gas conforms to EC regulations on the environment.

Avoid perforating the refrigerant circuit of the appliance.

ENVIRONMENTAL INFORMATION:

This unit contains fluorinated greenhouse gases covered by the Kyoto Protocol.

Maintenance and disposal must be carried out by qualified personnel only (R410A, GWP=1975).

INTRODUCTION

Thank you for choosing a De'Longhi product. Please take a few moments to read the instructions to avoid risks or damage to the appliance.

DESCRIPTION

Description of the appliance (see page 3 - A)

- A1** air outlet grille
- A2** control panel
- A3** handles
- A4** castor wheels
- A5** air filter
- A6** air intake grille
- A7** air exhaust hose housing
- A8** air intake grille
- A9** power cable
- A10** drainage hose with 2 caps
- A11** remote control signal receiver
- A12** remote control compartment

Descrizione dei accessori (see page 3 - B)

- B1** hose adaptors (2 pieces)
- B2** air exhaust hose
- B3** window bracket grille
- B4** bung for hole in bar
- B5** window bracket
- B6** additional window bracket
- B7** screws
- B8** window outlet
- B9** remote control

Electrical connection

Before plugging the appliance into the outlet, check that:

- the mains power supply corresponds to the value indicated on the rating plate on the back of the appliance;
- the power socket and mains electricity supply are adequate for the appliance;
- the mains socket matches the plug. If this is not the case, have the plug replaced;
- the mains socket is adequately earthed. **Failure to follow these important safety instructions absolves the manufacturer of all liability.**

If it becomes necessary, the power cable must be replaced by a qualified professional only.

The instructions below will enable you to prepare your air conditioner for operation as efficiently as possible. Before use, make sure the air intake and outlet grilles are unobstructed.

USE

AIR CONDITIONING WITHOUT INSTALLATION

Just a few simple steps and your air conditioner will ensure your comfort:

- Screw one of the hose adapters **B1** to one end of the air exhaust hose **B2**.
- Fit the other adapter **B1** to the air exhaust hose housing **A7** at the back of the appliance (see fig. 1).
- Screw the end of the hose without adapter to the adapter previously mounted on the appliance (fig. 1).

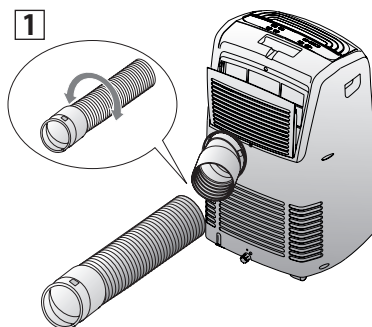

Sliding window

- Fit the window bracket grille **B3** to the window bracket **B5** and fix with the four screws **B7**, (fig. 2).

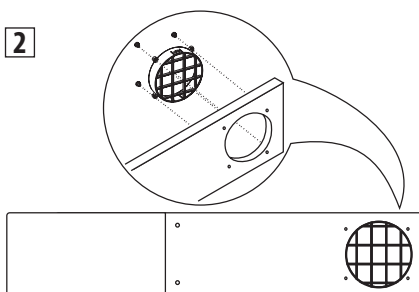

- Open the window.
- Place the window bracket **B5** in the window and extend it for the width of the window (fig. 3).
- Once the window bracket has been extended, fix it by screwing up the remaining two screws supplied.
- Lower the window (fig. 4).

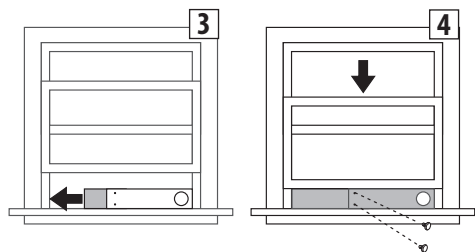

PREPARING FOR USE

- Place the air conditioner near the window. Insert the assembled air exhaust hose **B2** in the grille on the window bracket (fig. 5). Make sure the air exhaust hose is not blocked.
- When the appliance is not in use, the hole in the bar can be closed with the bung **B4** provided.

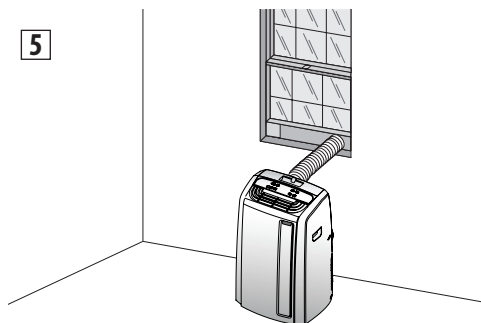

Double window

- Fit the window outlet **B8** to the air exhaust hose **B2** pre-assembled as shown in fig. 6.

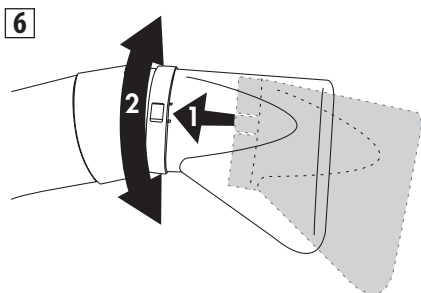

- Open the window or French window slightly and position the window outlet **B8** as shown in fig. 7.

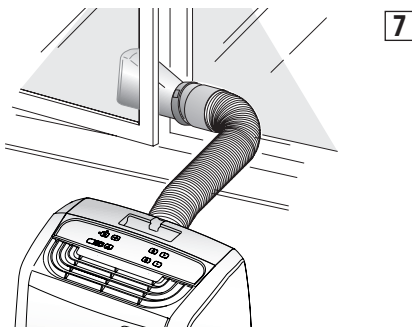

Note:

- Keep the air hoses as short and free of curves as possible to avoid bottlenecks.
- If the windows are large, use the additional window bracket **B6** (if provided) to cover your window aperture, extending it to the required length, then blocking it with the screws supplied (see figure 8). Make sure you do not cover the hole for the window outlet.

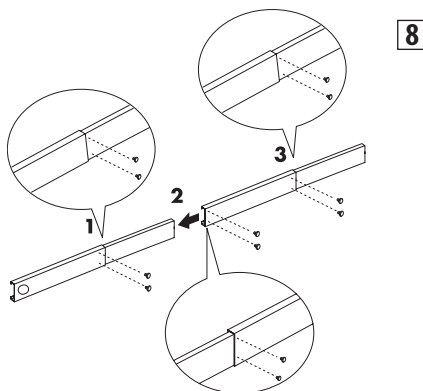

CONTROL PANEL

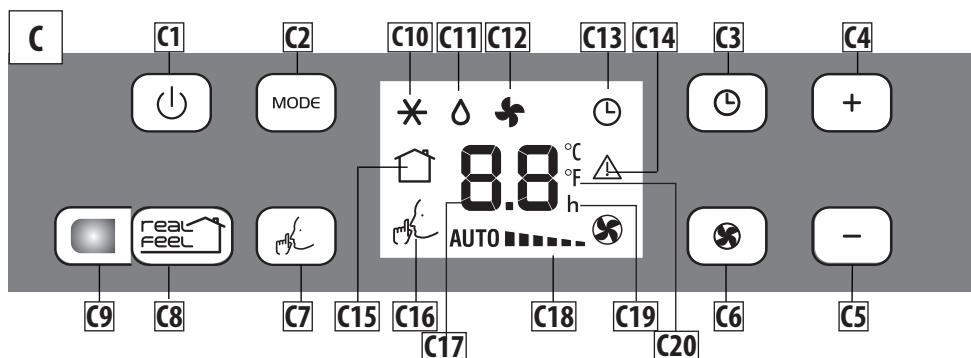

DESCRIPTION OF THE CONTROL PANEL (C)

- | | |
|--|--|
| C1 ON/OFF button | C13 Timer symbol |
| C2 MODE selection button (conditioning, dehumidifying, fan,) | C14 Alarm symbol |
| C3 Timer button | C15 REAL FEEL symbol |
| C4 Increase temperature/programmed operation time button | C16 SILENT MODE symbol |
| C5 Decrease temperature/programmed operation time button | C17 Temperature value set, programmed delayed ON/OFF time |
| C6 Fan speed selection button (LOW/MED/HIGH/AUTO) | C18 Fan speed indicator |
| C7 SILENT MODE selection button | C19 Timer indicator |
| C8 REAL FEEL selection button | C20 Temperature selected scale indicator |
| C9 REAL FEEL light | |
| C10 Air-conditioning symbol | |
| C11 Dehumidifying symbol | |
| C12 Fan symbol | |

Note: The panel buttons are backlit but only the buttons relevant to the active function will be on.

After few seconds of the control panel inactivity, its brightness will be automatically reduced and in the next few minutes it will be further reduced.

Note: Never turn the air conditioner off by unplugging from the mains. Always press the ON/OFF button, then wait for a few minutes before unplugging. This allows the appliance to perform a cycle of checks to verify operation.

OPERATING FROM THE CONTROL PANEL

TURNING THE APPLIANCE ON/OFF



Before plugging the appliance check the cap on back of the unit are correctly inserted on drainage hose A10

Plug the appliance into the mains. Two lines appear on the display indicating that the appliance is in stand-by and the buttons and light on.

Touch button (C1) to switch the appliance on.

When turned on, the air conditioner starts operating in the same mode as when it was turned off.

Note: If you don't switch on the appliance, after a few minutes, the and buttons switch off and the display fades to reduce energy consumption.

To turn off the appliance, touch the button, then unplug the appliance.

Note: Never switch off the appliance by unplugging it: always the button, wait a few minutes and then unplug. Doing so, the appliance will run a check of the operating conditions.

FUNCTION



REAL FEEL is the innovative De'Longhi technology that works simultaneously on temperature reduction and humidity control, securing best comfort level.

With traditional systems, during working time, optimal comfort conditions may be reached but not secured over time. With REAL FEEL, once optimal comfort is reached, PAC automatically modulates compressor action and fan speed, to keep it over time.

To activate the function, touch button.

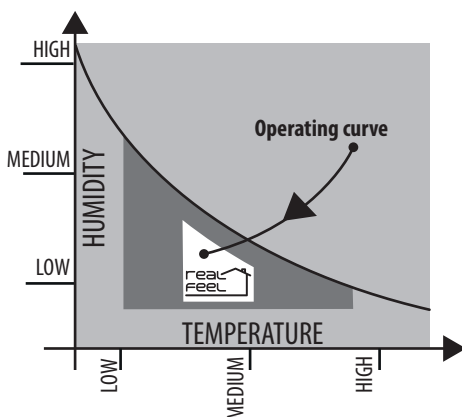

REAL FEEL light (C9) changes color when approaching the best comfort level (see following diagram).

ORANGE LIGHT: Room conditions far from optimal level.

GREEN LIGHT: Most people feel good room conditions, near optimal level.

BLUE LIGHT: Best comfort level.

- The well-being feeling is a subjective condition: for this reason, different people may judge differently the same environmental conditions.
- In particularly severe environmental conditions (large size of the environment, high temperature or humidity outside, poor insulation of the room, too many of people or strong heat load in the room, strong exposure to the sun ...) this device may not be able to reach the best comfort level.

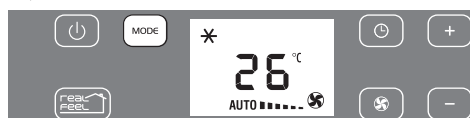

* AIR CONDITIONING MODE



Ideal for hot muggy weather when you need to cool and dehumidify the room. To set this mode:

- Touch repeatedly the **MODE** button until the conditioning symbol is displayed: the display shows the desired temperature.
- Press + (C4) or - (C5) buttons to adjust the desired temperature.
- Select the fan speed by pressing the button (C6).

You can choose:

- ..  **Minimum speed:** for silent operation.
-  **Medium speed:** reduces noise levels while maintaining a comfortable temperature.
-  **Maximum speed:** to achieve the target temperature as rapidly as possible.

AUTO  the appliance automatically selects the most suitable fan speed in relation to the temperature set on the digital display and current room temperature.

The most suitable temperature for the room during the summer varies from 75°F to 81°F (24 to 27°C). You are recommended, however, not to set a temperature much below the outdoor temperature.

SILENT MODE (available in conditioning mode only)

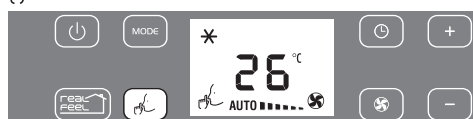

By activating this function, the operating noise is further reduced. To activate it, touch the  (C7) button. The display shows the relative symbol (C16).

DEHUMIDIFYING MODE

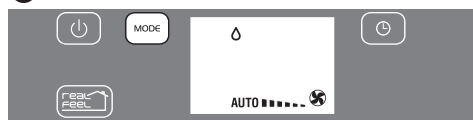

Ideal to reduce room humidity (spring and autumn, damp rooms, rainy periods, etc). In dehumidifying mode, the appliance **MUST** be set-up in the same way as for air conditioning, with the air exhaust hose (B2) attached to enable the moisture to be discharged outside. To set this mode:

- Touch repeatedly the **MODE** button until the dehumidifying symbol is displayed.

FAN MODE





When using the appliance in this mode, the air exhaust hose (B2) does not need to be connected.

To set this mode:

- Touch repeatedly the **MODE** button until the fan symbol is displayed.

- Select the fan speed by pressing the  button (C6).

You can choose:

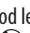
- ..  **Minimum speed:** for silent operation.
-  **Medium speed:** reduces noise levels but still maintains a good level of comfort.
-  **Maximum speed:** for maximum fan power.

CHANGING TEMPERATURE SCALE



The temperature can be displayed in °C or °F. To change the temperature scale, turn off the unit by pushing the  button, then keep pushed the **MODE** button for approximately 20 seconds. The appliance emits a beep to confirm.

SETTING THE TIMER



The timer can be used to delay appliance start up or shutdown. This avoids wasting electricity by not operating the appliance when it is not needed.

How to program delayed start up

- Plug the appliance into the mains and turn the unit to standby.
- Touch the timer button (C3): the timer symbol (C13) and the number of hours come on.
- Use the + (C4) or - (C5) buttons to set the number of hours delay before the appliance comes on.
- The appliance works using the mode previously set.

The appliance can be set to come on within the next 24 hours. A few second after set, the setting is memorised, the timer symbol is lit and the display shows that the appliance is in standby. To delet the setting, touch two times the timer button (C3). The timer symbol (C14) switches off.

How to program delayed shutdown

- With the air conditionin on, in every mode, it is possible to set the delayed shutdown.
- Touch the Timer (C3) button: the timer symbol (C13) and the hours switch on.
- Use the + (C4) or - (C5) buttons to set the number of hours delay before the appliance turns off.

A few second after set, the setting is memorised, the timer symbol is lit and the display shows the current mode.

At the end of the set time the appliance automatically turns in

standby mode.

To delete the setting, touch two times the timer button (C3). The timer symbol (C13) switches off.

OPERATING FROM THE REMOTE CONTROL

USING THE REMOTE CONTROL

- Point the remote control at the receiver (A11) on the air conditioner. The remote control must be no more than 16 ft (5 metres) away from the appliance (without obstacles between the remote control and the receiver).
- The remote control must be handled with extreme care. Do not drop it or expose it to direct sunlight or sources of heat.

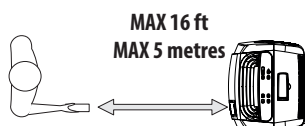

NOTE: The remote control can be safely stored in the appropriate compartment A12 (see figure).

DESCRIPTION OF THE REMOTE CONTROL (D)

- D1)** ON/OFF button
- D2)** Increase/decrease temperature/programmed operation
- D3)** “MODE” selection button
- D4)** Fan speed selection button ()
- D5)** REAL FEEL selection button
- D6)** SILENT MODE selection button
- D7)** Switch button °C/°F
- D8)** TIMER button

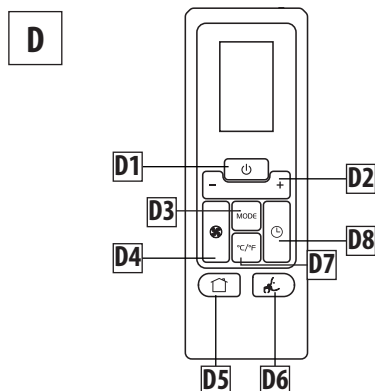

INSERTING OR REPLACING THE BATTERIES

- Remove the cover on the rear of the remote control;
- Replace the old batteries with two new R03 “AAA” 1.5V batteries, inserting them correctly (see the instructions inside the battery compartment);
- Replace the cover.

If the remote control unit is replaced or discarded, the batteries must be removed and disposed of in accordance with current legislation as they are harmful to the environment. Do not mix old and new batteries.

Do not mix alkaline, standard (carbon-zinc) or rechargeable (nickel-cadmium) batteries. Do not dispose of batteries in fire. Batteries may explode or leak. If the remote control is not be used for a certain length of time, remove the batteries.

TURNING THE APPLIANCE ON

- Plug into the outlet.
- Press the button (D1) (when turned on, the air conditioner starts operating in the same mode as when it was turned off).
- To switch the appliance off, press button (D1), then remove the plug.



NOTE: Never switch the appliance off by removing the plug. Always switch it off by pushing on the button and waiting few minutes before removing the plug. Only in this way the appliance will perform the standard checkings.

MODE SELECTION

The controls on the remote control are the same as those on the control panel of the appliance (C). You should therefore refer to the instructions in the chapter “OPERATING FROM THE CONTROL PANEL” to select the desired functions. Press button D7, to switch the temperature display from °C to °F and vice versa.

SELF-DIAGNOSIS

The appliance has a self diagnosis system to identify a number of malfunctions.
Error messages are displayed on the appliance display.

<div>IF ... IS DISPLAYED,</div> <div></div> <div>"Low Temperature" (frost prevention)</div> <div>..WHAT SHOULD I DO?</div> <div>The appliance is fitted with a frost protection device to avoid excessive formation of ice. The appliance starts up again automatically when the defrosting process is completed.</div>	<div>IF ... IS DISPLAYED,</div> <div></div> <div>Probe Failure (Probe damaged)</div> <div>..WHAT SHOULD I DO?</div> <div>If this is displayed, contact your local authorized service center.</div>	<div>IF ... IS DISPLAYED,</div> <div></div> <div>"High Level" (Internal tray full)</div> <div>..WHAT SHOULD I DO?</div> <div>Empty the internal safety tank following the instructions in the section "End of season operations". If HL alarm reoccurs frequently in Air Conditioning, Dehumidifying or Real Feel mode, contact your local authorized service center.</div>
---	--	---

TIPS FOR CORRECT USE

To ensure optimal results from your air conditioner, follow these recommendations:

- close the windows and doors in the room to be air conditioned. When installing the air conditioner semi-permanently, you should leave a door slightly open (as little as 0.39 inch. (1 cm)) to guarantee proper ventilation.

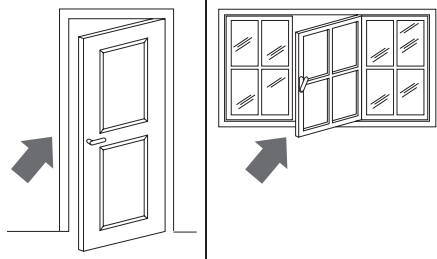

Close doors and windows

- Never use the appliance in very damp rooms (laundries for example).
- Protect the room from direct exposure to the sun by partially closing curtains and/or blinds to make the appliance much more economical to run

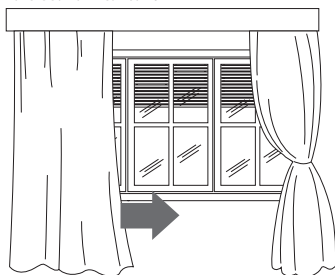

Close blinds or curtains

- Never use the appliance outdoors.
- Make sure there are no heat sources in the room;
- make sure the air conditioner is standing on a level surface.

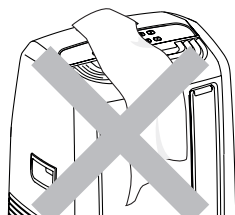

do not cover the appliance

- Never rest objects of any kind on the air conditioner;
- Never obstruct the air intake or outlet grilles;

CLEANING

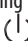
Before cleaning or maintenance, turn the appliance off by touching the  button, then unplug from the outlet.

CLEANING THE CABINET

You should clean the appliance with a slightly damp cloth then dry with a dry cloth. For safety reasons, never wash the air conditioner with water.

Precautions

Never use petrol, alcohol or solvents to clean the appliance. Never spray insecticide liquids or similar.

CLEANING THE AIR FILTER

To maintain the efficiency of the air conditioner, it is recommended to clean the dust filter after every week of use. The filter is located near the intake grille and the grille is located on the filter housing.

To clean the filter, it must be removed as shown in figure 9.

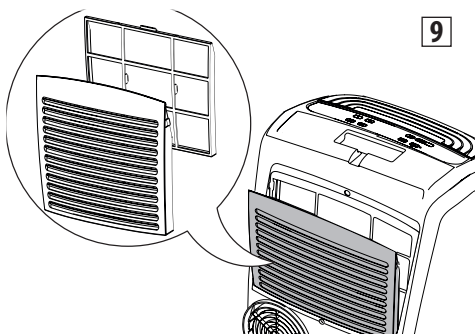

Use a vacuum cleaner to remove any dust. If it is very dirty, submerge it in warm water and rinse it several times. The water temperature must be kept below 40° C.

After washing the filter, allow it to dry.

To replace, put the filter back in its housing.

START OF SEASON CHECKS

Make sure the power cable and plug are undamaged and the earth system is efficient.

Follow the installation instructions precisely.

END OF SEASON OPERATIONS

To drain all water from the circuit, remove the external cap by unscrewing it in the anticlockwise direction then, remove the

internal cap from the drainage on the back of the appliance and allow the water to drain out into a basin (fig. 10).

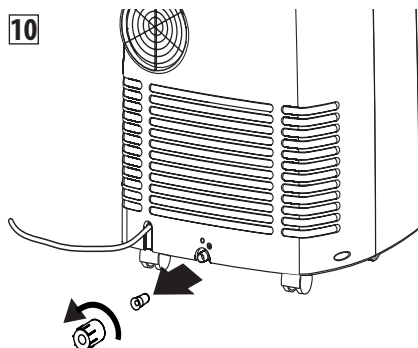

When the appliance is empty, replace the caps.
Clean the filter and dry thoroughly before putting back.

TECHNICAL SPECIFICATIONS

Power supply voltage	see rating label
Max. absorbed power	
during air conditioning	"
Refrigerant	"
Cooling capacity	"

LIMIT CONDITIONS

Room temperature for	
air conditioning	18° ÷ 35°C

Transport, filling, cleaning, recovery and disposal of refrigerant should be performed by a technical service centre appointed by the manufacturer only.

The appliance should be disposed of by a specialist centre appointed by the manufacturer only.

TO AVOID DAMAGE TO THE UNIT:

NEVER TRANSPORT OR TURN THE APPLIANCE UPSIDE DOWN OR ON ITS SIDE. IF THIS OCCURS, WAIT 6 HOURS BEFORE TURNING THE APPLIANCE ON, 24 HOURS IS RECOMMENDED. After the unit has been on its side, oil needs to return to the compressor to ensure proper function. Without allowing the unit this time (6-24 hours) the unit may function for only a short time, and then the compressor will break down from lack of oil.

ELECTRICAL CONNECTION

This appliance is equipped with a 3 prong grounded plug. The plug must be connected into an outlet that is properly installed and grounded in the accordance with all local codes and ordinances. Do not modify the plug provided with the appliance. If it will not fit the outlet, have a proper outlet installed by a qualified electrician or relocate the unit to a proper outlet. If the household electrical supply does not meet the above specifications, or if you are not sure your home has an effective electrical ground, have a qualified electrician or your local electrical utility company check it and correct any problems.

TROUBLESHOOTING

PROBLEM	CAUSE	SOLUTION
The air conditioner does not come on	it is not plugged into the outlet	plug into the outlet
	there is no current	wait
	the internal safety device has tripped	call the Service Center
The air conditioner works for a short time only	there are bends or kinks in the air exhaust hose	position the air hose correctly, keeping it as short and free of curves as possible to avoid bottlenecks
	something is preventing the air from being discharged	check and remove any obstacles obstructing air discharge
Real feel mode: green and/or blue lights do not appear	the technical specification of the appliance is not adequate for the room in which it is located and/or environmental conditions are particularly severe	
The air conditioner works, but does not cool the room	windows, doors and/or curtains open	close doors, windows and curtains, bearing in mind the "TIPS FOR CORRECT USE" given above
	there are heat sources in the room (oven, hairdryer, etc	eliminate the heat sources
	the air exhaust hose is detached from the appliance	fit the air exhaust hose in the housing at the back of the appliance (fig. 1)
	dust filters clogged	clean or replace the filters as described above
	the technical specification of the appliance is not adequate for the room in which it is located	
During operation, there is an unpleasant smell in the room	dust filter and electrostatic filter clogged	clean the filters as described above
The air conditioner does not operate for about three minutes after restarting it	prevents the appliance from being restarted until three minutes have elapsed since it was last turned off	wait. This delay is part of normal operation.
The symbol  and one of the following messages: <i>HL/PF</i>	the appliance has a self diagnosis system to identify a number of malfunctions.	see the SELF-DIAGNOSIS chapter