

IMPORTANT SAFEGUARDS

- Use the appliance as described in this instruction manual only.
As with all electrical equipment, whilst the instructions aim to cover as many eventualities as possible, caution and common sense should be used when operating and installing the appliance.
- This appliance is designed for home air conditioning and must not be used for other purposes.
- It is dangerous to modify or alter the characteristics of the appliance in any way.
- The appliance must be installed in conformity with national legislation regulating electrical equipment and installations.
- If the appliance requires repair, contact the manufacturer's Customer Services only. Repairs carried out by unauthorised personnel may be dangerous.
- This appliance must be used exclusively by adults.
- The appliance is not intended for use by persons (including children) with reduced physical, sensory or mental capabilities, or lack of experience and knowledge, unless they have been given supervision or instruction concerning use of the appliance by a person responsible for their safety.
Children must be supervised to ensure they do not play with the appliance.
- The appliance must be connected to an efficient earth system. Have your electricity installation checked by a qualified electrician.
- Do not use extension cables.
- Before cleaning or maintenance, always unplug the appliance from the mains socket.
- Never unplug the appliance by pulling on the power cable.
- Do not install the appliance in rooms containing gas, oil or sulphur. Do not install near sources of heat.
- Keep the appliance at least 50 cm away from flammable substances (alcohol etc) or pressurised containers (e.g. aerosol cans).
- Do not rest heavy or hot objects on top of the appliance.
- Clean the air filter at least once a week.
- Avoid using heating appliances near the air conditioner.
- The appliance must always remain upright or laid on one side during transportation. Before moving the appliance, empty the internal circuit completely of water. After moving the appliance, wait at least 1 hour before starting it.
- When putting the appliance away, do not cover with plastic bags.
- The materials used for packaging can be recycled. You are therefore recommended to dispose of them in special differentiated waste collection containers.
- At the end of its working life, consign the appliance to a specialist collection centre.
- If the power cable is damaged, it must be replaced by the manufacturer or the manufacturer's Customer Services in order to avoid all risk.

SPECIFIC WARNINGS FOR APPLIANCES WITH R410A* REFRIGERANT GAS

R410A refrigerant gas conforms to EC regulations on the environment. Avoid perforating the refrigerant circuit of the appliance.

ENVIRONMENTAL INFORMATION: This unit contains fluorinated greenhouse gases covered by the Kyoto Protocol. Maintenance and disposal must be carried out by qualified personnel only (R410A, GWP=1975).

** Verify the type of refrigerant gas used in your appliance on the rating plate.*

PREPARING FOR USE

DESCRIPTION

- | | | | |
|----|------------------------------|----|--------------------------|
| 1 | Air outlet grille | 11 | Air exhaust hose |
| 2 | Control panel | 12 | Hose adapter (2 pieces) |
| 3 | Handles | 13 | Window bracket grille |
| 4 | Castors | 14 | Bung for hole in bar |
| 5 | Filter | 15 | Window bracket |
| 6 | Evaporator air intake grille | 16 | Window bracket extension |
| 7 | Air exhaust hose housing | 17 | Screws |
| 8 | Condenser air intake grille | 18 | Window outlet |
| 9 | Power cable | 19 | Remote control |
| 10 | Drain hole bung | | |

ELECTRICAL CONNECTIONS

Before plugging the appliance into the mains socket, check that:

- the mains power supply corresponds to the value indicated on the rating plate on the back of the appliance;
- the power socket and mains electricity supply are adequate for the appliance;
- the mains socket matches the plug. If this is not the case, have the plug replaced;
- the mains socket is adequately earthed. **Failure to follow these important safety instructions absolves the manufacturer of all liability.**

The power cable must be replaced by a qualified professional only.

The instructions below will enable you to prepare your air conditioner for operation as efficiently as possible.

Before use, make sure the air intake and outlet grilles are unobstructed.

AIR CONDITIONING WITHOUT INSTALLATION

Just a few simple steps and your air conditioner will ensure your comfort:

- Screw one of the hose adapters **12** to one end of the air exhaust hose. **11**.
- Fit the other adapter **12** to the air exhaust hose housing **7** at the back of the appliance (see fig. **A**).
- Screw the end of the hose without adapter to the adapter previously mounted on the appliance (see fig. **A**).

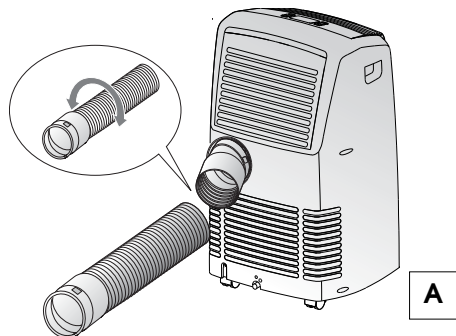

Vertically sliding window

- Fit the window bracket grille **13** to the window bracket **15** and fix with the four screws provided **17** (fig. **B**).

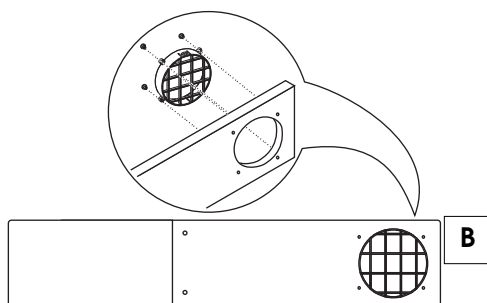

- Open the window.
- Place the bar **15** in the window and extend it for the width of the window (fig. **C**).
- Once the bar has been extended, fix it by screwing up the remaining two screws supplied.
- Lower the window (fig. **D**).

PREPARING FOR USE

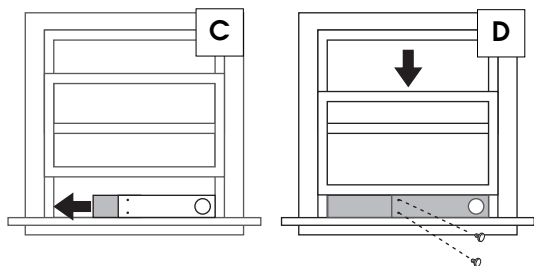

- Place the air conditioner near the window. Insert the assembled air exhaust hose **11** in the grille on the bar **15** (fig. **E**). Make sure the air exhaust hose is not blocked.
- When the appliance is not in use, the hole in the bar can be closed with the bung **14** provided.

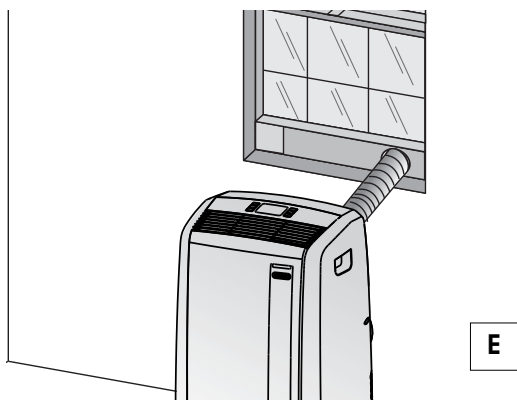

Double window

- Fit the window outlet **18** to the air exhaust hose **11** pre-assembled as shown in fig. **F**.

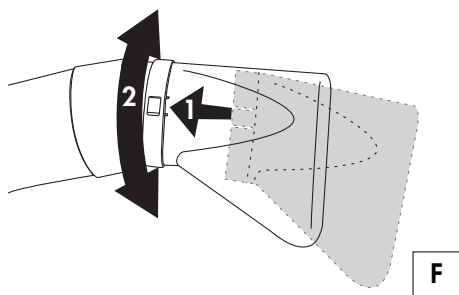

- Open the window or French window slightly and position the outlet **18** as shown in fig. **G**

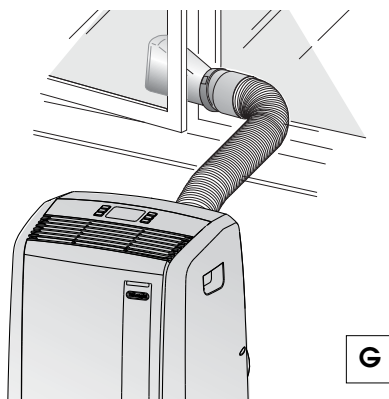

Keep the air hoses as short and free of curves as possible to avoid bottlenecks.

If the windows are large, use the window bracket extension (16) (if provided) to cover your window aperture, extending it to the required length, then blocking it with the screws supplied (see figure **H**). Make sure you do not cover the hole for the window outlet.

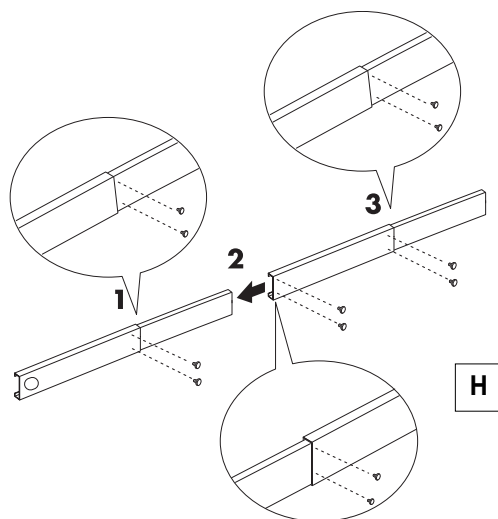

THE CONTROL PANEL

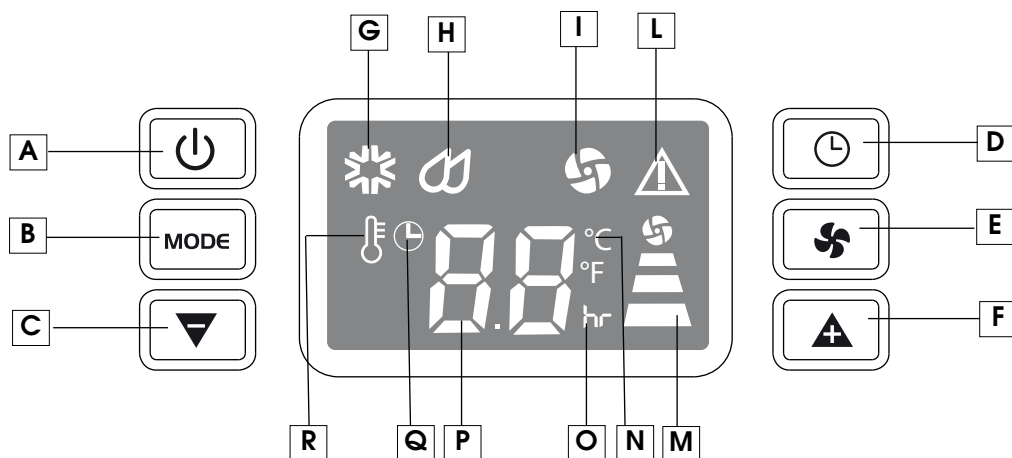

DESCRIPTION OF THE CONTROL PANEL

- A** ON /OFF button
- B** MODE selection button
Air conditioning, dehumidifying, fan
- C** Reduce temperature/programme mode time button
- D** Timer button
- E** Fan speed button (MAX/MED/MIN)
- F** Increase temperature/programme mode time button
- G** Air conditioning symbol
- H** Dehumidifying symbol
- I** Fan symbol
- L** Alarm symbol
- M** Fan speed indicator
- N** Temperature scale indicator
- O** Time indicator
- P** Set temperatures and programmed on/off time
- Q** Timer symbol
- R** Set temperature symbol

✓ Never turn the air conditioner off by unplugging from the mains. Always press the (⏻) button, then wait for a few minutes before unplugging. This allows the appliance to perform a cycle of checks to verify operation

USE

TURNING THE APPLIANCE ON

Plug the appliance into the mains.

Two lines appear on the display indicating that the appliance is in stand-by.

Press the  button (A).

The first time the appliance is turned on, it will be in air conditioning mode and fan speed will be at minimum. When turned on subsequently it will be in the same mode as when last turned off.

Press the **MODE** button (B) until the symbol corresponding to the required mode is displayed:

 Air conditioning symbol (G)



 Dehumidifying symbol (H)

 Fan symbol (I)

AIR CONDITIONING MODE

Ideal for hot muggy weather when you need to cool and dehumidify the room.

To set this function correctly:

- Press the MODE button a number of times until the air conditioning symbol appears.
- Select the target temperature by pressing the  button (F) or  button (C) until the required value is displayed.
During selection, the temperature flashes.
- Select the required fan speed by pressing the  button.

There are 3 speeds available:



High speed: to achieve the target temperature as rapidly as possible



Medium speed: reduces noise levels but still maintains a good level of comfort



Low speed: for silent operation

The most suitable temperature for the room during the summer varies from 24 to 27°C. You are recommended, however, not to set a temperature much below the outdoor temperature.



DEHUMIDIFYING MODE

Ideal to reduce room humidity (spring and autumn, damp rooms, rainy periods, etc). For this mode, the appliance should be prepared in the same way as for air conditioning, with the air exhaust hose attached to enable the moisture to be discharged outside.

To set this function correctly:

- Press the **MODE** button a number of times until the dehumidifying symbol appears.

NOTE: In this mode, with room temperature above 25 degree C, the fan speed is adjustable. If the temperature is below, fan speed is selected automatically by the appliance and cannot be set manually.



FAN MODES

When using the appliance in this mode, the air exhaust hose does not need to be attached.

To set this function correctly:

- Press the **MODE** button a number of times until the fan symbol appears.
- Select the required fan speed by pressing the  button.

There are 3 speeds available:



High speed: for maximum fan power;





Medium speed: reduces noise levels but still maintains a good level of comfort;



Low speed: for silent operation.



PLEASE NOTE: To change the unit of measurement for the displayed temperature, press the  and  buttons together for 3 seconds.



SETTING THE TIMER

SETTING THE TIMER

The timer can be used to delay when the appliance comes on or goes off. This avoids wasting electricity by optimising operating periods.

How to programme delay ON

- Plug the appliance into the mains socket. It will be in STAND-BY.
- Press the timer button (D). The timer symbol Q comes on.
- Use the ▲ (F) or ▼ (C) buttons to set the number of hours delay before the appliance comes on. They increase or decrease the time in steps of an hour.

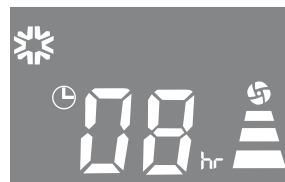

The appliance can be set to come on within the next 24 hours.

Five seconds after the timer has been set, the display dims and the setting is memorised.

PLEASE NOTE: after setting, the operating mode and fan speed can be modified.

To cancel the timer programme, press the timer button (D) again.

Pressing the ON/OFF button (A) cancels the timer programme and the air conditioner comes on immediately in the selected mode.

How to programme delay OFF

- Delay OFF can be programmed in any operating mode - air conditioning/fan/dehumidifying.
- Press the timer button (D). The timer on symbol Q comes on.
- Use the ▲ (F) or ▼ (C) buttons to set the number of hours delay before the appliance goes off.

They increase or decrease the time in steps of an hour.

The appliance can be set to go off within the next 24 hours.

Five seconds after the timer has been set, the operating mode is displayed and the timer symbol remains on.

At the set time, the air conditioner goes off and remains in stand-by.

To cancel the timer programme, press the timer button (D) again. The timer symbol goes off.

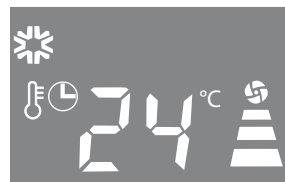

PLEASE NOTE: after setting, the operating mode and fan speed can be modified.

USING THE REMOTE CONTROL UNIT

MODELS WITH REMOTE CONTROL

- Point the remote control at the receiver on the air conditioner. The remote control must be no more than 5 metres away from the appliance (without obstacles between the remote control and the receiver).
- The remote control must be handled with **extreme care and respect**. Do not drop it or expose it to direct sunlight or sources of heat.

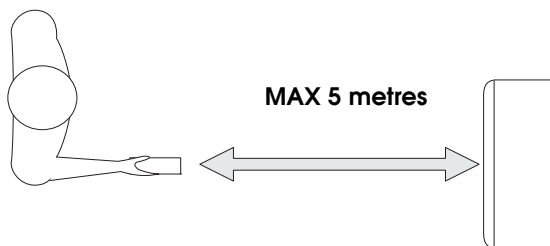

DESCRIPTION OF THE REMOTE CONTROL

20) "ON/OFF" button

21) "MODE" button

22) Temperature decrease/increase and programme mode button

23) "TIMER" button

24) Fan speed button (MAX/MED/MIN)

25) °F/°C switching button

Replacing the batteries

- Remove the cover on the back of the remote control;
- Insert two new LR03 "AAA" 1.5V batteries, making sure they are in the correct position (see the instructions inside the battery compartment);
- Replace the cover.

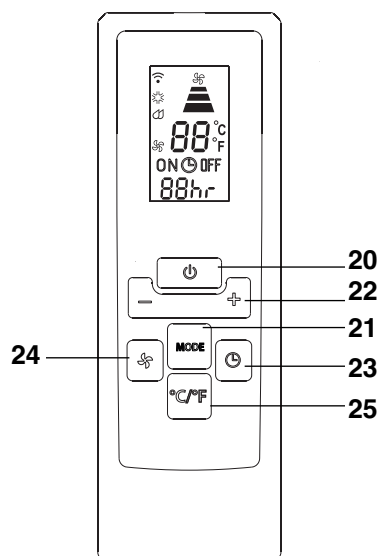

If the remote control unit is replaced or discarded, the batteries must be removed and disposed of in accordance with current legislation as they are harmful to the environment.

Do not mix alkaline, standard (zinc-carbon) and rechargeable (nickel-cadmium) batteries. Do not throw the batteries in the fire as they could explode or leak dangerous liquids.

TURNING THE APPLIANCE ON

Plug the appliance into the mains.

Press the **ON/OFF** button of the remote control (20) (when turned on, the air conditioner starts operating in the same mode as when last turned off).

Press the **MODE** button (21) button to select the required mode:

AIR CONDITIONING (COOLING)

DEHUMIDIFYING

FAN ONLY

The light corresponding to the selected mode lights up on the control panel.

For air conditioning/dehumidifying/fan only settings and programming the timer, see the paragraphs on pages 32-34.

TIPS

To get the best from your air conditioner, follow these recommendations:

- close the doors and windows of the room to be air conditioned. The only exception is when the appliance is installed through a hole in the wall. In this case, you are recommended to leave a slight draught through a door or window to guarantee correct ventilation.

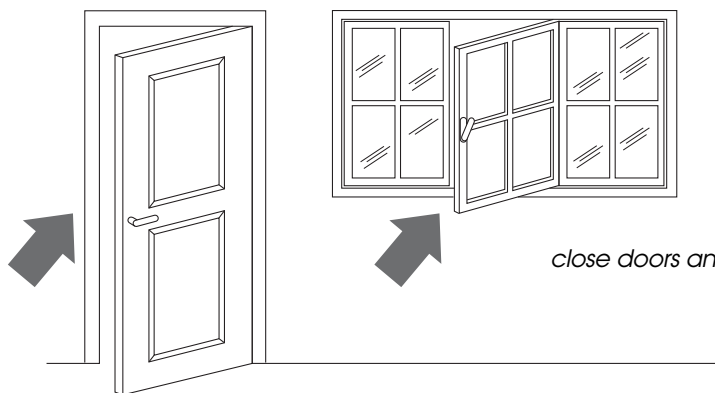

close doors and windows

- Protect the room from direct exposure to the sun by partially closing curtains and/or blinds to make the appliance much more economical to run;
- Never rest objects of any kind on the air conditioner;
- Do not obstruct the air intake **6** or outlet **1**;
- Make sure there are no heat sources in the room.

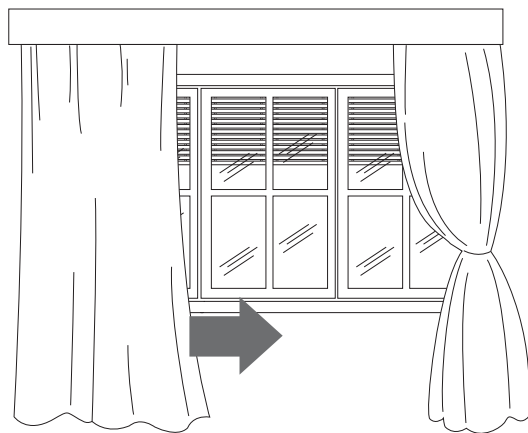

close blinds or curtains

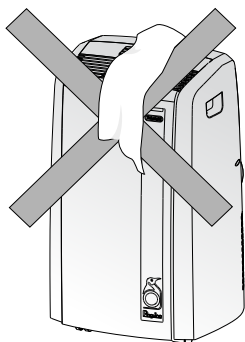

*do not cover
the appliance*

- Make sure the air conditioner is on a flat floor.

CLEANING

Before cleaning or maintenance, turn the appliance off by pressing the ON/OFF button (A) or in models with remote control, by pressing the ON/OFF button [20], then always unplug the appliance from the mains socket.

CLEANING THE CABINET

You should clean the appliance with a slightly damp cloth then dry with a dry cloth. For safety reasons, never wash the air conditioner with water.

Precautions

Never use petrol, alcohol or solvents to clean the appliance. Never spray insecticide liquids or similar.

CLEANING THE AIR PURIFYING FILTERS

To keep your air conditioner working efficiently, you should clean the dust filter every week of operation.

The filter is housed in the intake grille.

To clean the filter, extract as shown in fig. I.

Use a vacuum cleaner to remove the dust collected on the filter. If it is very dirty, immerse in warm water and rinse a number of times. The water should never be hotter than 40°C. After washing, leave the filter to dry.

To remount, put the filter back in its housing.

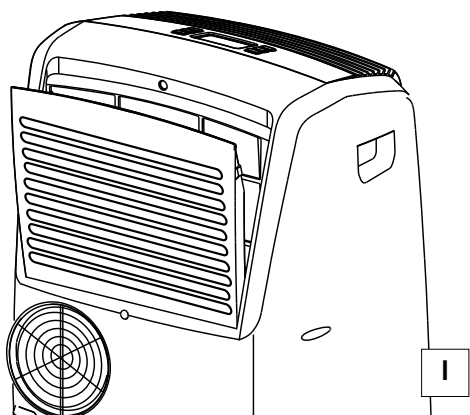

START OF SEASON CHECKS

Make sure the power cable and plug are undamaged and the earth system is efficient. Follow the installation instructions precisely.

END OF SEASON OPERATIONS

To drain all water from the circuit, remove the external cap by unscrewing it in the anti-clockwise direction then, remove the internal cap from the drain hose on the back of the appliance and allow the water to drain out into a basin (figure L).

When the appliance is empty, replace the caps.

Clean the filter and dry thoroughly before putting back.

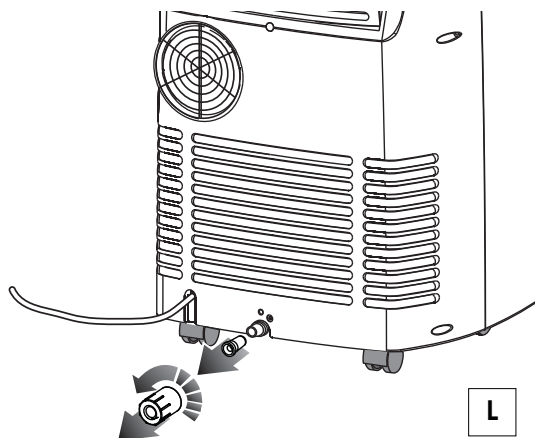



TROUBLESHOOTING

PROBLEM	CAUSE	REMEDY
The air conditioner does not come on	<ul style="list-style-type: none">there is no currentthe appliance is not plugged into the mainsThe safety device has tripped	<ul style="list-style-type: none">waitplug into the mains socketContact your local Customer Services
The air conditioner works for a short time only	<ul style="list-style-type: none">the air exhaust hose has a constrictionthe air exhaust hose is blockedthere are bends in the air exhaust hose	<ul style="list-style-type: none">position the air exhaust hose correctlycheck there are no obstacles obstructing air dischargeeliminate the bends
The air conditioner works, but does not cool the room	<ul style="list-style-type: none">window openthere are heat sources in the room (burner, lamp, etc)the exhaust hose is detachedair filter cloggedthe air conditioner is not powerful enough for the conditions or size of the room	<ul style="list-style-type: none">close the windoweliminate the heat sourceconnect the exhaust hoseclean or replace the filter
Particular odour in the room	<ul style="list-style-type: none">the air filter is clogged	<ul style="list-style-type: none">clean or replace the filter
The air conditioner does not operate for about 3 minutes after restarting it	<ul style="list-style-type: none">The safety device has tripped	<ul style="list-style-type: none">wait for 3 minutes
The alarm light (ALARM) L comes on	<ul style="list-style-type: none">The tray under the appliance is full	<ul style="list-style-type: none">Empty the tray (see paragraph on end-of-season operations on page 37).

SELF-DIAGNOSIS

The appliance has a self diagnosis system to identify a number of malfunctions. Error messages are displayed on the appliance display.

IF THE APPLIANCE DISPLAYS...	IF THE APPLIANCE DISPLAYS...	IF THE APPLIANCE DISPLAYS...
		
"Low Temperature"	"High Temperature"	"Probe Failure"
...THIS MEANS: room temperature is too low	...THIS MEANS: room temperature is too high	...THIS MEANS: contact your local Customer Services.

GUARANTEE/TECHNICAL SPECIFICATION

GUARANTEE AND CUSTOMER SERVICES

The conditions of the guarantee and customer service are given on the certificate supplied with your appliance.

TECHNICAL CHARACTERISTICS:

Power supply voltage	see rating plate
Max. power input during air conditioning	"
Refrigerant	"
Cooling capacity	"

LIMIT CONDITIONS	
Room temperature for air conditioning	21 ÷ 35°C

Transport, filling, cleaning, recovery and disposal of refrigerant should be performed by the Manufacturer's Customer Services only.

The appliance should be disposed of by a specialist centre authorised by the manufacturer only.