

WATER HARDNESS INDICATOR PAPER

SETTING WATER HARDNESS

The DESCALE message is displayed after a set period of time that depends on the hardness of the water. The machine is set by default for a hardness level of 4. The machine can also be programmed according to the hardness of the mains water in the various regions so that the machine needs to be descaled less often.

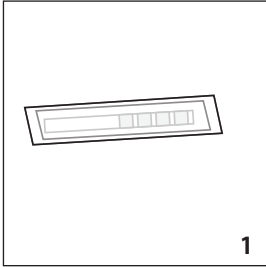





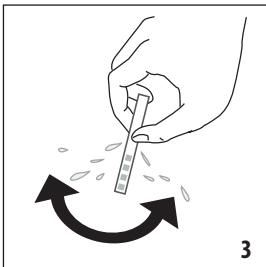
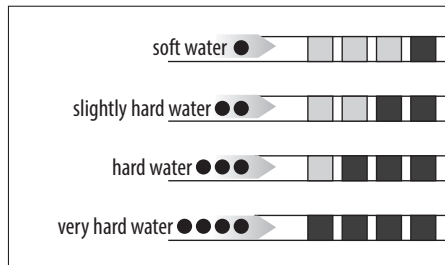
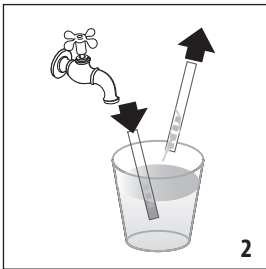

Measuring water hardness

1. Your machine includes an indicator paper (fig. 1).
2. Immerse the paper completely in a glass of water for one second (fig. 2)
3. Remove the paper from the water and shake lightly (fig. 3). After about a minute, 1, 2, 3, or 4 red squares form, depending on the hardness of the water. Each square corresponds to one level.



Setting water hardness

1. Press the MENU button to enter the menu;
2. Press the  or  button until "Water hardness" appears on the display (B1);
3. Confirm the selection by pressing the  button;
4. Press the  or  button repeatedly to set the level as measured by the indicator paper (see previous section);
5. Press the  button to confirm the setting.

The machine is now reprogrammed with the new water hardness setting. Press the **MENU** button to exit the menu.

