

Proudly distributed by
De'Longhi Australia Pty Limited
P.O. BOX 4540
CASULA MALL NSW 2170
Customer Service Ph: 1800 126 659
Fax: 1800 706932
www.delonghi.com.au
e-mail: info.au@delonghigroup.com

De'Longhi New Zealand Limited
99 Khyber Pass Road
Grafton 1023
Auckland, New Zealand
P.O. Box 58-056 Botany
MANUKAU 2163
Customer Service Ph: 0508 200 300
Fax: 0508 200 301
www.delonghi.co.nz
e-mail: info.nz@delonghigroup.com

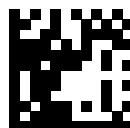

Register Now 
www.delonghi.com/register

EC78X-EC79X

COFFEE MAKER
Instructions for use



DeLonghi

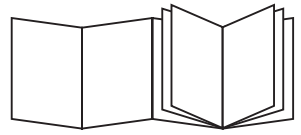

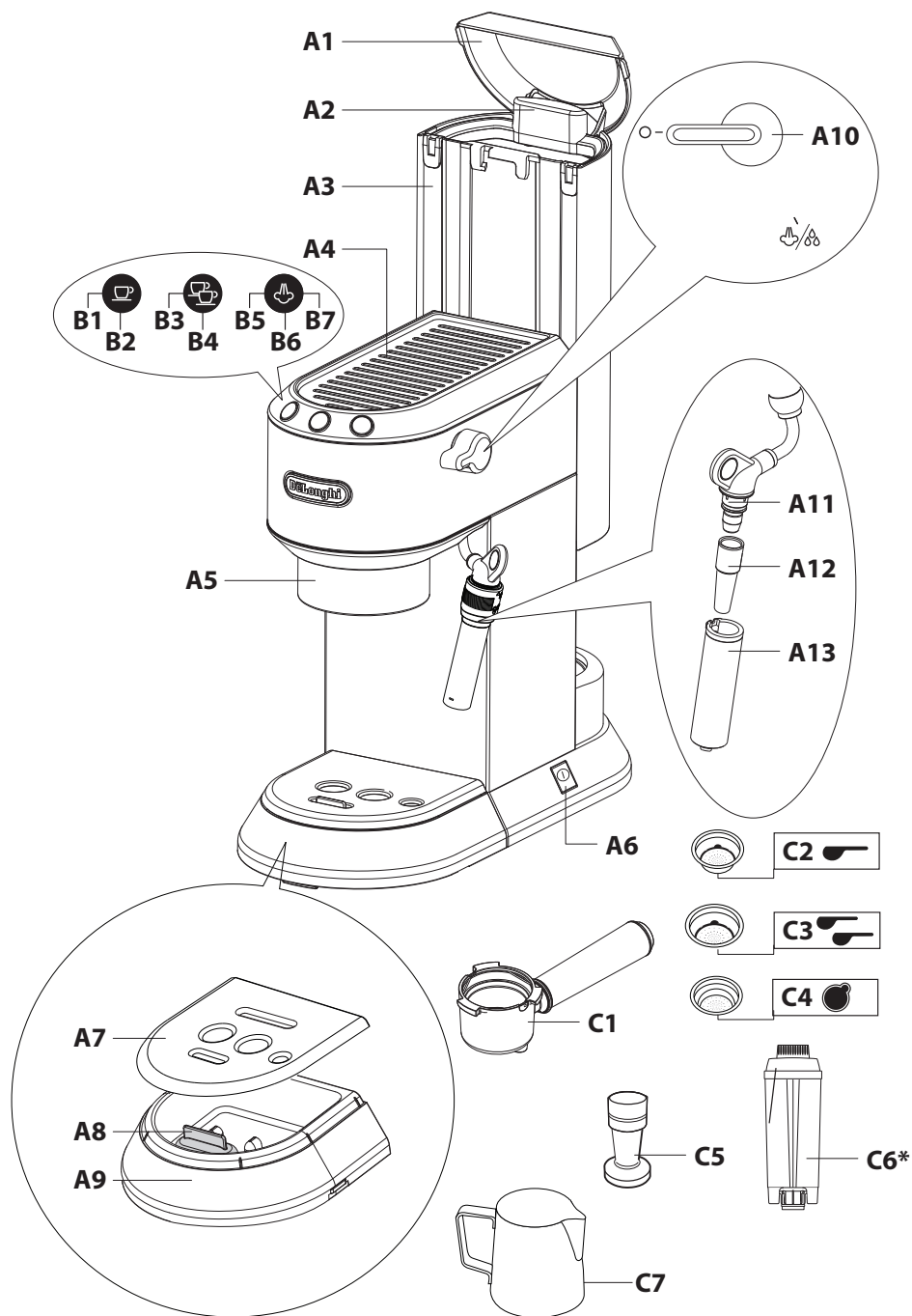

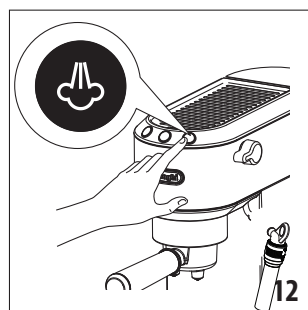
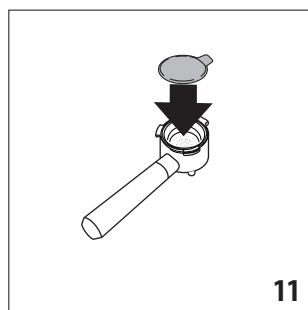
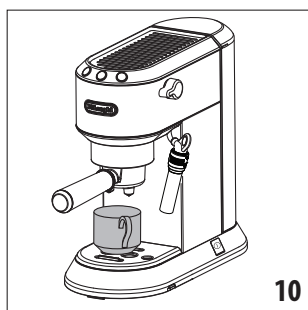
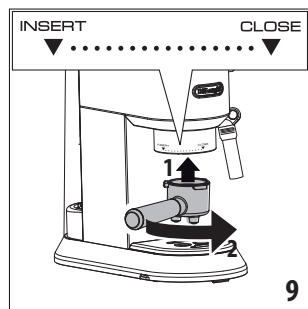
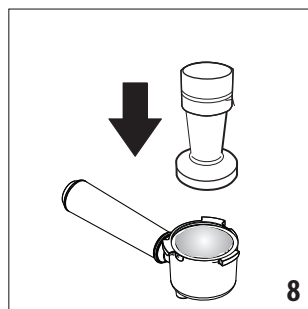
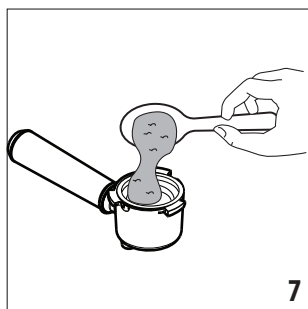
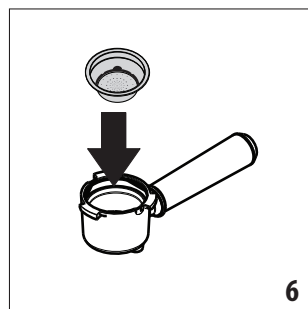
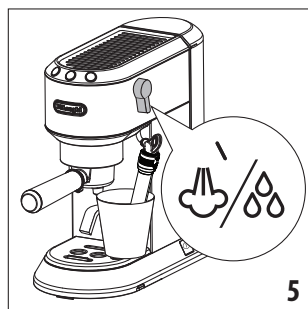
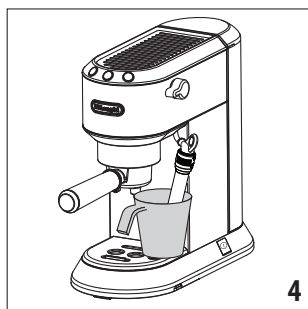
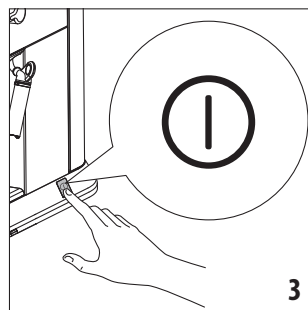
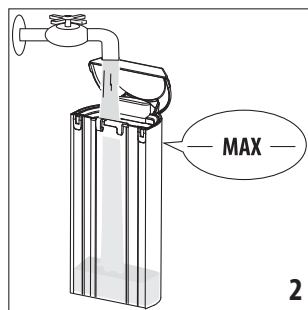

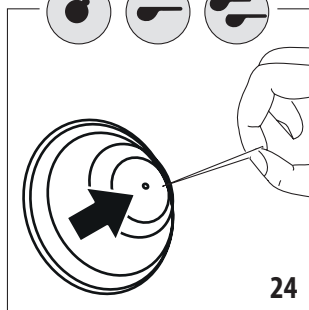
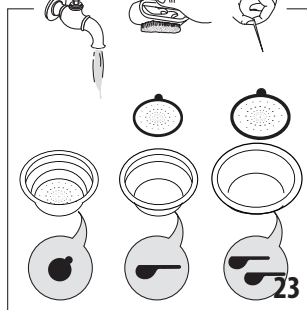
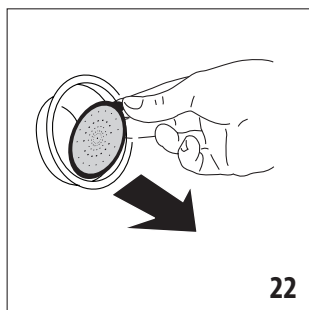
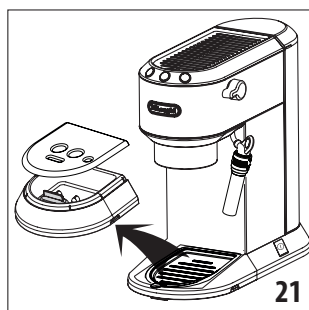
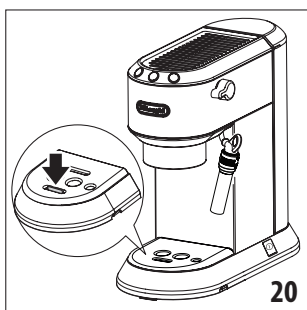
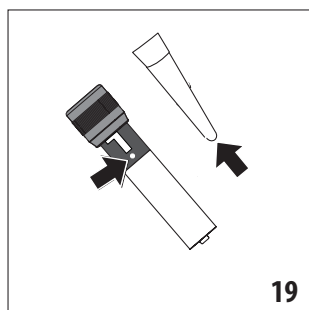
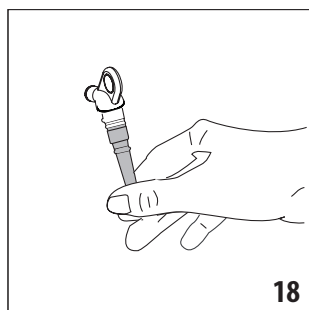
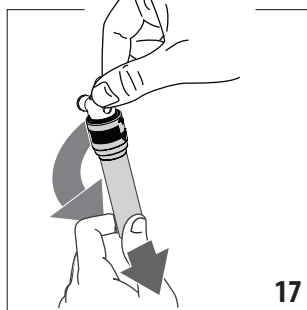
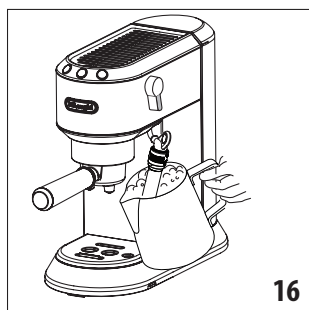
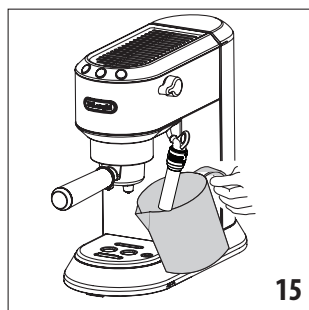
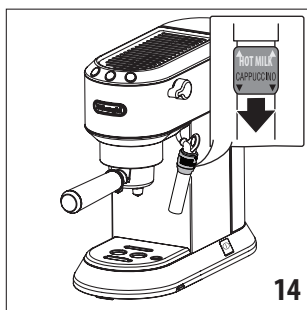
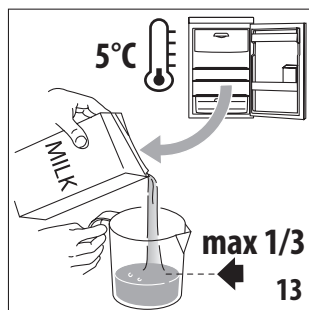

1. FUNDAMENTAL SAFETY WARNINGS

- The appliance is not intended for use by persons (including children) with reduced physical, sensory or mental capabilities, or lack of experience and knowledge, unless they have been given supervision or instruction concerning use of the appliance by a person responsible for their safety.
- Children should be supervised to ensure that they do not play with the appliance.
- Designated use: this appliance is designed and made to prepare beverages based on coffee, milk and hot water. Use drinking water only in the tank. Never use the accessories to make beverages other than those described in these instructions. Any other use is considered improper and thus dangerous. The manufacturer is not liable for damage deriving from improper use of the appliance.
- The surface of the heating element remains hot after use and the outside of the appliance may retain the heat for several minutes depending on use.
- Clean all the components thoroughly, taking particular care with parts in contact with the milk.
- Cleaning and user maintenance shall not be made by children without supervision.
- Never clean by immersing the appliance in water.
- IMPORTANT: to prevent damage to the appliance, do not clean with alkaline detergents; use a soft cloth and, where applicable, neutral detergent.
- This is an household appliance only. It is not intended to be used in: staff kitchen areas in shops, offices and other working environments; farm houses; by clients in hotels, motels and other residential type environments; bed and breakfast type environments.
- If the plug or power cord is damaged, it must be replaced by customer services only to avoid all risk.
- Appliances with removable cord: avoid splashes of water on the power cord connector or socket at the back of the appliance.
- IMPORTANT: Models with glass surfaces: do not use the appliance if the surface is cracked.
- The coffee maker must not be placed inside a cabinet or kitchen unit during use

FOR EUROPEAN MARKETS ONLY:

- This appliance can be used by children aged from 8 years and above if they have been given supervision or instruction concerning use of the appliance in a safe way and understand the hazards involved. Cleaning and user maintenance shall not be made by children unless they are above 8 years old and supervised. Keep the appliance and power cord away from children under 8 years of age.

- The appliance can be used by persons with reduced physical, sensory or mental capabilities or lack of experience and knowledge if they are supervised or have been given instruction concerning use of the appliance in a safe way and if they understand the hazards involved.
- Children shall not play with the appliance.
- Always unplug the appliance when left unattended and before assembly, taking apart or cleaning.



Surfaces marked with this symbol become hot during use (the symbol is present in certain models only).

This is an electrical appliance and may cause electric shock.

You should therefore follow these safety warnings:

- Never touch the appliance with damp hands or feet.
- Never touch the plug with damp hands.
- Make sure the socket used is freely accessible at all times, enabling the appliance to be unplugged when necessary.
- Unplug directly from the plug only. Never pull the cord as you could damage it.
- To disconnect the appliance completely you must unplug it from the mains socket.
- If the appliance is faulty, do not attempt to repair. Turn it off, unplug from the mains socket and contact Customer Services.
- Before cleaning the appliance, turn it off, unplug from the mains socket and allow to cool.

Important!

Keep all packaging (plastic bags, polystyrene foam) away from children.

CHOKING HAZARD. The appliance might contain small parts. Some of those small parts might be required to get disassembled during cleaning and maintenance operations. Handle with care and keep small parts out of reach of children.

Danger of burns!

This appliance produces hot water and steam may form while it is in operation.

During operation (automatic rinsing, hot beverage delivery, steam delivery, cleaning), avoid contact with splashes of hot water or steam.

When the appliance is in operation, the cup shelf could become very hot.

2. GENERAL INFORMATION

2.1 Instruction for Use

Read all the Instruction for Use carefully before using the appliance. Failure to follow this Instruction for Use may result in burns or damage to the appliance.

The manufacturer is not liable for damage deriving from failure to respect this Instruction for Use.

Please note:

These safety warnings are valid for all De'Longhi coffee machines.

Keep this leaflet together with the instructions accompanying the appliance.

If the appliance is passed to other persons, they must also be provided with this Instruction for Use.

3. BEFORE USE

3.1 Checking the appliance

After removing the packaging, make sure the product is complete and undamaged and that all accessories are present. Do not use the appliance if it is visibly damaged. Contact De'Longhi Customer Services.

3.2 Installing the appliance

When you install the appliance, you should respect the following safety warnings:

- The appliance gives off heat. After positioning the appliance on the worktop, leave a space of at least 3 cm between the surfaces of the appliance and the side and rear walls and at least 15 cm above the coffee maker.
- Water penetrating the appliance could cause damage. Do not place the appliance near taps or sinks.
- The appliance could be damaged if the water it contains freezes. Do not install the appliance in a room where the temperature could drop below freezing point.

- Arrange the power cord in such a way that it cannot be damaged by sharp edges or contact with hot surfaces (e.g. electric hot plates).

3.3 Connecting the appliance

Check that the mains power supply voltage corresponds to that indicated on the rating plate on the bottom of the appliance.

Connect the appliance to an efficiently earthed and correctly installed socket with a minimum current rating of 10A only.

If the power socket does not match the plug on the appliance, have the socket replaced with a suitable type by a qualified professional.

3.4 Setting up the appliance

The first time you use the machine, the water circuit is empty and the appliance could be very noisy. The noise becomes less as the circuit fills.

3.5 Cleaning and maintenance of materials in contact with food

- The first time you use the appliance, or if it is not used for more than 3 or 4 days, rinse all removable accessories which may come into contact with water or milk with hot water.
- If the appliance is not used for more than 3 or 4 days, before making the first beverage, rinse the water circuit as described in this Instruction for Use.
- You should carry out automatic cleaning and guided maintenance scrupulously when proposed by the appliance through the display or the lights described in the manual.

3.6 Making cappuccinos and milk-based coffees

- The appliance has been tested for use with cow's milk and the following products of plant origin: soya, rice and almond. No other type of milk or product of plant origin may be used.
- To clean the system, following use with any type of milk, please follow the standard procedures described in the instruction manual
- The cleaning methods provided by the manufacturer and described in the instructions do not guarantee the complete removal of allergens.
- In the case of confirmed or suspected allergies and intolerances, make sure that your machine has not been previously used with any milk or product of plant origin containing the allergens you are allergic or the substances you are intolerant to.

4. DESCRIPTION (page 3)

The terminology below will be used repeatedly on the following pages.



4.1 Description of the appliance

- A1. Water tank lid
- A2. Tank extraction handle
- A3. Water tank
- A4. Cup warmer
- A5. Coffee outlet
- A6. ON/OFF switch
- A7. Cup tray
- A8. Drip tray full indicator
- A9. Drip tray
- A10. Mugs or glasses tray
- A11. Steam dial
- A12. Hot water/steam spout
- A13. Hot water/steam connection nozzle
- A14. Cappuccino maker selection ring
- A15. Hot water/steam connection tube

4.2 Description control panel

- B1. One cup button
- B2. ON light on button (white)
- B3. Two cups button
- B4. ON light on button (white)
- B5. Steam button
- B6. ON light on button (white)
- B7. Descale light (orange)

4.3 Description of the accessories

- C1. Filter holder
- C2. 1 cup filter ( symbol under filter)
- C3. 2 cup filter ( symbol under filter)
- C4. Pod filter ( symbol under filter)
- C5. Tamper
- C6. Water softener filter (*not included, can be purchased from authorised Customer Services)
- C7. Milk Jug

5. FILLING THE WATER TANK

Please note:

Before first use, wash all the accessories and water tank with warm water.

1. Extract the tank by pulling it upwards (fig. 1).
2. Open the lid and fill the tank with fresh clean water, taking care not to exceed the MAX level (fig. 2). Put the tank back in the appliance, pressing lightly to open the valves located on the bottom of the tank.

- More simply, the tank can also be filled without removing it, pouring the water directly from a jug.

Important:

Never operate the appliance without water in the tank or without the tank.

Please note:

It is normal for there to be water in the space under the tank. This should therefore be dried regularly with a clean sponge.

6. FIRST USE

At first use, rinse the internal circuit as follows:

- Turn the appliance on by pressing the ON/OFF switch (fig. 3). The appliance performs a self-diagnosis cycle, indicated by sequential flashing of the three buttons.
- The ☕ and ☕ lights flash to indicate the appliance is heating up. When the lights stop flashing and remain on steadily, the appliance is ready for operating the rinse.
- Attach the filter holder to the appliance (fig. 9).
- Place a container with a minimum capacity of 500 ml under the coffee outlet (A5) (fig. 4) and press the ☕ button. Repeat this operation 5 times.
- Empty the container and put it under the hot water/steam spout (A12) (fig. 4).
- Turn the hot water/steam dial to the ☕/8 position (fig. 5) and deliver to empty the water tank (A3); then turn the knob to the ○ position.

7. PROGRAMMING THE SETTINGS MENU

To access the menu, make sure the appliance is ready for use, then press and hold the ☕ button for 10 seconds until the three buttons flash in sequence:

The appliance is now in programming mode.

Set the coffee maker as you wish, then exit the settings menu by waiting for 15 seconds.

Please note:

If no selections are made for 15 seconds, the appliance automatically exits programming and is ready for use again.

7.1 Setting coffee temperature

To modify the temperature of the water used to make the coffee, proceed as follows:

- Access the settings menu;
- Press the ☕ button to enter the coffee temperature selection mode. The lights corresponding to the current selection come on:



- The lights start flashing in sequence;
- Press the button corresponding to the required temperature:



- The ☕ button flashes to indicate that the selection has been saved.

The appliance exits the menu and is ready for use.

7.2 Setting water hardness

The light (B7) indicating that the coffee maker needs descaling comes on after a period of operation established according to water hardness.

The appliance can also be programmed according to the hardness of the mains water in the various regions so that descaling needs to be performed more or less frequently.

Proceed as follows:

- Access the settings menu;
- Press the ☕ button to enter the water hardness selection mode. The lights corresponding to the current selection come on:



- The lights start flashing in sequence;
- Press the button corresponding to the water hardness in your area:

| ☕ soft water | ☕ medium water | ☕ hard water |
|----------------------------|-------------------------------|----------------------------|
| <10°dH | 10°dH - 20°dH | >20°dH |
| <18°FH | 18°FH - 36°FH | >36°FH |
| <180mg/l CaCO ₃ | 180-360mg/l CaCO ₃ | >360mg/l CaCO ₃ |

- The ☕ button flashes to indicate that the selection has been saved.

The appliance exits the menu and is ready for use.

7.3 Adjusting auto-off (stand-by)

To save energy, an auto-off function turns the appliance off when not used for a long period. To turn it back on again, press any button on the control panel.

1. Access the settings menu;
2. Press the  button to enter the auto-off time selection mode. The lights corresponding to the current selection come on:

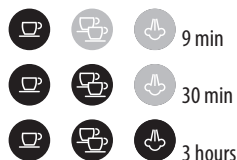

3. The lights start flashing in sequence;
4. Press the button corresponding to the required time:







5. The  button flashes to indicate that the selection has been saved.

The appliance exits the menu and is ready for use.

7.4 Default values (reset)

This resets all menu settings and programmed quantities back to the default values.

To reset the default values, proceed as follows:

1. Position the steam spout over the drip tray;
2. Access the settings menu;
3. Turn the steam dial to the  position;
4. Press the  button. The three lights flash simultaneously to confirm that the original settings have been restored.
5. The  and  lights flash to indicate that the steam dial must be closed again (○symbol).

When the steam dial has been closed, the appliance is ready for use.

8. HOW TO MAKE ESPRESSO COFFEE



8.1 Tips for a hotter coffee

For hotter espresso coffee, you should:

- You are recommended to warm the cups before making coffee by rinsing them with a little hot water.
- Attach the filter holder to the appliance with the filter in place but **without adding coffee**. Using the same cup as will later be used to make the coffee, press the 1 cup button and deliver hot water into the cup to heat it.
- Raise the coffee temperature in the settings menu.

- Rest the cups you will be using on the cup warmer (A4) which becomes hot during operation.



8.2 How to prepare espresso coffee using pre-ground coffee

1. Place the ground coffee filter (C2 or C3) in the filter holder (fig. 6). To make one coffee, use the filter with the  symbol on the bottom, to make two coffees, use the filter with the  symbol on the bottom.
2. To make just one coffee, place one level spoon (not included) of pre-ground coffee (about 7 g) in the filter (fig. 7). To make two coffees, place two loosely filled spoons (not included) (about 7+7 g) of pre-ground coffee in the filter. Fill the filter a little at a time to prevent the pre-ground coffee from overflowing.



Important:

For correct operation, before filling with pre-ground coffee, make sure there are no coffee residues left in the filter from the last time you made coffee.

3. Distribute the pre-ground coffee evenly and press lightly with the tamper (fig. 8).
Correct pressing of the pre-ground coffee is essential to obtain a good espresso. If you press too firmly, the coffee will be delivered slowly and will be strong. If you press too lightly, the coffee will be delivered quickly and will be weak.
4. Remove any excess coffee from the rim of the filter holder and attach the filter holder to the appliance. To attach correctly, align the filter holder handle with the INSERT symbol (fig. 9), attach the filter holder and rotate the handle towards the right until aligned with the CLOSE symbol.
5. Place the cup or cups under the filter holder spouts (fig. 10).
6. Make sure the lights corresponding to the coffee buttons are on, then press the  or  coffee button. The appliance proceeds to make the coffee and delivery is interrupted automatically.
7. To remove the filter holder, turn the handle from right to left.



Danger of burns!

To avoid splashes, never remove the filter holder while the appliance is delivering coffee. Always wait for a few seconds after delivery.

8.3 How to make espresso coffee using pods



Please note:

Use pods conforming to the ESE standard, indicated on the pack by the following symbol.



The ESE standard is a system accepted by leading pod producers and enables espresso coffee to be prepared simply and cleanly.

1. Place the filter for coffee pods (with the  symbol on the bottom) in the filter holder.
2. Insert the pod, centring it as far as possible on the filter (fig. 11). Always follow the instructions on the pod pack to position the pod on the filter correctly.

Proceed as described in points 4 to 6 in the previous section.



Please note:

- While the appliance is making coffee, delivery can be interrupted at any moment by pressing the coffee button pressed previously.
- At the end of delivery (within 3 seconds), to increase the amount of coffee in the cup, press and hold the coffee button pressed previously. Delivery is automatically interrupted after a few seconds.
- To remove the filter holder, turn the handle from right to left.





Danger of burns!

To avoid splashes, never remove the filter holder while the appliance is delivering coffee. Always wait for a few seconds after delivery.



8.4 Programming the quantities of coffee in the cup

The appliance is set by default to automatically deliver standard quantities. To change these quantities, proceed as follows:

1. Place one or two cups under the filter holder spouts.
2. Press and hold the button you want to programme ( or ). The coffee maker starts delivering coffee and the other coffee button flashes to indicate that the appliance is in programming mode.
3. Once the required quantity of coffee has been delivered into the cup, release the button. Delivery stops and the light flashes to indicate that the quantity has been saved correctly.
4. When the two coffee lights come on steadily, the appliance is ready for use.



9. HOW TO MAKE CAPPUCCINO

1. Prepare the espresso coffees as described in the previous sections, using sufficiently large cups. To use tall glasses, remove the drip tray and stand the glasses on the glasses tray (A10);

2. Press the  button (fig. 12). The light flashes;
3. In the meantime, fill a recipient with about 100 grams of milk for each cappuccino to be prepared. For a denser more even froth, you must use skimmed or partially skimmed milk at refrigerator temperature (about 5°C). In choosing the size of the recipient, bear in mind that the milk doubles or triples in volume (fig. 13).
4. Make sure the cappuccino maker selection ring (A14) is in the "CAPPUCCINO" position (fig. 14);
5. Wait for the light corresponding to the  button to come on steadily, indicating that the boiler has reached the ideal temperature to produce steam.
6. Position an empty container under the cappuccino maker and open the dial for a few seconds to eliminate any air left in the circuit. Close the dial again.
7. Place the recipient containing the milk under the cappuccino maker.
8. Immerse the cappuccino maker in the milk container. Never immerse the black ring (fig. 15). Turn the dial to the  position. Steam is delivered from the cappuccino maker, giving the milk a creamy frothy appearance (fig. 16). To obtain a creamier froth, immerse the cappuccino maker in the milk and rotate the container with slow upward movements.
9. When the required temperature (the ideal is 60°C) and froth density is reached, interrupt steam delivery by turning the steam dial clockwise.
10. Pour the frothed milk into the cups containing the espresso coffee prepared previously. The cappuccino is ready. Sweeten to taste and if desired, sprinkle the froth with a little cocoa powder.



Please note:

- to prepare more than one cappuccino, first make all the coffees then at the end prepare the frothed milk for all the cappuccinos;
- to exit the steam function, press any button. The  and  lights flash to indicate that the temperature is too high to make coffee (see section "Cooling the boiler").

You should not deliver steam for more than 60 seconds.

10. MAKING HOT MILK

To make hot milk without froth, proceed as described in the above section, making sure the cappuccino maker selection ring (A14) is positioned upwards in the "HOT MILK" position.

11. CLEANING THE CAPPUCCINO MAKER AFTER USE

Important:

For hygiene reasons, the cappuccino maker should always be cleaned after use.

Proceed as follows:

1. Turn the steam dial to deliver a little steam for a few seconds (points 2, 5 and 6 of the previous section). This causes the cappuccino maker to discharge any milk left inside. Press the ON/OFF button to turn the appliance off.
2. Wait a few minutes for the cappuccino maker to cool down. With one hand, hold the cappuccino maker tube firmly, with the other, release the cappuccino maker by turning it clockwise, then pull off downwards (fig. 17).
3. Remove the rubber steam connection nozzle from the spout by pulling it downwards (fig. 18).
4. Push the ring upwards and make sure the two holes shown by the arrows in fig. 19 are not blocked. If necessary, clean with a pin;
5. Replace the nozzle, move the ring downwards and put the cappuccino maker back on the connection nozzle, turning it and pushing it upwards until it is attached.

12. COOLING THE BOILER

To make coffee again immediately after frothing milk, the boiler must first be cooled or the coffee will be burnt. Proceed as follows:

- place a container under the cappuccino maker;
- open the steam dial to deliver hot water and cool the boiler;
- hot water delivery is interrupted automatically when the boiler is cool. When the pump stops operating and no more water is delivered, close the steam dial.

The coffee maker is now ready for use.

13. HOT WATER

1. Press the ON/OFF button (fig. 3) to turn the appliance on. Wait for the coffee lights to come on steadily.
2. Place a recipient under the cappuccino maker.
3. Turn the dial to the  position. Hot water is delivered from the cappuccino maker.
4. To stop hot water delivery, close the dial and press any button.

You should not deliver hot water for more than 60 seconds.

14. CLEANING

14.1 Cleaning the machine

The following parts of the machine must be cleaned regularly:

- drip tray (A9)
- the coffee filters (C2, C3 and C4);
- the coffee outlet (A5);
- water tank (A3);
- the cappuccino maker (A15) as described in section "11. Cleaning the cappuccino maker after use";

Important!

- Do not use solvents, abrasive detergents or alcohol to clean the coffee machine.
- Do not use metal objects to remove encrustations or coffee deposits as they could scratch metal or plastic surfaces.
- If the appliance is not used for more than one week, before using it again, we strongly recommend you perform a rinse cycle as described in section "6. first use".

Danger!

- While cleaning, never immerse the coffee maker in water. It is an electrical appliance.
- Before cleaning the outside of the appliance, turn it off, unplug from the mains socket and allow to cool.

14.2 Cleaning the drip tray

Important!

The drip tray is fitted with a level indicator (red) showing the level of water it contains (fig. 20). Before the indicator protrudes from the cup tray, the drip tray must be emptied and cleaned otherwise the water may overflow the edge and damage the appliance, the surface it rests on or the surrounding area.

1. Remove the drip tray (fig. 21).
2. Remove the cup tray (A7), empty the water and clean the drip tray with a cloth, then reassemble the drip tray. Extract the mugs or glasses tray (A10), clean with water, dry and put back in the machine;
3. Put the drip tray back in place.

14.3 Cleaning the coffee filters

Clean the coffee filters weekly:

1 and 2 cup filters

1. Extract the perforated filter by pulling the tab (fig. 22);
2. Rinse the filters under running water (fig. 23);
3. Make sure the holes are not blocked. If necessary, clean with a pin (figs. 23 and 24);
4. Place the perforated filter in the filter housing and press as far as it will go.

Pod filter

Rinse under running water. Make sure the holes are not blocked. If necessary, clean with a pin (figs. 23 and 24).

14.4 Cleaning the coffee outlet

After every 200 coffees, rinse the coffee outlet by delivering about 0.5 l of water from the coffee outlet (press the coffee button without using ground coffee).

14.5 Other cleaning operations

1. Do not use solvents or abrasive detergents to clean the coffee maker. Use a soft damp cloth only.
2. Clean the filter holder cup.

14.6 Cleaning the water tank

1. Clean the water tank regularly (about once a month) and whenever you replace the water softener filter (C6, *if provided) with a damp cloth and a little mild washing up liquid;
2. Remove the filter (*if present) and rinse with running water;
3. Put the filter (*if provided) back in the appliance, fill the tank with fresh water and replace the tank;
4. (Models with water softener filter only) Deliver about 100 ml of water.

Danger!

While cleaning, never immerse the coffee maker in water. It is an electrical appliance.

14.7 Descale

Descalcify the appliance when the orange light on the  button comes on.





Important!

- Before use, read the instructions and the labelling on the descaler pack.
- You should use De'Longhi descaler only. Using unsuitable descaler and/or performing descaling incorrectly may result in faults not covered by the manufacturer's guarantee.

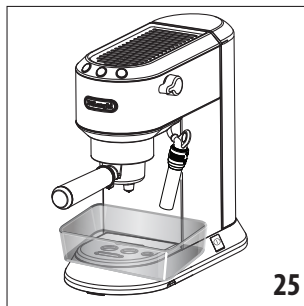
Proceed as follows:



1. (IF PRESENT, REMOVE THE WATER SOFTENER FILTER). Fill the tank with the descaler solution, obtained by diluting the descaler provided with water (fill the water tank up to the MAX level).
2. Press the ON/OFF button.



3. Make sure the filter holder is not attached and position a recipient under the hot water spout and coffee outlet (A5) (fig. 25).
4. Wait for the  and  lights to come on steadily, indicating that the appliance is ready for use.
5. Press and hold the  button for 10 seconds until the three buttons flash in sequence.
6. Turn the steam dial to the  position.
7. Press the  button to start descaling.
8. The descale programme starts and the descaler liquid comes out of the water spout. The descale programme removes limescale deposits from inside the appliance by automatically performing a series of rinses and pauses until the tank is completely empty.

Please note:

During descaling, to clean the coffee outlet, close the steam dial from time to time to deliver small quantities of descaler from the coffee outlet.

9. The appliance stops operation and the orange  light continues to flash, indicating that descaling is still underway.
10. The appliance is now ready for rinsing through with clean water. Extract the water tank, empty, rinse under running water, fill with fresh water up to the MAX level and put back in the appliance (if used, insert the water softener filter).
11. Empty the container used to collect the descaler solution and replace it empty under the hot water spout.
12. Make sure the steam dial is in the  position, then press the  button to start rinsing.

Please note:

During rinsing, to clean the coffee outlet, close the steam dial from time to time to deliver small quantities of water from the coffee outlet.

13. When the water tank is empty, the orange light goes out and descaling is complete.

14. Make sure the steam dial is in the closed position (○ symbol).

The appliance is ready for use.

Please note!

- If the descaling cycle is not completed correctly (e.g. no electricity) we recommend repeating the cycle;
- If the water tank has not been filled to the MAX level, at the end of descaling, the appliance requests a further rinse to guarantee that the descaler solution has been completely eliminated from the machine's internal circuits.

Repair of damage to the coffee maker caused by limescale is not covered by the guarantee unless descaling is performed regularly as described above.

15. TECHNICAL DATA

| | |
|----------------------------|---------------------|
| Mains voltage: | 220-240V~50/60Hz |
| Absorbed power:..... | 1350 W |
| Pressure: | 15 bar |
| Water tank capacity: | 1 l |
| Size LxHxD..... | 149x305x330 (414)mm |
| Weight..... | 4.04 kg |





None of the components or accessories is dishwasher safe.

16. EXPLANATION OF LIGHTS

| Lights | Operation | Explanation of lights |
|--------|---------------------------------|--|
| | The ON/OFF button is turned on | The appliance performs a self-diagnosis cycle, indicated by sequential flashing of the lights |
| | When the appliance is turned on | Flashing lights: the appliance is heating up to make coffee Lights on steadily: the appliance is ready to make coffee The lights flash rapidly: the tank is empty or the appliance will not make coffee. See the section “2. Filling the water tank” |
| | The steam function is required | Flashing light: the appliance is heating up to deliver steam Light on steadily: the appliance is ready to deliver steam |
| | The appliance needs descaling | Descalc the appliance, the operation is complete when the  light goes off. |
| | Steam dial open | Flashing lights: close the steam dial |
| | High boiler temperature | Flashing lights: Cool as described in section “9. Cooling the boiler” |

17. TROUBLESHOOTING

| Problem | Cause | Solution |
|---|--|---|
| No espresso coffee is delivered | No water in the tank | Fill the tank |
| | The holes in the filter holder are blocked | Clean the filter holder spout holes |
| | The filter is blocked | Clean as described in section "11.3 Cleaning the coffee filters" |
| | The tank has been inserted incorrectly and the valves on the bottom are not open | Press the tank down lightly to open the valves on the bottom |
| | Limescale in the water circuit | Descale as described in section "11.7 Descale" |
| The espresso coffee drips from the edges of the filter holder rather than the holes | The filter holder has been inserted incorrectly or is dirty | Attach the filter holder correctly and rotate firmly as far as it will go |
| | The espresso boiler gasket has lost elasticity or is dirty | Have the espresso boiler gasket replaced by Customer Services |
| | The holes in the filter holder spouts are blocked | Clean the filter holder spout holes |
| | The filter or the perforated filter is blocked | Clean as described in section "11.3 Cleaning the coffee filters" |
| The filter holder cannot be attached to the appliance | Too much coffee has been placed in the filter | Use the spoon (not included) and make sure you are using the correct filter for the type of preparation |
| The coffee froth is too light (delivered from the spout too fast) | The pre-ground coffee is not pressed down firmly enough | Press the pre-ground coffee more firmly |
| | There is not enough pre-ground coffee | Increase the quantity of pre-ground coffee |
| | The pre-ground coffee is too coarse | Use only pre-ground coffee for espresso coffee makers |
| | The wrong type of pre-ground coffee is being used | Change the type of pre-ground coffee |
| The coffee froth is too dark (delivered from the spout too slowly) | The pre-ground coffee is pressed down too firmly | Press the coffee down less firmly |
| | There is not enough pre-ground coffee | Reduce the quantity of pre-ground coffee |
| | The espresso boiler outlet is blocked | Clean as described in section "11.4 Cleaning the coffee outlet" |
| | The filter or the perforated filter is blocked | Clean as described in section "11.3 Cleaning the coffee filters" |
| | The pre-ground coffee is too fine | Use only pre-ground coffee for espresso coffee makers |
| | The pre-ground coffee is too fine or damp | Use pre-ground coffee for espresso coffee makers only and make sure it is not too damp |
| | Limescale in the water circuit | Descale as described in section "11.7 Descale" |

| | | |
|--|--|--|
| After delivering coffee, the filter remains attached to the boiler outlet | | Insert the filter holder again, deliver coffee, then remove the filter holder |
| The appliance will not make any drink and the  ,  and  lights flash for a few seconds | No water in the tank | Fill the tank with water |
| | The tank has been inserted incorrectly and the valves on the bottom are not open | Press the tank down lightly to open the valves on the bottom |
| | The espresso boiler outlet is blocked | Clean as described in section "11.4 Cleaning the coffee outlet" |
| | The filter is blocked | Clean as described in section "11.3 Cleaning the coffee filters" |
| | Limescale in the water circuit | Descale as described in section "11.7 Descale" |
| The appliance does not function and all the lights flash | | Disconnect the appliance immediately and contact authorised Customer Services. |
| No milk froth is formed when making cappuccino | The ring is in the "HOT MILK" position | Push the ring into the "CAPPUCCINO" position. |
| | Milk not cold enough | Always use milk at refrigerator temperature |
| | Cappuccino maker dirty | Clean as described in section "8. Cleaning the cappuccino maker after use" |
| | Limescale in the water circuit | Descale as described in section "11.7 Descale" |
| At the end of descaling, the appliance requests a further rinse | During the rinse cycle, the water tank has not been filled to the MAX level | Repeat the rinse cycle from point 10 of the section "Explanation of lights" "11.7 Descale" |