

ECAM35X.15

BEAN TO CUP ESPRESSO
AND CAPPUCCINO MACHINE
Instructions for Use

Instruction videos available at:
<http://ecam35015.delonghi.com>

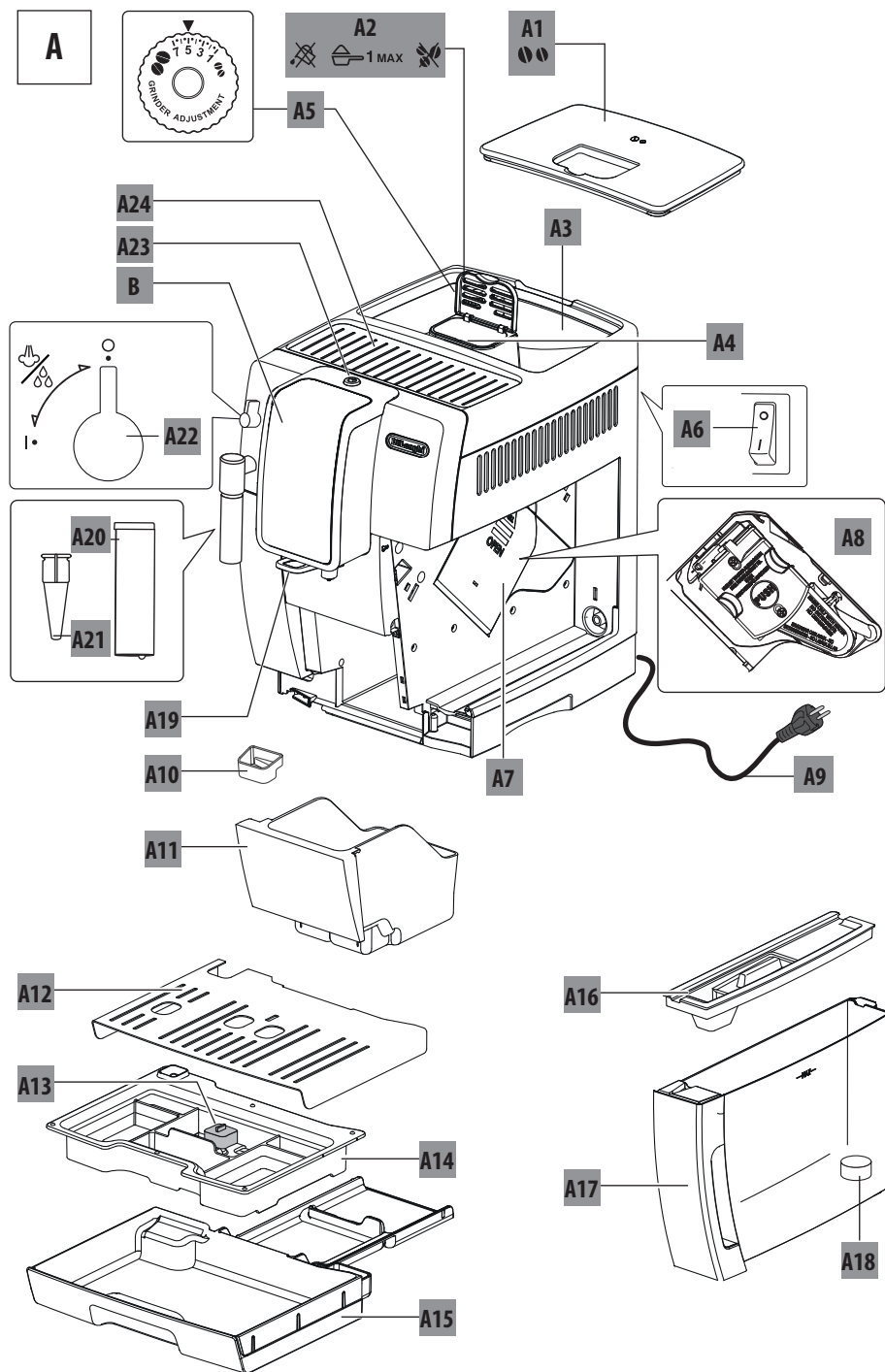

DeLonghi



B

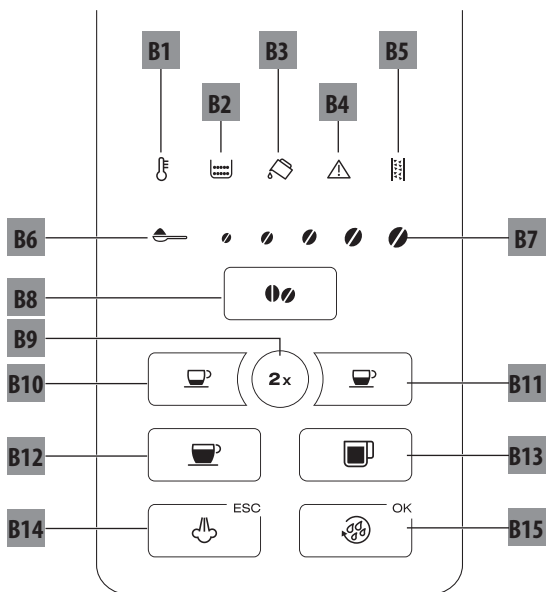

C

C1



C2

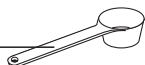

C3



C4



CONTENTS

| | | | |
|--|-----------|--|-----------|
| 1. INTRODUCTION..... | 5 | 19. WATER SOFTENER FILTER | 16 |
| 1.1 Letters in brackets..... | 5 | 19.1 Installing the filter | 16 |
| 1.2 Troubleshooting and repairs..... | 5 | 19.2 Replacing the filter..... | 17 |
| 2. DESCRIPTION..... | 5 | 20. TECHNICAL DATA..... | 17 |
| 2.1 Description of the appliance | 5 | 20.1 Tips for Energy Saving | 17 |
| 2.2 Description of the control panel | 5 | 21. EXPLANATION OF LIGHTS..... | 18 |
| 2.3 Description of the accessories..... | 5 | 22. TROUBLESHOOTING | 20 |
| 3. SETTING UP THE APPLIANCE | 5 | | |
| 4. TURNING THE APPLIANCE ON..... | 6 | | |
| 5. TURNING THE APPLIANCE OFF | 7 | | |
| 6. SETTING WATER HARDNESS | 7 | | |
| 7. SETTING TEMPERATURE | 7 | | |
| 8. AUTO-OFF | 7 | | |
| 9. ENERGY SAVING | 7 | | |
| 10. BEEP | 8 | | |
| 11. DEFAULT VALUES (RESET) | 8 | | |
| 12. RINSING..... | 8 | | |
| 13. MAKING COFFEE..... | 8 | | |
| 13.1 Adjusting the coffee mill | 8 | | |
| 13.2 Tips for a hotter coffee..... | 9 | | |
| 13.3 Making coffee using coffee beans | 9 | | |
| 13.4 Temporarily varying the coffee aroma..... | 10 | | |
| 13.5 Making coffee using pre-ground coffee..... | 10 | | |
| 13.6 Customising aroma and quantity | 11 | | |
| 14. MAKING CAPPUCCINO | 11 | | |
| 14.1 Cleaning the cappuccino maker after use..... | 11 | | |
| 15. DELIVERING HOT WATER | 12 | | |
| 16. CLEANING..... | 12 | | |
| 16.1 Cleaning the machine | 12 | | |
| 16.2 Cleaning the internal circuit | 12 | | |
| 16.3 Cleaning the coffee grounds container..... | 12 | | |
| 16.4 Cleaning the drip tray and condensate tray..... | 13 | | |
| 16.5 Cleaning the inside of the machine | 13 | | |
| 16.6 Cleaning the water tank | 13 | | |
| 16.7 Cleaning the coffee spouts | 13 | | |
| 16.8 Cleaning the pre-ground coffee funnel | 14 | | |
| 16.9 Cleaning the infuser | 14 | | |
| 17. DESCALING..... | 14 | | |
| 18. SETTING WATER HARDNESS | 16 | | |
| 18.1 Measuring water hardness | 16 | | |
| 18.2 Setting water hardness | 16 | | |

1. INTRODUCTION

Thank you for choosing this bean to cup espresso and cappuccino machine.

We hope you enjoy using your new appliance. Take a few minutes to read this Instruction for Use. This will avoid all risks and damage to the appliance.

1.1 Letters in brackets

The letters in brackets refer to the legend in the description of the appliance on pages 2-3.

1.2 Troubleshooting and repairs

In the event of problems, first try and resolve them by reading the information given in sections "21. Explanation of lights" and "22. Troubleshooting".

If this does not resolve the problem or you require further information, you should consult customer services by calling the number given on the annexed "Customer Service" sheet.

If your country is not among those listed on the sheet, call the number given in the guarantee. If repairs are required, contact De'Longhi customer services only. The addresses are given in the guarantee certificate provided with the machine.

2. DESCRIPTION

2.1 Description of the appliance















(page 2 - A)

- A1. Beans container lid
- A2. Pre-ground coffee funnel lid
- A3. Beans container
- A4. Pre-ground coffee funnel
- A5. Grinding adjustment dial
- A6. Main switch
- A7. Infuser door
- A8. Infuser
- A9. Power cord
- A10. Condensate tray
- A11. Coffee grounds container
- A12. Cup tray
- A13. Drip tray water level indicator
- A14. Tray grille
- A15. Drip tray
- A16. Water tank lid
- A17. Water tank
- A18. Water softener filter housing
- A19. Coffee spouts (adjustable height)
- A20. Cappuccino maker (removable)
- A21. Hot water and steam connection nozzle (removable)
- A22. Steam/hot water dial
- A23.  button: to turn the appliance on and off (standby)
- A24. Cup shelf

2.2 Description of the control panel

(page 3 - B)

A number of icons on the touch screen have a double function. This is indicated in brackets in the description.

- B1. Flashing  light: the appliance is heating up
- B2.  Light:
 - on steadily: put the grounds container (A11) back
 - flashing: the grounds container needs emptying
- B3.  Light:
 - on steadily: insert the water tank (A17)
 - flashing: insufficient water in the tank
- B4.  Light: general alarm (see section "21. Explanation of lights")
- B5.  Light:
 - on steadily: descaling programme underway
 - flashing: the appliance needs descaling
- B6.  : pre-ground function
- B7.  : aroma selection
- B8.  : coffee aroma
- B9. **2x** : to deliver 2 cups of "espresso" or "espresso lungo"
- B10.  : "Espresso"
- B11.  : "Espresso Lungo"
- B12.  : "Coffee"
- B13.  : "Long"
- B14.  **ESC**:
 - on steadily: to turn the steam function on (*when in the settings menu: press to exit the current programming*)
 - flashing: the steam/hot water dial (A22) must be turned
- B15.  **OK**: to perform a rinse cycle.
(*When in the settings menu: press to confirm the current programming*)

2.3 Description of the accessories

(page 2 - C)

- C1. Indicator paper
- C2. Pre-ground coffee measure
- C3. Descaler
- C4. Water softener filter (certain models only)

3. SETTING UP THE APPLIANCE

Please note:

- The first time you use the appliance, rinse with hot water all removable accessories which may come into contact with water or milk.
- Possible traces of coffee in the mill are the result of operating tests performed on the appliance before sale, proof

of the meticulous care and attention we invest in our products.

- You should customise water hardness as soon as possible following the instructions in section "18. Setting water hardness".

Proceed as described:

1. Plug the appliance into the mains socket and press the main switch (A6) on the back of the appliance (fig. 1).

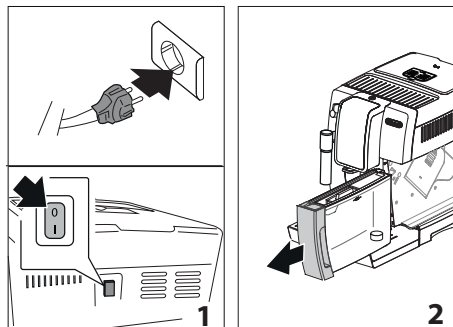

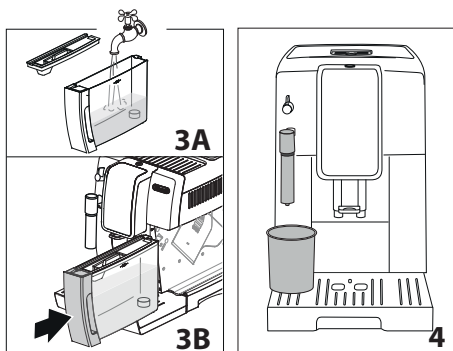

2. The  light (B3) flashes on the control panel (B). Remove the water tank (A17) (fig. 2), fill to the MAX line with fresh water (fig. 3A) then put back in the appliance (fig. 3B).

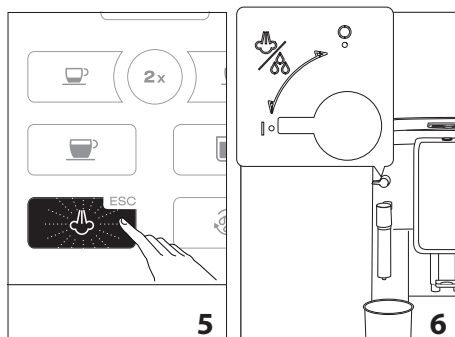

3. The  icon (B14) flashes on the control panel (fig. 4).
4. Place a container with a minimum capacity of 100 ml under the cappuccino maker (A20) (fig. 5).



5. Turn the steam/hot water dial to the "I" position (fig. 6) and press the  **OK** icon (B15). Water is delivered from the cappuccino maker.
6. When delivery stops automatically, the  icon flashes on the touch screen to indicate that the steam dial must be turned back to the "0" position.

The appliance goes off.

To use it, press the  button (A23) (fig. 7).

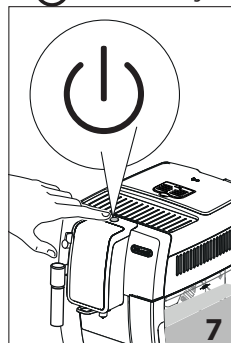

Please note:

- The first time you use the appliance, you need to make 4-5 cups of coffee before the appliance starts to give satisfactory results.
- To enjoy your coffee even more and improve the performance of your appliance, we recommend installing a water softener filter (C4) as described in section "19. Water softener filter". If your model is not provided with a filter, you can request one from De'Longhi customer services.

4. TURNING THE APPLIANCE ON



Please note:

Before turning the appliance on, make certain the main switch (A6) on the back of the appliance is pressed in (fig. 1).

Each time the appliance is turned on, it performs an automatic preheat and rinse cycle which cannot be interrupted. The appliance is ready for use only after completion of this cycle.

Danger of scalding!

During rinsing, a little hot water comes out of the coffee spouts (A19) and is collected in the drip tray (A15) underneath. Avoid contact with splashes of water.

- To turn the appliance on, press the  button (A23) (fig. 7). The  light (B1) flashes on the touch screen (B) to indicate the appliance is heating up.

While heating up, the machine performs a rinse cycle. As well as heating the boiler, this also heats the internal circuits by circulating hot water.



The appliance is ready when the main screen appears.

5. TURNING THE APPLIANCE OFF

Whenever the coffee machine is turned off after being used to make coffee, it performs an automatic rinse cycle.

Danger of scalding!

During rinsing, a little hot water flows from the coffee spouts (A19). Avoid contact with splashes of water.

- To turn the appliance off, press the  button (A23) (fig. 7).
- the  light (B1) flashes on the touch screen and (if provided for) the appliance performs a rinse cycle then goes off (standby).

Please note

If you will not be using the appliance for some time, unplug it from the mains socket:

- first turn the appliance off by pressing the  button (fig. 7);
- release the main switch (A6) (fig. 1).

Important!



Never press the main switch while the appliance is on.



6. SETTING WATER HARDNESS

For instructions on setting water hardness, see section "18. Setting water hardness".

7. SETTING TEMPERATURE



To change the temperature of the water used when making coffee (low, medium, high), proceed as follows:

- With the appliance off (standby), but the main switch pressed (fig. 1);
- Press and hold the **2x** icon (B9) until the lights on the touch screen (B) come on;
- Press the  icon (B10).
- Press the  icon again to select the required temperature:

| | |
|---|--------|
|  | low |
|  | medium |
|  | high |

Please note:

Varying the temperature has most effect for long beverages.

- Press the  icon **OK** (B15) to confirm (or  **ESC** (B14) to exit without making the change).



The lights go off.





The appliance returns to "standby" and the temperature is now programmed.



8. AUTO-OFF

The time can be changed so that the appliance switches off after being idle for 15 or 30 minutes, or after 1, 2 or 3 hours.

To change the Auto-off setting, proceed as follows:

- With the appliance off (standby), but the main switch pressed (fig. 1);
- Press and hold the **2x** (B9) icon until the lights on the touch screen (B) come on;
- Press the  (B11) icon;
- Select the required time interval by pressing the  icon again:

| | |
|---|---------|
|  | 15 min. |
|  | 30 min. |
|  | 1 hour |
|  | 2 hours |
|  | 3 hours |







- Press the  icon **OK** (B15) to confirm (or  **ESC** (B14) to exit without making the change). The lights go off.

The auto-off time is now programmed.

9. ENERGY SAVING

Use this function to enable or disable energy saving. This mode is active by default, reducing energy consumption while the ma-

chine is on in compliance with current European regulations. To change the setting, proceed as follows:

1. With the appliance off (standby), but the main switch pressed (fig. 1);
2. Press and hold the **2x** (B9) icon until the lights on the touch screen (B) come on;
3. Press the  icon (B13).
4. Press the  icon again to enable/disable the function:
 -  function enabled
 -  function disabled
5. Press the  OK icon (B15) to confirm (or  ESC (B14) to exit without making the change).
6. Press the  ESC icon to exit the menu. The lights go off.





The energy saving setting is now programmed.

Please note!

When in energy saving mode, a few seconds may elapse before the first coffee is delivered as the appliance must heat up again.



10. BEEP

This function enables or disables the beep. Proceed as follows:

1. With the appliance off (standby), but the main switch pressed (fig. 1);
2. Press and hold the **2x** icon (B9) until the lights on the touch screen (B) come on;
3. Press the **2x** icon to enable/disable the function:
 -  function enabled
 -  function disabled
4. Press the  OK (B15) icon to confirm (or  ESC (B14) to exit without making the change). The lights go off. The beep is now programmed.

11. DEFAULT VALUES (RESET)

This function resets all settings (temperature, auto-off, water hardness, energy saving and all quantity settings are reset to the default values).

1. With the appliance off (standby), but the main switch pressed (fig. 1);
2. Press and hold the **2x** icon (B9) until the lights on the touch screen (B) come on;
3. Press the  icon (B12). The beans (B7) on the touch screen flash;
4. Press the  OK icon (B15) to reset the default values (or  ESC (B14) to exit without making the change). The lights go off.

The settings and quantities of the beverages have been reset to the default values.



12. RINSING

Use this function to deliver hot water from the coffee spouts (A19) to clean and heat the appliance's internal circuit.

Place a container with a minimum capacity of 100ml under the coffee and hot water spouts.

Important! Danger of scalding.

Do not leave the appliance unattended while hot water is being delivered.

1. To activate the function, press  OK (B15);
2. After a few seconds, hot water is delivered from the coffee spouts, cleaning and heating the appliance's internal circuit.
3. To interrupt the function manually, press  OK again.

Please note!

- If the appliance is not used for more than 3-4 days, when you turn it on again, we strongly recommend performing 2/3 rinses before use;
- After cleaning, it is normal for the grounds container (A11) to contain water.

13. MAKING COFFEE

13.1 Adjusting the coffee mill

The coffee mill is factory-set in such a way that the coffee will be delivered correctly and should not require regulating initially. However, if after making the first few coffees you find that the coffee is either too weak and not creamy enough or delivery is too slow (a drop at a time), this can be corrected by adjusting the grinding adjustment dial (A5) (fig. 8).

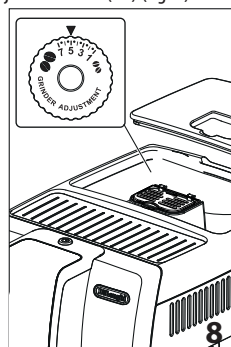

Please note:

The grinding adjustment dial must only be turned when the coffee mill is in operation.



If the coffee is delivered too slowly or not at all, turn one click clockwise towards 7. For fuller bodied creamier coffee, turn one click anticlockwise towards 1 (do not turn more than one click at a time otherwise the coffee could be delivered a drop

at a time).

The effect of the adjustment will be noticed only after making a further 2 cups of coffee, at least. If this adjustment does not produce the desired result, turn the dial another click.

13.2 Tips for a hotter coffee

For hotter coffee, proceed as follows:

- perform a rinse cycle by pressing  OK (B15);
- warm the cups with hot water using the hot water function (see section "15. Delivering hot water");
- increase the coffee temperature (see section "6. Setting water hardness"). **Please note:** Varying the temperature has most effect for long beverages.

13.3 Making coffee using coffee beans

Important!

Do not use green, caramelised or candied coffee beans as they could stick to the coffee mill and make it unusable.



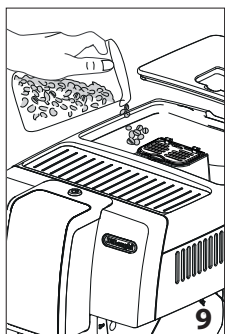



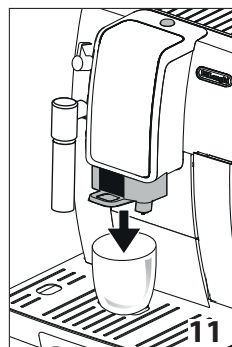





1. Fill the container (A3) with coffee beans (fig. 9);

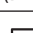

2. Place under the coffee spouts (A19):
 - 1 cup if you want 1 coffee (fig. 10);
 - 2 cups, if you want 2 coffees.
3. Lower the spouts as near as possible to the cup. This makes a creamier coffee (fig. 11);





4. Then select your required coffee:

| Recipe | Quantity | Program-mable quantity | Default aroma |
|--|-------------------|------------------------|--|
|  Espresso (B10) | ≈ 40 ml | from ≈20 to ≈80ml |  |
|  Espresso lungo (B11) | ≈ 120 ml | from ≈80 to ≈180c |  |
|  Coffee (B12) | ≈ 180 ml | from ≈100 a ≈240cc |  |
|  Long (B13) | ≈ 160 ml | from ≈115 a ≈250cc |  |
| 2x (B9) +  Espresso (B10) | ≈ 40 ml x 2 cups | -- |  |
| 2x (B9) +  Espresso lungo (B11) | ≈ 120 ml x 2 cups | -- |  |

5. Preparation begins and the light corresponding to the selected icon flashes on the touch screen (B).

Please note:

- To make 2 cups of "espresso" or "espresso lungo" at the same time:
 - Press the "2X" icon (B9). The icons corresponding to the beverages available for selection light up and the "2X" icon flashes. Press  or : Preparation begins. Alternatively, proceed as follows:

- Press or : preparation begins and the "2X" icon flashes for a few seconds. Press the "2X" icon while it is flashing.
- While the machine is making coffee, delivery can be interrupted at any moment by pressing the coffee icon.
- Once the coffee is in the cup, it is possible to increase the quantity delivered, if so desired, simply by pressing either one of the coffee icons (B10) or (B13) within 3 seconds.

Once the coffee has been made, the appliance is ready to make the next beverage.

Please note:

- Indicator lights may appear on the control panel (B) during use. Their meaning is given in section "21. Explanation of lights".
- For hotter coffee, see section "13.2 Tips for a hotter coffee".
- If the coffee is delivered a drop at a time, too weak and not creamy enough or too cold, read the tips in section "22. Troubleshooting".
- To customise the beverages according to personal taste, see section "13.6 Customising aroma and quantity".

13.4 Temporarily varying the coffee aroma

To temporarily vary the coffee aroma, press (B8):

| | |
|--|--|
| | EXTRA LIGHT |
| | LIGHT |
| | MEDIUM |
| | STRONG |
| | X-STRONG |
| | (see "13.5 Making coffee using pre-ground coffee") |

Please note:

- The variation in aroma is not saved and the next time a beverage is delivered automatically, the appliance selects the default value.
- If a few seconds elapse between temporary customising of the aroma and delivery of the beverage, the aroma returns to the default value.

13.5 Making coffee using pre-ground coffee

Important!

- Never add pre-ground coffee when the machine is off, as it could infiltrate and soil the inner workings. This could damage the machine.
- Never use more than 1 level measure (C2) as it could dirty the inside of the coffee machine or block the funnel (A4).



Please note:

When using pre-ground coffee, only one cup can be made at a time.

1. Press the (B8) repeatedly until the light (B6) comes on.
2. Make sure the funnel is not blocked, then add one level measure of pre-ground coffee (fig. 12).

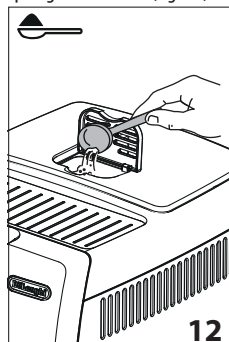

3. Place a cup under the coffee spouts (A19) (fig. 10);
4. Then select your required coffee:

| Recipe | Quantity |
|----------------------|----------|
| Espresso (B10) | ≈ 40 ml |
| Espresso Lungo (B11) | ≈ 120 ml |
| Coffee (B12) | ≈ 180 ml |
| Long (B13) | ≈ 160 ml |

5. Preparation begins and the light corresponding to the selected icon flashes on the touch screen (B).

Important! Making LONG coffee :

Halfway through preparation, the light flashes: Add one level measure of pre-ground coffee and press OK (B15).

Please note:

If "Energy Saving" mode is active, you may have to wait a few seconds before the first coffee is delivered.

13.6 Customising aroma and quantity

The appliance is set by default to make coffee with a standard aroma and quantity (see table in section "13.3 Making coffee using coffee beans").

To customise the coffee, proceed as follows:

1. Place a sufficiently large cup or glass under the coffee spouts (A19);
2. Press  (B8) to select the required aroma (see section "13.4 Temporarily varying the coffee aroma");
3. Press and hold the icon corresponding to the coffee to be customised. The icon flashes and all the alarm lights flash 4 times;
4. Release the icon. The icon flashes and the appliance starts delivering coffee;
5. As soon as the coffee in the cup reaches the required level, press the coffee icon again.

The aroma and quantity of coffee in the cup has now been programmed.

14. MAKING CAPPUCCINO***Danger of scalding!***

During preparation, steam is given off. Take care to avoid scalds.

1. When preparing cappuccino, make the coffee in a large cup.
2. Fill a container (preferably one with a handle to avoid scalding) with about 100 grams of milk for each cappuccino. In choosing the size of the container, bear in mind that the milk doubles or triples in volume.

Please note:





For a richer and denser froth, use skimmed or partially skimmed milk from the refrigerator (about 5°C). To avoid producing milk with poor froth or large bubbles, always clean the cappuccino maker as described in the section "14.1 Cleaning the cappuccino maker after use".

3. The cappuccino maker (A20) can be turned slightly outwards to allow containers of any size to be used;
4. Immerse the cappuccino maker in the milk container. Never immerse the black ring.

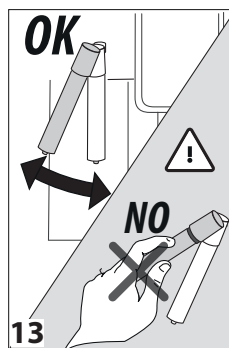
Important!

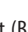
Never use force to turn the cappuccino maker (fig. 13). It could break!



5. Press the  icon (B14). The  light (B1) flashes to indicate the appliance is heating up.
6. When the appliance is at temperature, the  light goes off and the  icon flashes.
7. Turn the steam/hot water dial  (A22) to the position I. After a few seconds, steam is delivered from the cappuccino maker, giving the milk a creamy frothy appearance and making it more voluminous. For a creamier froth, rotate the container with slow movements in an upward direction.
8. When you have obtained the required froth, stop steam delivery by turning the dial to the "0" position.

Danger of scalding!

Interrupt steam delivery before removing the container with the frothed milk to avoid burns caused by splashes of boiling milk.

9. Add the milk froth to the coffee prepared previously. The cappuccino is ready. Sweeten to taste and, if desired, sprinkle the froth with a little cocoa powder.

Please note!

If "Energy saving" is active, you may have to wait a few seconds before steam is delivered.

14.1 Cleaning the cappuccino maker after use

Clean the cappuccino maker (A20) each time you use it to avoid the build-up of milk residues or blockages.

Danger of scalding!

When cleaning the cappuccino maker, a little hot water is delivered. Avoid contact with splashes of water.

1. Deliver a little water by turning the steam/hot water dial  (A22) to the I position. Then stop delivery by turning the dial back to the 0 position.
2. Wait a few minutes for the cappuccino maker to cool down, then rotate the cappuccino maker anticlockwise and extract downwards (fig. 14).

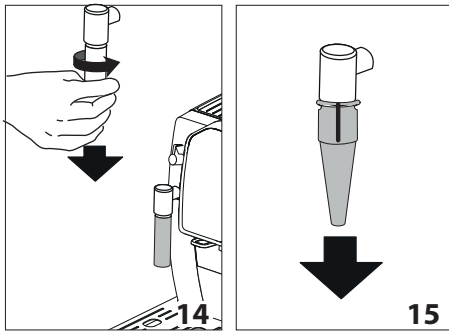

3. Remove the nozzle (A21) downwards (fig. 15).
4. Make sure the two holes shown by the arrow in fig. 16 are not blocked. If necessary, clean with a pin.

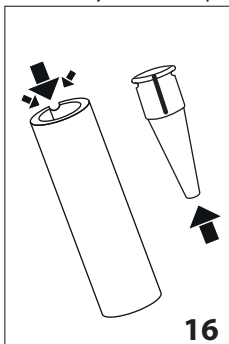

5. Reinsert the connection nozzle and replace the cappuccino maker on the nozzle, pushing it upwards and turning it until it is attached.

15. DELIVERING HOT WATER

Important! Danger of scalding.

Never leave the machine unattended while delivering hot water. The spout of the cappuccino maker (A20) becomes hot during delivery.

1. Place a container under the cappuccino maker (A20) (as close as possible to avoid splashes).
2. Turn the hot water/steam dial (A22) to the I position.
3. To stop hot water delivery manually, turn the steam/hot water dial (A22) to the 0 position.

Please note!

If "Energy Saving" is active, you may have to wait a few seconds before hot water and steam are delivered.

16. CLEANING

16.1 Cleaning the machine

The following parts of the machine must be cleaned regularly:

- the appliance's internal circuit;
- coffee grounds container (A11);
- drip tray (A15) and condensate tray (A10);
- water tank (A17);
- coffee spouts (A19);
- cappuccino maker (A20) - "14.1 Cleaning the cappuccino maker after use";
- pre-ground coffee funnel (A4);
- Infuser (A8), accessible after opening the infuser door (A7);
- touch screen (B).

Important!

- Do not use solvents, abrasive detergents or alcohol to clean the coffee machine. With De'Longhi superautomatic coffee machines, no chemical products are required for cleaning purposes.
- None of the components of the appliance can be washed in a dishwasher with the exception of the drip tray grille* (A14).
- Do not use metal objects to remove encrustations or coffee deposits as they could scratch metal or plastic surfaces.

16.2 Cleaning the internal circuit

If the appliance is not used for more than 3/4 days, before using it again, we strongly recommend switching it on and:

- performing 2/3 rinse cycles by pressing (B15);
- release hot water for a few seconds (section "15. Delivering hot water").

Please note:

Water may find its way into the grounds container (A11) during the above rinse procedure: this is quite normal.

16.3 Cleaning the coffee grounds container

When the  light (B2) flashes, the coffee grounds container (A11) must be emptied and cleaned. The appliance cannot be used to make coffee until the grounds container has been cleaned. Even if not full, the empty grounds container message is displayed 72 hours after the first coffee has been prepared. For the 72 hours to be calculated correctly, the machine must never be turned off with the main switch (A6).

Important! Danger of scalding

If you make a number of cappuccinos one after the other, the metal cup tray (A12) becomes hot. Wait for it to cool down before touching it and handle it from the front only.

To clean (with the machine on):

- Remove the drip tray (A15) (fig. 17), empty and clean.

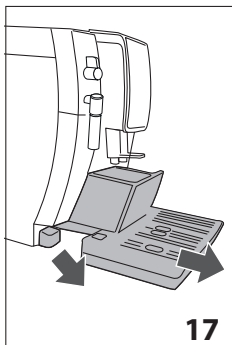

- Empty the grounds container (A11) and clean thoroughly to remove all residues left on the bottom.
- Check the red condensate tray (A10) and empty if necessary;

16.4 Cleaning the drip tray and condensate tray

Important!

The drip tray (A15) is fitted with a level indicator (A13) (red) showing the level of water it contains (fig. 18).

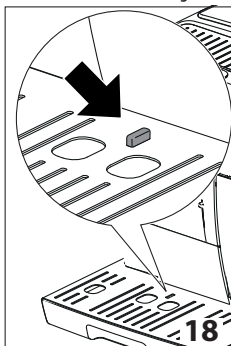

Before the indicator protrudes from the cup tray (A12), the drip tray must be emptied and cleaned, otherwise the water may overflow the edge and damage the appliance, the surface it rests on or the surrounding area.

To remove the drip tray:

1. Remove the drip tray and grounds container (A11) (fig. 17);
2. Remove the cup tray (A12) and drip tray grille* (A14), then empty the drip tray and grounds container and wash all components;
3. Check the red condensate tray (A10) and empty if necessary;
4. Replace the drip tray complete with grille and grounds container.

Important!

When removing the drip tray, the grounds container must be emptied, even if it contains few grounds.

If this is not done, when you make the next coffees, the grounds container will fill up more than expected and clog the machine.

16.5 Cleaning the inside of the machine

Danger of electric shock!

Before cleaning internal parts, the machine must be turned off (see section "5. Turning the appliance off") and unplugged from the mains power supply. Never immerse the machine in water.

1. Check regularly (about once a week) that the inside of the appliance (accessible after removing the drip tray (A15)) is not dirty. If necessary, remove coffee deposits with a brush and a sponge;
2. Remove all the residues with a vacuum cleaner (fig. 19).

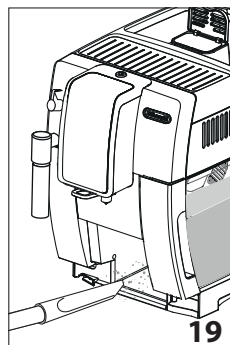

16.6 Cleaning the water tank

1. Clean the water tank (A17) regularly (about once a month) and whenever you replace the water softener filter (C4) (if provided) with a damp cloth and a little mild washing up liquid;
2. Remove the filter (C4) (if present) and rinse with running water;
3. Replace the filter (if installed), fill the tank with fresh water and replace;
4. Deliver about 100ml of water (models with water softener filter only).

16.7 Cleaning the coffee spouts

1. Clean the coffee spouts (A19) regularly with a sponge or cloth (fig. 20A);

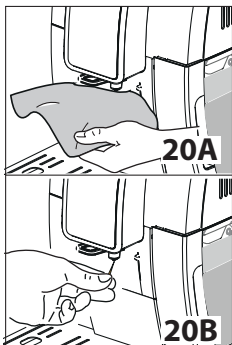

2. Check the holes in the coffee spouts are not blocked. If necessary, remove coffee deposits with a toothpick (fig. 20B).

16.8 Cleaning the pre-ground coffee funnel

Check regularly (about once a month) that the pre-ground coffee funnel (A4) is not blocked. If necessary, remove coffee deposits with a brush.

16.9 Cleaning the infuser

The infuser (A8) must be cleaned at least once a month.

Important!

The infuser cannot be removed when the machine is on.

1. Make sure the machine is correctly turned off (see section "5. Turning the appliance off");
2. Remove the water tank (A17);
3. Open the infuser door (A7) (fig. 21) on the right side of the appliance;

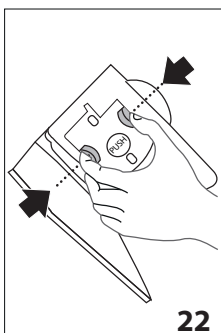
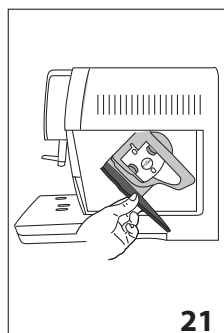

4. Press the two coloured release buttons inwards and at the same time pull the infuser outwards (fig. 22);
5. Soak the infuser in water for about 5 minutes, then rinse under the tap;

Important!

RINSE WITH WATER ONLY

NO WASHING UP LIQUID - NO DISHWASHER

Clean the infuser without using washing up liquid as it could be damaged.

6. Use a brush to remove any coffee residues left in the infuser housing, visible through the infuser door;
7. After cleaning, replace the infuser by sliding it onto the internal support, then push the PUSH symbol fully in until it clicks into place;

Please note:

If the infuser is difficult to insert, before insertion, adapt it to the right size by pressing the two levers (fig. 23).

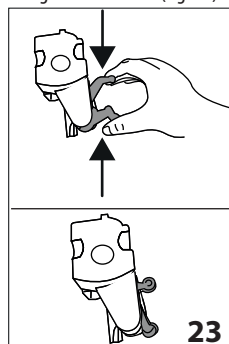

8. Once inserted, make sure the two coloured buttons have snapped out;
9. Close the infuser door;
10. Put the water tank back.

17. DESCALING

Important!

- Before use, read the instructions and the labelling on the descaler pack.
- Use De'Longhi descaler only. Using unsuitable descaler products and/or performing the descale procedure incorrectly could give rise to faults not covered by the manufacturer's guarantee.

Descaler could damage delicate surfaces. If the product is accidentally spilt, dry immediately.

| To descale | |
|------------|---------------------------|
| Descaler | De'Longhi descaler |
| Container | Recommended capacity: 1.8 |
| Time | ~45min |

Descale the appliance when the light (B5) on the touch screen (B) flashes and only the OK (B15) and ESC icons (B14) remain on.

To descale immediately, press OK and follow the instructions from point 4.

To descale the appliance later, press ESC. The light flashes on the touch screen to remind you that the appliance needs descaling.

To descale the appliance, proceed as follows:

1. Turn the appliance off (standby) by pressing the button (A23)- (fig. 7) (see section "5. Turning the appliance off");
2. Empty the drip tray (A15) and grounds container (A11) and return both to their positions in the machine;
3. Press and hold the icon (B8) until the light (B5) and the ESC and OK icons light up;
4. Empty the water tank (A17) completely and remove the water softener filter (C4) (if present).
5. Pour the descaler (C3) into the tank up to level A (corresponding to a 100ml pack) (fig. 24) marked on the inner surface of the tank, then add a litre of water up to level B (fig. 25) and put the water tank back in the appliance;

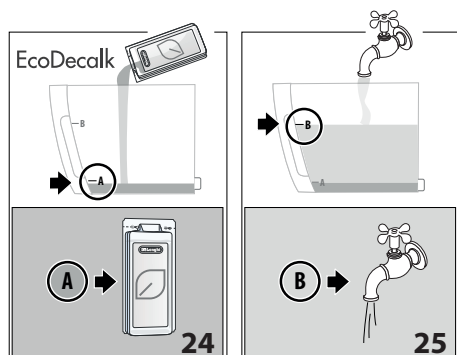

6. Place a container with a minimum capacity of 1.8 litres under the cappuccino maker (A20) and coffee spouts (A19) (fig. 26);

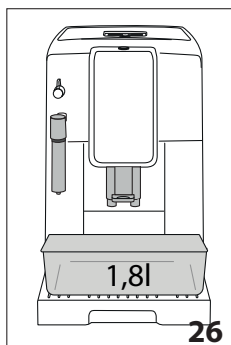



Important! Danger of scalding

Hot water containing acid flows from the cappuccino maker and coffee spouts. Take care to avoid contact with splashes of this solution.

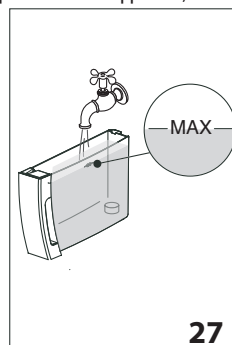
7. Press the OK icon to confirm that you have added the descaler solution. The descaling procedure begins;
 8. After a few minutes, the ESC icon (B14) flashes to indicate the steam/hot water dial (A22) must be turned to the I position;
 9. When the dial has been turned to the I position, the descale programme starts and the descaler liquid comes out of the cappuccino maker. A series of rinses and pauses are performed automatically to remove all the scale residues inside the coffee machine;
- After about 35 minutes, the appliance interrupts descaling and the light (B3) flashes.
10. The appliance is now ready to be rinsed out with clean water. Empty the container used to collect the descaler solution. Extract the water tank, empty, rinse under running water, fill with fresh water up to the MAX (fig. 27) level and put back in the appliance;



11. Place the container used to collect the descaler solution empty under the coffee spouts and cappuccino maker (fig. 26);
12. Press the OK icon: ESC flashes to indicate the steam/hot water dial must be turned to the 0 position;
13. Turn the steam/hot water dial to the 0 position to start rinsing. Hot water comes out of the coffee spouts;
14. After a preset time, ESC flashes. Turn the dial to the I position. Delivery continues from the cappuccino maker. When the water in the tank has run out, the light (B3) comes on;

15. The appliance is now ready for a second rinse with clean water. Empty the container used to collect the rinse water. Extract the water tank, empty, rinse under running water, fill with fresh water up to the MAX level, replace the water softener filter (if previously removed) and put back in the appliance;
 16. Place the container used to collect the rinsing water empty under the cappuccino maker;
 17. Press the  **OK** icon. The appliance begins rinsing again from the cappuccino maker only;
 18. When the water in the tank has run out, the  light flashes;
 19. Empty the container used to collect the rinse water, remove the water tank and fill with fresh water up to the MAX level, then put back in the appliance. The  **ESC** icon flashes;
 20. Turn the dial to the **0** position;
 21. Empty and replace the drip tray (A15) and grounds container (A11).
- The descaling cycle is now complete.

Please note!

- If the descaling cycle is not completed correctly (e.g. electrical power failure) it is advisable to repeat the procedure;
- After descaling, it is normal for the grounds container (A11) to contain water;
- If the water tank has not been filled to the MAX level, at the end of descaling, the appliance requests a third rinse to guarantee that the descaler solution has been completely eliminated from the machine's internal circuits.









18. SETTING WATER HARDNESS

The  light (B5) comes on after a period of time established according to water hardness.





The machine is set by default for a hardness level of 4. The machine can also be programmed according to the hardness of the mains water in the various regions so that the machine needs to be descaled less often.

18.1 Measuring water hardness

1. Remove the "TOTAL HARDNESS TEST" indicator paper (C1) from its pack (attached to the English instructions);
2. Immerse the paper completely in a glass of water for one second;
3. Remove the paper from the water and shake lightly. After about a minute, 1, 2, 3, or 4 red squares will appear, depending on the hardness of the water. Each square corresponds to 1 level;

| Indicator paper | Water hardness | Corresponding setting |
|---|----------------|--|
|  | low |  |
|  | medium |  |
|  | high |  |
|  | maximum |  |

18.2 Setting water hardness

1. With the appliance off (standby), but the main switch pressed (fig. 1);
2. Press and hold the **2x** (B9) icon until the lights on the touch screen (B) come on;
3. Press the  (B8) ;
4. Select the water hardness level by pressing the  icon again :
5. Press the  icon **OK** (B15) to confirm (or  **ESC** (B14) to exit without making the change). The lights go off. The machine is now reprogrammed with the new water hardness setting.

19. WATER SOFTENER FILTER

Certain models are fitted with a water softener filter (C4). If this is not the case with your model, you are recommended to purchase one from De'Longhi Customer Services.

To use the filter correctly, follow the instructions below.

19.1 Installing the filter

1. Remove the filter (C4) from the packaging. The date indicator disk varies according to the filter provided (fig. 28);

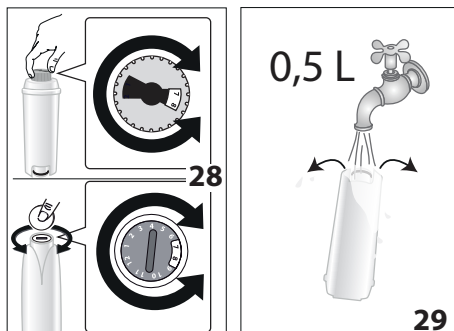

2. Turn the date disk to display the next 2 months of use.

Please note

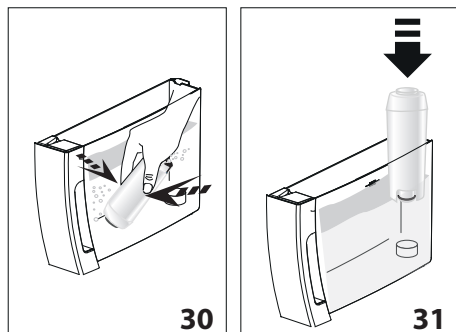

The filter lasts about two months if the appliance is used normally. If the coffee machine is left unused with the filter installed, it will last no longer than 3 weeks.

3. To activate the filter, run tap water through the hole in the filter as shown in fig. 29 until water comes out of the openings at the side for more than a minute.;
4. Extract the tank (A17) from the appliance and fill with water;
5. Insert the filter in the water tank and immerse it completely for about ten seconds, sloping it and pressing it lightly to enable the air bubbles to escape (fig. 30).

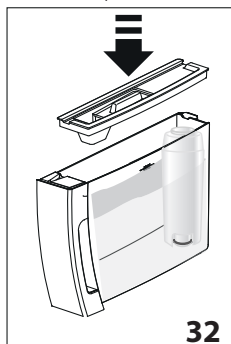

6. Insert the filter in the filter housing (A18) and press fully home (fig. 31);
7. Close the tank with the lid (A16) - (fig. 32), then replace the tank in the machine;



8. Position a container with a minimum capacity of 500ml under the cappuccino maker/hot water spout (A20).
9. Deliver hot water by turning the steam/hot water dial  (A22) to the **I** position.
10. Deliver at least 500 ml of hot water, then turn the steam/hot water dial  to the **0** position.

The filter is now active and you can use the coffee machine.

19.2 Replacing the filter

After two months (see date indicator) or when the appliance has not been used for 3 weeks, you should replace the filter:

1. Extract the tank (A17) and exhausted filter (C4);
2. Take the new filter out of its packet and proceed as illustrated in points 2 to 10 in the previous section.

The new filter is now active and the coffee machine can be used.

20. TECHNICAL DATA

| | |
|--------------------------------|------------------------------|
| Voltage: | 220-240 V~ 50/60 Hz max. 10A |
| Absorbed power: | 1450W |
| Pressure: | 1.5MPa (15 bars) |
| Max. water tank capacity: | 1.8l |
| Size LxDxH: | 240x440x360 mm |
| Cord length: | 1150 mm |
| Weight: | 9.2 kg |
| Max. beans container capacity: | 300 kg |









De'Longhi reserves the right to modify the technical specification and styling of its products at any moment, without compromising their functionality and quality.



20.1 Tips for Energy Saving

- Set auto-off to 15 minutes (see section "8. Auto-off");
- Enable Energy Saving (see section "9. Energy saving");





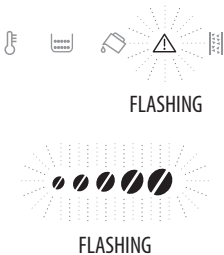
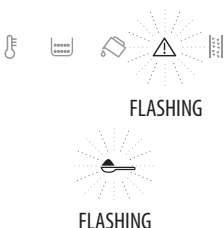

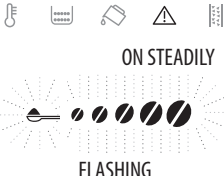
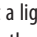
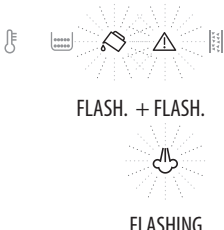
When requested by the machine, perform the descaling cycle.

21. EXPLANATION OF LIGHTS

| LIGHTS DISPLAYED | POSSIBLE CAUSE | REMEDY |
|---|---|--|
|  FLASHING | Insufficient water in the tank (A17). | Fill the tank with water and/or insert it correctly, pushing it as far as it will go until it clicks into place. |
|  ON STEADILY | The tank (A17) is missing or not correctly in place | Insert the tank correctly, pushing it as far as it will go until it clicks into place. |
|  FLASHING | The grounds container (A11) is full. | Empty the grounds container and drip tray(A15), clean and replace (fig. 16). Important: when removing the drip tray, the grounds container MUST be emptied, even if it contains few grounds. If this is not done, when you make the next coffees, the grounds container may fill up more than expected and clog the machine. |
|  ON | After cleaning, the grounds container has not been replaced (A11) | Remove the drip tray (A15) and insert the grounds container. |
|  ON STEADILY  FLASHING | The coffee beans have run out | Fill the beans container (A3) (fig. 9). |
| | The pre-ground coffee funnel (A4) is clogged | Empty the funnel with the aid of a brush as described in section "16.8 Cleaning the pre-ground coffee funnel". |
|  ON STEADILY  FLASHING | The pre-ground coffee function has been selected without placing any pre-ground coffee in the funnel (A4) | Place pre-ground coffee in the funnel (fig. 12) or deselect the "pre-ground" function. |
| | The pre-ground coffee funnel (A4) is clogged | Empty the funnel with the aid of a brush as described in section "16.8 Cleaning the pre-ground coffee funnel". |
|  FLASHING | The machine must be descaled | The descaling procedure described in section "17. Descaling" needs to be carried out without delay. |
| → | | |

| LIGHTS DISPLAYED | POSSIBLE CAUSE | REMEDY |
|--|---|---|
|  | <p>The grinding is too fine and the coffee is delivered too slowly or not at all</p> <p>If the water softener filter (C4) is present, an air bubble may have been released inside the circuit, obstructing delivery</p> | <p>Repeat coffee delivery and turn the grinding adjustment dial (A5) (fig. 8) one click clockwise towards 7 while the coffee mill is in operation. If after making at least 2 coffees delivery is still too slow, repeat the correction procedure, turning the grinding adjustment dial another click (see section "13.1 Adjusting the coffee mill"). If the problem persists, make sure the water tank (A17) is fully inserted, turn the hot water/steam dial (A22) to the I position and deliver a little water until the flow is regular.</p> <p>Deliver a little water by turning the steam dial (A22) to the I position until the flow is regular.</p> |
|  | <p>The pre-ground coffee used is too fine and the coffee is delivered too slowly or not at all</p> <p>If the water softener filter (C4) is present, an air bubble may have been released inside the circuit, obstructing delivery</p> | <p>Repeat coffee delivery using less pre-ground coffee, or a different type. If the problem persists, make sure the water tank (A17) is fully inserted, turn the hot water/steam dial (A22) to the I position and deliver a little water until the flow is regular.</p> <p>Deliver a little water by turning the steam dial (A22) to the I position until the flow is regular.</p> |
|  | <p>A LONG coffee with pre-ground coffee has been requested</p> | <p>Put one level measure (C2) of pre-ground coffee into the pre-ground coffee funnel (A4) and press  OK (B15) to continue and complete preparation.</p> |
|  | <p>Too much coffee has been used</p> | <p>Select a lighter taste by pressing  (B8) or reduce the quantity of pre-ground coffee.</p> |
|  | <p>The water circuit is empty</p> | <p>Turn the steam/hot water dial (A22) to the I position until delivery stops, then bring it back to the 0 position. If the alarm occurs while hot water or steam is being delivered, turn the dial to the 0 position. Turn the steam/hot water dial to the I position until delivery stops, then bring it back to the 0 position. If the problem persists, make sure the water tank (A17) is fully inserted.</p> |





| LIGHTS DISPLAYED | POSSIBLE CAUSE | REMEDY |
|---|---|--|
|  ON STEADILY | The inside of the machine is very dirty | Clean the inside of the appliance thoroughly, as described in section “16. Cleaning”. If the message is still displayed after cleaning, contact a customer service centre. |
|  FLASHING | The infuser has not been replaced after cleaning (A8) | Insert the infuser as described in section “16.9 Cleaning the infuser”. |
|  FLASHING | Indicates the steam/hot water dial must be turned (A22) | Turn the steam/hot water dial. |
|  FLASHING  ESC +  OK ON STEADILY | The machine must be descaled | The descaling procedure needs to be performed as soon as possible (see section “17. Descaling”). |

22. TROUBLESHOOTING

Below is a list of some of the possible malfunctions.

If the problem cannot be resolved as described, contact customer services.

| PROBLEM | POSSIBLE CAUSE | REMEDY |
|--|--|--|
| The coffee is not hot. | The cups were not preheated. | Warm the cups by rinsing them with hot water (Please note: you can use the hot water function). |
| | The internal circuits of the appliance have cooled down because 2/3 minutes have elapsed since the last coffee was made. | Before making coffee, rinse the internal circuits by pressing the  icon (B15). |
| | The coffee temperature setting is too low. | Set a higher coffee temperature in the menu (see section “7. Setting temperature”). Please note: Varying the temperature has most effect for long beverages. |
| The coffee is weak or not creamy enough. | The coffee beans have been ground too coarsely. | Turn the grinding adjustment dial (A5) one click anticlockwise towards “1” while the coffee mill is in operation (fig. 8). Continue one click at a time until coffee delivery is satisfactory. The effect is only visible after delivering 2 coffees (see section “13.1 Adjusting the coffee mill”). |
| | The coffee is unsuitable. | Use coffee for espresso machines. |
| → | | |

| PROBLEM | POSSIBLE CAUSE | REMEDY |
|---|--|--|
| The coffee is delivered too slowly or drop by drop. | The coffee is ground too finely. | Turn the grinding adjustment dial (A5) one click clockwise towards "7" while the coffee mill is in operation (fig. 8). Continue one click at a time until coffee delivery is satisfactory. The effect is only visible after delivering 2 coffees (see section "13.1 Adjusting the coffee mill"). |
| The appliance will not make coffee | The appliance has detected impurities in its internal circuits, the  light (B1) flashes | Wait for the appliance to be ready again and reselect the required beverage. Contact customer services if the problem persists. |
| The infuser (A8) cannot be removed | The appliance has not been turned off correctly | Turn the appliance off by pressing the  button (A23) (see section "5. Turning the appliance off"). |
| At the end of descaling, the appliance requests a third rinse | During the two rinse cycles, the water tank has not been filled to the MAX level. | Follow the instructions displayed by the appliance, but first empty the drip tray (A15) to avoid the water overflowing. |
| The frothed milk has large bubbles | The milk is not cold enough or is not semi-skimmed | Ideally, use skimmed or semi-skimmed milk from the refrigerator (about 5°C). If the result is still not as desired, try changing the brand of milk. |
| The milk is not frothed | The cappuccino maker(A22) and steam/hot water connection nozzle (A21) are dirty | Clean as described in section "14.1 Cleaning the cappuccino maker after use". |
| Steam delivery stops | A safety device stops steam delivery | Wait a few minutes and then enable the steam function again. |
| The appliance does not come on | The appliance is not plugged into the mains socket | Plug into the mains socket (fig. 1). |
| | The main switch (A6) is not pressed | Press the main switch (fig. 1). |
| Coffee does not come out of one or both of the coffee spouts | The coffee spouts (A19) are blocked | Clean as described in section "16.7 Cleaning the coffee spouts". |

Register Now 
www.delonghi.com/register



De'Longhi Appliances via Seitz, 47 31100 Treviso, Italy www.delonghi.com

5713232361_02_0321