



# DeLonghi

## Get Started

This short guide is not intended to explain all the functions of the appliance. Please read all the owner's instruction booklet before use.



BCO432



# MACHINE SET UP



Remove water tank, fill with water and replace.

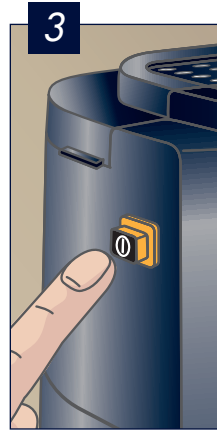
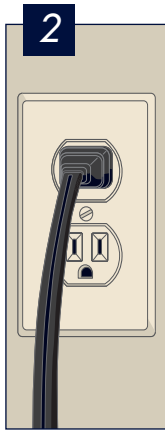

To turn on machine, push  button on the left side.

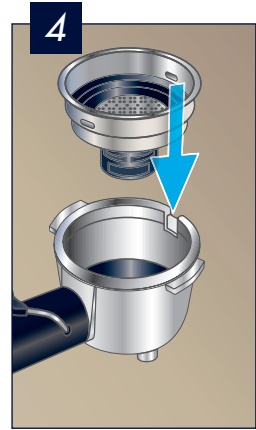

Put steel filter cup into the steel filter holder.



Turn filter holder to right to lock into position.



Press coffee/hot water  button.



Wait until water is delivered, then press coffee/hot water  button to stop the flow.

*Machine is now ready to work!*

# BREWING ESPRESSO



Use correct filter:  
smaller filter= 1 cup  
larger filter= 2 cups

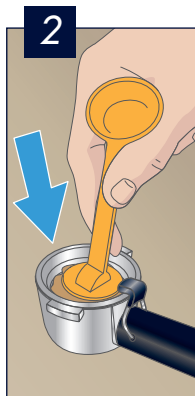

Tamp the coffee.

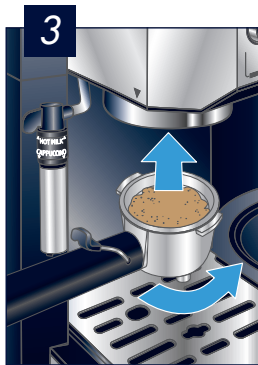

Attach filter holder in place into boiler outlet.



Turn filter holder firmly to right to lock into position.



When ☕ light is green, press button to start coffee delivery. When the desired quantity is reached press button again to stop.



Brew 1 or 2 Espresso at one time.



# BREWING CAPPUCCINO or HOT MILK

Refer to previous section BREWING ESPRESSO for the espresso related part.



**Hot Milk**



**Cappuccino**



Fill 1/3 of the pitcher, 3.5 oz. for Cappuccino, 6 oz. for Latte.



Press steam button.



Wait for GREEN light to turn on.



Be sure frother is immersed in milk, but not beyond the metal pipe



Turn the steam dial counter-clockwise to ON to release the steam.

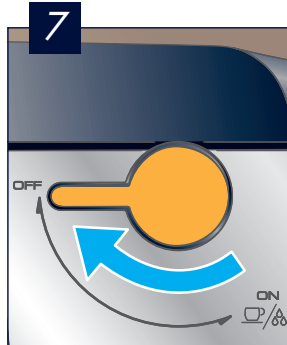

When the desired level of foam is reached, turn the steam dial clockwise to OFF to stop the steam.



Pour the milk over the espresso and enjoy!

*Tip for the  
BEST CAPPUCCINO:*

Use Skim or 2% Milk at Refrigerator Temperature (about 41°F/5°C)

## BREWING DRIP COFFEE



Remove coffee pot, fill with desired amount of water.

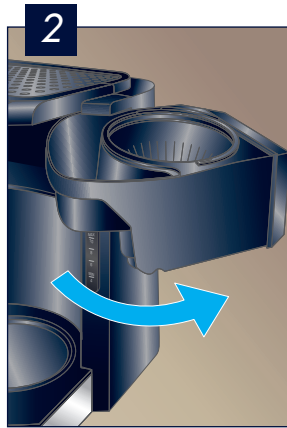

Open the water fill compartment.



Pour water into water reservoir then replace coffee pot onto warming plate.

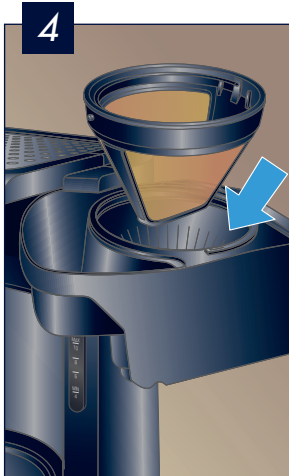

Place gold tone coffee filter into filter reservoir.



Add desired amount of coffee into coffee filter and close the compartment.



Press ON button to start brewing process. When machine has finished to brew coffee press OFF button





[www.delonghi.com](http://www.delonghi.com)

 like us: DeLonghi North America –  follow us @DeLonghiNA

5713238261\_00\_0518 - Printed in China