

- A1. Water tank lip and filter storage
- A2. Cup warmer/storage tray
- A3. Control panel dial
- A4. Boiler outlet
- A5. Steam dial
- A6. Steam spout / frother
- A7. High glass tray
- A8. Drip tray
- A9. Water tank

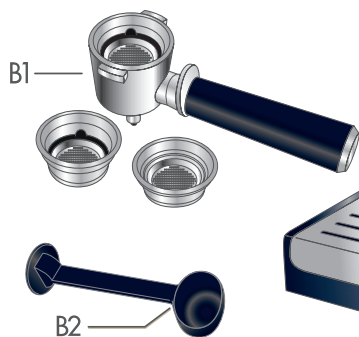

- B1. Filter holder with 3 filter cups
- B2. Tamper/dispenser measure scoop

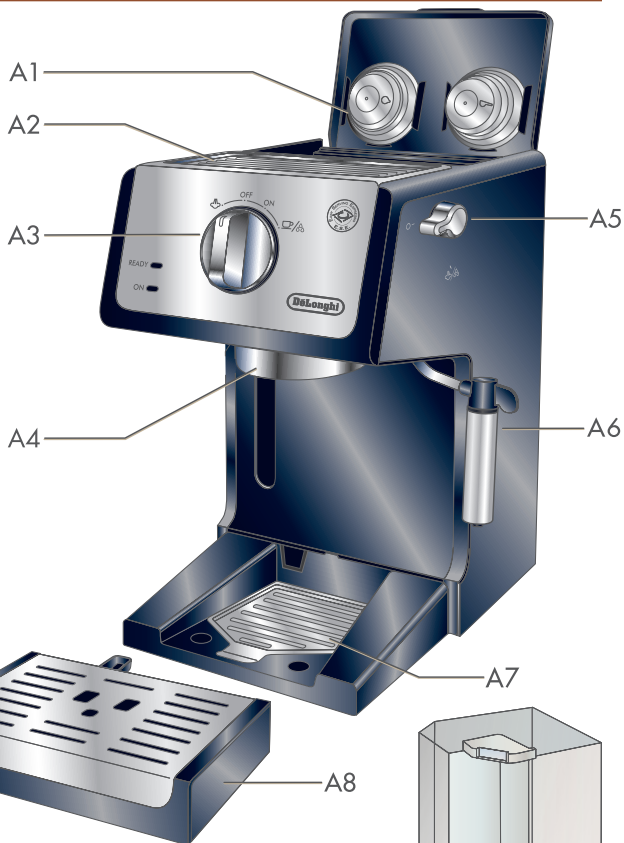

Get Started &
Owner's Instructions
Booklets

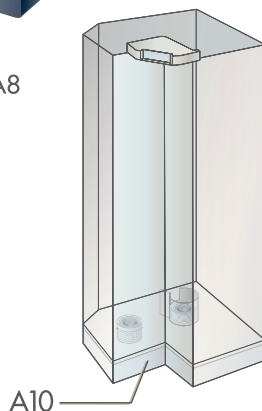

MACHINE SET UP

DeLonghi

5713235611_00_0817



Remove tank, fill with water

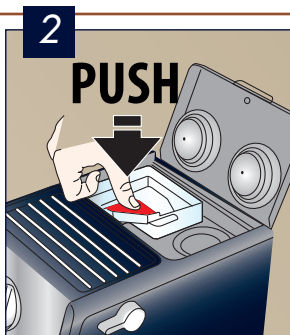

Replace water tank and plug the appliance in



Place containers under boiler outlet and cappuccino maker



Turn dial to ON position, red light is on and unit is heating up.

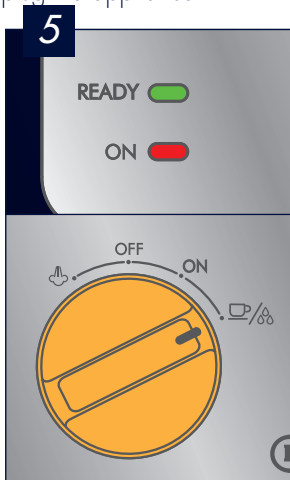

When READY light is green, turn dial to  position let about half the tank discharge from the boiler outlet.

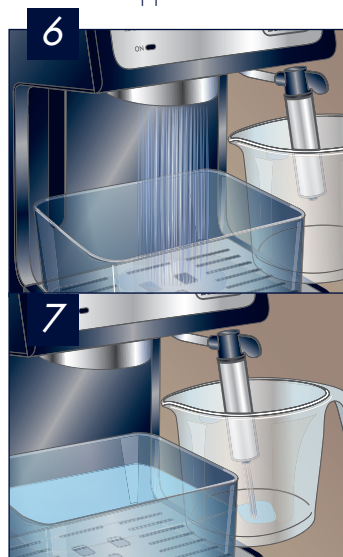

Then turn the steam dial to the  position and discharge all the water remaining in the tank from the cappuccino maker. Turn the steam dial back to 0 and the selector dial to ON position to stop the flow.

*Note: This operation can take a few minutes.
The machine may vibrate.*

Machine is now ready to work!

ECP3420-3220