



---

ECAM25.46X

BEAN TO CUP ESPRESSO  
AND CAPPUCCINO MACHINE  
Instruction for Use



---

**De'Longhi**

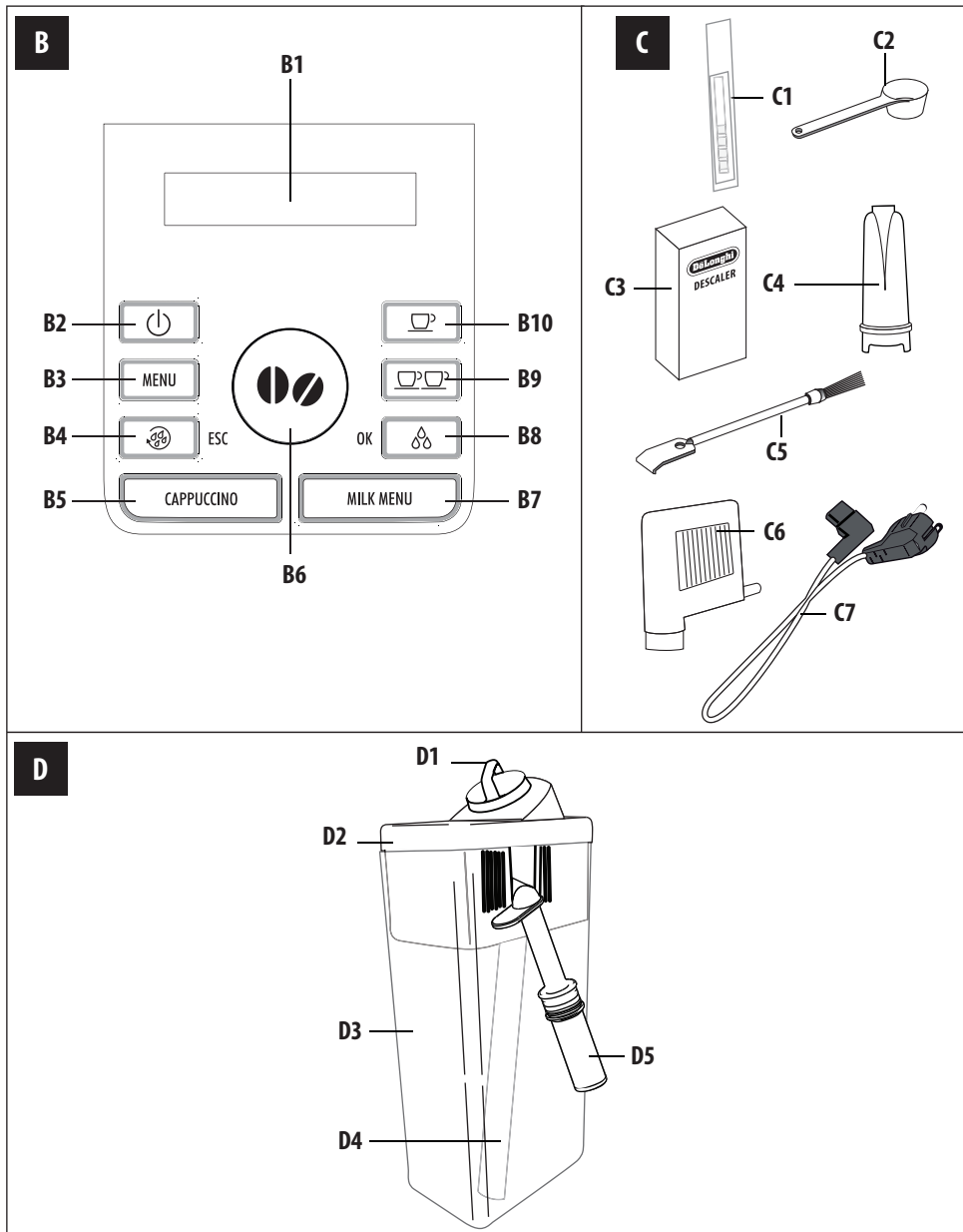
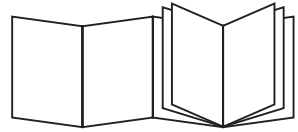

**A**

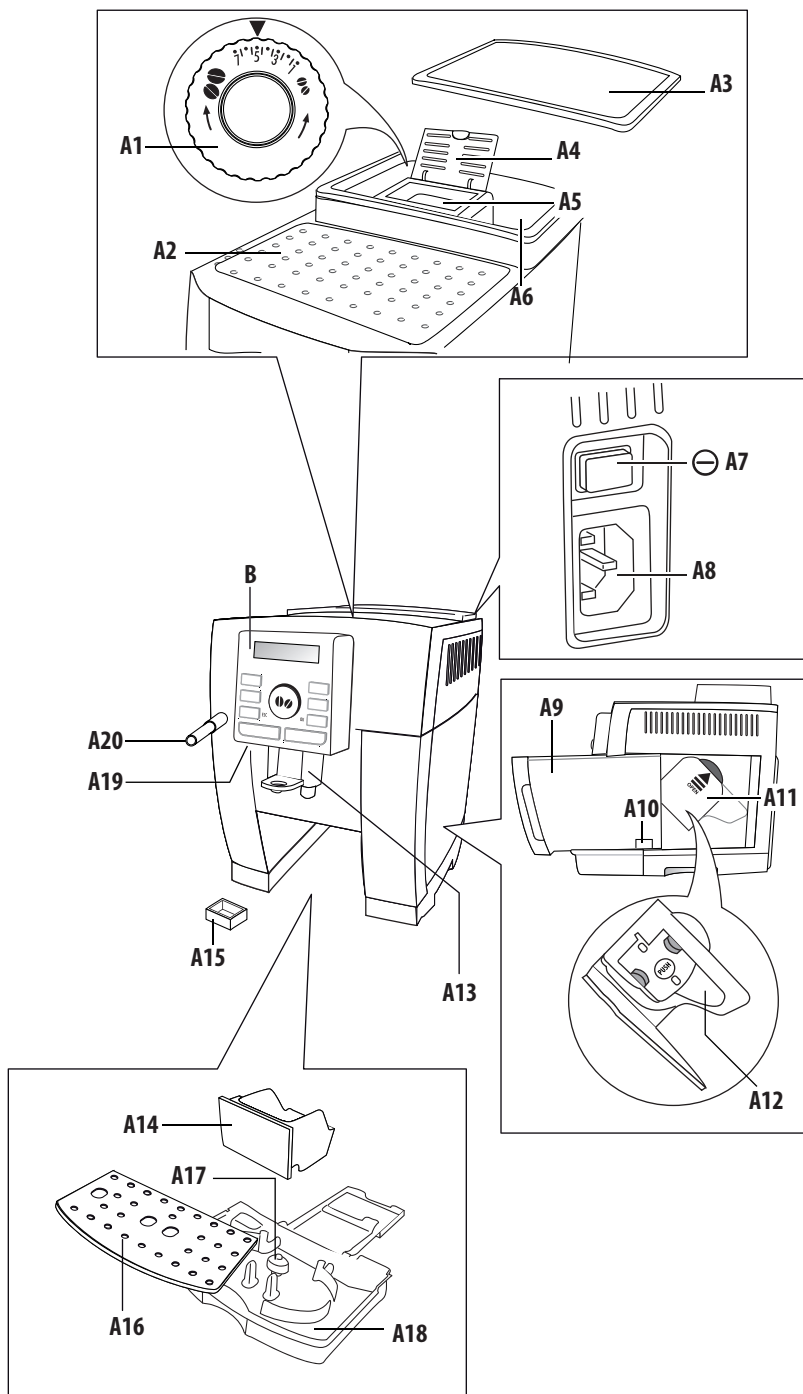

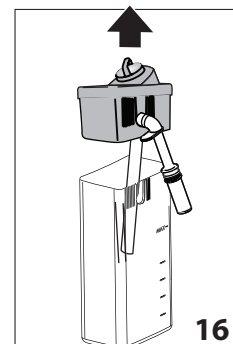
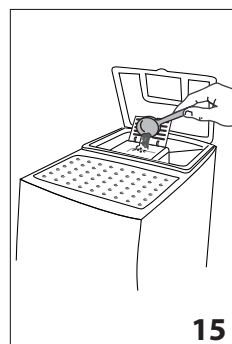
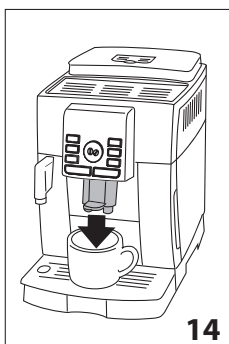
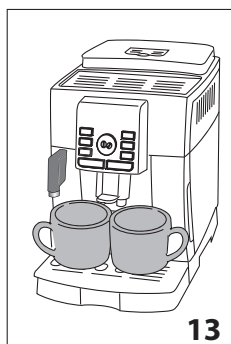
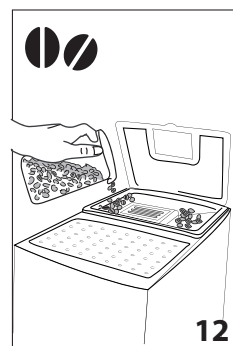
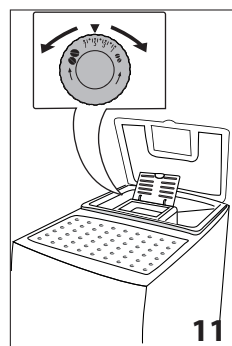
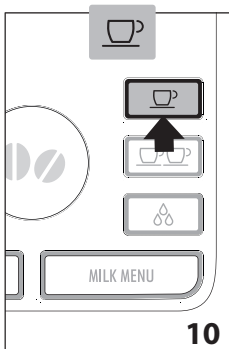
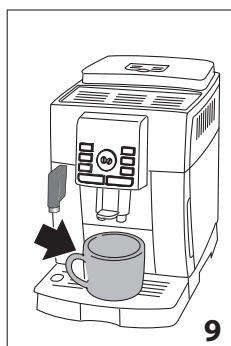
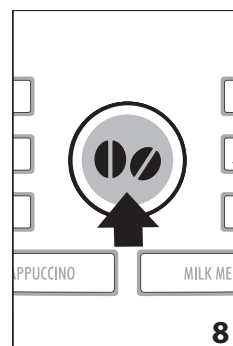
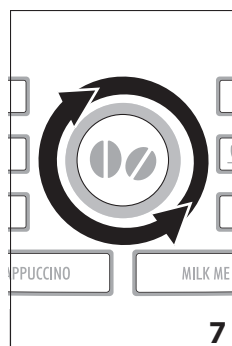
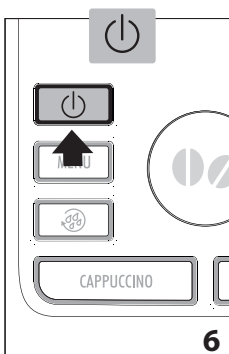
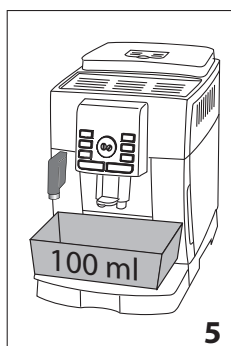
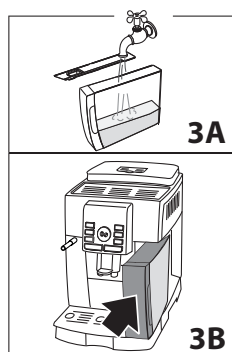
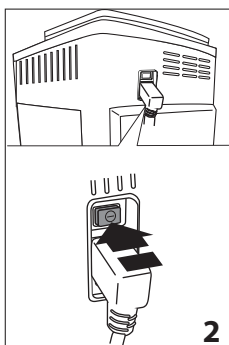
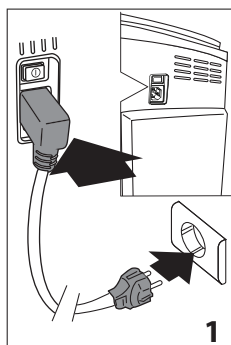

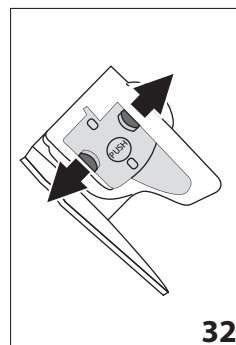
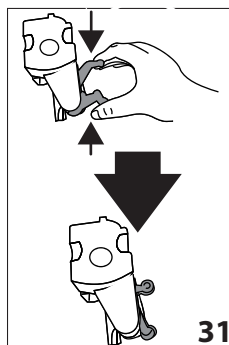
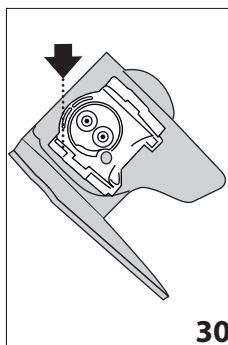
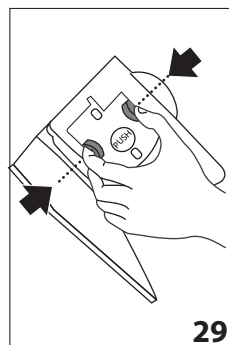
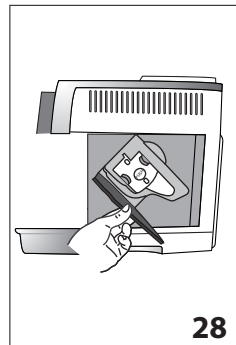
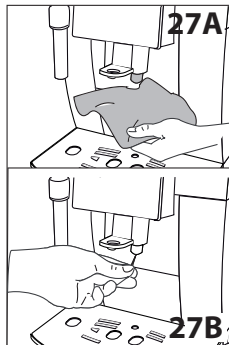
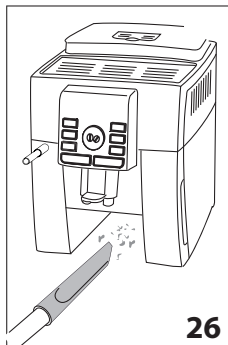
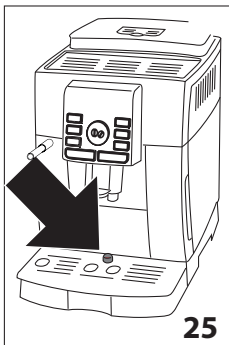
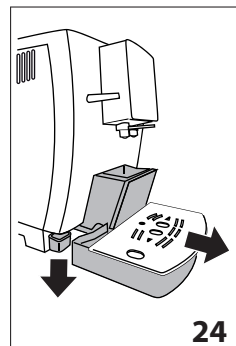
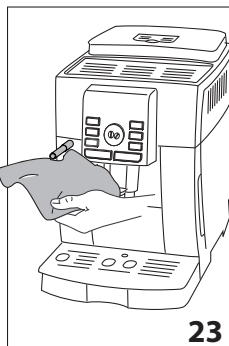
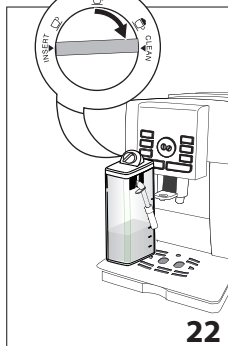
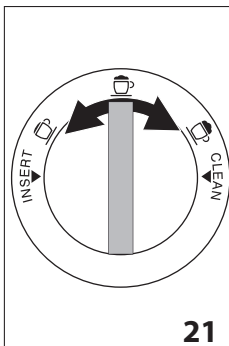
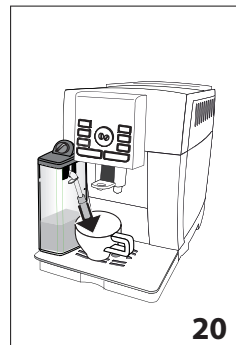
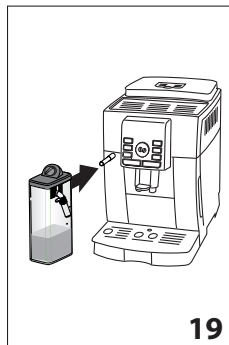
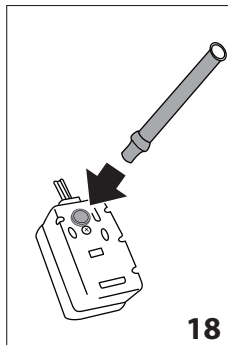
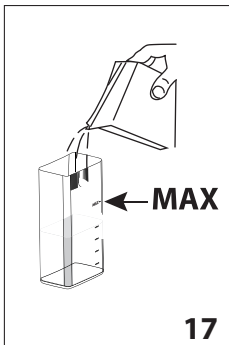

## CONTENTS

|  |           |
|--|-----------|
| <b>1. FUNDAMENTAL SAFETY WARNINGS</b>            | <b>7</b>  |
| <b>2. SAFETY WARNINGS</b>                        | <b>8</b>  |
| 2.1 Symbols used in these instructions           | 8         |
| 2.2 Designated use                               | 8         |
| 2.3 Instruction for Use                          | 8         |
| <b>3. INTRODUCTION</b>                           | <b>8</b>  |
| 3.1 Letters in brackets                          | 8         |
| 3.2 Troubleshooting and repairs                  | 8         |
| <b>4. DESCRIPTION</b>                            | <b>9</b>  |
| 4.1 Description of the appliance                 | 9         |
| 4.2 Description of the control panel             | 9         |
| 4.3 Description of the accessories               | 9         |
| 4.4 Description of the milk container            | 9         |
| <b>5. BEFORE USE</b>                             | <b>9</b>  |
| 5.1 Checking the appliance                       | 9         |
| 5.2 Installing the appliance                     | 9         |
| 5.3 Connecting the appliance                     | 10        |
| 5.4 Setting up the appliance                     | 10        |
| <b>6. TURNING THE APPLIANCE ON</b>               | <b>10</b> |
| <b>7. TURNING THE APPLIANCE OFF</b>              | <b>10</b> |
| <b>8. MENU SETTINGS</b>                          | <b>11</b> |
| 8.1 Descaling                                    | 11        |
| 8.2 Install filter                               | 11        |
| 8.3 Replacing the filter                         | 11        |
| 8.4 Adjust time                                  | 11        |
| 8.5 Auto-start                                   | 11        |
| 8.6 Auto-off                                     | 11        |
| 8.7 Cup warmer                                   | 11        |
| 8.8 Energy saving                                | 11        |
| 8.9 Set temperature                              | 12        |
| 8.10 Setting water hardness                      | 12        |
| 8.11 Enable/disable the beep                     | 12        |
| 8.12 Setting the language                        | 12        |
| 8.13 Cup lighting                                | 12        |
| 8.14 Default values (reset)                      | 12        |
| 8.15 Statistics function                         | 12        |
| <b>9. RINSING</b>                                | <b>13</b> |
| <b>10. MAKING COFFEE</b>                         | <b>13</b> |
| 10.1 Selecting the coffee taste                  | 13        |
| 10.2 Selecting the quantity of coffee in the cup | 13        |
| 10.3 Customising the "my coffee" quantity        | 13        |
| 10.4 Adjusting the coffee mill                   | 13        |
| 10.5 Tips for a hotter coffee                    | 14        |
| 10.6 Making coffee using coffee beans            | 14        |
| 10.7 Making coffee using pre-ground coffee       | 14        |

|   |           |
|---|-----------|
| <b>11. MAKING CAPPUCCINO AND MILK-BASED COFFEES</b>           | <b>14</b> |
| 11.1 Filling and attaching the milk container                 | 14        |
| 11.2 Adjusting the amount of froth                            | 15        |
| 11.3 Making cappuccino  | 15        |
| 11.4 Making MACCHIATO / CAFFELATTE/ MILK / FLAT WHITE         | 15        |
| 11.5 Cleaning the milk container after every use              | 15        |
| 11.6 Programming the quantities of coffee and milk in the cup | 16        |
| 11.7 Programming cappuccino:                                  | 16        |
| 11.8 Programming "MILK MENU" drinks:                          | 16        |
| <b>12. PREPARING HOT WATER</b>                                | <b>16</b> |
| 12.1 Changing the quantity of water delivered automatically   | 16        |
| <b>13. CLEANING</b>   | <b>16</b> |
| 13.1 Cleaning the machine                                     | 16        |
| 13.2 Cleaning the machine's internal circuit                  | 17        |
| 13.3 Cleaning the coffee grounds container                    | 17        |
| 13.4 Cleaning the drip tray and condensate tray               | 17        |
| 13.5 Cleaning the inside of the coffee machine                | 17        |
| 13.6 Cleaning the water tank                                  | 17        |
| 13.7 Cleaning the coffee spouts                               | 17        |
| 13.8 Cleaning the pre-ground coffee funnel                    | 17        |
| 13.9 Cleaning the infuser                                     | 17        |
| 13.10 Cleaning the milk container                             | 18        |
| 13.11 Cleaning the hot water/steam connection nozzle          | 18        |
| <b>14. DESCALING</b>  | <b>18</b> |
| <b>15. SETTING WATER HARDNESS</b>                             | <b>19</b> |
| 15.1 Measuring water hardness                                 | 20        |
| 15.2 Setting water hardness                                   | 20        |
| <b>16. WATER SOFTENER FILTER</b>                              | <b>20</b> |
| 16.1 Replacing the filter                                     | 20        |
| 16.2 Removing the filter                                      | 21        |
| <b>17. TECHNICAL DATA</b>                                     | <b>21</b> |
| <b>18. DISPOSAL</b>   | <b>21</b> |
| <b>19. DISPLAYED MESSAGES</b>                                 | <b>22</b> |
| <b>20. TROUBLESHOOTING</b>                                    | <b>23</b> |
| <b>21. ELECTRICAL CONNECTION (UK ONLY)</b>                    | <b>25</b> |

## 1. FUNDAMENTAL SAFETY WARNINGS

- The appliance is not intended for use by persons (including children) with reduced physical, sensory or mental capabilities, or lack of experience and knowledge, unless they have been given supervision or instruction concerning use of the appliance by a person responsible for their safety.
- Children should be supervised to ensure that they do not play with the appliance.
- Cleaning and user maintenance shall not be made by children without supervision.
- Never clean by immersing the appliance in water.
- This is an household appliance only.  
It is not intended to be used in: staff kitchen areas in shops, offices and other working environments; farm houses; by clients in hotels, motels and other residential type environments; bed and breakfast type environments.
- If the plug or cord is damaged, it must be replaced by Customer Services only to avoid all risk.

### FOR EUROPEAN MARKETS ONLY:

- This appliance can be used by children aged from 8 years and above if they have been given supervision or instruction concerning use of the appliance in a safe way and understand the hazards involved.  
Cleaning and user maintenance shall not be made by children unless they are above 8 years old and supervised.  
Keep the appliance and power cord away from children under 8 years of age.
- Appliances can be used by persons with reduced physical, sensory or mental capabilities or lack of experience and knowledge if they are supervised or have been given instruction concerning use of the appliance in a safe way and if they understand the hazards involved.
- Children shall not play with the appliance.
- Always unplug the appliance when left unattended and before assembly, taking apart or cleaning.



Surfaces marked with this symbol become hot during use (the symbol is present in certain models only).



## 2. SAFETY WARNINGS

### 2.1 Symbols used in these instructions

Important warnings are identified by these symbols. It is vital to respect these warnings.



#### **Danger!**

Failure to observe the warning may result in life threatening injury by electric shock.



#### **Important!**

Failure to observe the warning could result in injury or damage to the appliance.



#### **Danger of burns!**

Failure to observe the warning could result in scalds or burns.



#### **Please note:**

This symbol identifies important advice or information for the user.



#### **Danger!**

This is an electrical appliance and may cause electric shock.

You should therefore follow these safety warnings:

- Never touch the appliance with damp hands or feet.
- Never touch the plug with damp hands.
- Make sure the socket used is freely accessible at all times, enabling the appliance to be unplugged when necessary.
- Unplug directly from the plug only.  
Never pull the cord as you could damage it.
- To disconnect the appliance completely you must unplug it from the mains socket.
- If the appliance is faulty, do not attempt to repair.  
Turn it off, unplug from the mains socket and contact Customer Services.
- Before cleaning the appliance, turn it off, unplug from the mains socket and allow to cool.



#### **Important:**

Keep all packaging (plastic bags, polystyrene foam) away from children.



#### **Danger of burns!**

This appliance produces hot water and steam may form while it is in operation.

Avoid contact with splashes of water or hot steam.

When the appliance is in operation, the cup shelf could become very hot.

### 2.2 Designated use

This appliance is designed and made to prepare coffee and heat drinks. Any other use is considered improper and thus dangerous. The manufacturer is not liable for damage deriving from improper use of the appliance.

### 2.3 Instruction for Use

Read this Instruction for Use carefully before using the appliance. Failure to follow this Instruction for Use may result in injury or damage to the appliance.

The manufacturer is not liable for damage deriving from failure to respect this Instruction for Use.



#### **Please note:**

Keep this Instruction for Use.

If the appliance is passed to other persons, they must also be provided with this Instruction for Use.

## 3. INTRODUCTION

Thank you for choosing this bean to cup espresso and cappuccino machine.

We hope you enjoy using your new appliance.

Take a few minutes to read this Instruction for Use.

This will avoid all risks and damage to the appliance.

### 3.1 Letters in brackets

The letters in brackets refer to the legend in the description of the appliance on pages 2-3.

### 3.2 Troubleshooting and repairs

In the event of problems, first try to resolve them by reading the information given in sections "19. Displayed messages" and "20. Troubleshooting"

If this does not resolve the problem or you require further information, you should consult Customer Services by calling the number given on the annexed "Customer Service" sheet.

If your country is not among those listed on the sheet, call the number given in the guarantee.

If repairs are required, contact De'Longhi Customer Services only.

The addresses are given in the guarantee certificate provided with the machine.

## 4. DESCRIPTION

### 4.1 Description of the appliance





(page 3 - A )

- A1. Grinding adjustment dial
- A2. Cup shelf (cup warmer active when selected from settings menu)
- A3. Beans container lid
- A4. Pre-ground coffee funnel lid
- A5. Pre-ground coffee funnel
- A6. Beans container
- A7. Main switch
- A8. Power cord connector socket
- A9. Water tank
- A10. Water softener filter housing
- A11. Infuser door
- A12. Infuser
- A13. Coffee spouts (adjustable height)
- A14. Coffee grounds container
- A15. Condensate tray
- A16. Cup tray
- A17. Drip tray water level indicator
- A18. Drip tray
- A19. Cup light
- A20. Hot water/steam connection nozzle

### 4.2 Description of the control panel

(page 2 - B )

*A number of buttons on the panel have a double function. This is indicated in brackets in the description.*

- B1. Display: guides the user in using the appliance
- B2.  button: turns the appliance on and off
- B3. **MENU** button to access the menu
- B4.  button: to perform a rinse cycle.  
*(When in the settings MENU this button functions as an ESC button to exit the function selected and go back to the main menu)*
- B5. **CAPPUCCINO** button: to deliver a cappuccino.
- B6. Selection dial:
  - turn to select the required quantity of coffee.
  - press to select the required taste.*(When in the settings MENU, turn to select the required function)*
- B7. **MILK MENU** button: to access preparation of MACCHIATO, CAFFELATTE, MILK and FLAT WHITE.
- B8.  button to deliver hot water.  
*(When you access the MENU: "OK" button to confirm the selection made)*
- B9.  button: to make 2 cups of coffee
- B10.  button: to make 1 cup of coffee

### 4.3 Description of the accessories

(page 2 - C )

- C1. "Total Hardness Test" indicator paper
- C2. Measure
- C3. Descaler
- C4. Water softener filter (certain models only)
- C5. Cleaning brush
- C6. Hot water spout
- C7. Power cord

### 4.4 Description of the milk container

(page 3 - D )

- D1. Froth adjustment and CLEAN dial
- D2. Milk container lid
- D3. Milk container
- D4. Milk intake tube
- D5. Frothed milk spout (adjustable)

## 5. BEFORE USE

### 5.1 Checking the appliance

After removing the packaging, make sure the product is complete and undamaged and that all accessories are present.

Do not use the appliance if it is visibly damaged.

Contact De'Longhi Customer Services.

### 5.2 Installing the appliance



#### **Important!**

When you install the appliance, you should respect the following safety warnings:

- The appliance gives off heat.  
After positioning the appliance on the worktop, leave a space of at least 3 cm between the surfaces of the appliance and the side and rear walls and at least 15 cm above the coffee maker.
- Water penetrating the coffee maker could cause damage.  
Do not place the appliance near taps or sinks.
- The appliance could be damaged if the water it contains freezes.  
Do not install the appliance in a room where the temperature could drop below freezing point.
- Arrange the cord in such a way that it cannot be damaged by sharp edges or contact with hot surfaces (e.g. electric hot plates).

### 5.3 Connecting the appliance



#### **Important!**

Check that the mains power supply voltage corresponds to that indicated on the rating plate on the bottom of the appliance.

Connect the appliance to an efficiently earthed and correctly installed socket with a minimum current rating of 10A only.

If the power socket does not match the plug on the appliance, have the socket replaced with a suitable type by a qualified electrician.

### 5.4 Setting up the appliance





#### **Please note:**

- Coffee has been used to factory test the appliance and it is therefore completely normal for there to be traces of coffee in the mill.  
The machine is, however, guaranteed to be new.
- You should customise water hardness as soon as possible following the instructions in section "15. Setting water hardness".

1. Insert the power cord (C7) connector into the socket (A8) at the back of the appliance and connect the appliance to the mains electricity supply (fig. 1). Make sure the main switch (A7) at the back of the appliance is pressed (fig. 2).
2. Remove the water tank (A9), fill to the MAX line with fresh water (fig. 3A) then put back in the appliance (fig. 3B).

You must first choose the language by turning the selection dial (B6), or waiting until the languages scroll through on the display (B1) at intervals of about 3 seconds:

3. When "English" appears, press the  button (B8) (fig. 4) for a few seconds until "English set" appears on the display. Follow the instructions indicated on the appliance display:
4. "INSERT WATER SPOUT": Check that the hot water spout (C6) is inserted on the connection nozzle (A20) and place a container holding a minimum of 100 ml underneath (fig. 5)
5. "HOT WATER Confirm?" appears on the display;
6. Press the  button to confirm. The appliance delivers hot water from the spout then goes off automatically.

The coffee machine is now ready for normal use.



#### **Please note:**

- When setting up the appliance, you need to make 4-5 cups of coffee or 4-5 cappuccinos before the appliance starts to give satisfactory results.
- When making the first 5-6 cappuccinos, it is normal to hear the noise of boiling water. After this, the noise becomes less.

- To enjoy your coffee even more and improve the performance of your appliance, we recommend installing a water softener filter (C4) as described in section "15. Setting water hardness".

If your model is not provided with a filter, you can request one from De'Longhi Customer Services.

### 6. TURNING THE APPLIANCE ON



#### **Please note:**

Before turning the appliance on, make sure the main switch (A7) on the back of the appliance is pressed (fig. 2).

Each time the appliance is turned on, it performs an automatic preheat and rinse cycle which cannot be interrupted.

The appliance is ready for use only after completion of this cycle.



#### **Danger of burns!**

During rinsing, a little hot water comes out of the coffee spouts (A13) and is collected in the drip tray (A18) underneath.

Avoid contact with splashes of water.

- To turn the appliance on, press the  button (B2) (fig. 6). The message "Heating up Please wait" appears on the display (B1).

When heating is complete, the message changes to "Rinsing". As well as heating the boiler, this also heats the internal circuits by circulating hot water.

The appliance is at temperature when the message indicating the taste and quantity of coffee appears.

### 7. TURNING THE APPLIANCE OFF

Whenever the coffee machine is turned off after being used to make coffee, it performs an automatic rinse cycle.



#### **Danger of burns!**

During rinsing, a little hot water flows from the coffee spouts (A13).

Avoid contact with splashes of water.

- To turn the appliance off, press the  button (B2) (fig. 6);
- The message "Turning off Please wait" appears on the display (B1), then the appliance performs a rinse cycle and goes off (standby).



#### **Please note:**

If you will not be using the appliance for some time, unplug from the mains socket:

- first turn the appliance off by pressing the  button (fig. 6);
- press the main switch (fig. 2).



### **Important!**

Never press the main switch (A7) while the appliance is on.

## **8. MENU SETTINGS**

### **8.1 Descaling**

For instructions on descaling, see section "14. Descaling".

### **8.2 Install filter**



For instructions on how to install the filter, see section "16. Water softener filter".

### **8.3 Replacing the filter**

For instructions on how to replace the filter, see section "16.2 Replacing the filter".

### **8.4 Adjust time**

To adjust the time on the display (B1), proceed as follows:

1. Press the **MENU** button (B3) to enter the menu;
2. Turn the selection dial (B6) (fig. 7) until "Adjust time" appears on the display;
3. Press the  button (B8) (fig. 4);
4. Turn the selection dial to change the hours;
5. Press the  button to confirm;
6. Turn the selection dial to change the minutes;
7. Press the  button to confirm.

This sets the time. Press the  (B4) button to exit the menu.





### **8.5 Auto-start**

You can set the auto-start time in order to have the appliance ready at a certain time (for example in the morning) so you can make coffee immediately.





#### **Please note:**

To enable this function, the time must already be set correctly.

1. Press the **MENU** button (B3) to enter the menu;
2. Turn the selection dial (B6) (fig. 7) until "Auto-start" appears on the display (B1);
3. Press the  button (B8) (fig. 4). "Enable?" appears on the display;
4. Press the  button to confirm;
5. Turn the selection dial to choose the hours;
6. Press the  button to confirm;
7. Turn the selection dial to change the minutes;
8. Press the  button to confirm;
9. Press the  button (B4) to exit the menu.



Once the time has been confirmed, activation of auto-start is indicated by the  symbol displayed alongside the time and under "Auto-start" in the menu.

To disable the function:

1. Select "Auto-start" from the menu;
  2. Press the  button. "Disable?" appears on the display;
  3. Press the  button to confirm.
- The  symbol is no longer displayed.

### **8.6 Auto-off**

Auto-off can be set so that the appliance goes off after 15 or 30 minutes, or after 1, 2 or 3 hours.



1. Press the **MENU** button (B3) to enter the menu;
2. Turn the selection dial (B6) (fig. 7) until "Auto-off" appears on the display (B1);
3. Press the  button (B8) (fig. 4);
4. Turn the selection dial until the desired operation time appears on the display (15 or 30 minutes, or 1, 2 or 3 hours);
5. Press the  button to confirm.

Auto-off is now programmed. Press the  button (B4) to exit the menu.

### **8.7 Cup warmer**

This function enables or disables the cup warmer (A2).

Proceed as follows:

1. Press the **MENU** button (B3) to enter the menu;
2. Turn the selection dial (B6) (fig. 7) until "Cup warmer" appears on the display (B1);
3. Press the  button (B8) (fig. 4). "Enable?" or "Disable?" appears on the display;
4. Press the  button to enable or disable the cup warmer (an asterisk under "Cup warmer" indicates that it is active);
5. Press the  button (B4) to exit the menu.



#### **Please note:**

Warming the cups keeps the coffee hot.



### **8.8 Energy saving**

Use this function to enable or disable energy saving.

When enabled, the function reduces energy consumption in compliance with European regulations.

When energy saving mode is active, an asterisk appears under "Energy Saving" in the menu.

To disable (or enable) energy saving, proceed as follows:

1. Press the **MENU** button (B3) to enter the menu;
2. Turn the selection dial (B6) (fig. 7) until "Energy Saving" appears on the display (B1);
3. Press the  button (B8) (fig. 4). "Enable?" or "Disable?" appears on the display;
4. Press the  button to enable or disable energy saving mode;

Press the  button (B4) to exit the menu.

When the function is active, if the machine is not used for some time, "Energy Saving" appears on the display.





#### **Please note!**

- When in energy saving mode, a few seconds elapse before the first coffee or milk-based drink is delivered as the appliance must heat up again.
- To prepare any drink, press any button to exit energy saving, then press the button corresponding to the drink you want to make.
- If the milk container (D) is inserted, "Energy Saving" cannot be activated.

### **8.9 Set temperature**

To modify the temperature of the water used to make the coffee, proceed as follows:

1. Press the **MENU** button (B3) to enter the menu;
2. Turn the selection dial (B6) (fig. 7) until "Set temperature" appears on the display (B1);
3. Press the  button (B8) (fig. 4);
4. Turn the selection dial until the required temperature (● = low; ●●●● = high) appears on the display;
5. Press the  button to confirm.

The temperature is now programmed. Press the  button (B4) to exit the menu.



### **8.10 Setting water hardness**

For instructions on setting water hardness, see section "15. Setting water hardness".

### **8.11 Enable/disable the beep**

This enables or disables the beep emitted by the machine each time a button is pressed or an accessory is inserted/removed.

To disable or re-enable the beep, proceed as follows:

1. Press the **MENU** button (B3) to enter the menu;
2. Turn the selection dial (B6) (fig. 7) until "Beep" appears on the display;
3. Press the  button (B8) (fig. 4). "Enable?" or "Disable?" appears on the display;
4. Press the  button to enable or disable the beep.
5. When the function is active, an asterisk appears under "Beep" in the menu.

Press the  button (B4) to exit the menu.

### **8.12 Setting the language**

To modify the language on the display (B1), proceed as follows:

1. Press the **MENU** button (B3) to enter the menu;
2. Turn the selection dial (B6) (fig. 7) until "Set language" appears on the display;
3. Press the  button (B8) (fig. 4);

4. Turn the selection dial until the required language appears on the display;
5. Press the  button to confirm;
6. A message confirming the language selected appears on the display.



Press the  button (B4) to exit the menu.

### **8.13 Cup lighting**

This function enables or disables the cup lights (A19).

When the function is active, the lighting comes on whenever coffee or milk-based drinks are made or the appliance is rinsed.



To disable or enable this function, proceed as follows:

1. Press the **MENU** button (B3) to enter the menu;
2. Turn the selection dial (B6) (fig. 7) until "Cup lighting" appears on the display;
3. Press the  button (B8) (fig. 4). "Enable?" or "Disable?" appears on the display (B1);
4. Press the  button to enable or disable the cup lighting;
5. When the function is active, an asterisk appears under "Cup lighting" in the menu.

Press the  button (B4) to exit the menu.

### **8.14 Default values (reset)**



This resets all menu settings and programmed quantities back to the default values (with the exception of the language which remains as set).

1. Press the **MENU** button (B3) to enter the menu;
2. Turn the selection dial (B6) (fig. 7) until "Default values" appears on the display (B1);
3. Press the  button (B8) (fig. 4);
4. The message "Confirm?" is now displayed
5. Press the  button to confirm and exit.

### **8.15 Statistics function**

This displays statistics relating to the machine.

To display, proceed as follows:

1. Press the **MENU** button (B3) to enter the menu;
2. Turn the selection dial (B6) (fig. 7) until "Statistics" appears on the display (B1);
3. Press the  button (B8) (fig. 4);
4. Turn the selection dial to verify:
  - how many coffees have been made;
  - the total number of cappuccinos and milk-based coffees;
  - the total number of litres of water delivered;
  - how many times the machine has been descaled;
  - how many times the water softener filter has been replaced.
5. Press the  (B4) button twice to exit the menu.

## 9. RINSING

Use this function to deliver hot water from the coffee spouts (A13) and from the hot water spout (C6), if inserted, to clean and heat the appliance's internal circuit.

Place a container with a minimum capacity of 100 ml under the hot water spout (fig. 5).



### **Danger of burns!**

Do not leave the appliance unattended while hot water is being delivered.

1. Press the  button (B4). "RINSING, Please wait" appears on the display (B1);
2. After a few seconds, hot water is delivered first from the coffee spouts, then from the hot water spout (if inserted) to clean and heat the appliance's internal circuit. "RINSING" appears on the display, together with a progress bar which fills gradually as preparation proceeds;
3. To stop the process press any button or wait for delivery of water to stop automatically.



### **Please note!**

- If the appliance is not used for more than 3-4 days, when switched on again, we strongly recommend performing 2/3 rinses before use;
- After cleaning, it is normal for the coffee grounds container (A14) to contain water.

## 10. MAKING COFFEE

### 10.1 Selecting the coffee taste

The appliance is set by default to make coffee with a standard taste.

You can also choose one of these tastes:

Extra mild taste

Mild taste

Standard taste

Strong taste

Extra-strong taste

To change the taste, press the  dial (B6) (fig. 8) repeatedly until the required taste appears on the display (B1).

### 10.2 Selecting the quantity of coffee in the cup



To select the quantity of coffee, turn the selection dial (B6) (fig. 7) until the message corresponding to the required quantity of coffee appears on the display (B1):

| Coffee selected | Quantity in cup (ml)               |
|-----------------|------------------------------------|
| MY COFFEE       | ≈30 (program.<br>from ≈20 to ≈180) |
| SHORT           | ≈40                                |
| STANDARD        | ≈60                                |
| LONG            | ≈90                                |
| EXTRA LONG      | ≈120                               |

### 10.3 Customising the "my coffee" quantity

The appliance is set by default to automatically deliver 30 ml of "MY COFFEE".

To modify this quantity, proceed as follows:

1. Place a cup under the coffee spouts (A13) (fig. 9);
2. Turn the selection dial (B6) (fig. 7) until "MY COFFEE" appears on the display;
3. Press and hold the  button (B10) (fig. 10) until the message "1 MY COFFEE Program quantity" appears on the display (B1) and coffee delivery begins. Then release the button;
4. soon as the coffee in the cup reaches the required level, press the  button (fig. 10) again.

The quantity of coffee in the cup has now been programmed.

### 10.4 Adjusting the coffee mill

The coffee mill is set by default to prepare coffee correctly and should not require regulating initially.

However, if after making the first few coffees you find that the coffee is either too weak and not creamy enough or delivery is too slow (a drop at a time), this can be corrected by adjusting the grinding adjustment dial (A1) (fig. 11).



### **Please note:**

The grinding adjustment dial must only be turned when the coffee mill is in operation.

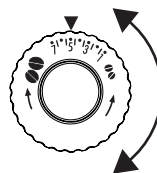

If the coffee is delivered too slowly or not at all, turn one click clockwise towards "7".

For fuller bodied creamier coffee, turn one click anticlockwise towards "1" (do not turn more than one click at a time otherwise the coffee could

be delivered a drop at a time). These adjustments will only be evident after at least 2 cups of coffee have been delivered. If this adjustment does not obtain the desired result, turn the dial another click.

## 10.5 Tips for a hotter coffee

For hotter coffee, you should:

- before delivering the coffee, perform a rinse cycle (see section “9. Rinsing”);
- warm the cups with hot water (using the hot water function);
- enable the cup warmer (A2) in the settings menu (see section “8.7 Cup warmer”);
- set a hotter coffee temperature in the settings menu (see the section “8.9 Setting the temperature”).

## 10.6 Making coffee using coffee beans



Do not use caramelised or candied coffee beans as they could stick to the coffee mill and make it unusable.

1. Fill the container with coffee beans (fig. 12).
2. Place under the coffee spouts (A13):
  - 1 cup, if you want 1 coffee (fig. 9);
  - 2 cups, if you want 2 coffees (fig. 13);
3. Lower the spouts as near as possible to the cup (fig. 14). This makes a creamier coffee.
4. Press the button corresponding to the number of coffees required (one cup - B10 or two cups - B9 ).
5. Preparation begins. The amount of coffee selected appears on the display (B1) together with a progress bar which gradually fills as preparation progresses.



### Please note:

- While the machine is making coffee, delivery can be interrupted at any moment by pressing any button.
- At the end of delivery, to increase the quantity of coffee in the cup, just press and hold (within 3 seconds) one of the coffee buttons ( or ).

Once the coffee has been made, the appliance is ready to make the next drink.



### Please note!

- Various alarm messages could be displayed while using the appliance (FILL TANK, EMPTY GROUNDS CONTAINER, etc.). Their meaning is explained in section “18. Displayed messages”.
- For hotter coffee, see section “10.5 Tips for a hotter coffee”.
- If the coffee is delivered a drop at a time, too weak and not creamy enough or too cold, read the tips in section “20. Troubleshooting”.

## 10.7 Making coffee using pre-ground coffee



- Never place coffee beans in the pre-ground coffee funnel (A5) as this could damage the appliance.

- Never add pre-ground coffee when the machine is off or it could spread through the inside of the machine and dirty it.

This could damage the appliance.

- Never use more than 1 level measure (C2) or it could dirty the inside of the coffee machine or block the funnel.



### Please note:

When you use pre-ground coffee, you can only make one cup of coffee at a time.

1. Make sure the appliance is on.
2. Press the dial (B6) (fig. 8) until “Pre-ground” appears on the display (B1);
3. Make sure the funnel is not blocked, then add one level measure of pre-ground coffee (fig. 15);
4. Place a cup under the coffee spouts (fig. 9);
5. Press the 1 cup coffee button (B10) (fig. 10);
6. Preparation begins. The amount of coffee selected appears on the display together with a progress bar which gradually fills as preparation progresses.



### Please note:

If “Energy Saving” mode is active, you may have to wait a few seconds before the first coffee is delivered.

## 11. MAKING CAPPUCCINO AND MILK-BASED COFFEES



### Please note:

To avoid producing milk with poor froth or large bubbles, always clean the milk container lid (D2) and hot water connection nozzle (A20) as described in sections “11.5 Cleaning the milk container after every use”, “13.10 Cleaning the milk container” and “13.11 Cleaning the hot water/steam connection nozzle”.

### 11.1 Filling and attaching the milk container

1. Remove the lid (D2) (fig. 16).
2. Fill the milk container (D3) with a sufficient quantity of milk, not exceeding the MAX level marked on the container (fig. 17).  
Each mark on the side of the container corresponds to 100 ml of milk.



### Please note!

- For a denser more even froth, you must use skimmed or partially skimmed milk at refrigerator temperature (about 5°C).



- If “Energy saving” mode is enabled, you may have to wait a few seconds before the drink is delivered.
3. Make sure the milk intake tube (D4) is correctly inserted in the bottom of the milk container lid (fig. 18).
  4. Attach the lid back on the milk container.
  5. Attach the container to the connection nozzle (A20) (fig. 19) and push as far as it will go. The appliance emits a beep (if the beep function is enabled).
  6. Place a sufficiently large cup under the coffee spouts and the frothed milk spout (D5). Adjust the length of the milk spout. To move it nearer the cup, simply pull it downwards (fig. 20).
  7. Follow the instructions below for each function.

## 11.2 Adjusting the amount of froth

Turn the froth adjustment dial (D1) on the milk container lid (D2) to adjust the amount of froth on the milk delivered while making milk-based coffees (fig. 21).

Follow the tips in the table below:

| Dial position   | Description | Recommended for...             |
|---|-------------|--------------------------------|
|  | No froth    | CAFFELATTE/MILK (HOT MILK)     |
|  | Min. froth  | MACCHIATO / FLAT WHITE         |
|  | Max. froth  | CAPPUCCINO/MILK (FROTHED MILK) |

## 11.3 Making cappuccino

1. After attaching the milk container (D), turn the froth adjustment dial (D1) on the milk container lid (D2) to the required position (fig. 21).
2. Press the CAPPUCCINO button (B5). “CAPPUCCINO” appears on the display (B1), together with a progress bar which fills gradually as preparation proceeds.
3. After delivering the milk, the machine automatically makes the coffee.



### **Please note:**

- If during delivery you want to stop making milk or coffee, press the CAPPUCCINO button twice.
- At the end of delivery, to increase the quantity of milk or coffee in the cup, within 3 seconds, press and hold the CAPPUCCINO button.
- Do not leave the milk container out of the refrigerator for long periods. The warmer the milk (5°C is ideal), the poorer the quality of froth produced.

## 11.4 MAKING MACCHIATO / CAFFELATTE/ MILK / FLAT WHITE

1. After attaching the milk container (D), turn the froth adjustment dial (D1) on the milk container lid (D2) to the required position (fig. 21).
2. Press the **MILK MENU** button (B7).
3. Turn the selection dial (B6) until the required drink appears on the display (MACCHIATO, CAFFELATTE, MILK, FLAT WHITE);
4. Press the **MILK MENU** button to confirm. The name of the drink appears on the display together with a progress bar which gradually fills as preparation progresses.
5. After a few seconds, milk is delivered from the milk spout (D5) into the cup below.  
The milk stops automatically and (if required for the drink) coffee delivery begins.



### **Please note!**

- Milk or coffee delivery can be interrupted by pressing the **CAPPUCCINO** (B5) or **MILK MENU** button according to the drink selected.
- At the end of delivery, to increase the quantity of milk or coffee in the cup, just press and hold (within 3 seconds) the button corresponding to the drink being made.
- Do not leave the milk container out of the refrigerator for long periods. The warmer the milk (5°C is ideal), the poorer the quality of froth produced.

## 11.5 Cleaning the milk container after every use



### **Important! Danger of burns**

When cleaning the internal tubes of the milk container (D), a little hot water and steam leak out of the milk spout (D5).

Avoid contact with splashes of water.

“SET DIAL TO CLEAN” appears on the display (B1) each time you use a milk function.

To eliminate all milk residues, proceed as follows:

1. Leave the milk container in the machine (you do not need to empty it);
2. Place a cup or other recipient under the milk spout (fig. 20);
3. Turn the froth adjustment dial (D1) to “CLEAN” (fig. 22). A progress bar appears and gradually fills as the operation proceeds together with “Cleaning underway”. Cleaning stops automatically.
4. Turn the dial back to one of the froth selections.
5. Remove the milk container and always clean the steam connection nozzle with a sponge (fig. 23).



### **Please note!**

- To prepare a number of cappuccinos or milk-based coffees, clean the milk container after you have prepared the last drink only.
- The milk container can be kept in the refrigerator.
- In some cases, to clean you must wait for the appliance to heat up.

## 11.6 Programming the quantities of coffee and milk in the cup

The appliance is set by default to automatically deliver standard quantities.

To change these quantities, proceed as follows:

1. Place a cup under the coffee spouts (A13) and milk spout (D5);

## 11.7 Programming cappuccino:

2. Press and hold the **CAPPUCCINO** button (B5) until the message "CAPPUCCINO PROGRAM MILK" appears on the display;
3. The appliance starts delivering milk.  
Release the button;
4. Once the required quantity of milk has been delivered into the cup, press the **CAPPUCCINO** button again;
5. The appliance stops delivering milk and after a few seconds the coffee is delivered into the cup. "CAPPUCCINO PROGRAM COFFEE" appears on the display;
6. Once the required quantity of coffee has been delivered into the cup, press the **CAPPUCCINO** button again.

Coffee delivery stops and the machine is "ready for use" again.

This completes programming

## 11.8 Programming "MILK MENU" drinks:

2. Press the **MILK MENU** button (B7);
3. Turn the selection dial (B6) until the required drink appears on the display (B1) (MACCHIATO, CAFFELATTE, MILK, FLAT WHITE);
4. Press and hold the **MILK MENU** button until the message "(DRINK) PROGRAM MILK" appears on the display;
5. The appliance starts delivering milk.  
Release the button;
6. Once the required quantity of milk has been delivered into the cup, press the **MILK MENU** button again;
7. After a few seconds, if required by the drink, the appliance starts delivering coffee into the cup and the message "(DRINK) PROGRAM COFFEE" appears on the display;
8. Once the required quantity of coffee has been delivered into the cup, press the **MILK MENU** button again.

Coffee delivery stops and the machine is "ready for use" again.



This completes programming

## 12. PREPARING HOT WATER



### **Danger of burns!**

Never leave the machine unattended while delivering hot water.

1. Make sure the hot water spout (C6) is attached correctly;
2. Place a cup under the spout (as close as possible to avoid splashes);
3. Press the  button (B8). "HOT WATER" appears on the display (B1), together with a progress bar which fills gradually as preparation proceeds;
4. The machine delivers about 250 ml of hot water, then delivery stops automatically. To interrupt delivery of hot water manually, press the  button again.





### **Please note:**

If "Energy Saving" mode is active, you may have to wait a few seconds before the hot water is delivered.

## 12.1 Changing the quantity of water delivered automatically

The machine is set by default to automatically deliver 250 ml of hot water.

To modify these quantities, proceed as follows:

1. Make sure the hot water spout (C6) is attached correctly;
2. Position a cup under the spout;
3. Press and hold the  button (B8) until "HOT WATER Program Quantity" appears on the display (B1), then release;
4. When the hot water in the cup reaches the required level, press the  button.

The machine is now reprogrammed with the new quantity.

## 13. CLEANING

### 13.1 Cleaning the machine

The following parts of the machine must be cleaned regularly:

- the appliance's internal circuit;
- coffee grounds container (A14),
- drip tray (A18) and condensate tray (A15);
- water tank (A9);
- coffee spouts (A13);
- pre-ground coffee funnel (A5);
- infuser (A12), accessible after opening the infuser door (A11);
- milk container (D);
- hot water/steam connection nozzle (A20);



### **Important!**



- Do not use solvents, abrasive detergents or alcohol to clean the coffee machine.

With De'Longhi superautomatic coffee machines, you need not use chemical products to clean the machine.

- None of the components of the appliance can be washed in a dishwasher with the exception of the milk container (D).
- Do not use metal objects to remove encrustations or coffee deposits as they could scratch metal or plastic surfaces.

### 13.2 Cleaning the machine's internal circuit

If the appliance is not used for more than 3/4 days, before using it again, we strongly recommend switching it on and:

- performing 2/3 rinse cycles by pressing the  button (B4);
- delivering hot water for a few seconds by pressing the  button (B8).



#### **Please note:**

After cleaning, it is normal for the coffee grounds container (A14) to contain water.

### 13.3 Cleaning the coffee grounds container

When "EMPTY GROUNDS CONTAINER" appears on the display (B1), the grounds container must be emptied and cleaned.

The appliance cannot be used to make coffee until you have cleaned the grounds container (A14).

Even if not full, the empty grounds container message appears on the display 72 hours after the first coffee has been prepared. For the 72 hours to be calculated correctly, the machine must never be turned off with the main switch (A7).

To clean (with the machine on):

- Remove the drip tray (A18) (fig. 24), empty and clean.
- Empty the grounds container (A14) and clean thoroughly to remove all residues left on the bottom. This can be done with the spatula on the brush (C5) provided;
- Check the condensate tray (A15) and empty if necessary.



#### **Important!**

When removing the drip tray, the grounds container **must** be emptied, even if it contains few grounds.

If this is not done, when you make the next coffees, the grounds container may fill up more than expected and clog the machine.

### 13.4 Cleaning the drip tray and condensate tray



#### **Important!**

The drip tray (A18) is fitted with a level indicator (A17) (red) showing the level of water it contains (fig. 25).

Before the indicator protrudes from the cup tray (A16), the drip tray must be emptied and cleaned, otherwise the water may overflow the edge and damage the appliance, the surface it rests on or the surrounding area.

To remove the drip tray:

1. Remove the drip tray and grounds container (fig. 24);
2. Empty the drip tray and grounds container and wash them;
3. Check the condensate tray (A15) (red) and empty if necessary;
4. Replace the drip tray and grounds container.

### 13.5 Cleaning the inside of the coffee machine



#### **Danger of electric shock!**

Before cleaning internal parts, the machine must be turned off (see section "7 Turning off") and unplugged from the mains power supply.

Never immerse the coffee machine in water.

1. Check regularly (about once a month) that the inside of the appliance (accessible after removing the drip tray (A18 and grounds container (A14)) is not dirty.  
If necessary, remove coffee deposits with the brush (C5) or a sponge.
2. Remove all the residues with a vacuum cleaner (fig. 26).

### 13.6 Cleaning the water tank

1. Clean the water tank (A9) regularly (about once a month) and whenever you replace the water softener filter (C4, if provided) with a damp cloth and a little mild washing up liquid;
2. Remove the filter (if present) and rinse with running water;
3. Replace the filter (if provided), fill the tank with fresh water and replace the tank;
4. (Models with water softener filter only) Deliver about 100 ml of water.

### 13.7 Cleaning the coffee spouts

1. Clean the coffee spouts (A13) with a sponge or cloth (fig. 27A).
2. Check that the holes in the coffee spouts are not blocked.  
If necessary, remove coffee deposits with a toothpick (fig. 27B).

### 13.8 Cleaning the pre-ground coffee funnel

Check regularly (about once a month) that the pre-ground coffee funnel (A5) is not blocked. If necessary, remove coffee deposits with the brush (C5) supplied.

### 13.9 Cleaning the infuser

The infuser (A12) must be cleaned at least once a month.



#### **Important!**

The infuser may not be extracted when the machine is on.

1. Make sure the machine is correctly turned off (see section "7 Turning off");
2. Remove the water tank (A9).
3. Open the infuser door (A11) (fig. 28) on the right side of the appliance.
4. Press the two coloured release buttons inwards and at the same time pull the infuser outwards (fig. 29);



**Important!**

RINSE WITH WATER ONLY NO WASHING UP LIQUID - NO DISH WASHER

Clean the infuser without using washing up liquid as it could be damaged.

5. Soak the infuser in water for about 5 minutes, then rinse under the tap;
6. Use the brush (C5) to remove any coffee residues left in the infuser housing, visible through the infuser door;
7. After cleaning, replace the infuser by sliding it onto the internal support (fig. 30), then push the PUSH symbol fully in until it clicks into place (fig. 32);



**Please note:**

If the infuser is difficult to insert, before insertion, adapt it to the right size by pressing the two levers (fig. 31);

8. Once inserted, make sure the two coloured buttons have snapped out (fig. 32);
9. Close the infuser door;
10. Put the water tank back.

### 13.10 Cleaning the milk container

Clean the milk container (D) every two days as described below:

1. Remove the lid (D2);
2. Remove the milk spout (D5) and intake tube (D4) (fig. 33);

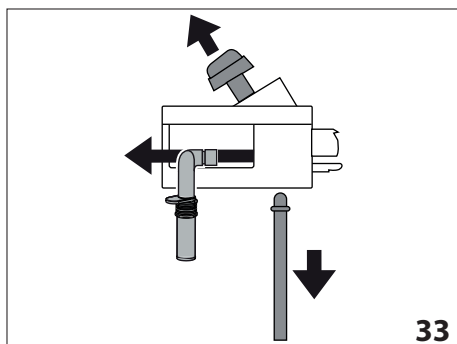

**33**

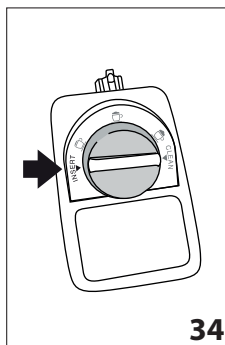

**34**

3. Turn the froth adjustment dial (D1) to the "INSERT" position (fig. 34) and pull it off upwards (fig. 33);
4. Wash all the components thoroughly with hot water and mild washing-up liquid. All components are dishwasher safe, placing them in the top basket of the dishwasher.

Make sure there are no milk residues on the hollow and groove under the dial (fig. 35). If necessary, scrape the groove with a toothpick;

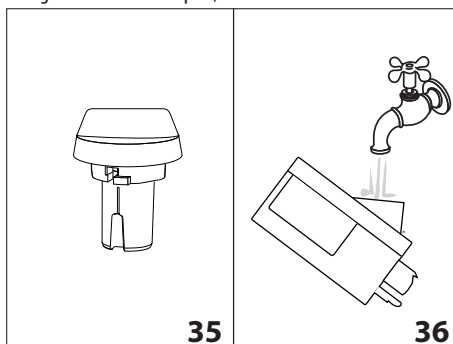

**35**

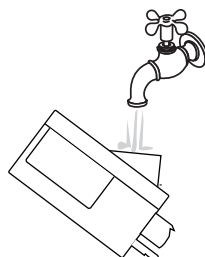

**36**

5. Rinse inside the froth adjustment dial seat with running water (fig. 36);
6. Check that the intake tube and spout are not clogged with milk residues;
7. Replace the dial (lining up the arrow with the word "INSERT"), the spout and the milk intake tube;
8. Place the lid back on the milk container.

### 13.11 Cleaning the hot water/steam connection nozzle

Each time you prepare milk, clean the connection nozzle (A20) with a sponge to remove milk residues from the gaskets (fig. 23).

## 14. DESCALING



Descale the machine when the message "DESCALE" flashes on the display (B1).



**Important!**

- Before use, read the instructions and the labelling on the descaler pack.

- You should use De'Longhi descaler only. Using unsuitable descaler and/or performing descaling incorrectly may result in faults not covered by the manufacturer's guarantee.

1. Turn the appliance on and wait until it is ready for use;
2. Press the **MENU** button (B3) to access the menu; turn the selection dial (B6) (fig. 7) until "Descaling" appears on the display;
3. Select by pressing the  button (B8). The message "Descaling Confirm?" is displayed;
4. Press the  button again to confirm. "EMPTY DRIP TRAY" appears on the display, alternating with "REMOVE FILTER" (if the filter is present) and "Add descaler Confirm?";
5. Empty the water tank (A9) completely and remove the water softener filter (C4), if present. Empty the drip tray (A18) (fig. 24) and grounds container (A14), then put them back in the appliance;

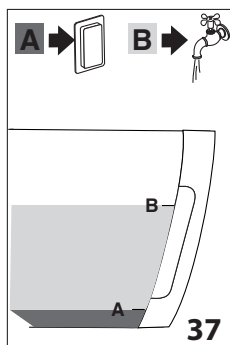

6. Pour the descaler (C3) into the tank up to level A (corresponding to a 100 ml pack) marked on the inner surface of the tank (fig. 37), then add a litre of water up to level B (fig. 37) and put the water tank back in the appliance;

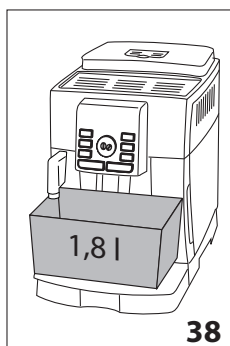

7. Place an empty container with a minimum capacity of 1.8 litres under the coffee spouts (A14) and hot water spout (C6) (fig. 38).





**Important! Danger of burns!**

Hot water containing acid flows out of the coffee spouts and hot water spout. Take care to avoid contact with

splashes of this solution.

8. Press the  button to confirm that you have added the descaler solution. The message "Descale underway" appears on the display and the descaling procedure begins. The descaler liquid comes out of the coffee spouts and hot water spout and a series of rinses and pauses is performed to remove limescale deposits from inside the machine;

After about 25 minutes, descaling stops and the messages "RINSING" and "FILL TANK" alternate on the display;

9. The appliance is now ready for rinsing through with clean water. Empty the container used to collect the descaler solution. Extract the water tank, empty, rinse under running water, fill with fresh water up to the MAX level and put back in the appliance: "RINSING, Confirm?" is displayed;
10. Place the container used to collect the descaler solution empty under the coffee spouts and hot water spout (fig. 38);
11. Press the  button to start rinsing. Hot water flows out of the spouts and the message "Rinsing Please wait" is displayed.
12. When the water tank is empty, the messages "RINSING", "FILL TANK" and "REPLACE FILTER" (if previously removed) alternate on the display. Empty the container used to collect the rinsing water;
13. Remove the water tank, replace the water softener filter (if previously removed), fill the tank up to the MAX level with fresh water and insert it in the appliance. "RINSING, Confirm?" appears on the display;
14. Place the container used to collect the rinsing water empty under the hot water spout;
15. Press the  button to resume rinsing. Rinsing begins again from the hot water spout only and the message "RINSING Please wait" is displayed;
16. When it finishes, the message "Rinsing complete, Confirm?" appears on the display;
17. Press the  button. The message "FILL TANK" is displayed;
18. Empty the drip tray, remove and top up the water tank with fresh water to the MAX level and put back in the machine.

Descaling is complete.



**Please note!**

- If the descaling cycle is not completed correctly (e.g. no electricity) we recommend repeating the cycle;
- After descaling, it is normal for the grounds container (A14) to contain water

## 15. SETTING WATER HARDNESS

The DESCAL message appears on the display after a period of time established according to water hardness.

The machine is set by default for a hardness value of 4.

The machine can also be programmed according to the hardness of the mains water in the various regions so that the machine needs to be descaled less often.

## 15.1 Measuring water hardness

1. Remove the "TOTAL HARDNESS TEST" indicator paper (C1) from its pack (attached to the English instructions).
2. Immerse the paper completely in a glass of water for one second.
3. Remove the paper from the water and shake lightly. After about a minute, 1, 2, 3, or 4 red squares form, depending on the hardness of the water. Each square corresponds to one level.

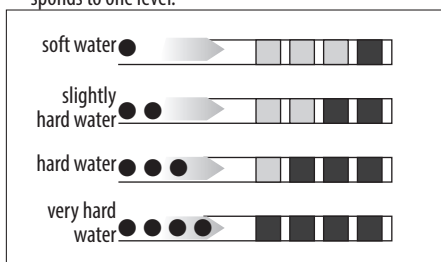

## 15.2 Setting water hardness

1. Press the **MENU** button (B3) to enter the menu;
2. Turn the selection dial (B6) until "Water Hardness" appears on the display (B1);
3. Press the  $\Delta$  button (B8);
4. Turn the selection dial and set the number of squares measured by the indicator paper (see figure in previous paragraph);
5. Press the  $\Delta$  button to confirm the setting.
6. Press the  $\otimes$  button (B4) to exit the menu.

The machine is now reprogrammed with the new water hardness setting.

## 16. WATER SOFTENER FILTER

Certain models are fitted with a water softener filter (C4). If this is not the case with your model, you are recommended to purchase one from De'Longhi Customer Services.

To use the filter correctly, follow the instructions below.

### Installing the filter

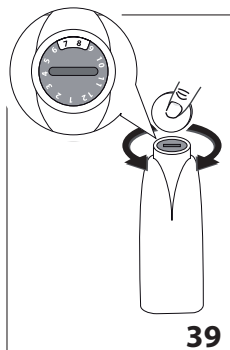

1. Remove the filter (C4) from the packaging;
2. Turn the date indicator disk (see fig. 39) until the next two months of use are displayed;



#### **Please note:**

The filter lasts about two months if the appliance is used normally.

If the coffee machine is left unused with the filter installed, it will last a maximum of three weeks.

3. To activate the filter, run tap water through the hole in the filter as shown in the figure until water comes out of the openings at the side for more than a minute (fig. 40).

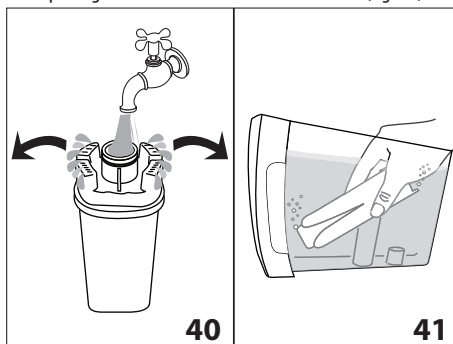

4. Extract the tank (A9) from the appliance and fill with water;
5. Insert the filter in the water tank and immerse it completely for about ten minutes, sloping it to enable the air bubbles to escape (fig. 41);
6. Insert the filter in the filter housing (A10) and press as far as it will go;
7. Close the tank with the lid, then put the tank back in the machine;

When you install the filter, you must notify the appliance of its presence.



8. Press the **MENU** button (B3) to enter the menu;
9. Turn the selection dial (B6) until "Install filter" appears on the display (B1);
10. Press the  $\Delta$  button (B8);
11. "Enable?" appears on the display;
12. Press the  $\Delta$  button to confirm the selection. "HOT WATER Confirm?" appears on the display;
13. Position a container under the hot water spout (C6) (min. capacity: 500 ml);
14. Press the  $\Delta$  button to confirm the selection. The appliance begins hot water delivery and the message "Please wait" appears on the display;
15. After the flow of hot water stops, the appliance automatically resets to "Ready for coffee" status.

The new filter is active and indicated by an asterisk displayed under "Install filter" in the menu. You can now use the appliance.

### 16.1 Replacing the filter

When "REPLACE FILTER" appears on the display (B1), after two months (see date indicator) or when the appliance has not been used for 3 weeks, you should replace the filter (C4):

1. Extract the tank (A9) and exhausted filter;



2. Take the new filter out of its packet and proceed as illustrated in points 2, 3, 4, 5 and 6 in the previous section;
3. Position a container under the hot water spout (C6) (min. capacity: 500 ml);
4. Press the **MENU** button (B3) to enter the menu;
5. Turn the selection dial (B5) until "Replace filter" appears on the display;
6. Press the  button (B8);
7. The message "Confirm?" is now displayed;
8. Press the  button to confirm the selection;
9. "HOT WATER Confirm?" appears on the display;
10. Press the  button to confirm the selection. The appliance begins hot water delivery and the message "Please wait" appears on the display;
11. After the flow of hot water stops, the appliance automatically resets to "Ready for coffee" status.

The new filter is now active and you can use the coffee machine.

## 16.2 Removing the filter

If you want to use the appliance without the filter (C4), you must remove it and notify the appliance of its removal.

Proceed as follows:

1. Extract the tank (A9) and exhausted filter;
2. Press the **MENU** button (B3) to enter the menu;
3. Turn the selection dial (B6) until "Install filter\*" appears on the display (B1);
4. Press the  button (B8);
5. "Disable?" appears on the display;
6. Press the  button to confirm and the  button (B4) to exit the menu.

## 17. TECHNICAL DATA

|                                |                               |
|--------------------------------|-------------------------------|
| Voltage:                       | 220-240 V ~ 50/60 Hz max. 10A |
| Absorbed power:                | 1450W                         |
| Pressure:                      | 1.5 MPa (15 bars)             |
| Max. water tank capacity:      | 1.8 l                         |
| Dimensions LxDxH               | 240x430x350 mm                |
| Cord length:                   | 1750 mm                       |
| Weight:                        | 9.7 kg                        |
| Max. beans container capacity: | 250 g                         |



The appliance complies with the following EC directives:

- European Standby Regulation 1275/2008
- Materials and accessories coming into contact with food conform to EEC regulation 1935/2004.

## 18. DISPOSAL



The appliance must not be disposed of with household waste, but taken to an authorised waste separation and recycling centre.

## 19. DISPLAYED MESSAGES

| DISPLAYED MESSAGE           | POSSIBLE CAUSE   | SOLUTION  |
|-----------------------------|--|---|
| FILL TANK                   | Insufficient water in the tank (A9).   | Fill the tank with water and/or insert it correctly, pushing it as far as it will go until it clicks into place (fig. 3).   |
| EMPTY GROUNDS CONTAINER     | The grounds container (A14) is full.   | Empty the grounds container and drip tray (A18), clean and replace (fig. 24).<br>Important: when removing the drip tray, the grounds container (A14) must be emptied, even if it contains few grounds.<br>If this is not done, when you make the next coffees, the grounds container may fill up more than expected and clog the machine.   |
| GROUND TOO FINE ADJUST MILL | The grinding is too fine and the coffee is delivered too slowly or not at all.   | Repeat coffee delivery and turn the grinding adjustment dial (A1) (fig. 11) one click clockwise towards "7" while the coffee mill is in operation.<br>If after making at least 2 coffees delivery is still too slow, repeat the correction procedure, turning the grinding adjustment dial another click until delivery is correct (see section: "10.4 Adjusting the coffee mill").<br>If the problem persists, make sure the water tank (A9) is fully inserted, press the button (B8) and deliver a little water from the spout. |
|                             | If the water softener filter (C4) is present, an air bubble may have been released inside the circuit, obstructing delivery. | Insert the hot water spout (C6) in the appliance and deliver a little water until the flow becomes regular.   |
| INSERT GROUNDS CONTAINER    | After cleaning, the grounds container (A14) has not been replaced.   | Remove the drip tray (A18) and insert the grounds container.  |
| ADD PRE-GROUND COFFEE       | The "pre-ground coffee" function has been selected without placing any pre-ground coffee in the funnel (A5).                 | Place pre-ground coffee in the funnel or deselect the "pre-ground" function.  |
| DESCALE                     | The machine must be descaled.  | The descaling procedure described in section "14. Descaling" needs to be performed as soon as possible.   |
| REDUCE COFFEE AMOUNT        | Too much coffee has been used.   | Select a milder taste or reduce the quantity of pre-ground coffee.  |
| FILL BEANS CONTAINER        | The coffee beans have run out.   | Fill the beans container (A6).  |
|                             | The pre-ground coffee funnel (A5) is clogged.  | Empty the funnel with the help of a brush, as described in section "13.8 Cleaning the pre-ground coffee funnel".  |
| INSERT INFUSER ASSEMBLY     | The infuser (A12) has not been replaced after cleaning.  | Insert the infuser as described in section "13.9 Cleaning the infuser".   |
| INSERT TANK                 | The tank (A9) is not correctly in place.   | Insert the tank correctly and press as far as it will go.   |

|  |   |   |
|--|---|---|
| GENERAL ALARM  | The inside of the appliance is very dirty.  | Clean the inside of the appliance thoroughly, as described in section "13. Cleaning".<br>If the message is still displayed after cleaning, contact a service centre.  |
| REPLACE FILTER   | The water softener filter (C4) is exhausted.  | Replace the filter or remove it as described in section "16. Water softener filter".  |
| EMPTY CIRCUIT FILL CIRCUIT alternating with "HOT WATER CONFIRM?" | The water circuit is empty.   | Press the  button (B8) to deliver water from the spout (C6) until it flows out normally. If the problem persists, make sure the water tank (A9) is fully inserted. |
| SET DIAL TO CLEAN  | Milk has been delivered recently and the tubes inside the milk container must be cleaned. | Turn the froth adjustment dial (D1) to CLEAN.   |
| INSERT WATER SPOUT   | The water spout (C6) is not inserted or is inserted incorrectly.                          | Insert water spout as far as it will go.  |
| INSERT MILK CONTAINER  | The milk container (D) is not inserted correctly.   | Insert the milk container (fig. 19) as far as it will go.   |

## 20. TROUBLESHOOTING

Below is a list of some of the possible malfunctions.

If the problem cannot be resolved as described, contact Customer Services.

| PROBLEM                                 | POSSIBLE CAUSE   | SOLUTION  |
|---|--|---|
| The coffee is not hot.                  | The cups were not preheated.   | Warm the cups by rinsing them with hot water (Please note: you can use the hot water function).<br><br>Enable the cup warmer (A2) and leave the cups at least 20 minutes to warm up.  |
|   | The internal circuits of the appliance have cooled down because 2/3 minutes have elapsed since the last coffee was made. | Before making coffee, heat the infuser by pressing the  button (B4).   |
|   | A low coffee temperature is set.   | Set a hotter coffee temperature (see section "8.9 Setting the temperature").  |
| The coffee is weak or not creamy enough | The coffee is ground too coarsely.   | Turn the grinding adjustment dial (A1) one click anticlockwise towards "1" while the coffee mill is in operation (fig. 11). Continue one click at a time until coffee delivery is satisfactory. The effect is only visible after delivering 2 coffees (see section "10.4 Adjusting the coffee mill"). |
|   | The coffee is unsuitable.  | Use pre-ground coffee for espresso machines.  |



|   |  |   |
|---|--|---|
| The coffee is delivered too slowly or a drop at a time.                                     | The coffee is ground too finely.   | Turn the grinding adjustment dial (A1) one click clockwise towards "7" while the coffee mill is in operation (fig. 11).<br>Continue one click at a time until coffee delivery is satisfactory.<br>The effect is only visible after delivering 2 coffees (see section "10.4 Adjusting the coffee mill"). |
| Coffee does not come out of one or both of the spouts.                                      | The coffee spouts (A13) are blocked.   | Clean the spouts with a toothpick (fig. 27B).   |
| The milk does not come out of the milk spout.   | The milk container lid (D2) is dirty.  | Clean the milk container lid and dial as described in sections "11.5 Cleaning the milk container after every use" and "13.10 Cleaning the milk container".  |
| The milk contains large bubbles and squirts out of the milk spout or there is little froth. | The milk is not cold enough or is not semi-skimmed.  | Use skimmed or semi-skimmed milk at refrigerator temperature (about 5°C).<br>If the result is not as you wished, try changing brand of milk.  |
|   | The froth adjustment dial (D1) is incorrectly adjusted.                                      | Adjust according to the instructions in section "11.2 Adjusting the amount of froth".   |
|   | The milk container lid (D2) or froth adjustment dial (D1) on the milk container (D) is dirty | Clean the milk container lid and dial as described in sections "11.5 Cleaning the milk container after every use" and "13.10 Cleaning the milk container".  |
|   | The hot water/steam connection nozzle (A20) is dirty   | Clean the connection nozzle as described in section "13.11 Cleaning the hot water/steam connection nozzle".   |
| The appliance does not come on  | It is not plugged into the mains socket (fig. 1).  | Plug into the mains socket.   |
|   | The power cord connector (C7) is not inserted fully in the socket (A8).                      | Make sure the connector is correctly connected.   |
|   | The main switch (A7) is not turned on.   | Press the main switch (fig. 2).   |
| The infuser cannot be extracted   | The appliance has not been turned off correctly.   | Turn the appliance off as described in section "7. Turning off".  |

## 21. ELECTRICAL CONNECTION (UK ONLY)

Before using this appliance ensure that the voltage indicated on the product corresponds with the main voltage in your home, if you are in any doubt about your supply contact your local electricity company.

The flexible mains lead is supplied connected to a B.S. 1363 fused plug having a fuse of 13 amp capacity.

Should this plug not fit the socket outlets in your home, it should be cut off and replaced with a suitable plug, following the procedure outlined below.

**Note:** Such a plug cannot be used for any other appliance and should therefore be properly disposed of and not left where children might find it and plug it into a supply socket - with the obvious consequent danger.

**Please note:** We recommend the use of good quality plugs and wall sockets that can be switched off when the machine is not in use.

**IMPORTANT:** The wires in the mains lead fitted to this appliance are coloured in accordance with the following code:

GREEN AND YELLOW  
BLUE  
BROWN

EARTH  
NEUTRAL  
LIVE

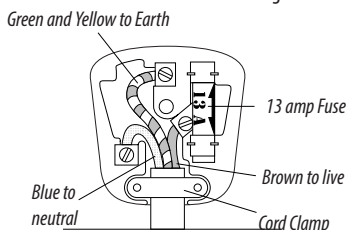

As the colours of the wires in the mains lead of this appliance may not correspond with the coloured markings identifying the terminals in your plug, proceed as follows:

- The wire which is coloured green and yellow must be connected to the terminal in the plug which is marked with the letter E or by the earth symbol  or coloured green or green and yellow.
- The wire which is coloured blue must be connected to the terminal which is marked with the letter N or coloured black.
- The wire which is coloured brown must be connected to the terminal which is marked with the letter L or coloured red.

When wiring the plug, ensure that all strands of wire are securely retained in each terminal. Do not forget to tighten the mains lead clamp on the plug. If your electricity supply point has only two pin socket outlets, or if you are in doubt, consult a qualified electrician.

Should the mains lead ever require replacement, it is essential that this operation be carried out by a qualified electrician and should only be replaced with a flexible cord of the same size.

After replacement of a fuse in the plug, the fuse cover must be refitted. If the fuse cover is lost, the plug must not be used until a replacement cover is obtained. The colour of the correct replacement fuse cover is that of the coloured insert in the base of the fuse recess or elsewhere on the plug. Always state this colour when ordering a replacement fuse cover.

Only 13amp replacement fuses which are approved to B.S. 1362 should be fitted.

This appliance conforms to the Norms EN 55014 regarding the suppression of radio interference.

**Warning - this appliance must be earthed**