

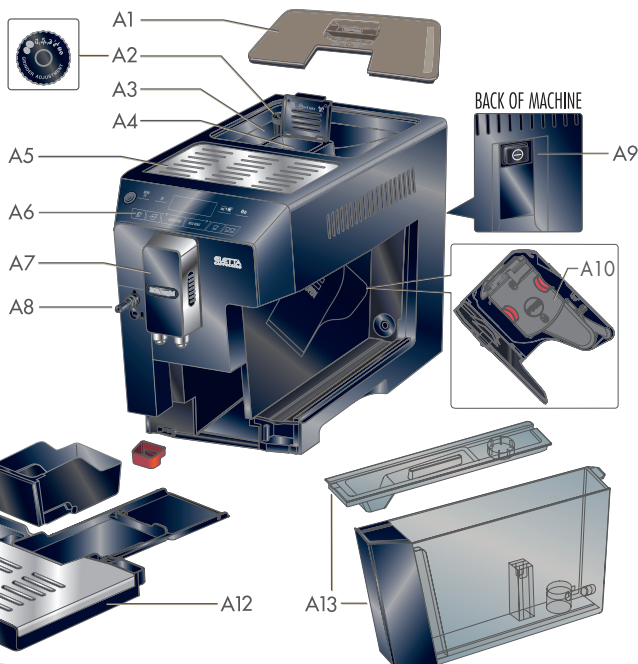

IN THE BOX

- A1. Beans container lid
- A2. Grinding adjustment dial
- A3. Beans container
- A4. Pre-ground coffee funnel
- A5. Cup warmer shelf
- A6. Control panel
- A7. Coffee spout (adjustable height)
- A8. Hot water and steam nozzle
- A9. Main switch
- A10. Infuser
- A11. Coffee grounds container
- A12. Drip tray
- A13. Water tank with lid



- B1. I.F.D. (Instant Frothing Dispenser) Carafe
- B2. Measuring scoop
- B3. Cleaning brush
- B4. Hot water spout
- B5. Water filter



Natural Descaler
100ml/3.4 oz.



Get Started & Own-
er's Instructions
Booklets



MACHINE SET UP



571329331/02.16

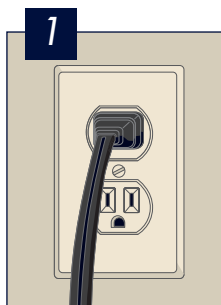

Plug into outlet



Push **ON** main switch, located on back of machine.

3 Fill Water and Bean Container

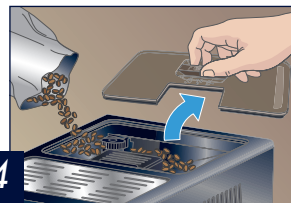
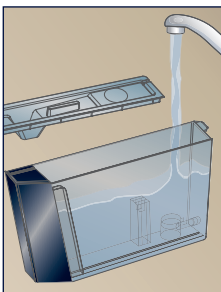
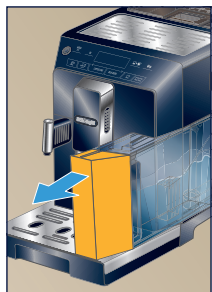

Open top lid, pull out beans container lid. Pour coffee beans into beans container.



Insert water spout and place a container underneath.



Press **OK** Button. The machine will prime. A little water will be released by the hot water spout. The machine will then switch it off automatically.

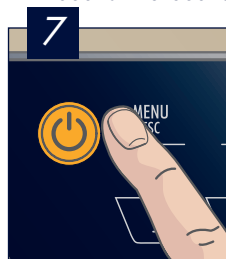

Press **ON/OFF** button to turn **ON** machine.

Machine is now ready to work!

Video available on <http://ecam44660.delonghi.com>

ECAM44660