

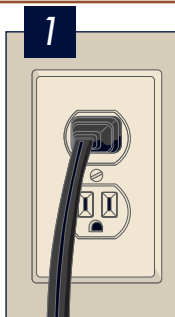

MACHINE SET UP

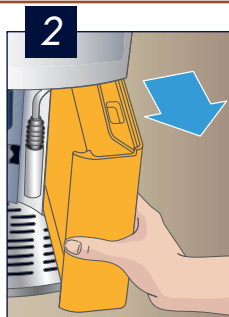

1 Plug into outlet



2 Fill water tank

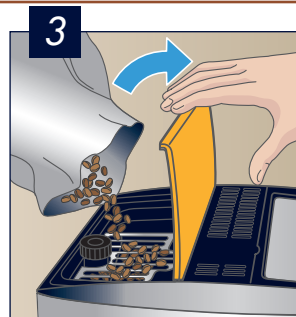
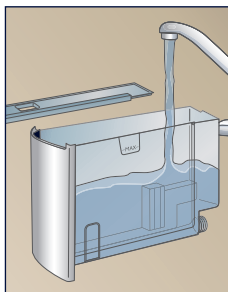

3 Fill bean container with coffee beans

4 Priming the appliance

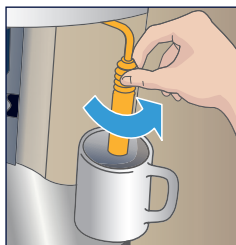

Place a cup under the milk frother.



Push ON main switch, located on back of machine.

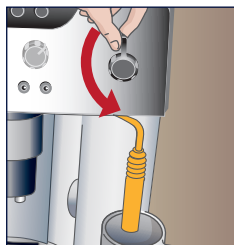

Turn knob counter-clockwise to start the prime. Hot water will be released by the milk frother.



After 1/3 of the cup is full turn the knob clockwise to stop the water flow.

5

Flashing

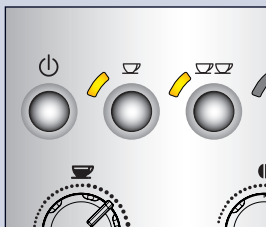

Steady

Machine is now ready to work!

Video available on <http://esam04110.delonghi.com>



5713228631/09.16

ESAM04.110