

ESAM685X

BEAN TO CUP ESPRESSO
AND CAPPUCCINO MACHINE
Instruction for Use

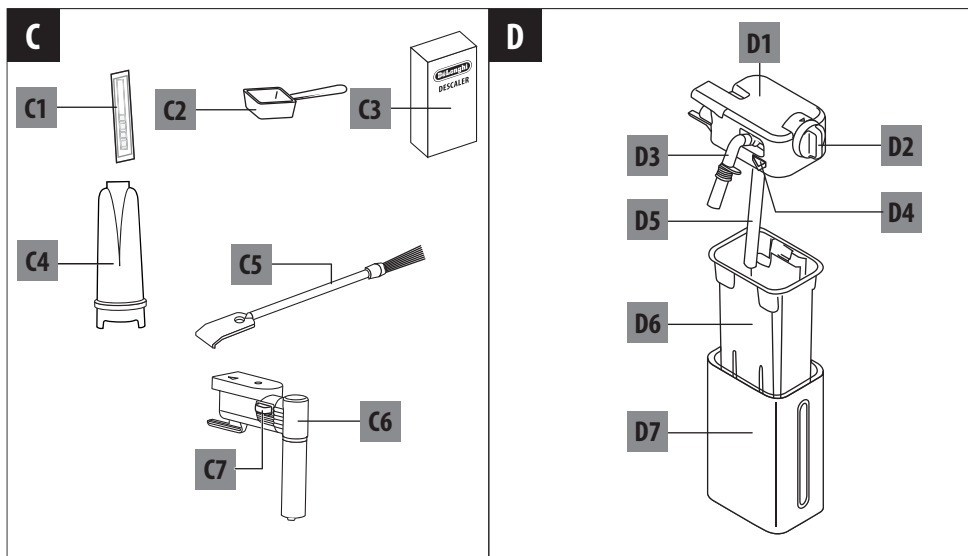

De'Longhi

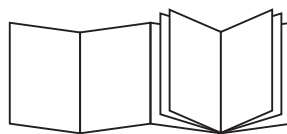

A

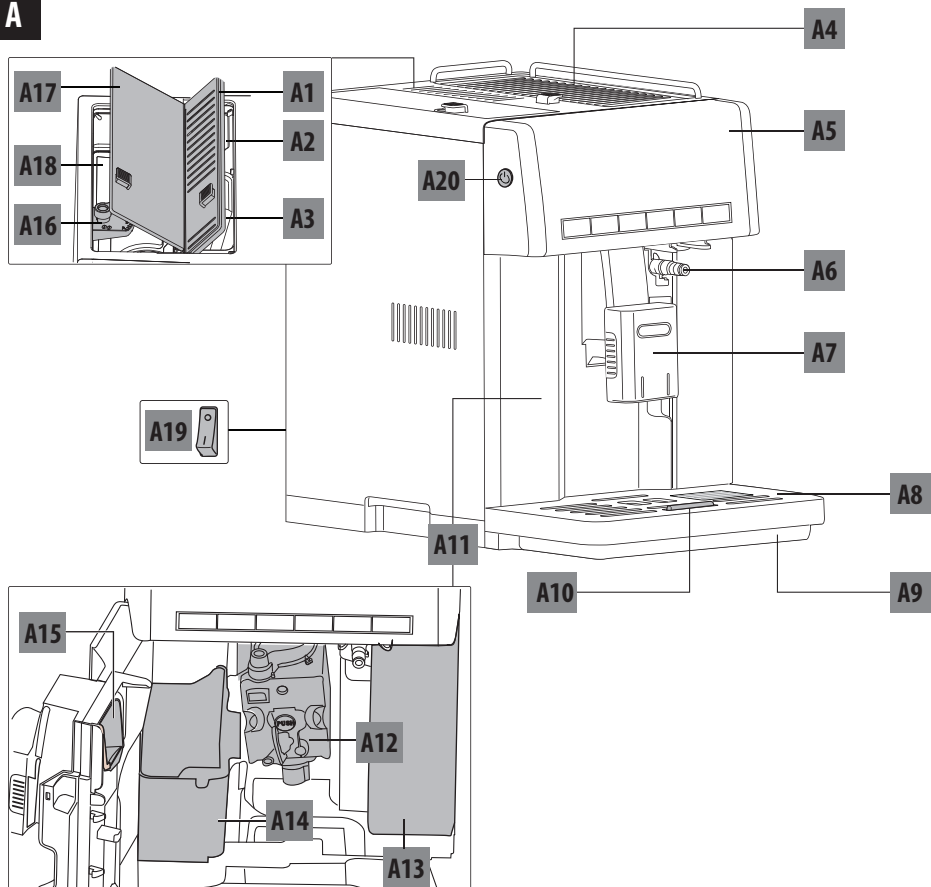

B

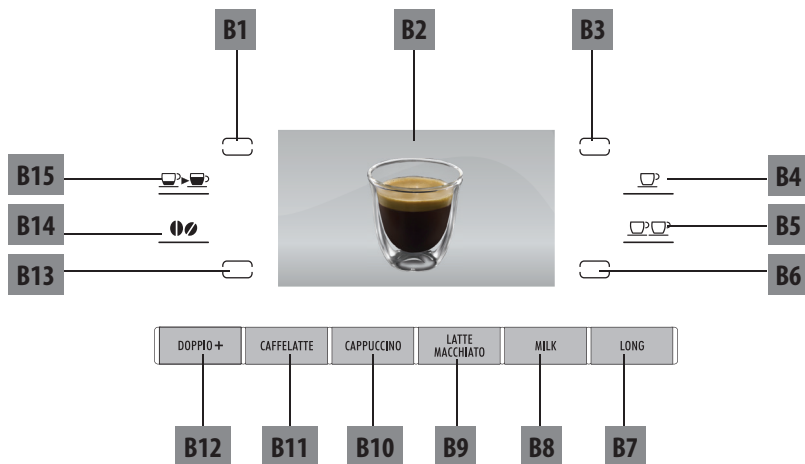

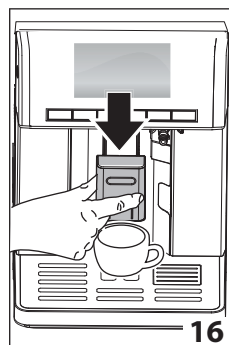
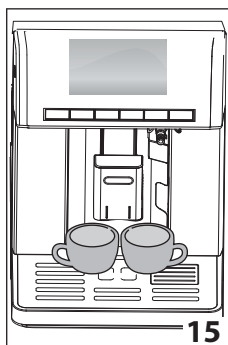
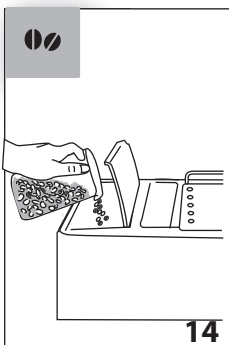
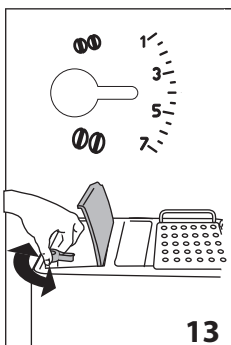
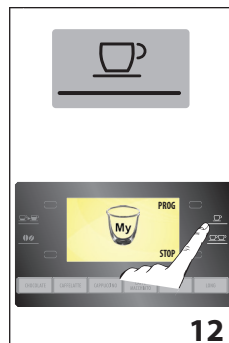
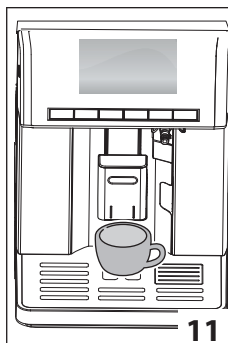
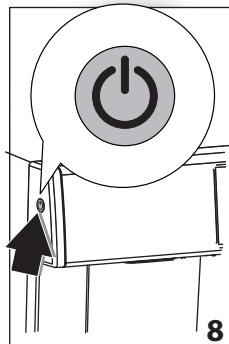
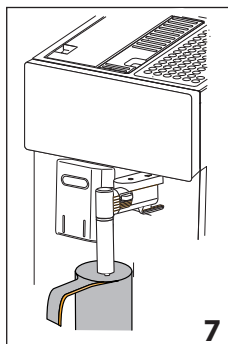
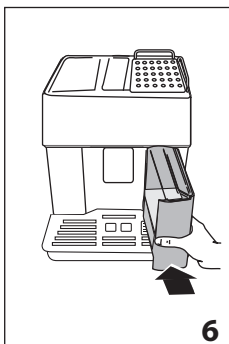
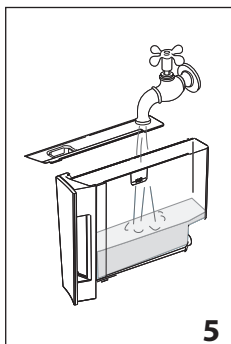
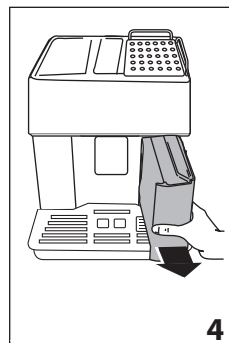
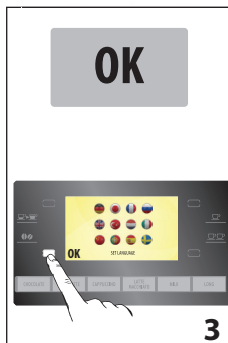
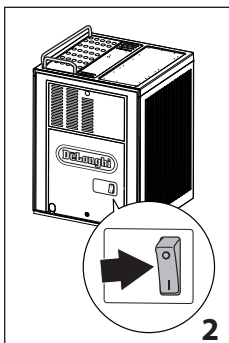
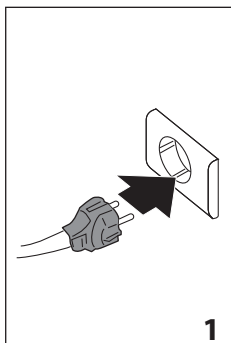

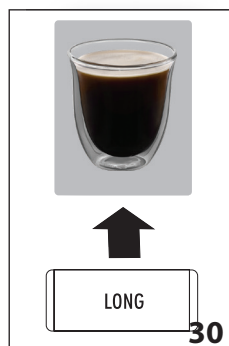
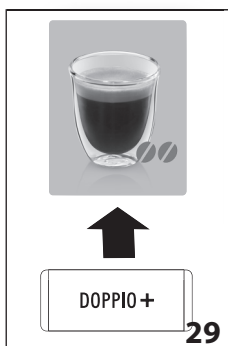
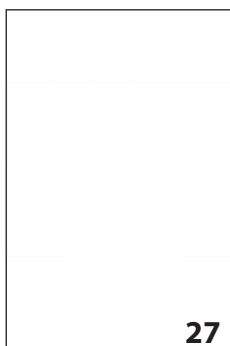
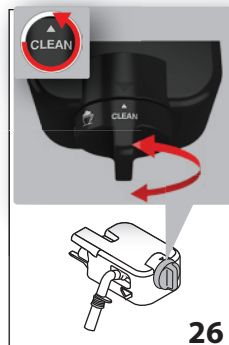
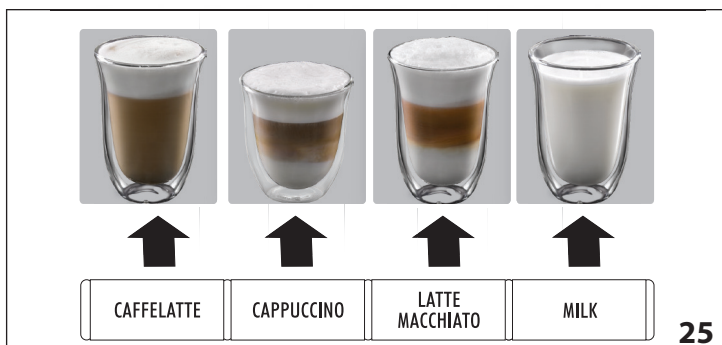
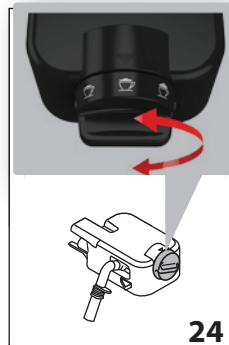
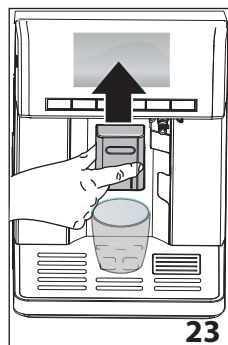
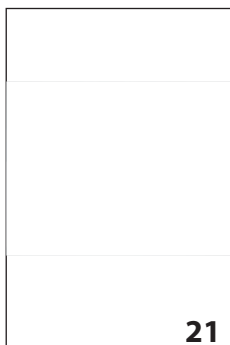
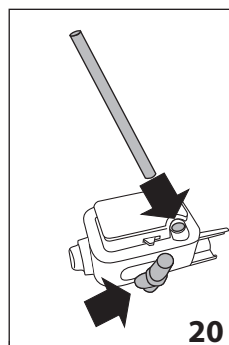
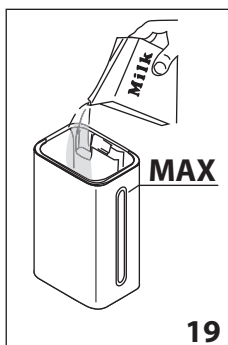
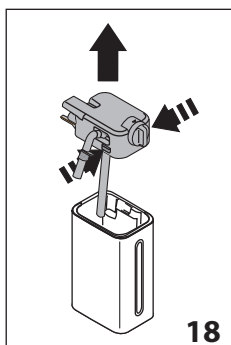

CONTENTS

1. FUNDAMENTAL SAFETY WARNINGS.....	7
2. SAFETY WARNINGS	8
2.1 Symbols used in these instructions	8
2.2 Designated use.....	8
2.3 Instruction for Use.....	8
3. INTRODUCTION.....	8
3.1 Letters in brackets	8
3.2 Troubleshooting and repairs.....	8
4. DESCRIPTION.....	9
4.1 Description of the appliance	9
4.2 Description of touch screen	9
4.3 Description of the accessories.....	9
4.4 Description of the milk container	9
5. BEFORE USE.....	9
5.1 Checking the appliance	9
5.2 Installing the appliance.....	9
5.3 Connecting the appliance.....	10
5.4 Setting up the appliance	10
6. TURNING THE APPLIANCE ON.....	10
7. TURNING THE APPLIANCE OFF	10
8. MENU SETTINGS	11
8.1 Rinsing.....	11
8.2 Select background.....	11
8.3 Descale.....	11
8.4 Install water filter (if provided)	11
8.5 Set clock.....	11
8.6 Auto-start	11
8.7 Auto-off (standby)	11
8.8 Energy saving.....	11
8.9 Coffee temperature	12
8.10 Setting water hardness	12
8.11 Beep.....	12
8.12 Default values (reset)	12
8.13 Statistics.....	12
8.14 Set language.....	12
9. MAKING COFFEE.....	12
9.1 Selecting the coffee taste.....	12
9.2 Selecting the quantity of coffee in the cup.....	12
9.3 Customising the “My coffee” quantity.....	13
9.4 Adjusting the coffee mill	13
9.5 Tips for a hotter coffee.....	13
9.6 Making espresso coffee using coffee beans	13
9.7 Making espresso coffee using pre-ground coffee	13
10. MAKING CAPPUCCINO AND MILK-BASED COFFEES	14
10.1 Filling and attaching the milk container.....	14
10.2 Adjusting the amount of froth.....	14
10.3 Making caffelatte/cappuccino/latte macchiato/milk	14
10.4 Programming the quantities of coffee and milk in the cup	14
10.5 Cleaning the milk container after every use	15
11. MAKING DOPPIO+ COFFEE.....	15
12. MAKING LONG COFFEE.....	15
12.1 Making LONG coffee using pre-ground coffee	15
12.2 Customising the “My LONG coffee” quantity	15
13. DELIVERING HOT WATER AND STEAM	16
13.1 Hot water	16
13.2 Changing the quantity of water delivered automatically	16
13.3 Steam delivery	16
13.4 Tips for using steam to froth milk.....	16
13.5 Clean the hot water/steam spout after use	16
14. MEMORISING YOUR PERSONAL PROFILE....	17
15. CLEANING.....	17
15.1 Cleaning the machine	17
15.2 Cleaning the machine's internal circuit.....	17
15.3 Cleaning the coffee grounds container	17
15.4 Cleaning the drip tray.....	18
15.5 Cleaning the inside of the coffee machine.....	18
15.6 Cleaning the water tank.....	18
15.7 Cleaning the coffee spouts	18
15.8 Cleaning the pre-ground coffee funnel	18
15.9 Cleaning the infuser	19
15.10 Cleaning the milk container (D).....	19
15.11 Cleaning the hot water/steam connection nozzle.....	20
16. DESCALING.....	20
17. SETTING WATER HARDNESS	20
17.1 Measuring water hardness	21
17.2 Setting water hardness	21
18. WATER SOFTENER FILTER (IF PROVIDED) ...	21
18.1 Installing the filter	21
18.2 Replacing the filter.....	22
18.3 Removing the filter	22
19. TECHNICAL DATA.....	22
20. DISPOSAL	22
21. DISPLAYED MESSAGES.....	23
22. TROUBLESHOOTING	25
23. ELECTRICAL CONNECTION (UK ONLY)	27

1. FUNDAMENTAL SAFETY WARNINGS

- The appliance is not intended for use by persons (including children) with reduced physical, sensory or mental capabilities, or lack of experience and knowledge, unless they have been given supervision or instruction concerning use of the appliance by a person responsible for their safety.
- Children should be supervised to ensure that they do not play with the appliance.
- Cleaning and user maintenance shall not be made by children without supervision.
- Never clean by immersing the appliance in water.
- This is an household appliance only. It is not intended to be used in: staff kitchen areas in shops, offices and other working environments; farm houses; by clients in hotels, motels and other residential type environments; bed and breakfast type environments.
- If the plug or cord is damaged, it must be replaced by Customer Services only to avoid all risk.

FOR EUROPEAN MARKETS ONLY:

- This appliance can be used by children aged from 8 years and above if they have been given supervision or instruction concerning use of the appliance in a safe way and understand the hazards involved. Cleaning and user maintenance shall not be made by children unless they are older than 8 and supervised. Keep the appliance and power cord away from children under 8 years of age.
- The appliance can be used by persons with reduced physical, sensory or mental capabilities or lack of experience and knowledge if they are supervised or have been given instruction concerning use of the appliance in a safe way and if they understand the hazards involved.
- Children shall not play with the appliance.
- Always unplug the appliance when left unattended and before assembly, taking apart or cleaning.



Surfaces marked with this symbol become hot during use (the symbol is present in certain models only).

2. SAFETY WARNINGS

2.1 Symbols used in these instructions

Important warnings are identified by these symbols. It is vital to respect these warnings.



Danger!

Failure to observe the warning may result in life threatening injury by electric shock.



Important!

Failure to observe the warning could result in injury or damage to the appliance.



Danger of burns!

Failure to observe the warning could result in scalds or burns.



Please note:

This symbol identifies important advice or information for the user.



Danger!

This is an electrical appliance and may cause electric shock.

You should therefore follow these safety warnings:

- Never touch the appliance with damp hands or feet.
- Never touch the plug with damp hands.
- Make sure the socket used is freely accessible at all times, enabling the appliance to be unplugged when necessary.
- Unplug directly from the plug only. Never pull the cord as you could damage it.
- To disconnect the appliance completely you must unplug it from the mains socket.
- If the appliance is faulty, do not attempt to repair. Turn it off, unplug from the mains socket and contact Customer Services.
- Before cleaning the appliance, turn it off, unplug from the mains socket and allow to cool.



Important:

Keep all packaging (plastic bags, polystyrene foam) away from children.



Danger of burns!

This appliance produces hot water and steam may form while it is in operation.

Avoid contact with splashes of water or hot steam.

When the appliance is in operation, the cup shelf could become very hot.

2.2 Designated use

This appliance is designed and made to prepare coffee and heat drinks.

Any other use is considered improper and thus dangerous. The manufacturer is not liable for damage deriving from improper use of the appliance.

2.3 Instruction for Use

Read this Instruction for Use carefully before using the appliance. Failure to follow this Instruction for Use may result in injury or damage to the appliance.

The manufacturer is not liable for damage deriving from failure to respect this Instruction for Use.



Please note:

Keep this Instruction for Use. If the appliance is passed to other persons, they must also be provided with this Instruction for Use.

3. INTRODUCTION

Thank you for choosing this bean to cup espresso and cappuccino machine.

We hope you enjoy using your new appliance. Take a few minutes to read this Instruction for Use. This will avoid all risks and damage to the appliance.

3.1 Letters in brackets

The letters in brackets refer to the legend in the description of the appliance on pages 2-3.

3.2 Troubleshooting and repairs

In the event of problems, first try to resolve them by reading the information given in sections "21. Displayed messages" and "22. Troubleshooting".

If this does not resolve the problem or you require further information, you should consult Customer Services by calling the number given on the annexed "Customer Service" sheet.

If your country is not among those listed on the sheet, call the number given in the guarantee. If repairs are required, contact De'Longhi Customer Services only. The addresses are given in the guarantee certificate provided with the machine.

4. DESCRIPTION

4.1 Description of the appliance









(page 3 - A)

- A1. Cover for funnel and measure compartment
- A2. Measure compartment
- A3. Pre-ground coffee funnel
- A4. Cup shelf (cup warmer when Energy Saving is disabled)
- A5. Touch screen (B)
- A6. Hot water/steam connection nozzle
- A7. Coffee spouts (adjustable height)
- A8. Cup tray
- A9. Drip tray
- A10. Drip tray water level indicator
- A11. Service door
- A12. Infuser
- A13. Water tank
- A14. Grounds container
- A15. Coffee guide
- A16. Grinding adjustment dial
- A17. Beans container lid
- A18. Beans container
- A19. Main switch (on back of machine)
- A20. ON/STANDBY button

4.2 Description of touch screen

(page 3 - B)

Only the icons relating to the controls enabled for the particular function currently being used will be lit on the touch screen.

- B1.  icon: changes function according to the text displayed alongside the icon
- B2. Display: guides the user in using the appliance
- B3.  icon: changes function according to the text displayed alongside the icon
- B4.  icon: to deliver one cup of espresso coffee.
- B5.  icon: to deliver two cups of espresso coffee.
- B6.  icon: changes function according to the text displayed alongside the icon
- B7. **LONG** icon: to deliver a cup of LONG coffee.
- B8. **MILK** icon: to deliver a cup of milk.
- B9. **LATTE MACCHIATO** icon: to deliver a cup of latte macchiato.
- B10. **CAPPUCCINO** icon: to deliver a cappuccino.
- B11. **CAFFELATTE** icon: to deliver a caffelatte.
- B12. **DOPPIO+** icon: to make one DOPPIO+ coffee.
- B13.  icon: changes function according to the text displayed alongside the icon
- B14.  icon: to select the coffee taste.
- B15.  icon: to select the coffee quantity.



Please note:

A light touch is enough to activate the icon.

4.3 Description of the accessories

(page 2 - C)

- C1. "Total Hardness Test" indicator paper
- C2. Pre-ground coffee measure
- C3. Descaler
- C4. Water softener filter (*certain models only)
- C5. Cleaning brush
- C6. Hot water/steam spout (cappuccino maker)
- C7. Spout release button

4.4 Description of the milk container

(page 2 - D)

- D1. Lid with milk frother
- D2. Froth adjustment and CLEAN dial
- D3. Frothed milk spout (adjustable)
- D4. Lid release buttons
- D5. Milk intake tube
- D6. Milk container
- D7. Thermal casing

5. BEFORE USE

5.1 Checking the appliance

After removing the packaging, make sure the product is complete and undamaged and that all accessories are present. Do not use the appliance if it is visibly damaged. Contact De'Longhi Customer Services.

5.2 Installing the appliance



Important!

When you install the appliance, you should respect the following safety warnings:

- The appliance gives off heat.
After positioning the appliance on the worktop, leave a space of at least 3 cm between the surfaces of the appliance and the side and rear walls and at least 15 cm above the coffee maker.
- Water infiltration could damage the appliance and cause electric shock.
Do not place the appliance near taps or sinks.
- The appliance could be damaged if the water it contains freezes.
Do not install the appliance in a room where the temperature could drop below freezing point.
- Arrange the cord in such a way that it cannot be damaged by sharp edges or contact with hot surfaces (e.g. electric hot plates).

5.3 Connecting the appliance



Important!

Check that the mains power supply voltage corresponds to that indicated on the rating plate on the bottom of the appliance.

Connect the appliance to an efficiently earthed and correctly installed socket with a minimum current rating of 10A only.

If the power socket does not match the plug on the appliance, have the socket replaced with a suitable type by a qualified professional.

5.4 Setting up the appliance



Please note:

- Coffee has been used to factory test the appliance and it is therefore completely normal for there to be traces of coffee in the mill. The machine is, however, guaranteed to be new.
- You should customise water hardness as soon as possible following the instructions in section "17. Setting water hardness".

1. Plug the appliance into the mains socket (fig. 1) and place the main switch (A19) on the back of the appliance in the I position (fig. 2).

You must first choose the language (the languages scroll through at intervals of about 3 seconds):

2. When "English" appears, press and hold the **OK** icon (fig. 3) for a few seconds until "English set" appears on the display (B2).

Follow the instructions indicated by the appliance:

3.  "FILL TANK": remove the water tank (A13) (fig. 4), fill to the MAX line with fresh water (fig. 5), then replace in the appliance (fig. 6).

4.  "INSERT WATER SPOUT": Check that the hot water spout (C6) is inserted on the connection nozzle (A6) and place a container holding a minimum of 100 ml underneath (fig. 7).

5.  "Water delivery PRESS OK": press the OK icon on the display.

6. The appliance starts delivering water from the hot water spout.

7. The appliance ends the first start up procedure and goes off automatically.

The coffee machine is now ready for normal use.



Please note:

- When setting up the appliance, you need to make 4-5 cups of coffee or 4-5 cappuccinos before the appliance starts to give satisfactory results.
- When making the first 5-6 cappuccinos, it is normal to hear the noise of boiling water. After this, the noise becomes less.

6. TURNING THE APPLIANCE ON



Please note:

Before turning the appliance on, make sure the main switch (A19) on the back of the appliance is in the I position (fig. 1).

Each time the coffee machine is turned on, it performs an automatic preheat cycle and, if necessary, a rinse cycle which cannot be interrupted. The appliance is ready for use only after completion of this cycle.



Danger of burns!

During rinsing, a little hot water comes out of the coffee spouts (A7) and is collected in the drip tray (A9) underneath. Avoid contact with splashes of water.

- To turn the appliance on, press and hold the  button (A20) (fig. 8) for a few moments:



The message "Heating Up... Please wait" appears on the display (B2).



When heating is complete, the message changes to "RINSING".



The appliance is ready for use when an espresso coffee cup appears on the display.

7. TURNING THE APPLIANCE OFF

Whenever the coffee machine is turned off after being used to make coffee, it performs an automatic rinse cycle.



Danger of burns!

During rinsing, a little hot water flows from the coffee spouts (A7). Avoid contact with splashes of water.

To turn the appliance off, press the  button (A20) (fig. 8). The appliance performs a rinse cycle then goes off (stand-by).



Please note:

If you will not be using the appliance for some time, unplug from the mains socket:

- first turn the appliance off by pressing the  button (fig. 8);
- press the main switch (A19) to the **0** position.



Important!

Never place the main switch in the 0 position while the appliance is on.

8. MENU SETTINGS

To access the settings menu, press the **MENU** icon. Scroll through the menu by pressing the  or  icon.

To exit the menu or cancel setting, press the **ESC** icon.

The following can be selected from the menu: Rinsing, Select background, Descale, Install water filter, Set clock, Auto-start, Auto-off, Energy Saving, Set temperature, Water Hardness, Beep, Default values, Statistics, Set language.

8.1 Rinsing

Use this function to deliver hot water from the coffee spouts (A7) to heat the internal circuit and make the coffee delivered hotter.



Press the **OK** icon to select the function.

Press **OK** again to confirm and start rinsing.

After rinsing, the appliance is automatically ready to make the next drink.





Please note!

During rinsing, a little hot water comes out of the coffee spouts (A7) and is collected in the drip tray (A9) underneath. Avoid contact with splashes of water.

8.2 Select background

Use this function to change the colour of the display (B2) background.



Press the **OK** icon to select the function. Press the  or  icon to select the required background, then press **OK** again to confirm the choice.



Please note!

This menu item can be customised in all profiles (see section "14. Memorising your personal profile").

8.3 Descale



For instructions on descaling, see section "16. Descaling".

8.4 Install water filter (if provided)





For instructions on the water filter (C4), see section "18. Water softener filter (if provided)".

8.5 Set clock

To set the time on the display (B2), proceed as follows:



Press the **OK** icon to select the function. Set the hour using the  symbol to increase and the  symbol to decrease, then press **OK** again to confirm, then adjust the minutes in the same way. Finally, press **OK** to memorise the time set.



Please note!

Press and hold the  or  icon to run through the hours and minutes quickly.

8.6 Auto-start

You can set the auto-start time in order to have the appliance ready at a certain time (for example in the morning) so you can make coffee immediately.



Please note!

- For the appliance to come on at the set time, **the time must first have been set correctly.**
- To set the auto-start time, the time of day must have already been set.



Press the **OK** icon to select the function, then press **OK** again to confirm. Adjust the time as described in the previous section and confirm with **OK**. The grey symbol indicates that the function is not active.





Please note!

- When the function is active, the  symbol appears on the display (B2) alongside the current time.
- To disable the function, access the menu and select the function as described above. "DISABLE?" is displayed. Press **OK** to confirm. The symbol alongside the current time disappears.
- If auto-start is enabled and the appliance is turned off by the main switch, the auto-start setting will be lost.

8.7 Auto-off (standby)

Auto-off can be set so that the appliance goes off after 15 or 30 minutes, or after 1, 2 or 3 hours.



Press the **OK** icon to select the function. Press the  or  icon to select the required time, then press **OK** again to confirm.

8.8 Energy saving

Use this function to enable or disable energy saving. When enabled, the function reduces energy consumption in compliance with current European regulations.



Press the **OK** icon to select the function, then press **OK** again to enable or disable the function.





Please note!

- When the function is active, the  symbol appears alongside the current time.
- A few seconds may elapse between Energy Saving mode and delivery of the first drink.
- When Energy Saving is disabled, the appliance turns the cup warmer (A4) on automatically.
- If the milk container (D) is inserted, Energy Saving cannot be activated.

8.9 Coffee temperature

To modify the temperature of the water used to make the coffee, proceed as follows:



Press the **OK** icon to select the function. Press the  or  icon to select the required temperature, then press **OK** again to confirm.



Please note!

This menu item can be customised in all profiles (see section "14. Memorising your personal profile").

8.10 Setting water hardness



For instructions on setting water hardness, see section "17. Setting water hardness".

8.11 Beep

This enables or disables the beep emitted by the machine each time an icon is pressed or an accessory is inserted/removed. The beep is active by default.



Press the **OK** icon to select the function. Press **OK** again to enable or disable the beep. The grey symbol indicates that the function is not active.

8.12 Default values (reset)



This resets all menu settings and programmed quantities back to the default values (with the exception of the language which remains as set).

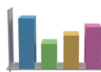

Press the **OK** icon to select the function. Press **OK** again to confirm and reset to the default values.

8.13 Statistics





This displays statistics relating to the machine. Press the **OK** icon to select the function. Press the  or  icon to display the available statistics:

- number of coffees delivered;
- number of drinks with milk delivered (CAPPUCCINO, LATTE MACCHIATO, CAFFELATTE, MILK);
- total litres of water delivered;
- number of water filters used;
- number of times the machine has been descaled.

8.14 Set language

To modify the language of the display (B2), proceed as follows:



Press the **OK** icon to select the function. Press the  or  icon to select the required language, then press **OK** to confirm the choice.

9. MAKING COFFEE

9.1 Selecting the coffee taste

The appliance is set by default to make coffee with a standard taste.

You can select one of the following tastes appearing on the display (B2) under the glass:



To change the taste, press the  icon (B14) (fig. 9) repeatedly until the required taste is displayed.

9.2 Selecting the quantity of coffee in the cup

The appliance is set by default to make a standard quantity of coffee.



To select the quantity of coffee, press the  icon (B15) (fig. 10) repeatedly until the message corresponding to the required quantity of coffee appears on the display (B2):

Corresponding coffee	ESPRESSO (ml)
My coffee	≈30 (program. from ≈20 to ≈180)
Short	≈40
Standard	≈60
Long	≈90
Extra long	≈120

9.3 Customising the “My coffee” quantity

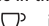

The appliance is set by default to automatically deliver 30 ml of “My coffee”. To modify this quantity, proceed as follows:

1. Place a cup under the coffee spouts (A7) (fig. 11).
2. Press the  icon (B15) (fig. 10) repeatedly until “My coffee” appears on the display (B2);
3. Press the 1 cup icon  (B4) (fig. 12). The appliance starts making the coffee;
4. Press the **PROG** icon. The appliance starts programming;
5. As soon as the coffee in the cup reaches the required level, press the **STOP** or  icon.

The quantity set has now been programmed.



Please note:

- You can programme a single cup of coffee only.
- To cancel “My coffee” programming, press the **EXIT PROG** icon.



“My coffee” can be customised in all profiles (see section “14. Memorising your personal profile”).

9.4 Adjusting the coffee mill

The coffee mill is set by default to prepare coffee correctly and should not require regulating initially.

However, if after making the first few coffees you find that delivery is either too fast or too slow (a drop at a time), this can be corrected by adjusting the grinding adjustment dial (A16) (fig. 13).



Please note!

The grinding adjustment dial must only be turned when the coffee mill is in operation.

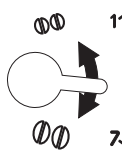

For fuller bodied creamier coffee, turn one click anticlockwise towards “1” (finer ground coffee).

For faster delivery (not a drop at a time), turn one click clockwise towards “7” (coarser ground coffee).

These adjustments will only be evident after at least 2 cups of coffee have been delivered. If delivery is still too fast or too slow, repeat the correction, turning the dial another click.

9.5 Tips for a hotter coffee

For hotter coffee, you should:

- perform a rinse cycle before delivering the coffee, using the “Rinsing” function in the menu;
- if Energy Saving is disabled, place the cups on the cup warmer (A4) until they are warm;



- warm the cups with hot water (using the hot water function);
- set a higher coffee temperature in the menu.

9.6 Making espresso coffee using coffee beans



Important!

Do not use caramelised or candied coffee beans as they could stick to the coffee mill and make it unusable.

1. Fill the beans container (A18) (fig. 14) with coffee beans.
2. Place under the coffee spouts (A7):
 - 1 cup, if you want to make 1 coffee (fig. 11);
 - 2 cups, if you want 2 coffees (fig. 15).
3. Lower the coffee spouts as near as possible to the cup. This makes a creamier coffee (fig. 16).
4. Press the icon corresponding to the number of coffees required (B4 - one cup  or B5 - two cups ) (figs. 12 or 17).
5. The appliance starts making coffee. An image corresponding to the type of preparation chosen appears on the display (B2) together with a progress bar which fills as preparation proceeds.

At the end of preparation, the appliance prepares to make the next drink.

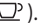
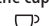
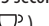

Please note:

- While the appliance is making coffee, delivery can be interrupted at any moment by pressing the **STOP** icon or one of the coffee icons ( or ).
- At the end of delivery, to increase the quantity of coffee in the cup, within 3 seconds just press one of the coffee icons ( or ).



Important!

- If the coffee is delivered a drop at a time, too fast and not creamy enough or too cold, read the tips in section “22. Troubleshooting”.
- Various alarm messages could be displayed while the machine is in use. Their meaning is explained in section “21. Displayed messages”.

9.7 Making espresso coffee using pre-ground coffee





Important!



- Never add pre-ground coffee when the machine is off or it could spread through the inside of the machine and dirty it. This could damage the appliance.
- Never use more than 1 level measure (C2) or it could dirty the inside of the coffee machine or block the funnel.

Please note!

If you use pre-ground coffee, you can only make one cup of coffee at a time.

1. Press the  icon (B14) (fig. 9) repeatedly to select the pre-ground coffee symbol .
2. Put one level measure of pre-ground coffee into the pre-ground coffee funnel (A3) (fig. 18).
3. Place a cup under the coffee spouts (A7) (fig. 11).
4. Press the 1 cup icon  (B4).
5. The appliance starts making coffee. An image corresponding to the type of preparation chosen appears on the display (B2) together with a progress bar which fills as preparation proceeds.

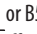
Please note!

- While the appliance is making coffee, delivery can be interrupted at any moment by pressing the STOP icon or one of the coffee icons (B4-  or B5- ).
- To increase the quantity of coffee in the cup, within 3 seconds just press and hold the coffee icon .

At the end of preparation, the appliance prepares to make the next drink.

10. MAKING CAPPUCCINO AND MILK-BASED COFFEES

Please note!

A few seconds may elapse between Energy Saving and delivery of the first drink.

10.1 Filling and attaching the milk container

1. Press the release buttons (D4) and lift the milk container lid (D1) (fig. 18).
2. Fill the milk container (D6) with a sufficient quantity of milk, not exceeding the MAX level (fig. 19).

Please note!



For a richer denser froth, use skimmed or partially skimmed milk at refrigerator temperature (about 5°C). To avoid producing milk with poor froth or large bubbles, always clean the milk container lid and hot water/steam connection nozzle (A6) as described in sections "13.5 Cleaning the hot water/steam spout after use", "15.10 Cleaning the milk container (D)" and "15.11 "Cleaning the hot water/steam connection nozzle".

3. Make sure the spout (D3) and milk intake tube (D5) are correctly inserted in the bottom of the milk container lid (fig. 20).
4. Attach the lid back on the milk container.

5. Attach the container to the connection nozzle (A6) (fig. 21), pushing as far as it will go.
6. Place a sufficiently large cup under the coffee spouts (A7) and frothed milk spout (fig. 22). To use particularly tall cups/glasses, lift the coffee and milk spouts (fig. 23).
7. Follow the instructions below for each function.

10.2 Adjusting the amount of froth

Turn the froth adjustment dial (D2) on the milk container lid (D1) to adjust the amount of froth on the milk delivered while making cappuccinos and milk-based coffees (fig. 24). Follow the tips in the table below:

Dial position	Description	Recommended for...
	No froth	CAFFELATTE/MILK (hot milk)
	Min. froth	LATTE MACCHIATO
	Max. froth	CAPPUCCINO/MILK (frothed milk)

10.3 Making caffelatte/cappuccino/latte macchiato/milk

1. Press the icon corresponding to the drink you want to make (fig. 25).
2. After a few seconds, milk is delivered from the milk spout (D3) into the cup below. Delivery of milk stops automatically and (if needed for the drink), coffee delivery starts. An image of the drink being prepared appears on the display (B2) (fig. 25) together with a progress bar which fills gradually.

Please note!

Milk or coffee delivery can be interrupted by pressing the STOP icon. To stop preparation altogether, press the ESC icon.

10.4 Programming the quantities of coffee and milk in the cup

The appliance is set by default to automatically deliver standard quantities. To change these quantities, proceed as follows:

1. Place a cup under the coffee spouts (A7) and milk spout (D3) (fig. 22).
2. Press the icon corresponding to the function to be programmed (caffelatte, cappuccino, latte macchiato, milk) (fig. 25). The machine starts delivering milk.
3. Press the **PROG** icon.
4. When the required quantity of milk has flowed into the cup, press the **STOP** icon.

- If needed for the drink, after a few seconds, the machine starts delivering coffee. When the required quantity of coffee has flowed into the cup, press the **STOP** icon. Coffee delivery stops.

The machine is now reprogrammed with the new quantities.



Please note!

- To cancel programming of the drinks, press the **EXIT PROG** icon.



Milk-based drinks can be customised in all profiles (see section "14. Memorising your personal profile").

10.5 Cleaning the milk container after every use



Important! Danger of burns

When cleaning the internal tubes of the milk container, a little hot water and steam leak out of the frothed milk spout (D3). Avoid contact with splashes of water.



After preparing a cappuccino or milk-based coffee, the machine must be cleaned to remove the milk residues. Proceed as follows:

- Leave the milk container (D) in the machine (you do not need to empty it).
- Place a cup or other recipient under the frothed milk spout.
- Turn the froth adjustment dial (D2) to **CLEAN** (fig. 26). The operation is shown on the display (B2) (fig. 27) and stops automatically.
- Turn the dial back to one of the froth selections.
- Remove the milk container (D) and always clean the hot water/steam connection nozzle (A6) with a sponge (fig. 28).



Please note!

- To prepare a number of cappuccinos or milk-based coffees, clean the milk container after you have prepared the last drink only.
- The milk container can be kept in the refrigerator.
- In some cases, to clean you must wait for the appliance to heat up.

11. MAKING DOPPIO+ COFFEE

Prepare the appliance following the instructions in section "9.6 Making coffee using coffee beans", then press the **DOPPIO+** icon (B12) (fig. 29).

12. MAKING LONG COFFEE

- Choose the length and taste required, following the same procedure as for espresso coffee.

Corresponding coffee	LONG (ml)
My coffee	≈ 100 (program. from 20 to 250)
Short	≈ 125
Standard	≈ 175
Long	≈ 210
Extra long	≈ 250

- Press the **LONG** icon (B7) (fig. 30).
- The appliance starts making coffee. An image corresponding to the type of drink chosen appears on the display (B2) together with a progress bar which fills as preparation proceeds.



Please note!

To interrupt delivery, press the **LONG** or **STOP** icon.

12.1 Making LONG coffee using pre-ground coffee

- Select the pre-ground coffee symbol and the taste required, following the same procedure as for espresso coffee.
- Press the **LONG** icon (B7) (fig. 30).
- The appliance starts making coffee. An image corresponding to the type of drink chosen appears on the display (B2) together with a progress bar which fills as preparation proceeds.

12.2 Customising the "My LONG coffee" quantity



The appliance is set by default to automatically deliver 100ml of "My coffee". To modify these settings, proceed as follows:

- Place a sufficiently large cup or glass under the coffee spouts (A7) (fig. 11).
- Press the icon (B15) (fig. 10) repeatedly until "My coffee" appears on the display (B2);
- Release the **LONG** icon (B7). The appliance starts delivering coffee;
- Press the **PROG** icon. The appliance starts programming;
- As soon as the coffee in the cup reaches the required level, press the **STOP** icon again.

The quantity set has now been programmed.



Please note!

- To cancel "My coffee" programming, press the **EXIT PROG** icon.



"My coffee" can be customised in all profiles (see section "14. Memorising your personal profile").

13. DELIVERING HOT WATER AND STEAM



Important! Danger of burns.

Do not leave the appliance unattended while hot water or steam is being delivered. The spout (C6) becomes hot during delivery. Hold by the handle only.



Please note!

If Energy Saving is active, you may have to wait a few seconds before hot water and steam are delivered.

13.1 Hot water

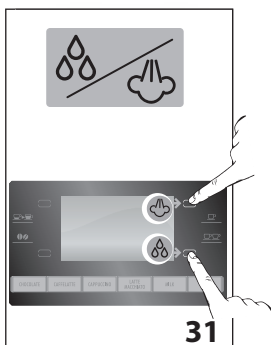

1. Make sure the hot water/steam spout (C6) is attached correctly.
2. Place a container under the hot water/steam spout (as close as possible to avoid splashes) (fig. 7).
3. Press the  icon (fig. 31).

4. Hot water delivery

begins and then stops automatically. A progress bar fills gradually as preparation proceeds. To interrupt hot water delivery manually, press the **STOP** icon again.



Please note!

The quantity of hot water can be customised in all profiles (see section "14. Memorising your personal profile").

13.2 Changing the quantity of water delivered automatically

The machine is set by default to automatically deliver 250 ml of hot water. To modify these quantities, proceed as follows:

1. Make sure the hot water/steam spout (C6) is attached correctly.
2. Position a container under the hot water/steam spout (fig. 7).
3. Press the , then the **PROG** icon.
4. When the hot water in the cup reaches the required level, press the **STOP** icon.

The machine is now reprogrammed with the new quantity.



Please note!

To cancel programming, press the **EXIT PROG** icon.

13.3 Steam delivery

1. Make sure the hot water/steam spout (C6) is attached correctly.
2. Fill a container with the liquid to be heated or frothed and immerse the hot water/steam spout in the liquid.
3. Press the  icon (fig. 31). After a few seconds, the steam to heat the liquid comes out of the hot water/steam spout;
4. When the required temperature is obtained, interrupt steam delivery by pressing the **STOP** icon. (You should not discharge steam for more than 3 minutes at a time).



Important!

Always stop steam delivery before extracting the container containing the liquid to avoid burns from splashes.

13.4 Tips for using steam to froth milk

- When choosing the size of the container, bear in mind that the liquid doubles or triples in volume.
- For a richer denser froth, use skimmed or partially skimmed milk at refrigerator temperature (about 5°C).
- For a creamier froth, rotate the container with slow movements in an upward direction.
- To avoid milk with poor froth or large bubbles, always clean the spout as described in the following section.

13.5 Clean the hot water/steam spout after use

Always clean the hot water/steam spout (C6) after use to avoid the build-up of milk residues and prevent it from clogging.

1. Place a container under the hot water/steam spout (fig. 6) and deliver a little water by pressing the  icon (fig. 31). Stop delivery of hot water by pressing the **STOP** icon.
2. Wait a few minutes for the hot water/steam spout to cool down, then extract it (fig. 32) by pressing the release button (C7). Hold the spout with one hand and with the other, turn the cappuccino maker and pull it downwards (fig. 33).

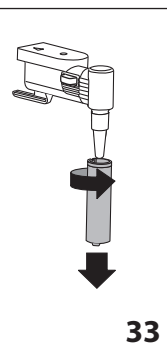
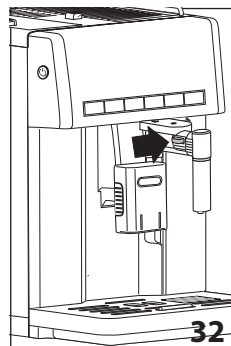

3. Also remove the steam connection nozzle by pulling it downwards (fig. 34).

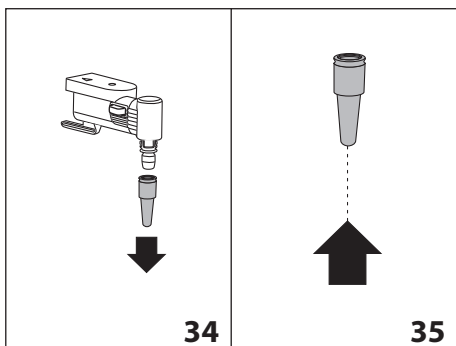

4. Check the hole in the nozzle shown by the arrow in fig. 35 is not blocked. If necessary, clean using a toothpick.
5. Wash all parts of the spout thoroughly with a sponge and warm water.
6. Insert the nozzle and cappuccino maker on the connection nozzle by pushing them upwards and turning them clockwise until they are attached.

14. MEMORISING YOUR PERSONAL PROFILE



The appliance allows you to memorise 6 different profiles, each associated with a different colour.

In each profile you can customise:

- the quantities of espresso and LONG “My coffee”;
- the quantities for all cappuccinos and milk-based coffees;
- the quantity of hot water;
- the preferred background (from the menu);
- the coffee temperature (from the menu).

To use the function, proceed as follows:

1. Enter the “Profiles” section by pressing the icon;
2. Choose your colour by pressing the **CHANGE** icon and then press the **OK** icon to confirm. The chosen colour appears at the bottom left of the display (B2) to indicate you are operating with that profile;
3. Proceed to programme the memorisable drinks as described above. Each time you access the profile, the machine uses the programmed settings.



Please note!

To change the profile, access profile selection by pressing the icon at the bottom left corresponding to the colour in use:

- Press the **CHANGE** icon to enter another profile and **OK** to confirm.
- Press the icon to exit all profiles.
- When in the menu, the colour of the profile is shown on the right (for background and temperature selection only).

15. CLEANING

15.1 Cleaning the machine

The following parts of the machine must be cleaned regularly:

- the appliance's internal circuit,
- grounds container (A14),
- drip tray (A9),
- inside the machine, accessible after opening the service door (A11),
- water tank (A13),
- coffee spouts (A7) and hot water connection nozzle (A6),
- pre-ground coffee funnel (A3),
- infuser (A12),
- touch screen (B),
- milk container (D),
- hot water/steam spout (C6).



Important!

- Do not use solvents, abrasive detergents or alcohol to clean the coffee machine. With De'Longhi superautomatic coffee machines, you need not use chemical products to clean the machine.
- None of the components of the appliance can be washed in a dishwasher with the exception of the milk container (D). **The thermal casing (D7) cannot be washed in a dishwasher or immersed in water.**
- Do not use metal objects to remove encrustations or coffee deposits as they could scratch metal or plastic surfaces.

15.2 Cleaning the machine's internal circuit

If the appliance is not used for more than 3/4 days, before using it again, we strongly recommend switching it on and:

- performing 2-3 rinse cycles by selecting the “Rinsing” function in the settings menu (see section “8.1 Rinsing”);
- delivering hot water for a few seconds by pressing the .



Please note!

- After cleaning, it is normal for the coffee grounds container (A14) to contain water.

15.3 Cleaning the coffee grounds container



The display (B2) indicates when the grounds container (A14) is full. The appliance cannot be used to make coffee until you have cleaned the grounds container. Even if not full, the empty grounds container message is displayed 72 hours after the first coffee has been prepared. For the 72 hours to be calculated correctly, the machine must never be turned off with the main switch (A19) in the 0 position.

To clean (with the machine on):

- Open the service door (A11) on the front of the appliance (fig. 36), extract the drip tray (A9) (fig. 37), empty and clean.

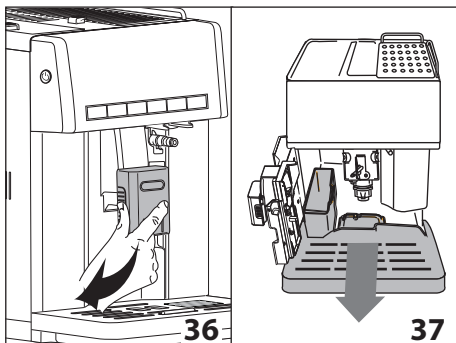

- Empty the grounds container and clean thoroughly to remove all residues left on the bottom. This can be done with the spatula or the brush (C5) provided.

! Important!

When removing the drip tray, the grounds container **must** be emptied, even if it contains few grounds. If this is not done, when you make the next coffees, the grounds container may fill up more than expected and clog the machine.

15.4 Cleaning the drip tray

! Important!

If the drip tray (A9) is not emptied regularly, the water could overflow from the edge and seep inside or around the machine. This could damage the machine, the surface it rests on or the surrounding area.

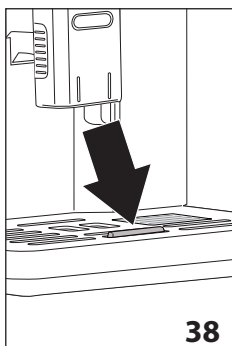

The drip tray is fitted with a level indicator (A10) (red) showing the level of water it contains (fig. 38). As soon as the indicator becomes visible, the tray must be emptied and cleaned.

To remove the drip tray:

1. Open the service door (A11) (fig. 36);
2. Remove the drip tray and the grounds container (A14) (fig. 37);
3. Empty the drip tray and grounds container and wash them;
4. Replace the drip tray complete with grounds container;
5. Close the service door.

15.5 Cleaning the inside of the coffee machine



Danger of electric shock!

Before cleaning internal parts, the machine must be turned off (see section "7. Turning off") and unplugged from the mains power supply. Never immerse the coffee machine in water.

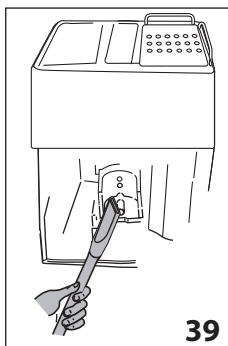

1. Check regularly (about every 100 coffees) that the inside of the appliance (accessible after removing the drip tray, A9) is not dirty. If necessary, remove coffee deposits with the brush (C5) or a sponge.
2. Remove all the residues with a vacuum cleaner (fig. 39).

15.6 Cleaning the water tank

Clean the water tank (A13) about once a month and whenever you replace the water softener filter (C4) (if provided) as follows:

1. Remove the filter.
2. Clean the water tank with a damp cloth and a little light washing up liquid. Rinse with running water.
3. Rinse the filter (if provided) and put back in the water tank. Fill the tank with fresh water and put back in the appliance.
4. (Models with water softener filter only) Deliver about 100 ml of water.

15.7 Cleaning the coffee spouts

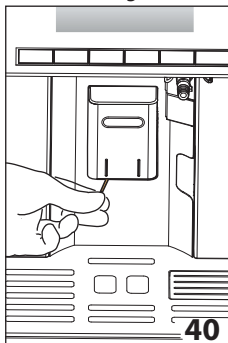

1. Clean the coffee spouts (A7) with a sponge or cloth (fig. 28).
2. Check that the holes in the coffee spouts are not blocked. If necessary, remove coffee deposits using a toothpick (fig. 40).

15.8 Cleaning the pre-ground coffee funnel

Check regularly (about once a month) that the pre-ground coffee funnel (A3) is not blocked. If necessary, remove coffee deposits with the brush (C5).

15.9 Cleaning the infuser

The infuser (A12) must be cleaned at least once a month.



Important!

The infuser may not be extracted when the machine is on.

1. Make sure the machine is correctly turned off (see section "7. Turning off").

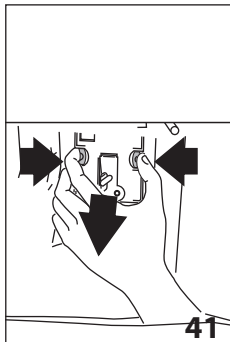

2. Open the service door (A11) (fig. 36).
3. Remove the drip tray (A9) and grounds container (A14) (fig. 37).
4. Press the two coloured release buttons inwards and at the same time pull the infuser (A12) outwards (fig. 41).



Important!

RINSE WITH WATER ONLY

NO WASHING UP LIQUID - NO DISH WASHER

Clean the infuser without using washing up liquid as it could be damaged.

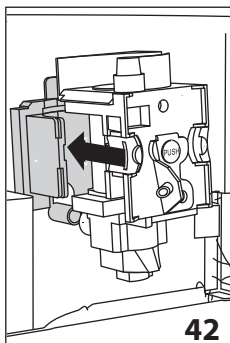

5. Soak the infuser in water for about 5 minutes, then rinse under the tap.
6. After cleaning, replace the infuser by sliding it onto the internal support and pin at the bottom, then push the PUSH symbol fully in until it clicks into place (fig. 42).



Please note!

If you encounter difficulty inserting the infuser, before inserting it you must adapt it to the right dimension by pressing it forcefully from the bottom and top as shown in figure 43.

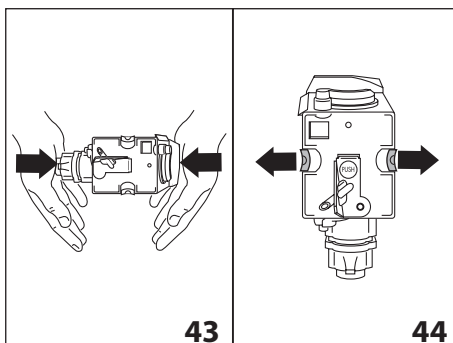

7. Once inserted, make sure the two coloured buttons have snapped out (fig. 44).
8. Replace the drip tray and waste coffee container.
9. Close the service door.

15.10 Cleaning the milk container (D)

Clean the milk container (D) every two days as described below:

1. Lift and remove the lid (D1);
2. Extract the milk container (D6) from the thermal casing (D7), holding it by the two side grips.



Important!

The thermal casing must not be filled with or immersed in water: clean with a damp cloth.

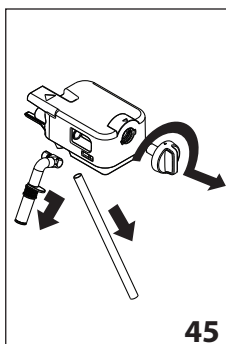

3. Remove the milk spout (D3) and intake tube (D5) (fig. 45).
4. Turn the froth adjustment dial clockwise to the "INSERT" position and pull off.
5. Wash all the components of the frother thoroughly with hot water and light washing-up liquid.

All components and the container are dishwasher safe, placing them in the top basket of the dishwasher.

Make sure there are no milk residues on the hollow and groove under the dial (fig. 46). If necessary, scrape the groove with a toothpick.

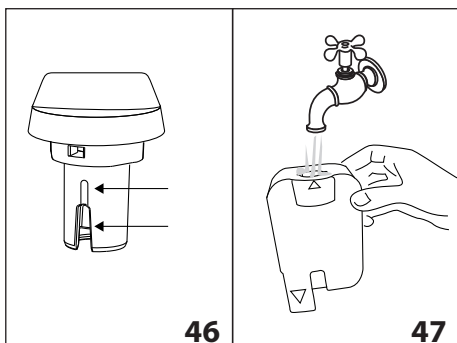

6. Rinse inside the froth adjustment dial seat and the milk frother connector hole (fig. 47).
7. Check that the intake tube and spout are not clogged with milk residues.
8. Replace the dial (lining up the arrow with the word "INSERT"), spout and milk intake tube.
9. Place the milk container in the thermal casing.
10. Place the lid back on the milk container.

15.11 Cleaning the hot water/steam connection nozzle

Each time you prepare milk, clean the connection nozzle (A6) with a sponge to remove milk residues from the gaskets (fig. 28).

16. DESCALING

When the corresponding symbol appears, the appliance must be descaled.



Important!

- Before use, read the instructions and the labelling on the descaler pack.
- You should use De'Longhi descaler only. Using unsuitable descaler and/or performing descaling incorrectly may result in faults not covered by the manufacturer's guarantee.

1. Turn the coffee machine on.
2. Access the settings menu by pressing the **MENU** icon. Scroll through the menu by pressing the **▲** or **▼** icon to select "Descale".
3. Press the **OK** icon to select the function. Press **OK** again to confirm.
4. "ADD DESCALER FILL WATER TANK" appears on the display (B2).
5. Empty the water tank (A13) completely and remove the water softener filter (C4) if present;

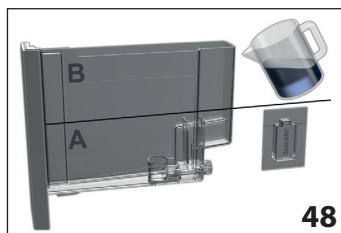

Pour the descaler into the tank up to the level **A** (corresponding to a 100 ml pack) marked on the side of the tank (fig. 48), then add water (1 litre) up to level **B** (fig. 48) and put the water tank back.

Place an empty container with a minimum capacity of 1.4 litres under the hot water/steam spout (C6).



Important! Danger of burns

Hot water containing acid flows out of the hot water/steam spout. Avoid contact with splashes of water.

6. Start descaling by pressing the **OK** icon.
7. The descale programme starts and the descaler liquid comes out of the hot water/steam spout. The descale programme automatically performs a series of rinses and pauses at regular intervals to remove limescale deposits from inside the machine. The cycle lasts about 30 minutes and is indicated by a progress bar which fills and empties.
8. "Rinsing FILL WATER TANK": The appliance is now ready for rinsing through with clean water. Remove the water tank, empty, rinse under running water, fill with clean water and replace.
9. Empty the container used to collect the descaler solution and replace it under the hot water/steam spout.
10. Press the **OK** icon to start rinsing. Hot water comes out of the hot water/steam spout.
11. When "Descaling complete" "PRESS OK" appears on the display, press the **OK** icon. The appliance goes off.
12. Put the water softener filter (if used) back and fill the tank. To use the appliance, press the **☺** button (A20).



Please note!

- If the descaling cycle is not completed correctly (e.g. no electricity) we recommend repeating the cycle.
- After descaling, it is normal for the grounds container (A14) to contain water.

17. SETTING WATER HARDNESS

Descaling is requested after a period of time established according to water hardness. The machine is set by default for a hardness value of 4 (very hard water). The machine can also be programmed according to the hardness of the mains water in the

various regions so that the machine needs to be descaled less often.

17.1 Measuring water hardness

1. Remove the "TOTAL HARDNESS TEST" (C1) indicator paper from its pack.
2. Immerse the paper completely in a glass of water for one second.
3. Remove the paper from the water and shake lightly. After about a minute, 1, 2, 3, or 4 red squares form, depending on the hardness of the water. Each square corresponds to one level.

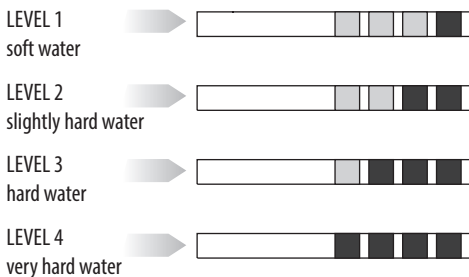

17.2 Setting water hardness

1.  Access the settings menu by pressing the **MENU** icon. Scroll through the menu by pressing the **▲** or **▼** icon to select "Water hardness".
 2. Confirm the selection by pressing the **OK** icon.
 3. Press **▲** or **▼** to set the water hardness identified using the indicator paper (see figure in the previous section).
 4. Press the **OK** icon to confirm the setting.
 5. Press the **ESC** icon to exit the menu.
- The machine is now reprogrammed with the new water hardness setting.

18. WATER SOFTENER FILTER (IF PROVIDED)

Certain models are fitted with a water softener filter (C4). If this is not the case with your model, you are recommended to purchase one from De'Longhi Customer Services. To use the filter correctly, follow the instructions below.

18.1 Installing the filter

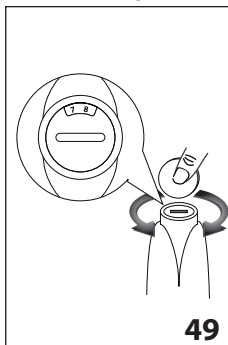

1. Remove the filter (C4) from the packaging.
2. Turn the date indicator disk until the next two months of use are displayed (fig 49)



Please note

The filter lasts about two months if the appliance is used normally. If the coffee machine is left unused with the filter installed, it will last a maximum of three weeks.

3. To activate the filter, run tap water through the hole in the filter as shown in the figure until water comes out of the openings at the side for more than a minute (fig. 50).

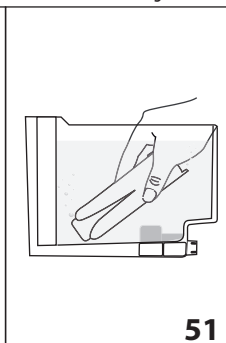
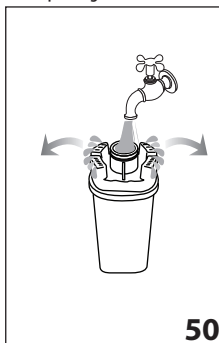

4. Extract the tank (A13) from the appliance and fill with water.
5. Insert the filter upside down in the water tank and immerse it completely for about thirty seconds, to enable the air bubbles to escape (fig. 51).
6. Insert the filter in the filter housing and press as far as it will go (fig. 52).

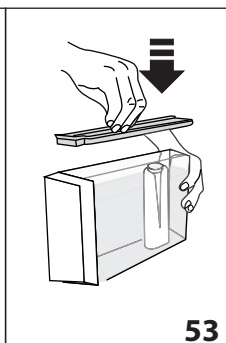
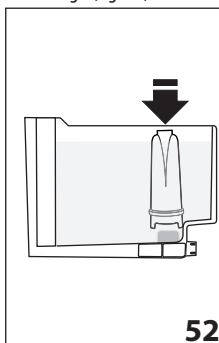

- Close the tank with the lid (fig. 53), then replace the tank in the machine.

When you install the filter, you must notify the appliance of its presence.

- Access the menu by pressing the **MENU** icon;
- Scroll through the menu by pressing the **▲** or **▼** icon until "Install water filter" appears on the display (B2).
- Press the **OK** icon.
- The message "Install water filter CONFIRM?" is displayed.
- Press the **OK** icon to confirm the selection. "INSERT WATER SPOUT PRESS OK" appears on the display.
- Position a container under the hot water/steam spout (C6) (min. capacity: 100ml).
- Press **OK** to confirm. The appliance begins hot water delivery and "Please wait" is displayed.
- After the flow of hot water stops, the appliance automatically resets to "Ready for coffee" status.

The filter is now active and you can use the coffee machine.

18.2 Replacing the filter



When the filter alarm appears on the display (B2), after two months (see date indicator) or if the appliance has not been used for 3 weeks, you should replace the filter (C4):

- Extract the tank (A13) and exhausted filter.
- Take the new filter out of its packet and proceed as illustrated in points 3, 4, 5 and 6 in the previous section.
- Position a container under the hot water/steam spout (C6) (min. capacity: 100ml).
- Access the menu by pressing the **MENU** icon.
- Scroll through the menu by pressing the **▲** or **▼** icon until "Install water filter" appears on the display.
- Press the **OK** icon.
- The message "CONFIRM?" appears on the display.
- Press the **OK** icon to confirm the selection.
- "Water delivery PRESS OK" is displayed.
- Press **OK** to confirm. The appliance begins hot water delivery and "Please wait" is displayed.
- After the flow of hot water stops, the appliance automatically resets to "Ready for coffee" status.

The new filter is now active and you can use the coffee machine.

18.3 Removing the filter

If you want to use the appliance without the filter (C4), you must remove it and notify the appliance of its removal. Proceed as follows:

- Extract the tank (A13) and exhausted filter.
- Replace the tank.
- Access the menu by pressing the **MENU** icon.

- Scroll through the menu by pressing the **▲** or **▼** icon until "Install water filter" appears on the display (B2).
- Press the **OK** icon.
- The message "CONFIRM?" appears on the display;
- Press the **OK** icon to confirm and the **ESC** icon to exit the menu.

19. TECHNICAL DATA

Voltage:	220-240 V~ 50/60 Hz max. 10A
Absorbed power:	1350W
Pressure:	15 bar
Water tank capacity:	1,4 litres
Size: LxHxD:	280x400x425 mm
Max. beans container capacity	250 g
Weight of machine (with drip tray)	13,7 Kg
Water/steam spout:	57g
Milk container:	720g
Hot chocolate carafe:	378g
Power cord length:	1450mm



The appliance complies with the following EC directives:







- European Standby Regulation 1275/2008
- Materials and accessories coming into contact with food conform to EEC regulation 1935/2004.









20. DISPOSAL





The appliance must not be disposed of with household waste, but taken to an authorised waste separation and recycling centre.

21. DISPLAYED MESSAGES

DISPLAYED MESSAGE	POSSIBLE CAUSE	SOLUTION
 FILL WATER TANK	Insufficient water in tank (A13) or tank not inserted correctly.	Fill the tank with water and/or insert it correctly, pushing it as far as it will go until it clicks into place.
 GROUND TOO FINE ADJUST MILL	<p>The grinding is too fine and the coffee is delivered too slowly or not at all.</p> <p>If the water softener filter (C4) is present, an air bubble may have been released inside the circuit, obstructing delivery.</p>	<p>Repeat coffee delivery and turn the grinding adjustment dial (A16) one click clockwise towards "7" while the coffee mill is in operation. If after making at least 2 coffees delivery is still too slow, repeat the correction procedure, turning the grinding adjustment dial another click until delivery is correct. If the problem persists, press OK to deliver water from the spout until it flows out normally.</p> <p>Insert the hot water spout (C6) in the appliance and deliver a little water until the flow becomes regular.</p>
 INSERT WATER SPOUT	The hot water/steam spout (C6) is not inserted or is inserted incorrectly.	Insert water spout as far as it will go.
 EMPTY GROUNDS CONTAINER	The grounds container (A14) is too full or more than 3 days have passed since delivery of the first coffee (this guarantees correct hygiene of the machine).	Empty the grounds container and clean, then replace. Important: when removing the drip tray (A9), the grounds container must be emptied, even if it contains few grounds. If this is not done, when you make the next coffees, the grounds container may fill up more than expected and clog the machine.
 INSERT GROUNDS CONTAINER	After cleaning, the grounds container (A14) has not been replaced.	Open the service door, remove the drip tray (A9) and insert the grounds container.
 ADD PRE-GROUND COFFEE	<p>With the "pre-ground coffee" function selected, pre-ground coffee has not been poured into the funnel (A3).</p> <p>The pre-ground coffee funnel (A3) is blocked.</p>	<p>Place pre-ground coffee in the funnel or deselect the "pre-ground" function.</p> <p>Empty the funnel with the help of the cleaning brush (C5) as described in section "15.8 Cleaning the pre-ground coffee funnel".</p>

 DESCALING	The machine must be descaled.	The descaling procedure described in section "16. Descaling" needs to be performed as soon as possible.
 Replace filter	The water softener filter (C4) is exhausted.	Replace the filter or remove it as described in section "18. Water softener filter (if provided)".
 REDUCE COFFEE AMOUNT	Too much coffee has been used.	Select a lighter taste or reduce the quantity of pre-ground coffee.
 FILL BEANS CONTAINER	The coffee beans have run out.	Fill the beans container (A18).
	The pre-ground coffee funnel (A3) is clogged.	Empty the funnel with the help of a brush (C5) as described in section "15.8 Cleaning the pre-ground coffee funnel".
 INSERT INFUSER ASSEMBLY	The infuser (A12) has not been replaced after cleaning.	Insert the infuser as described in section "15.9 Cleaning the infuser".
 INSERT MILK CONTAINER	The milk container (D) is not inserted correctly.	Insert the milk container as far as it will go.
 TURN DIAL TO CLEAN	Each time you make cappuccino or milk-based coffee, the milk container lid with milk frother (D1) must be cleaned using the CLEAN function.	Turn the froth adjustment dial (D2) to the CLEAN position.
 TURN THE MILK FROTH ADJUSTMENT DIAL	The froth adjustment dial (D2) is not in the correct position.	Turn the froth adjustment dial to one of the froth amount positions.
 CLOSE DOOR	The service door (A11) is open.	Close the service door.



 GENERAL ALARM	The inside of the appliance is very dirty.	Clean the inside of the appliance thoroughly, as described in section "15. Cleaning". If the message is still displayed after cleaning, contact customer services.
 CIRCUIT EMPTY FILL CIRCUIT <i>alternating with</i> WATER DELIVERY PRESS OK	The water circuit is empty.	Press OK to deliver water from the hot water/steam spout (C6) until it flows out normally. If the problem persists, make sure the water tank (A13) is fully inserted.

22. TROUBLESHOOTING

Below is a list of some of the possible malfunctions.

If the problem cannot be resolved as described, contact Customer Services.

PROBLEM	POSSIBLE CAUSE	SOLUTION
The coffee is not hot.	The cups were not preheated.	<ul style="list-style-type: none"> If Energy Saving is not active, leave the cups on the cup warmer for at least 20 minutes for them to warm up. Warm the cups by rinsing them with hot water (using the hot water function).
	The internal circuits of the appliance have cooled down because 2/3 minutes have elapsed since the last coffee was made.	Before making the coffee, heat the infuser by performing a rinse cycle (see the section "Tips for a hotter coffee").
	A low coffee temperature is set.	Set a higher coffee temperature in the menu.
The coffee is not creamy enough.	The coffee is ground too coarsely.	Turn the grinding adjustment dial (A16) one click anticlockwise towards "1" while the coffee mill is in operation (fig. 11). Continue one click at a time until coffee delivery is satisfactory. The effect is only visible after delivering 2 coffees
	Wrong type of coffee.	Use a type of coffee for espresso coffee machines.
The coffee is delivered too slowly or a drop at a time.	The coffee is ground too finely.	Turn the grinding adjustment dial (A16) one click anticlockwise towards "7" while the coffee mill is in operation (fig. 11). Continue one click at a time until coffee delivery is satisfactory. The effect is only visible after delivering 2 coffees
The coffee does not come out of the spouts, but from around the service door	The holes in the spouts are clogged with dry coffee dust.	Clean the coffee spouts (A7) with a toothpick, sponge or hard bristled kitchen brush.
	The coffee guide (A15) inside the service door is blocked and cannot swing.	Thoroughly clean the coffee guide, particularly near the hinges.

The coffee is delivered too quickly.		The coffee is ground too coarsely.	Turn the grinding adjustment dial (A16) one click anticlockwise towards "1" while the coffee mill is in operation (fig. 11). Avoid turning the grinding adjustment dial excessively otherwise when you select two cups, the coffee may be delivered a drop at a time
Coffee does not come out of one or both of the spouts.		The coffee spouts (A7) are blocked.	Clean the spouts with a toothpick
Water comes out of the spouts instead of coffee.		The pre-ground coffee may be blocked in the funnel (A3).	Empty the funnel with the help of the brush as described in the section "Cleaning the pre-ground coffee funnel"
The appliance does not come on		The appliance is not plugged into the mains socket.	Plug into the mains socket.
		The main switch (A19) is not turned on.	Place the main switch in the I position (fig. 1).
		The  button (A20) has not been pressed sufficiently.	Hold the button down for a few seconds.
Energy Saving is enabled, but the cup warmer (A4) is hot		A number of drinks have been prepared in rapid succession.	
	The milk does not come out of the milk spout (D3)	The milk container lid (D1) is dirty	Clean the milk container lid as described in section "15.10 Cleaning the milk container (D)".
	The milk contains large bubbles and squirts out of the milk spout (D3) or there is little froth	The milk is not cold enough or is not semi-skimmed.	Use skimmed or semi-skimmed milk at refrigerator temperature (about 5° C). If the result is not as you wished, try changing brand of milk.
		The froth adjustment dial (D2) is incorrectly adjusted.	Adjust according to the instructions in section "10.2 Adjusting the amount of froth".
		The milk container lid (D1) or froth adjustment dial (D2) are dirty.	Clean the milk container lid and dial as described in section "15.10 Cleaning the milk container (D)".
		The hot water/steam connection nozzle (A6) is dirty.	Clean the connection nozzle as described in section "15.11 Cleaning the hot water/steam connection nozzle".
	The hot water/steam spout (C6) is dirty.	Clean as described in section "13.5 Cleaning the hot water/steam spout after use".	
	The milk is not cold enough or is not semi-skimmed.	You should ideally use skimmed or semi-skimmed milk at refrigerator temperature (about 5°C). If the result is not as you wished, try changing brand of milk.	
	The steam connection nozzle has not been inserted after cleaning.	Replace all the spout components correctly.	

The LONG coffee has too much froth	The coffee is ground too finely.	Turn the grinding adjustment dial (A16) one click anticlockwise towards "7" while the coffee mill is in operation (fig. 11). Continue one click at a time until coffee delivery is satisfactory. The effect is only visible after delivering 2 coffees.
---	----------------------------------	---

23. ELECTRICAL CONNECTION (UK ONLY)

Before using this appliance ensure that the voltage indicated on the product corresponds with the main voltage in your home, if you are in any doubt about your supply contact your local electricity company.

The flexible mains lead is supplied connected to a B.S. 1363 fused plug having a fuse of 13 amp capacity.

Should this plug not fit the socket outlets in your home, it should be cut off and replaced with a suitable plug, following the procedure outlined below.

Note: Such a plug cannot be used for any other appliance and should therefore be properly disposed of and not left where children might find it and plug it into a supply socket - with the obvious consequent danger.

Please note: We recommend the use of good quality plugs and wall sockets that can be switched off when the machine is not in use.

IMPORTANT: The wires in the mains lead fitted to this appliance are coloured in accordance with the following code:

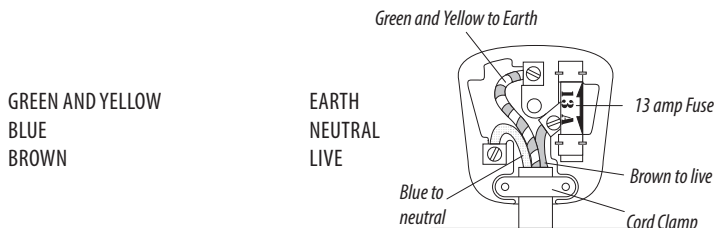

As the colours of the wires in the mains lead of this appliance may not correspond with the coloured markings identifying the terminals in your plug, proceed as follows:

- The wire which is coloured green and yellow must be connected to the terminal in the plug which is marked with the letter E or by the earth symbol  or coloured green or green and yellow.
- The wire which is coloured blue must be connected to the terminal which is marked with the letter N or coloured black.
- The wire which is coloured brown must be connected to the terminal which is marked with the letter L or coloured red.

When wiring the plug, ensure that all strands of wire are securely retained in each terminal. Do not forget to tighten the mains lead clamp on the plug. If your electricity supply point has only two pin socket outlets, or if you are in doubt, consult a qualified electrician. Should the mains lead ever require replacement, it is essential that this operation be carried out by a qualified electrician and should only be replaced with a flexible cord of the same size.

After replacement of a fuse in the plug, the fuse cover must be refitted. If the fuse cover is lost, the plug must not be used until a replacement cover is obtained. The colour of the correct replacement fuse cover is that of the coloured insert in the base of the fuse recess or elsewhere on the plug. Always state this colour when ordering a replacement fuse cover.

Only 13amp replacement fuses which are asta approved to B.S. 1362 should be fitted.

This appliance conforms to the Norms EN 55014 regarding the suppression of radio interference.

Warning - this appliance must be earthed