



---

ESAM56XY - 57XY

BEAN TO CUP ESPRESSO AND  
CAPPUCCINO MACHINE  
Instruction for Use



---

**De'Longhi**

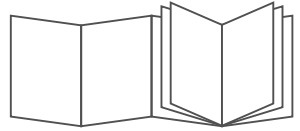

**B**

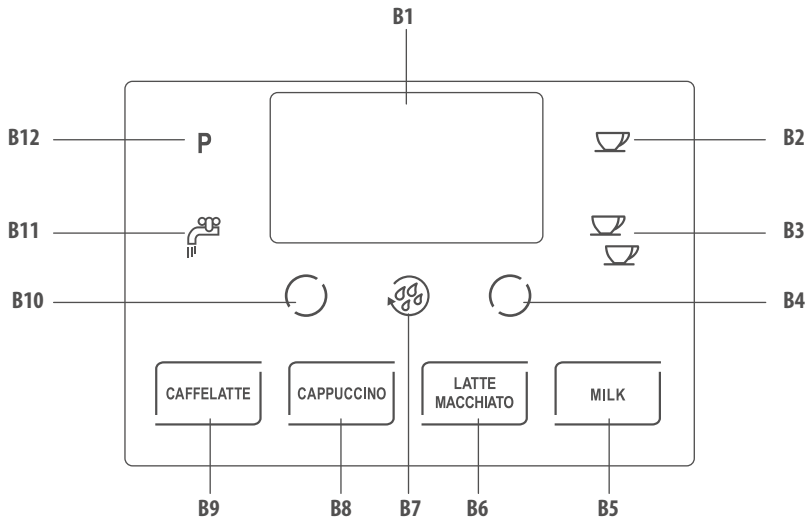

**C**

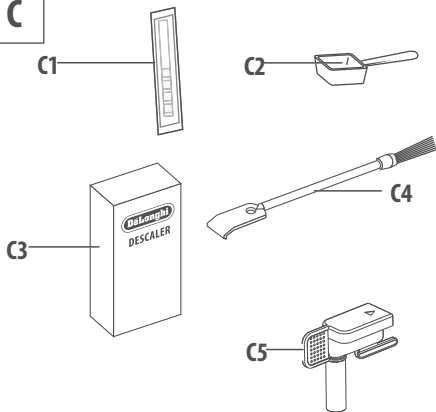

**D**

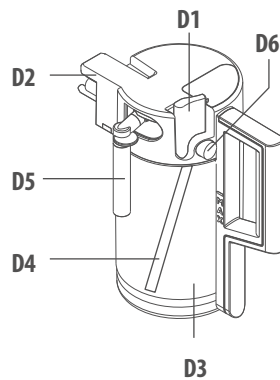

**A**

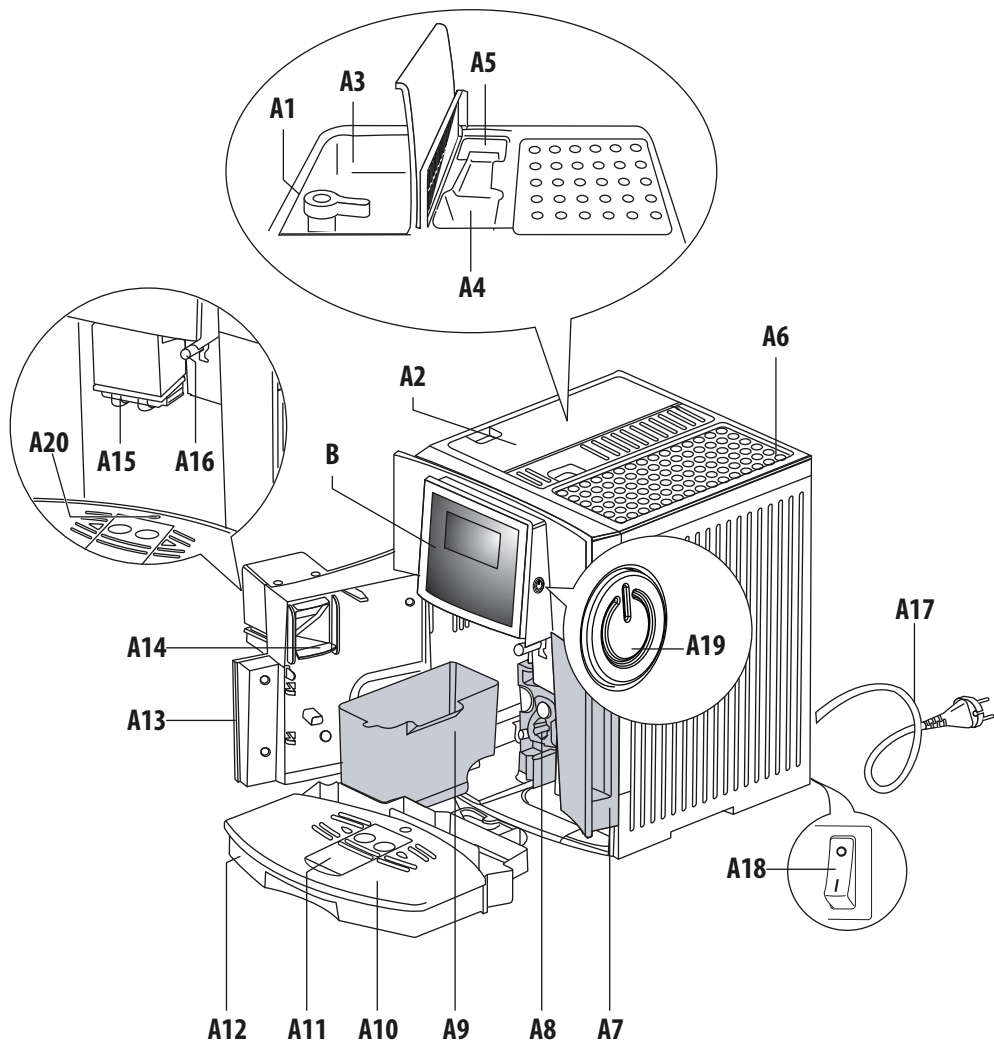

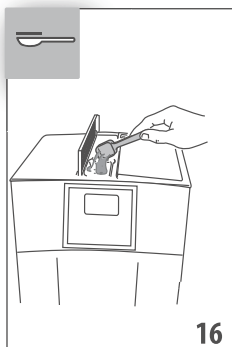
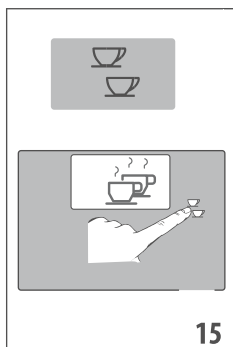
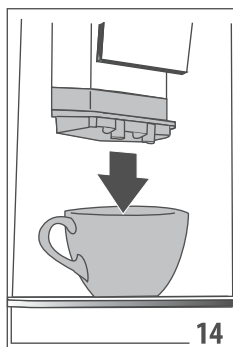
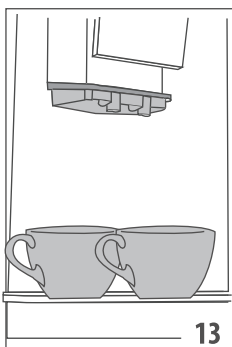
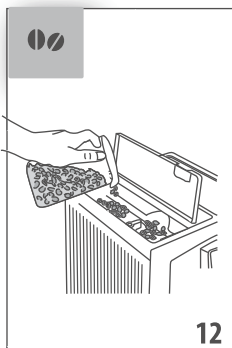
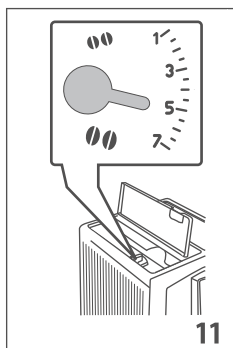
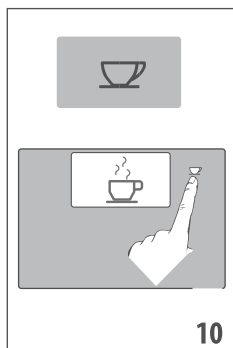
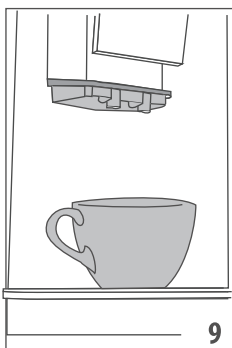
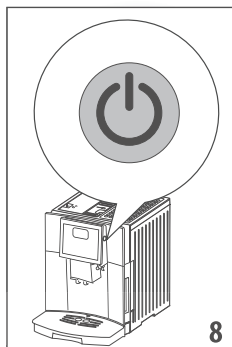
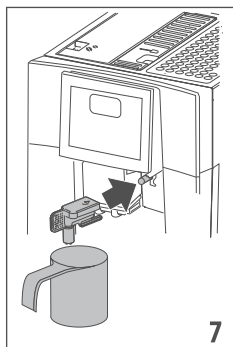
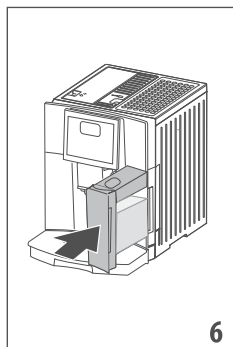
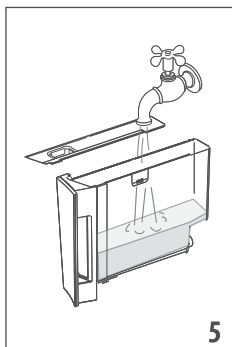
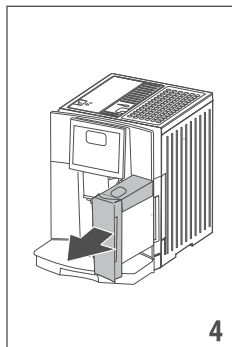
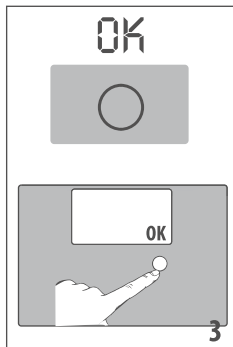
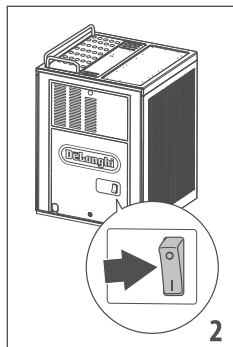
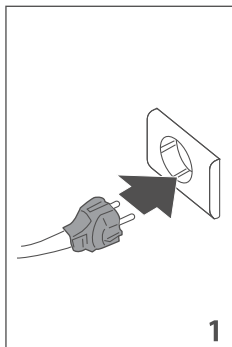

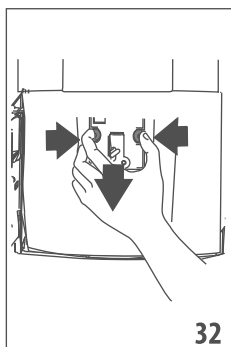
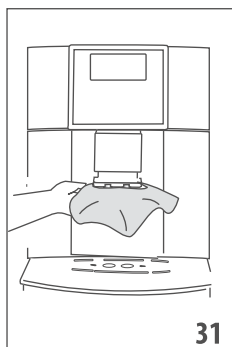
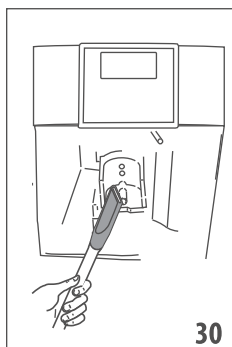
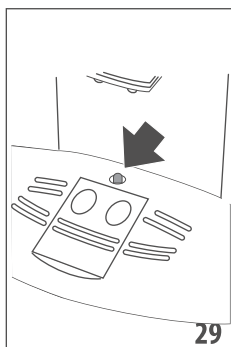
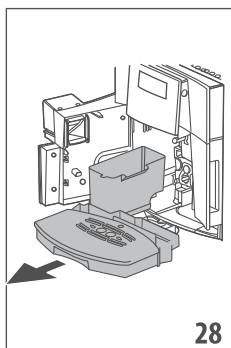
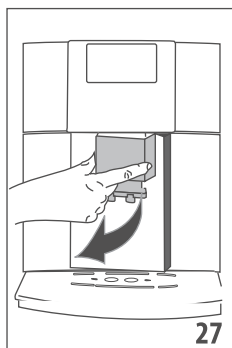
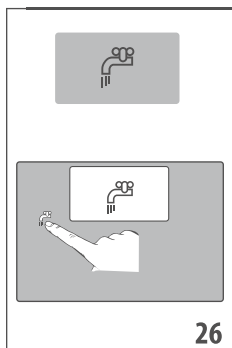
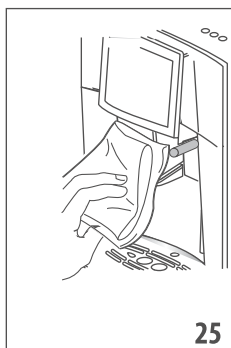
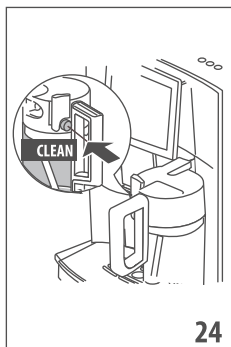
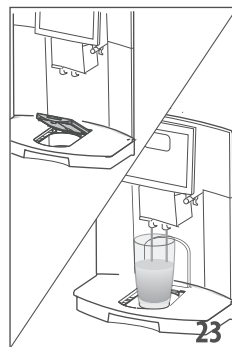
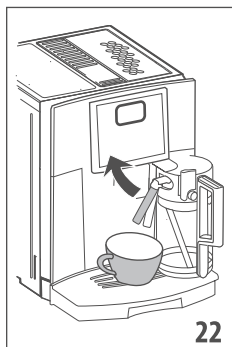
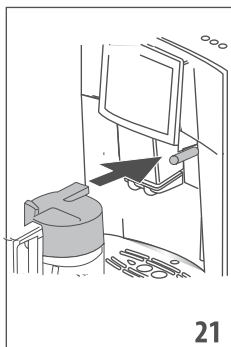
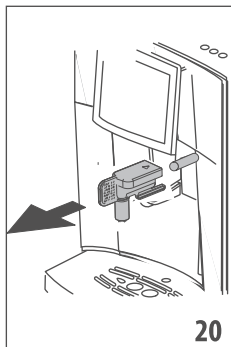
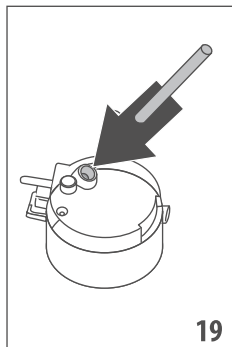
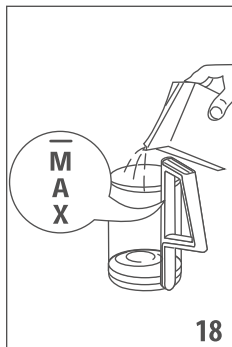
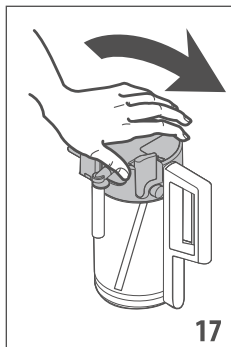

## CONTENTS

<b>1. FUNDAMENTAL SAFETY WARNINGS.....</b>	<b>7</b>
<b>2. SAFETY WARNINGS .....</b>	<b>8</b>
2.1 Symbols used in these instructions .....	8
2.2 Designated use.....	8
2.3 Instruction for use .....	8
<b>3. INTRODUCTION.....</b>	<b>8</b>
3.1 Letters in brackets .....	8
3.2 Troubleshooting and repairs.....	8
<b>4. DESCRIPTION.....</b>	<b>9</b>
4.1 Description of the appliance.....	9
4.2 Description of the touch screen .....	9
4.3 Meaning of animations .....	9
4.4 Description of the accessories.....	9
4.5 Description of the milk container .....	9
<b>5. BEFORE USE.....</b>	<b>10</b>
5.1 Checking the appliance .....	10
5.2 Installing the appliance.....	10
5.3 Connecting the appliance.....	10
5.4 Setting up the appliance .....	10
<b>6. TURNING THE APPLIANCE ON.....</b>	<b>10</b>
<b>7. TURNING THE APPLIANCE OFF .....</b>	<b>11</b>
<b>8. MENU SETTINGS .....</b>	<b>11</b>
8.1 Setting the language .....	11
8.2 Energy saving.....	11
8.3 Coffee temperature .....	11
8.4 Setting water hardness .....	12
8.5 Setting display contrast.....	12
8.6 Beep.....	12
8.7 Default values (reset) .....	12
8.8 Descaling .....	12
8.9 Statistics function.....	12
8.10 Adjust time .....	12
8.11 Auto-start .....	12
8.12 Auto-off (standby) .....	13
<b>9. RINSING.....</b>	<b>13</b>
<b>10. MAKING COFFEE.....</b>	<b>13</b>
10.1 Selecting the coffee taste.....	13
10.2 Selecting the quantity of coffee in the cup .....	13
10.3 Customising the “my coffee” quantity.....	14
10.4 Adjusting the coffee mill .....	14
10.5 Tips for a hotter coffee.....	14
10.6 Making coffee using coffee beans .....	14
10.7 Making coffee using pre-ground coffee.....	14
<b>11. MAKING CAPPUCCINOS AND MILK BASED COFFEES .....</b>	<b>15</b>
11.1 Filling and attaching the milk container.....	15
11.2 Adjusting the amount of froth.....	15
11.3 Making cappuccino and milk based coffees automatically .....	15
11.4 Cleaning the milk container after every use .....	16
11.5 Programming the quantity of coffee and milk in the cup for the CAFFELATTE, CAPPUCCINO, MACCHIATO and MILK icons .....	16
<b>12. DELIVERING HOT WATER .....</b>	<b>16</b>
12.1 Changing the quantity of water delivered automatically .....	16
<b>13. CLEANING.....</b>	<b>16</b>
13.1 Cleaning the machine .....	16
13.2 Cleaning the machine's internal circuit.....	17
13.3 Cleaning the coffee grounds container.....	17
13.4 Cleaning the drip tray and condensate tray.....	17
13.5 Cleaning the inside of the coffee machine.....	17
13.6 Cleaning the water tank .....	17
13.7 Cleaning the coffee spouts .....	17
13.8 Cleaning the pre-ground coffee funnel .....	17
13.9 Cleaning the infuser .....	18
13.10 Cleaning the milk container .....	18
13.11 Cleaning the hot water/steam connection nozzle.....	19
13.12 Cleaning the touch screen .....	19
<b>14. DESCALING.....</b>	<b>19</b>
<b>15. SETTING WATER HARDNESS .....</b>	<b>19</b>
15.1 Measuring water hardness .....	19
15.2 Setting water hardness .....	20
<b>16. TECHNICAL DATA.....</b>	<b>20</b>
<b>17. DISPOSAL.....</b>	<b>20</b>
<b>18. DISPLAYED MESSAGES.....</b>	<b>21</b>
<b>19. TROUBLESHOOTING .....</b>	<b>23</b>
<b>20. ELECTRICAL CONNECTION (UK ONLY) .....</b>	<b>25</b>

## 1. FUNDAMENTAL SAFETY WARNINGS

---

- The appliance is not intended for use by persons (including children) with reduced physical, sensory or mental capabilities, or lack of experience and knowledge, unless they have been given supervision or instruction concerning use of the appliance by a person responsible for their safety.
- Children should be supervised to ensure that they do not play with the appliance.
- Cleaning and user maintenance shall not be made by children without supervision.
- Never clean by immersing the appliance in water.
- This is an household appliance only.  
It is not intended to be used in: staff kitchen areas in shops, offices and other working environments; farm houses, hotels, motels and other residential type environments; bed and breakfast type environments.
- If the plug or cord is damaged, it must be replaced by Customer Services only to avoid all risk.

### FOR EUROPEAN MARKETS ONLY:

- This appliance can be used by children aged from 8 years and above if they have been given supervision or instruction concerning use of the appliance in a safe way and understand the hazards involved.  
Cleaning and user maintenance shall not be made by children unless they are above 8 years old and supervised. Keep the appliance and power cord away from children under eight years of age.
- Appliances can be used by persons with reduced physical, sensory or mental capabilities or lack of experience and knowledge if they are supervised or have been given instruction concerning use of the appliance in a safe way and if they understand the hazards involved.
- Children shall not play with the appliance.
- Always unplug the appliance when left unattended and before assembly, taking apart or cleaning.



Surfaces marked with this symbol become hot during use (the symbol is present in certain models only).



## 2. SAFETY WARNINGS

### 2.1 Symbols used in these instructions

Important warnings are identified by these symbols.

It is vital to respect these warnings.



#### **Danger!**

Failure to observe the warning may result in life threatening injury by electric shock.



#### **Important!**

Failure to observe the warning could result in injury or damage to the appliance.



#### **Danger of burns!**

Failure to observe the warning could result in scalds or burns.



#### **Please note:**

This symbol identifies important advice or information for the user.



#### **Danger!**

This is an electrical appliance and may cause electric shock.

You should therefore follow these safety warnings:

- Never touch the appliance with damp hands or feet.
- Never touch the plug with damp hands.
- Make sure the socket used is freely accessible at all times, enabling the appliance to be unplugged when necessary.
- Unplug directly from the plug only.  
Never pull the cord as you could damage it.
- To disconnect the appliance completely you must unplug it from the mains socket.
- If the appliance is faulty, do not attempt to repair.  
Turn it off, unplug from the mains socket and contact Customer Services.
- Before cleaning the appliance, turn it off, unplug from the mains socket and allow to cool.



#### **Important:**

Keep all packaging (plastic bags, polystyrene foam) away from children.



#### **Danger of burns!**

This appliance produces hot water and steam may form while it is in operation.

Avoid contact with splashes of water or hot steam.

When the appliance is in operation, the cup shelf could become very hot.

### 2.2 Designated use

This appliance is designed and made to prepare coffee and heat drinks.

Any other use is considered improper and thus dangerous.

The manufacturer is not liable for damage deriving from improper use of the appliance.

### 2.3 Instruction for use

Read this Instruction for use carefully before using the appliance.

Failure to follow this Instruction for use may result in burns or damage to the appliance.

The manufacturer is not liable for damage deriving from failure to respect this Instruction for use.



#### **Please note:**

Keep this Instruction for use.

If the appliance is passed to other persons, they must also be provided with this Instruction for use.

## 3. INTRODUCTION

Thank you for choosing this bean to cup espresso and cappuccino machine.

We hope you enjoy using your new appliance.

Take a few minutes to read this Instruction for use.

This will avoid all risks and damage to the appliance.

### 3.1 Letters in brackets

The letters in brackets refer to the legend in the description of the appliance on pages 2-3.

### 3.2 Troubleshooting and repairs

In the event of problems, first try and resolve them following the information given in sections "18. Displayed messages" and "19. Troubleshooting".

If this does not resolve the problem or you require further information, you should consult Customer Services by calling the number given on the annexed "Customer Service" sheet.

If your country is not among those listed on the sheet, call the number given in the guarantee.

If repairs are required, contact De'Longhi Customer Services only.

The addresses are given in the guarantee certificate provided with the machine.

## 4. DESCRIPTION

### 4.1 Description of the appliance





(page 3 - A)

- A1. Grinding adjustment dial
- A2. Beans container lid
- A3. Beans container
- A4. Pre-ground coffee funnel
- A5. Measure compartment
- A6. Cup shelf (cup warmer when Energy Saving is disabled)
- A7. Water tank
- A8. Infuser
- A9. Coffee grounds container
- A10. Cup tray
- A11. Compartment for macchiato/milk glass
- A12. Drip tray
- A13. Service door
- A14. Coffee guide
- A15. Coffee spouts (adjustable height)
- A16. Hot water/steam connection nozzle
- A17. Power cord
- A18. Main switch
- A19. ON/STANDBY button
- A20. Drip tray water level indicator

### 4.2 Description of the touch screen

(page 2 - B)

*Only the icons relating to the controls enabled for the particular function currently being used will be lit on the touch screen.*

- B1. Display: guides the user in using the appliance.
- B2.  icon to deliver one cup of coffee.
- B3.  icon to deliver two cups of coffee.
- B4. Coffee taste selection icon.  
(When in the settings MENU, it changes function according to the text shown above the icon).
- B5. **MILK** icon: to deliver a cup of milk.
- B6. **MACCHIATO** icon: to deliver a cup of macchiato.
- B7.  icon to perform a manual rinse.  
(When in the settings MENU, it changes function according to the text shown above the icon).
- B8. **CAPPUCCINO** icon: to deliver a cappuccino.
- B9. **CAFFELATTE** icon: to deliver a caffelatte.
- B10. Selection icon to choose the coffee quantity.  
(When in the settings MENU, it changes function according to the text shown above the icon).
- B11.  icon: to enable the hot water function.
- B12.  icon: to access or exit the settings menu.



#### **Please note:**

A light touch is enough to activate the icons.

### 4.3 Meaning of animations

Below is an explanation of the animations describing the operation the appliance is currently performing:



RINSING



HEATING UP



(see section: "Displayed messages")



PLEASE WAIT



FILL TANK



HOT WATER

### 4.4 Description of the accessories

(page 2 - C)

- C1. "Total Hardness Test" indicator paper
- C2. Pre-ground coffee measure
- C3. Descaler
- C4. Cleaning brush
- C5. Cappuccino maker/hot water spout

### 4.5 Description of the milk container

(page 2 - D)

- D1. Froth regulator
- D2. Milk container lid
- D3. Milk container
- D4. Milk intake tube
- D5. Frothed milk spout
- D6. CLEAN button

## 5. BEFORE USE

### 5.1 Checking the appliance

After removing the packaging, make sure the product is complete and undamaged and that all accessories are present. Do not use the appliance if it is visibly damaged. Contact De'Longhi Customer Services.

### 5.2 Installing the appliance



#### **Important!**

When you install the appliance, you should respect the following safety warnings:

- The appliance gives off heat.  
After positioning the appliance on the worktop, leave a space of at least 3 cm between the surfaces of the appliance and the side and rear walls and at least 15 cm above the coffee maker.
- Water penetrating the coffee maker could cause damage. Do not place the appliance near taps or sinks.
- The appliance could be damaged if the water it contains freezes.  
Do not install the appliance in a room where the temperature could drop below freezing point.
- Arrange the power cord (A17) in such a way that it cannot be damaged by sharp edges or contact with hot surfaces (e.g. electric hot plates).

### 5.3 Connecting the appliance



#### **Important!**

Check that the mains power supply voltage corresponds to that indicated on the rating plate on the bottom of the appliance. Connect the appliance to an efficiently earthed and correctly installed socket with a minimum current rating of 10A only. If the power socket does not match the plug on the appliance, have the socket replaced with a suitable type by a qualified electrician.

### 5.4 Setting up the appliance



#### **Please note!**

- Coffee has been used to factory test the appliance and it is therefore completely normal for there to be traces of coffee in the mill.  
The machine is, however, guaranteed to be new.
  - You should customise water hardness as soon as possible following the instructions in section "15. Setting water hardness".
1. Connect the appliance to the mains electricity supply (fig. 1) and make sure the main switch (A18) at the back of the appliance is pressed down (fig. 2).

You must first choose the language by waiting until the languages scroll through on the display (B1) automatically at intervals of about 3 seconds:

2. When English appears, press the selection icon (B4) corresponding to **OK** on the display (fig. 3) for a few seconds until the message "English set" is displayed.

Follow the instructions indicated on the appliance display:

3. "FILL TANK": remove the water tank (A7) (fig. 4), open the lid, fill to the MAX line with fresh water (fig. 5), close the lid and put the tank back in the appliance (fig. 6);
4. "INSERT WATER SPOUT": Check that the hot water spout (C5) is inserted on the connection nozzle (A16) and place a container (fig. 7) with a minimum capacity of 100 ml underneath.
5. "HOT WATER Press OK" is displayed;
6. Press the selection icon corresponding to **OK** to confirm (fig. 3). The appliance delivers water from the spout and then goes off automatically.

The coffee machine is now ready for normal use.



#### **Please note!**

- When setting up the appliance, you need to make 4-5 cups of coffee or 4-5 cappuccinos before the appliance starts to give satisfactory results.
- When making the first 5-6 cappuccinos, it is normal to hear the noise of boiling water. After this, the noise becomes less.

## 6. TURNING THE APPLIANCE ON



#### **Please note!**

Before turning the appliance on, make sure the main switch (A18) is pressed (fig. 2).

Each time the appliance is turned on, it performs an automatic preheat and rinse cycle which cannot be interrupted.

The appliance is ready for use only after completion of this cycle.



#### **Danger of burns!**

During rinsing, a little hot water comes out of the coffee spouts (A15) and is collected in the drip tray (A12).

Avoid contact with splashes of water.

- To turn the appliance on, press the  button (A19) (fig. 8). The message "Heating up, Please wait" appears on the display (B1).

When heating is complete, the message changes to "Rinsing". As well as heating the boiler, this also heats the internal circuits by circulating hot water.

The appliance is at temperature when the message indicating the taste and quantity of coffee appears.

## 7. TURNING THE APPLIANCE OFF

Whenever the coffee machine is turned off after being used to make coffee, it performs an automatic rinse cycle.



### **Danger of burns!**

During rinsing, a little hot water flows from the coffee spouts (A15).

Avoid contact with splashes of water.

- To turn the appliance off, press the  button (A19) (fig. 8).
- The message “Turning off, Please wait” appears on the display (B1), then the appliance performs a rinse cycle and goes off (standby).



### **Please note!**

If you will not be using the appliance for some time, unplug from the mains socket:

- first turn the appliance off by pressing the  button;
- release the main switch (A18) at the back of the appliance (fig. 2).



### **Important!**

Never press the main switch while the appliance is on.

## 8. MENU SETTINGS

The settings menu is divided into 3 sections indicated by different icons. Each section is divided into groups as described below:

### SETTINGS

- Language
- Energy saving
- Coffee temperature
- Water hardness
- Display contrast
- Beep
- Default values

### MAINTENANCE

- Descaling
- Statistics

### CLOCK

- Adjust time
- Auto-start
- Auto-off (standby)

To access the required section, press the **P** icon (B12) and use the selection icons (B4 and B10) to scroll until the image you want appears on the display (B1). Then press the  icon (B7) to confirm (or the **P** icon again to exit).





### **Please note!**

When navigating in the settings menu and you want to exit, press the **P** icon repeatedly.

### 8.1 Setting the language

To modify the language on the display (B1), proceed as follows:

1. Choose the “SETTINGS” section as described above;
2. Press the selection icons (B4 and B10) until “Language” appears on the display;
3. Press the  icon (B7) to confirm;
4. Press the selection icons until the required language is displayed;
5. Press the  icon to confirm.

The language is set. Press the **P** icon (B12) repeatedly to exit the menu.

### 8.2 Energy saving

Use this function to enable or disable energy saving.

When enabled, the function reduces energy consumption in compliance with European regulations.

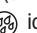
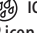
1. Choose the “SETTINGS” section as described above;
2. Press the selection icons (B4 and B10) until “Energy saving” appears on the display (B1);
3. Press the  icon (B7) to confirm. “Disable?” appears on the display (or “Enable?” if the function has been disabled);
4. Press the  icon to disable or enable the function;
5. Press the **P** icon (B12) repeatedly to exit the menu.



When the function is enabled, if the machine is not used for some time, “Energy saving” is displayed.

### **Please note!**

- When in energy saving mode, a few seconds elapse before the first coffee, cappuccino or milk based coffee is delivered as the appliance must heat up again.
- If the milk container (D) is inserted, the energy saving function cannot be enabled.
- When “Energy Saving” is disabled, the appliance turns the cup warmer on automatically.

### 8.3 Coffee temperature

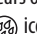
To modify the temperature of the water used to make the coffee, proceed as follows:



1. Choose the “SETTINGS” section as described above;
2. Press the selection icons (B4 and B10) until “Coffee temperature” appears on the display (B1);
3. Press the  icon (B7) to confirm;
4. Press the selection icons until the required temperature (● = low; ●●●● = high) is displayed;
5. Press the  icon to confirm;
6. Press the **P** icon (B12) repeatedly to exit the menu.

## 8.4 Setting water hardness

For instructions on setting water hardness, see section "15. Setting water hardness".

## 8.5 Setting display contrast



To increase or reduce the contrast of the display (B1), proceed as follows:

1. Choose the "SETTINGS" section as described above;
2. Press the selection icons (B4 and B10) until "Display contrast" appears on the display;
3. Press the  icon (B7) to confirm;
4. Press the selection icons until the required display contrast is reached. The progress bar indicates the level of contrast selected;
5. Then press the  icon to confirm or the **P** icon (B12) to exit the menu;
6. Press the **P** icon repeatedly to exit the menu.

## 8.6 Beep



This enables or disables the beep emitted by the machine each time an icon is pressed or an accessory is inserted/removed.

To disable or re-enable the beep, proceed as follows:

1. Choose the "SETTINGS" section as described above;
2. Press the selection icons (B4 and B10) until "Beep" appears on the display;
3. Press the  icon (B7) to confirm. "Disable?" appears on the display (B1) (or "Enable?" if the function has been disabled);
4. Press the  icon to confirm and enable or disable the function;
5. Press the **P** icon (B12) repeatedly to exit the menu.

## 8.7 Default values (reset)

This resets all menu settings and programmed quantities back to the default values (with the exception of the language which remains as set).

1. Choose the "SETTINGS" section as described above;
2. Press the selection icons (B4 and B10) until "Default values" appears on the display (B1);
3. Press the  icon (B7) to confirm. "OK to confirm" is displayed;
4. Press the  icon to return to the original settings (or the **P** icon to cancel the operation).

The appliance is automatically ready for use again with the default settings.



## 8.8 Descaling

For instructions on descaling, see section "14. Descaling".

## 8.9 Statistics function



This displays statistics relating to the machine.

To display, proceed as follows:

1. Choose the "MAINTENANCE" section as described above;
2. Press the selection icons (B4 and B10) until "Statistics" appears on the display B1);
3. Press the  icon (B7) to confirm;
4. Press the selection icons to verify:
  - how many coffees have been made;
  - the total number of cappuccinos and milk based coffees;
  - how many times the machine has been descaled;
  - the total number of litres of water delivered;
5. Press the  icon to confirm or the **P** icon (B12) to exit the menu.

## 8.10 Adjust time

To adjust the time on the display (B1), proceed as follows:

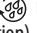
1. Choose the "CLOCK" section as described above;
2. Press the selection icons (B4 and B10) until "Adjust time" appears on the display (B1);
3. Press the  icon (B7) to confirm. The hours flash on the display;
4. Press the selection icons to modify the hours;
5. Press the  icon to confirm. The minutes flash on the display;
6. Press the selection icons to modify the minutes;
7. Press the  icon to confirm (or the **P** icon (B12) to cancel the operation).



The time has been set. Press the **P** icon repeatedly to exit the menu.



## 8.11 Auto-start

You can set the auto-start time in order to have the appliance ready at a certain time (for example in the morning) so you can make coffee immediately.

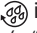

### Please note!

To enable this function, **the time must already be set correctly** (adjust time).

1. Choose the "CLOCK" section as described above.
2. Press the selection icons (B4 and B10) until "Auto-start" appears on the display (B1).
3. Press the  icon (B7) to confirm. "Disable?" appears on the display (or "Enable?" if the function has been disabled);
4. Press the  icon to confirm. The hours flash on the display;

- Press the selection icons to modify the hours;
- Press the  icon to confirm. The minutes flash on the display;
- Press the selection icons to modify the minutes;
- Press the  icon to confirm. "Auto-start activated" appears on the display;
- Press the **P** icon (B12) repeatedly to exit the menu. Once the time has been confirmed, activation of auto-start is indicated by the  symbol displayed alongside the time.

To disable the function:



- Choose the "Clock" section as described above;
- Press the selection icons until "Auto-start" is displayed;
- Press the  icon to confirm. "Disable?" is displayed;
- Press the  icon to confirm. This disables the function and the symbol  disappears from the display;
- Press the **P** icon repeatedly to exit the menu.

To change the auto-start time when the function is already enabled:

- Choose the "CLOCK" section as described above;
- Press the selection icons until "Auto-start" is displayed;
- Press the  icon to confirm. "Disable?" is displayed;
- Press the selection icons until "Adjust time" is displayed;
- Adjust the time as described above.

## 8.12 Auto-off (standby)

Auto-off can be set so that the appliance goes off after 15 or 30 minutes, or 1, 2 or 3 hours.

- Choose the "CLOCK" section as described above;
- Press the selection icons (B4 and B10) until "Auto-off" appears on the display (B1);
- Press the icon  (B7) to confirm;
- Press the selection icons until the required number of hours operation (15 or 30 minutes or 1, 2 or 3 hours) is displayed;
- Press the  icon to confirm (or the **P** icon (B12) to cancel the operation).

The time has been set. Press the **P** icon repeatedly to exit the menu.

## 9. RINSING

Use this function to deliver hot water from the coffee spouts (A15) to clean and heat the appliance's internal circuit.

Place a container with a minimum capacity of 100 ml under the coffee spouts (fig. 7).

### **Important! Danger of burns!**

Do not leave the appliance unattended while hot water is being delivered.

- To enable this function, press the  icon (B7) "Rinsing" is displayed;
- After a few seconds, hot water is delivered from the coffee spouts, cleaning and heating the appliance's internal circuit;
- To stop the process press any icon or wait for delivery of water to stop automatically.

### **Please note!**

- If the appliance is not used for more than 3-4 days, we strongly recommend, when switching on the appliance, performing 2/3 rinses before using it.

## 10. MAKING COFFEE

### 10.1 Selecting the coffee taste

The appliance is set by default to make coffee with a standard taste.

To change the taste, press the selection icon (B4) repeatedly until the "taste" bar has filled as follows:







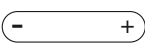

The bar fills up progressively each time you press the selection icon.

### 10.2 Selecting the quantity of coffee in the cup

The appliance is set by default to make a standard quantity of coffee.

To choose the quantity of coffee, press the selection icon (B10) repeatedly until the "quantity" bar has filled as follows:

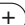



"Quantity" bar	Coffee selected	Quantity (ml)
	MY COFFEE	Programme From ≈ 20 to ≈ 180
	EXTRA SHORT COFFEE	≈ 30
	SHORT COFFEE	≈ 40
	STANDARD COFFEE	≈ 60

 	LONG COFFEE	≈ 90
 	EXTRA-LONG COFFEE	≈ 120

### 10.3 Customising the “my coffee” quantity

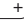
The appliance is set by default to automatically deliver 30 ml of “MY COFFEE”.

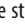
To modify this quantity, proceed as follows:

1. Place a cup under the coffee spouts (A15) (fig. 9)
2. Press the selection icon (B10) repeatedly until the bar on the display (B1) corresponds to   “MY COFFEE”;
3. Press and hold the  icon (B2) (fig. 10) until “MY COFFEE Program Quantity” and the  symbol are displayed, then release. The machine starts delivering the coffee and the  icon flashes;
4. As soon as the coffee in the cup reaches the required level, press the  icon again.

The quantity of coffee in the cup has now been programmed.

### 10.4 Adjusting the coffee mill

The coffee mill is set by default to prepare coffee correctly and should not require regulating initially.

However, if after making the first few coffees you find that the coffee is either too weak and not creamy enough or delivery is too slow (a drop at a time), this can be corrected by adjusting the grinding adjustment dial (A1) (fig. 11).

#### Please note!

The grinding adjustment dial must only be turned when the coffee mill is in operation.

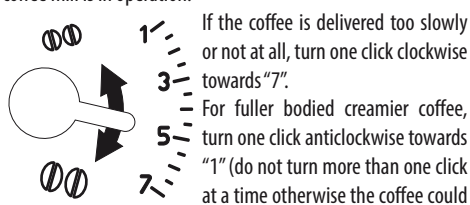

be delivered a drop at a time).

These adjustments will only be evident after at least 2 cups of coffee have been delivered.

If this adjustment does not obtain the desired result, turn the dial another click.

### 10.5 Tips for a hotter coffee

For hotter coffee, you should:



- perform a rinse cycle (see section “9. Rinsing”);
- if “Energy Saving” is disabled, place the cups on the cup warmer (A6) until they are warm;

- warm the cups with hot water (using the hot water function);
- set a hotter coffee temperature in the settings menu (see section “8.3 Coffee temperature”).



### 10.6 Making coffee using coffee beans

#### Important!

Do not use caramelised or candied coffee beans as they could stick to the coffee mill and make it unusable.

1. Fill the container (A3) (fig. 12) with coffee beans;
2. Place under the coffee spouts (A15):
  - 1 cup, if you want to make 1 coffee (fig. 9);
  - 2 cups, if you want 2 coffees (fig. 13).
3. Lower the spouts as near as possible to the cup (fig. 14). This makes a creamier coffee;
4. Press the icon corresponding to the number of coffees required (1 cup  B2, or 2 cups  B3) (figs. 10 and 15);
5. Preparation begins. One or two cups appear on the display (B1) and gradually fill as preparation progresses.

#### Please note:

- While the machine is making coffee, delivery can be interrupted at any moment by pressing any icon;
- At the end of delivery, to increase the quantity of coffee in the cup, just press one of the coffee icons (  or  ) within 3 seconds.

Once the coffee has been made, the appliance is ready to make the next drink.

#### Please note!

- Various alarm messages could be displayed while using the appliance (FILL TANK, EMPTY GROUNDS CONTAINER, etc.). Their meaning is explained in section “18. Displayed messages”.
- For hotter coffee, see section “10.5 Tips for a hotter coffee”.
- If the coffee is delivered a drop at a time, too weak and not creamy enough or too cold, read the tips in the section “19. Troubleshooting”.

### 10.7 Making coffee using pre-ground coffee

#### Important!

- Never place coffee beans in the pre-ground coffee funnel (A4) as this could damage the appliance.
- Never add pre-ground coffee when the machine is off or it could spread through the inside of the machine and dirty it. This could damage the appliance.
- Never use more than 1 level measure (C2) or it could dirty the inside of the coffee machine or block the funnel (A4).



**Please note!**

When you use pre-ground coffee, you can only make one cup of coffee at a time.

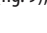
1. Press the selection icon (B4) corresponding to the “taste” bar repeatedly until “Pre-ground” and  flash on the display;
2. Make sure the funnel (A4) is not blocked, then add one level measure of pre-ground coffee (fig. 16);
3. Place a cup under the coffee spouts (A15) (fig. 9);
4. Press the 1 cup coffee icon  (B2);
5. Preparation begins. A cup appears on the display (B1) and gradually fills as preparation progresses.

**Please note!**

If “Energy Saving” mode is active, you may have to wait a few seconds before the first coffee is delivered.

## 11. MAKING CAPPUCCINOS AND MILK BASED COFFEES

**Please note!**

- To avoid producing milk with poor froth or large bubbles, always clean the milk container lid (D2) and hot water connection nozzle (A16) as described in sections “11.4 Cleaning the milk container after every use”, “13.10 Cleaning the milk container” and “13.11 Cleaning the hot water/steam connection nozzle”.

### 11.1 Filling and attaching the milk container

1. Turn the milk container lid (D2) clockwise until it becomes noticeably difficult to turn, then remove (fig. 17);
2. Fill the milk container (D3) with a sufficient quantity of milk, not exceeding the MAX level marked on the handle (fig. 18);

**Please note!**

- For a denser, more even froth, you must use skimmed or partially skimmed milk at refrigerator temperature (about 5°C).
  - If “Energy saving” mode is enabled, you may have to wait a few seconds before the drink is delivered.
3. Make sure the milk intake tube (D4) is correctly inserted in the bottom of the milk container lid (fig. 19);
  4. Replace the milk container lid and turn anticlockwise as far as it will go;
  5. Remove the hot water spout (C5) (fig. 20);
  6. Attach the milk container to the connection nozzle (A16) and push as far as it will go (fig. 21). The machine emits a beep (if the beep function is enabled);

7. Place a sufficiently large cup under the coffee spouts (A15) and frothed milk spout (D5) (fig. 22).
8. Follow the instructions below for each function.

**Please note!**

To use particularly tall cups/glasses, raise the lid of the special compartment (A11) in the cup tray (A10) (fig. 23).

### 11.2 Adjusting the amount of froth

Turn the froth regulator (D1) on the milk container lid (D2) to adjust the amount of froth on the milk delivered while making cappuccino and milk based coffee.

Follow the tips in the table below:

Froth regulator position	Description	Recommended for...
CAFFELATTE	No froth	CAFFELATTE/MILK (HOT MILK)
MACCHIATO	Min. froth	MACCHIATO
CAPPUCCINO	Max. froth	CAPPUCCINO/MILK (FROTHED MILK)

### 11.3 Making cappuccino and milk based coffees automatically

The CAFFELATTE (B9), CAPPUCCINO (B8), MACCHIATO (B6) and MILK (B5) icons on the touch screen (B) enable these drinks to be prepared automatically.

Proceed as follows:

1. Fill the milk container (D) and attach it as described above;
2. Turn the froth adjustment dial (D1) on the milk container lid (D2) to the position corresponding to the required froth;
3. Press the icon corresponding to the required drink. A glass appears on the display (B1) and gradually fills as preparation progresses;
4. After a few seconds, frothed milk is delivered from the milk spout (D5) into the cup below.  
When making milk based coffees, after delivering the milk, the machine automatically makes the coffee.

**Please note: general indications when preparing all milk based drinks**

- If you want to interrupt preparation during delivery, press any icon.
- At the end of delivery, to increase the quantity of milk or coffee in the cup, within 3 seconds, just press and hold one of the milk based coffee icons.
- Do not leave the milk container out of the refrigerator for long periods. The warmer the milk (5°C is ideal), the poorer the quality of froth produced.



## 11.4 Cleaning the milk container after every use



### **Important! Danger of burns**

When cleaning the internal tubes of the milk container (D), a little hot water and steam leak out of the frothed milk spout (D5). Avoid contact with splashes of water.

"Press CLEAN button" appears on the display (B1) whenever you use a milk function.

To eliminate all milk residues, proceed as follows:

1. Leave the milk container in the machine (you do not need to empty it);
2. Place a cup or other recipient under the frothed milk spout;
3. Press and hold the CLEAN button (fig. 24) until the progress bar which appears on the display together with the message "Cleaning underway" is complete;
4. Remove the milk container and always clean the steam connection nozzle (A16) with a sponge (fig. 25);





### **Please note!**

- To prepare a number of cappuccinos or milk based coffees, clean the milk container after you have prepared the last drink only.
- The milk container can be kept in the refrigerator.
- In some cases, to clean you must wait for the appliance to heat up, holding the CLEAN button down.

## 11.5 Programming the quantity of coffee and milk in the cup for the CAFFELATTE, CAPPUCCINO, MACCHIATO and MILK icons

The appliance is set by default to automatically deliver standard quantities.

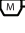
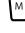
To change these quantities, proceed as follows:

1. Place a cup under the coffee spouts (A15) and milk spout (D5).
2. Press and hold one of the milk function icons until "Program Quantity PROGRAM MILK" appears on the display (B1) together with the  or  symbol according to the function selected;
3. When the appliance starts delivering milk, release the icon;
4. Once the required quantity of milk has been delivered into the cup, press the icon again;
5. The appliance stops delivering milk and, if required for the drink being prepared, after a few seconds the coffee is delivered into the cup. "Program quantity PROGRAM COFFEE" appears on the display and the  icon (B2) flashes;
6. As soon as the coffee in the cup reaches the required level, press the  icon. Coffee delivery stops and the machine is "ready for use" again.



This completes programming.

## 12. DELIVERING HOT WATER



### **Important! Danger of burns.**

Never leave the machine unattended while delivering hot water. The hot water spout (C5) becomes hot during delivery. Hold by the handle only.

1. Make sure the hot water spout is attached correctly (fig. 7);
2. Place a cup under the spout (as close as possible to avoid splashes);
3. Press the  icon (B11) (fig. 26). Preparation begins. "Hot water" and the corresponding animation appear on the display (B1);
4. The machine delivers about 250 ml of hot water, then delivery stops automatically. To interrupt delivery of the hot water manually, press the  icon again.





### **Please note!**

If "Energy Saving" is active, you may have to wait a few seconds before hot water and steam are delivered.

### 12.1 Changing the quantity of water delivered automatically

The machine is set by default to automatically deliver 250 ml of hot water.

To modify these quantities, proceed as follows:

1. Make sure the hot water spout (C5) is attached correctly;
2. Position a cup under the hot water spout;
3. Press and hold the  icon (B11) until "HOT WATER Program Quantity" appears on the display (B1) and the  icon flashes, then release the icon;
4. When the hot water in the cup reaches the required level, press the  icon again.

The machine is now reprogrammed with the new quantity.

## 13. CLEANING

### 13.1 Cleaning the machine

The following parts of the machine must be cleaned regularly:



- the appliance's internal circuit;
- coffee grounds container (A9),
- drip tray (A12),
- inside the machine, accessible after opening the service door (A13),
- water tank (A7),
- coffee spouts (A15) and hot water connection nozzle (A16),
- pre-ground coffee funnel (A4),
- infuser (A8),
- milk container (D)
- touch screen (B)

**Important!**

- Do not use solvents, abrasive detergents or alcohol to clean the coffee machine.  
With De'Longhi superautomatic coffee machines, you need not use chemical products to clean the machine.
- None of the components of the appliance can be washed in a dishwasher with the exception of the milk container (D).
- Do not use metal objects to remove encrustations or coffee deposits as they could scratch metal or plastic surfaces.

**13.2 Cleaning the machine's internal circuit**

If the appliance is not used for more than 3/4 days, before using it again, we strongly recommend switching it on and:

- performing 2 or 3 rinse cycles by pressing the  icon (B7);
- delivering hot water for a few seconds by pressing the  icon (B11).

**13.3 Cleaning the coffee grounds container**

When "EMPTY GROUNDS CONTAINER" is displayed, the grounds container must be emptied and cleaned.

The appliance cannot be used to make coffee until you have cleaned the grounds container (A9).

Even if not full, the empty grounds container message is displayed 72 hours after the first coffee has been prepared. For the 72 hours to be calculated correctly, the machine must never be turned off with the main switch (A18).

**Important! Danger of burns**

If you make a number of cappuccinos one after the other, the metal cup tray (A10) becomes hot.

Wait for it to cool down before touching it and handle it from the front only.

To clean (with the machine on):

- Open the service door (A13) (fig. 27) on the front of the appliance, extract the drip tray (A12) (fig. 28), empty and clean;
- Empty the grounds container and clean thoroughly to remove all residues left on the bottom. This can be done with the spatula on the brush (C4) provided.

**Important!**

When removing the drip tray, the grounds container must be emptied, even if it contains few grounds.

If this is not done, when you make the next coffees, the grounds container may fill up more than expected and clog the machine.

**13.4 Cleaning the drip tray and condensate tray****Important!**

The drip tray (A12) is fitted with a level indicator (A20 - red) showing the level of water it contains (fig. 29).

Before the indicator protrudes from the cup tray (A10), the drip tray must be emptied and cleaned, otherwise the water may overflow the edge and damage the appliance, the surface it rests on or the surrounding area.

To remove the drip tray:

1. Open the service door (A13) (fig. 27). Extract the drip tray and grounds container (A9) (fig. 28);
2. Empty the drip tray and grounds container and wash them;
3. Replace the drip tray complete with grounds container;
4. Close the service door.

**13.5 Cleaning the inside of the coffee machine****Danger of electric shock!**

Before cleaning internal parts, the machine must be turned off (see section "7. Turning off") and unplugged from the mains power supply.

Never immerse the coffee machine in water.

1. Check regularly (about once a month) that the inside of the appliance is not dirty (to access, open the service door (A13) and remove the drip tray (A12) with the grounds container (A9)).  
If necessary, remove coffee deposits with the brush (C4) supplied and a sponge;
2. Remove all the residues with a vacuum cleaner (fig. 30).

**13.6 Cleaning the water tank**

1. Clean the water tank (A7) regularly (about once a month) with a damp cloth and a little mild washing up liquid;
2. After cleaning, rinse the water tank thoroughly to remove all washing up liquid residues.

**13.7 Cleaning the coffee spouts**

1. Clean the coffee spouts (A15) regularly with a sponge or cloth (fig. 31);
2. Check that the holes in the coffee spouts are not blocked.  
If necessary, remove coffee deposits with a toothpick.

**13.8 Cleaning the pre-ground coffee funnel**

Check regularly (about once a month) that the pre-ground coffee funnel (A4) is not blocked.

If necessary, remove coffee deposits with the brush (C4) supplied.

### 13.9 Cleaning the infuser

The infuser (A8) must be cleaned at least once a month.



#### **Important!**

The infuser may not be extracted when the machine is on.

1. Make sure the machine is correctly turned off (see section "7. Turning off").
2. Open the service door (A13) (fig. 27);
3. Remove the drip tray (A12) and grounds container (A9) (fig. 28);
4. Press the two coloured release buttons inwards and at the same time pull the infuser outwards (fig. 32);



#### **Important!**

RINSE WITH WATER ONLY - NO WASHING UP LIQUID  
- NO DISH WASHER

Clean the infuser without using washing up liquid as it could be damaged.

5. Soak the infuser in water for about 5 minutes, then rinse under the tap;
6. Use the brush (C4) to remove any coffee residues left in the infuser housing, visible through the infuser door;
7. After cleaning, replace the infuser by sliding it onto the internal support (fig. 33), then push the PUSH symbol fully in until it clicks into place;

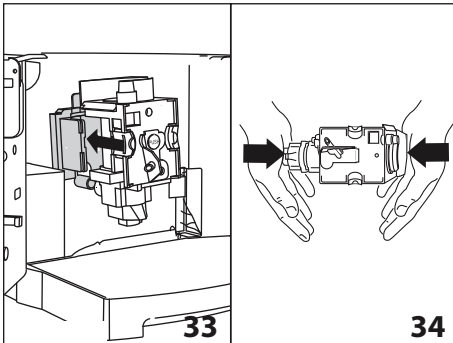

#### **Please note!**

If you encounter difficulty inserting the infuser, before inserting it you must adapt it to the right dimension by pressing it forcefully from the bottom and top as shown in figure 34.

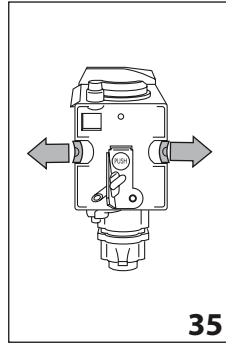

8. Once inserted, make sure the two coloured buttons have snapped out (fig. 35);
9. Replace the drip tray and grounds container in the appliance;
10. Close the service door.

### 13.10 Cleaning the milk container

Every two days, clean the milk container (D) as described below:

1. Turn the milk container lid (D2) clockwise then remove it (fig. 17);
2. Remove the milk spout (D5) and intake tube (D4) (fig. 36);

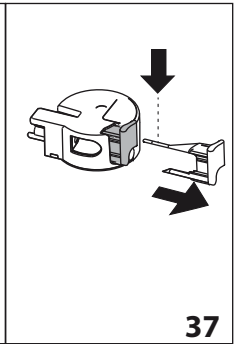
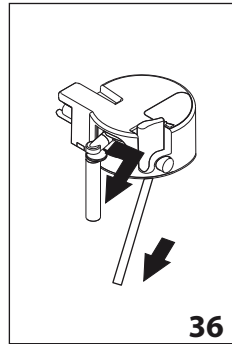

3. Remove the froth regulator (D1) by pulling it outwards (fig. 37);
4. Wash all the components thoroughly with hot water and mild washing-up liquid.

All components are dishwasher safe, placing them in the top basket of the dishwasher.

Make sure there are no milk residues left inside the holes (fig. 38) and the groove on the fine end of the froth regulator (fig. 37). If necessary, scrape the groove with a toothpick.

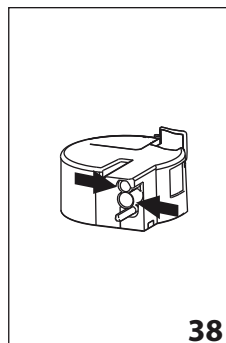

5. Use the brush supplied or another brush (not metal) to remove residues from the milk hole;
6. Check that the intake tube and spout are not clogged with milk residues;
7. Replace the container pointer, milk spout and intake tube;

8. Replace the lid on the milk container, turning it anticlockwise to hook it in place.

### 13.11 Cleaning the hot water/steam connection nozzle

Each time you prepare milk, clean the connection nozzle (A16) with a sponge to remove milk residues from the gaskets (fig. 25).

### 13.12 Cleaning the touch screen

1. If the machine is on, turn off by pressing the  button (A19) (fig. 8) to avoid starting the appliance accidentally during cleaning;
2. Clean the touch screen (B) with a damp cloth. Do not use solvents, aggressive detergents and/or sharp objects as they could damage the surface of the screen.

## 14. DESCALING

Descalc the machine when the message "DESCALE" flashes on the display (B1).



### **Important!**

- Before use, read the instructions and the labelling on the descaler pack.
- You should use De'Longhi descaler only. Using unsuitable descaler and/or performing descaling incorrectly may result in faults not covered by the manufacturer's guarantee.

1. Turn the appliance on and wait until it is ready for use;
2. Choose the "MAINTENANCE" section as describe in section "8. Changing the menu settings";
3. Press the selection icons (B4 and B10) until "Descaling" appears on the display (B1);
4. Press the icon  (B7) to confirm. "OK to confirm" is displayed. Press the icon again to enable the function.
5. The message "Add descaler. Press OK" appears on the display;
6. Before confirming, empty the water tank (A7).  
Pour the descaler diluted with water (respecting the proportions indicated on the descaler pack) into the water tank and put the water tank back in the appliance;  
Place an empty container with a minimum capacity of 1.7 litres under the hot water spout (C5) (fig. 39);



### **Important! Danger of burns**

Hot water containing acid flows out of the hot water spout. Avoid contact with splashes of water.

7. Press the selection icon corresponding to **OK** to start the descaling programme;
8. The message "Descalc underway" is displayed.  
The descale programme starts and the descaler liquid comes out of the water spout. The descaling programme automatically performs a series of rinses and pauses to remove limescale deposits from inside the machine;  
After about 30 minutes, the message "Rinsing FILL TANK" is displayed.
9. The appliance is now ready for rinsing through with clean water.  
Empty the container used to collect the descaler solution. Extract the water tank, empty, rinse under running water, fill with fresh water up to the MAX level and put back in the appliance: "Rinsing, Press OK" is displayed;
10. Place the container used to collect the descaler solution empty under the hot water spout;
11. Press the icon corresponding to **OK** to start rinsing.  
Hot water flows out of the spout and the message "Rinsing" is displayed;
12. When it finishes, the message "Rinsing complete, Press OK" is displayed;
13. Press the icon corresponding to **OK**. The appliance goes off. Descaling is complete. To use it again, turn the appliance on by pressing the  button (A19).



### **Please note!**

- If the descaling cycle is not completed correctly (e.g. no electricity) we recommend repeating the cycle;

## 15. SETTING WATER HARDNESS

The DESCALE message is displayed after a period of time established according to water hardness.

The machine is set by default for a hardness value of 4.



The machine can also be programmed according to the hardness of the mains water in the various regions so that the machine needs to be descaled less often.

### 15.1 Measuring water hardness

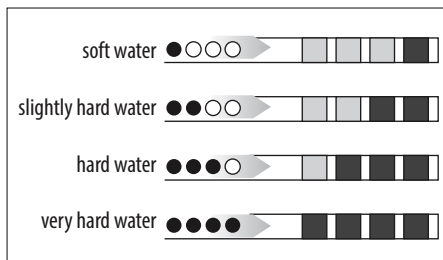
1. Remove the "TOTAL HARDNESS TEST" indicator paper (C1) from its pack (attached to the English instructions).
2. Immerse the paper completely in a glass of water for one second.
3. Remove the paper from the water and shake lightly. After about a minute, 1, 2, 3, or 4 red squares form, depending on the hardness of the water. Each square corresponds to one level.



## 15.2 Setting water hardness

1. Choose the "SETTINGS" section as described in section "8. Menu settings".
  2. Press the selection icons (B4 or B10) until "Water hardness" appears on the display (B1).
  3. Press the icon  (B7) to confirm.
  4. Press the selection icons to set the level corresponding to the water hardness identified by the indicator paper (see figure in previous section).
  5. Press the  icon to confirm the setting.
  6. Press the **P** icon (B12) repeatedly to exit the menu.
- The machine is now reprogrammed with the new water hardness setting.

## 16. TECHNICAL DATA

Voltage:	220-240 V~ 50/60 Hz max. 10 A
Power:	1350 W
Pressure:	1.5 MPa (15 bars)
Water tank capacity:	1.7 l
Size LxDxH:	285x450x380 mm
Cord length:	1450 mm
Weight:	11.9 kg
Beans container capacity:	280 g



The appliance complies with the following EC directives:





- European Standby Regulation 1275/2008
- Materials and accessories coming into contact with food conform to European regulation 1935/2004.



## 17. DISPOSAL



The appliance must not be disposed of with household waste, but taken to an authorised waste separation and recycling centre.

## 18. DISPLAYED MESSAGES



DISPLAYED MESSAGE	POSSIBLE CAUSE	SOLUTION
<p>FILL TANK</p> 	Insufficient water in the tank (A7).	Fill the tank with water and/or insert it correctly, pushing it as far as it will go until it clicks into place.
<p>GROUND TOO FINE ADJUST MILL</p> <p>Insert Water Spout and Press OK</p>	The grinding is too fine and the coffee is delivered too slowly or not at all.	<p>Repeat coffee delivery and turn the grinding adjustment dial (A1) one click clockwise towards "7" while the coffee mill is in operation. If after making at least 2 coffees delivery is still too slow, repeat the correction procedure, turning the grinding adjustment dial another click until delivery is correct.</p> <p>If the problem persists, press the icon corresponding to <b>OK</b> and deliver water from the spout until it flows out normally.</p>
<p>INSERT WATER SPOUT</p>	The water spout (C5) is not inserted or is inserted incorrectly.	Insert water spout as far as it will go.
<p>EMPTY GROUNDS CONTAINER</p> 	The grounds container (A9) is too full or more than 3 days have passed since delivery of the first coffee (this guarantees correct hygiene of the machine).	<p>Empty the grounds container and clean, then replace. Important: when removing the drip tray (A12), the grounds container <b>MUST</b> be emptied, even if it contains few grounds.</p> <p>If this is not done, when you make the next coffees, the grounds container may fill up more than expected and clog the machine.</p>
<p>INSERT GROUNDS CONTAINER</p> 	After cleaning, the grounds container (A9) has not been replaced.	Open the service door (A13), remove the drip tray (A12) and insert the grounds container.
<p>ADD PRE-GROUND COFFEE</p> 	<p>The "pre-ground coffee" function has been selected without placing any pre-ground coffee in the funnel (A4).</p> <p>The funnel (A4) is blocked.</p>	<p>Place pre-ground coffee in the funnel or deselect the "pre-ground" function.</p> <p>Empty the funnel with the help of the brush (C4) as described in section "13.8 Cleaning the pre-ground coffee funnel".</p>
<p>DESCALE</p>	The machine must be descaled.	The descaling procedure described in the section "14. Descaling" needs to be performed as soon as possible.
<p>REDUCE COFFEE AMOUNT</p> 	Too much coffee has been used.	Select a milder taste or reduce the quantity of pre-ground coffee, then make the coffee again.

FILL BEANS CONTAINER 	The coffee beans have run out.	Fill the beans container (A3).
	The pre-ground coffee funnel (A4) is clogged.	The pre-ground coffee funnel (A4) is clogged. Empty the funnel with the help of the brush (C4) as described in section "13.8 Cleaning the pre-ground coffee funnel"
INSERT INFUSER ASSEMBLY 	The infuser (A8) has not been replaced after cleaning.	Insert the infuser as described in the section "13.9 Cleaning the infuser".
INSERT MILK CONTAINER	The milk container (D) is not inserted correctly.	Insert the milk container as far as it will go.
CLOSE DOOR 	The service door (A15) is open.	Close the service door.
PRESS CLEAN	Milk has been delivered recently and the tubes inside the milk container must be cleaned (D).	Press the CLEAN button (D6) and keep it pressed until the progress bar which appears on the display (B1) together with the message "Cleaning Underway" is complete.
Energy saving	The function is active and reduces electricity consumption.	Disable the function from the menu (See section "8.2 Energy saving").
GENERAL ALARM	The inside of the appliance is very dirty.	Clean the inside of the appliance thoroughly, as described in the section "13 Cleaning". If the message is still displayed after cleaning, contact a service centre.

## 19. TROUBLESHOOTING

Below is a list of some of the possible malfunctions.

If the problem cannot be resolved as described, contact Customer Services.

PROBLEM	POSSIBLE CAUSE	SOLUTION
The coffee is not hot.	The cups were not preheated.	<ul style="list-style-type: none"> <li>Disable energy saving (see section "8.2  Energy saving") and warm the cups by leaving them on the cup warmer (A6) for at least 20 minutes.</li> <li>Warm the cups by rinsing them with hot water (using the hot water function).</li> </ul>
	The internal circuit has cooled down because 2/3 minutes have elapsed since the last coffee was made.	Before making coffee, heat the infuser by pressing the  icon (see section "9. Rinsing").
	A low coffee temperature is set.	Set a high coffee temperature in the menu.
The coffee is not creamy enough.	The coffee is ground too coarsely.	Turn the grinding adjustment dial (A1) one click anticlockwise towards "1" while the coffee mill is in operation (fig. 11). Continue one click at a time until coffee delivery is satisfactory. The effect is only visible after delivering 2 coffees.
	Wrong type of coffee.	Use a type of coffee for espresso coffee machines.
The coffee is delivered too slowly or a drop at a time.	The coffee is ground too finely.	Turn the grinding adjustment dial (A1) one click clockwise towards "7" while the coffee mill is in operation (fig. 11). Continue one click at a time until coffee delivery is satisfactory. The effect is only visible after delivering 2 coffees.
The coffee does not come out of the spouts, but from around the service door	The holes in the spouts (A15) are clogged with dry coffee dust.	Clean the spouts with a toothpick.
	The coffee guide (A14) inside the service door (A13) is blocked .	Thoroughly clean the coffee guide, particularly near the hinges.
The coffee is delivered too quickly.	The coffee is ground too coarsely.	Turn the grinding adjustment dial (A1) one click anticlockwise towards "1" while the coffee mill is in operation (fig. 11). Avoid turning the grinding adjustment dial excessively otherwise when you select two cups, the coffee may be delivered a drop at a time.
Coffee does not come out of one or both of the spouts.	The coffee spouts (A15) are blocked.	Clean the spouts with a toothpick.



Water comes out of the spouts instead of coffee.	The pre-ground coffee may be blocked in the funnel (A4).	Empty the funnel with the help of the brush (C4) supplied, as described in section "13.8 Cleaning the pre-ground coffee funnel".
The milk contains bubbles or squirts out of the milk spout	The milk is not cold enough or is not semi-skimmed.	You should ideally use skimmed or semi-skimmed milk at refrigerator temperature (about 5°C). If the result is not as you wished, try changing brand of milk.
	The froth regulator (D1) is incorrectly adjusted.	Adjust according to the instructions in section "11.2 Adjusting the amount of froth".
	The milk container lid (D2) is dirty	Clean the milk container lid as described in section "13.10 Cleaning the milk container".
The milk is not frothed	The froth regulator (D1) is incorrectly adjusted	Adjust following the instructions in the section "11.2 Adjusting the amount of froth".
	The milk container lid (D2) is dirty.	Clean the milk container lid as described in section "13.10 Cleaning the milk container".
The appliance does not come on	It is not plugged into the mains socket.	Plug into the mains socket (fig. 1).
	The main switch (A18) is not turned on.	Place the main switch in the I position (fig. 2).
The milk does not come out of the milk spout (D5)	The milk container lid (D2) is dirty.	Clean the milk container lid as described in section "13.10 Cleaning the milk container".
"Energy Saving" is enabled, but the cup warmer (A6) is hot	A number of drinks have been prepared in rapid succession	

## 20. ELECTRICAL CONNECTION (UK ONLY)

Before using this appliance ensure that the voltage indicated on the product corresponds with the main voltage in your home, if you are in any doubt about your supply contact your local electricity company.

The flexible mains lead is supplied connected to a B.S. 1363 fused plug having a fuse of 13 amp capacity.

Should this plug not fit the socket outlets in your home, it should be cut off and replaced with a suitable plug, following the procedure outlined below.

**Note:** Such a plug cannot be used for any other appliance and should therefore be properly disposed of and not left where children might find it and plug it into a supply socket - with the obvious consequent danger.

**Please note:** We recommend the use of good quality plugs and wall sockets that can be switched off when the machine is not in use.

**IMPORTANT:** The wires in the mains lead fitted to this appliance are coloured in accordance with the following code:

GREEN AND YELLOW  
BLUE  
BROWN

EARTH  
NEUTRAL  
LIVE

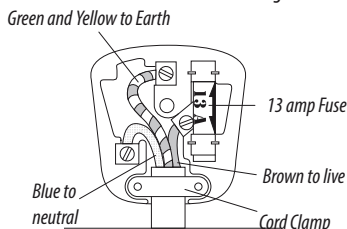

As the colours of the wires in the mains lead of this appliance may not correspond with the coloured markings identifying the terminals in your plug, proceed as follows:

- The wire which is coloured green and yellow must be connected to the terminal in the plug which is marked with the letter E or by the earth symbol  or coloured green or green and yellow.
- The wire which is coloured blue must be connected to the terminal which is marked with the letter N or coloured black.
- The wire which is coloured brown must be connected to the terminal which is marked with the letter L or coloured red.

When wiring the plug, ensure that all strands of wire are securely retained in each terminal. Do not forget to tighten the mains lead clamp on the plug. If your electricity supply point has only two pin socket outlets, or if you are in doubt, consult a qualified electrician.

Should the mains lead ever require replacement, it is essential that this operation be carried out by a qualified electrician and should only be replaced with a flexible cord of the same size.

After replacement of a fuse in the plug, the fuse cover must be refitted. If the fuse cover is lost, the plug must not be used until a replacement cover is obtained. The colour of the correct replacement fuse cover is that of the coloured insert in the base of the fuse recess or elsewhere on the plug. Always state this colour when ordering a replacement fuse cover.

Only 13amp replacement fuses which are approved to B.S. 1362 should be fitted.

This appliance conforms to the Norms EN 55014 regarding the suppression of radio interference.

**Warning - this appliance must be earthed**