



---

# ECAM23.460

## COFFEE MAKER

Instructions for use. Keep these instructions

Visit [www.delonghiregistration.com](http://www.delonghiregistration.com) to register  
your product

Visit [www.delonghi.com](http://www.delonghi.com) for a list of service centers  
near you.

## ELECTRIC CHARACTERISTICS

120 V~ 60 Hz 1250 W

## MACHINE À CAFÉ

Mode d'emploi . Conservez cette notice

Visitez [www.delonghiregistration.com](http://www.delonghiregistration.com) pour  
enregistrer votre produit en ligne.

Visitez [www.delonghi.com](http://www.delonghi.com) pour y voir une liste des  
centres de réparation proches de chez vous.

## CARACTÉRISTIQUES ÉLECTRIQUES

120 V~ 60 Hz 1250 W



## CAFETERA

Repase y guarde estas instrucciones.

Lea cuidadosamente este instructivo antes de usar  
su aparato.

Visite [www.delonghiregistration.com](http://www.delonghiregistration.com) para registrar  
su producto en línea.

Visite [www.delonghi.com](http://www.delonghi.com) para ver la lista de  
centros de servicios cercanos a usted.

## CARACTERISTICAS ELECTRICAS:

120 V~ 60 Hz 1250 W

---

The DeLonghi logo is located at the bottom right of the page. It consists of the word "DeLonghi" in a bold, serif font, enclosed within a rounded rectangular border.

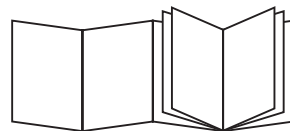

**B**

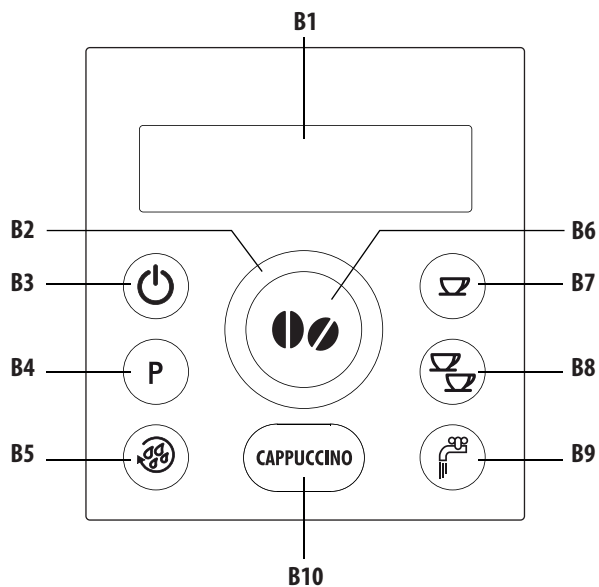

**C**

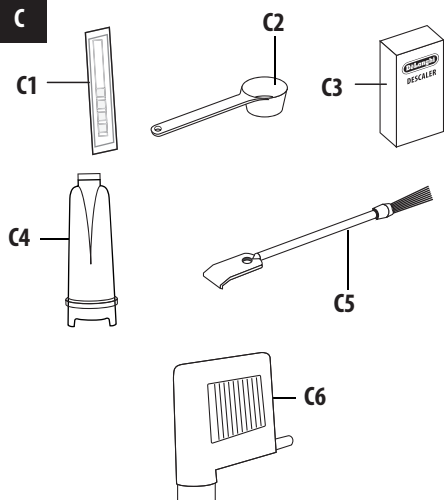

**D**

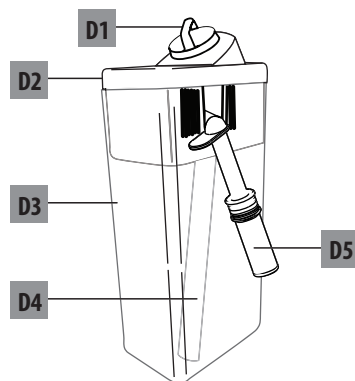

**A**

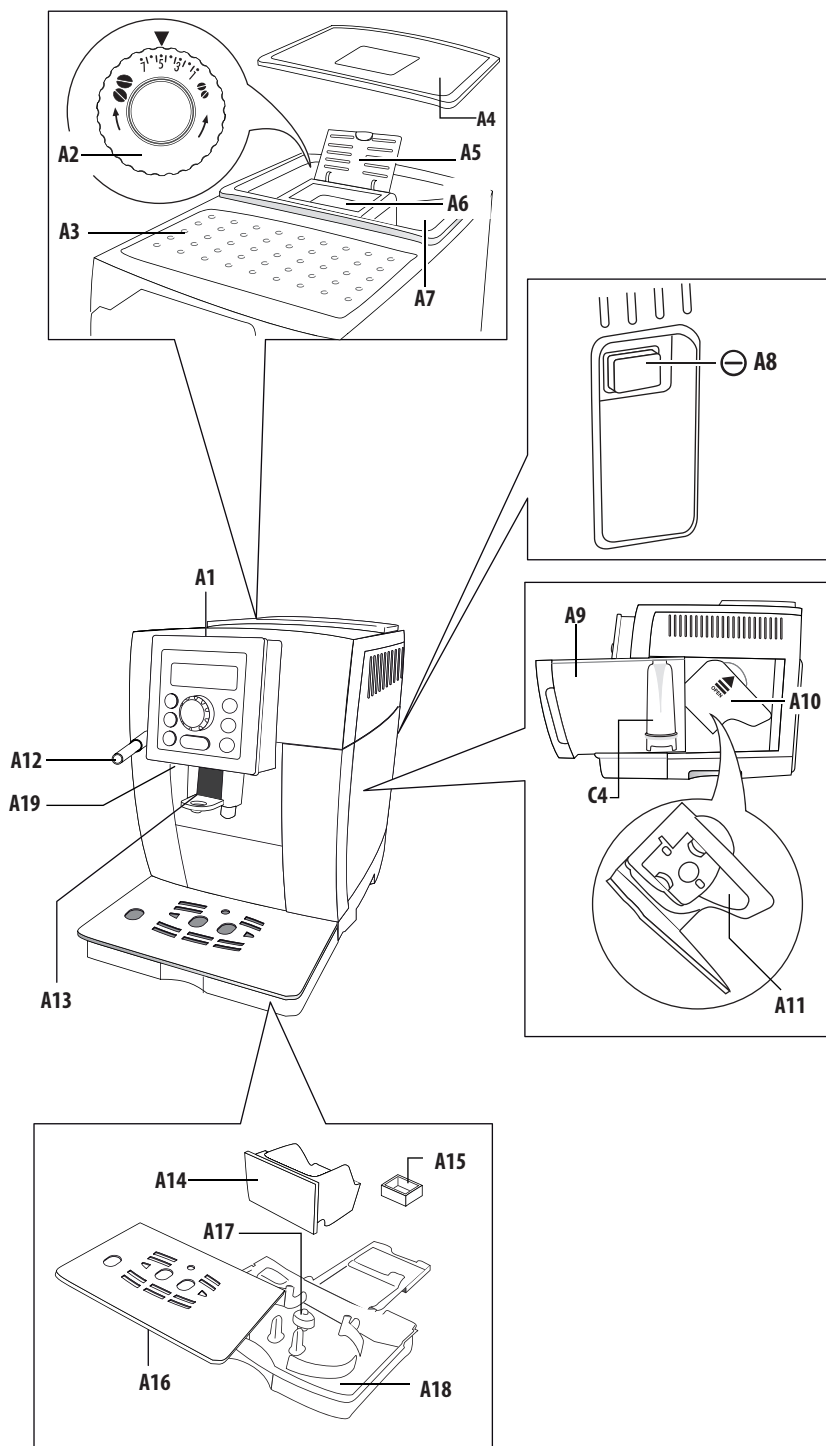

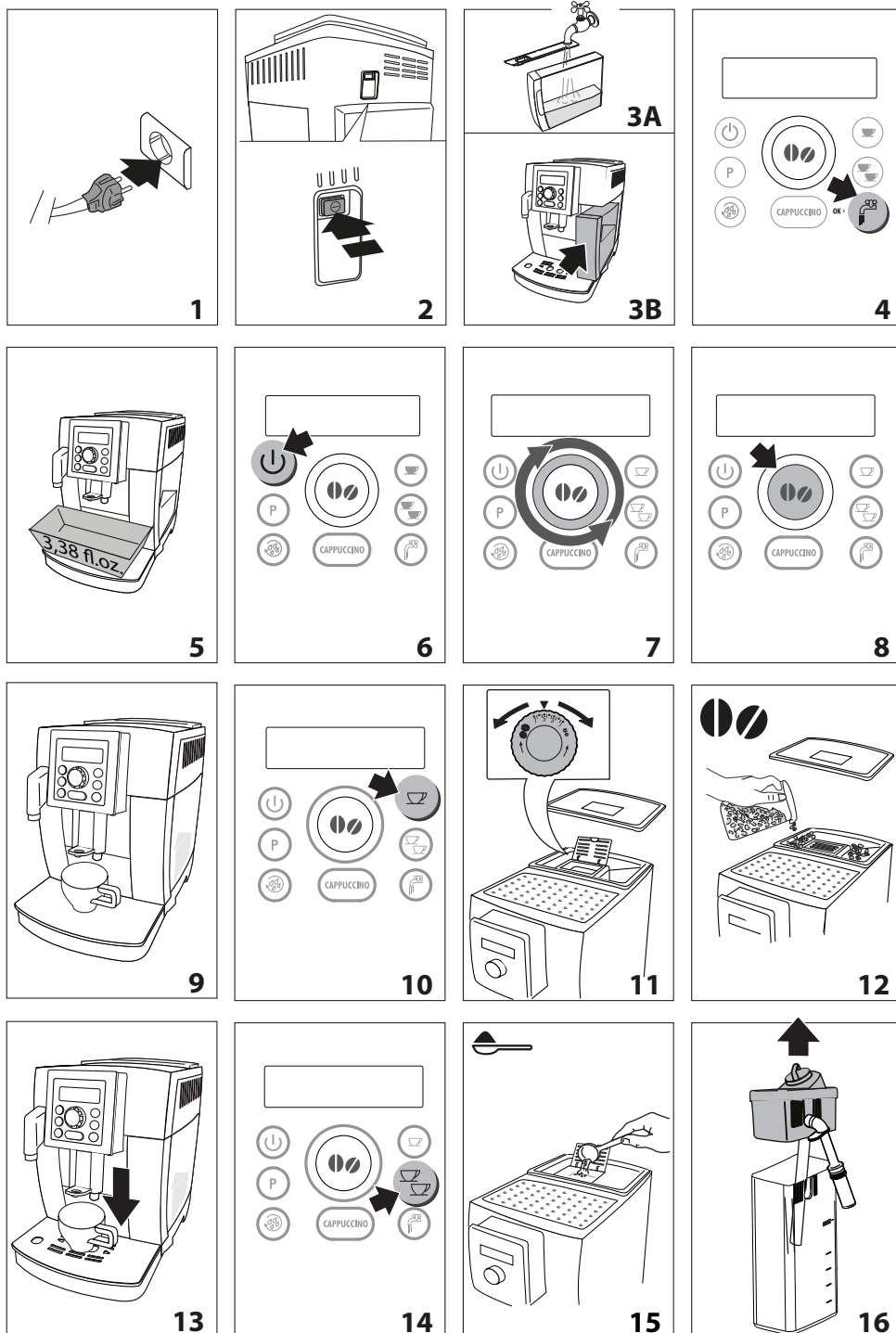

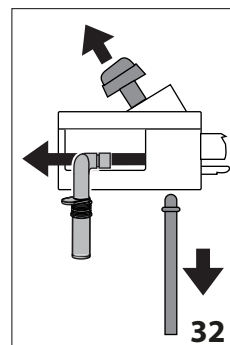
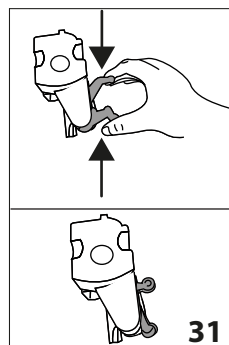
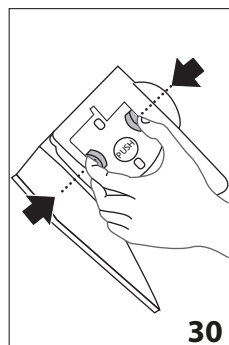
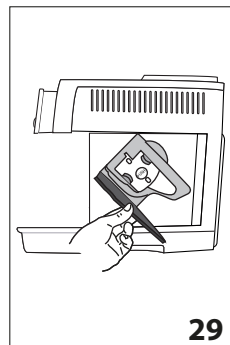
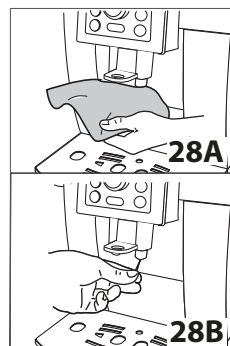
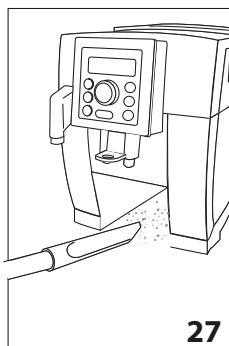
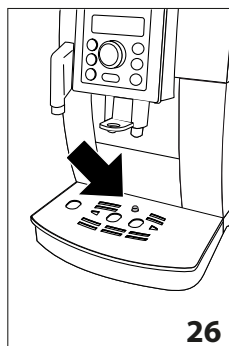
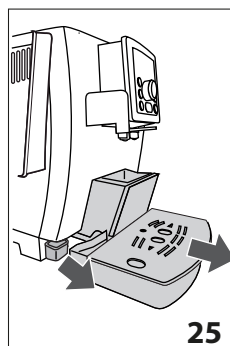
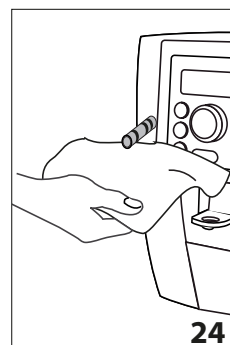
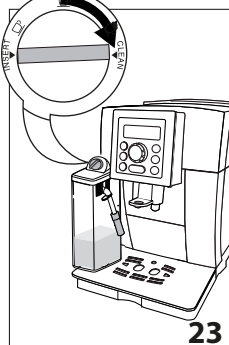
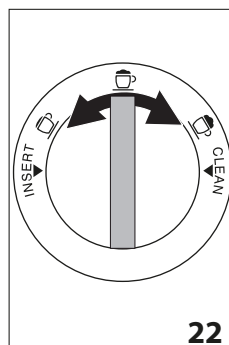
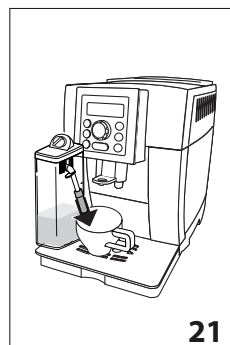
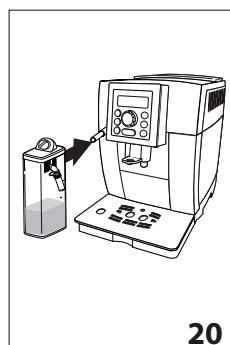
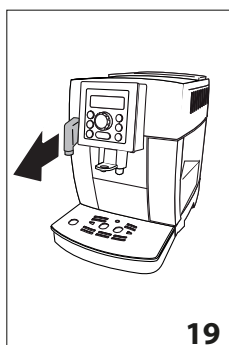
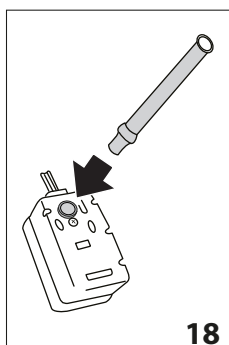
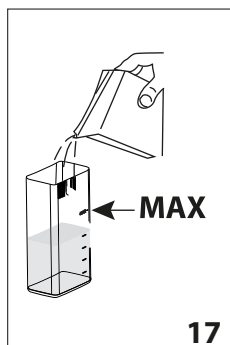

## CONTENTS

<b>1. IMPORTANT SAFEGUARDS .....</b>	<b>7</b>
1.1 Short cord instructions .....	7
<b>2. INTRODUCTION.....</b>	<b>8</b>
2.1 Symbols used in these instructions .....	8
2.2 Letters in brackets .....	8
2.3 Troubleshooting and repairs.....	8
2.4 Video instruction manual available on: .....	8
<b>3. DESCRIPTION.....</b>	<b>8</b>
3.1 Description of the appliance .....	8
3.2 Description of the control panel .....	8
3.3 Description of the accessories.....	9
3.4 Description of the milk container .....	9
<b>4. BEFORE USE.....</b>	<b>9</b>
4.1 Checking the appliance .....	9
4.2 Installing the appliance.....	9
4.3 Connecting the appliance.....	9
4.4 Setting up the appliance.....	9
<b>5. TURNING THE APPLIANCE ON.....</b>	<b>10</b>
<b>6. TURNING THE APPLIANCE OFF .....</b>	<b>10</b>
<b>7. MENU SETTINGS .....</b>	<b>10</b>
7.1 Descaling .....	10
7.2 Install filter.....	10
7.3 Replacing the filter.....	10
7.4 Adjust time .....	10
7.5 Auto-start .....	10
7.6 Auto-off.....	11
7.7 Energy saving.....	11
7.8 Setting the temperature .....	11
7.9 Setting water hardness .....	11
7.10 Enable/disable the beep .....	11
7.11 Setting the language .....	11
7.12 Cup light.....	11
7.13 Default values (reset) .....	12
7.14 Statistics function.....	12
<b>8. RINSING .....</b>	<b>12</b>
<b>9. MAKING COFFEE.....</b>	<b>12</b>
9.1 Selecting the coffee taste .....	12
9.2 Selecting the quantity of coffee in the cup.....	12
9.3 Customising the "my coffee" quantity.....	13
9.4 Adjusting the coffee mill .....	13
9.5 Tips for a hotter coffee.....	13
9.6 Making coffee using coffee beans .....	13
9.7 Making coffee using pre-ground coffee.....	13
<b>10. MAKING CAPPUCCINOS AND MILK-BASED COFFEES.....</b>	<b>14</b>
10.1 Filling and attaching the milk container.....	14
10.2 Adjusting the amount of froth.....	14
10.3 Making cappuccino or latte macchiato.....	14
10.4 Making frothed milk (without coffee) .....	14
10.5 Preparing milk (unfrothed and without coffee).....	14
10.6 Cleaning the milk container after use .....	15
10.7 Programming the quantity of coffee and milk in the cup for cappuccino or milk .....	15
<b>11. HOT WATER .....</b>	<b>15</b>
11.1 Changing the quantity of water delivered automatically .....	15
<b>12. CLEANING.....</b>	<b>15</b>
12.1 Cleaning the machine .....	15
12.2 Cleaning the machine's internal circuit .....	16
12.3 Cleaning the coffee grounds container.....	16
12.4 Cleaning the drip tray and condensate tray.....	16
12.5 Cleaning the inside of the coffee machine.....	16
12.6 Cleaning the water tank.....	16
12.7 Cleaning the coffee spouts .....	16
12.8 Cleaning the pre-ground coffee funnel .....	16
12.9 Cleaning the infuser .....	17
12.10 Cleaning the milk container .....	17
12.11 Cleaning the hot water/steam connection nozzle.....	17
<b>13. DESCALING .....</b>	<b>17</b>
<b>14. SETTING WATER HARDNESS .....</b>	<b>18</b>
14.1 Measuring water hardness.....	18
14.2 Setting water hardness .....	19
<b>15. WATER SOFTENER FILTER .....</b>	<b>19</b>
15.1 Installing the filter .....	19
15.2 Replacing the filter.....	20
15.3 Removing the filter .....	20
<b>16. TECHNICAL DATA.....</b>	<b>20</b>
<b>17. DISPLAYED MESSAGES.....</b>	<b>21</b>
<b>18. TROUBLESHOOTING .....</b>	<b>22</b>

# 1. IMPORTANT SAFEGUARDS

When using electrical appliances, basic safety precautions should always be followed, including the following.

- Read all instructions carefully.
- Make sure the voltage of your electrical system corresponds to the voltage shown on the bottom of the machine.
- Do not touch hot surfaces. Use handles or knobs.
- To protect against fire, electrical shock and personal injury, do not immerse cord, plug or appliance in water or other liquid.
- Keep the appliance out of the reach of children and do not leave appliance unattended while in operation.
- Unplug from the outlet when not in use and before cleaning.
- Do not operate with a damaged cord or plug, or after the appliance malfunctions, or has been damaged in any manner. Return the appliance to the nearest authorized service facility for examination, repair or adjustment.
- The use of accessory attachments not recommended by the manufacturer may result in fire, electrical shock, or personal injury.
- Do not use outdoors.
- Make sure the power cord does not hang over the edge of the table or counter-top to avoid getting accidentally caught or entangled.
- Do not place the appliance or its electrical parts on or near electric stoves, cooking surfaces, or gas burners.
- Plug cord into the wall outlet. To disconnect, first turn machine "off", then remove plug from wall outlet.
- Do not use the appliance for other than the intended use. This appliance is to be utilized for domestic use only. The manufacturer declines all responsibility for any damage caused by improper, incorrect, or irresponsible use.

**WARNING: To reduce the risk of fire or electric shock, do not remove the cover or the exterior of the unit. Don't attempt to repair or modify the machine, doing so will void the warranty. Repair should be done by authorized service personnel only!**

## SAVE THESE INSTRUCTIONS

THIS APPLIANCE IS FOR HOUSEHOLD USE ONLY

### 1.1 Short cord instructions

- A short power cord is provided to reduce risks resulting from becoming entangled in or tripping over a longer cord.
- Longer, detachable power supply cords or extension cords are available and may be used if care is exercised in their use.
- If an extension cord is used, the marked electrical rating should be at least as great as the electrical rating of the appliance. If the appliance is provided with 3- wire, grounding type cord, the extension should be a GROUNDING TYPE 3 - WIRE CORD. The longer cord should be arranged so that it will not drape over the counter-top or table top where it can be pulled on by children or tripped over.
- Your product is equipped with a polarized alternating current line plug (a plug having one blade wider than the other). This plug will fit into the power outlet only one way. This is a safety feature. If you are unable to insert the plug fully into the outlet, try reversing the plug. If the plug should still fail to fit, contact your electrician to replace your obsolete outlet. Do not defeat the safety purpose of the polarized plug.



## 2. INTRODUCTION

Thank you for choosing the ECAM2346X automatic coffee and cappuccino maker.

We hope you enjoy using your new appliance.

Take a few minutes to read these instructions.

This will avoid all risks and damage to the machine.

### 2.1 Symbols used in these instructions

Important warnings are identified by these symbols.

It is vitally important to observe these warnings.



#### **Danger!**

Failure to observe the warning could result in life threatening injury from electric shock.



#### **Important!**

Failure to observe the warning could result in injury or damage to the appliance.



#### **Danger of burns!**

Failure to observe the warning could result in scalds.



#### **Please note:**

This symbol identifies important advice or information for the user.

### 2.2 Letters in brackets

The letters in brackets refer to the legend in the Description of the Appliance on page 3.

### 2.3 Troubleshooting and repairs

In the event of problems, first try and resolve them following the information given in the section "17. Displayed messages" and "18. Troubleshooting".

If this does not resolve the problem or you require further information, you should consult Customer Experience by calling the number given on the annexed "Customer Experience" sheet. If your country is not among those listed on the sheet, call the number given in the guarantee.

If repairs are required, contact De'Longhi Customer Experience only.

Contact details are given in the guarantee certificate provided with the appliance.

### 2.4 Video instruction manual available on:

<http://ecam23460.delonghi.com>

## 3. DESCRIPTION

### 3.1 Description of the appliance







(page 3 - A)

- A1. Control panel
- A2. Grinding adjustment dial
- A3. Cup shelf
- A4. Beans container lid
- A5. Pre-ground coffee funnel lid
- A6. Pre-ground coffee funnel
- A7. Beans container
- A8. Main switch
- A9. Water tank
- A10. Infuser door
- A11. Infuser
- A12. Hot water and steam connection nozzle
- A13. Coffee spouts (adjustable height)
- A14. Coffee grounds container
- A15. Condensate tray
- A16. Cup tray
- A17. Drip tray water level indicator
- A18. Drip tray
- A19. Cup light

### 3.2 Description of the control panel

(page 2 - B)

*A number of buttons on the panel have a double function. This is indicated in brackets in the description.*

- B1. Display: guides the user in using the appliance
- B2. Selection dial: turn to select the required quantity of coffee. *(When in the settings MENU, turn to select the required function)*
- B3.  button: turns the appliance on and off
- B4.  button to access the menu
- B5.  button: to perform a rinse cycle.  
*(When in the settings MENU, it acts as the "ESC" button to exit from the selected function and go back to the main menu)*
- B6.  aroma selection button: to select the coffee taste
- B7.  button: to make 1 cup of coffee with the settings displayed
- B8.  button: to make 2 cups of coffee with the settings displayed
- B9.  button to deliver hot water *(When in the MENU, it acts as the "OK" button to confirm the selection made)*
- B10. CAPPUCCINO button: to prepare cappuccino or frothed milk

### 3.3 Description of the accessories

(page 2 - C)

- C1. Indicator paper
- C2. Pre-ground coffee measure
- C3. Descaler
- C4. Water softener filter (certain models only)
- C5. Cleaning brush
- C6. Hot water spout

### 3.4 Description of the milk container

(page 2 - D)

- D1. Froth adjustment and CLEAN dial
- D2. Milk container lid
- D3. Milk container
- D4. Milk intake tube
- D5. Frothed milk spout (adjustable)

## 4. BEFORE USE

### 4.1 Checking the appliance

After removing the packaging, make sure the product is complete and undamaged and that all accessories are present. Do not use the appliance if it is visibly damaged. Contact De'Longhi Customer Services.

### 4.2 Installing the appliance



#### **Important!**

When you install the appliance, you should respect the following safety warnings:

- The appliance gives off heat. After positioning the appliance on the worktop, leave a space of at least 3 cm between the surfaces of the appliance and the side and rear walls and at least 15 cm above the coffee maker.
- Water penetrating the coffee maker could cause damage. Do not place the appliance near taps or sinks.
- The appliance could be damaged if the water it contains freezes.  
Do not install the appliance in a room where the temperature could drop below freezing point.
- Arrange the cord in such a way that it cannot be damaged by sharp edges or contact with hot surfaces (e.g. electric hot plates).

### 4.3 Connecting the appliance



#### **Important!**

Check that the mains power supply voltage corresponds to that indicated on the rating plate on the bottom of the appliance. Connect the appliance to an efficiently earthed and correctly installed socket with a minimum current rating of 10A only. If the power socket does not match the plug on the appliance, have the socket replaced with a suitable type by a qualified professional.

### 4.4 Setting up the appliance



#### **Please note:**

- Coffee has been used to factory test the appliance and it is therefore completely normal for there to be traces of coffee in the mill. The machine is, however, guaranteed to be new.  
You should customise water hardness as soon as possible following the instructions in section "14. Setting water hardness".

1. Connect the appliance to the mains electricity supply (fig. 1). Make sure the main switch (A8) at the back of the appliance is pressed (fig. 2);
2. Remove the water tank (A9), fill to the MAX line with fresh water (fig. 3A) then put back in the appliance (fig. 3B);  
You must first choose the language by turning the selection dial, or waiting until the languages scroll through on the display (B1) automatically at intervals of about 3 seconds:
3. When "English" appears on the display, press the  button (B9) (fig. 4) for a few seconds until "English set" is displayed;

Follow the instructions indicated on the appliance display:

4. "INSERT WATER SPOUT": Check that the hot water spout (C6) is inserted on the connection nozzle (A12) and place a container holding a minimum of 3,38 fl. oz. (100ml) underneath (fig. 5);
5. "HOT WATER Confirm?" appears on the display;
6. Press the  button to confirm (fig. 4). The appliance delivers water from the spout then goes off automatically.

The coffee machine is now ready for normal use.



#### **Please note:**

- The first time you use the coffee maker, you need to make 4/5 cups of coffee or 4/5 cappuccinos before it starts to give satisfactory results.
- When making the first 5-6 cappuccinos, it is normal to hear the noise of boiling water. After this, the noise becomes less.

- To enjoy your coffee even more and improve the performance of your appliance, we recommend installing a water softener filter (C4) as described in section "15. Water softener filter". If your model is not provided with a filter, you can request one from De'Longhi Customer Services.

## 5. TURNING THE APPLIANCE ON



### **Please note:**

Before turning the appliance on, make sure the main switch (A8) on the back of the appliance is pressed (fig. 2).

Each time the appliance is turned on, it performs an automatic preheat and rinse cycle which cannot be interrupted. The appliance is ready for use only after completion of this cycle.



### **Danger of burns!**

During rinsing, a little hot water comes out of the coffee spouts (A13) and is collected in the drip tray (A18) underneath. Avoid contact with splashes of water.

- To turn the appliance on, press the  button (B3) (fig. 6). The message "Heating up Please wait" appears on the display (B1).

When heating is complete, the message changes to "RINSING". As well as heating the boiler, this also heats the internal circuits by circulating hot water.

The appliance is at temperature when the message indicating the taste and quantity of coffee appears.

## 6. TURNING THE APPLIANCE OFF

Whenever the coffee machine is turned off after being used to make coffee, it performs an automatic rinse cycle.



### **Danger of burns!**

During rinsing, a little hot water flows from the coffee spouts (A13). Avoid contact with splashes of water.

- To turn the appliance off, press the  button (B3) (fig. 6);
- The message "Turning off Please wait" appears on the display (B1), then the appliance performs a rinse cycle and goes off (standby).



### **Please note!**

If you will not be using the appliance for some time, unplug from the mains socket:

- first turn the appliance off by pressing the  button (fig. 6);
- press the main switch (A8) (fig. 2).



### **Important!**

Never press the main switch while the appliance is on.

## 7. MENU SETTINGS

When you access the settings menu by pressing the **P** button (B4), the following menu items can be selected:

### 7.1 Descaling

For instructions on descaling, see section "13. Descaling".

### 7.2 Install filter



For instructions on how to install the filter (C4), see section "15.1 Installing the filter".

### 7.3 Replacing the filter

For instructions on how to replace the filter (C4), see section "15.2 Replacing the filter".

### 7.4 Adjust time

To adjust the time on the display (B1), proceed as follows:

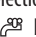
1. Press the **P** button (B4) to enter the menu;
2. Turn the selection dial (B2) (fig. 7) until "Adjust time" is displayed;
3. Press the  button (B9) (fig. 3);
4. Turn the selection dial to change the hours;
5. Press the  button to confirm;
6. Turn the selection dial to change the minutes;
7. Press the  button to confirm.

The time is set: press the  button (B5) to exit the menu.

### 7.5 Auto-start





You can set the auto-start time in order to have the appliance ready at a certain time (for example in the morning) so you can make coffee immediately.



### **Please note:**

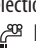

To enable this function, the time must already be set correctly.

To enable auto-start, proceed as follows:

1. Press the **P** button (B4) to enter the menu;
2. Turn the selection dial (B2) (fig. 7) until "Auto-start" appears on the display (B1);
3. Press the  button (B9). "Enable?" appears on the display;
4. Press the  button to confirm;
5. Turn the selection dial to choose the hours;
6. Press the  button to confirm;
7. Turn the selection dial to change the minutes;
8. Press the  button to confirm;
9. Press the  button (B5) to exit the menu.

Once the time has been confirmed, activation of auto-start is indicated by the  symbol displayed alongside the time and under "Auto-start" in the menu.



To disable the function:

1. Select auto-start from the menu;
  2. Press the  button. "Disable?" is displayed;
  3. Press the  button to confirm.
- The  symbol is no longer displayed.

## 7.6 Auto-off

The time can be changed so that the appliance switches off after 15 or 30 minutes, or after 1, 2 or 3 hours.

To re-programme Auto-off, proceed as follows:

1. Press the **P** button (B4) to enter the menu;
2. Turn the selection dial (B2) (fig. 7) until "Auto-off" appears on the display (B1);
3. Press the  button (B9);
4. Turn the selection dial until the required operating time (15 or 30 minutes, or 1, 2 or 3 hours) is displayed;
5. Press the  button to confirm;
6. Press the  button (B5) to exit the menu.



Auto-off is now programmed.

## 7.7 Energy saving

Use this function to enable or disable energy saving. When enabled, the function reduces energy consumption in compliance with European regulations.

When energy saving mode is active, an asterisk appears under "Energy Saving" in the menu.

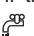
To enable or disable energy saving, proceed as follows:

1. Press the **P** button (B4) to enter the menu;
2. Turn the selection dial (B2) (fig. 7) until "Energy Saving" appears on the display (B1);
3. Press the  button (B9). "Disable?" is displayed (or "Enable?" if the function has already been disabled);
4. Press the  button to disable energy saving mode;
5. Press the  button (B5) to exit the menu.

When the function is active, if the machine is not used for some time, "Energy saving" is displayed.





### **Please note!**

- When in energy saving mode, a few seconds elapse before the first coffee, cappuccino or milk-based drink is delivered as the appliance must heat up again.
- To prepare any drink, press any button to exit energy saving, then press the button corresponding to the drink you want to make.
- If the milk container (D) is inserted, "Energy Saving" cannot be activated.

## 7.8 Setting the temperature

To modify the temperature of the water used to make the coffee, proceed as follows:



1. Press the **P** button (B4) to enter the menu;
2. Turn the selection dial (B2) (fig. 7) until "Set temperature" appears on the display (B1);
3. Press the  button (B9);
4. Turn the selection dial until the required temperature (●=low; ●●●●=high) appears on the display;
5. Press the  button to confirm;
6. Press the  button (B5) to exit the menu.

## 7.9 Setting water hardness

For instructions on setting water hardness, see section "14. Setting water hardness".

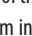

## 7.10 Enable/disable the beep

This enables or disables the beep emitted by the machine each time the buttons are pressed or an accessory is inserted/removed. The beep is active by default. To disable or re-enable the beep, proceed as follows:

1. Press the **P** button (B4) to enter the menu;
2. Turn the selection dial (B2) (fig. 7) until "Beep" appears on the display (B1);
3. Press the  button (B9). "Disable?" or "Enable?" is displayed;
4. Press the  button to enable or disable the beep;
5. Activation of the beep is indicated by an asterisk below the "Beep" item in the menu. Press the  button (B5) to exit the menu.

## 7.11 Setting the language

To modify the language of the display (B1), proceed as follows:



1. Press the **P** button (B4) to enter the menu;
2. Turn the selection dial (B2) (fig. 7) until "Set language" is displayed;
3. Press the  button (B9);
4. Turn the selection dial until the required language appears on the display;
5. Press the  button to confirm;
6. A message confirming the language installed is displayed;
7. Press the  button (B5) to exit the menu.

## 7.12 Cup light

This function enables or disables the cup lights. The lights are enabled by default.

The lights come on each time coffee and cappuccino is made and during each rinsing cycle.



To disable or enable this function, proceed as follows:

1. Press the **P** button (B4) to enter the menu;
2. Turn the selection dial (B2) (fig. 7) until "Cup lighting" appears on the display (B1);
3. Press the  button (B9). "Disable?" or "Enable?" appears on the display (B1);
4. Press the  button to enable or disable the cup lighting;
5. When the function is active, an asterisk appears under "Cup lighting" in the menu. Press the  button (B5) to exit the menu.

### 7.13 Default values (reset)



This resets all menu settings and programmed quantities back to the default values (with the exception of the language which remains as set).

To reset the default values, proceed as follows:

1. Press the **P** button (B4) to enter the menu;
2. Turn the selection dial (B2) (fig. 7) until "Default values" appears on the display;
3. Press the  button (B9);
4. The message "Confirm?" is now displayed;
5. Press the  button to confirm and exit.

### 7.14 Statistics function

This displays statistics relating to the machine. To display, proceed as follows:

1. Press the **P** button (B4) to enter the menu;
2. Turn the selection dial (B2) (fig. 7) until "Statistics" appears on the display (B1);
3. Press the  button (B9);
4. Turn the selection dial to verify:
  - how many coffees have been made;
  - the total number of cappuccinos and milk-based coffees made;
  - the total number of litres of water delivered;
  - how many times the machine has been descaled;
  - how many times the water softener filter has been replaced.
5. Press the  button (B5) twice to exit the menu.

## 8. RINSING

Use this function to deliver hot water from the coffee spouts (A13) and hot water spout (C6), if inserted, to clean and heat the appliance's internal circuit.

Place a container with a minimum capacity of 3,38 fl. oz./100ml under the coffee and hot water spouts (fig. 5).



**Important! Danger of burns.**

Do not leave the appliance unattended while hot water is being delivered.

- 1) To enable this function, press the button  (B5). "RINSING, Please wait" appears on the display (B1);
- 2) After a few seconds, hot water is delivered first from the coffee spouts, then from the hot water spout (if inserted) to clean and heat the appliance's internal circuit. "RINSING" appears on the display, together with a progress bar which fills gradually as preparation proceeds;
- 3) To stop the process press any button or wait for delivery of water to stop automatically.



#### **Please note!**

- If the appliance is not used for more than 3-4 days, when switched on again, we strongly recommend performing 2/3 rinses before use;
- After cleaning, it is normal for the coffee grounds container (A13) to contain water.

## 9. MAKING COFFEE

### 9.1 Selecting the coffee taste

The appliance is set by default to make coffee with a standard taste.

You can also choose one of these tastes:

Extra-mild taste

Mild taste

Standard taste

Strong taste

Extra-strong taste

To change the taste, press the aroma selection button  (B6) (fig. 8) repeatedly until the required taste appears on the display (B1).



### 9.2 Selecting the quantity of coffee in the cup

The appliance is set by default to make a standard quantity of coffee. To select the quantity of coffee, turn the selection dial (B2) (fig. 7) until the message corresponding to the required quantity of coffee appears on the display (B1):

Coffee selected	Quantity in cup (fl. oz.)/(ml)
MY COFFEE	Programmable: from $\approx 0,62/20$ to $\approx 6,07/180$
SHORT	$\approx 1,35/40$
STANDARD	$\approx 2,03/60$
LONG	$\approx 3,04/90$
EXTRA LONG	$\approx 4,06/120$

### 9.3 Customising the "my coffee" quantity

The appliance is set by default to automatically deliver 1,01 fl.oz. / 30ml of "my coffee". To modify this quantity, proceed as follows:

1. Place a cup under the coffee spouts (A13) (fig. 9);
2. Turn the selection dial (B2) (fig. 7) until "MY COFFEE" is displayed;
3. Press and hold the  button (B7) (fig. 10) until the message "1 MY COFFEE Program quantity" appears on the display (B1) and coffee delivery begins. Then release the button;
4. As soon as the coffee in the cup reaches the required level, press the  button (fig. 10) again.

The quantity of coffee in the cup has now been programmed.

### 9.4 Adjusting the coffee mill

The coffee mill is set by default to prepare coffee correctly and should not require regulating initially.

However, if after making the first few coffees you find that the coffee is either too weak and not creamy enough or delivery is too slow (a drop at a time), this can be corrected by adjusting the grinding adjustment dial (A2) (fig. 11).



#### **Please note:**

The grinding adjustment dial must only be turned when the coffee mill is in operation.



If the coffee is delivered too slowly or not at all, turn one click clockwise towards 7. For fuller bodied creamier coffee, turn one click anticlockwise towards 1 (do not turn more than one click at a time otherwise the coffee could be delivered a drop at a time).

These adjustments will only be evident after at least 2 cups of coffee have been delivered. If this adjustment does not obtain the desired result, turn the dial another click.

### 9.5 Tips for a hotter coffee

For hotter coffee, you should:



- perform a rinse cycle before delivery by pressing the  button (B5), as described in section "9. making coffee";
- warm the cups with hot water using the hot water function (see section "11. Hot water");
- select the "high" coffee temperature in the menu (see section "7.8 Setting the temperature").

### 9.6 Making coffee using coffee beans





#### **Important!**

Do not use caramelised or candied coffee beans as they could stick to the coffee mill and make it unusable.

1. Fill the container (A7) (fig. 12) with coffee beans;
2. Place under the coffee spouts (A13):
  - 1 cup, if you want to make 1 coffee (fig. 9);
  - 2 cups if you want 2 coffees.
3. Lower the spouts as near as possible to the cup. This makes a creamier coffee (fig. 13);
4. Press the button corresponding to the number of coffees required (1 cup  B7 or 2 cups  B8) (figs. 10 and 14);
5. Preparation begins. The amount of coffee selected appears on the display (B1) together with a progress bar which gradually fills as preparation progresses.

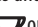

#### **Please note:**

- While the machine is making coffee, delivery can be interrupted at any moment by pressing any button.
- At the end of delivery, to increase the quantity of coffee in the cup, just press and hold (within 3 seconds) one of the coffee buttons ( or ).

Once the coffee has been made, the appliance is ready to make the next drink.



#### **Please note:**

- Various alarm messages could be displayed while using the appliance (FILL TANK, EMPTY GROUNDS CONTAINER, ETC.). Their meaning is explained in section "17. Displayed messages".
- For hotter coffee, see section "9.5 Tips for a hotter coffee".
- If the coffee is delivered a drop at a time, too weak and not creamy enough or too cold, read the tips in section "18. Troubleshooting".

### 9.7 Making coffee using pre-ground coffee



#### **Important!**

- Never add pre-ground coffee when the machine is off or it could spread through the inside of the machine and dirty it. This could damage the appliance.
- Never use more than 1 level measure (C2) or it could dirty the inside of the coffee machine or block the funnel (A6).



#### **Please note:**

If you use pre-ground coffee, you can only make one cup of coffee at a time.

1. Press the  button (B6) (fig. 8) until "Pre-ground" appears on the display (B1).
2. Make sure the funnel is not blocked, then add one level measure of pre-ground coffee (fig. 15).
3. Place a cup under the coffee spouts (A13) (fig. 9).

- Press the 1 cup coffee button  (B7)(fig. 10).
- Preparation begins. The amount of coffee selected appears on the display together with a progress bar which gradually fills as preparation progresses.

**i Please note:**

If "Energy Saving" mode is active, you may have to wait a few seconds before the first coffee is delivered.

## 10. MAKING CAPPUCCINOS AND MILK-BASED COFFEES

**i Please note:**

- To avoid milk with poor froth or large bubbles, always clean the milk container lid (D2) and hot water connection nozzle (A12) as described in sections "10.6 Cleaning the milk container after use", "12.10 Cleaning the milk container" and "12.11 Cleaning the hot water/steam connection nozzle".

### 10.1 Filling and attaching the milk container



- Remove the lid (D2) (fig. 16);
- Fill the milk container (D3) with a sufficient quantity of milk, not exceeding the MAX level marked on the container (fig. 17). Each mark on the side of the container corresponds to 100ml of milk;

**i Please note:**

- For a denser more even froth, you must use skimmed or partially skimmed milk at refrigerator temperature (about 5°C).
  - If "Energy Saving" mode is enabled, you may have to wait a few seconds before the first cappuccino is delivered.
- Make sure the milk intake tube (D4) is correctly inserted in the bottom of the milk container lid (fig. 18);
  - Place the lid back on the milk container;
  - Remove the hot water spout (C6) from the connection nozzle (A12) (fig. 19);
  - Attach the container to the connection nozzle and push as far as it will go (fig. 20). The machine emits a beep (if enabled);
  - Place a sufficiently large cup under the coffee spouts (A13) and frothed milk spout (D5). Adjust the length of the milk spout. To move it nearer the cup, simply pull it downwards (fig. 21);
  - Follow the instructions below for each function.

### 10.2 Adjusting the amount of froth

Turn the froth adjustment dial (D1) to adjust the amount of froth on the milk delivered while making cappuccinos and milk-based coffees.

Dial position	Description	Recommended for...
	No froth	HOT MILK
	Min. froth	CAPPUCCINO / LATTE MACCHIATO / FROTHED MILK
	Max. froth	

### 10.3 Making cappuccino or latte macchiato

- After attaching the milk container (D), turn the froth adjustment dial (D1) on the milk container lid (D2) to the required position (fig. 22);
- Press the CAPPUCCINO button (B10). "CAPPUCCINO" appears on the display (B1), together with a progress bar which fills gradually as preparation proceeds;
- After delivering the milk, the machine automatically makes the coffee.

**i Please note:**

- If during delivery you want to stop making milk or coffee, press the CAPPUCCINO button twice.
- At the end of delivery, to increase the quantity of milk or coffee in the cup press and hold (within 3 seconds) the CAPPUCCINO button.
- Do not leave the milk container out of the refrigerator for long periods. The warmer the milk (5°C is ideal), the poorer the quality of froth produced.

### 10.4 Making frothed milk (without coffee)

Proceed as described in the previous section "10.3 Making cappuccino or latte macchiato", pressing the CAPPUCCINO button (B10) twice instead of once.

**i Please note:**

If during delivery you want to stop preparation, press the CAPPUCCINO button once.

### 10.5 Preparing milk (unfrothed and without coffee)

Proceed as described in the previous section ("10.4 Making frothed milk (without coffee)", turning the froth adjustment dial (D1) to the  position.



## 10.6 Cleaning the milk container after use



### **Important! Danger of burns**

When cleaning the internal tubes of the milk container (D), a little hot water and steam leak out of the milk spout (D5). Avoid contact with splashes of water.

"SET DIAL TO CLEAN" appears on the display (B1) each time you use a milk function. To eliminate all milk residues, proceed as follows:

1. Leave the milk container (D) in the machine (you do not need to empty it);
2. Place a cup or other recipient under the frothed milk spout (fig. 21);
3. Turn the froth adjustment dial (D1) to "CLEAN" (fig. 23). A progress bar appears on the display and gradually fills as the operation proceeds together with the message "Cleaning underway, Please wait". Cleaning stops automatically;
4. Turn the dial back to one of the froth selections;
5. Remove the milk container and always clean the steam connection nozzle (A12) with a sponge (fig. 24).



### **Please note!**

- To prepare a number of cappuccinos or milk-based coffees, clean the milk container after you have prepared the last drink only.
- The milk container can be kept in the refrigerator.
- In some cases, before cleaning you must wait for the appliance to heat up.

## 10.7 Programming the quantity of coffee and milk in the cup for cappuccino or milk

The appliance is set by default to automatically deliver standard quantities. To change these quantities, proceed as follows:

1. Place a cup under the coffee spouts (A13) and milk spout (D5) (fig. 21);
2. Press and hold the CAPPUCCINO BUTTON (B10) until the message "PROGRAM MILK Program Quantity" appears on the display (B1);
3. Release the button. The appliance starts delivering milk;
4. Once the required quantity of milk has been delivered into the cup, press the CAPPUCCINO button again;
5. The appliance stops delivering milk and after a few seconds the coffee is delivered into the cup. "PROGRAM COFFEE Program quantity" is displayed;
6. Once the required quantity of coffee has been delivered into the cup, press the CAPPUCCINO button again. Coffee delivery stops.



The machine is now reprogrammed with the new milk and coffee quantities.

## 11. HOT WATER



### **Important! Danger of burns.**

Never leave the machine unattended while delivering hot water. The hot water spout (C6) becomes hot during delivery. Hold by the handle only.

1. Make sure the hot water spout is attached correctly;
2. Place a container under the spout (as close as possible to avoid splashes);
3. Press the  button (B9) (fig. 4). "HOT WATER" appears on the display (B1), together with a progress bar which fills gradually as preparation proceeds;
4. The machine delivers about 8,45 fl.oz./250ml of hot water, then delivery stops automatically. To interrupt delivery of hot water manually, press the  button again.





### **Please note:**

If "Energy Saving" mode is active, you may have to wait a few seconds before hot water is delivered.

## 11.1 Changing the quantity of water delivered automatically

The machine is set by default to automatically deliver about 250ml of hot water. To modify these quantities, proceed as follows:

1. Position a container under the hot water spout (C6);
2. Press and hold the  button (B9) until "HOT WATER Program Quantity" appears on the display (B1), then release the  button.
3. When the hot water in the cup reaches the required level, press the  button again.

The machine is now reprogrammed with the new quantity.

## 12. CLEANING

### 12.1 Cleaning the machine

The following parts of the machine must be cleaned regularly:

- the appliance's internal circuit;
- coffee grounds container (A14);
- drip tray (A18) and condensate tray (A15);
- water tank (A9);
- coffee spouts (A13);
- pre-ground coffee funnel (A6);
- infuser (A11), accessible after opening the infuser door (A10);
- milk container (D);
- hot water/steam connection nozzle (A12);



### **Important!**

- Do not use solvents, abrasive detergents or alcohol to clean the coffee machine. With De'Longhi superautomatic coffee





machines, you need not use chemical products to clean the machine.

- None of the components of the appliance can be washed in a dishwasher with the exception of the milk container (D).
- Do not use metal objects to remove encrustations or coffee deposits as they could scratch metal or plastic surfaces.

## 12.2 Cleaning the machine's internal circuit

If the appliance is not used for more than 3/4 days, before using it again, we strongly recommend switching it on and:

- performing 2/3 rinse cycles by pressing the  button (B5);
- delivering hot water for a few seconds by pressing the  button (B9).

## 12.3 Cleaning the coffee grounds container

When "EMPTY GROUNDS CONTAINER" appears on the display (B1), the grounds container must be emptied and cleaned. The appliance cannot be used to make coffee until you have cleaned the grounds container (A14). Even if not full, the empty grounds container message is displayed 72 hours after the first coffee has been prepared. For the 72 hours to be calculated correctly, the machine must never be turned off with the main switch.



### **Important! Danger of burns**

If you make a number of cappuccinos one after the other, the metal cup tray (A16) becomes hot. Wait for it to cool down before touching it and handle from the front only.

To clean (with the machine on):

- Remove the drip tray (A18) (fig. 25), empty and clean.
- Empty the grounds container (A14) and clean thoroughly to remove all residues left on the bottom. This can be done with the spatula on the brush (C5) provided.
- Check the condensate tray (A15) (red) and empty if necessary.



### **Important!**

When removing the drip tray, the grounds container must be emptied, even if it contains few grounds.

If this is not done, when you make the next coffees, the grounds container may fill up more than expected and clog the machine.



### **Please note:**

After cleaning, it is normal for the coffee grounds container to contain water.

## 12.4 Cleaning the drip tray and condensate tray



### **Important!**

The drip tray (A18) is fitted with a level indicator (A17) (red) showing the level of water it contains (fig. 26). Before the in-

dicator protrudes from the cup tray (A16), the drip tray must be emptied and cleaned otherwise the water may overflow the edge and damage the appliance, the surface it rests on or the surrounding area.

To remove the drip tray:

1. Remove the drip tray and the coffee grounds container (A14) (fig. 25);
2. Empty the drip tray and grounds container and wash them;
3. Check the red condensate tray (A15) and empty if necessary;
4. Replace the drip tray and grounds container.

## 12.5 Cleaning the inside of the coffee machine



### **Danger of electric shock!**

Before cleaning internal parts, the machine must be turned off (see section "6. Turning the appliance off") and unplugged from the mains power supply. Never immerse the coffee machine in water.

1. Check regularly (about once a month) that the inside of the appliance (accessible after removing the drip tray (A18)) is not dirty. If necessary, remove coffee deposits with the brush (C5) supplied and a sponge;
2. Remove all the residues with a vacuum cleaner (fig. 27).

## 12.6 Cleaning the water tank

1. Clean the water tank (A9) regularly (about once a month and whenever you replace the water softener filter (C4) (if provided)) with a damp cloth and a little mild washing up liquid;
2. Remove the filter (C4) (if present) and rinse with running water;
3. Replace the filter (if provided), fill the tank with fresh water and replace the tank;
4. (Models with water softener filter only) Deliver about 100ml of water.

## 12.7 Cleaning the coffee spouts

1. Clean the coffee spouts (A13) regularly with a sponge or cloth (fig. 28A);
2. Check that the holes in the coffee spouts are not blocked. If necessary, remove coffee deposits with a toothpick (fig. 28B).

## 12.8 Cleaning the pre-ground coffee funnel

Check regularly (about once a month) that the pre-ground coffee funnel (A6) is not blocked.

If necessary, remove coffee deposits with the brush (C5) supplied.

## 12.9 Cleaning the infuser

The infuser (A11) must be cleaned at least once a month.



The infuser may not be extracted when the machine is on.

1. Make sure the machine is correctly turned off (see "6. Turning the appliance off");
2. Remove the water tank (A9);
3. Open the infuser door (A10) (fig. 29) on the right side of the appliance (fig. 29);
4. Press the two coloured release buttons inwards and at the same time pull the infuser outwards (fig. 30);
5. Soak the infuser in water for about 5 minutes, then rinse under the tap;

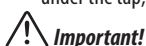

**RINSE WITH WATER ONLY**

**NO WASHING UP LIQUID - NO DISH WASHER**

Clean the infuser without using washing up liquid as it could be damaged.

6. Use the brush (C5) to remove any coffee residues left in the infuser housing, visible through the infuser door;
7. After cleaning, replace the infuser by sliding it onto the internal support, then push the PUSH symbol fully in until it clicks into place;



If the infuser is difficult to insert, before insertion, adapt it to the right size by pressing the two levers (fig. 31).

8. Once inserted, make sure the two coloured buttons have snapped out;
9. Close the infuser door;
10. Put the water tank back.

## 12.10 Cleaning the milk container

Clean the milk container (D) each time you prepare milk as described below:

1. Remove the lid (D2);
2. Remove the milk spout (D5) and intake tube (D4) (fig. 32);

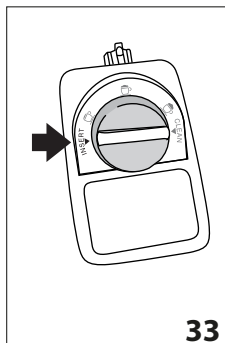

33

Make sure there are no milk residues on the hollow and groove under the dial (fig. 34). If necessary, scrape the groove with a toothpick;

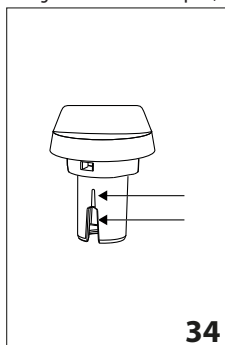

34

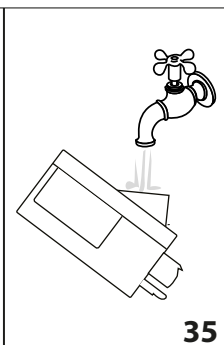

35

5. Rinse inside the froth adjustment dial seat with running water (fig. 35);
6. Check that the intake tube and milk spout are not clogged with milk residues;
7. Replace the dial (in correspondence to the word "INSERT"), spout and milk intake tube;
8. Place the lid back on the milk container (D3).

## 12.11 Cleaning the hot water/steam connection nozzle

Each time you prepare milk, clean the connection nozzle (A12) with a sponge to remove milk residues from the gaskets (fig. 24).



## 13. DESCALING

Descalc the machine when the message "DESCALE" flashes on the display (B1).



- Before use, read the instructions and the labelling on the descaler pack.

- You should use De'Longhi descaler only. Using unsuitable descaler and/or performing descaling incorrectly may result in faults not covered by the manufacturer's guarantee.

1. Turn the appliance on and wait until it is ready for use;
2. Press the **P** button (B4) to access the menu;
3. Turn the selection dial (B2) until "Descale" is displayed;
4. Select by pressing the  button (B9). "Descale Confirm?" appears on the display (B1). Press  again to enable the function;
5. "EMPTY DRIP TRAY" is displayed, alternating with "RE-MOVE FILTER" (if the filter is present) and "Add descaler Confirm?";
6. Empty the water tank (A9) completely and remove the water softener filter (C4) (if present). Empty the drip tray (A18) and grounds container (A14), then put them back in the appliance;
7. Pour the descaler into the tank up to level **A** (corresponding to a 3,40 fl. oz./100ml pack) marked on the side of the tank (fig. 36), then add water (33,85 fl.oz./1 litre) up to level **B** (fig. 36) and put the water tank back;

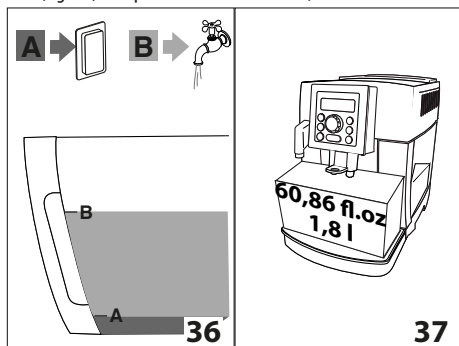



8. Place an empty container with a minimum capacity of 60,86 fl. oz / 1.8 litres under the coffee spouts (A13) and hot water spout (C6) (fig. 37).



#### **Important! Danger of burns**

Hot water containing acid flows out of the coffee spouts and hot water spout. Take care to avoid contact with splashes of this solution.

9. Press the  button to confirm that you have added the descaler solution. The message "Descale underway" is displayed and the descaling procedure begins. The descaler liquid comes out of the coffee spouts and hot water spout and a series of rinses and pauses is performed to remove limescale deposits from inside the machine;
- After about 25 minutes, descaling stops and the messages "RINSING" and "FILL TANK" alternate on the display.

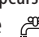
10. The appliance is now ready for rinsing through with clean water. Empty the container used to collect the descaler solution. Extract the water tank, empty, rinse under running water, fill with fresh water up to the MAX level and put back in the appliance: "RINSING, Confirm?" is displayed;
11. Place the container used to collect the descaler solution empty under the coffee spouts and hot water spout (fig. 37);
12. Press the  button to start rinsing. Hot water flows out of the spouts and the message "Rinsing Please wait" is displayed;
13. When the water tank is empty, the messages "RINSING", "FILL TANK" and "REPLACE FILTER" (if previously removed) alternate on the display;
14. Remove the water tank, replace the filter (if previously removed), fill the tank up to the MAX level with fresh water and insert it in the appliance: the display will show "RINSING Confirm?";
15. Place the container used to collect the rinsing water empty under the hot water spout;
16. Press the  button to restart rinsing: Hot water flows out of the hot water spout only and the message "RINSING Please wait" is displayed;
17. When it finishes, the message "Rinsing complete, Confirm?" appears on the display;
18. Press the  hot water button. The message "FILL TANK" is displayed;
19. Empty the drip tray, remove and top up the water tank with fresh water to the MAX level and put back in the machine.

Descaling is complete.



#### **Please note!**

- If the descaling cycle is not completed correctly (e.g. no electricity) we recommend repeating the cycle;
- After descaling, it is normal for the grounds container (A14) to contain water.

## **14. SETTING WATER HARDNESS**

The DESCAL message is displayed after a period of time established according to water hardness.

The machine is set by default for a hardness value of 4. The machine can also be programmed according to the hardness of the mains water in the various regions so that the machine needs to be descaled less often.

### **14.1 Measuring water hardness**

1. Remove the "TOTAL HARDNESS TEST" indicator paper (C1) from its pack (attached to the English instructions);

- Immerse the paper completely in a glass of water for one second;
- Remove the paper from the water and shake lightly. After about a minute, 1, 2, 3, or 4 red squares form, depending on the hardness of the water. Each square corresponds to one level;

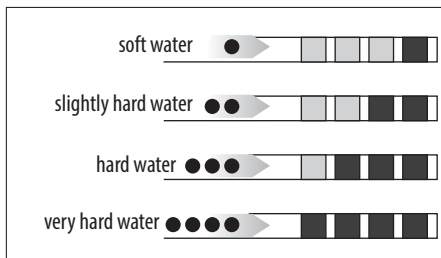

## 14.2 Setting water hardness

- Press the **P** button (B4) to enter the menu;
- Turn the selection dial (B2) to select "Water Hardness".
- Confirm the selection by pressing the button (B9);
- Turn the selection dial and set the level shown by the indicator paper (C1) (see previous section);
- Press the button to confirm the setting;
- Press the button (B5) to exit the menu.

The machine is now reprogrammed with the new water hardness setting.

## 15. WATER SOFTENER FILTER

Certain models are fitted with a water softener filter (C4). If this is not the case with your model, you are recommended to purchase one from De'Longhi Customer Services.

To use the filter correctly, follow the instructions below.

### 15.1 Installing the filter

- Remove the filter (C4) from the packaging;
- Turn the date indicator disk (see fig. 38) until the next two months of use are displayed;

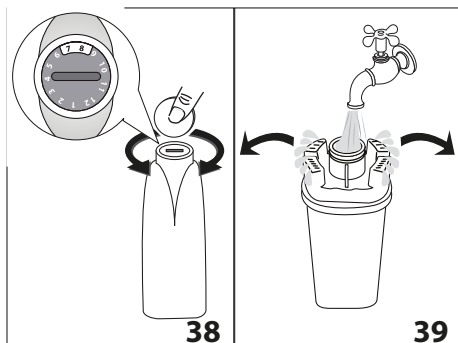

### Please note

The filter lasts about two months if the appliance is used normally. If the coffee machine is left unused with the filter installed, it will last a maximum of three weeks.

- To activate the filter, run tap water through the hole in the filter as shown in figure 39 until water comes out of the openings at the side for more than a minute.;
- Extract the tank (A9) from the appliance and fill with water;
- Insert the filter in the water tank and immerse it completely for about ten seconds, sloping it to enable the air bubbles to escape (fig. 40);

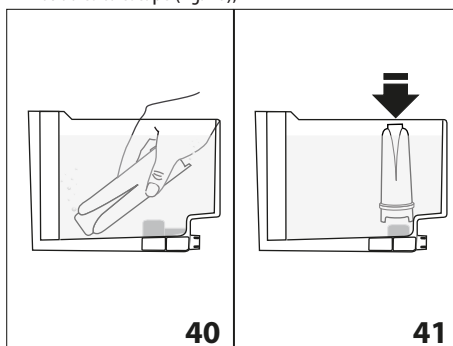

- Insert the filter in the filter housing and press as far as it will go (fig. 41);

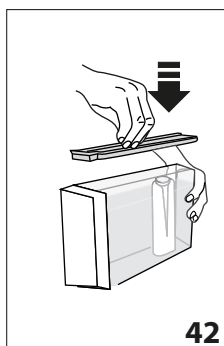

- Close the tank with the lid, then put the tank back in the machine (fig. 42);

When you install the filter, you must notify the appliance of its presence.



- Press the **P** button (B4) to enter the menu;
- Turn the selection dial (B2) (fig. 9) until "Install filter" appears on the display (B1);
- Press the button (B9);
- "Enable?" appears on the display;
- Press the button to confirm the selection. "HOT WATER Confirm?" is displayed;
- Position a container under the hot water spout (C6) (min. capacity: 16,9 fl.oz./500ml);
- Press the button to confirm the selection. The appliance begins hot water delivery and the message "Please wait" is displayed;

15. After the flow of hot water stops, the appliance automatically resets to "Ready for coffee" status.

The new filter is active and indicated by an asterisk displayed under "Install filter" in the menu. You can now use the appliance.

### 15.2 Replacing the filter



When "REPLACE FILTER" appears on the display (B1), after two months (see date indicator) or when the appliance has not been used for three weeks, you should replace the filter (C4):

1. Extract the tank (A9) and exhausted filter;
2. Take the new filter out of its packet and proceed as illustrated in points 2, 3, 4, 5 and 6 in the previous section;
3. Position a container with a minimum capacity of 16,9 fl.oz./500ml under the hot water spout;
4. Press the **P** button (B4) to enter the menu;
5. Turn the selection dial (B2) until "Replace filter" is displayed;
6. Press the  button (B9);
7. The message "Confirm?" is now displayed;
8. Press the  button to confirm the selection;
9. "HOT WATER Confirm?" is displayed;
10. Press the  button to confirm the selection. The appliance begins hot water delivery and the message "Please wait" is displayed;
11. After the flow of hot water stops, the appliance automatically resets to "Ready for coffee" status.

The new filter is now active and you can use the coffee machine.

### 15.3 Removing the filter

If you want to use the appliance without the filter (C4), you must remove it and notify the appliance of its removal. Proceed as follows:

1. Extract the tank (A9) and exhausted filter;
2. Press the **P** button (B4) to enter the menu;
3. Turn the selection dial (B2) (fig. 9) until "Install filter \*" appears on the display (B1);
4. Press the  button (B4);
5. "Disable?" appears on the display;
6. Press the  button to confirm and the  button (B5) to exit the menu.

### 16. TECHNICAL DATA

Voltage:	120 V ~ 60 Hz max. 10A
Power:	1250W
Pressure:	1.5MPa (15 bars)
Max. water tank capacity:	60,86 fl. oz/1.8 l
Size LxDxH:	240x430x350 mm
Cord length:	1350 mm
Weight:	342,15 oz/ 9.7 kg
Max. beans container capacity:	8.82 oz/ 250 g

## 17. DISPLAYED MESSAGES

DISPLAYED MESSAGE	POSSIBLE CAUSE	REMEDY
FILL TANK	Insufficient water in the tank (A9).	Fill the tank with water and/or insert it correctly, pushing it as far as it will go until it clicks into place (fig. 3).
EMPTY GROUNDS CONTAINER	The grounds container (A14) is full.	Empty the grounds container and drip tray (A18), clean and replace (fig. 25). Important: when removing the drip tray, the grounds container must be emptied, even if it contains few grounds. If this is not done, when you make the next coffees, the grounds container may fill up more than expected and clog the machine.
INSERT GROUNDS CONTAINER	After cleaning, the grounds container has not been replaced (A14).	Remove the drip tray (A18) and insert the grounds container.
ADD PRE-GROUND COFFEE	The "pre-ground coffee" function has been selected without placing any pre-ground coffee in the funnel (A6).	Place pre-ground coffee in the funnel (fig. 15) or deselect the "pre-ground" function.
GROUND TOO FINE ADJUST MILL	The grinding is too fine and the coffee is delivered too slowly or not at all.	Repeat coffee delivery and turn the grinding adjustment dial (A2) (fig. 11) one click clockwise towards 7 while the coffee mill is in operation. If after making at least 2 coffees delivery is still too slow, repeat the correction procedure, turning the grinding adjustment dial another click until delivery is correct (see section "9.4 Adjusting the coffee mill"). If the problem persists, make sure the water tank (A9) is fully inserted.
	If the water softener filter (C4) is present, an air bubble may have been released inside the circuit, obstructing delivery.	Insert the hot water spout (C6) in the appliance and deliver a little water until the flow becomes regular.
DESCALE	The machine must be descaled.	The descaling procedure described in section "13. Descaling" needs to be performed.
LESS COFFEE	Too much coffee has been used.	Select a milder taste by pressing the dial  (B6) (fig. 8) or reduce the quantity of pre-ground coffee.
FILL BEANS CONTAINER	The coffee beans have run out.	Fill the beans container (A7) (fig. 12).
	The pre-ground coffee funnel (A6) is clogged.	Empty the funnel with the help of the brush (C5) as described in section "12.8 Cleaning the pre-ground coffee funnel".
INSERT INFUSER ASSEMBLY	The infuser (A11) has not been replaced after cleaning.	Insert the infuser as described in section "12.9 Cleaning the infuser".
INSERT TANK	The tank (A9) is not correctly in place.	Insert the tank correctly and press as far as it will go (page 3B).

GENERAL ALARM	The inside of the appliance is very dirty.	Clean the inside of the appliance thoroughly, as described in section "12. Cleaning". If the message is still displayed after cleaning, contact a service centre.
REPLACE FILTER	The water softener filter (C4) is exhausted.	Replace the filter or remove it as described in the "Water softener filter" section.
SET DIAL TO CLEAN	Milk has been delivered recently and the tubes inside the milk container (D) must be cleaned.	Turn the froth adjustment dial (D1) to the CLEAN position.
INSERT WATER SPOUT	The hot water spout (C6) is not inserted or is inserted incorrectly.	Insert water spout as far as it will go.
INSERT MILK CONTAINER	The milk container (D) is not inserted correctly.	Insert the milk container (fig. 20) as far as it will go.
WATER CIRCUIT EMPTY FILL WATER CIRCUIT HOT WATER Confirm?	The water circuit is empty.	Press  (B9) to deliver water from the hot water spout (C6) until it flows out normally. If the problem persists, make sure the water tank (A9) is fully inserted.

## 18. TROUBLESHOOTING

Below is a list of some of the possible malfunctions.

If the problem cannot be resolved as described, contact Customer Services.

PROBLEM	POSSIBLE CAUSE	REMEDY
The coffee is not hot.	The cups were not preheated.	Warm the cups by rinsing them with hot water (Please note: you can use the hot water function).
	The internal circuits of the appliance have cooled down because 2/3 minutes have elapsed since the last coffee was made.	Before making coffee, rinse the internal circuits by pressing the  button (B5).
	A low coffee temperature is set.	Set a high coffee temperature in the menu.
The coffee is weak or not creamy enough.	The coffee is ground too coarsely.	Turn the grinding adjustment dial (A2) one click anticlockwise towards 1 while the coffee mill is in operation (fig. 11). Continue one click at a time until coffee delivery is satisfactory. The effect is only visible after delivering 2 coffees (see section "9.4 Adjusting the coffee mill").
	The coffee is unsuitable.	Use pre-ground coffee for espresso machines.
The coffee is delivered too slowly or a drop at a time.	The coffee is ground too finely.	Turn the grinding adjustment dial (A2) one click clockwise towards 7 while the coffee mill is in operation (fig. 11). Continue one click at a time until coffee delivery is satisfactory. The effect is only visible after delivering 2 coffees (see section "9.4 Adjusting the coffee mill").

Coffee does not come out of one or both of the spouts.	The coffee spouts (A13) are blocked.	Clean the spouts with a toothpick (fig. 28B).
The milk does not come out of the milk spout (D5)	The lid (D2) of the milk container lid is dirty	Clean the milk container lid as described in section "12.10 Cleaning the milk container".
The appliance does not come on	It is not plugged into the mains socket.	Plug into the mains socket.
	The main switch (A8) is not turned on.	Place the main switch in the I position (fig. 2).
The infuser cannot be extracted	The appliance has not been turned off correctly	Turn the appliance off by pressing the  button (B3) (fig. 6) (see section "6. Turning the appliance off").
The milk contains large bubbles and squirts out of the milk spout (D5) or there is little froth	The milk is not cold enough or is not semi-skimmed.	Use skimmed or semi-skimmed milk at refrigerator temperature (about 5° C). If the result is not as you wished, try changing brand of milk.
	The froth adjustment dial (D1) is incorrectly adjusted.	Adjust following the instructions in section "10.2 Adjusting the amount of froth".
	The milk container lid (D2) or froth adjustment dial (D1) is dirty	Clean the milk container lid and control knob as described in section "13. Descaling".
	The hot water/steam connection nozzle (A12) is dirty	Clean the connection nozzle as described in section "12.11 Cleaning the hot water/steam connection nozzle".