



---

ECAM23.21X

BEAN TO CUP ESPRESSO  
AND CAPPUCCINO  
MACHINE  
Instruction for Use



---

**DeLonghi**

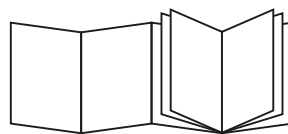

**B**

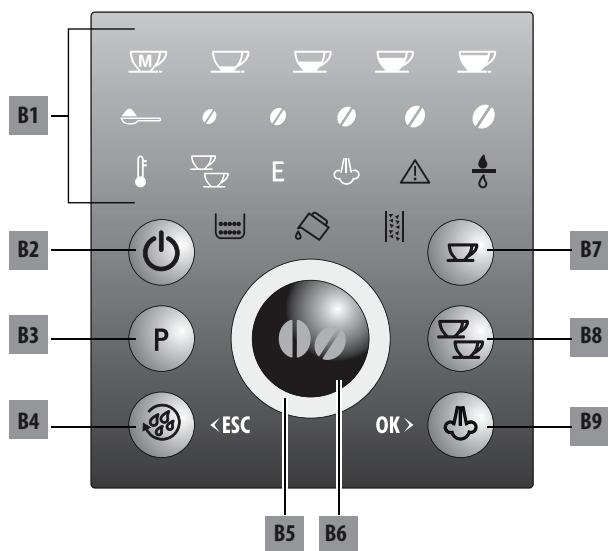

**C**

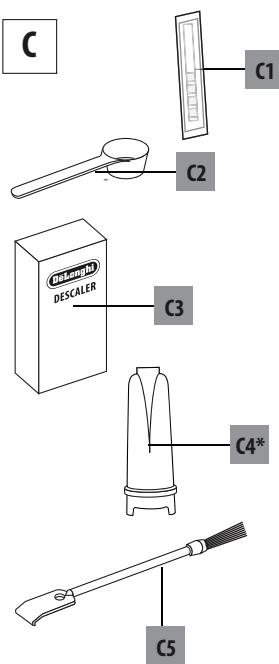

**A**

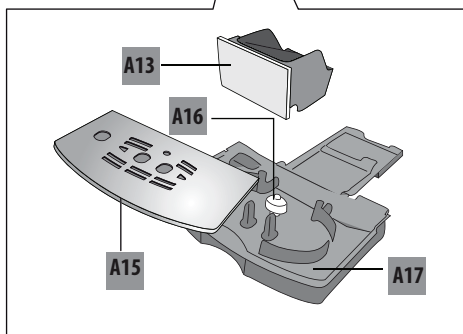
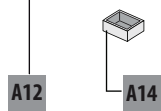
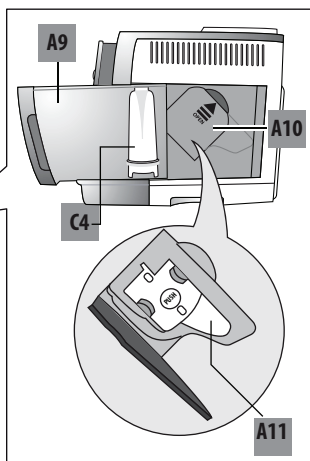
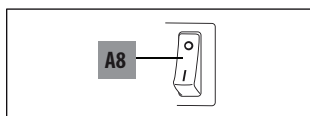
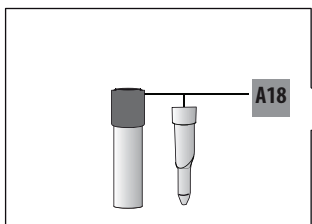
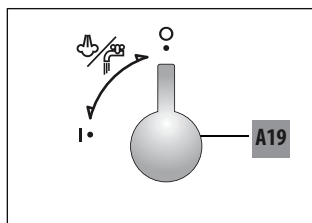
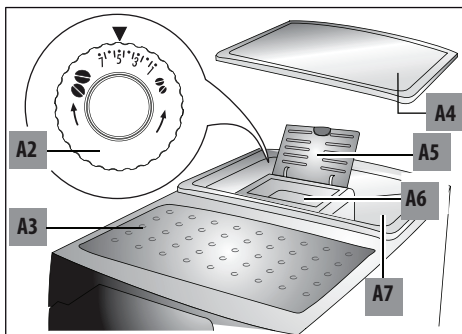

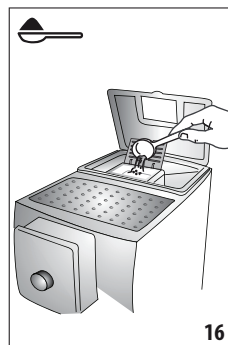
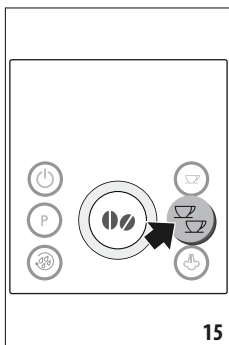
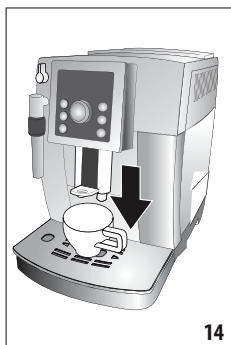
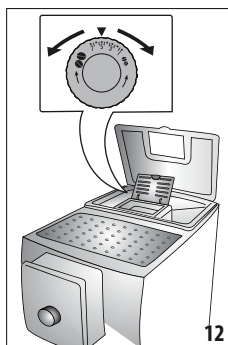
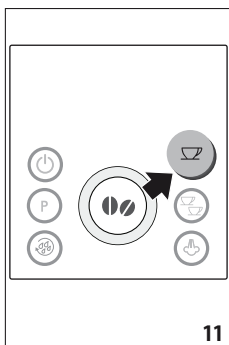
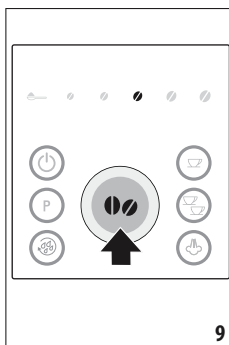
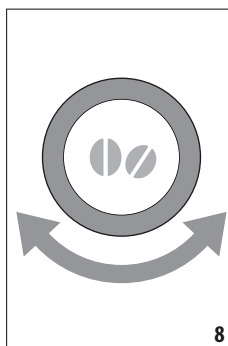
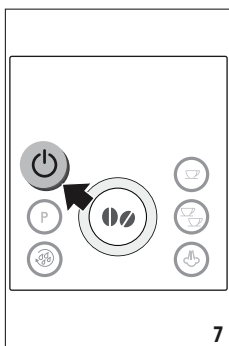
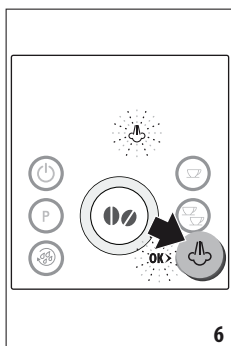
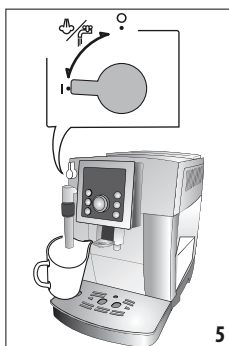
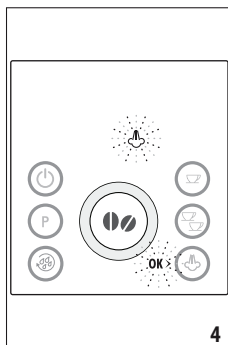
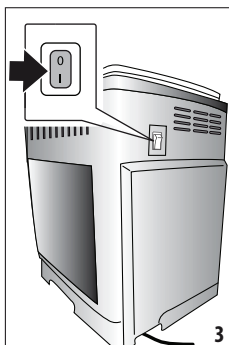
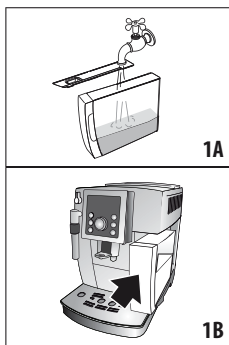

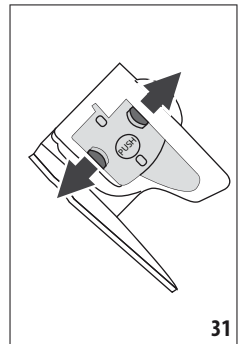
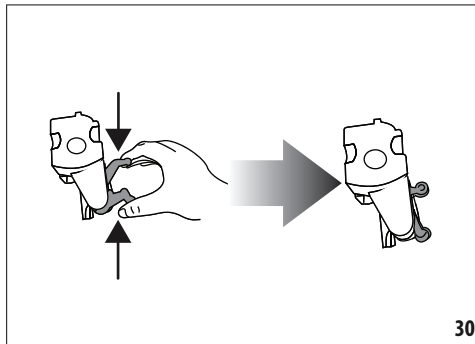
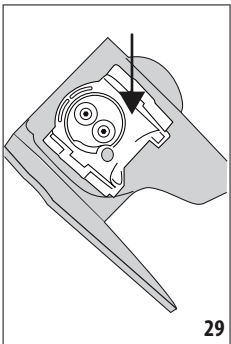
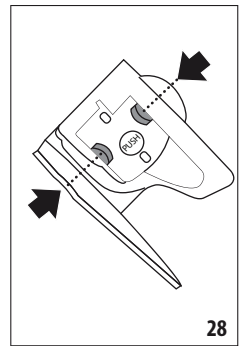
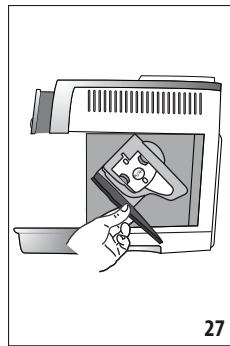
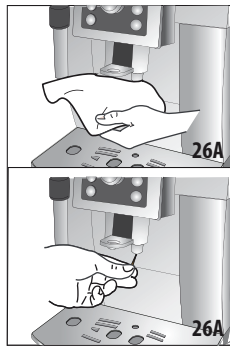
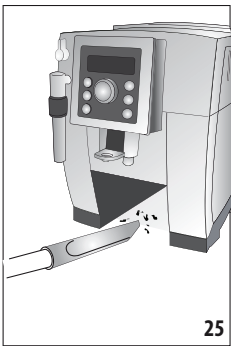
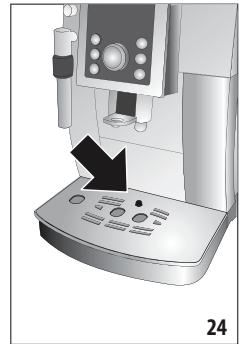
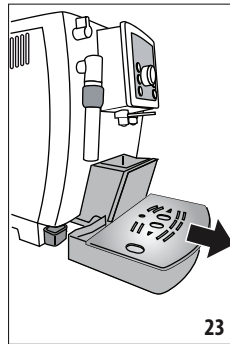
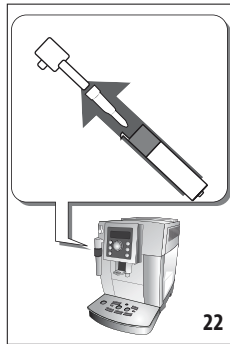
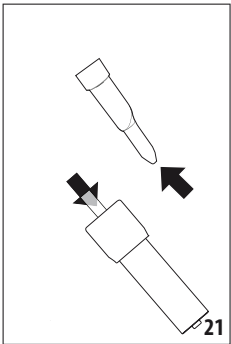
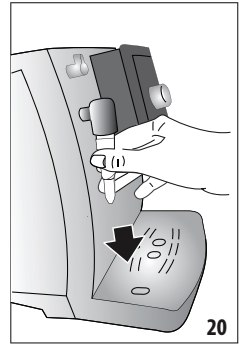
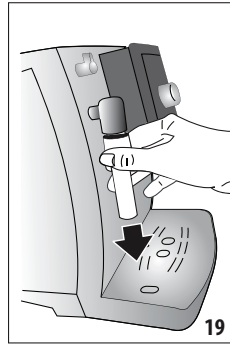
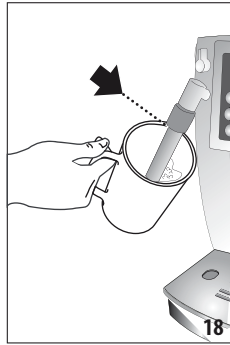
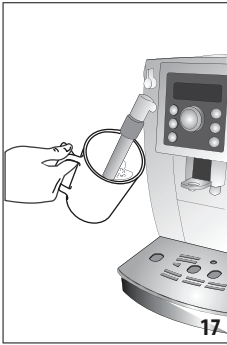

## CONTENTS

<b>1. FUNDAMENTAL SAFETY WARNINGS.....</b>	<b>7</b>
<b>2. SAFETY WARNINGS .....</b>	<b>8</b>
2.1 Symbols used in these instructions .....	8
2.2 Designated use.....	8
2.3 Instruction for Use.....	8
<b>3. INTRODUCTION.....</b>	<b>8</b>
3.1 Letters in brackets .....	8
3.2 Troubleshooting and repairs .....	8
<b>4. DESCRIPTION.....</b>	<b>9</b>
4.1 Description of the appliance .....	9
4.2 Description of the control panel .....	9
4.3 Description of the accessories .....	9
4.4 Description of lights .....	9
<b>5. BEFORE USE.....</b>	<b>9</b>
5.1 Checking the appliance .....	9
5.2 Installing the appliance.....	9
5.3 Connecting the appliance.....	10
5.4 Setting up the appliance .....	10
<b>6. TURNING THE APPLIANCE ON.....</b>	<b>10</b>
<b>7. TURNING THE APPLIANCE OFF .....</b>	<b>10</b>
<b>8. MENU SETTINGS .....</b>	<b>11</b>
8.1 Descaling .....	11
8.2 Auto-off .....	11
8.3 Set temperature .....	11
8.4 Energy saving.....	11
8.5 Setting water hardness .....	11
8.6 Install filter.....	11
8.7 Replacing the filter.....	11
8.8 Default values (reset) .....	11
8.9 Statistics function.....	11
<b>9. MAKING COFFEE.....</b>	<b>12</b>
9.1 Selecting the coffee taste.....	12
9.2 Selecting the quantity of coffee in the cup ..	12
9.3 Customising the “my coffee” quantity.....	12
9.4 Adjusting the thermostat.....	12
9.5 Tips for a hotter coffee.....	12
9.6 Making coffee using coffee beans .....	13
9.7 Making coffee using pre-ground coffee.....	13
<b>10. MAKING CAPPUCCINO .....</b>	<b>13</b>
10.1 Cleaning the cappuccino maker after use....	14
<b>11. HOT WATER .....</b>	<b>14</b>
<b>12. CLEANING.....</b>	<b>14</b>
12.1 Cleaning the machine .....	14
12.2 Cleaning the machine's internal circuit.....	14
12.3 Cleaning the coffee grounds container.....	14
12.4 Cleaning the drip tray and condensate tray..	15
12.5 Cleaning the inside of the coffee machine..	15
12.6 Cleaning the water tank .....	15
12.7 Cleaning the coffee spouts .....	15
12.8 Cleaning the pre-ground coffee funnel .....	15
12.9 Cleaning the infuser .....	15
<b>13. DESCALING.....</b>	<b>16</b>
<b>14. SETTING WATER HARDNESS .....</b>	<b>16</b>
14.1 Measuring water hardness .....	17
14.2 Setting water hardness .....	17
<b>15. WATER SOFTENER FILTER (IF PRESENT) .....</b>	<b>17</b>
15.1 Installing the filter .....	17
15.2 Replacing the filter.....	18
15.3 Removing the filter .....	18
<b>16. TECHNICAL DATA.....</b>	<b>18</b>
<b>17. DISPOSAL.....</b>	<b>18</b>
<b>18. EXPLANATION OF LIGHTS .....</b>	<b>19</b>
<b>19. TROUBLESHOOTING .....</b>	<b>21</b>
<b>20. ELECTRICAL CONNECTION (UK ONLY) .....</b>	<b>22</b>

## 1. FUNDAMENTAL SAFETY WARNINGS

---

- The appliance is not intended for use by persons (including children) with reduced physical, sensory or mental capabilities, or lack of experience and knowledge, unless they have been given supervision or instruction concerning use of the appliance by a person responsible for their safety.
- Children should be supervised to ensure that they do not play with the appliance.
- Cleaning and user maintenance shall not be made by children without supervision.
- Never clean by immersing the appliance in water.
- This is an household appliance only. It is not intended to be used in: staff kitchen areas in shops, offices and other working environments; farm houses; by clients in hotels, motels and other residential type environments; bed and breakfast type environments.
- If the plug or cord is damaged, it must be replaced by Customer Services only to avoid all risk.

### FOR EUROPEAN MARKETS ONLY:

- This appliance can be used by children aged from 8 years and above if they have been given supervision or instruction concerning use of the appliance in a safe way and understand the hazards involved. Cleaning and user maintenance shall not be made by children unless they are older than 8 and supervised. Keep the appliance and power cord away from children under eight years of age.
- Appliances can be used by persons with reduced physical, sensory or mental capabilities or lack of experience and knowledge if they are supervised or have been given instruction concerning use of the appliance in a safe way and if they understand the hazards involved.
- Children shall not play with the appliance.
- Always unplug the appliance when left unattended and before assembly, taking apart or cleaning.



Surfaces marked with this symbol become hot during use (the symbol is present in certain models only).



## 2. SAFETY WARNINGS

### 2.1 Symbols used in these instructions

Important warnings are identified by these symbols. It is vital to respect these warnings.



#### **Danger!**

Failure to observe the warning may result in life threatening injury by electric shock.



#### **Important!**

Failure to observe the warning could result in injury or damage to the appliance.



#### **Danger of burns!**

Failure to observe the warning could result in scalds or burns.



#### **Please note:**

This symbol identifies important advice or information for the user.



#### **Danger!**

This is an electrical appliance and may cause electric shock.

You should therefore follow these safety warnings:

- Never touch the appliance with damp hands or feet.
- Never touch the plug with damp hands.
- Make sure the socket used is freely accessible at all times, enabling the appliance to be unplugged when necessary.
- Unplug directly from the plug only. Never pull the cord as you could damage it.
- To disconnect the appliance completely you must unplug it from the mains socket.
- If the appliance is faulty, do not attempt to repair. Turn it off, unplug from the mains socket and contact Customer Services.
- Before cleaning the appliance, turn it off, unplug from the mains socket and allow to cool.



#### **Important:**

Keep all packaging (plastic bags, polystyrene foam) away from children.



#### **Danger of burns!**

This appliance produces hot water and steam may form while it is in operation.

Avoid contact with splashes of water or hot steam.

When the appliance is in operation, the cup shelf could become very hot.

### 2.2 Designated use

This appliance is designed and made to prepare coffee and heat drinks.

Any other use is considered improper and thus dangerous. The manufacturer is not liable for damage deriving from improper use of the appliance.

### 2.3 Instruction for Use

Read this Instruction for Use carefully before using the appliance. Failure to follow this Instruction for Use may result in burns or damage to the appliance.

The manufacturer is not liable for damage deriving from failure to respect this Instruction for Use.



#### **Please note:**

Keep this Instruction for Use. If the appliance is passed to other persons, they must also be provided with this Instruction for Use.

## 3. INTRODUCTION

Thank you for choosing this bean to cup espresso and cappuccino machine.

We hope you enjoy using your new appliance. Take a few minutes to read this Instruction for Use. This will avoid all risks and damage to the appliance.

### 3.1 Letters in brackets

The letters in brackets refer to the legend in the description of the appliance on page 2-3.

### 3.2 Troubleshooting and repairs

In the event of problems, first try and resolve them by reading the information given in the sections "18 Explanation of lights" and "19 Troubleshooting".

If this does not resolve the problem or you require further information, you should consult Customer Services by calling the number given on the annexed "Customer Service" sheet.

If your country is not among those listed on the sheet, call the number given in the guarantee. If repairs are required, contact De'Longhi Customer Services only. The addresses are given in the guarantee certificate provided with the machine.

## 4. DESCRIPTION

### 4.1 Description of the appliance







(page 3 - A )

- A1. Control panel
- A2. Grinding adjustment dial
- A3. Cup shelf
- A4. Beans container lid
- A5. Pre-ground coffee funnel lid
- A6. Pre-ground coffee funnel
- A7. Beans container
- A8. Main switch (ON/OFF)
- A9. Water tank
- A10. Infuser door
- A11. Infuser
- A12. Coffee spouts (adjustable height)
- A13. Coffee grounds container
- A14. Condensate tray
- A15. Cup tray
- A16. Drip tray water level indicator
- A17. Drip tray
- A18. Cappuccino maker
- A19. Steam/hot water dial

### 4.2 Description of the control panel

(page 2 - B )

*A number of buttons on the panel have a double function. This is indicated in brackets in the description.*

- B1. Lights
- B2.  button: turns the appliance on and off (standby)
- B3.  button to access the menu
- B4.  rinse button.  
(When in the settings MENU, it acts as the "ESC" button to exit from the selected function and go back to the main menu).
- B5. Selection dial: turn to select the required quantity of coffee. (When in the settings MENU, turn to select the required function).
- B6.  aroma selection button: to select the coffee taste
- B7.  button: to make 1 cup of coffee with the settings displayed
- B8.  button: to make 2 cups of coffee with the settings displayed
- B9.  button: to deliver steam to make hot milk-based coffees. (When you access the MENU: "OK" button to confirm the selection made)

### 4.3 Description of the accessories

(page 2 - C )

- C1. "Total Hardness Test" indicator paper
- C2. Measure
- C3. Descaler bottle
- C4. Water softener filter (certain models only)
- C5. Cleaning brush

### 4.4 Description of lights



Light flashing: the machine is heating up or a rinse cycle is underway.



The appliance is delivering two cups of coffee.



"Energy Saving" mode is active.



Light on steadily: the "steam" function has been selected.

Light flashing: you must turn the steam dial.



An alarm is displayed on the control panel (see the section "19. Explanation of lights").



Light flashing: the water softener filter must be replaced.



Indicator on: that the coffee grounds container must be inserted.

Light flashing: the grounds container is full and must be emptied.



Light on steadily: the water tank is missing.

Light flashing: there is not enough water in the tank.



Light flashing: the appliance must be descaled (see the section "13. Descaling").

< **ESC** > Indicates the button to press to exit the settings menu or selected function.

**OK** > Indicates the button to press to confirm the function selected in the settings menu.

## 5. BEFORE USE

### 5.1 Checking the appliance

After removing the packaging, make sure the product is complete and undamaged and that all accessories are present. Do not use the appliance if it is visibly damaged. Contact De'Longhi Customer Services.

### 5.2 Installing the appliance



**Important!**

When you install the appliance, you should respect the following safety warnings:

- The appliance could be damaged if the water it contains freezes.

Do not install the appliance in a room where the temperature could drop below freezing point.

- The appliance gives off heat. After positioning the appliance on the worktop, leave a space of at least 3 cm between the surfaces of the appliance and the side and rear walls and at least 15 cm above the coffee machine.
- Water penetrating the coffee machine could cause damage.  
Do not place the appliance near taps or sinks.
- Arrange the cord in such a way that it cannot be damaged by sharp edges or contact with hot surfaces (e.g. electric hot plates).

### 5.3 Connecting the appliance



#### **Important!**

Check that the mains power supply voltage corresponds to the value indicated on the rating plate on the bottom of the appliance.

Connect the appliance to an efficiently earthed and correctly installed socket with a minimum current rating of 10A only.

If the power socket does not match the plug on the appliance, have the socket replaced with a suitable type by a qualified professional.



### 5.4 Setting up the appliance



#### **Please note:**

- Coffee has been used to factory test the appliance and it is therefore completely normal for there to be traces of coffee in the mill. The machine is, however, guaranteed to be new.
- You should customise water hardness as soon as possible following the Instruction for use in the section "14 Setting water hardness".

Proceed as described:

1. Remove the water tank (A9), fill to the MAX line with fresh water (fig. 1A) then put back in the appliance (fig. 1B).
2. Place a container with a minimum capacity of 100 ml under the cappuccino maker (A18) (fig. 2).
3. Plug the appliance into the mains socket and place the main switch (A8) on the back of the appliance in the **I** position (fig. 3).
4. The  light flashes on the control panel (A1) (fig. 4).
5. Turn the steam dial (A19) to the **I** position (fig. 5) and press the  button (B9) to confirm (fig. 6). The appliance delivers water from the cappuccino maker then goes off.

6. Turn the steam dial to the **0** position.

The coffee machine is now ready for normal use.



#### **Please note:**

- When setting up the appliance, you need to make 4-5 cups of coffee or 4-5 cappuccinos before the appliance starts to give satisfactory results.
- To enjoy your coffee even more and improve the performance of your appliance, we recommend installing a water softener filter (C4) as described in the section "15 Water softener filter". If your model is not provided with a filter, you can request one from De'Longhi Customer Services.

## 6. TURNING THE APPLIANCE ON





#### **Please note:**

- Before turning the appliance on, make sure the main switch (A8) on the back of the appliance is in the **I** position (fig. 3).
- Each time the appliance is turned on, it performs an automatic preheat and rinse cycle which cannot be interrupted. The appliance is ready for use only once this cycle is complete.



#### **Danger of burns!**

During rinsing, a little hot water comes out of the coffee spouts (A12) and is collected in the drip tray (A17) underneath. Avoid contact with splashes of water.

- To turn the appliance on, press the  button (B2 -fig. 7). The  light flashes while the appliance is heating up and performing an automatic rinse cycle (by circulating hot water, the appliance heats both the boiler and the internal circuits).

The appliance is at temperature when the  light goes off and the coffee lights come on.

## 7. TURNING THE APPLIANCE OFF

Whenever the coffee machine is turned off after being used to make coffee, it performs an automatic rinse cycle.



#### **Danger of burns!**

During rinsing, a little hot water flows from the coffee spouts (A12).

Avoid contact with splashes of water.

To turn the appliance off, press the  button (B2, fig. 7). The appliance performs a rinse cycle then goes off.



#### **Please note:**

If the appliance is not used for an extended period, place the main switch (A8) in the **0** position (fig. 3).

## **Important!**

To avoid damaging the appliance, never place the main switch (A8- fig. 3) in the **0** position until the appliance has been turned off using the  button.

## **8. MENU SETTINGS**

When you access the settings menu by pressing the **P** (B3) button, the following menu items can be selected: Descaling, Auto-off, Set temperature, Energy saving, Water hardness, Install filter, Replace filter, Default values, Statistics.



### **8.1 Descaling**











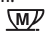















For instructions on descaling, see the section “13. Descaling”.

### **8.2 Auto-off**

The time can be changed so that the appliance switches off after being idle for 15 or 30 minutes, or after 1, 2 or 3 hours.



To change the Auto-off setting, proceed as follows:















1. Press the **P** button (B3) to enter the menu;
  2. Turn the selection dial (B5- fig. 8) until the  light comes on;
  3. Press the  button (B9) to select the function;
  4. Turn the selection dial until the lights corresponding to the number of hours before the appliance goes off automatically come on:  

15 minutes					
30 minutes					
1 hour					
2 hours					
3 hours					
  5. Press the  button to confirm;
  6. Press the  button (B4) to exit the menu.
- Auto-off is programmed.

### **8.3 Set temperature**





To modify the temperature of the water used to make the coffee, proceed as follows:

1. Press the **P** button (B3) to enter the menu;
2. Turn the selection dial (B5) until the  light comes on;
3. Press the  button (B9);
4. Turn the selection dial until the lights corresponding to the required temperature come on:  

LOW				
MEDIUM				
HIGH				
5. Press the  button to confirm;
6. Press the  button (B4) to exit the menu.

### **8.4 Energy saving**

Use this function to enable or disable energy saving. When enabled, the function reduces energy consumption in compliance with European regulations.

1. Press the **P** button (B3) to enter the menu;
  2. Turn the selection dial (B5) until the E light comes on.
  3. Press the  button (B9). The OK light flashes.
  4. Press the  button to enable, or  (B4) to disable, the energy saving mode;
  5. Press the  button to exit the menu.
- When the function is active, the E light remains on.



#### **Please note:**

When in energy saving mode, a few seconds may elapse before the first coffee is delivered as the appliance must heat up again.

### **8.5 Setting water hardness**

For instructions on setting water hardness, see section “14.2 Setting water hardness”.

### **8.6 Install filter**





For instructions on how to install the filter (C4), see the section “15.1 Installing the filter”.

### **8.7 Replacing the filter**

For instructions on how to replace the filter (C4), see the section “15.2 Replacing the filter”.

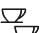



### **8.8 Default values (reset)**

This resets all menu settings and programmed quantities back to the default values.

1. Press the **P** button (B3) to enter the menu;
2. Turn the selection dial (B5) until the lights   come on.
3. Press the  button (B9). The OK light flashes.
5. Press the  button to confirm and exit.

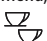
### **8.9 Statistics function**

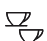
This displays statistics relating to the machine. To display, proceed as follows:

1. Press the **P** button (B3) to enter the menu;
2. Turn the selection dial (B5) until the  light comes on;
3. Press the  button (B9).
4. When the selection dial is turned and the corresponding light flashes, the following information is displayed:
  -  how many coffees have been made;
  -  how many times the machine has been descaled;



- 12

- before delivering the coffee, perform a rinse cycle by pressing the  button (B4). Hot water is delivered from the spout (A12), heating the internal circuits of the appliance and thus raising the coffee temperature;
- warm the cups with hot water (using the hot water function);
- set a hotter coffee temperature (see the section “8.3 Setting the temperature”).





## 9.6 Making coffee using coffee beans



Do not use caramelised or candied coffee beans as they could stick to the coffee mill and damage it.

1. Fill the container (A7, fig. 13) with coffee beans.
2. Place under the coffee spouts (A12):
  - 1 cup, if you want to make 1 coffee (fig. 10);
  - 2 cups if you want 2 coffees.
3. Lower the spouts as near as possible to the cup. This makes a creamier coffee (fig. 14).
4. Press the button corresponding to the number of coffees required (1 cup  B7 or 2 cups  B8) (figs. 11 and 15).
5. Preparation begins and the lights corresponding to the taste and quantity of coffee selected are displayed on the control panel (A1).  
Once the coffee has been made, the appliance is ready to make the next drink.



- While the machine is making coffee, delivery can be interrupted at any moment by pressing one of the two coffee buttons ( or .
- At the end of delivery, to increase the quantity of coffee in the cup, just press (within 3 seconds) one of the coffee buttons ( or .



For hotter coffee, see the section “9.5 Tips for a hotter coffee”.



- If the coffee is delivered a drop at a time, too weak and not creamy enough or too cold, read the tips in the “19 Trouble-shooting” sections.
- Lights may be displayed on the control panel during use. Their meaning is given in the section “18 Explanation of the lights”.



## 9.7 Making coffee using pre-ground coffee



- Never place coffee beans in the pre-ground coffee funnel (A6) as this could damage the appliance.
- Never add pre-ground coffee when the machine is off or it could spread through the inside of the machine and dirty it. This could damage the appliance.
- Never use more than 1 level measure (C2) or it could dirty the inside of the coffee machine or block the funnel.



When you use pre-ground coffee, you can only make one cup of coffee at a time.

1. Make sure the appliance is on.
2. Press the  button repeatedly (B6- fig. 9) until the  symbol appears.
3. Make sure the funnel is not blocked, then add one level measure of pre-ground coffee (fig. 16).
4. Place a cup under the coffee spouts (A12).
5. Press the 1 cup coffee button  (B7- fig. 11).
6. Preparation begins.

## 10. MAKING CAPPUCCINO





During preparation, steam is given off. Take care to avoid scalds.

1. When preparing cappuccino, make the coffee in a large cup;
2. Fill a container (preferably one with a handle to avoid scalding) with about 100 ml of milk for each cappuccino. In choosing the size of the container, bear in mind that the milk doubles or triples in volume;



For a richer denser froth, use skimmed or partially skimmed milk at refrigerator temperature (about 5°C). To avoid milk with poor froth or large bubbles, always clean the cappuccino maker as described in the following section “10.1 Cleaning the cappuccino maker after use”.

3. Press the  button (B9). The  light flashes.
4. Immerse the cappuccino maker (A18) in the milk container (fig. 17).
5. After a few seconds, when the  light flashes, turn the steam dial (A19) to the I position (fig. 5). Steam is delivered from the cappuccino maker, giving the milk a creamy frothy appearance and making it more voluminous;

- For a creamier froth, rotate the container with slow movements in an upward direction. (You should not deliver steam for more than 3 minutes at a time);
- When you have obtained the required froth, stop steam delivery by turning the steam dial back to the **0** position.



### **Danger of burns!**

Stop steam delivery before removing the container with the frothed milk to avoid burns caused by splashes of boiling milk.

- Add the milk froth to the coffee prepared previously. The cappuccino is ready. Sweeten to taste and, if desired, sprinkle the froth with a little cocoa powder.

## **10.1 Cleaning the cappuccino maker after use**

Always clean the cappuccino maker (A18) after use to avoid the build-up of milk residues and prevent the spouts from clogging.

- Place a container under the cappuccino maker and deliver a little water for a few seconds by rotating the steam dial (A19) to the **I** position (fig. 5). Then turn the steam dial to the **0** position to stop the flow of hot water.
- Wait a few minutes for the cappuccino maker to cool down. Grip the handle of the cappuccino maker tube firmly in one hand and with the other rotate the cappuccino maker anti-clockwise (fig. 19), then remove by pulling downwards.
- Also remove the steam connection nozzle by pulling it downwards (fig. 20).
- Make sure the two holes shown by the arrow in fig. 21 are not blocked. If necessary, clean using a toothpick.
- Wash all parts of the cappuccino maker thoroughly with a sponge and warm water.
- Reinsert the nozzle, then replace the cappuccino maker on the nozzle, turning it and pushing it upwards until it is attached.

## **11. HOT WATER**



### **Danger of burns!**

Never leave the machine unattended while delivering hot water. The hot water spout (A18) becomes hot while water is being delivered and must be handled by the handle only.

- Place a container under the cappuccino maker (as close as possible to avoid splashes).
- Turn the steam dial (A19) to the **I** position. Delivery begins.
- Stop by turning the steam dial to the **0** position.



### **Please note:**

If “energy saving” mode is active, you may have to wait a few seconds before the hot water is delivered.

## **12. CLEANING**

### **12.1 Cleaning the machine**

The following parts of the machine must be cleaned regularly:

- the appliance's internal circuit,
- coffee grounds container (A13),
- drip tray (A17) and condensate tray (A14),
- water tank (A9),
- coffee spouts (A12);
- cappuccino maker (A18);
- pre-ground coffee funnel (A6),
- infuser (A11), accessible after opening the service door (A10),
- control panel (A1).



### **Important!**

- Do not use solvents, abrasive detergents or alcohol to clean the coffee machine. With De'Longhi superautomatic coffee machines, you need not use chemical products to clean the machine.
- None of the components can be washed in a dishwasher.
- Do not use metal objects to remove encrustations or coffee deposits as they could scratch metal or plastic surfaces.

### **12.2 Cleaning the machine's internal circuit**

If the appliance is not used for more than 3-4 days, before using it again, we strongly recommend switching the appliance on and performing:

- 2 or 3 rinse cycles by pressing the  (B4) icon.
- delivering hot water by turning the hot water/steam dial (A19) to the **I** position.



### **Please note!**

After cleaning, it is normal for the grounds container (A13) to contain water.

### **12.3 Cleaning the coffee grounds container**

When the  light flashes, the coffee grounds container (A13) must be emptied and cleaned. Unless you clean the grounds container, the light will continue to flash and the appliance cannot be used to make coffee.

To clean (with the machine on):

- Remove the drip tray (A17) (fig. 23), empty and clean.
- Empty the grounds container and clean thoroughly to remove all residues left on the bottom.
- Check the red condensate tray (A14) and empty if necessary.

### **Important!**

When removing the drip tray, the grounds container must be emptied, even if it contains few grounds.

If this is not done, when you make the next coffees, the grounds container may fill up more than expected and clog the machine.

## 12.4 Cleaning the drip tray and condensate tray

### **Important!**

If the drip tray (A17) is not emptied regularly, the water could overflow from the edge and seep inside or around the machine. This could damage the machine, the surface it rests on or the surrounding area.

The drip tray is fitted with a level indicator (A16, red) showing the level of water it contains (fig. 24). Before the indicator protrudes from the cup tray, the drip tray must be emptied and cleaned.

To remove the drip tray:

1. Remove the drip tray and the grounds container (A13) (fig. 23);
2. Empty the drip tray and grounds container and wash them;
3. Check the condensate tray (A14) and empty if necessary.
4. Replace the drip tray and grounds container.

## 12.5 Cleaning the inside of the coffee machine

### **Danger of electric shock!**

Before cleaning internal parts, the machine must be turned off (see section "7. Turning off") and unplugged from the mains power supply. Never immerse the coffee machine in water.

1. Check regularly (about once a month) that the inside of the appliance (accessible after removing the drip tray - A17) is not dirty. If necessary, remove coffee deposits with a sponge.
2. Remove the residues with a vacuum cleaner (fig. 25).

## 12.6 Cleaning the water tank

1. Clean the water tank (A9) regularly (about once a month) and whenever you replace the water softener filter (C4, if provided) with a damp cloth and a little mild washing up liquid.
2. Remove the filter (if present) and rinse with running water.
3. Replace the filter (if provided), fill the tank with fresh water and replace the tank.
4. (Models with water softener filter only) Deliver about 100 ml of water.

## 12.7 Cleaning the coffee spouts

1. Clean the coffee spouts (A12) with a sponge or cloth (fig. 26A).
2. Check the holes in the coffee spouts are not blocked. If necessary, remove coffee deposits with a toothpick (fig. 26B).

## 12.8 Cleaning the pre-ground coffee funnel

Check regularly (about once a month) that the pre-ground coffee funnel (A6) is not blocked. If necessary, remove coffee deposits.

## 12.9 Cleaning the infuser

The infuser (A11) must be cleaned at least once a month.

### **Important!**

The infuser may not be extracted when the machine is on.

1. Make sure the machine is correctly turned off (see section "7. Turning off").
2. Remove the water tank (A9).
3. Open the infuser door (A10) (fig. 27) on the right side of the appliance.
4. Press the two coloured release buttons inwards and at the same time pull the infuser outwards (fig. 28).

### **Important!**

RINSE WITH WATER ONLY

NO WASHING UP LIQUID - NO DISH WASHER

Clean the infuser without using washing up liquid as it could be damaged.

5. Soak the infuser in water for about 5 minutes, then rinse under the tap.
6. Clean coffee residues from the support where the infuser rests.
7. After cleaning, replace the infuser by sliding it onto the internal support (fig. 29), then push the PUSH symbol fully in until it clicks into place.

### **Please note:**

If the infuser is difficult to insert, before insertion, adapt it to the right size by pressing the two levers shown in fig. 30.

8. Once inserted, make sure the two coloured buttons have snapped out (fig. 31).
9. Close the infuser door.
10. Put the water tank back.







### 13. DESCALING

Descalc the appliance when the  light on the control panel (A1) flashes.

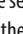
#### **Important!**

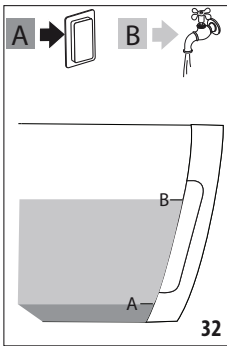

- Before use, read the instructions and the labelling on the descaler (C3) pack.
- You should use De'Longhi descaler only. Using unsuitable descaler and/or performing descaling incorrectly may result in faults not covered by the manufacturer's guarantee.

1. Turn the appliance on and wait until it is ready for use.
2. Press the **P** button (B3), turn the selector dial (B5) until the  light is selected and press the  button (B9). The **OK** light flashes. Press the  button again to confirm. The  light flashes.
3. Empty the water tank (A9) completely and remove the water softener filter (C4), if present.

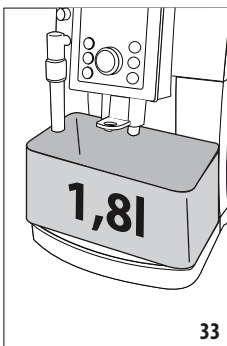

4. Pour the descaler (C3) into the tank up to level A (corresponding to a 100 ml pack) marked on the inner surface of the tank (fig.32A), then add a litre of water up to level B (fig. 32B) and put the water tank back in the appliance.







5. Place a container with a minimum capacity of 1.8 litres under the cappuccino maker (A18) and coffee spouts (A12) (fig. 33).
6. Press the  button to confirm that you have added the solution and begin the descaling procedure. The  and  lights flash to indicate the hot water/steam dial must be turned to the **I** position.

#### **Important! Danger of burns**

Hot water containing acid flows from the cappuccino maker and coffee spouts. Take care to avoid contact with splashes of this solution.

7. Turn the hot water/steam dial to the **I** position: the descale programme starts and the descaler liquid comes out of the cappuccino maker and coffee spouts. A series of rinses and pauses are performed automatically to remove all the scale residues inside the coffee machine.

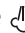
After about 25 minutes, descaling stops and the  light flashes on the control panel. Turn the hot water/steam dial to the **0** position.

8. The appliance is now ready for rinsing through with clean water. Empty the container used to collect the descaler solution. Extract the water tank, empty, rinse under running water, fill with fresh water up to the MAX level and put back in the appliance: the  light flashes to indicate the hot water/steam dial must be turned to the **I** position.
  9. Place the container used to collect the descaler solution empty under the cappuccino maker and coffee spouts (fig. 33).
  10. Turn the hot water/steam dial to the **I** position to begin rinsing. Hot water is delivered first from the cappuccino maker, to continue and end with the coffee spout.
  11. When the water tank is completely empty, the  light flashes on the control panel. Turn the hot water/steam dial to the **0** position.
  12. Empty the container used to collect the rinsing water. Remove the water tank, replace the water softener filter (if removed previously), fill the tank up to the MAX level with cold water and insert in the appliance. The  light flashes.
  13. Place the container used to collect the rinsing water empty under the cappuccino maker.
  14. Turn the hot water/steam dial to the **I** position. Rinsing continues from the cappuccino maker only.
  15. When it finishes, the  light flashes on the control panel. Turn the hot water/steam dial to the **0** position.
  16. Top up the water tank with fresh water to the MAX level and put back in the machine.
- Descaling is complete.

#### **Please note!**

- If the descaling cycle is not completed correctly (e.g. no electricity) we recommend repeating the cycle.
- After descaling, it is normal for the grounds container (A13) to contain water.

### 14. SETTING WATER HARDNESS

The light  is displayed after a period of time established according to the water hardness set.

The machine is set by default for a hardness value of 4. The machine can also be programmed according to the hardness of the

mains water in the various regions so that the machine needs to be descaled less often.

### 14.1 Measuring water hardness

1. Remove the "TOTAL HARDNESS TEST" indicator paper (C1) from its pack (attached to the English instructions).
2. Immerse the paper completely in a glass of water for one second.
3. Remove the paper from the water and shake lightly. After about a minute, 1, 2, 3, or 4 red squares form, depending on the hardness of the water. Each square corresponds to one level.

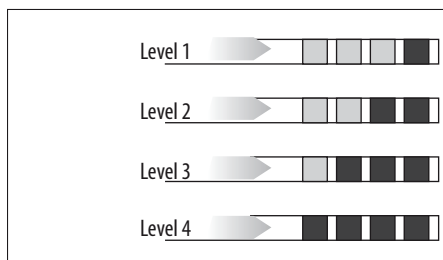

### 14.2 Setting water hardness

1. Press the **P** button (B3) to enter the menu.
2. Turn the selector dial (B5) until the light is selected.
3. Confirm the selection by pressing the button (B9).
4. Turn the selection dial and set the level shown by the indicator paper (see previous paragraph).



5. Press the button to confirm the setting.
6. Press the (B4) button to exit the menu.

The machine is now reprogrammed with the new water hardness setting.

## 15. WATER SOFTENER FILTER (IF PRESENT)

Certain models are fitted with a water softener filter (C4). If this is not the case with your model, you are recommended to purchase one from De'Longhi Customer Services. To use the filter correctly, follow the instructions below.

### 15.1 Installing the filter

1. Remove the filter (C4) from the packaging.

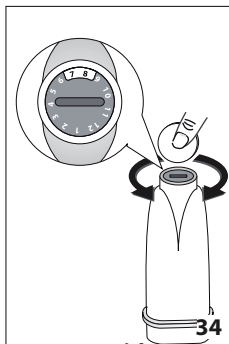

2. Turn the date indicator disk until the next two months of use are displayed (fig 34).

#### Please note

The filter lasts about two months if the appliance is used normally. If the coffee machine is left unused with the filter installed, it will last a maximum of three weeks.

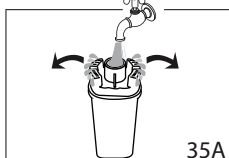

3. To activate the filter, run tap water through the hole in the filter as shown in the figure until water comes out of the openings at the side for more than a minute (fig. 35A).

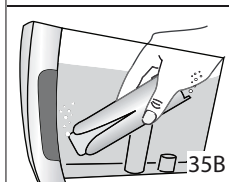

4. Extract the tank (A9) from the appliance and fill with water.

5. Insert the filter upside down in the water tank and immerse it completely for about thirty seconds, to enable the air bubbles to escape.

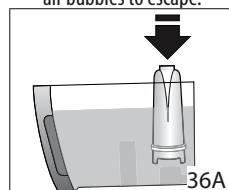

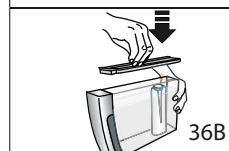

6. Insert the filter into the filter housing and press as far as it will go (fig.36A).
7. Close the tank with the lid, then put the tank back in the machine (fig.36B).









When you install the filter, you must notify the appliance of its presence.

8. Press the **P** button (B3) to enter the menu.
9. Turn the selection dial (B5) until the and lights come on.
10. Press the button (B9). The **OK** light flashes.
11. Press the button to confirm the selection.
12. Place a container (min. capacity: 500 ml) underneath the cappuccino maker (A18).

13. Turn the steam dial (A19) to the I position and press the  button.
  14. After delivery, the  light flashes. Close the dial (0 position) and the appliance returns automatically to the "ready for coffee" state.;
- The filter is now active and you can use the coffee machine.

## 15.2 Replacing the filter





When the  light flashes, after two months (see date indicator) or when the appliance has not been used for 3 weeks, you should replace the filter (C4):

1. Extract the tank (A9) and exhausted filter.
2. Take the new filter out of its packet and proceed as illustrated in points 3, 4, 5, 6 and 7 in the previous section.
3. Place a container (min. capacity: 500 ml) underneath the cappuccino maker (A18).
4. Press the **P** button (B3) to enter the menu.
5. Turn the selection dial (B5) until the  and  lights come on.
6. Press the  button (B9). The **OK** light flashes.
7. Press the  button to confirm the selection.
8. Turn the steam dial to the I position and press the  button.
9. After delivery, the  light flashes. Close the dial (0 position) and the appliance returns automatically to the "ready for coffee" state.

The new filter is now active and you can use the coffee machine.

## 15.3 Removing the filter

If you want to use the appliance without the filter, you must remove it and notify the appliance of its removal. Proceed as follows:

1. Extract the tank (A9) and exhausted filter (C4).
2. Press the **P** button (B3) to enter the menu.
3. Turn the selection dial (B5 - fig. 8) until the  and  lights come on.
4. Press the  button (B9). The **OK** light flashes.
5. Press the  button (B4) to confirm use of the appliance without the filter.
6. Press the  button to exit the menu.

## 16. TECHNICAL DATA

Voltage:	220-240 V~ 50/60 Hz max. 10 A
Absorbed power:	1450 W
Pressure:	1,5 MPa (15 bars)
Max. water tank capacity:	1,8 L
Size LxHxD:	240x430x350 mm
Cord length:	1150 mm
Weight:	9 Kg
Max. beans container capacity:	250 g



The appliance complies with the following EC directives:





- European Standby Regulation 1275/2008
- Materials and accessories coming into contact with food conform to EEC regulation 1935/2004.







## 17. DISPOSAL



The appliance must not be disposed of with household waste, but taken to an authorised waste separation and recycling centre.

## 18. EXPLANATION OF LIGHTS

LIGHT	POSSIBLE CAUSE	SOLUTION
	<p>Indicates the hot water/steam dial must be turned (A19).</p>	<p>Turn the hot water/steam dial.</p>
	<p>Insufficient water in the tank (A9).</p>	<p>Fill the tank with water and/or insert it correctly, pushing it as far as it will go until it clicks into place.</p>
	<p>The tank (A9) is not correctly in place.</p>	<p>Insert the tank correctly and press as far as it will go.</p>
	<p>The grounds container (A13) is full.</p>	<p>Empty the grounds container (A13) and drip tray (A17), clean and replace. Important: when removing the drip tray, the grounds container MUST be emptied, even if it contains few grounds. If this is not done, when you make the next coffees, the grounds container may fill up more than expected and clog the machine.</p>
	<p>After cleaning, the grounds container has not been replaced (A13).</p>	<p>Remove the drip tray (A17) and insert the grounds container.</p>

	<p>The grinding is too fine and the coffee is delivered too slowly or not at all.</p>	<p>Repeat coffee delivery and turn the grinding adjustment dial (A2, fig. 10) one click clockwise towards "7" while the coffee mill is in operation. If after making at least 2 coffees delivery is still too slow, repeat the correction procedure, turning the Grinding adjustment dial another click until delivery is correct (see the section: "9.4 Adjusting the coffee mill"). If the problem persists, turn the steam dial to the I position and let some water run from the cappuccino maker.</p>
	<p>If the water softener filter (C4) is present, an air bubble may have been released inside the circuit, obstructing delivery.</p>	<p>Deliver a little water by turning the steam dial (A19) to the I position until the flow is regular.</p>
	<p>The "pre-ground coffee" function has been selected without placing any pre-ground coffee in the funnel (A6).</p>	<p>Place pre-ground coffee in the funnel or deselect the "pre-ground" function.</p>
	<p>The machine must be descaled.</p>	<p>The descaling procedure described in the "13 Descaling" section needs to be performed as soon as possible.</p>
	<p>Too much coffee has been used.</p>	<p>Select a milder taste or reduce the quantity of pre-ground coffee, then make the coffee again.</p>
	<p>The coffee beans have run out.</p>	<p>Fill the beans container (A7).</p>
	<p>The pre-ground coffee funnel (A6) is clogged.</p>	<p>Empty the funnel with the help of a knife, as described in the section "12.8 Cleaning the pre-ground coffee funnel".</p>
	<p>The infuser has not been replaced after cleaning (A11).</p>	<p>Insert the infuser as described in the section "12.9 Cleaning the infuser".</p>

	<p>The inside of the appliance is very dirty.</p>	<p>Clean the inside of the appliance thoroughly, as described in the section “Cleaning and maintenance”. If the message is still displayed after cleaning, contact a service centre.</p>
	<p>The filter (C4) is exhausted.</p>	<p>Replace the filter (see the section “Replacing the water softener filter”).</p>

## 19. TROUBLESHOOTING

Below is a list of some of the possible malfunctions.

If the problem cannot be resolved as described, contact Customer Services.

PROBLEM	POSSIBLE CAUSE	SOLUTION
The coffee is not hot.	The cups were not preheated.	Warm the cups by rinsing them with hot water. Please note: the hot water or rinse function can be used.
	The internal circuits of the appliance have cooled down because 2/3 minutes have elapsed since the last coffee was made.	Before making coffee, heat up the infuser by pressing the  rinse button (B4).
The coffee is weak or not creamy enough.	The coffee is ground too coarsely.	Turn the grinding dial (A2) one click anticlockwise while the grinder is in operation (fig. 12). Continue one click at a time until coffee delivery is satisfactory. The effect is only visible after delivering 2 coffees (see section "9.4 Adjusting the coffee mill").
	The coffee is unsuitable.	Use pre-ground coffee for espresso machines.
The coffee is delivered too slowly or a drop at a time.	The coffee is ground too finely.	Turn the grinding dial (A2) one click clockwise while the grinder is in operation (fig. 12). Continue one click at a time until coffee delivery is satisfactory. The effect is only visible after delivering 2 coffees (see section "9.4 Adjusting the coffee mill").
Coffee does not come out of one or both of the spouts.	The coffee spouts (A12) are blocked.	Clean the spouts with a toothpick.
The frothed milk has large bubbles	The milk is not cold enough or is not semi-skimmed.	You should ideally use skimmed or semi-skimmed milk at refrigerator temperature (about 5°C). If the result is not as you wished, try changing brand of milk.
The milk is not frothed	The cappuccino maker (A18) is dirty.	Clean as described in the section "10.1 Cleaning the cappuccino maker after use".

Steam delivery stops	A safety device stops steam delivery after 3 minutes.	Wait, and then enable the steam function again.
The appliance does not come on	It is not plugged into the mains socket.	Plug into the mains socket.
	The main switch (A8) is not turned on.	Push the main switch in the I position (fig. 3).

## 20. ELECTRICAL CONNECTION (UK ONLY)

Before using this appliance ensure that the voltage indicated on the product corresponds with the main voltage in your home, if you are in any doubt about your supply contact your local electricity company.

The flexible mains lead is supplied connected to a B.S. 1363 fused plug having a fuse of 13 amp capacity.

Should this plug not fit the socket outlets in your home, it should be cut off and replaced with a suitable plug, following the procedure outlined below.

**Note:** Such a plug cannot be used for any other appliance and should therefore be properly disposed of and not left where children might find it and plug it into a supply socket - with the obvious consequent danger.

**Please note:** We recommend the use of good quality plugs and wall sockets that can be switched off when the machine is not in use.

**IMPORTANT:** The wires in the mains lead fitted to this appliance are coloured in accordance with the following code:

GREEN AND YELLOW  
BLUE  
BROWN

EARTH  
NEUTRAL  
LIVE

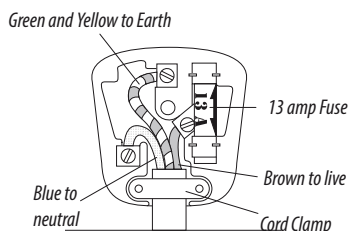

As the colours of the wires in the mains lead of this appliance may not correspond with the coloured markings identifying the terminals in your plug, proceed as follows:

- The wire which is coloured green and yellow must be connected to the terminal in the plug which is marked with the letter E or by the earth symbol  or coloured green or green and yellow.
- The wire which is coloured blue must be connected to the terminal which is marked with the letter N or coloured black.
- The wire which is coloured brown must be connected to the terminal which is marked with the letter L or coloured red.

When wiring the plug, ensure that all strands of wire are securely retained in each terminal. Do not forget to tighten the mains lead clamp on the plug. If your electricity supply point has only two pin socket outlets, or if you are in doubt, consult a qualified electrician.

Should the mains lead ever require replacement, it is essential that this operation be carried out by a qualified electrician and should only be replaced with a flexible cord of the same size.

After replacement of a fuse in the plug, the fuse cover must be refitted. If the fuse cover is lost, the plug must not be used until a replacement cover is obtained. The colour of the correct replacement fuse cover is that of the coloured insert in the base of the fuse recess or elsewhere on the plug. Always state this colour when ordering a replacement fuse cover.

Only 13amp replacement fuses which are astA approved to B.S. 1362 should be fitted.

This appliance conforms to the Norms EN 55014 regarding the suppression of radio interference.

**Warning - this appliance must be earthed**