

ECAM22.32X

BEAN TO CUP ESPRESSO AND
CAPPUCCINO MACHINE

Instruction for Use

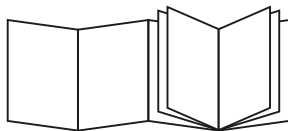

De'Longhi



B

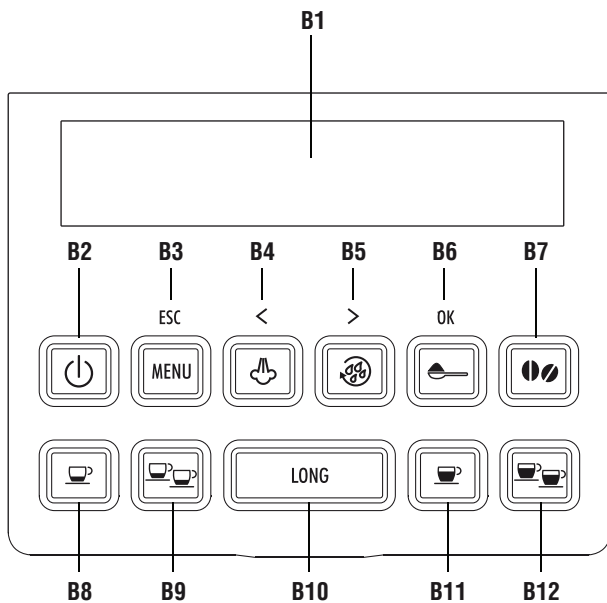

C

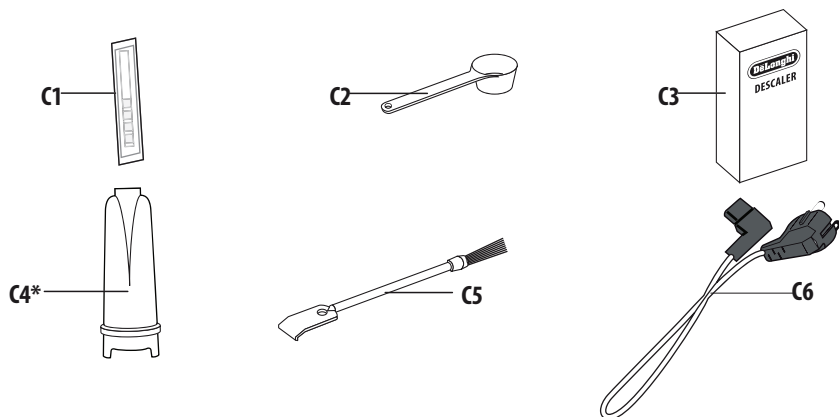

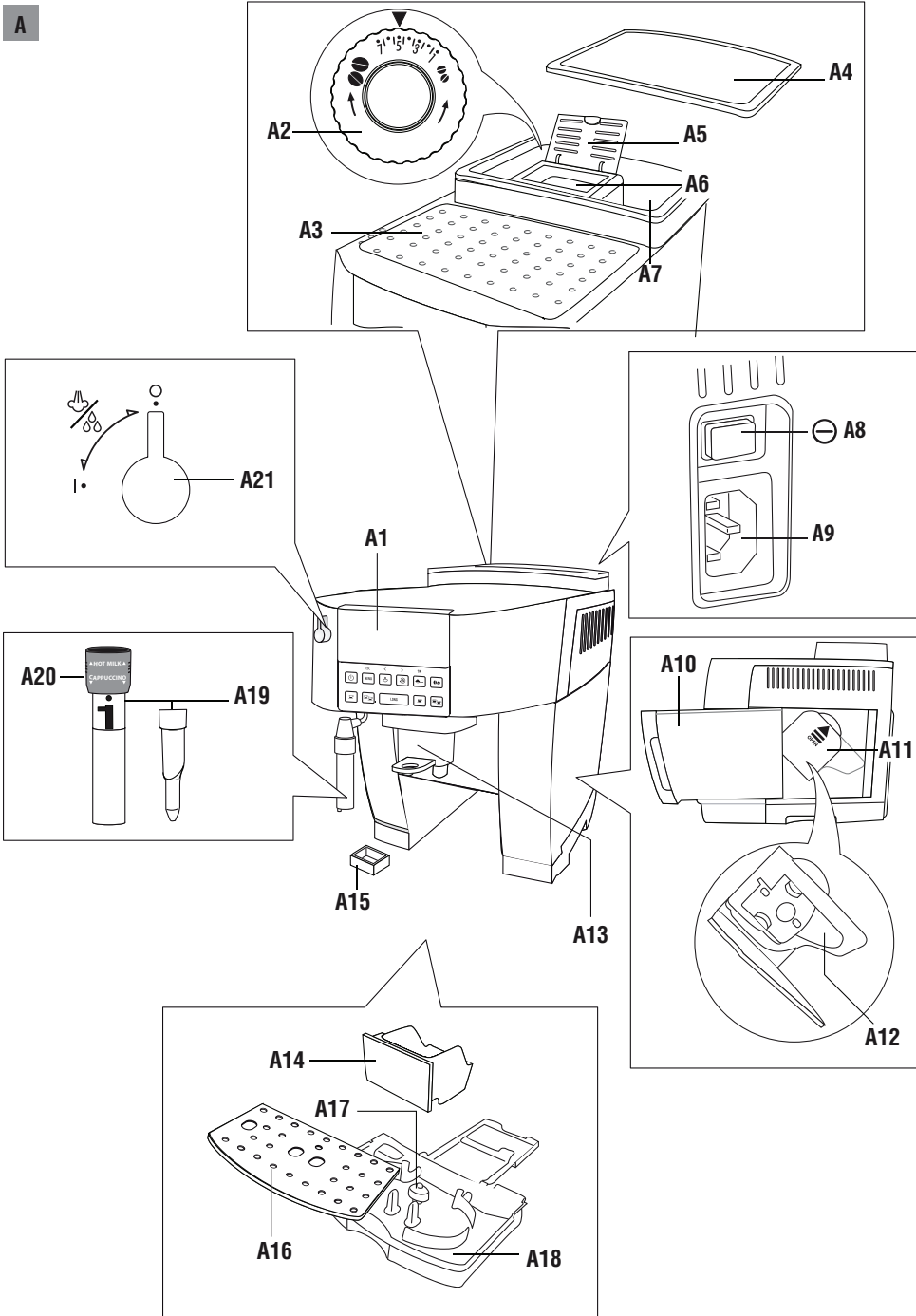

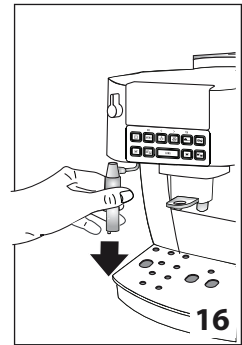
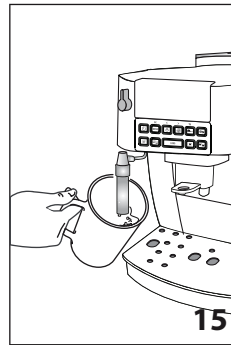
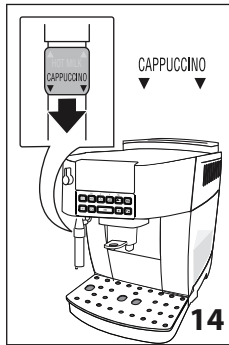
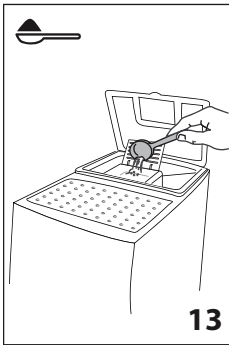
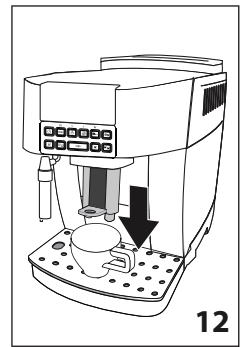
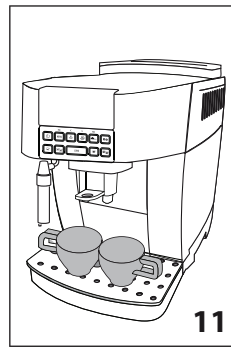
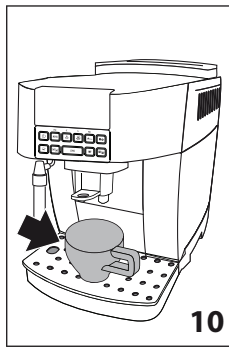
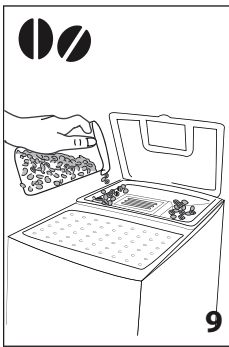
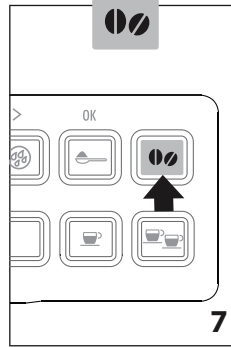
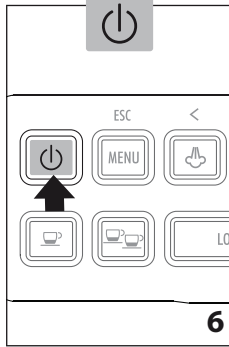
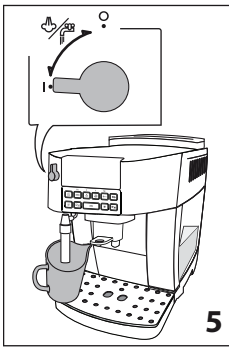
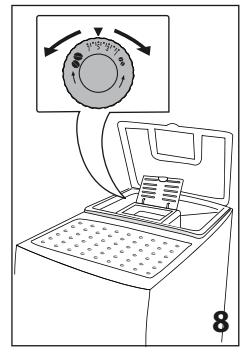
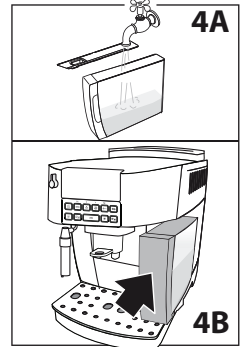
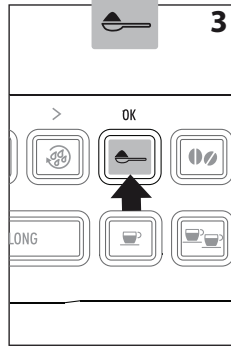
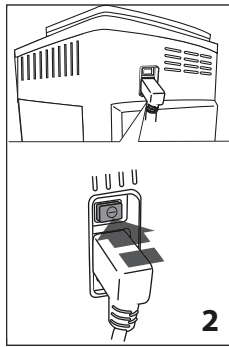
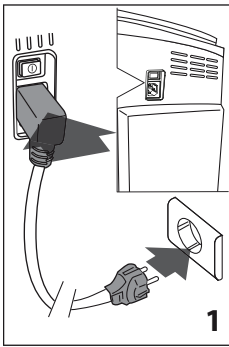

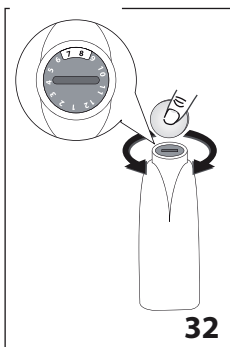
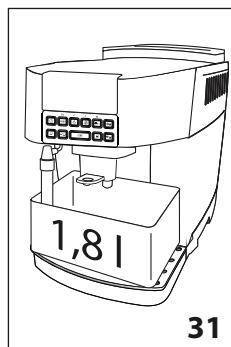
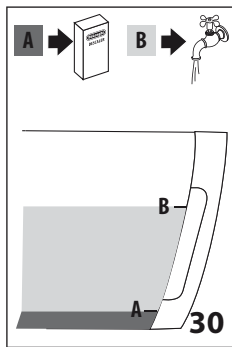
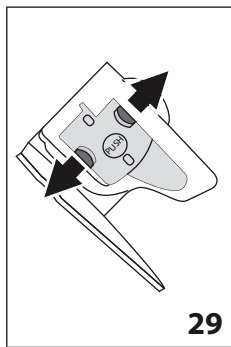
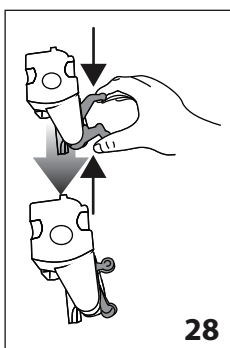
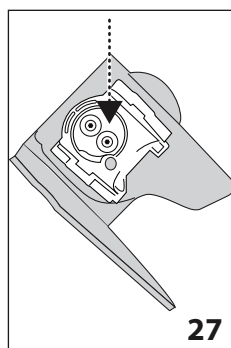
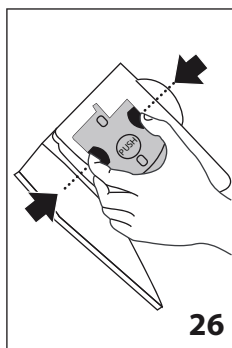
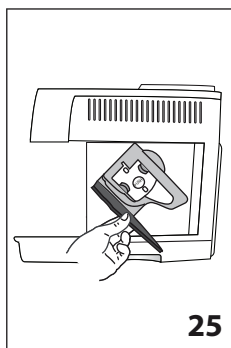
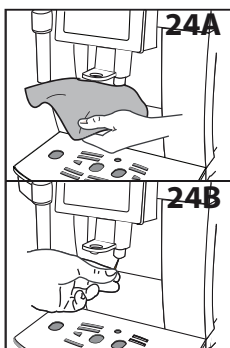
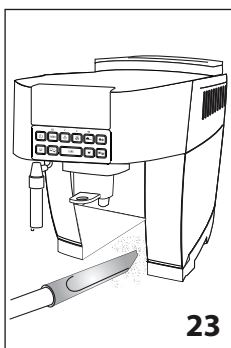
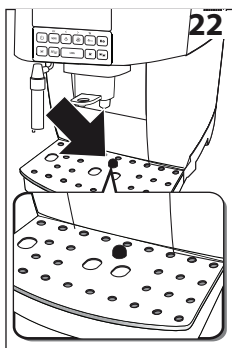
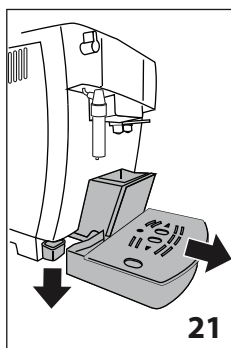
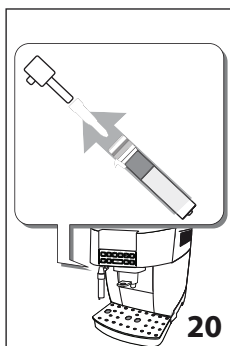
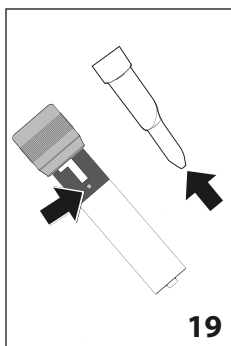
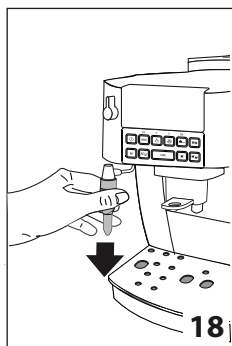
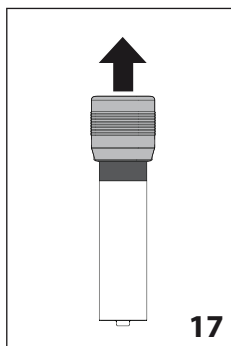

CONTENTS

1. FUNDAMENTAL SAFETY WARNINGS.....	7
2. SAFETY WARNINGS	8
2.1 Symbols used in these instructions	8
2.2 Designated use.....	8
2.3 Instruction for use.....	8
3. INTRODUCTION.....	8
3.1 Letters in brackets.....	8
3.2 Troubleshooting and repairs.....	8
4. DESCRIPTION.....	9
4.1 Description of the appliance.....	9
4.2 Description of the control panel	9
4.3 Description of the accessories.....	9
5. BEFORE USE.....	9
5.1 Checking the appliance	9
5.2 Installing the appliance.....	9
5.3 Connecting the appliance.....	9
5.4 Setting up the appliance	10
6. TURNING THE APPLIANCE ON.....	10
7. TURNING THE APPLIANCE OFF	10
8. MENU SETTINGS	10
8.1 Descaling	10
8.2 Adjust time	10
8.3 Auto-off	11
8.4 Auto-start	11
8.5 Set temperature.....	11
8.6 Energy saving.....	11
8.7 Setting water hardness	11
8.8 Setting the language	11
8.9 Install filter.....	12
8.10 Replacing the filter.....	12
8.11 Default values (reset)	12
8.12 Statistics function.....	12
9. MAKING COFFEE.....	12
9.1 Selecting the coffee taste	12
9.2 Selecting the quantity of coffee in the cup ..	12
9.3 Adjusting the coffee mill	12
9.4 Tips for a hotter coffee.....	12
9.5 Making coffee using coffee beans	13
9.6 Making coffee using pre-ground coffee.....	13
10. MAKING LONG COFFEE.....	13
11. MAKING CAPPUCCINO AND HOT MILK (NOT FROTHED)	13
11.1 Making hot milk (not frothed).....	14
11.2 Cleaning the cappuccino maker after use	14
12. HOT WATER	14
13. CLEANING.....	14
13.1 Cleaning the machine	14
13.2 Cleaning the machine's internal circuit.....	14
13.3 Cleaning the coffee grounds container	15
13.4 Cleaning the drip tray and condensate tray ..	15
13.5 Cleaning the inside of the coffee machine...	15
13.6 Cleaning the water tank.....	15
13.7 Cleaning the coffee spouts	15
13.8 Cleaning the pre-ground coffee funnel	15
13.9 Cleaning the infuser	15
14. DESCALING.....	16
15. SETTING WATER HARDNESS	16
15.1 Measuring water hardness	17
15.2 Setting water hardness	17
16. WATER SOFTENER FILTER	17
16.1 Installing the filter	17
16.2 Replacing the filter.....	18
16.3 Removing the filter	18
17. TECHNICAL DATA.....	18
18. DISPOSAL.....	18
19. DISPLAYED MESSAGES.....	19
20. TROUBLESHOOTING	20
21. ELECTRICAL REQUIREMENTS (UK ONLY).....	21

1. FUNDAMENTAL SAFETY WARNINGS

- The appliance is not intended for use by persons (including children) with reduced physical, sensory or mental capabilities, or lack of experience and knowledge, unless they have been given supervision or instruction concerning use of the appliance by a person responsible for their safety.
- Children should be supervised to ensure that they do not play with the appliance.
- Cleaning and user maintenance shall not be made by children without supervision.
- Never clean by immersing the appliance in water.
- This is an household appliance only. It is not intended to be used in: staff kitchen areas in shops, offices and other working environments; farm houses; by clients in hotels, motels and other residential type environments; bed and breakfast type environments.
- If the plug or cord is damaged, it must be replaced by Customer Services only to avoid all risk.

FOR EUROPEAN MARKETS ONLY:

- This appliance can be used by children aged from 8 years and above if they have been given supervision or instruction concerning use of the appliance in a safe way and understand the hazards involved. Cleaning and user maintenance shall not be made by children unless they are older than 8 and supervised. Keep the appliance and power cord away from children under eight years of age.
- Appliances can be used by persons with reduced physical, sensory or mental capabilities or lack of experience and knowledge if they are supervised or have been given instruction concerning use of the appliance in a safe way and if they understand the hazards involved.
- Children shall not play with the appliance.
- Always unplug the appliance when left unattended and before assembly, taking apart or cleaning.



Surfaces marked with this symbol become hot during use (the symbol is present in certain models only).

2. SAFETY WARNINGS

2.1 Symbols used in these instructions

Important warnings are identified by these symbols.

It is vital to respect these warnings.



Danger!

Failure to observe the warning may result in life threatening injury by electric shock.



Important!

Failure to observe the warning could result in injury or damage to the appliance.



Danger of burns!

Failure to observe the warning could result in scalds or burns.



Please note:

This symbol identifies important advice or information for the user.



Danger!

This is an electrical appliance and may cause electric shock.

You should therefore follow these safety warnings:

- Never touch the appliance with damp hands or feet.
- Never touch the plug with damp hands.
- Make sure the socket used is freely accessible at all times, enabling the appliance to be unplugged when necessary.
- Unplug directly from the plug only.
Never pull the cord as you could damage it.
- To disconnect the appliance completely you must unplug it from the mains socket.
- If the appliance is faulty, do not attempt to repair.
Turn it off, unplug from the mains socket and contact Customer Services.
- Before cleaning the appliance, turn it off, unplug from the mains socket and allow to cool.



Important:

Keep all packaging (plastic bags, polystyrene foam) away from children.



Danger of burns!

This appliance produces hot water and steam may form while it is in operation.

Avoid contact with splashes of water or hot steam.

When the appliance is in operation, the cup shelf could become very hot.

2.2 Designated use

This appliance is designed and made to prepare coffee and heat drinks.

Any other use is considered improper and thus dangerous. The manufacturer is not liable for damage deriving from improper use of the appliance.

2.3 Instruction for use

Read this Instruction for use carefully before using the appliance. Failure to follow this Instruction for use may result in burns or damage to the appliance.

The manufacturer is not liable for damage deriving from failure to respect this Instruction for use.



Please note:

Keep this Instruction for Use. If the appliance is passed to other persons, they must also be provided with this Instruction for Use.

3. INTRODUCTION

Thank you for choosing this bean to cup espresso and cappuccino machine.

We hope you enjoy using your new appliance.

Take a few minutes to read this Instruction for Use. This will avoid all risks and damage to the appliance.

3.1 Letters in brackets

The letters in brackets refer to the legend in the description of the appliance on page 2-3.

3.2 Troubleshooting and repairs

In the event of problems, first try and resolve them following the information given in the sections "19 Displayed messages" and "20 Troubleshooting".

If this does not resolve the problem or you require further information, you should consult Customer Services by calling the number given on the annexed "Customer Service" sheet.

If your country is not among those listed on the sheet, call the number given in the guarantee. If repairs are required, contact De'Longhi Customer Services only. The addresses are given in the guarantee certificate provided with the machine.

4. DESCRIPTION

4.1 Description of the appliance









(page 3 - A)

- A1. Control panel
- A2. Grinding adjustment dial
- A3. Cup shelf
- A4. Beans container lid
- A5. Pre-ground coffee funnel lid
- A6. Pre-ground coffee funnel
- A7. Beans container
- A8. Main switch
- A9. Power cord connector socket
- A10. Water tank
- A11. Infuser door
- A12. Infuser
- A13. Coffee spout (adjustable height)
- A14. Coffee grounds container
- A15. Condensate tray
- A16. Cup tray
- A17. Drip tray water level indicator
- A18. Drip tray
- A19. Cappuccino maker
- A20. Cappuccino maker selection ring
- A21. Steam/hot water dial

4.2 Description of the control panel

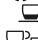
(page 2 - B)

A number of buttons on the panel have a double function. This is indicated in brackets in the description.

- B1. Display: guides the user in using the appliance.
- B2.  button: turns the appliance on and off.
- B3. MENU button to access the menu (When in the settings MENU: "ESC" button to exit the selected function and go back to the main menu).
- B4.  button: to deliver steam to make hot milk-based coffees.
(When in the settings MENU: < button to scroll backwards)
- B5.  button: to perform a rinse cycle.
(When in the settings MENU: > button to scroll forwards)
- B6.  button : to make coffee using pre-ground coffee.
(When in the settings MENU: "OK" button to confirm the selection made)
- B7.  aroma selection button: to select the coffee taste
- B8.  button: to make 1 cup of short espresso coffee.
- B9.  button: to make 2 cups of short espresso coffee.
- B10. LONG button: to make 1 cup of LONG coffee
- B11.  button: to make 1 cup of long espresso coffee
- B12.  button: to make 2 cups of long espresso coffee

4.3 Description of the accessories

(page 2 - C)

- C1. "Total Hardness Test" indicator paper
- C2. Pre-ground coffee measure
- C3. Descaler
- C4. Water softener filter (*certain models only)
- C5. Cleaning brush
- C6. Power cord

5. BEFORE USE

5.1 Checking the appliance

After removing the packaging, make sure the product is complete and undamaged and that all accessories are present. Do not use the appliance if it is visibly damaged. Contact De'Longhi Customer Services.

5.2 Installing the appliance



Important!

When you install the appliance, you should respect the following safety warnings:

- The appliance gives off heat. After positioning the appliance on the worktop, leave a space of at least 3 cm between the surfaces of the appliance and the side and rear walls and at least 15 cm above the coffee machine.
- Water penetrating the coffee machine could cause damage.
Do not place the appliance near taps or sinks.
- The appliance could be damaged if the water it contains freezes.
Do not install the appliance in a room where the temperature could drop below freezing point.
- Arrange the cord in such a way that it cannot be damaged by sharp edges or contact with hot surfaces (e.g. electric hot plates).

5.3 Connecting the appliance



Important!

Check that the mains power supply voltage corresponds to the value indicated on the rating plate on the bottom of the appliance.

Connect the appliance to an efficiently earthed and correctly installed socket with a minimum current rating of 10A only.

If the power socket does not match the plug on the appliance, have the socket replaced with a suitable type by a qualified professional.

5.4 Setting up the appliance



Please note:

- Coffee has been used to factory test the appliance and it is therefore completely normal for there to be traces of coffee in the mill. The machine is, however, guaranteed to be new.
 - You should customise water hardness as soon as possible following the instructions in the section “15. Setting water hardness”.
1. Insert the power cord (C6) connector into the socket (A9) at the back of the appliance and connect the appliance to the mains electricity supply (fig. 1).
Make sure the main switch (A8) at the back of the appliance is pressed (fig. 2).

You must first choose the language (the languages scroll through at intervals of about 3 seconds).

2. When “English” appears, press the  button (B6- fig. 3) for a few seconds until “ENGLISH set” is displayed.

Follow the instructions indicated on the appliance display:

3. “Fill tank”: remove the water tank (A10), fill to the MAX line with fresh water (fig. 4A), then replace in the appliance (fig. 4B).
4. Place a container with a minimum capacity of 100 ml under the cappuccino maker (A19) (fig. 5).
5. “TURN STEAM DIAL”: turn the steam dial (A21) to the **I** position (fig. 5). “Hot water Confirm?” appears on the display;
6. Press the  button to confirm. The appliance delivers water from the cappuccino maker then goes off automatically.
7. Turn the steam dial to the **0** position.

The coffee machine is now ready for normal use.



Please note:

- When setting up the appliance, you need to make 4-5 cups of coffee or 4-5 cappuccinos before the appliance starts to give satisfactory results.
 - To enjoy your coffee even more and improve the performance of your appliance, we recommend installing a water softener filter (C4) as described in the section “16. Water softener filter”.
- If your model is not provided with a filter, you can request one from De'Longhi Customer Services.

6. TURNING THE APPLIANCE ON



Please note:

Before turning the appliance on, make sure the main switch (A8) on the back of the appliance is pressed (fig. 2).
Each time the appliance is turned on, it performs an automatic preheat and rinse cycle which cannot be interrupted.

The appliance is ready for use only after completion of this cycle.



Danger of burns!

During rinsing, a little hot water comes out of the coffee spouts (A13) and is collected in the drip tray (A18) underneath. Avoid contact with splashes of water.

- To turn the appliance on, press the  button (B2- fig. 6). The message “Heating up, Please wait” is displayed.

When heating is complete, the message changes to “Rinsing”.
As well as heating the boiler, this also heats the internal circuits by circulating hot water.

The appliance is at temperature when the message indicating the taste and quantity of coffee appears.

7. TURNING THE APPLIANCE OFF

Each time the appliance is turned off, it performs an automatic rinse cycle which cannot be interrupted.



Danger of burns!

During rinsing, a little hot water flows from the coffee spouts (A13).

Avoid contact with splashes of water.

To turn the appliance off, press the  button (B2, fig. 6). The appliance performs a rinse cycle then goes off (stand-by).



Please note:

If you will not be using the appliance for some time, unplug from the mains socket:

- first turn the appliance off by pressing the  button;
- press the main switch (A8 - fig. 2).



Important!

Never press the main switch while the appliance is on.

8. MENU SETTINGS

When you access the settings menu by pressing the **MENU** button (B3), the following menu items can be selected: Descaling, Adjust time, Auto-off, Auto-start, Set temperature, Energy saving, Water hardness, Set language, Install filter, Replace filter, Default values, Statistics.







8.1 Descaling

For instructions on descaling, see the section “14. Descaling”.

8.2 Adjust time

To adjust the time on the display (B1), proceed as follows:



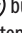
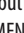



1. Press the **MENU** button (B3) to enter the menu;

2. Press the  (B4) or  (B5) button until "Adjust time" is displayed;
3. Press the  button (B6).
4. Press the  or  button to change the hour;
5. Press the  button to confirm;
6. Press the  or  button to change the minutes;
7. Press the  button to confirm.

The time is set: press MENU to exit menu.

8.3 Auto-off

Auto-off can be set so that the appliance goes off after 15 or 30 minutes, or after 1, 2 or 3 hours.

1. Press the **MENU** button (B3) to enter the menu;
2. Press the  (B4) or  (B5) button until "Auto-off" is displayed;
3. Press the  button (B6).
4. Press the  or  button until the number of minutes/ hours of operation is displayed (15 or 30 minutes, or 1, 2 or 3 hours);
5. Press the  button to confirm.

Auto-off is set. Press **MENU** to exit menu.







8.4 Auto-start

You can set the auto-start time in order to have the appliance ready at a certain time (for example in the morning) so you can make coffee immediately.

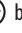

Please note:

To enable this function, the time must already be set correctly.

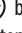
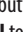
1. Press the **MENU** button (B3) to enter the menu;
2. Press the  (B4) or  (B5) button until "Auto-start" is displayed;
3. Press the  button (B6). "Enable?" is displayed;
4. Press the  button to confirm;
5. Press the  or  button to choose the hour;
6. Press the  button to confirm;
7. Press the  or  button to change the minutes;
8. Press the  button to confirm;
9. Then press **MENU** to exit menu.

Once the time has been confirmed, activation of auto-start is indicated by the  symbol displayed alongside the time and under "Auto-start" in the menu.



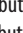
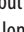



To disable the function:

1. Select auto-start from the menu;
2. Press the  button. "Disable?" is displayed;
3. Press the  button to confirm.

The  symbol is no longer displayed.

8.5 Set temperature

To modify the temperature (low, medium, high) of the water used to make the coffee, proceed as follows:

1. Press the **MENU** button (B3) to enter the menu;
2. Press the  (B4) or  (B5) button until "Set temperature" is displayed;
3. Press the  button (B6);
4. Press the  or  button until the required temperature is displayed (low, medium, high);
5. Press the  button to confirm.





The temperature is set. Press **MENU** to exit menu.

8.6 Energy saving

Use this function to enable or disable energy saving.

When enabled, the function reduces energy consumption in compliance with European regulations.

When energy saving mode is active, an asterisk appears below "Energy saving" in the menu.

1. Press the **MENU** button (B3) to enter the menu;
2. Press the  (B4) or  (B5) button until "Energy saving" is displayed;
3. Press the  button (B6). "Enable?" or "Disable?" is displayed;
4. Press the  button to enable or disable energy saving mode;

Then press **MENU** to exit menu.

When the function is active, if the machine is not used for some time, "Energy saving" is displayed.



Please note:







When in energy saving mode, a few seconds may elapse before the first coffee is delivered as the appliance must heat up again.

8.7 Setting water hardness

For instructions on setting water hardness, see section "15. Setting water hardness".

8.8 Setting the language

To modify the language on the display (B1), proceed as follows:

1. Press the **MENU** button (B3) to enter the menu;
2. Press the  (B4) or  (B5) button until "Set language" is displayed;
3. Press the  button (B6);
4. Press the  or  button until the required language is displayed;
5. Press the  button to confirm;

The language is set. Press **MENU** to exit menu.

8.9 Install filter





For instructions on how to install the filter (C4), see the section "16.1 Installing the filter".

8.10 Replacing the filter

For instructions on how to replace the filter (C4), see the section "8.10 Replacing the filter".







8.11 Default values (reset)

This resets all menu settings and programmed quantities back to the default values (with the exception of the language which remains as set).

1. Press the **MENU** button (B3) to enter the menu;
2. Press the  (B4) or  (B5) button until "Default values" is displayed;
3. Press the  button (B6);
4. The message "Confirm?" is now displayed;
5. Press the  button to confirm and exit.

8.12 Statistics function

This displays statistics relating to the machine. To display, proceed as follows:

1. Press the **MENU** button (B3) to enter the menu;
2. Press the  (B4) or  (B5) button until "Statistics" is displayed;
3. Press the  button (B6);
4. By pressing the  or  button you can check:
 - how many coffees have been made;
 - how many times the machine has been descaled;
 - the total number of litres of water delivered;
 - how many times the water filter has been replaced.
5. Press the  button twice to exit the menu.

9. MAKING COFFEE

9.1 Selecting the coffee taste

The appliance is set by default to make coffee with a standard taste.





You can also choose one of these tastes:

Extra mild taste
Mild taste
Standard taste
Strong taste
Extra-strong taste

To change the taste, press the  button (B7- fig. 7) repeatedly until the required taste is displayed.

9.2 Selecting the quantity of coffee in the cup

The appliance is set by default to automatically make the following quantities of coffee:

- short coffee (≈40ml) when the  button (B8) is pressed;
- long coffee (≈120ml) when the  button (B11) is pressed;
- two short espresso coffees when the  button (B9) is pressed;
- two long espresso coffees when the  button (B12) is pressed.

To change the quantity of coffee the appliance delivers automatically into the cup, proceed as described below.

- press and hold the button corresponding to the quantity to be modified until "PROGRAM QUANTITY" is displayed, then release the button;
- when the coffee in the cup reaches the desired level, press the same button again to memorise the new amount.

The machine is now reprogrammed with the new quantities.

9.3 Adjusting the coffee mill

The coffee mill is set by default to prepare coffee correctly and should not require regulating initially.

However, if after making the first few coffees you find that the coffee is either too weak and not creamy enough or delivery is too slow (a drop at a time), this can be corrected by adjusting the grinding adjustment dial (A2 - fig. 8).



Please note:

The grinding adjustment dial must only be turned when the coffee mill is in operation.

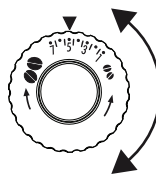

If the coffee is delivered too slowly or not at all, turn one click clockwise towards "7".

For fuller bodied creamier coffee, turn one click anticlockwise towards "1" (do not turn more than one click at a time otherwise the coffee could be

delivered a drop at a time).

These adjustments will only be evident after at least 2 cups of coffee have been delivered. If this adjustment does not obtain the desired result, turn the dial another click.

9.4 Tips for a hotter coffee

For hotter coffee, you should:

- before delivering the coffee, perform a rinse cycle by pressing the  button (B5). Hot water is delivered from the

- spout (A13), heating the internal circuits of the appliance and thus raising the coffee temperature;
- warm the cups with hot water (using the hot water function);
- set a hotter coffee temperature in the settings menu (see the section “8.5 Setting the temperature”).

9.5 Making coffee using coffee beans



Important!

Do not use caramelised or candied coffee beans as they could stick to the coffee mill and damage it.

- Fill the container (A7, fig. 9) with coffee beans.
- Place under the coffee spouts (A13):
 - 1 cup, if you want to make 1 coffee (fig. 10);
 - 2 cups, if you want 2 coffees (fig. 11);
- Lower the spouts as near as possible to the cup. This makes a creamier coffee (fig. 12).
- Press the button corresponding to the required coffee:



- Preparation begins and information on the coffee selected is displayed.

Once the coffee has been made, the appliance is ready to make the next drink.



Please note:

- While the machine is making coffee, delivery can be interrupted at any moment by pressing one of the coffee buttons.
- At the end of delivery, to increase the quantity of coffee in the cup, just press one of the coffee icons (within 3 seconds).
- For hotter coffee, see the section “9.4 Tips for a hotter coffee”.



Important!

- If the coffee is delivered a drop at a time, too weak and not creamy enough or too cold, read the tips in the section “20. Troubleshooting”.
- Various alarm messages may appear on the display (B1) while the machine is in use. Their meaning is explained in the section “19. Displayed messages”.

9.6 Making coffee using pre-ground coffee



Important!

- Never place coffee beans in the pre-ground coffee funnel (A6) as this could damage the appliance.

- Never add pre-ground coffee when the machine is off or it could spread through the inside of the machine and dirty it. This could damage the appliance.
- Never use more than 1 level measure (C1) or it could dirty the inside of the coffee machine or block the funnel.



Please note:

When you use pre-ground coffee, you can only make one cup of coffee at a time.

- Make sure the appliance is on.
- Press the ☞ button (B6).
- Make sure the funnel is not blocked, then add one level measure of pre-ground coffee (fig. 13).
- Place a cup under the coffee spouts (A13).
- Press the corresponding one cup coffee button (☞-B8 or ☞-B11).
- Preparation begins.

10. MAKING LONG COFFEE

LONG coffee can be made using either coffee beans or pre-ground coffee.

Follow the instructions above to prepare the machine and press the **LONG** button (B10).

11. MAKING CAPPUCCINO AND HOT MILK (NOT FROTHED)



Danger of burns!

During preparation, steam is given off. Take care to avoid scalds.

- When preparing cappuccino, make the coffee in a large cup;
- Fill a container with about 100 grams of milk for each cappuccino to be made. In choosing the size of the container, bear in mind that the milk doubles or triples in volume;



Please note:

For a richer denser froth, use skimmed or partially skimmed milk at refrigerator temperature (about 5°C). To avoid milk with poor froth or large bubbles, always clean the cappuccino maker (A19) as described in the section “Cleaning the cappuccino maker after use”.

- Make sure the cappuccino maker selection ring (A20) is positioned downwards in the “CAPPUCCINO” position (fig. 14);
- Press the ☞ (B4) button. “Heating up Please wait” appears on the display (B1), followed after a few seconds by “TURN STEAM DIAL”;

5. Turn the cappuccino maker outwards and immerse it in the milk container (fig. 15). Take care not to immerse the black ring;
6. Turn the steam dial (A21) to the **I** position (fig. 5). Steam is delivered from the cappuccino maker, giving the milk a creamy frothy appearance and making it more voluminous;
7. For a creamier froth, rotate the container with slow movements in an upward direction. (You should not deliver steam for more than 3 minutes at a time);
8. When you have obtained the required froth, stop steam delivery by turning the steam dial back to the **0** position.



Danger of burns!

Stop steam delivery before removing the container with the frothed milk to avoid burns caused by splashes of boiling milk.

9. Add the milk froth to the cup of coffee prepared previously. The cappuccino is ready. Sweeten to taste and, if desired, sprinkle the froth with a little cocoa powder.

11.1 Making hot milk (not frothed)

To make hot milk without froth, proceed as described in the above section, but with the cappuccino maker selection ring (A20) positioned upwards in the "HOT MILK" position.

11.2 Cleaning the cappuccino maker after use

Clean the cappuccino maker (A19) each time you use it to avoid the build-up of milk residues or blockages.



Danger of burns!

When cleaning the cappuccino maker, a little hot water is delivered. Avoid contact with splashes of water.

1. Deliver a little water for a few seconds by rotating the steam dial (A21) to the **I** position. Then turn the steam dial to the **0** position to stop the flow of hot water.
2. Wait a few minutes for the cappuccino maker to cool down. Turn the cappuccino maker outwards and remove it by pulling it downwards (fig. 16).
3. Move the selection ring (A20) upwards (fig. 17).
4. Remove the nozzle downwards (fig. 18).
5. Make sure the two holes shown by the arrow in fig. 19 are not blocked. If necessary, clean with a pin.
6. Replace the nozzle, move the ring downwards and put the cappuccino maker back on the nozzle (fig. 20), turning it and pushing it upwards until it is attached.

12. HOT WATER



Danger of burns!

Never leave the machine unattended while delivering hot water. As shown below, stop delivery of hot water when the cup is full. The cappuccino maker (A19) becomes hot while water is being delivered and must be held by the black ring (A20) only.

1. Place a container under the cappuccino maker (as close as possible to avoid splashes) (fig. 15).
2. Turn the steam dial (A19) to the **I** position. "Hot water" is displayed and delivery begins.
3. Stop by turning the steam dial to the **0** position.



Please note:

If "Energy Saving" mode is active, you may have to wait a few seconds before the hot water is delivered.

13. CLEANING

13.1 Cleaning the machine

The following parts of the machine must be cleaned regularly:

- the appliance's internal circuit;
- coffee grounds container (A14);
- drip tray (A18) and condensate tray (A15);
- water tank (A10);
- coffee spouts (A13);
- cappuccino maker (A19);
- pre-ground coffee funnel (A6);
- infuser (A12), accessible after opening the service door (A11);
- control panel (A1).



Important!

- Do not use solvents, abrasive detergents or alcohol to clean the coffee machine. With De'Longhi superautomatic coffee machines, you need not use chemical products to clean the machine.
- None of the components can be washed in a dishwasher.
- Do not use metal objects to remove encrustations or coffee deposits as they could scratch metal or plastic surfaces.

13.2 Cleaning the machine's internal circuit

If the appliance is not used for more than 3-4 days, before using it again, we strongly recommend switching it on and performing:

- 2/3 rinse cycles by pressing the button (B5);
- delivering hot water by turning the hot water/steam dial (A21) to the **I** position.



Please note:

After cleaning, it is normal for the grounds container (A14) to contain water.

13.3 Cleaning the coffee grounds container

When "EMPTY GROUNDS CONTAINER" appears on the display (B1), the grounds container must be emptied and cleaned. Until the grounds container (A14) has been cleaned, the appliance continues to display the message and coffee cannot be made.

To clean (with the machine on):

- Remove the drip tray (A18) (fig. 21), empty and clean;
- Empty the grounds container and clean thoroughly to remove all residues left on the bottom;
- Check the condensate tray (A15) (red) and empty if necessary.



Important!

When removing the drip tray, the grounds container **must** be emptied, even if it contains few grounds.

If this is not done, when you make the next coffees, the grounds container may fill up more than expected and clog the machine.

13.4 Cleaning the drip tray and condensate tray



Important!

If the drip tray (A18) is not emptied regularly, the water could overflow from the edge and seep inside or around the machine. This could damage the machine, the surface it rests on or the surrounding area. The drip tray is fitted with a level indicator (A17) (red) showing the level of water it contains (fig. 22). Before the indicator protrudes from the cup tray (A16), the drip tray must be emptied and cleaned.

To remove the drip tray:

1. Remove the drip tray and the grounds container (A14) (fig. 21);
2. Empty the drip tray and grounds container and wash them;
3. Check the condensate tray (A15) (red) and empty if necessary;
4. Replace the drip tray and grounds container.

13.5 Cleaning the inside of the coffee machine



Danger!

Before cleaning internal parts, the machine must be turned off (see section "7. Turning off") and unplugged from the mains power supply. Never immerse the coffee machine in water.

1. Check regularly (about once a month) that the inside of the appliance (accessible after removing the drip tray - A18) is not dirty. If necessary, remove coffee deposits with the brush (C5) or a sponge.
2. Remove the residues with a vacuum cleaner (fig. 23).

13.6 Cleaning the water tank

1. Clean the water tank (A10) regularly (about once a month and whenever you replace the water softener filter (C4) (if provided) with a damp cloth and a little mild washing up liquid;
2. Remove the filter (if present) and rinse with running water;
3. Replace the filter (if provided), fill the tank with fresh water and replace the tank;
4. (Models with water softener filter only) Deliver about 100ml of hot water to reactivate the filter.

13.7 Cleaning the coffee spouts

1. Clean the coffee spouts (A13) with a sponge or cloth (fig. 24A);
2. Check that the holes in the coffee spouts are not blocked. If necessary, remove coffee deposits with a toothpick (fig. 24B).

13.8 Cleaning the pre-ground coffee funnel

Check regularly (about once a month) that the pre-ground coffee funnel (A6) is not blocked. If necessary, remove coffee deposits with the brush (C5).

13.9 Cleaning the infuser

The infuser (A12) must be cleaned at least once a month.



Important!

The infuser may not be extracted when the machine is on.

1. Make sure the machine is correctly turned off (see section "7. Turning off");
2. Remove the water tank (A10);
3. Open the infuser door (A11) (fig. 25) on the right side of the appliance;
4. Press the two coloured release buttons inwards and at the same time pull the infuser outwards (fig. 26);



Important!

RINSE WITH WATER ONLY

NO WASHING UP LIQUID - NO DISH WASHER

Clean the infuser without using washing up liquid as it could be damaged.

5. Soak the infuser in water for about 5 minutes, then rinse under the tap;
6. Use the brush (C5) to remove any coffee residues left in the infuser housing, visible through the infuser door;
7. After cleaning, replace the infuser by sliding it onto the internal support (fig. 27), then push the PUSH symbol fully in until it clicks into place.

Please note:

If the infuser is difficult to insert, before insertion, adapt it to the right size by pressing the two levers (fig. 28).



- Once inserted, make sure the two coloured buttons have snapped out (fig. 29).
- Close the infuser door.
- Put the water tank back.

14. DESCALING

Descal the machine when the message "DESCALE" flashes on the display (B1).

Important!

- Before use, read the instructions and the labelling on the descaler pack.
- You should use De'Longhi descaler only.
Using unsuitable descaler and/or performing descaling incorrectly may result in faults not covered by the manufacturer's guarantee.

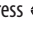
- Turn the appliance on and wait until it is ready for use;
- Press the MENU button (B3) to access the menu;
- Press the  (B4) or  (B8) button until "Descal" is displayed;
- Select by pressing the  button (B6): "Descal Confirm?" is displayed. Press  again to enable the function;
- The message "Add descaler Confirm?" is displayed;
- Empty the water tank (A10) completely and remove the water softener filter (C4- if present);
- Pour the descaler (C3) into the tank up to level A (corresponding to a 100 ml pack) marked on the inner surface of the tank, then add a litre of water up to level B (fig. 30) and put the water tank back in the appliance;
- Place an empty container with a minimum capacity of 1.8 litres under the cappuccino maker (A19) and coffee spouts (A13) (fig. 31).

Important! Danger of burns

Hot water containing acid flows from the cappuccino maker and coffee spouts. Take care to avoid contact with splashes of this solution.

- Press the  button (B6) to confirm that the descaler solution has been introduced. "TURN STEAM DIAL" then appears on the display;
- Turn the hot water/steam dial to the **I** position (fig. 5); the descale programme starts and the descaler liquid comes out of the cappuccino maker and coffee spouts. A series of

rinses and pauses are performed automatically to remove all the scale residues inside the coffee machine;

After about 25 minutes, descaling stops and the message "FILL TANK" appears on the display. Turn the hot water/steam dial to the **0** position and empty the container used to collect the descaler;

- The appliance is now ready for rinsing through with clean water. Remove the water tank, empty, rinse under running water, fill with fresh water up to the MAX level and put back in the appliance: the message "TURN STEAM DIAL" is displayed;
- Place the container used to collect the descaler solution empty under the cappuccino maker and coffee spouts (fig. 31);
- Turn the hot water/steam dial to the **I** position to begin rinsing. Hot water is delivered first from the cappuccino maker, to continue and end with the coffee spouts;
- When the water tank is completely empty, the message "FILL TANK" appears on the display. Turn the hot water/steam dial to the **0** position and empty the container used to collect the rinsing water;
- Remove the water tank, replace the water softener filter (if previously removed), fill the tank up to the MAX level with fresh water and put back in the appliance. "TURN STEAM DIAL" appears on the display;
- Place the container used to collect the rinsing water empty under the cappuccino maker;
- Turn the hot water/steam dial to the **I** position. Rinsing continues from the cappuccino maker only;
- When it finishes, the message "TURN STEAM DIAL" appears on the display. Turn the hot water/steam dial to the **0** position;
- The message "FILL TANK" is displayed. Remove and top up the water tank with fresh water to the MAX level and put back in the machine.

Descaling is complete.

Please note:

- If the descaling cycle is not completed correctly (e.g. no electricity) we recommend repeating the cycle;
- After descaling, it is normal for the grounds container (A14) to contain water.

15. SETTING WATER HARDNESS

The DESCALE message is displayed after a period of time established according to water hardness.

The machine is set by default for a hardness value of 4.



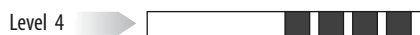
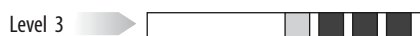

The machine can also be programmed according to the hardness of the mains water in the various regions so that the machine needs to be descaled less often.

15.1 Measuring water hardness

1. Remove the "TOTAL HARDNESS TEST" indicator paper (C1) from its pack (attached to the English instructions);
2. Immerse the paper completely in a glass of water for one second.
3. Remove the paper from the water and shake lightly. After about a minute, 1, 2, 3, or 4 red squares form, depending on the hardness of the water. Each square corresponds to one level.

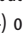

15.2 Setting water hardness

1. Press the **MENU** button (B3) to enter the menu;
2. Press the  (B4) or  (B5) button until "Water hardness" is displayed (B1).
3. Confirm the selection by pressing the  button (B6).
4. Press the  or  button repeatedly to set the level as measured by the indicator paper (see previous section).
5. Press the  button to confirm the setting.

The machine is now reprogrammed with the new water hardness setting. Press the **MENU** button to exit the menu.

16. WATER SOFTENER FILTER

Certain models are fitted with a water softener filter (C4). If this is not the case with your model, you are recommended to purchase one from De'Longhi Customer Services.

To use the filter correctly, follow the instructions below.

16.1 Installing the filter

1. Remove the filter (C4) from the packaging.
2. Turn the date indicator disk (see fig. 32) until the next two months of use are displayed.



Please note:



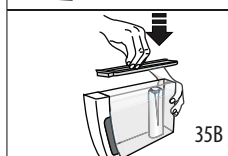
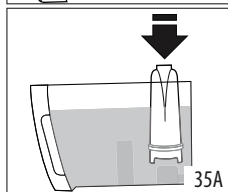
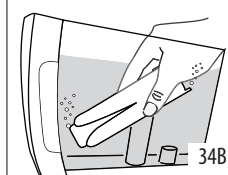
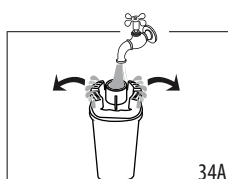

The filter lasts about two months if the appliance is used normally.

If the coffee machine is left unused with the filter installed, it will last a maximum of three weeks.

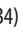

3. To activate the filter, run tap water through the hole in the filter as shown in the figure until water comes out of the openings at the side for more than a minute (fig. 34A);
4. Extract the tank (A10) from the appliance and fill with water;
5. Insert the filter in the water tank and immerse it completely for about ten minutes, sloping it to enable the air bubbles to escape (fig. 34B);
6. Insert the filter in the filter housing (fig. 35A) and press as far as it will go;
7. Close the tank with the lid (fig. 35B), then replace the tank in the machine.





When you install the filter, you must notify the appliance of its presence.

8. Press the **MENU** button (B3) to enter the menu;
9. Press the  (B4) or  (B5) button repeatedly until "Install filter" is displayed;
10. Press the  button (B6);
11. "Enable?" is displayed;
12. Press the  button to confirm selection. "TURN STEAM DIAL" appears on the display;
13. Place a container (min. capacity: 100ml) underneath the cappuccino maker (A19);
14. Turn the steam dial (A21) to the **I** position (fig. 5). "Hot Water Confirm?" is displayed;
15. Press the  button to confirm the selection. The appliance begins hot water delivery and the message "Please wait..." is displayed.
16. Once delivery is completed, "TURN STEAM DIAL" is displayed.
17. Turn the steam dial to the **0** position. The appliance returns automatically to the "Ready for coffee" state.

The new filter is active and indicated by an asterisk displayed under "Install filter" in the menu. You can now use the appliance.

16.2 Replacing the filter





When "REPLACE FILTER" is displayed (B1), after two months (see date indicator) or when the appliance has not been used for 3 weeks, you should replace the filter:

1. Extract the tank (A10) and exhausted filter;
2. Take the new filter out of its packet and proceed as illustrated in points 3, 4, 5 and 6 in the previous section;
3. Place a container (min. capacity: 100 ml) under the cappuccino maker;
4. Press the **MENU** button (B3) to enter the menu;
5. Press the  (B4) or  (B5) button repeatedly until "Replace filter" is displayed.
6. Press the  button (B6);
7. The message "Confirm?" is now displayed.
8. Press the  button to confirm selection. "TURN STEAM DIAL" appears on the display;
9. Turn the steam dial (A21) to the **I** position. "Hot Water... Confirm?" is displayed;
10. Press the  button to confirm the selection. The appliance begins hot water delivery and the message "Please wait..." is displayed.
11. After delivery, "TURN STEAM DIAL" is displayed. Turn the steam dial to the **0** position and the appliance returns automatically to the "Ready for coffee" position.

The new filter is now active and you can use the coffee machine.

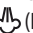
16.3 Removing the filter

If you want to use the appliance without the filter, you must remove it and notify the appliance of its removal. Proceed as follows:

1. Extract the tank (A10) and exhausted filter (C4);
2. Press the **MENU** button (B3) to enter the menu;
3. Press the  (B4) or  (B5) button repeatedly until "Install filter" is displayed (B1);
4. Press the  on (B6);
5. "Disable?" is displayed;
6. Press the  button to confirm and the **MENU** button to exit the menu.

17. TECHNICAL DATA

Voltage:	220-240 V~ 50/60 Hz max. 10 A
Power	1450 W
Pressure	1,5 MPa (15 bars)
Water tank capacity:	1,8 L
Size LxHxD:	240x430x350 mm
Cord length:	1750 mm
Weight	8,8 Kg
Beans container capacity:	250 g

 The appliance complies with the following EC directives:

- European Standby Regulation 1275/2008
- Materials and accessories coming into contact with food conform to EEC regulation 1935/2004.

18. DISPOSAL



The appliance must not be disposed of with household waste, but taken to an authorised waste separation and recycling centre.

19. DISPLAYED MESSAGES

DISPLAYED MESSAGE	POSSIBLE CAUSE	SOLUTION
FILL TANK	Insufficient water in the tank (A10).	Fill the tank with water and/or insert it correctly, pushing it as far as it will go until it clicks into place (fig. 4).
EMPTY GROUNDS CONTAINER	The grounds container (A14) is full.	Empty the grounds container and drip tray (A18), clean (fig. 21) and replace. Important: when removing the drip tray, the grounds container MUST be emptied, even if it contains few grounds. If this is not done, when you make the next coffees, the grounds container may fill up more than expected and clog the machine.
GROUND TOO FINE ADJUST MILL! alternating with... TURN STEAM DIAL	The grinding is too fine and the coffee is delivered too slowly or not at all.	Repeat coffee delivery and turn the grinding adjustment dial (A2, fig. 8) one click clockwise towards «7» while the coffee mill is in operation. If after making at least 2 coffees delivery is still too slow, repeat the correction procedure, turning the grinding adjustment dial another click until delivery is correct (see the section: «9.3 Adjusting the coffee mill»). If the problem persists, turn the steam dial (A21) to the I position and let some water run from the cappuccino maker.
	If the water softener filter (C4) is present, an air bubble may have been released inside the circuit, obstructing delivery.	Deliver a little water by turning the steam dial (A21) to the I position until the flow is regular.
INSERT GROUNDS CONTAINER	After cleaning, the grounds container has not been replaced (A14).	Remove the drip tray (A18) and insert the grounds container.
ADD PRE-GROUND COFFEE	The "pre-ground coffee" function has been selected without placing any pre-ground coffee in the funnel (A6).	Place pre-ground coffee in the funnel or deselect the "pre-ground" function.
DESCALE	The machine must be descaled.	The descaling procedure described in the section "14. Descaling" needs to be performed as soon as possible.
REDUCE COFFEE AMOUNT	Too much coffee has been used.	Select a milder taste or reduce the quantity of pre-ground coffee.
FILL BEANS CONTAINER	The coffee beans have run out.	Fill the beans container (A7).
	The pre-ground coffee funnel (A6) is clogged.	Empty the funnel with the help of the brush (C5) as described in the section "13.8 Cleaning the pre-ground coffee funnel".
INSERT INFUSER ASSEMBLY	The infuser has not been replaced after cleaning (A12).	Insert the infuser as described in the section "13.9 Cleaning the infuser".

INSERT TANK	The tank (A10) is not correctly in place.	Insert the tank correctly and press as far as it will go.
GENERAL ALARM	The inside of the appliance is very dirty.	Clean the inside of the appliance thoroughly, as described in the section "13. Cleaning". If the message is still displayed after cleaning, contact a service centre.
REPLACE FILTER	The water softener filter (C4) is exhausted.	Replace the filter or remove it as described in the section "16. Water softener filter".
EMPTY CIRCUIT FILL CIRCUIT <i>alternating with</i> HOT WATER PRESS OK	The water circuit is empty.	Press the  button (B6) and deliver water from the cappuccino maker (A19) until it flows out normally. If the problem persists, make sure the water tank (A10) is fully inserted.

20. TROUBLESHOOTING

Below is a list of some of the possible malfunctions.

If the problem cannot be resolved as described, contact Customer Services.

PROBLEM	POSSIBLE CAUSE	SOLUTION
The coffee is not hot.	The cups were not preheated.	Warm the cups by rinsing them with hot water (Please note: you can use the hot water function).
	The internal circuits of the appliance have cooled down because 2/3 minutes have elapsed since the last coffee was made.	Before making coffee, heat up the infuser by pressing the  rinse button (B5).
	A low coffee temperature is set.	Set a hotter coffee temperature (see the section «8.5 Setting the temperature»).
The coffee is weak or not creamy enough.	The coffee is ground too coarsely.	Turn the grinding adjustment dial (A2) one click anticlockwise towards "1" while the coffee mill is in operation (fig. 8). Continue one click at a time until coffee delivery is satisfactory. The effect is only visible after delivering 2 coffees (see section "9.3 Adjusting the coffee mill").
	The coffee is unsuitable.	Use pre-ground coffee for espresso machines.
The coffee is delivered too slowly or a drop at a time.	The coffee is ground too finely.	Turn the grinding adjustment dial (A2) one click clockwise towards «7» while the coffee mill is in operation (fig. 10). Continue one click at a time until coffee delivery is satisfactory. The effect is only visible after delivering 2 coffees (see section «9.3 Adjusting the coffee mill»).

Coffee does not come out of one or both of the spouts (A13).	The coffee spouts are blocked.	Clean the spouts with a toothpick.
The frothed milk has large bubbles	The milk is not cold enough or is not semi-skimmed.	You should ideally use skimmed or semi-skimmed milk at refrigerator temperature (about 5°C). If the result is not as you wished, try changing brand of milk.
The milk is not frothed	The cappuccino maker (A19) is dirty.	Clean as described in the section "11.2 Cleaning the cappuccino maker after use".
	The ring on the cappuccino maker (A20) is NOT in the cappuccino position.	Place the ring in the cappuccino position.
Steam delivery stops	A safety device stops steam delivery after 3 minutes.	Wait, then enable the steam function again.
The appliance does not come on	It is not plugged into the mains socket.	Plug into the mains socket.
	The main switch (A8) is not turned on.	Push the main switch into the I position (fig. 2).

21. ELECTRICAL REQUIREMENTS (UK ONLY)

Before using this appliance ensure that the voltage indicated on the product corresponds with the main voltage in your home, if you are in any doubt about your supply contact your local electricity company.

The flexible mains lead is supplied connected to a B.S. 1363 fused plug having a fuse of 13 amp capacity.

Should this plug not fit the socket outlets in your home, it should be cut off and replaced with a suitable plug, following the procedure outlined below.

Note: Such a plug cannot be used for any other appliance and should therefore be properly disposed of and not left where children might find it and plug it into a supply socket - with the obvious consequent danger.

N.B. We recommend the use of good quality plugs and wall sockets that can be switched off when the machine is not in use.

IMPORTANT: the wires in the mains lead fitted to this appliance are coloured in accordance with the following code:

GREEN AND YELLOW
BLUE
BROWN

EARTH
NEUTRAL
LIVE

Green and Yellow to Earth

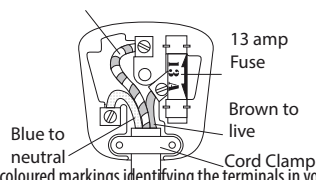

As the colours of the wires in the mains lead of this appliance may not correspond with the coloured markings identifying the terminals in your plug, proceed as follows:

- The wire which is coloured green and yellow must be connected to the terminal in the plug which is marked with the letter E or by the earth symbol  or coloured green or green and yellow.
- The wire which is coloured blue must be connected to the terminal which is marked with the letter N or coloured black.
- The wire which is coloured brown must be connected to the terminal which is marked with the letter L or coloured red.

When wiring the plug, ensure that all strands of wire are securely retained in each terminal. Do not forget to tighten the mains lead clamp on the plug. If your electricity supply point has only two pin socket outlets, or if you are in doubt, consult a qualified electrician.

Should the mains lead ever require replacement, it is essential that this operation be carried out by a qualified electrician and should only be replaced with a flexible cord of the same size.

After replacement of a fuse in the plug, the fuse cover must be refitted. If the fuse cover is lost, the plug must not be used until a replacement cover is obtained. The colour of the correct replacement fuse cover is that of the coloured insert in the base of the fuse recess or elsewhere on the plug. Always state this colour when ordering a replacement fuse cover. Only 13amp replacement fuses which are asta approved to B.S. 1362 should be fitted.

This appliance conforms to the Norms EN 55014 regarding the suppression of radio interference.

Warning - this appliance must be earthed